

STAGE 1 HIGH PERFORMANCE AIR CLEANER KIT



P/N 2881779-XXX

REGULATORY NOTIFICATION:

⚠ This kit meets EPA and CARB emission limits. Tampering with emission related parts can lead to substantial regulatory penalties. Non-competition street use may violate federal noise limits.

APPLICATION

Verify accessory fitment at www.indianmotorcycle.com.

BEFORE YOU BEGIN

Read these instructions and check to be sure all parts and tools are accounted for. Please retain these installation instructions for future reference and parts ordering information.

KIT CONTENTS

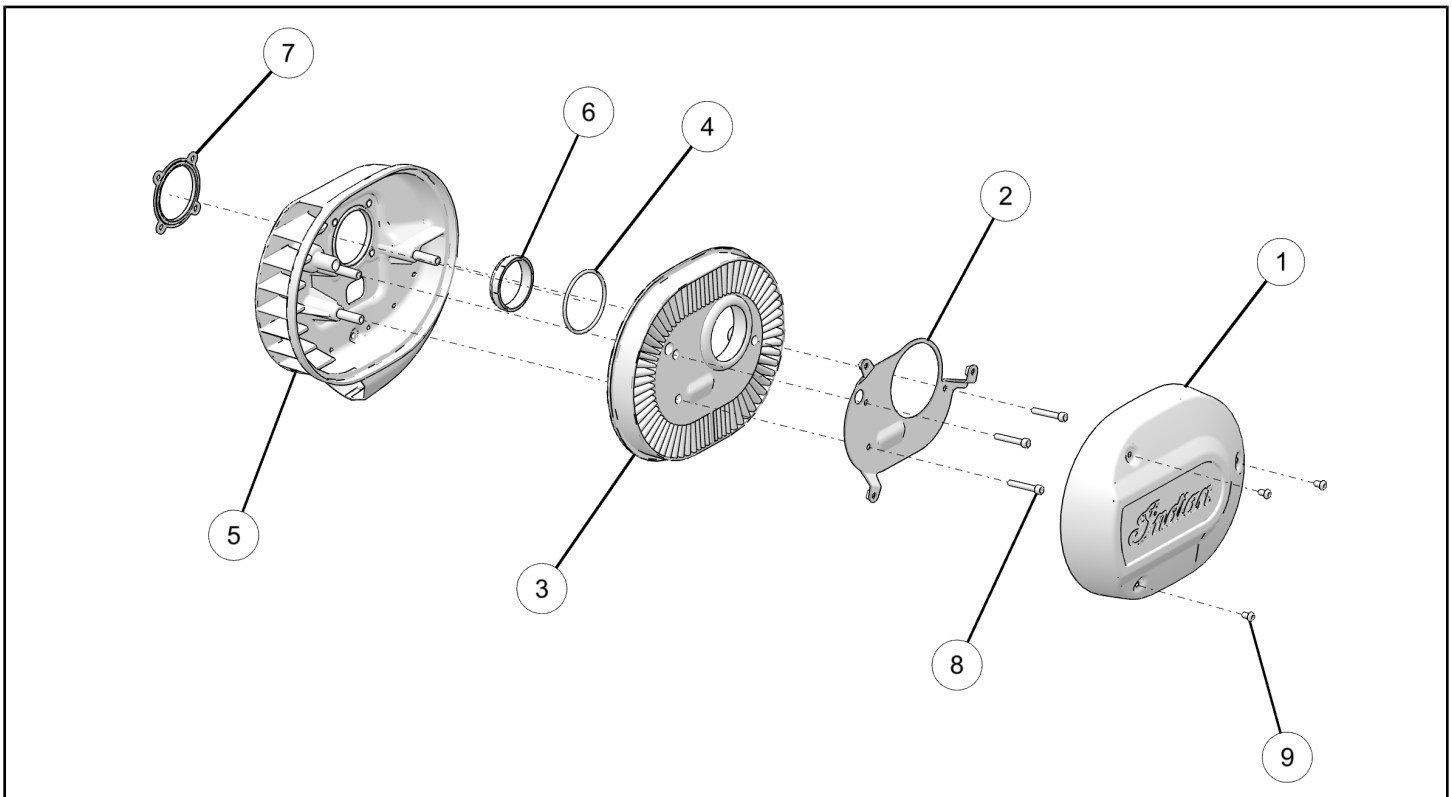

NOTE

XXX = Indian Motorcycle® color code (For example: 521 = Black)

REF	QTY	PART DESCRIPTION	P/N AVAILABLE SEPARATELY
1	1	Airbox Cover	-
2	1	Bracket	-
3	1	Air Intake Filter	5415825
4	1	O - Ring	5415963
5	1	Airbox Base	-

REF	QTY	PART DESCRIPTION	P/N AVAILABLE SEPARATELY
6	1	Adapter (MY 18 and older w/stock throttle housing)	-
7	1	Airbox Gasket	-
8	3	Screw, M6 X 1.0 X 40	7517261
9	3	Screw, M6 X 1.0 X 10	7517406
10	1	Calibration Card (Not Shown)	-
11	1	Label, CARB (Not Shown)	-
	1	Instructions	9927781

TOOLS REQUIRED

- Safety Glasses
- Hex Key Set, Metric
- Socket Set, Hex Bit, Metric
- Socket Set, Metric
- Socket Set, Torx® Bit
- Torque Wrench

IMPORTANT

Your Indian Stage 1 High Performance Air Cleaner Kit is exclusively designed for your vehicle. Please read the installation instructions thoroughly before beginning. Installation is easier if the vehicle is clean and free of debris. For your safety, and to ensure a satisfactory installation, perform all installation steps correctly in the sequence shown.

INSTALLATION INSTRUCTIONS

VEHICLE PREPARATION

GENERAL

1. Turn key or ignition switch to “OFF” position and remove key. If equipped with keyless fob, remove fob from proximity of vehicle.
2. Ensure motorcycle is parked on a flat surface, kickstand is fully extended, and vehicle is stable prior to installation.
3. Remove seat and side covers as per owner’s manual.

STOCK AIRBOX REMOVAL

1. Remove and retain two rear tank mount bolts and washers **(A)**.

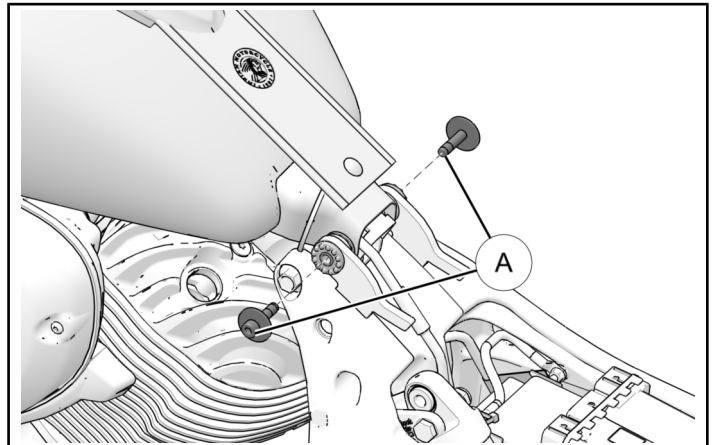

2. Remove and discard three airbox cover mounting screws (B). Remove and discard stock airbox cover (C).

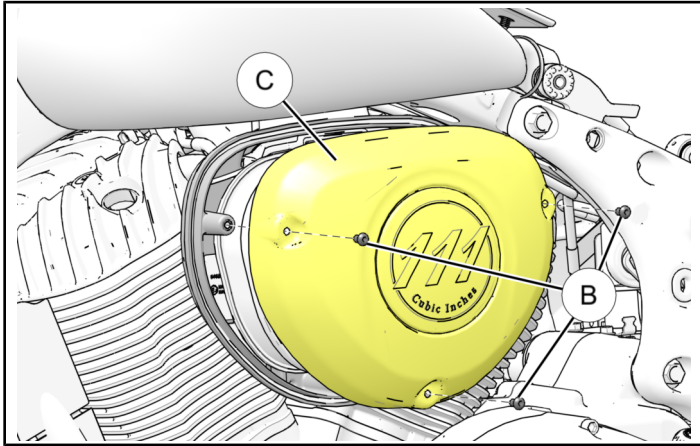

5. Lift rear of fuel tank to gain access. Remove and retain two airbox connector base screws (H) from airbox connector base (J).

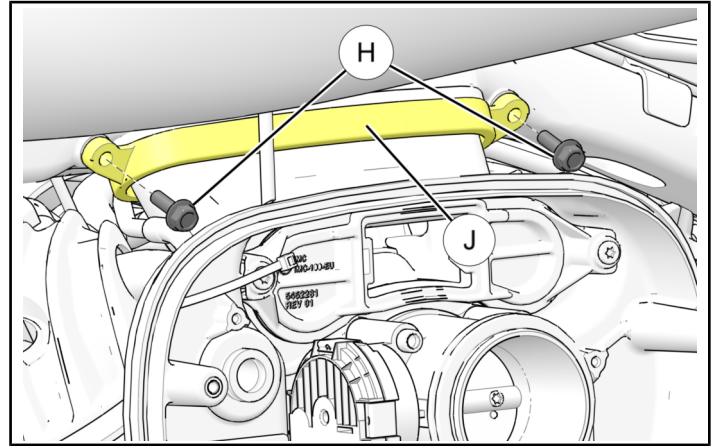

3. Remove and discard three air filter mounting screws (D) and stock air filter (E).

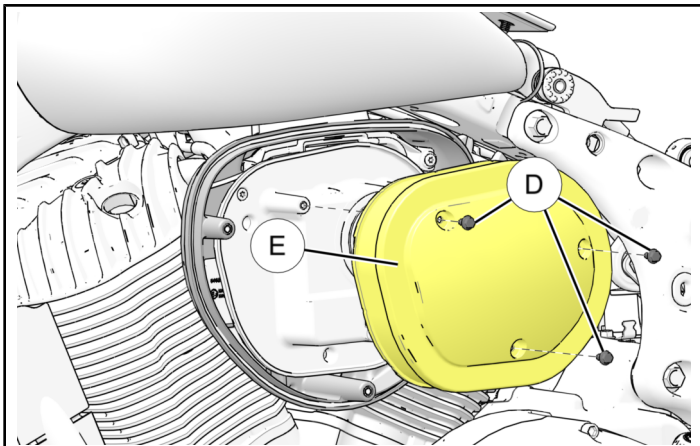

6. Disconnect electrical connection (K) to throttle valve (L). Disengage wire, connector, and grommet (M) through back of airbox base (N). Discard grommet.

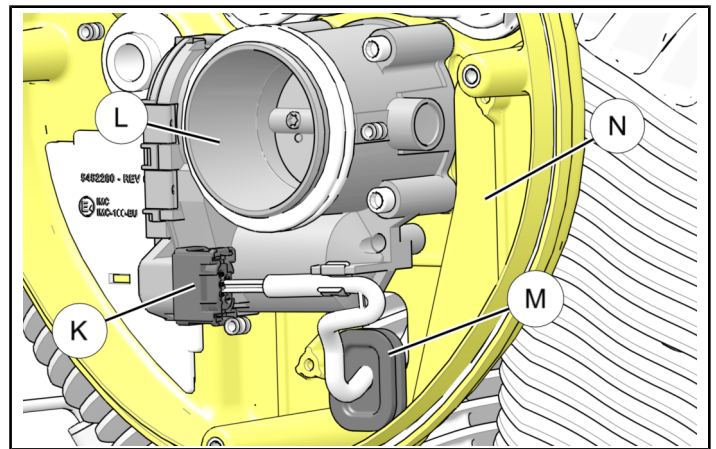

4. Remove and discard three air filter retainer screws (F). Twist and pull air filter retainer (G) to remove and discard.

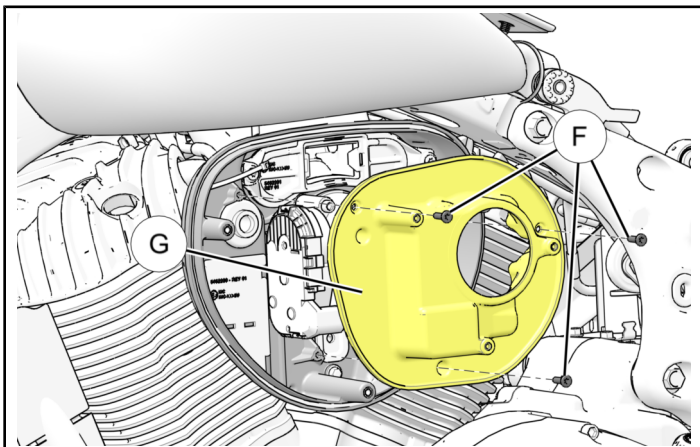

7. Remove and discard four throttle valve mounting screws (P). Remove throttle valve (L) from airbox base (N). Carefully set aside throttle valve (L) for reinstallation.

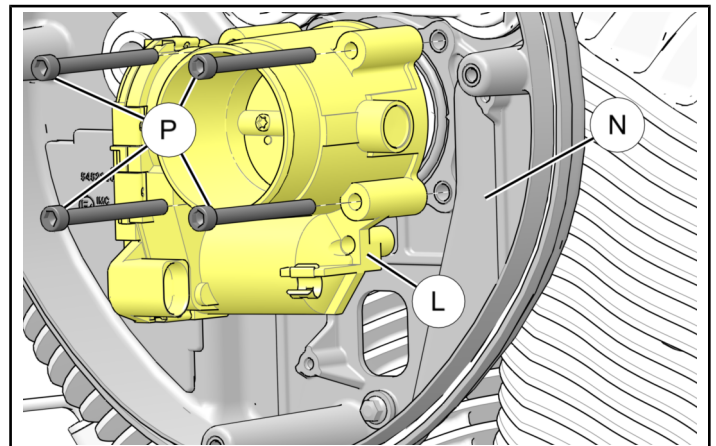

8. Carefully remove and retain throttle valve to airbox o-ring (Q). Remove and retain airbox base screw (R).

NOTE

Inspect o-ring for damage or wear. If any is found, replace o-ring.

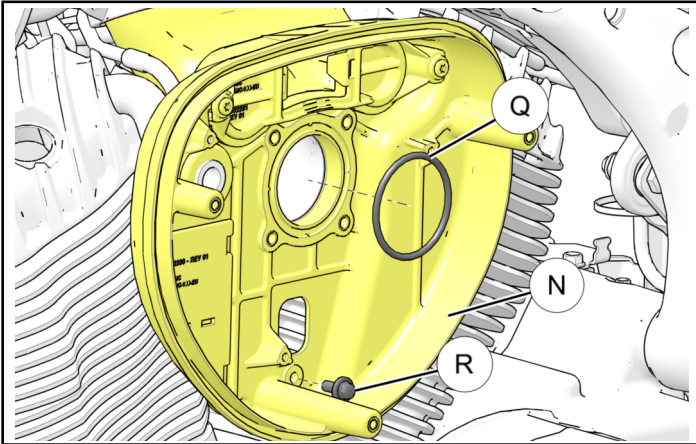

9. Remove Airbox Base (N) from frame. Ensure airbox to intake manifold o-ring (S) is removed from bracket.

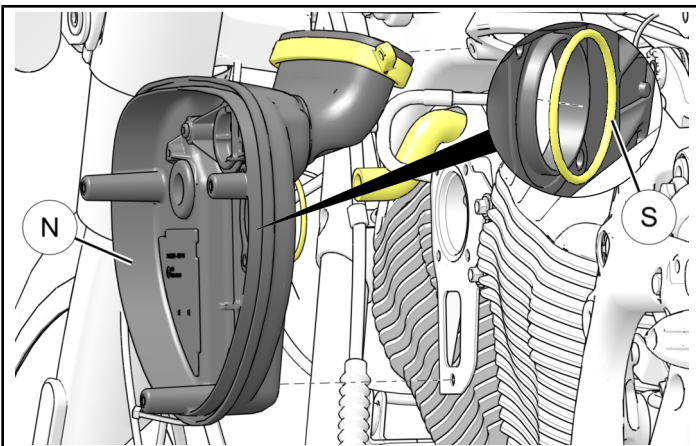

10. Remove and retain breather hose (T) from engine.

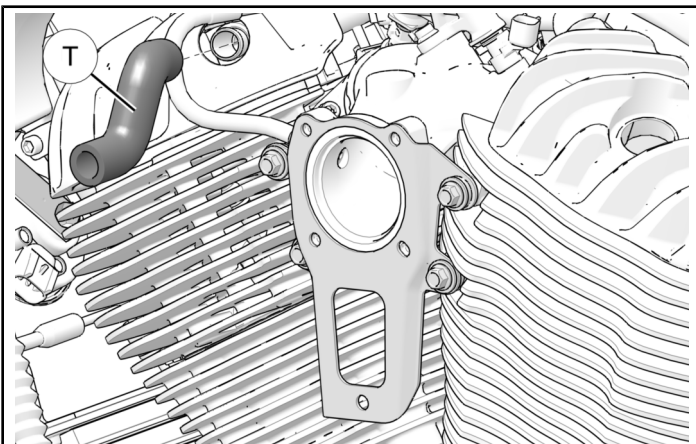

STAGE 1 PERFORMANCE AIR CLEANER KIT INSTALLATION

AIRBOX INSTALLATION

1. Install airbox gasket (7) onto intake manifold.
 - a. Ensure protruding rubber-lined edge faces into intake manifold.
 - b. Sealing surface of sealing ring should face outward when oriented correctly.

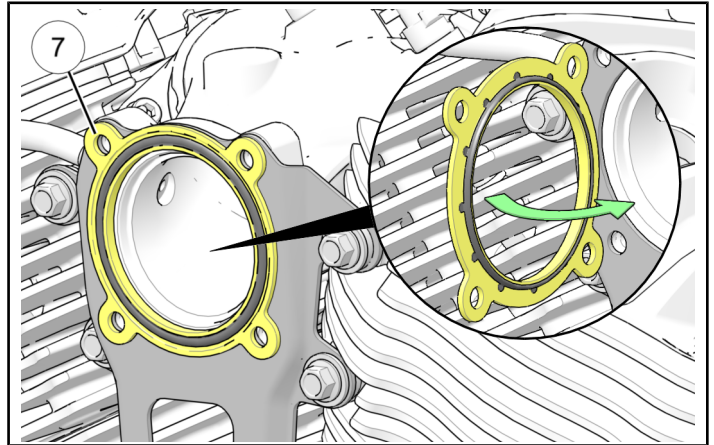

2. Install retained stock breather hose (T) onto new airbox (5) back first. This will make installation easier.

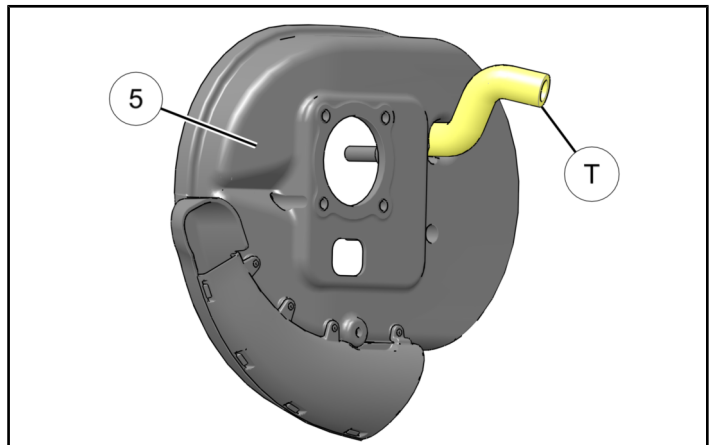

3. Position airbox base ⑤ on engine as shown and feed throttle body wire connector ① through hole in airbox base ⑤. Install rubber harness seal ② in rectangular cutout as shown.

IMPORTANT

Ensure harness seal is fully seated in air box cutout.

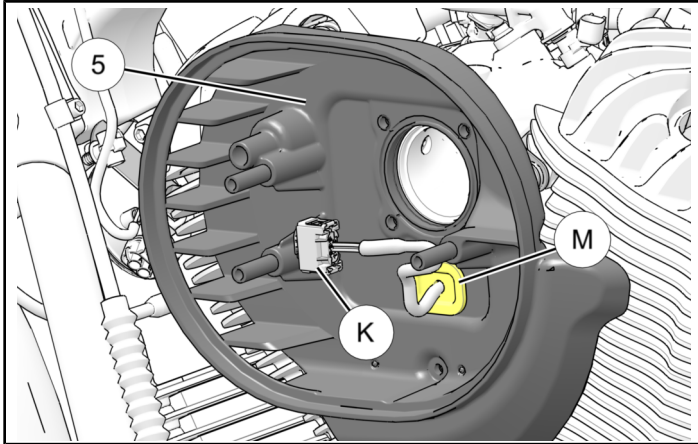

4. Loosely install airbox base ⑤ to engine using retained screw and washer ④. **Do not tighten screw ③.** Slide cylinder head end of breather hose ⑤ onto cylinder head breather spigot.

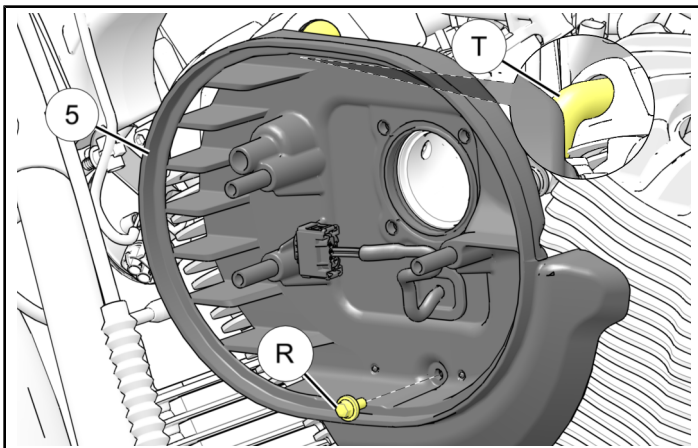

5. **Model year 2018 and older Adapter Installation** (If Model 2019 or newer, skip to step 8)

- a. Insert new adapter ⑥ inside airbox base ⑤. Ensure protruding lip is facing into intake manifold when assembled as shown.

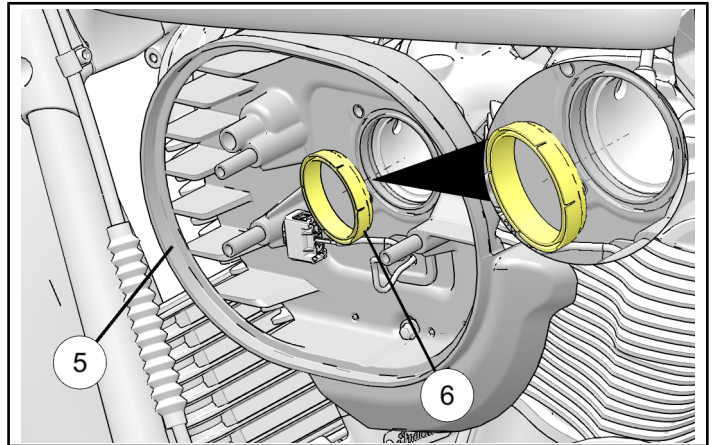

6. Install new throttle body sealing O-ring ④ in groove in airbox back ⑤ as shown.

NOTE

Ensure airbox gasket holes are aligned with airbox back screw holes.

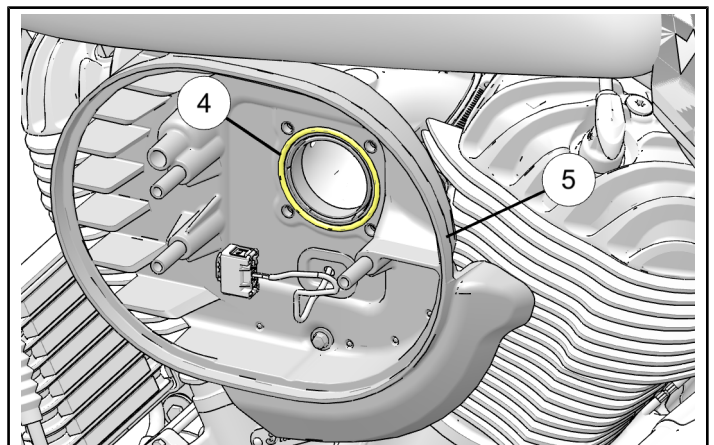

7. Install retained throttle valve **L** onto airbox **5** back using four retained screws **P**. Torque screws **P** to specification.

TORQUE

Throttle Valve Screws **P**: **88 in. lbs. (10 Nm)**

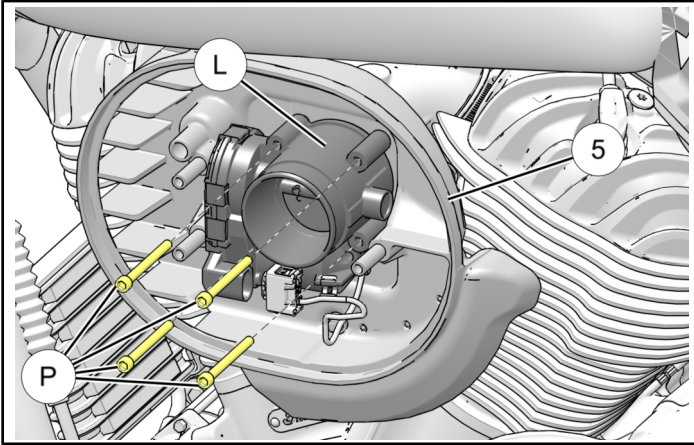

8. Plug throttle body wire connector **K** into throttle body **L**. Torque airbox base screw **R** to specification.

TORQUE

Airbox Base Screw **R**: **88 in. lbs. (10 Nm)**

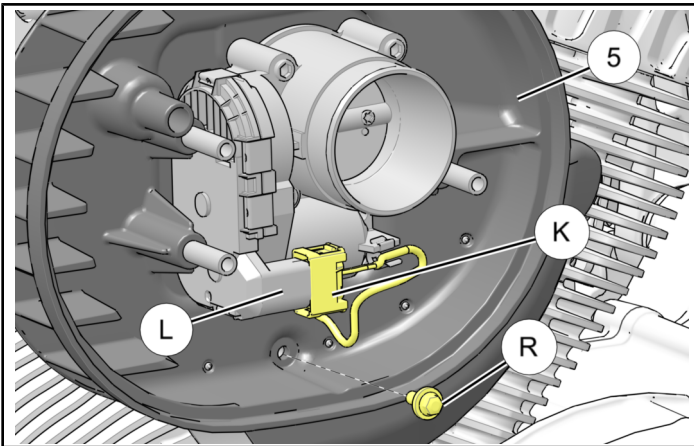

9. Install new filter element **3** onto airbox **5** back. Ensure throttle body **L** seats into velocity stack molding.

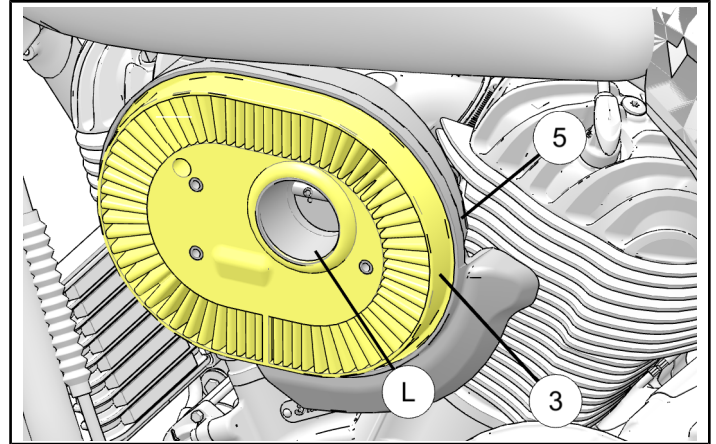

10. Install new filter element bracket cover **2** onto airbox assembly **5** using three new screws **8**. Torque screws **8** to specification.

TORQUE

Air Filter Bracket Screw **8**: **88 in. lbs. (10 Nm)**

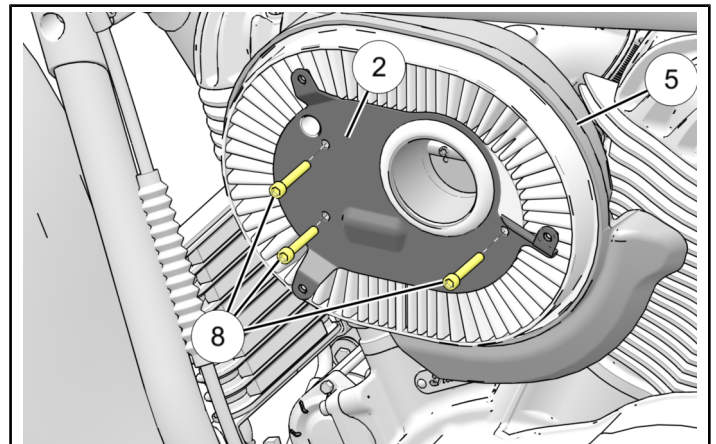

11. Install new airbox cover ① using three new screws ⑨. Torque screws ⑨ to specification.

TORQUE

Airbox Cover Screw ⑨: **88 in. lbs. (10 Nm)**

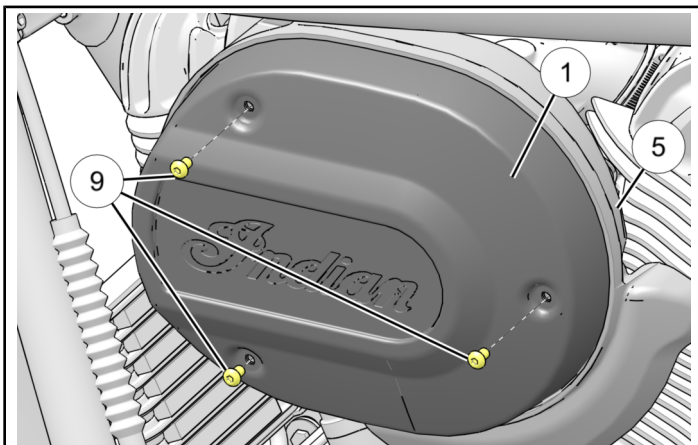

12. Reinstall fuel tank into position and install two retained screws ① (Removed in **step 1** of *Stock Airbox Removal* section). Torque screws to specification.

TORQUE

Fuel Tank Screws ①: **18 ft. lbs. (24 Nm)**

VEHICLE REASSEMBLY

GENERAL

1. Reinstall seat and side covers as per owner's manual.

RECOMMENDED SERVICE INTERVALS

- Inspect filter element: Every 5,000 miles.
- Replace filter element: Every 10,000 miles. (Filter element PN: 5415825)

FEEDBACK FORM

A feedback form has been created for the installer to provide any comments, questions or concerns about the installation instructions. The form is viewable on mobile devices by scanning the QR code or by clicking [HERE](#) if viewing on a PC.

FEEDBACK FORM



APPLY LABEL AND UPDATE ECM

1. **If motorcycle is a MY2014 or MY2015 “50-state” model:** Install aftermarket exemption label ⑪ required by California Air Resource Board. To determine if motorcycle is a 50-state model, look for a California EVAP label (PN7183238) ⑤ on left hand tube frame ⑥. If label is on frame, apply CARB exemption label ⑪ on left hand tube frame underneath EVAP label.

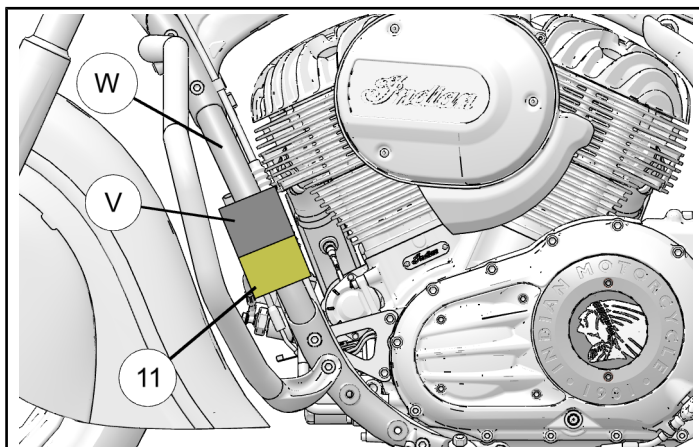

IMPORTANT

Product information label is required to aid in passing California Smog Check program.

IMPORTANT

Update ECM with new calibration software using Calibration Card ⑩ included in this kit. This step must be completed by an Authorized Indian Dealer. Do not operate vehicle until re-calibration of vehicle is complete.