

AIRBOX KIT



P/N 2883737-XXX, 2884461-XXX (50 STATE)

APPLICATION

Verify accessory fitment at www.indianmotorcycle.com.

BEFORE YOU BEGIN

Read these instructions and check to be sure all parts and tools are accounted for. Please retain these installation instructions for future reference and parts ordering information.

KIT CONTENTS

NOTE

XXX = Indian Motorcycle® color code (For example: 266 = Black)

P/N 2884461-XXX Shown

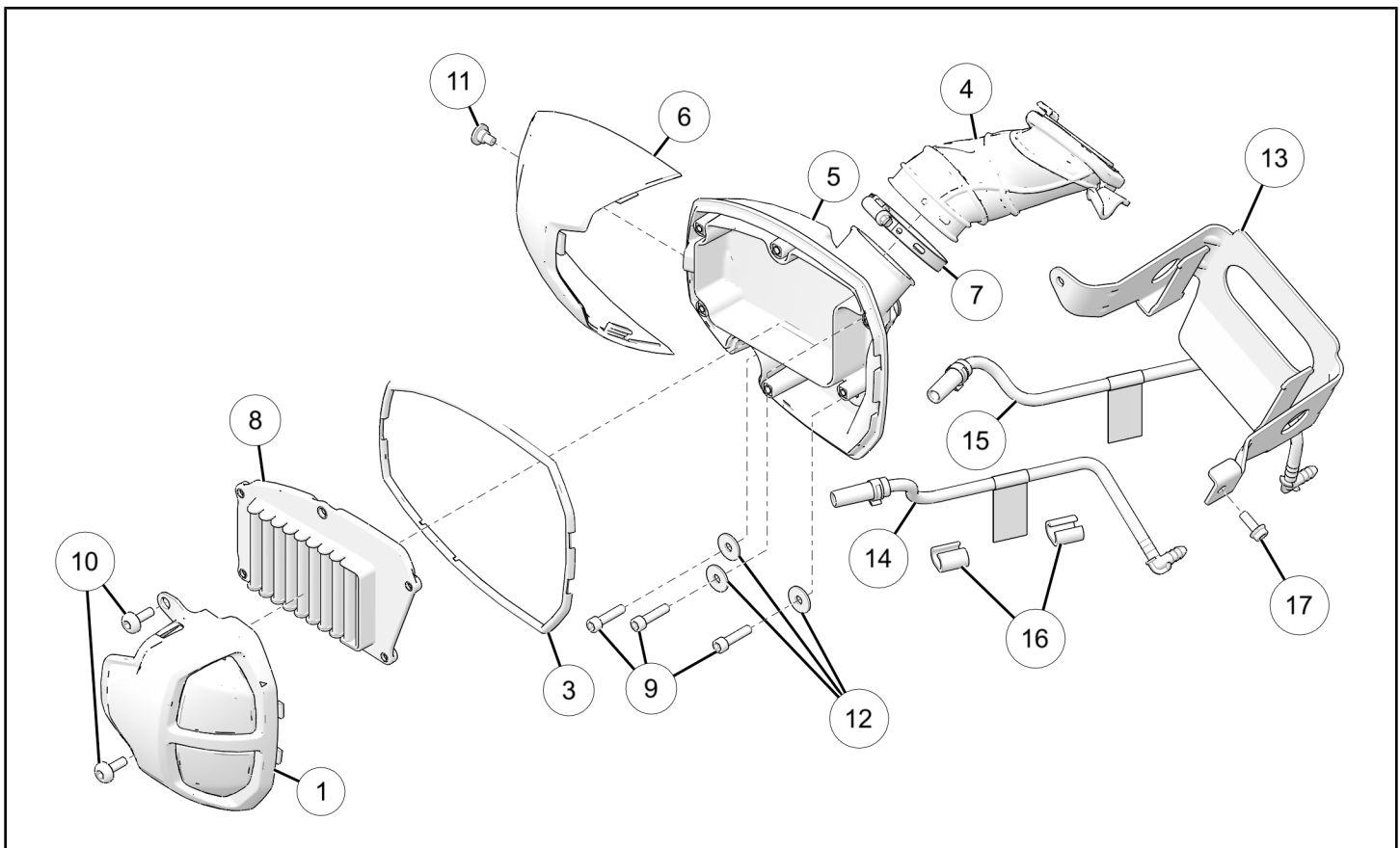

REF	QTY	PART DESCRIPTION	P/N AVAILABLE SEPARATELY
1	1	Airbox Cover Assembly	2637312
2	1	LH Evap Relocation Kit (2884461-XXX Only) - See Kit Contents for Details	2884117-XXX
3	1	Cover Seal	5417166
4	1	Airbox Duct	5417274
5	1	Airbox Base	5455654

REF	QTY	PART DESCRIPTION	P/N AVAILABLE SEPARATELY
6	1	Rear Airbox Cover	5455655-XXX
7	1	Narrow Band Clamp	7080511
8	1	Airbox Filter	7082461
9	3	Screw, Hex Socket Head, M6 X 1.0 X 25	7517638
10	2	Screw, Hex Button Head, M6 X 1.0 X 10	7520201
11	1	Bolt, Hex Shoulder, M6 X 1.0	7520510
12	3	Washer 6.4 X 20.0 X 1.6	7556054

P/N 2884117-XXX (California Only)

REF	QTY	PART DESCRIPTION	P/N AVAILABLE SEPARATELY
13	1	Evap Bracket, LH Mount	5267475-XXX
14	1	Canister Vent Line	5455992
15	1	Purge Vent Line	5455993
16	2	Dual Oval Clip	7082491
17	1	Screw, Hex Socket Flange Head, M6 X 1.0 X 16	7518803

TOOLS REQUIRED

- Cutting Tool
- Hex Key Set, Metric
- Push Dart (Panel Clip) Tool
- Ratchet
- Ratchet Extension
- Safety Glasses
- Screwdriver, Slotted
- Socket Set, Hex Bit, Metric
- Socket Set, Metric
- Torque Wrench
- Wrench Set, Metric

CONSUMABLES REQUIRED

- Isopropyl Alcohol (IPA)
- Gloves, Chemical Resistant

IMPORTANT

Your Indian Motorcycle® Airbox Kit is exclusively designed for your vehicle. Please read the installation instructions thoroughly before beginning. Installation is easier if the vehicle is clean and free of debris. For your safety, and to ensure a satisfactory installation, perform all installation steps correctly in the sequence shown.

INSTALLATION INSTRUCTIONS

VEHICLE PREPARATION

GENERAL

1. Turn key or ignition switch to **OFF** position and remove key. If equipped with keyless fob, remove fob from proximity of vehicle.
2. Ensure motorcycle is parked on a flat surface, kickstand is fully extended, and vehicle is stable prior to installation.
3. Remove gas tank as per owner's manual.

ACCESSORY INSTALLATION

RH COVER BRACKET REMOVAL

1. Remove three screws (A) from RH cover (B).

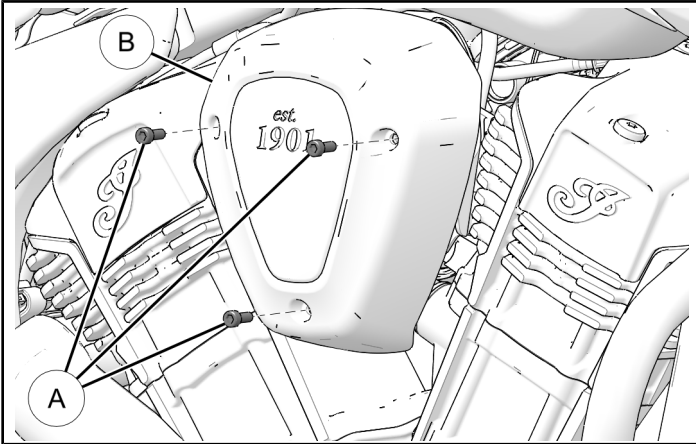

2. Remove and discard RH cover (B).

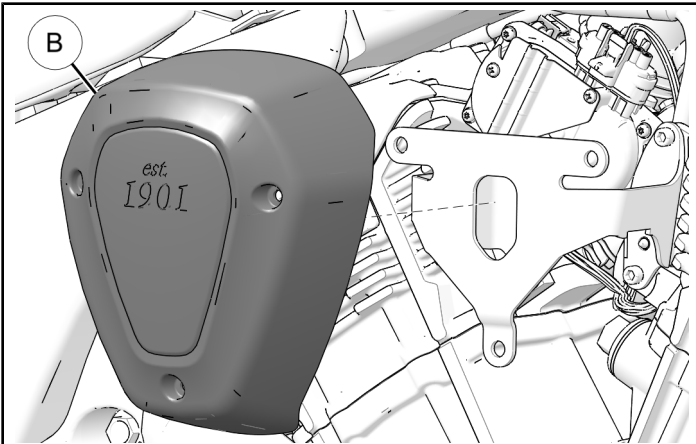

3. Remove three screws (C) from RH cover bracket (D). Remove and discard bracket.

NOTE

Kit 2884461: Support canister while removing bracket screws as to not let it fall and hang by vent lines. DO NOT remove bracket at this time.

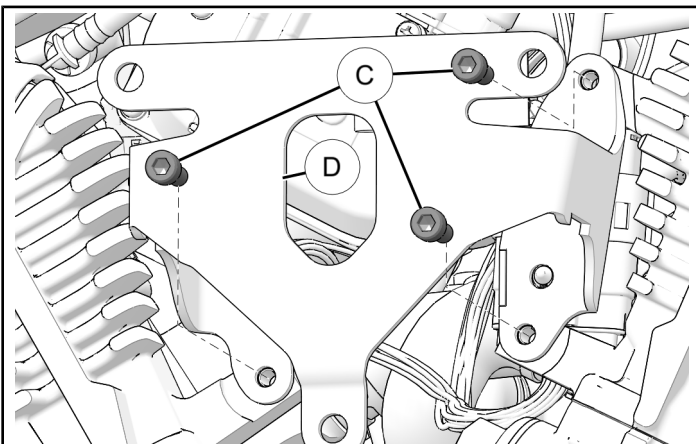

CANISTER RELOCATION

CALIFORNIA AND INTERNATIONAL MODELS ONLY

North American Models: Skip to "Airbox Installation" Section

1. Support canister (A) and cover bracket (B). Disconnect purge vent line (C) and tank vent line (D) from canister.

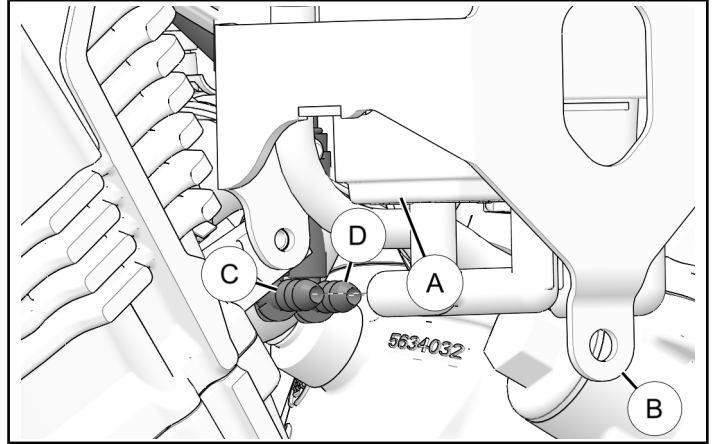

2. Lubricate canister band (E) with Isopropyl Alcohol to avoid damage to band. Remove and retain canister (A) from bracket (B). Discard bracket.

⚠ WARNING

Follow all chemical manufacturer instructions and safety precautions. Failure to follow all manufacturer instructions and precautions may result in severe injury or death.

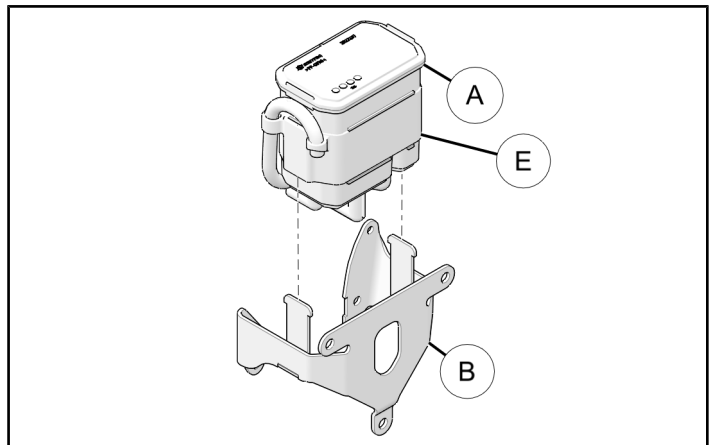

3. Set canister aside. Repeat steps 1-2 of "RH Cover Bracket Removal" section for LH side cover.

4. Locate fan cover (F). Remove and retain pushpin clips (G) from fan cover. Remove and retain cover.

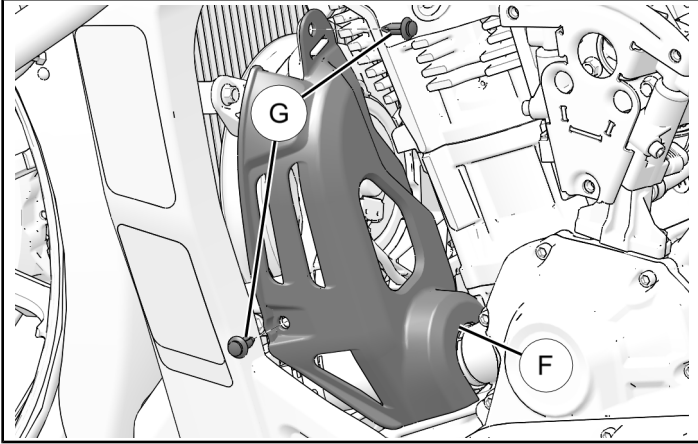

5. Remove and retain screw (H) located behind LH side cover bracket (I).

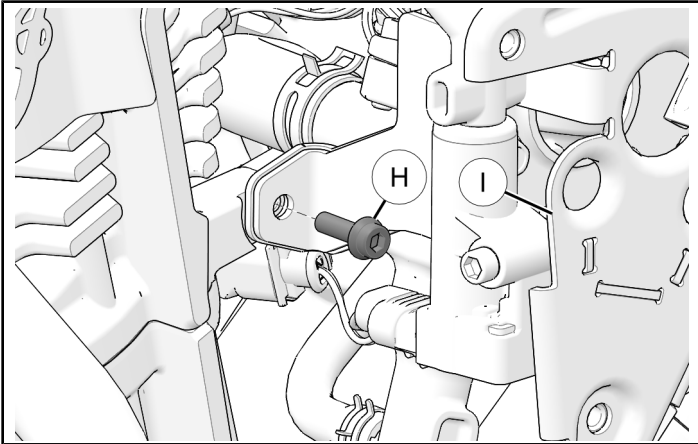

6. Assemble tank vent line (14) and purge vent line (15) using two dual oval clips (16) as shown.

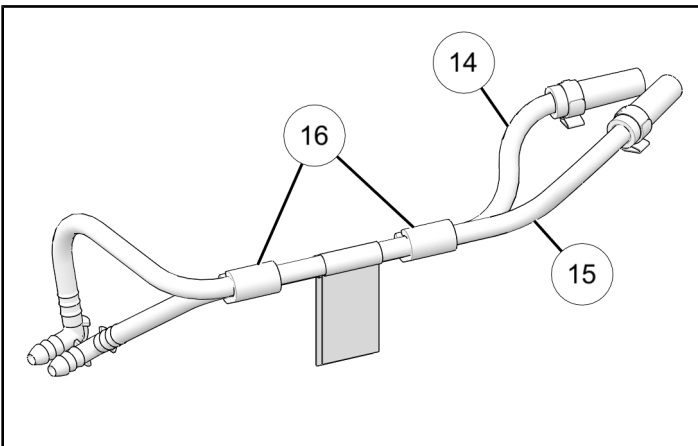

7. Route preformed vent lines under and to left of LH cover bracket (I) and through engine v-gap.

TIP

Rotate vent line assembly as needed to ensure vent lines do not come in contact with parts and become damaged.

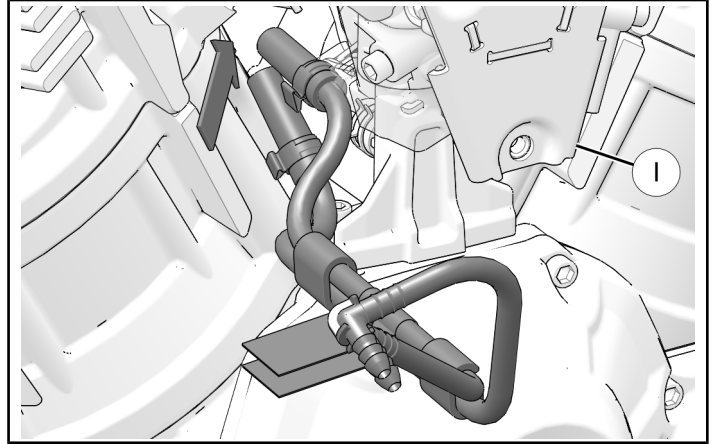

8. Locate OEM purge vent line connection (C) and OEM tank vent line (D) on RH side of vehicle. Ensure vent line assembly is routed as shown. Connect vent line (14) to tank vent line connection and vent line (15) to purge vent line connection.

NOTE

Ensure OEM vent line connections are installed into correct hose.

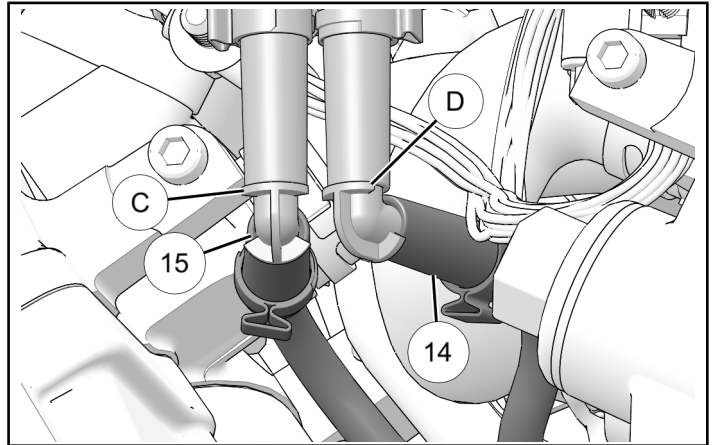

9. To allow new canister bracket to be installed, clearance cut shown section of fan cover (F).

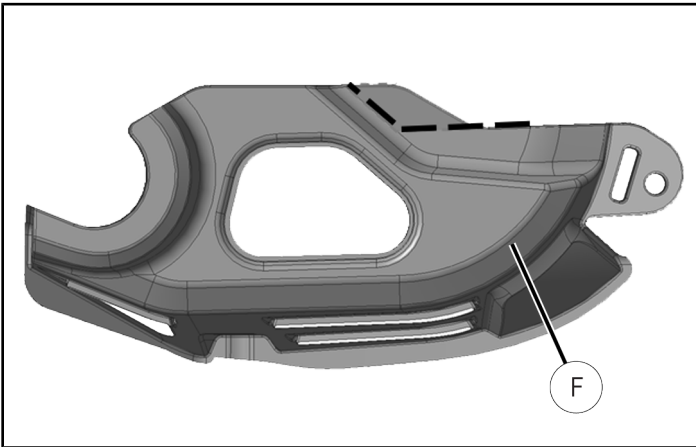

10. Using screw (17) included in 2884117 kit (2) and retained screw (H), install new canister bracket (13) on LH side as shown.

TORQUE

Bracket screw (17) and (H):
84 in-lbs (9.5 N·m)

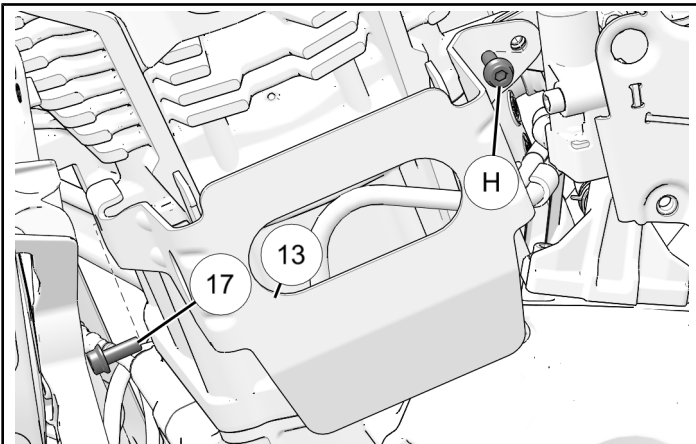

11. Lubricate canister band (E) with Isopropyl Alcohol to avoid damage to band. Mount canister (A) to new canister bracket (13).

⚠ WARNING

Follow all chemical manufacturer instructions and safety precautions. Failure to follow all manufacturer instructions and precautions may result in severe injury or death.

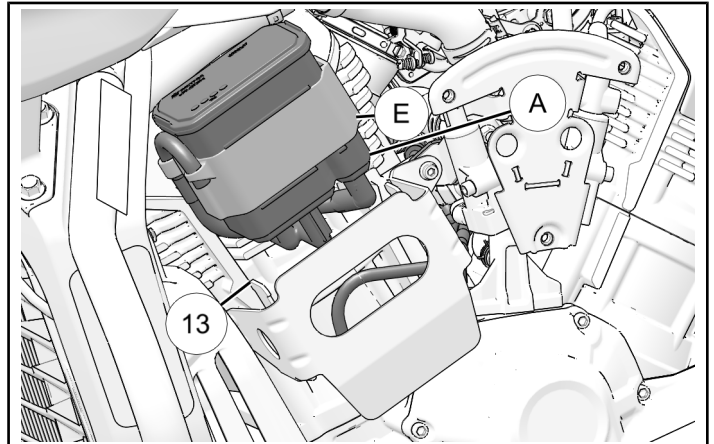

12. Connect new tank vent line (14) to tank receiver (J) and new purge vent line (15) to purge receiver (K) on canister (A).

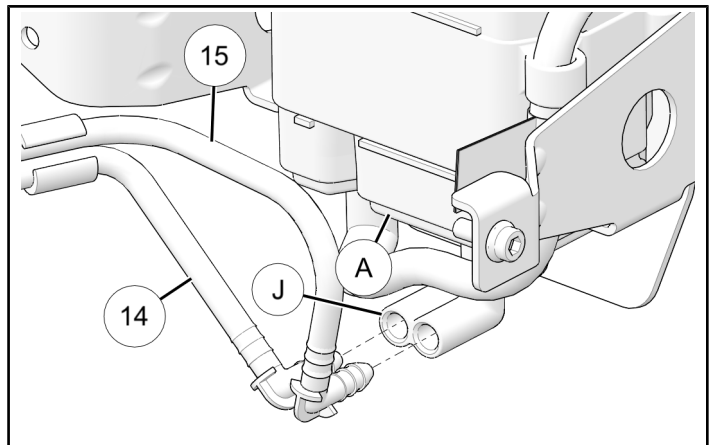

13. Reinstall fan cover and LH side cover.

TORQUE

LH Side Cover Bolt:
84 in-lbs (9.5 N·m)

AIRBOX INSTALLATION

1. Remove and retain **A** from hatch cover **B** on RH side of backbone. Remove hatch cover.

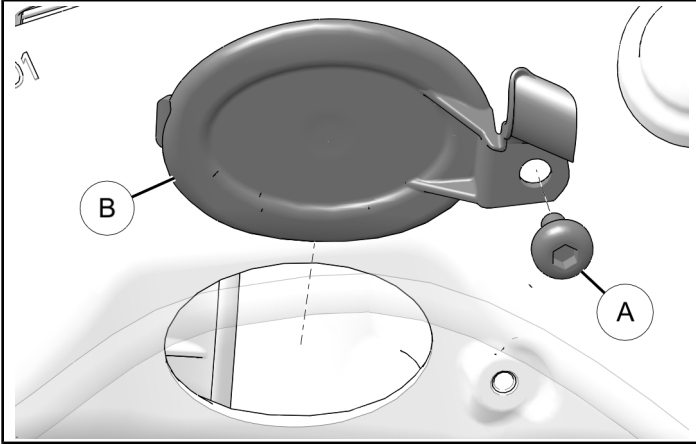

2. Install new airbox duct **4** to backbone using retained screw **A**. Torque screw to specification.

TORQUE

Duct Bolt **A**:
24 in-lbs (2.7 N·m)

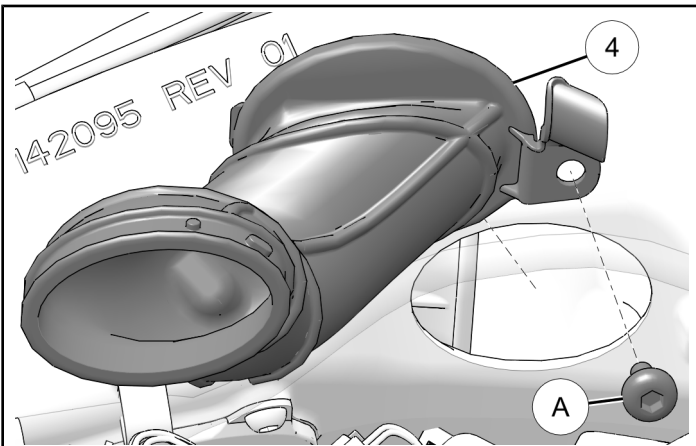

3. Connect airbox base **5** to duct **4** using clamp **7**. DO NOT tighten clamp at this time.

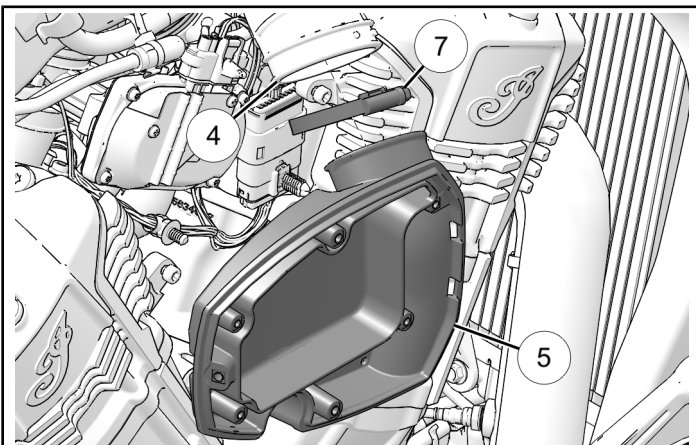

4. Rotate clamp **7** so screw **C** is behind airbox and out of view. Torque clamp screw to specification.

TORQUE

Clamp Bolt **C**:
24 in-lbs (2.7 N·m)

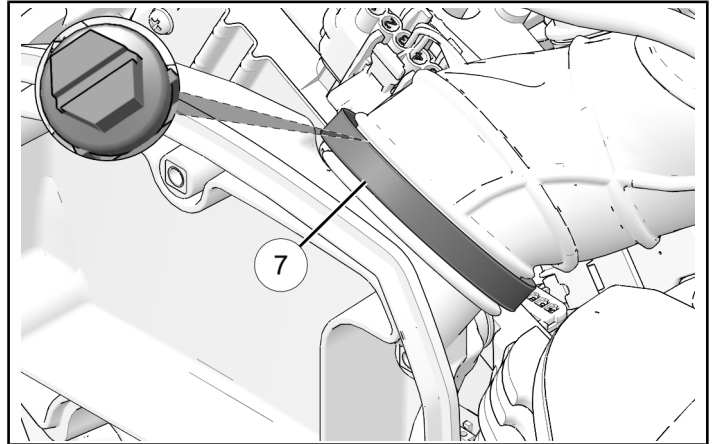

5. Secure airbox base to cover bracket mounts using three washers **12** and three screws **9**. Torque screws to specification.

TORQUE

Airbox Base Bolt **9**:
24 in-lbs (2.7 N·m)

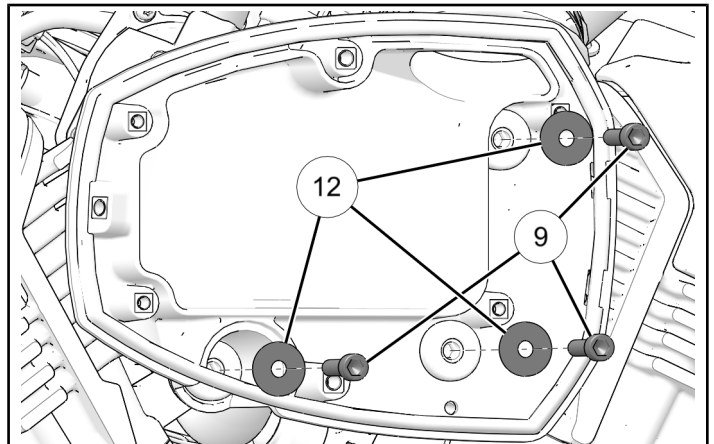

6. Install filter with four, pre-inserted screws ①. Torque screws to specification.

TORQUE

Filter Screw ①:
24 in-lbs (2.7 N·m)

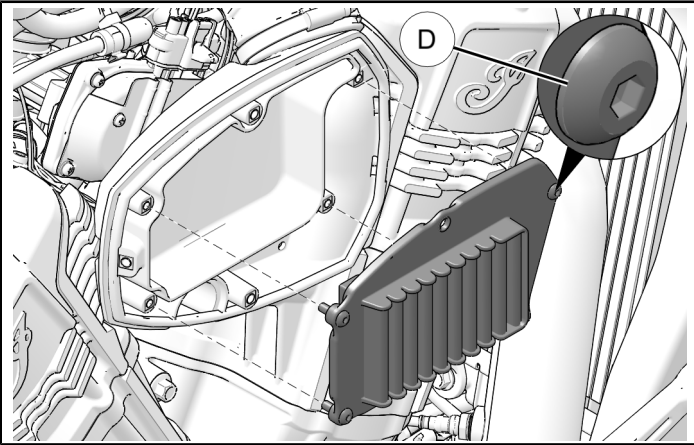

7. Press rubber trim ③ on lip of airbox base ⑤ edges.

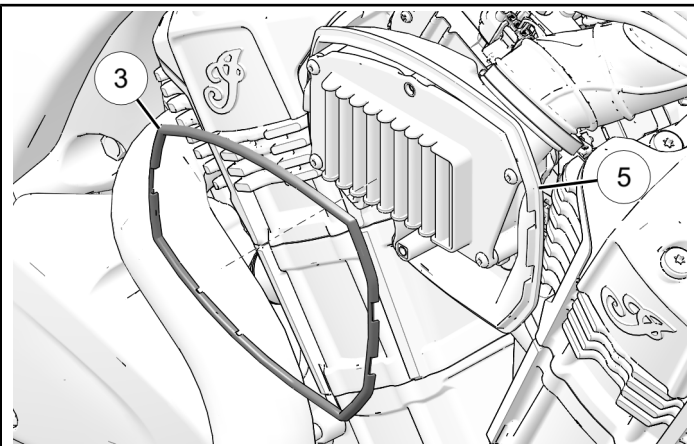

8. Install airbox front cover ① by sliding cover from back to front at an angle. Insert cover tabs into hooks on plastic base ③ as shown. Rotate back of cover onto airbox.

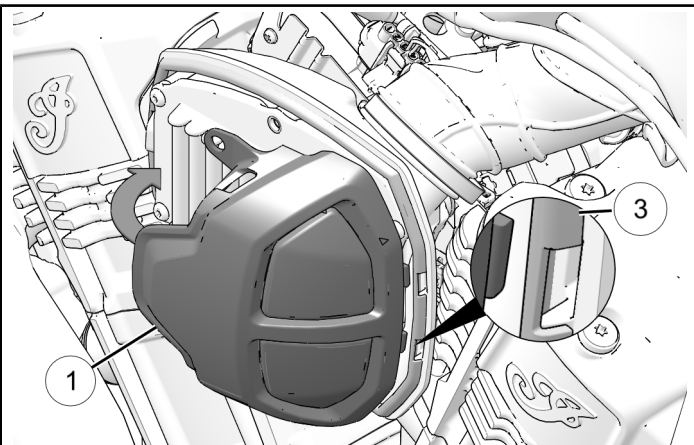

9. Secure airbox front cover ① by installing two screws ⑩ as shown. Torque screws to specification.

TORQUE

Front Cover Bolt ⑩:
24 in-lbs (2.7 N·m)

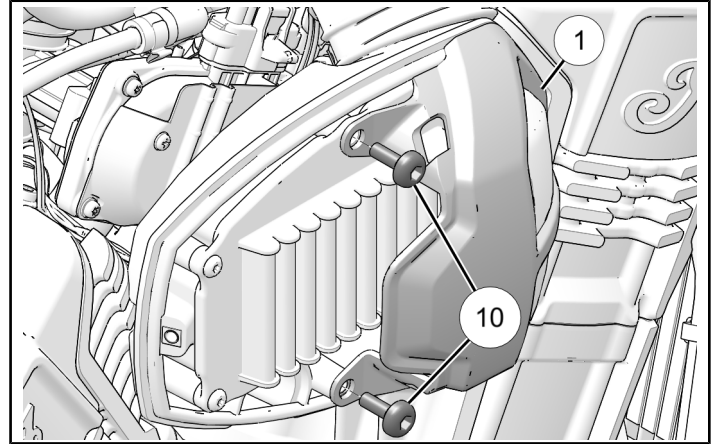

10. Slide airbox rear cover ⑥ onto airbox base ⑤. Ensure hooks from rear cover are inserted into front cover ① as shown.

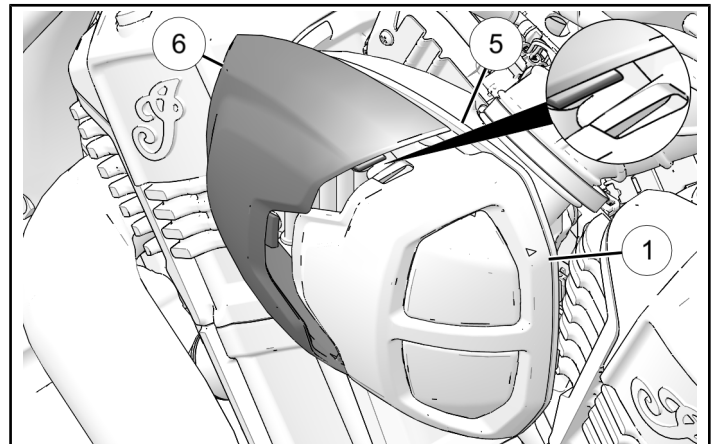

11. Secure airbox rear cover ⑥ with one bolt ⑪ as shown. Torque bolt to specification.

TORQUE

Rear Cover Bolt ⑪:
24 in-lbs (2.7 N·m)

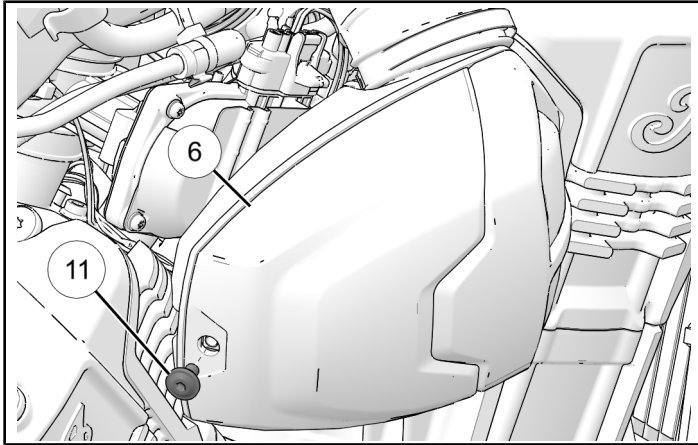

VEHICLE REASSEMBLY

GENERAL

1. Reinstall gas tank as per owner's manual.

RECOMMENDED SERVICE INTERVALS

- Inspect filter element: Every 5,000 miles.
- Replace filter element: Every 10,000 miles. (See Kit Contents for Part Number)

FEEDBACK FORM

A feedback form has been created for the installer to provide any comments, questions or concerns about the installation instructions. The form is viewable on mobile devices by scanning the QR code or by clicking [HERE](#) if viewing on a PC.

