

FRONT HIGHWAY BAR KIT



P/N 2884177-XXX

APPLICATION

Verify accessory fitment at www.indianmotorcycle.com.

BEFORE YOU BEGIN

Read these instructions and check to be sure all parts and tools are accounted for. Please retain these installation instructions for future reference and parts ordering information.

KIT CONTENTS

NOTE

XXX = Indian Motorcycle® color code (For example: 266 = Black)

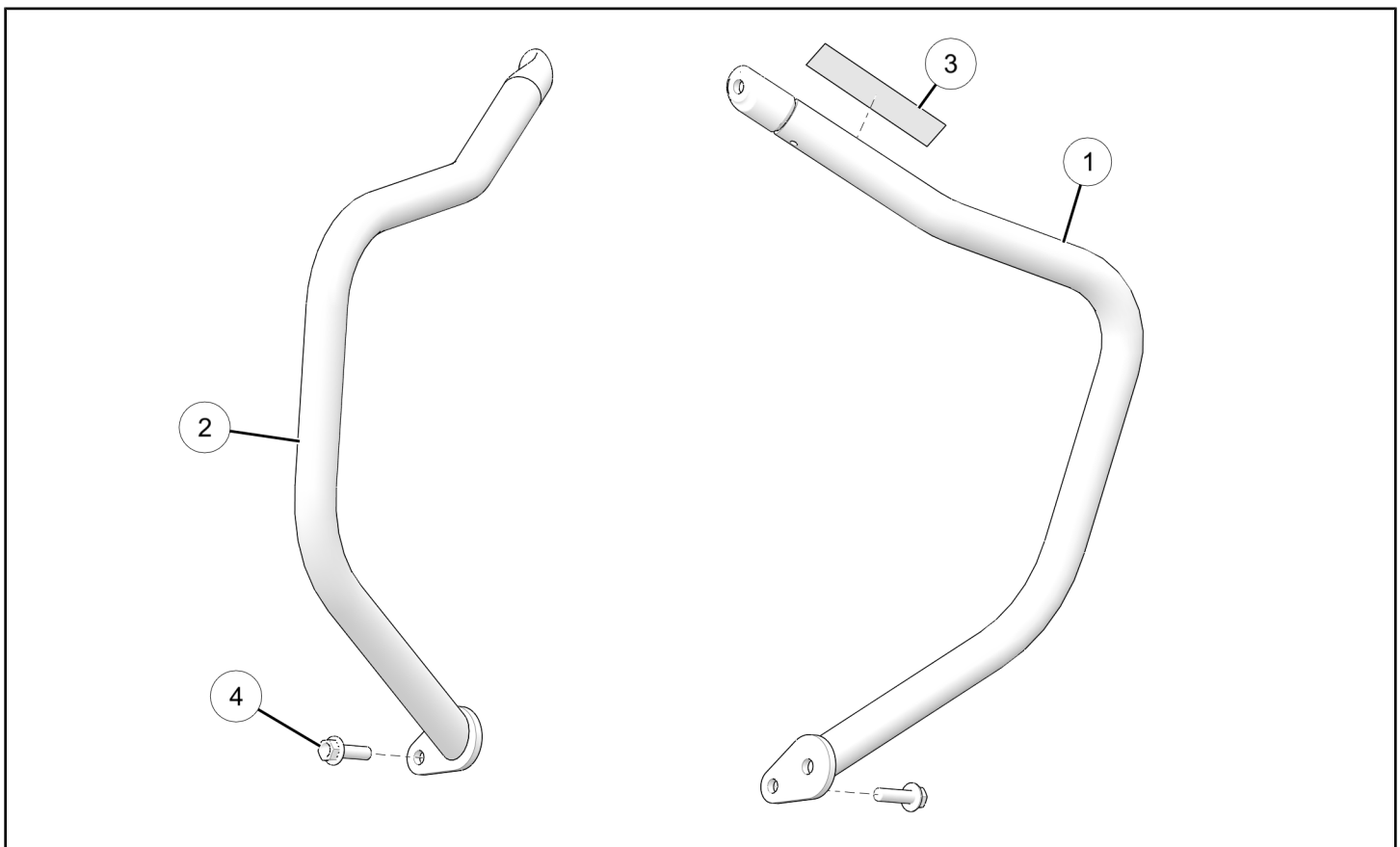

| REF | QTY | PART DESCRIPTION | P/N AVAILABLE SEPARATELY |
|-----|-----|--------------------------|--------------------------|
| 1 | 1 | Front Highway Bar, LH | 1024082-XXX |
| 2 | 1 | Front Highway Bar, RH | 1024083-XXX |
| 3 | 1 | Decal, Front Highway Bar | 7176355 |
| 4 | 2 | Screw, M10 X 1.5 X 35 | 7520719 |

TOOLS REQUIRED

- Safety Glasses
- Socket Set, Metric

- Torque Wrench

IMPORTANT

Your Indian Motorcycle® Front Highway Bar Kit is exclusively designed for your vehicle. Please read the installation instructions thoroughly before beginning. Installation is easier if the vehicle is clean and free of debris. For your safety, and to ensure a satisfactory installation, perform all installation steps correctly in the sequence shown.

INSTALLATION INSTRUCTIONS

VEHICLE PREPARATION

GENERAL

1. Turn key or ignition switch to **OFF** position and remove key. If equipped with keyless fob, remove fob from proximity of vehicle.
2. Ensure motorcycle is parked on a flat surface, kickstand is fully extended, and vehicle is stable prior to installation.

HIGHWAY BAR INSTALLATION

LEFT SIDE INSTALLATION

NOTE

Protect all finished surfaces prior to installation.

1. Remove and retain bolt (A).

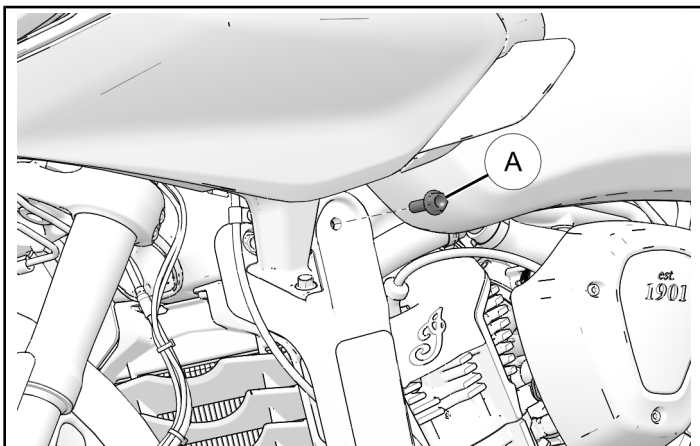

2. Install LH highway bar (1) using retained bolt (A) and one new bolt (4) as shown. Torque bolts to specification.

TORQUE

Retained (A) and New (4) Highway Bar Bolt :
45 ft-lbs (61 N·m)

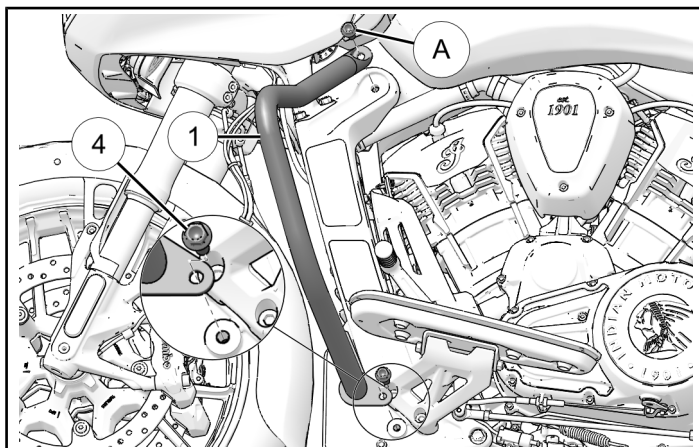

RIGHT SIDE INSTALLATION

1. Repeat "Left Side Installation" section for RH highway bar (2) installation.

DECAL INSTALLATION

1. Install warning decal (3) onto LH highway bar (1) as shown.

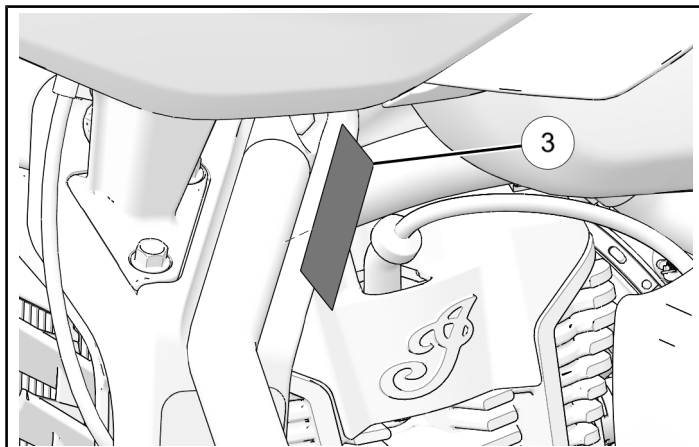

FEEDBACK FORM

A feedback form has been created for the installer to provide any comments, questions or concerns about the installation instructions. The form is viewable on mobile devices by scanning the QR code or by clicking [HERE](#) if viewing on a PC.

