

TRUNK AUDIO KIT



P/N 2881845

APPLICATION

Indian Heavy Weight with Accessory Trunk and without Fairing

BEFORE YOU BEGIN

Read these instructions and check to be sure all parts and tools are accounted for. Please retain these installation instructions for future reference and parts ordering information.

KIT CONTENTS

This Kit includes:

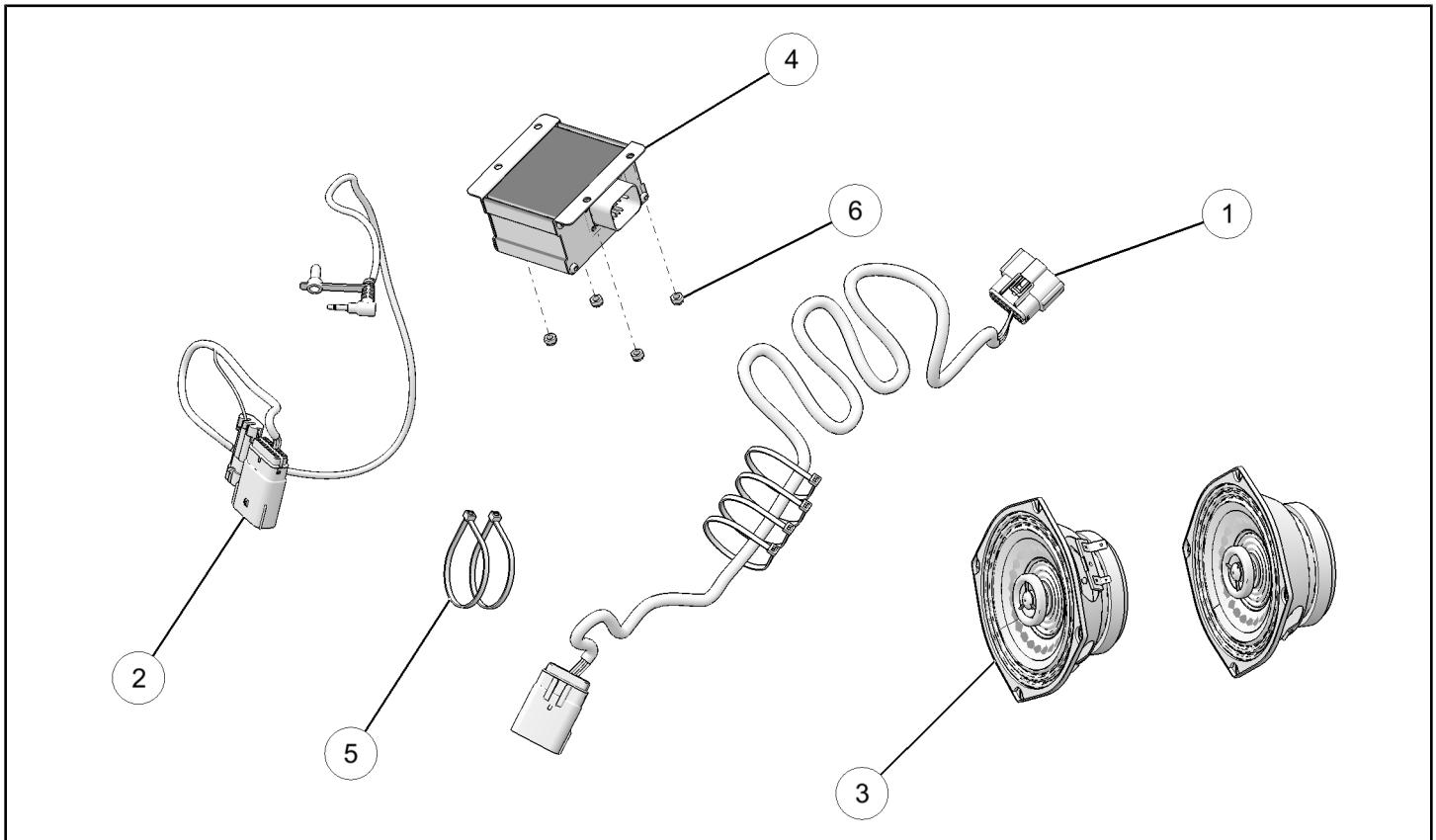

REF	QTY	PART DESCRIPTION	PART NUMBER
1	1	Harness - Trunk, Chieftain Seat	2413049
2	1	Harness - HPSBA, Front	2413057
3	2	Ferrite Speaker, 50 watt	4014650
4	1	Audio Amplifier, Premium	4015241
5	6	Panduit Strap	7080138
6	4	Hex Nut - M5 X 0.8, Nyloc-Y	7546601
	1	Instructions	9926960

TOOLS REQUIRED

- Metric Socket Set
- Metric Hex Key Set
- Torx Bit Set

- Torque Wrench
- 5 mm and 6 mm Hex Key
- Side cutters

IMPORTANT

Your Indian TRUNK AUDIO KIT is exclusively designed for your vehicle. Please read the installation instructions thoroughly before beginning. Installation is easier if the vehicle is clean and free of debris. For your safety, and to ensure a satisfactory installation, perform all installation steps correctly in the sequence shown.

ASSEMBLY TIME

Approximately 60 minutes

INSTALLATION INSTRUCTIONS

TRUNK AUDIO INSTALLATION

Amplifier Installation

1. Remove trunk following instructions in owner's manual. Use caution to prevent damage to the trunk's finish. Place trunk upside down on clean blankets or other suitable material which will prevent damage to the painted surfaces and leather.
2. Cut wire tie (A) to remove electrical connector from amplifier plug bracket (B) and remove black vinyl plug from connector.
3. Remove two M5 nuts and remove amplifier plug bracket (B).

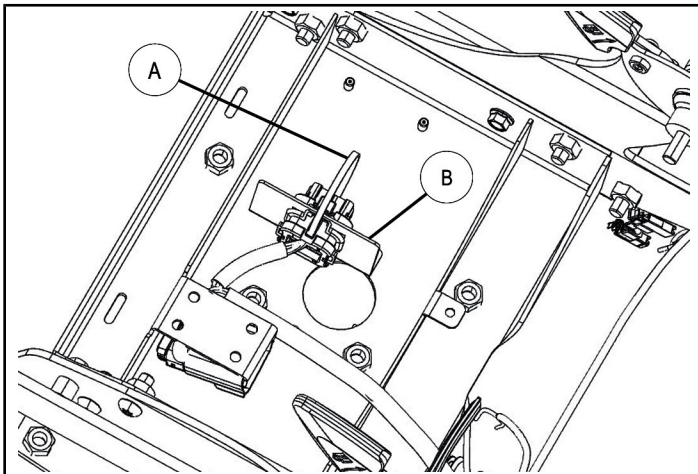

4. Place amplifier (4) on studs (C) with connector facing the left side of the bike. Install four M5 nuts (6) and torque to specification to secure amplifier.

TORQUE

45 in. lbs. (5.08 Nm)

5. Install electrical connector (D) on amplifier.

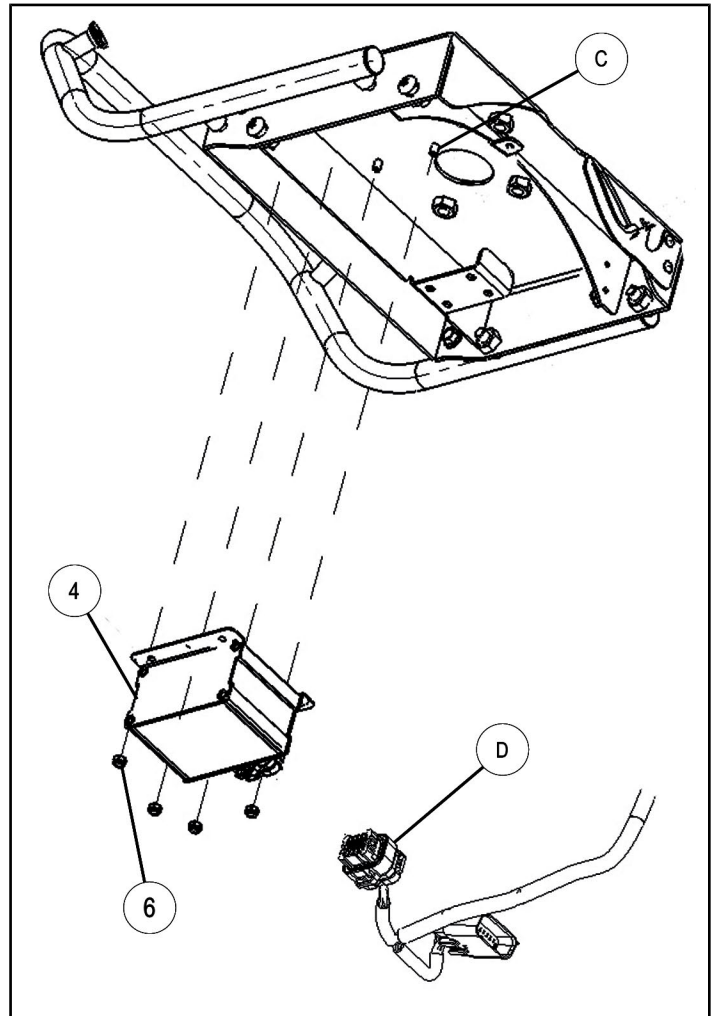

6. Replace trunk on motorcycle following instructions in owner's manual.

Speaker Installation

7. Remove the lower backrest (E) to get the speaker covers off.

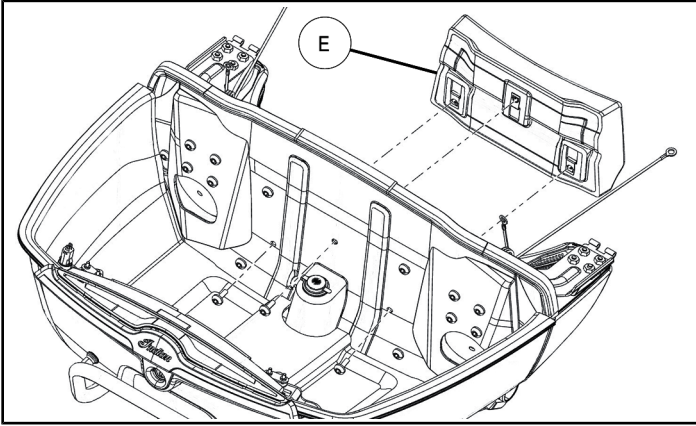

8. Remove bolts (F) from inside the trunk and retain for reuse.

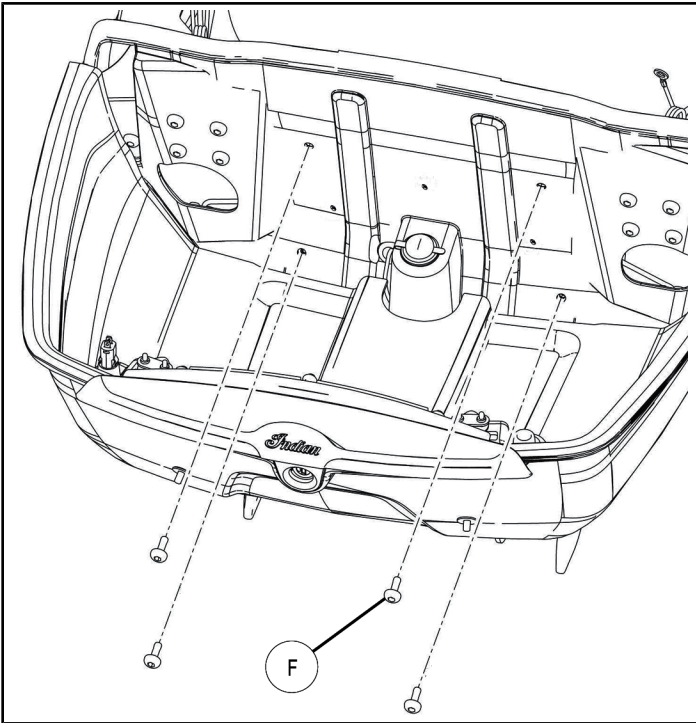

9. Pull speaker grilles (G) forward to remove from trunk by removing one bolt (H) on each side of the trunk.

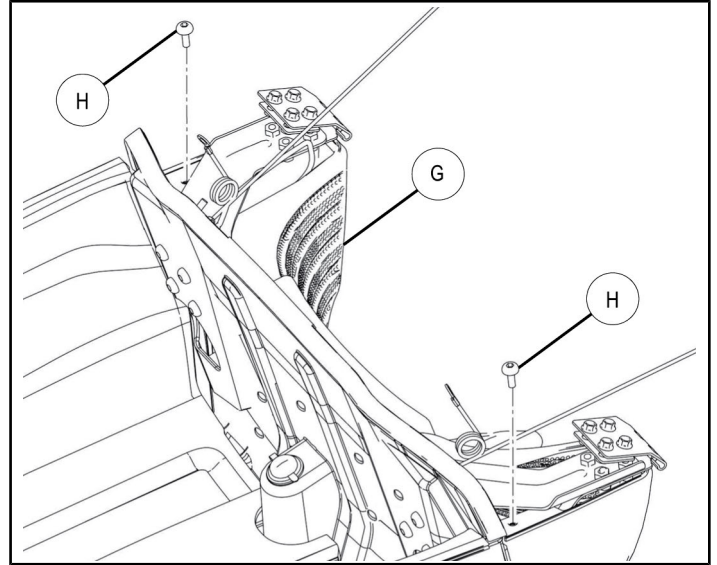

10. Remove the four screws (J) holding RH side speaker plate to the trunk and retain for reuse. Repeat the same for LH side also. Remove and discard speaker plates and gaskets.

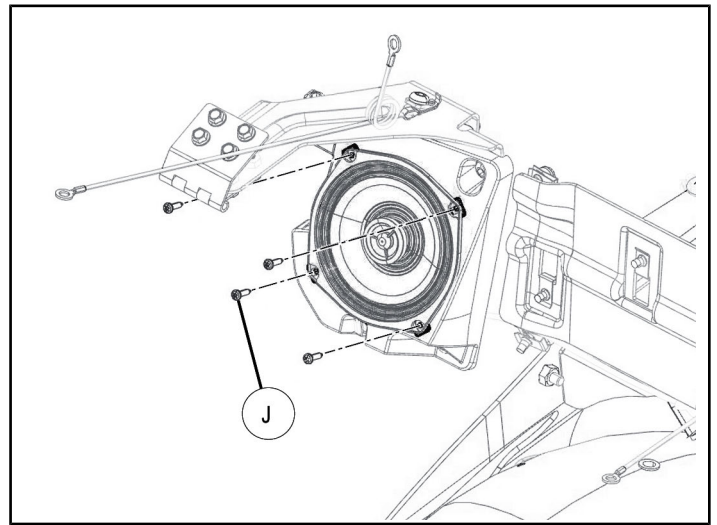

11. Attach wires inside speaker area to your speakers.

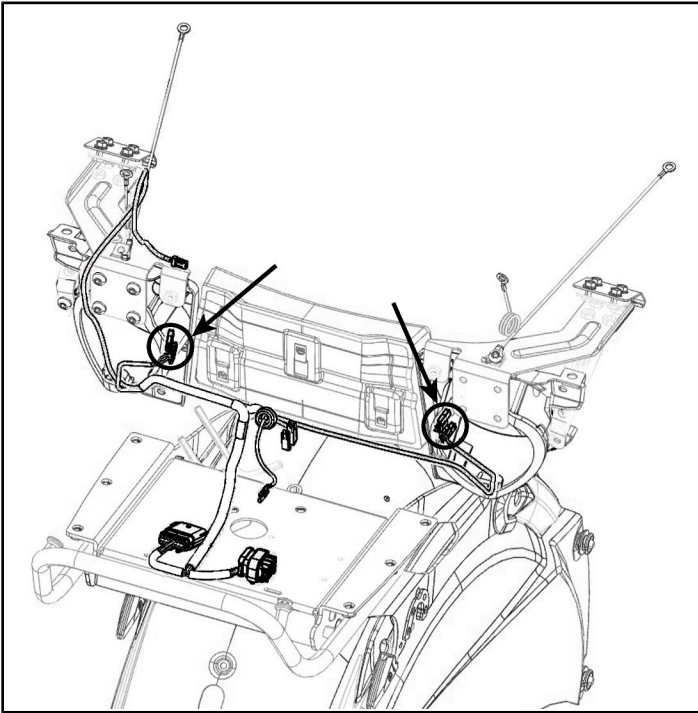

12. Attach RH side speakers ③ using screws (H) from speaker plates. Torque to specification.

TORQUE

18 in. lbs. (2.03 Nm)

Repeat the same for LH side also. Connect the speaker with wiring connector.

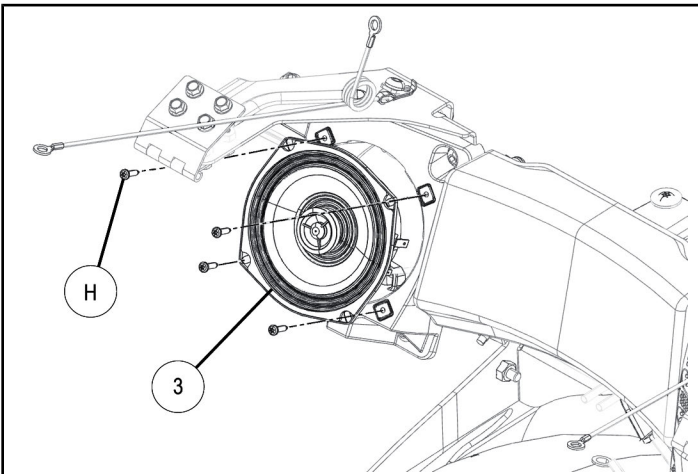

13. Replace speaker grilles and lower trunk pad. Torque fasteners to specification.

TORQUE

36 in. lbs. (4.06 Nm)

TOUR SEAT WIRING HARNESS INSTALLATION

1. Remove the seat from the motorcycle following instructions in the owner's manual. Place seat on a clean cloth to protect from damage.
2. Plug harness ① into motorcycle, position and route wire under left hand side cover.

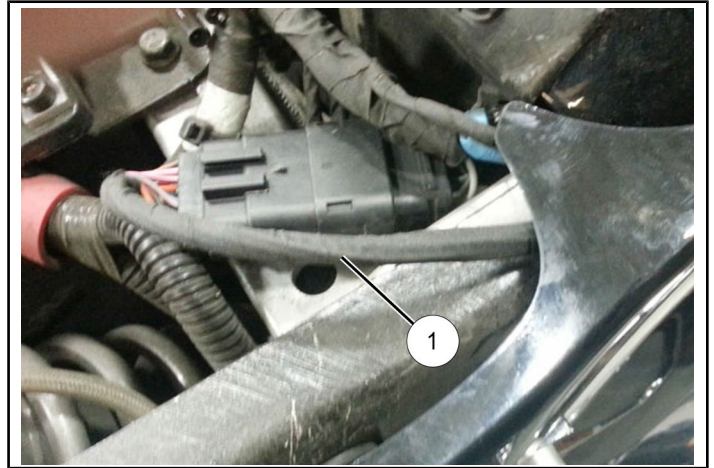

3. Replace seat on motorcycle following instruction in owner's manual.
4. Place harness ① between fender and frame (K) of trunk.



5. Using panduits ⑤, attach the harness to trunk frame (K). Be sure to tie harness in such a manner as to prevent contact with painted surfaces.



6. Route harness ① through wire retainer and connect harness to trunk connector (L) and place as shown in figure.

CAUTION

Contact between the harness and painted surfaces will cause paint damage. Ensure that the harness is fastened properly and securely and there is no contact possible before riding the motorcycle.

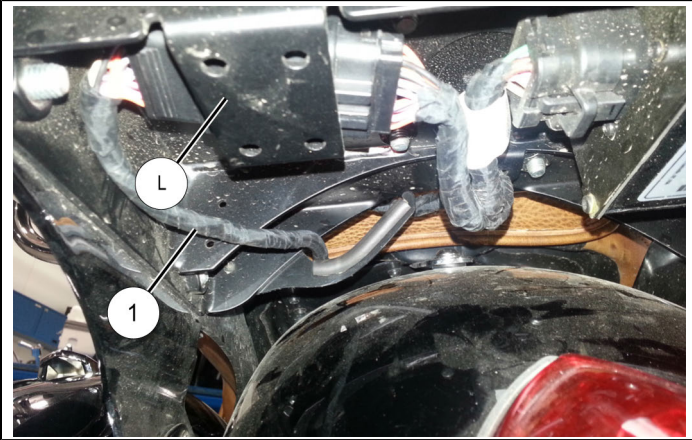

THE FOLLOWING PROCESS IS ONLY NEEDED FOR VEHICLES WITHOUT A FARING. INSTALLING THE 3.5 MM AUDIO JACK

1. Locate the un-used 16-pin connector (M), without opening the headlight housing, by turning the handlebars to one side. The connector will be tucked into the headlight housing. If the connector cannot be located with this method, skip to Step 3 for instructions on how to gain access. Otherwise, continue to Step 2.

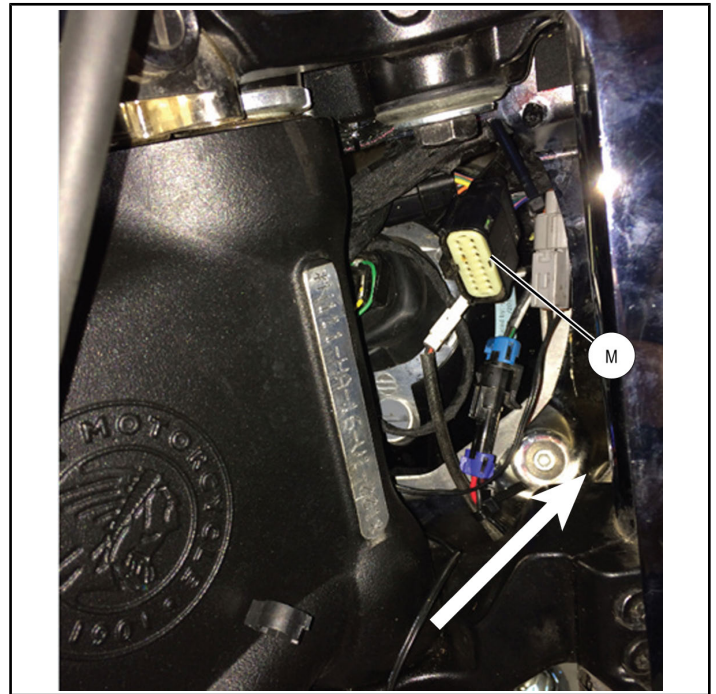

2. Attempt to locate the un-used power connector (N), without opening the headlight housing, by turning the handlebars to one side. The connector will be tucked into the headlight housing. If the 16-pin connector and the power connector are both accessible, skip to Step 7. Otherwise, access can be gained in Steps 3-6.

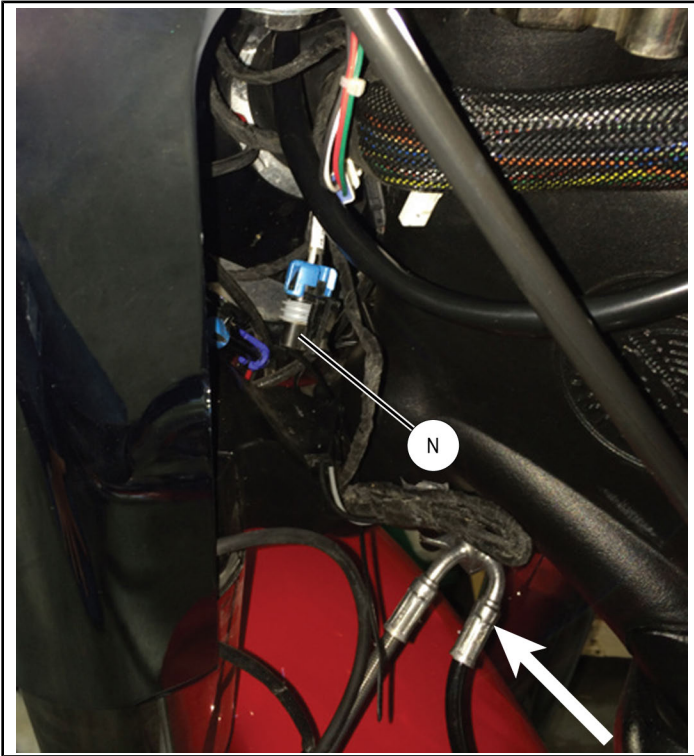

3. If applicable, remove windshield.
4. Use a 6 mm external hex socket wrench to remove the two bolts on each side of the headlight housing.
5. Use a 5 mm external hex socket wrench to remove the two bolts on the top of the headlight housing.

6. Pull the headlight housing (P) open, but do not fully remove the halves of the shell. Open the headlight housing until the available 16-pin connector (Q) and the available power connector (R) in the headlight bucket are accessible.

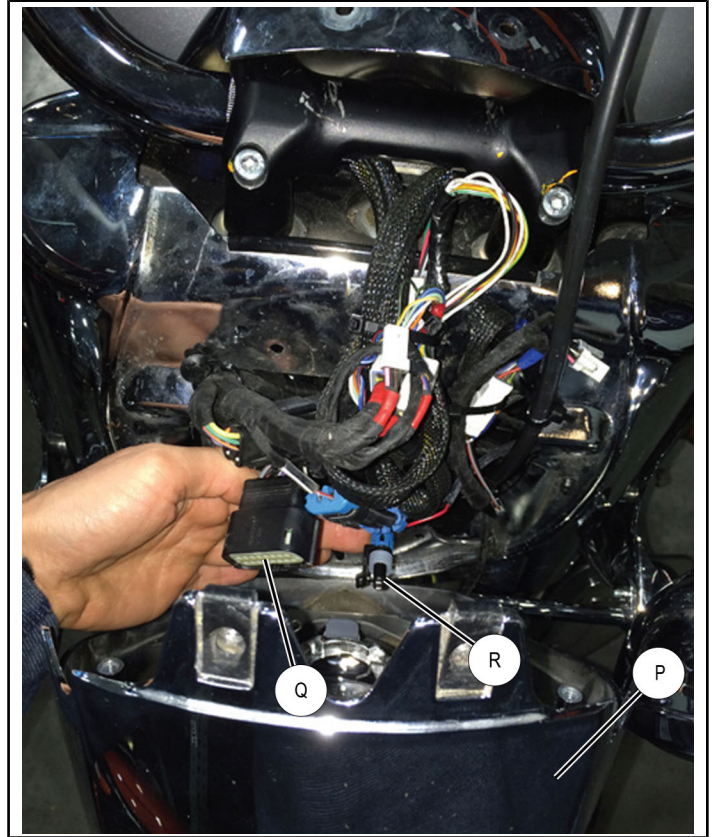

7. Connect the 16-pin connector (S) on the Front Harness ② to the available 16-pin connector in the headlight housing.
8. Connect the power connector (R) on the Front Harness ② to the available power connector in the headlight housing.

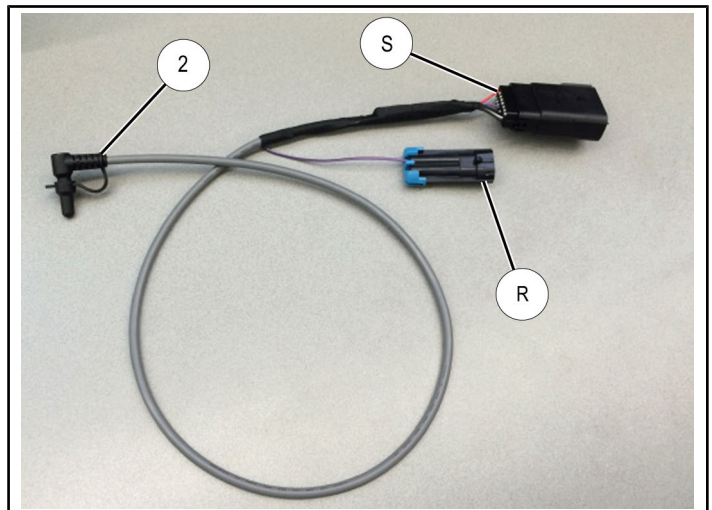

9. Route the 3.5 mm audio jack on the front harness along the brake line and out of the headlight housing (P). Allow no more than 12 inches of wire length to stick out from the headlight housing, and secure the remaining wire to the brake line with a panduit strap inside the headlight housing, to ensure the front harness wire will not interfere with steering.

IMPORTANT

Cycle the steering lock-to-lock to ensure proper operation.



10. If the Accessory Nacelle Mount is installed, route the 3.5 mm jack through the key hole on the Nacelle Accessory Mount bracket (T).

NOTE

The hinge must be removed from the bracket in order to route the connector through the Nacelle Accessory Mount.

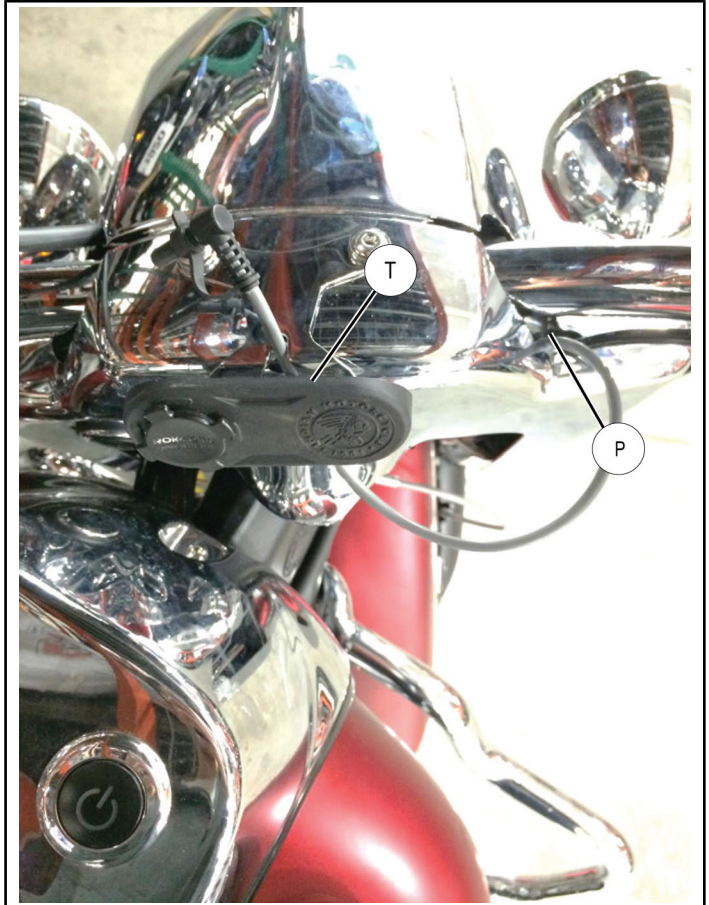

11. Reinstall the headlight housing, if it was removed. Torque the two bolts on top of the headlight housing to specification.

TORQUE

36±6 in. lbs. (4.07 Nm)

Torque the four bolts on the sides of the headlight housing to specification.

TORQUE

18±3 ft. lbs. (24.4 Nm).