

AUDIO SPLITTER KIT



P/N 2882309

APPLICATION

Indian Heavy Weight with Trunk Audio and Saddlebag Audio

BEFORE YOU BEGIN

Read these instructions and check to be sure all parts and tools are accounted for. Please retain these installation instructions for future reference and parts ordering information.

KIT CONTENTS

To complete this installation, the additional kits are needed:

- Kit-Audio, Saddlebag Speakers (2882212)
- Kit-Audio, Trunk Speakers (2882213) (Unless OE trunk audio is installed)

Plus one of the two kits (unless OE trunk is installed):

- Kit-Trunk, No Amp (2882345-XXX (in optional color))
- Kit-Trunk, Ind (2880283-XXX (in optional color))

Plus the additional kit:

- Kit-Lid, Audio, Saddlebag (2879656-XXX (in optional color))

Plus two of the following amplifier kits (model and model year dependent):

- Kit-Audio, Amp, Saddlebag/Trunk, Faring (2882215)
- Kit-Audio, Amp, 2Vpp, No Faring (2882216)
- Kit-Audio, Amp, 4Vpp, Faring (2882231)

This Kit includes:

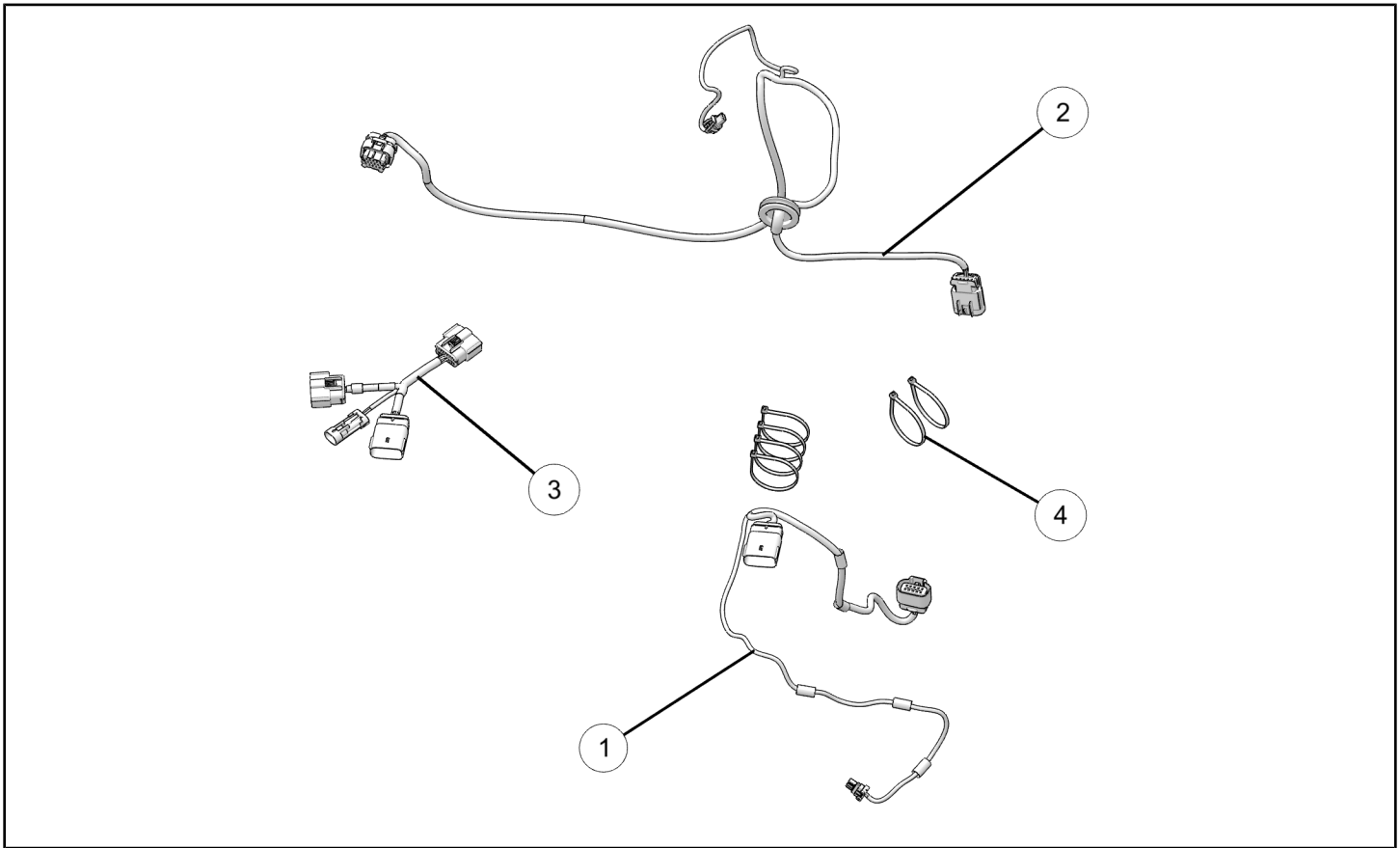

REF	QTY	PART DESCRIPTION	PART NUMBER
1	1	Seat Harness	2413055
2	1	Bag Harness, LH	2403058
3	1	Splitter Harness	2413764
4	6	Panduit Strap	7080138
	1	Instructions	9926962

TOOLS REQUIRED

- Torque Wrench (in-lbs.)
- 6mm External Hex Socket Wrench
- 5mm External Hex Socket Wrench
- Ratchet

IMPORTANT

Your Indian AUDIO SPLITTER KIT is exclusively designed for your vehicle. Please read the installation instructions thoroughly before beginning. Installation is easier if the vehicle is clean and free of debris. For your safety, and to ensure a satisfactory installation, perform all installation steps correctly in the sequence shown.

ASSEMBLY TIME

Approximately 35 minutes

INSTALLATION INSTRUCTIONS

Vehicle Preparation Instructions

1. Ensure ignition is off and the vehicle is cooled down.

REMOVAL

1. Remove both the right and left hand side covers (A).

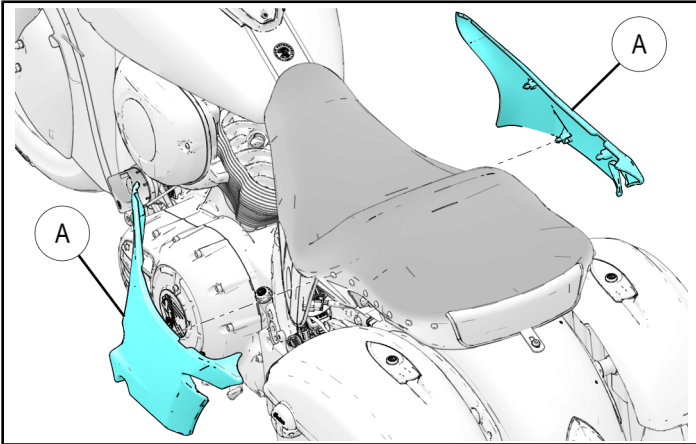

2. Remove the seat by removing to screws (B) and (B1) using a 6mm external hex wrench.

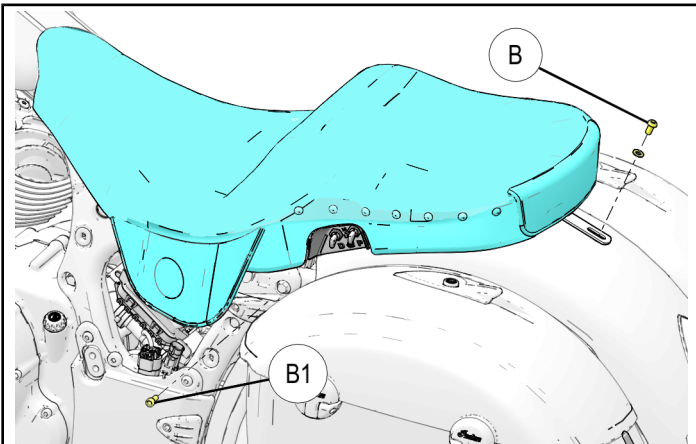

3. Locate the splitter harness ③ in this kit. Plug the splitter harness ③ into the 16-pin connector and the 2-pin power connector under the seat as shown. If the 16-pin connector is already occupied by trunk audio or saddlebag audio, remove the current connector and replace with the splitter.

NOTE

If an OE trunk is installed, the "Trunk" labeled connector at the end of the splitter harness ③ will mate with the 16-pin connector under the seat when the seat is reinstalled upon completion of all audio kits.

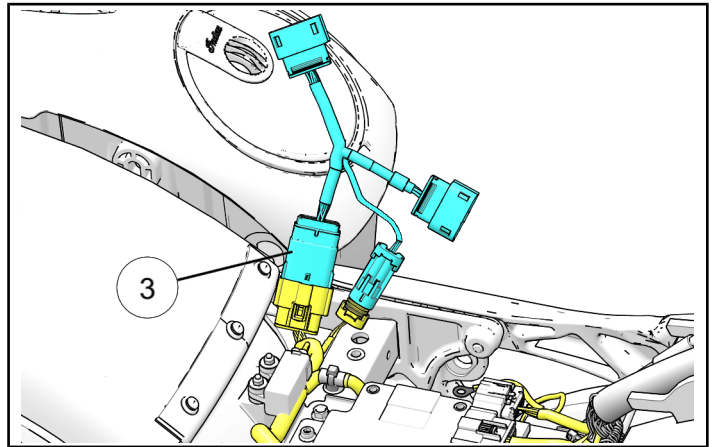

4. If an OE trunk is not installed, follow the instructions in the Trunk Audio Speaker Kit PN 2882213 to complete the installation of trunk audio.

5. Follow the instructions in the Saddlebag Audio Speaker Kit (PN 2882212, refer to section of instructions titled *Instructions for Customers with an Amplifier in the LH Saddlebag*) to complete the installation of saddlebag audio. Upon completion, ensure saddlebag audio and trunk audio are mated with the correct connectors on the splitter, per the labels on the splitter.

NOTE

Harnesses ① and ② will be used during saddlebag audio installation. It is possible that these harnesses were previously installed. If that is the case, these harnesses from this kit are extra. If saddlebag audio was previously installed and harnesses ① and ② were not retained from that kit, they will now be used to connect saddlebag audio from the splitter to the LH and RH speaker harnesses, and to the amplifier in the LH saddlebag. Instructions for this procedure are detailed in the Saddlebag Audio Speaker instruction kit PN 2882212, in the section titled *Instructions for Customers with an Amplifier in the LH Saddlebag*.

IMPORTANT

Ensure wires and connectors are not pinched or damaged when seat is reinstalled, or by moving components when the motorcycle is in use (i.e. shock). Use Panduit straps as necessary to retain wiring