

USB KIT



P/N 2885161

BEFORE YOU BEGIN

Read these instructions and check to be sure all parts and tools are accounted for. Please retain these installation instructions for future reference and parts ordering information.

APPLICATION

Verify accessory fitment at www.indianmotorcycle.com.

KIT CONTENTS

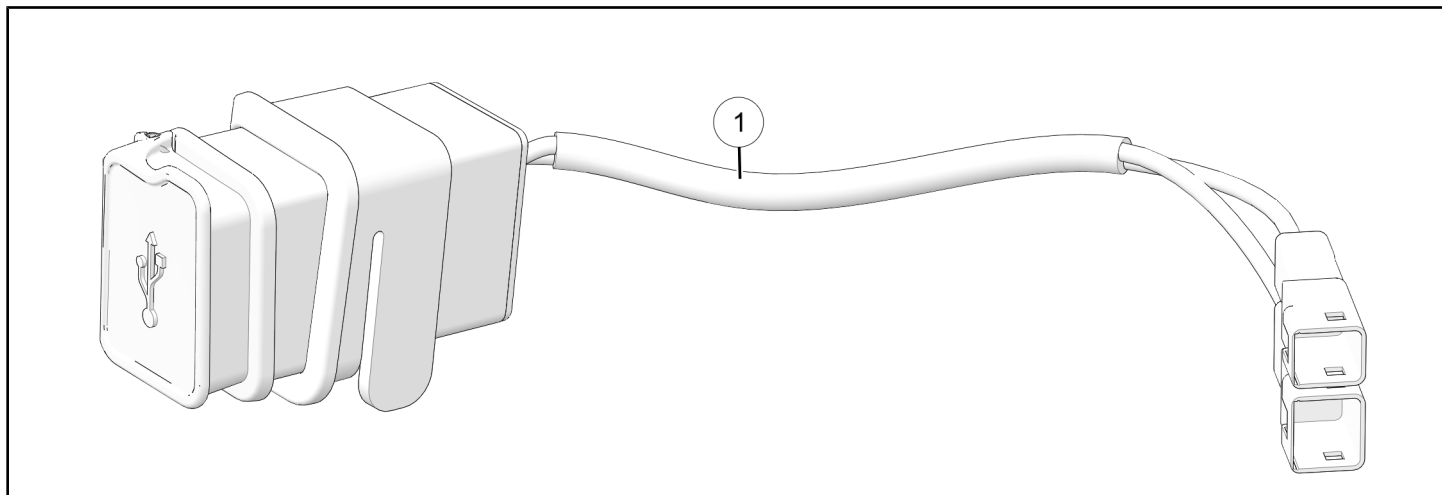

REF	QTY	PART DESCRIPTION	P/N AVAILABLE SEPARATELY
1	1	Module-USB	2414669

TOOLS REQUIRED

- Safety Glasses
- Hex Key Set, Metric
- Socket Set, Hex Bit, Metric
- Torque Wrench

IMPORTANT

Your Indian Motorcycle® USB Kit is exclusively designed for your vehicle. Please read the installation instructions thoroughly before beginning. Installation is easier if the vehicle is clean and free of debris. For your safety, and to ensure a satisfactory installation, perform all installation steps correctly in the sequence shown.

INSTALLATION INSTRUCTIONS

VEHICLE PREPARATION

GENERAL

1. Park motorcycle on a flat surface, fully extend kickstand, and make sure vehicle is stable.
2. Turn key to OFF position and remove key.

INSTRUMENT CLUSTER REMOVAL

1. Remove two fasteners and two washers from front of instrument cluster.

IMPORTANT

Protect airbox painted finish with protective cloth during removal.

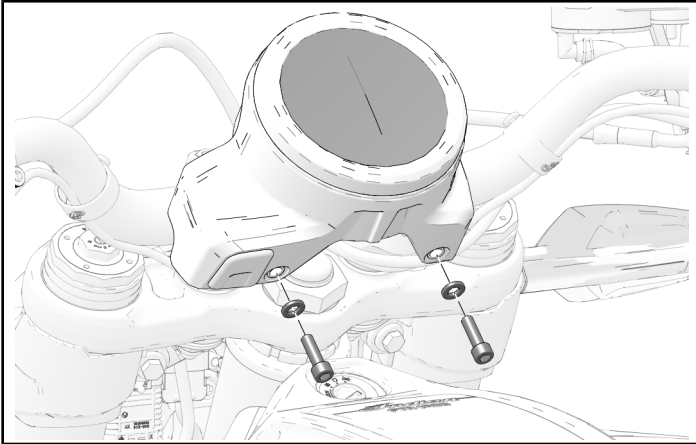

2. Disconnect all electrical connections before removing instrument cluster from handlebar.

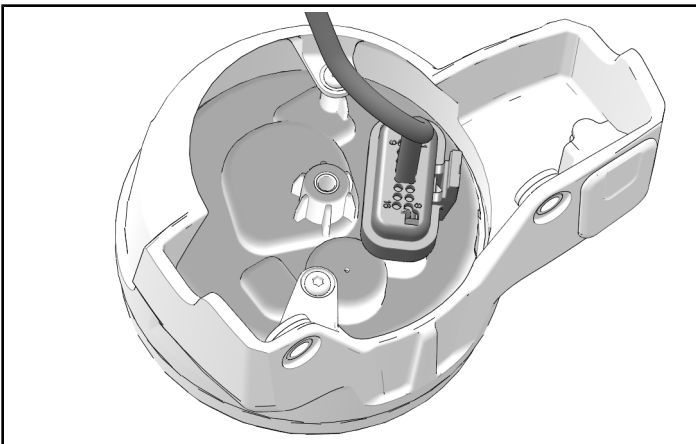

3. Keep two bushings and two rubber washers from rear of instrument cluster.

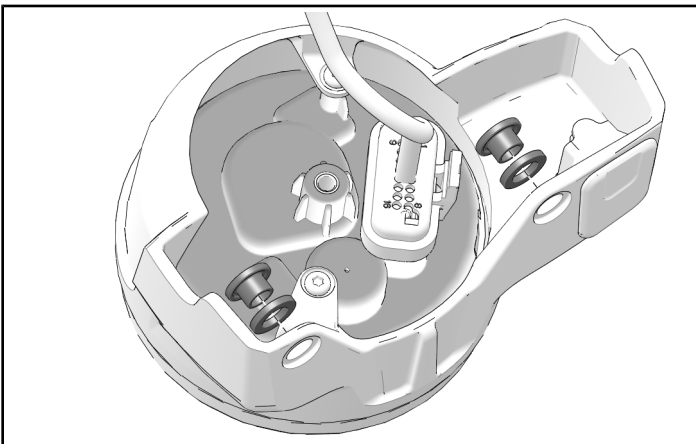

ACCESSORY INSTALLATION

1. Push USB plug out of instrument cluster assembly.

TIP

USB connectors are taped to backside of USB plug.

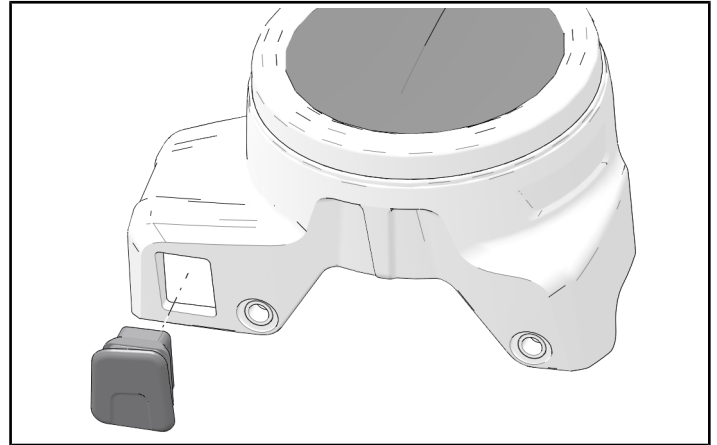

2. Install accessory USB harness ①.

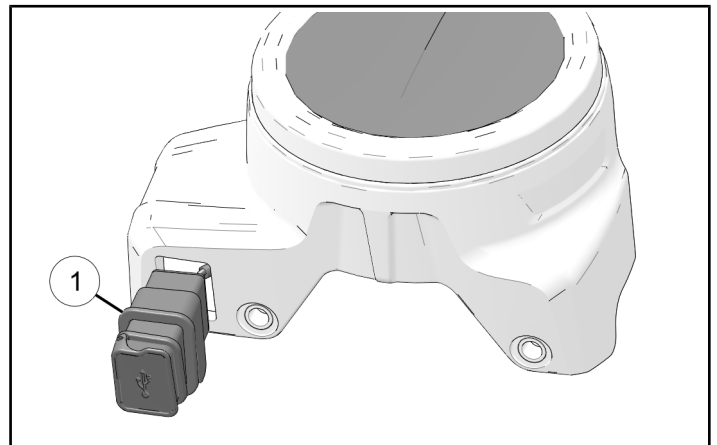

3. Make sure USB module is fully seated.

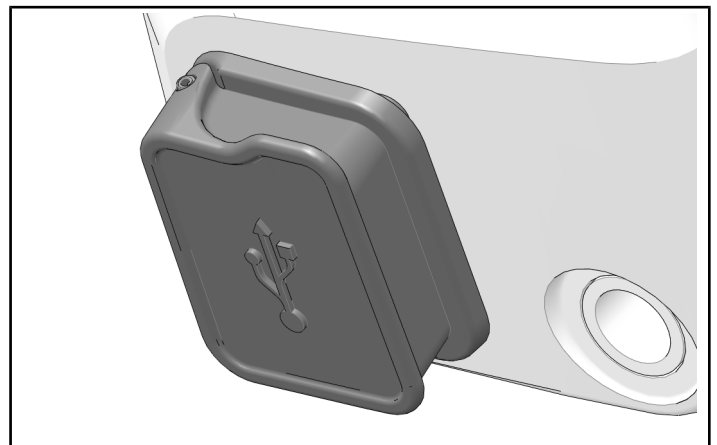

4. Put connectors around speedometer mount post, as shown.

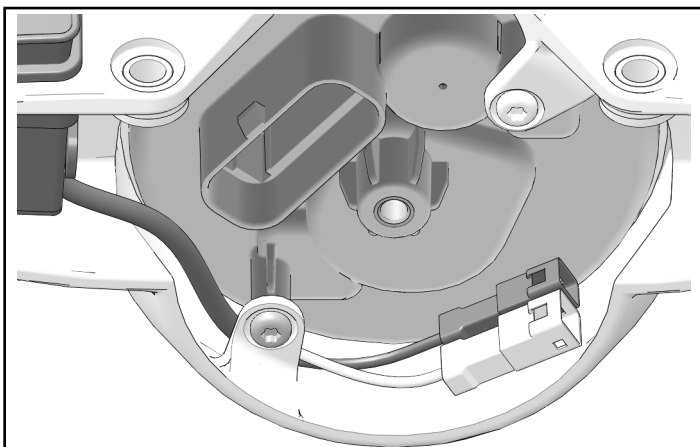

5. Install 2-pin connector only.

IMPORTANT

Do not install 3-pin connector. Make sure 3-pin connector on main vehicle harness has cap installed.

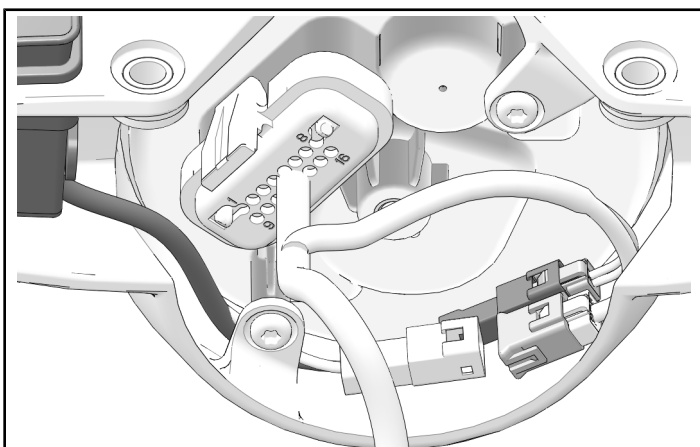

2. Connect all electrical connections.

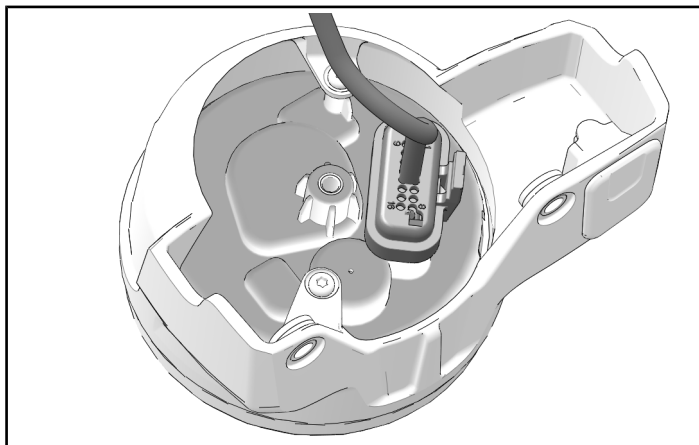

3. Install instrument cluster with two retained fasteners and two retained washers.

TORQUE

Instrument Cluster Fasteners:
84 in-lbs (9.5 N·m)

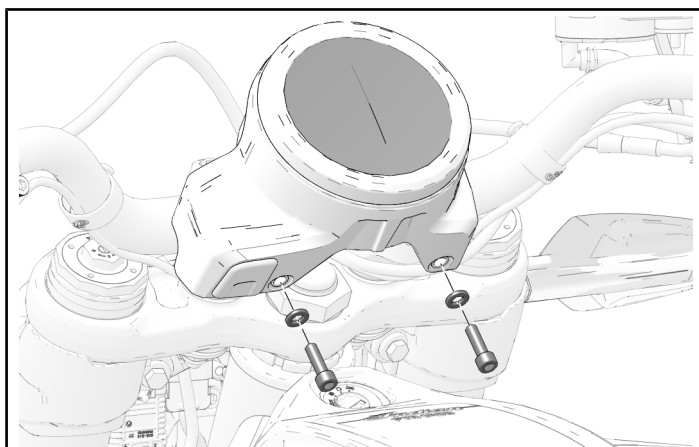

VEHICLE REASSEMBLY

INSTRUMENT CLUSTER INSTALLATION

1. Install two bushings through two rubber washers and put in instrument cluster assembly, as shown.

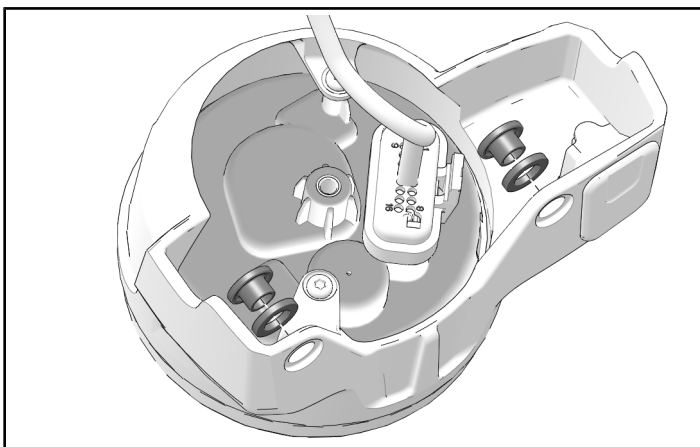

INSTRUCTION FEEDBACK FORM

A feedback form has been created for the installer to provide any comments, questions or concerns about the installation instructions. The form is viewable on mobile devices by scanning the QR code or by clicking [HERE](#) if viewing on a PC.

