

# CUP HOLDER KIT

**KIT P/N 2880137**



## Application

All Chief, Chieftain and Roadmaster Platform Vehicles

**NOTE:** Before you begin, read these instructions and check to be sure all parts and tools are accounted for in package. Please retain these installation instructions for future reference and parts ordering information. For your safety, and to ensure a satisfactory installation, perform all installation steps correctly in the sequence shown below.

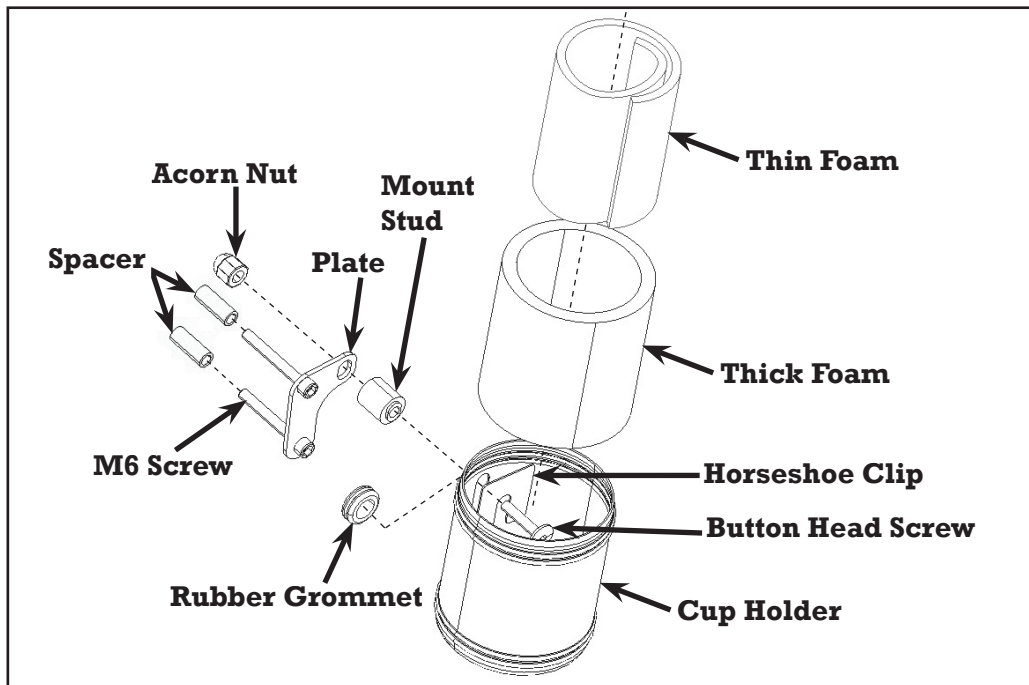

## Kit Contents:

| Quantity | Part Description | Part Number |
|----------|------------------|-------------|
| 1        | Cup Holder Kit   | 2880137     |
| 1        | Instructions     | 9925043     |

## You will need to supply:

5 mm Hex Key Socket  
14 mm Socket

4 mm Hex Key Socket  
T30 Torx Bit

Torque Wrench

**APPROXIMATE ASSEMBLY TIME:** 15 minutes

## **INSTALLATION INSTRUCTIONS**

### **Installation:**

1. Remove clutch lever cap screws using a T30 Torx socket. See Figure 1.

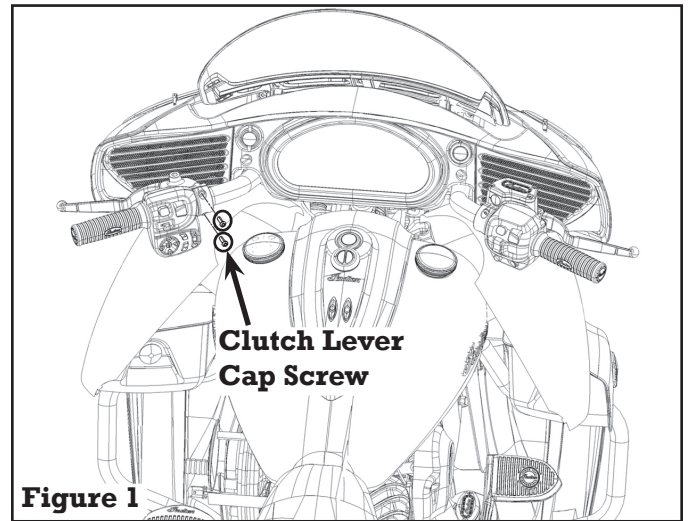

2. With the spacers behind the plate, tighten the plate to the clutch assembly using the M6 screws. Ensure the placement and orientation of the plate and spacers match Figure 2. Torque the screws to 70 in-lbs (7.9 Nm), be sure to torque top screw first.

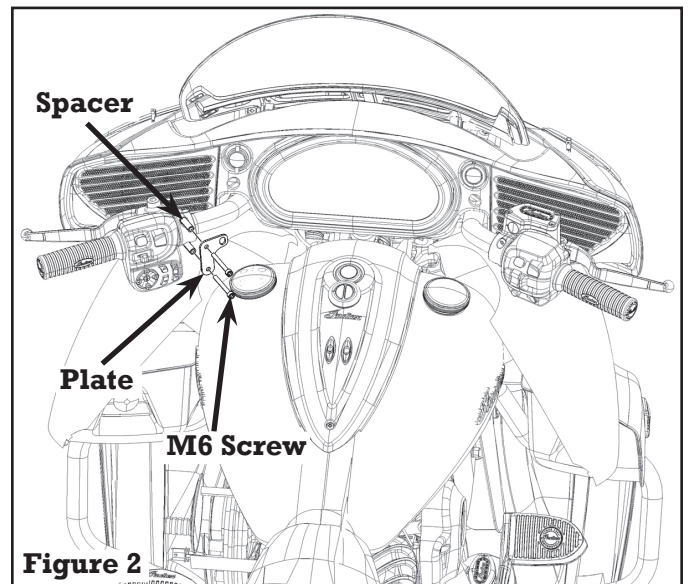

3. Tighten the mount stud to the plate using the button head screw and the acorn nut. Ensure the embossed feature on the rider's side of the mount stud is aligned with the slot in the cup holder. See Figure 3.

4. Place the horseshoe clip on mount stud as shown in Figure 3 and check that the slot in the horseshoe aligns with the mount stud feature mentioned in the previous step.

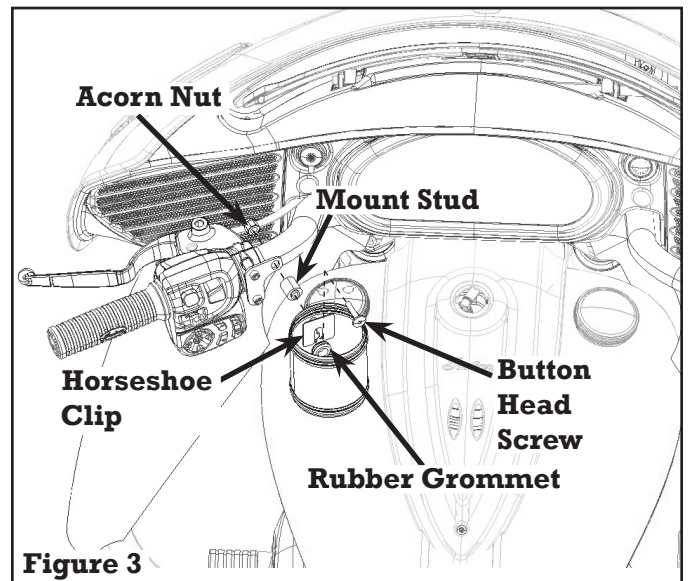

5. Mount the cup holder via its slot. Ensure a proper fit by checking the cup holder wall is securely between the button head screw and the mount stud. See Figure 4.
6. Place the Rubber Grommet into the lower half of the slot.

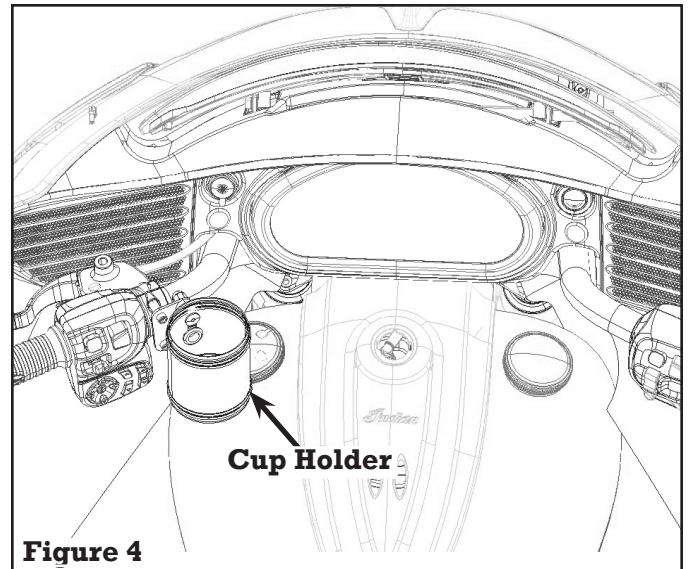

**NOTE: The thin foam insert may be removed to accommodate different drink sizes.**