

# ÖHLINS® FORK KIT



P/N 2889062

## BEFORE YOU BEGIN

Read these instructions and check to be sure all parts and tools are accounted for. Please retain these installation instructions for future reference and parts ordering information.

## APPLICATION

Verify accessory fitment at [www.indianmotorcycle.com](http://www.indianmotorcycle.com).

### IMPORTANT

This accessory is not compatible with 19 in wheels.

## KIT CONTENTS

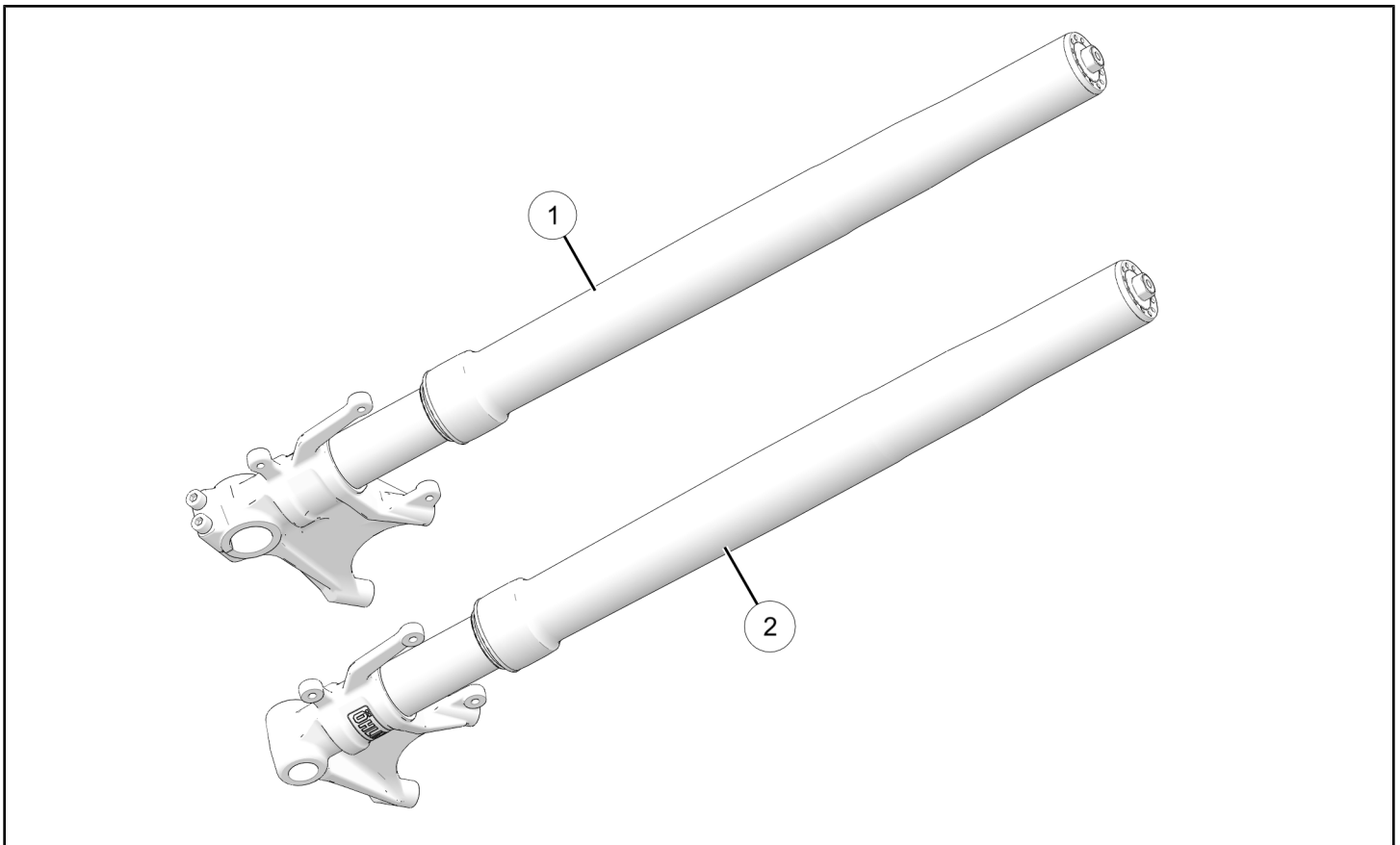

REF	QTY	PART DESCRIPTION	P/N AVAILABLE SEPARATELY
1	1	Assembly-Fork, Right-Hand	1824982
2	1	Assembly-Fork, Left-Hand	1824981

## TOOLS REQUIRED

- Safety Glasses
- Hex Key Set, Metric
- Hex Key Set, Ball End, Metric
- Pick and Hook Set

- Platform Jack, Motorcycle
- Ruler
- Socket Set, Hex Bit, Metric
- Socket Set, Hex Bit, Metric, Ball-End

- Socket Set, Metric
- Tape Measure
- Torque Wrench
- Wrench Set, Metric

## IMPORTANT

Your Indian Motorcycle® Öhlins® Fork Kit is exclusively designed for your vehicle. Please read the installation instructions thoroughly before beginning. Installation is easier if the vehicle is clean and free of debris. For your safety, and to ensure a satisfactory installation, perform all installation steps correctly in the sequence shown.

## INSTALLATION INSTRUCTIONS

### VEHICLE PREPARATION

#### GENERAL

1. Park motorcycle on a flat surface, fully extend kickstand, and make sure vehicle is stable.
2. Turn key to OFF position and remove key.

#### HEADLIGHT COWL REMOVAL (IF APPLICABLE)

1. Remove and keep four screws and four washers from headlight cowl.

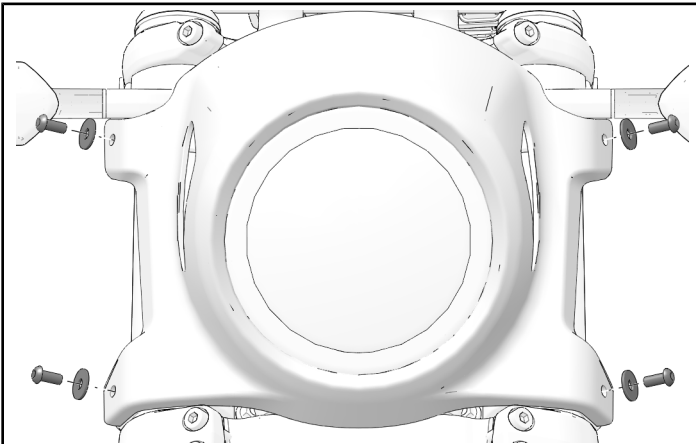

2. Remove headlight cowl.

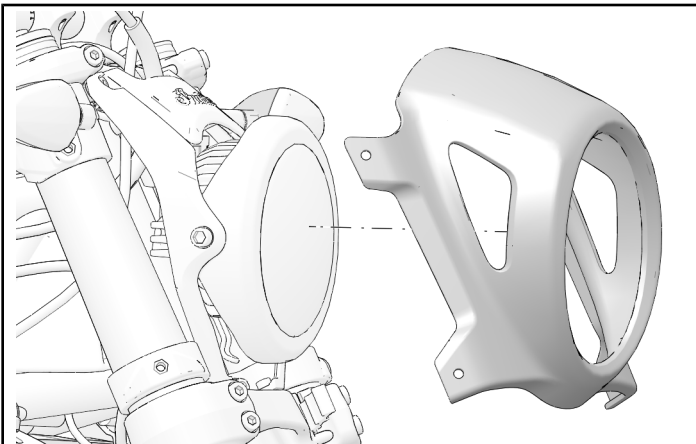

#### FRONT TURN SIGNAL MOUNT REMOVAL

##### NOTICE

Right turn signal shown; left turn signal similar.

1. Disconnect turn signal from chassis electrical harness.

##### NOTICE

Headlight bracket hidden for procedure clarity.

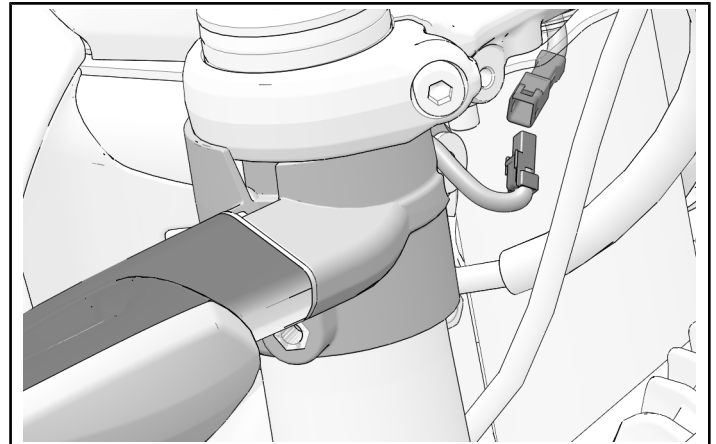

2. Remove and keep one screw and one washer from turn signal mount. Remove turn signal assembly from motorcycle.

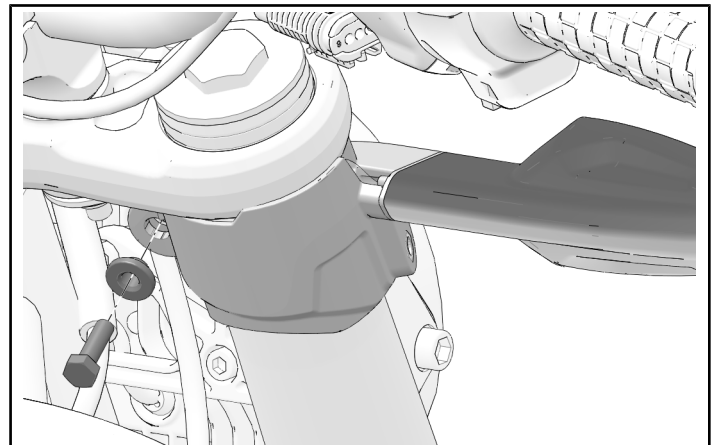

## HEADLIGHT COWL MOUNT REMOVAL (IF APPLICABLE)

### NOTICE

Right mount shown; left mount similar.

1. Loosen fastener and turn headlight cowl mount to access hardware for removal.

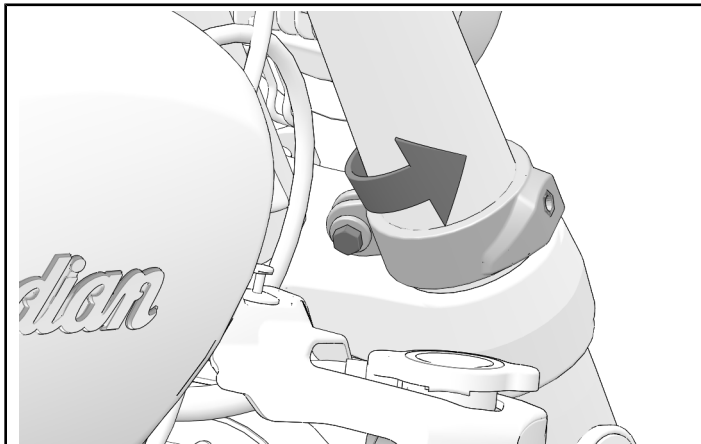

2. Remove one fastener, two bushings, and one nut to remove headlight cowl mount.

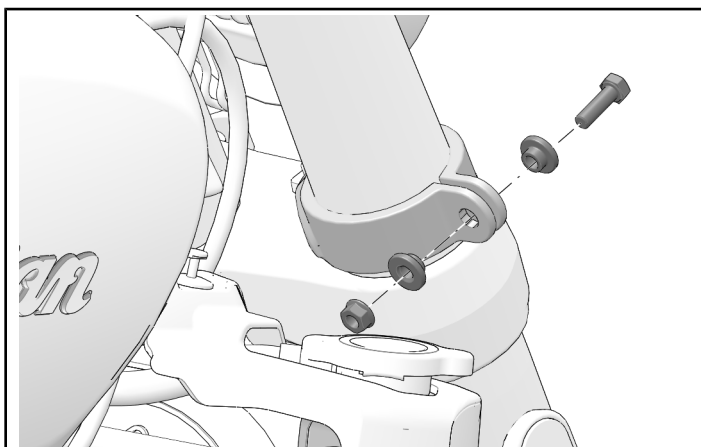

## FRONT MUDGUARD REMOVAL

1. Remove four fasteners to remove mudguard from motorcycle.

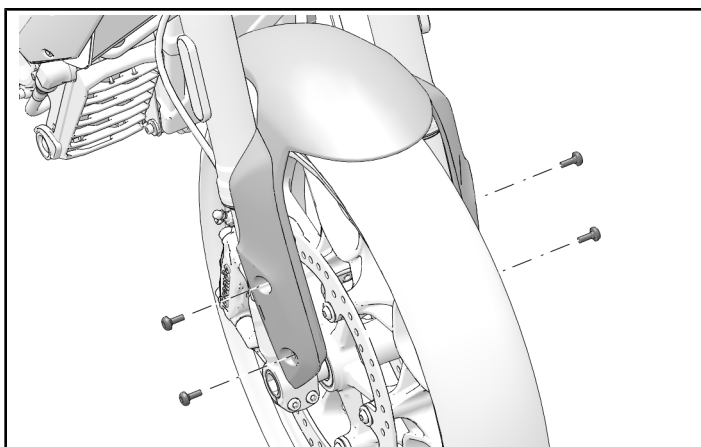

## FRONT CALIPER REMOVAL

### NOTICE

Right brake caliper shown; left brake caliper similar.

### CAUTION

Do not twist brake hose or brake line. Do not allow calipers to hang from brake line. Damage to brake line may affect braking performance resulting in injury or death. Always secure calipers in a way that avoids damage to calipers or brake line.

### IMPORTANT

Do not operate front brake lever with calipers or wheel removed.

1. Remove front caliper mounting fasteners to remove caliper.

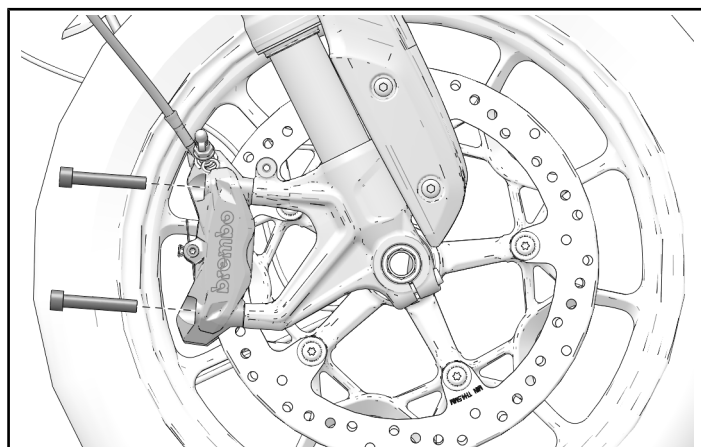

## FRONT WHEEL REMOVAL

### **⚠ WARNING**

**This procedure requires raising and supporting motorcycle so front wheel is off ground. Precautions should be taken to ensure motorcycle is properly stabilized at all times. Failure to properly support motorcycle may result in personal injury or damage to motorcycle.**

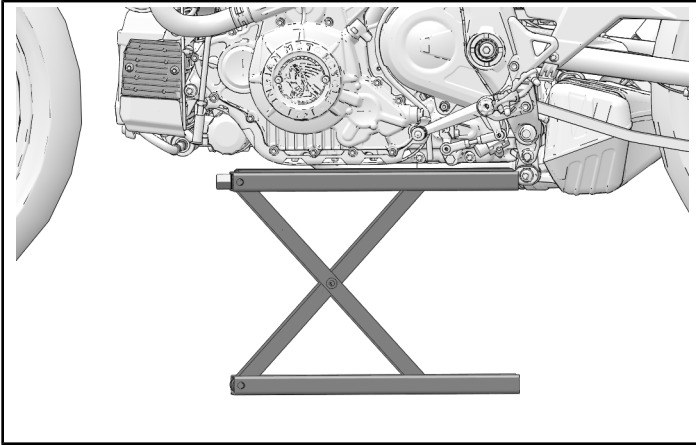

1. Secure motorcycle in an upright position with tie-down straps and platform jack positioned beneath engine cases.

### **IMPORTANT**

**Do not operate front brake lever with calipers or wheel removed.**

2. Loosen axle pinch bolts on lower right fork leg.

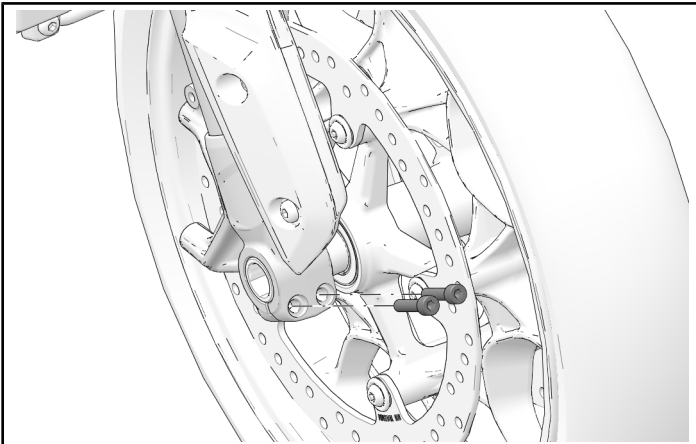

3. Support wheel and remove axle.

### **TIP**

**Spacer is loosely held in place by dust seals and may fall out after wheel has been removed.**

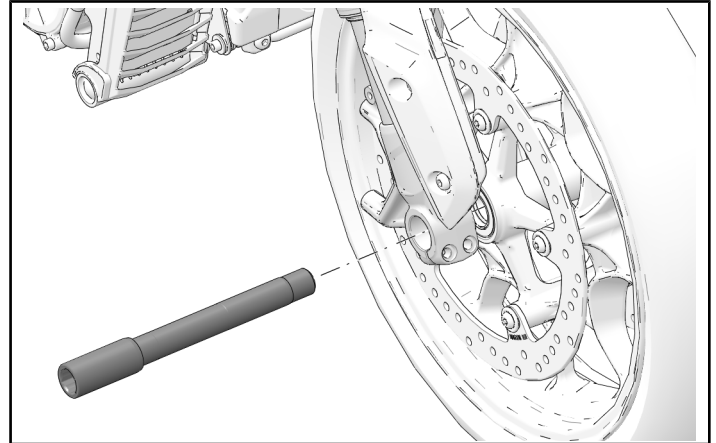

4. Wheel speed sensor will fall out when axle and wheel are removed.

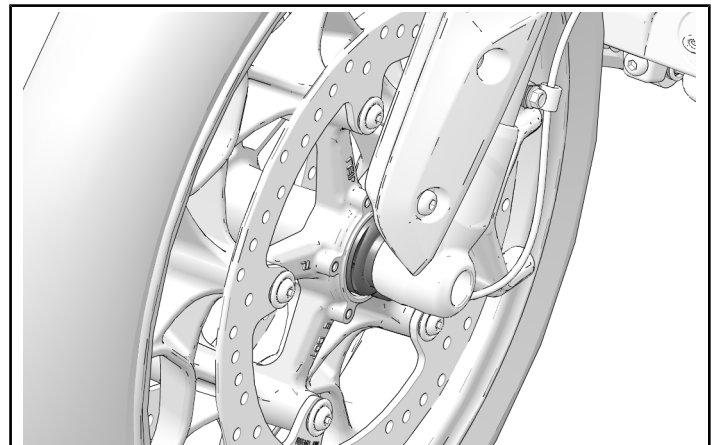

## FRONT FORK REMOVAL

1. Loosen two top triple clamp fasteners.

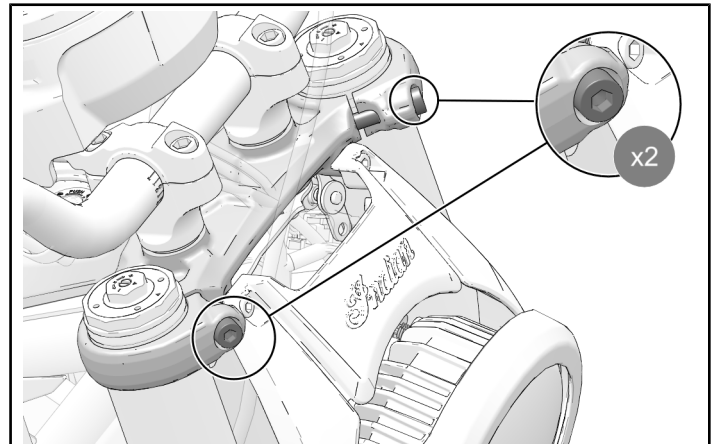



2. Loosen four lower triple clamp fasteners.

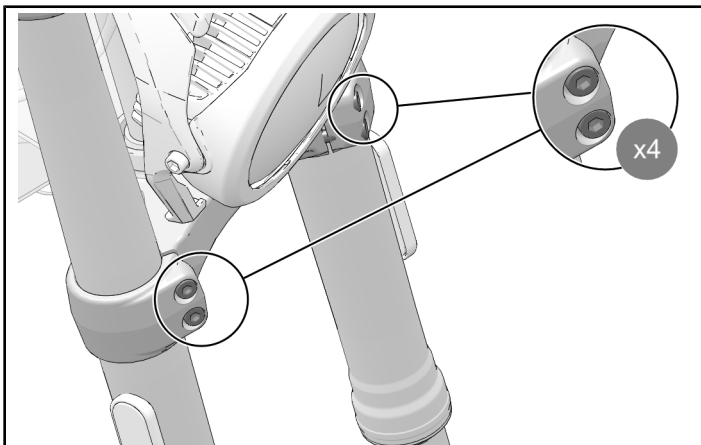

3. Carefully move fork assemblies downward and out of triple clamps.

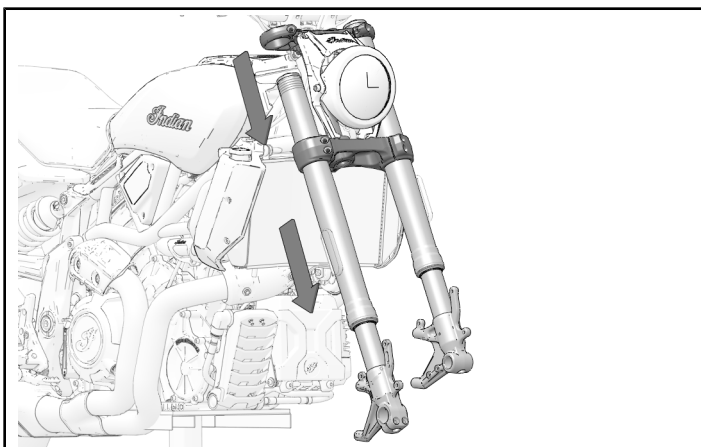

## ACCESSORY INSTALLATION

### IMPORTANT

Install fork assemblies one at a time.

1. Install one accessory fork assembly into lower triple clamp.

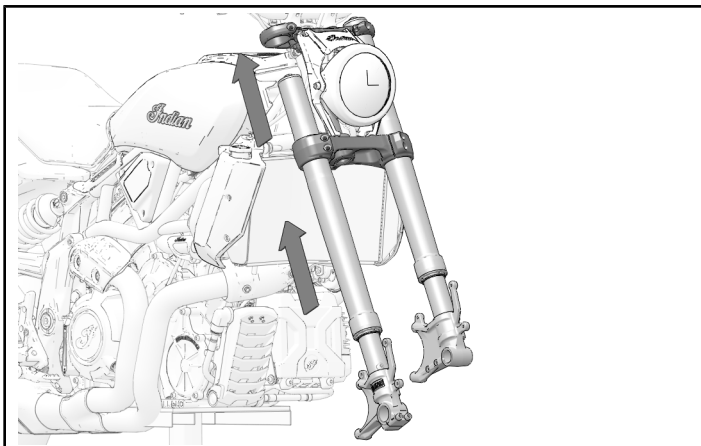

2. Continue to install fork assembly into upper triple clamp. Leave **11 mm** between top triple clamp and adjustment dial, as shown.

### MEASUREMENT

Measurement **A**:  
**11 mm**

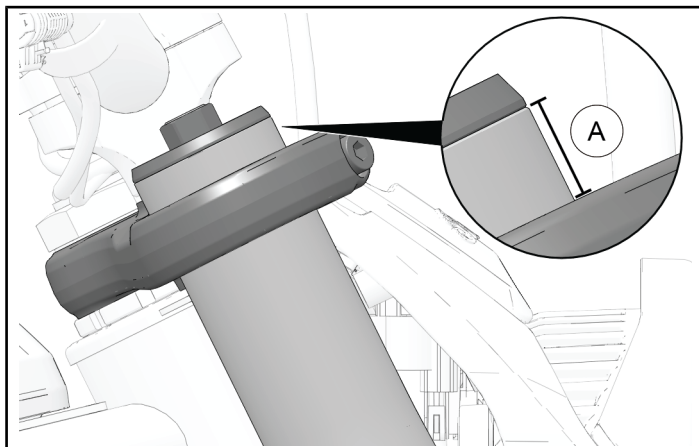

3. Torque lower triple clamp fasteners to specification.

### TORQUE

Triple Clamp Fasteners:  
**18 ft-lbs (24 N·m)**

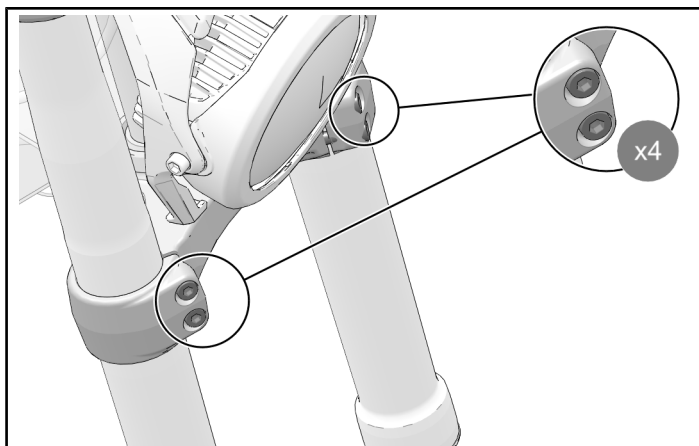

4. Torque upper triple clamp fasteners to specification.

#### **TORQUE**

Triple Clamp Fasteners:  
**18 ft-lbs (24 N·m)**

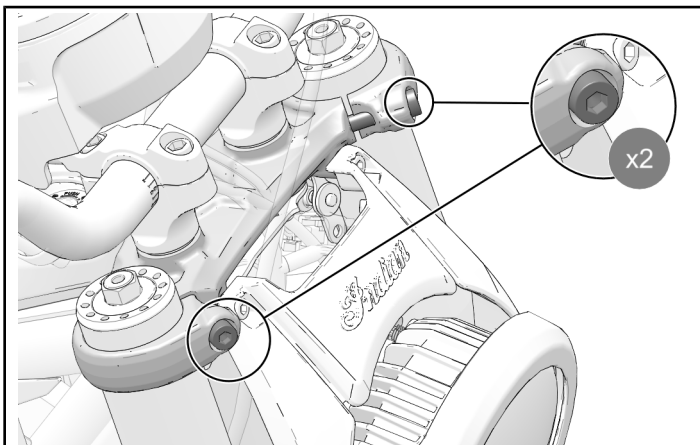

5. Torque lower triple clamp fasteners to specification a second time.

#### **TORQUE**

Triple Clamp Fasteners:  
**18 ft-lbs (24 N·m)**

6. Torque upper triple clamp fasteners to specification a second time.

#### **TORQUE**

Triple Clamp Fasteners:  
**18 ft-lbs (24 N·m)**

## **VEHICLE REASSEMBLY**

### **FRONT WHEEL INSTALLATION**

1. Install front wheel and spacers into fork.
2. Install the axle.

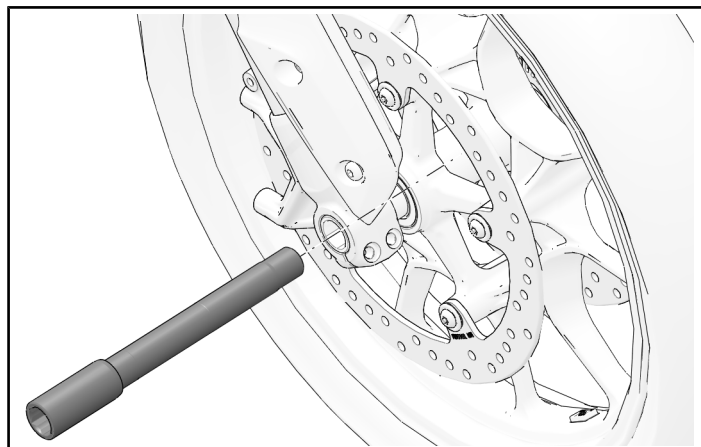

3. Make sure wheel speed sensor is installed between left fork and wheel.

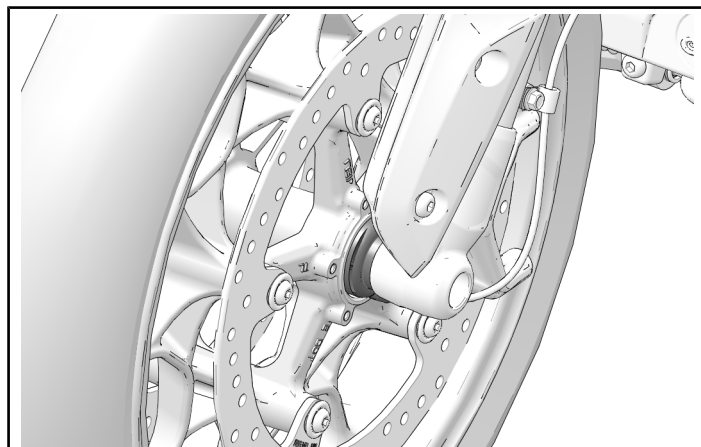

4. Torque axle to specification.

#### **TORQUE**

Axle (front fork):  
**55 ft-lbs (75 N·m)**

5. Cycle front suspension. Tighten axle pinch bolts to specification.

#### **TORQUE**

Axle Pinch Fasteners:  
**14 ft-lbs (19 N·m)**

**Tighten each screw once after initial torque**

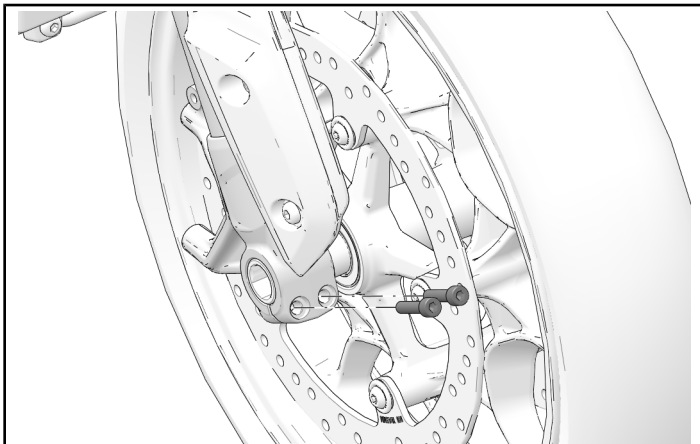

6. Install front wheel speed sensor harness to left fork.

#### **TORQUE**

Clip Fastener:  
**84 in-lbs (9.5 N·m)**

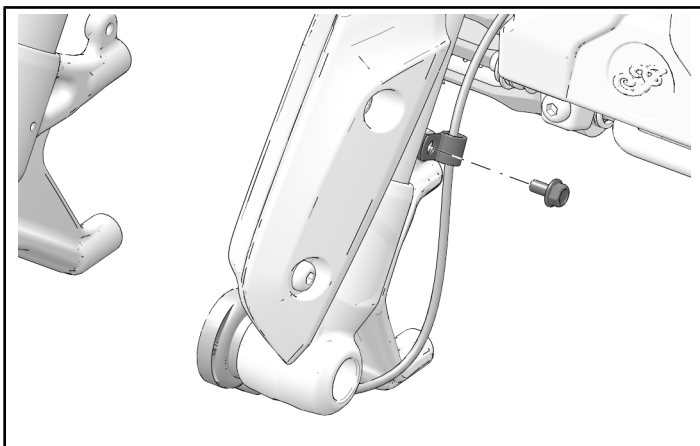

### **FRONT MUDGUARD INSTALLATION**

1. Install mudguard to forks with four fasteners. Torque four fasteners to specification.

#### **TORQUE**

Mud Guard Fasteners:  
**96 in-lbs (11 N·m)**

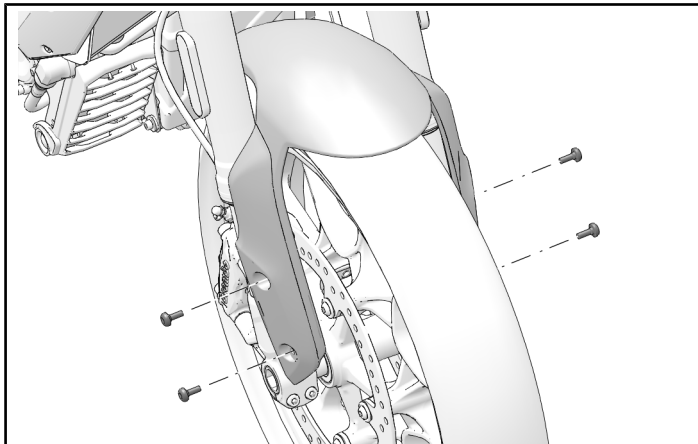

### **FRONT CALIPER INSTALLATION**

#### **NOTICE**

Right caliper shown; left caliper similar.

1. Install front caliper with two fasteners. Torque fasteners to specification.

#### **TIP**

Make sure proper caliper alignment by lightly applying brake force with brake lever while simultaneously tightening fasteners.

#### **TORQUE**

Caliper Fasteners (front):  
**32 ft-lbs (43 N·m)**

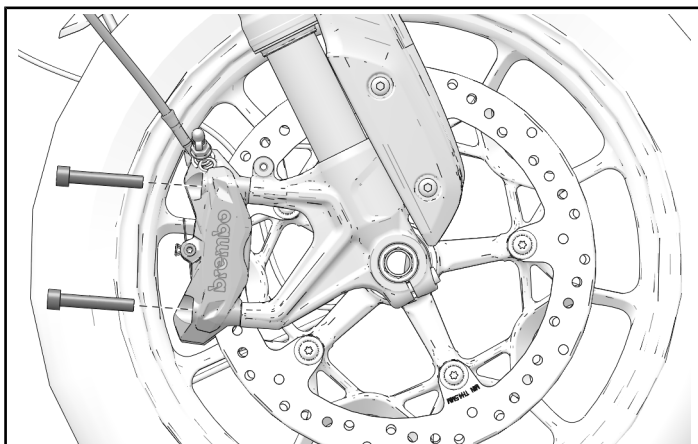

## FRONT TURN SIGNAL MOUNT INSTALLATION

### NOTICE

Right turn signal shown; left turn signal similar.

1. Install turn signal mount onto fork with one fastener and one washer. Rotate mount to desired position and torque fastener to specification.

### TORQUE

Turn Signal Mount Fastener:  
**36 in-lbs (4 N·m)**

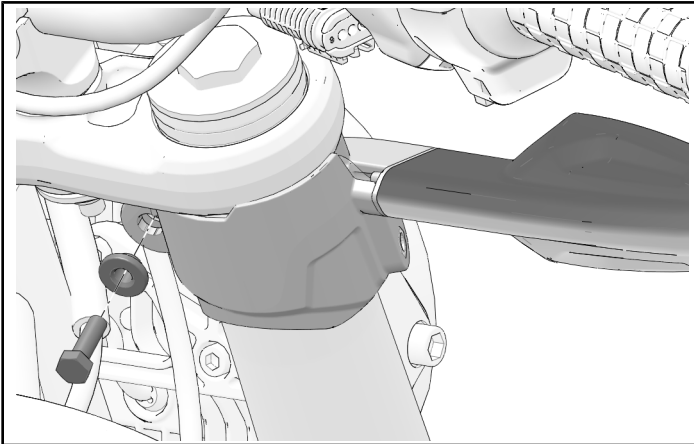

2. Install turn signal connector to chassis harness connector.

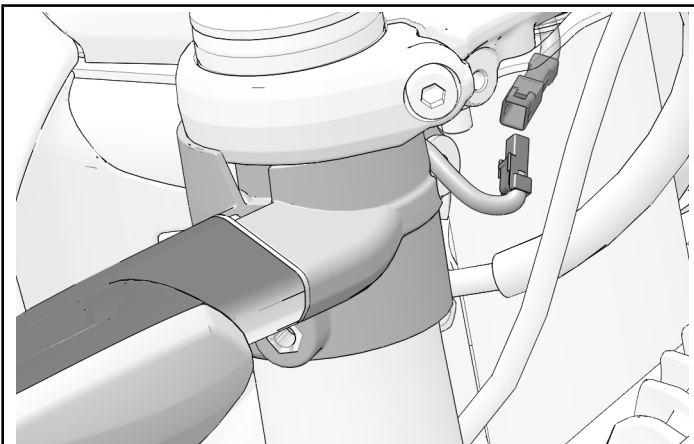

## HEADLIGHT COWL MOUNT INSTALLATION

### NOTICE

Right mount shown; left mount similar.

1. Install headlight cowl mount with retained hardware: one fastener, two bushings, and one nut.

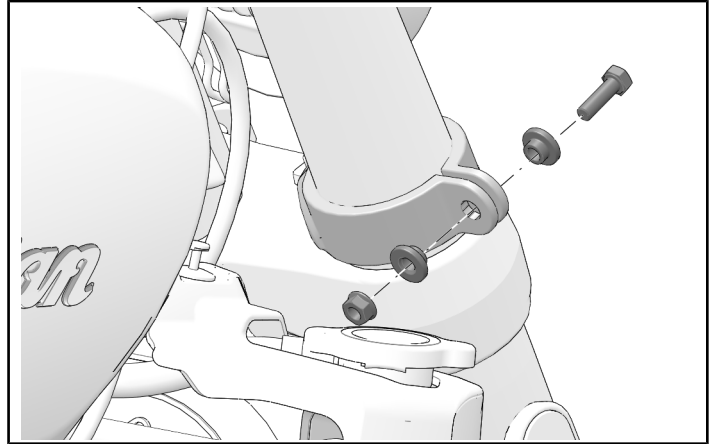

2. Turn headlight cowl mount to installed position and hand tighten fastener.

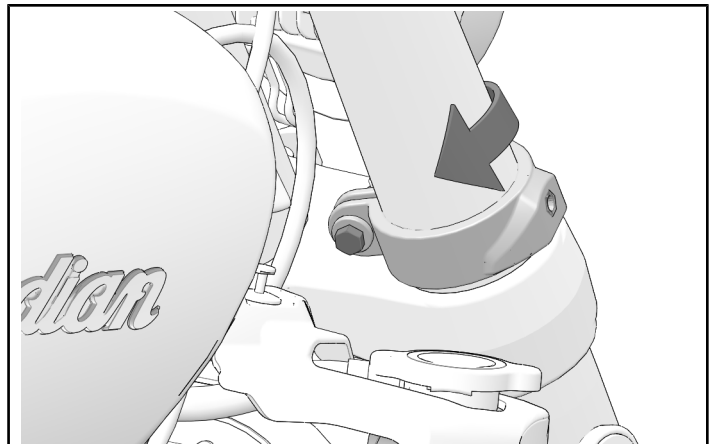



## **HEADLIGHT COWL INSTALLATION (IF APPLICABLE)**

1. Install headlight cowl onto turn signal mounts and headlight cowl mounts with four fasteners and four washers. Torque fasteners to specification.

### **TORQUE**

Headlight Cowl Fasteners:  
**18 in-lbs (2 N·m)**

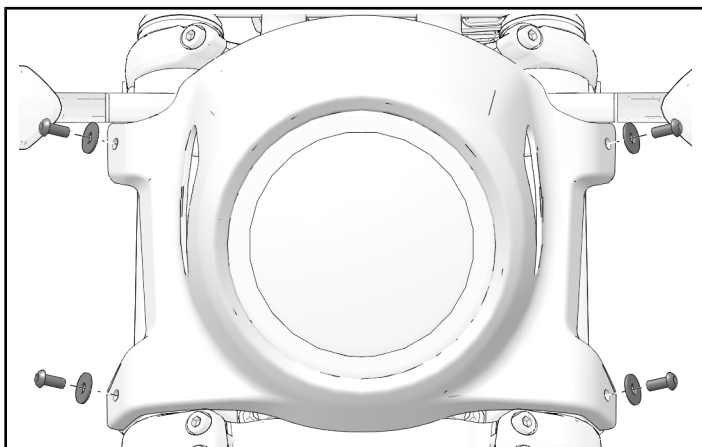

## FRONT FORK ADJUSTMENT GUIDE

### RECOMMENDED DAMPING SETTINGS

Riding Type	Compression Left-Hand Fork	Rebound Right-Hand Fork
Low Speed Riding (Urban)	22 clicks out	18 clicks out
General Riding (Town/ Highway)	18 clicks out	16 clicks out
General Riding (2-up)	15 clicks out	14 clicks out
Aggressive Riding (Track)	14 clicks out	19 clicks out

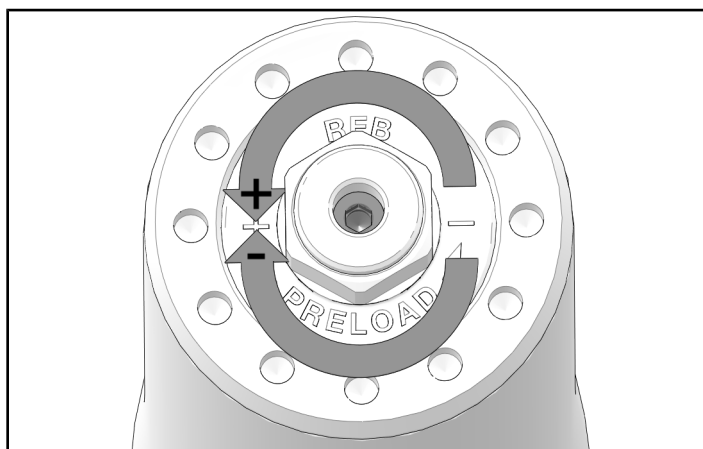

### RECOMMENDED PRE-LOAD SETTINGS

Adjustments can be made to the fork to increase or decrease pre-load for a personal rider preference.

#### IMPORTANT

Make sure both forks are adjusted evenly.

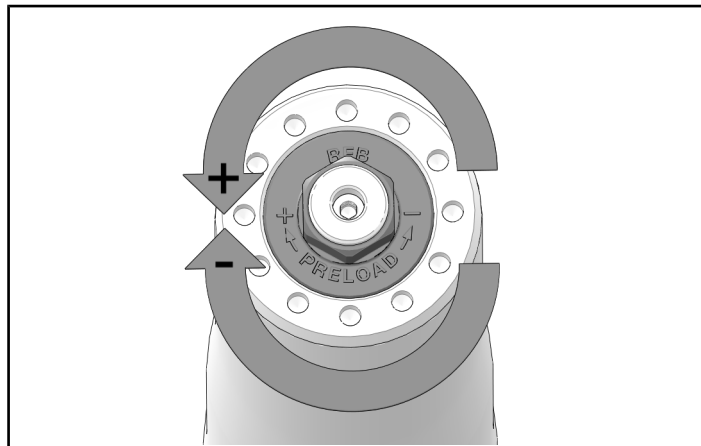

### INSTRUCTION FEEDBACK FORM

A feedback form has been created for the installer to provide any comments, questions or concerns about the installation instructions. The form is viewable on mobile devices by scanning the QR code or by clicking [HERE](#) if viewing on a PC.

