

DOOR LOCK KIT

P/N 2881170



APPLICATION

INDIAN ROADMASTER AND INDIAN MOTORCYCLES WITH THE ACCESSORY HARD LOWER FAIRING KIT

BEFORE YOU BEGIN

Read these instructions and check to be sure all parts and tools are accounted for. Please retain these installation instructions for future reference and parts ordering information.

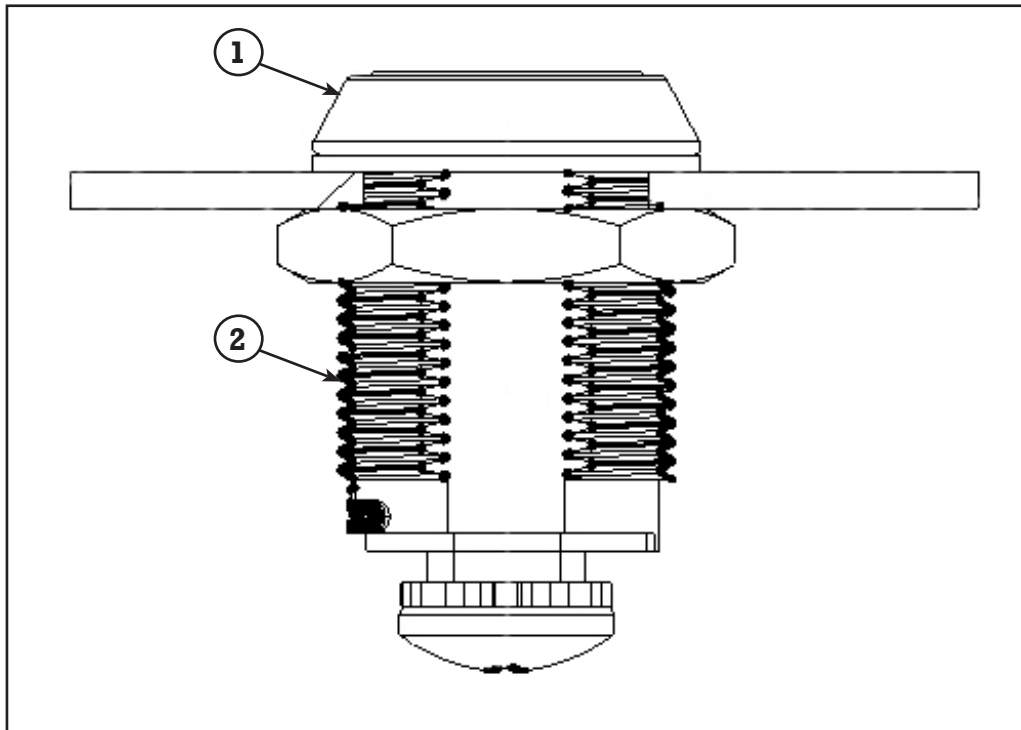

KIT CONTENTS

Ref	Qty	Part Description	Part Number
1	2	Keyed Lock Sets (Includes key, lock housing, seal, screw, lock washer, and nut)	-
2	2	Cams	-
	1	Instructions	9926113

TOOLS NEEDED

7/8" or 22 mm Wrench
Drill and 5/8" Drill Bit
Small Flat and Round File or small Rotary Dremel style tool with 1/2" or Less Sanding Drum
Philips or Flat Bladed Screwdriver
Needle Nose Pliers

APPROXIMATE ASSEMBLY TIME

20 mins

NOTE: Make sure the motorcycle kickstand is fully extended and vehicle is stabilized on a flat surface.

IMPORTANT

Your Indian DOOR LOCK KIT is exclusively designed for your vehicle. Please read the installation instructions thoroughly before beginning. Installation is easier if the vehicle is clean and free of debris. For your safety, and to ensure a satisfactory installation, perform all installation steps correctly in the sequence shown.

INSTALLATION INSTRUCTIONS

CAUTION: Make sure the motorcycle kickstand is fully extended and vehicle is stabilized on a flat surface.

1. Open the doors and remove the two hinge pin C-clips (A) located as shown in figure from each compartment door. Rotate the clip so the open area is pointing forward on the bike. With a needle nose pliers, pull reward to disengage the clip being careful not to twist or deform it. Remove the pins and save the parts for reinstallation.

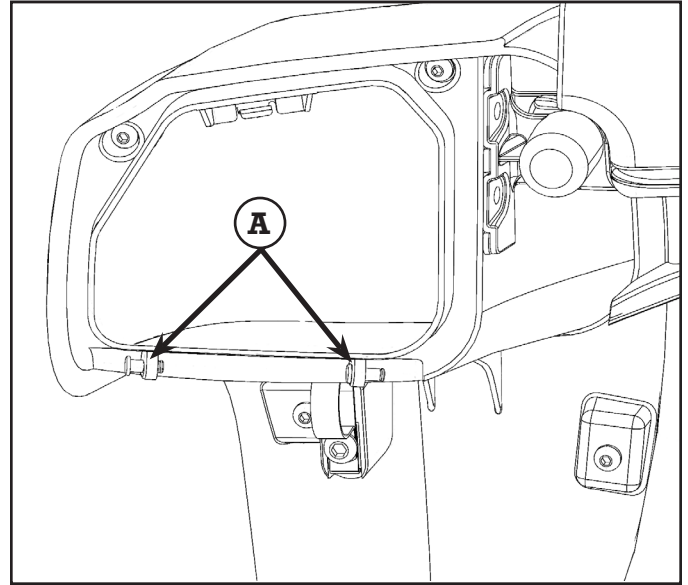

2. Locate the circular feature on the upper inboard area of the door. The center depression is the drill tip guide (B). The round area with two flats is the file/sanding line (C). See figure. Place the 5/8" drill bit in the drill tip guide and drill a hole through the part being careful to protect the far side (visible surface) from damage. Using files or a rotary sanding tool, remove the material inside the file/sanding line. While working, periodically check the fit of the lock housing. The flats on the lock housing should line up with and be snug against the flats in the hole.

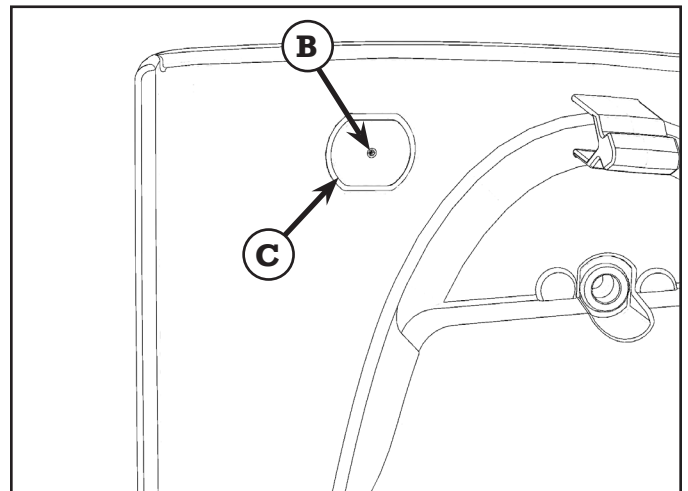

3. Assemble a lock in each door. Place the seal (D) on the lock housing (E) aligning the seal flats to the flats on the housing. Insert the lock housing into the door hole with the flats mating with the flats in the door. The key slot should be vertical and the depressed area next to the key slot should be on the left for consistency. Place the nut (F) on the back side of the door and tighten until lock is held snugly. Place the cam (G) on the lock housing with the end in the up position. See figure. Install the lock washer (H) and screw (J) to retain the cam. Tighten the screw. See figure.

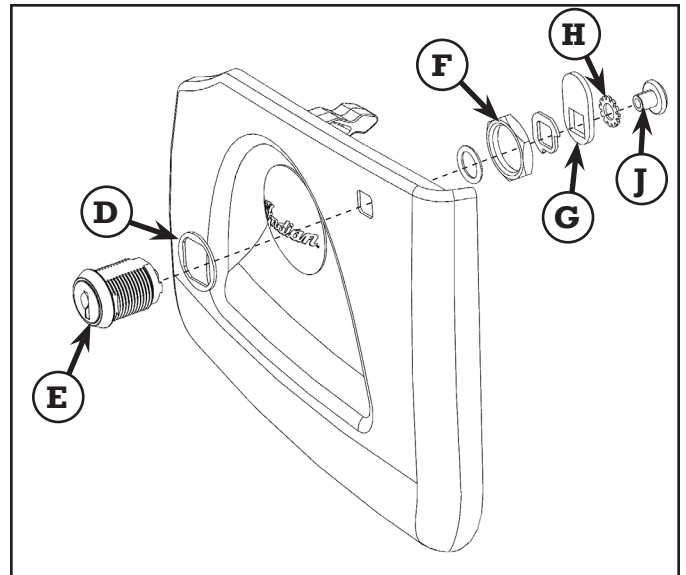

4. Reinstall the door by inserting the hinge pins and installing the C-clips using a needle nose pliers. Insert the key and rotate it 90 degrees counterclockwise to the open position. Close the door until it latches and rotate the key back to the vertical position to lock the door. This may require additional light pressure against the door to compress the seal after the initial installation. The key can be removed in either the locked or unlocked positions.