

TOUR BLACK HEADLIGHT BEZEL KIT



P/N 2881770

APPLICATION

All MY2014 and Newer Indian Motorcycles with a Factory Installed Fairing

BEFORE YOU BEGIN

Read these instructions and check to be sure all parts and tools are accounted for. Please retain these installation instructions for future reference and parts ordering information.

KIT CONTENTS

This Kit includes:

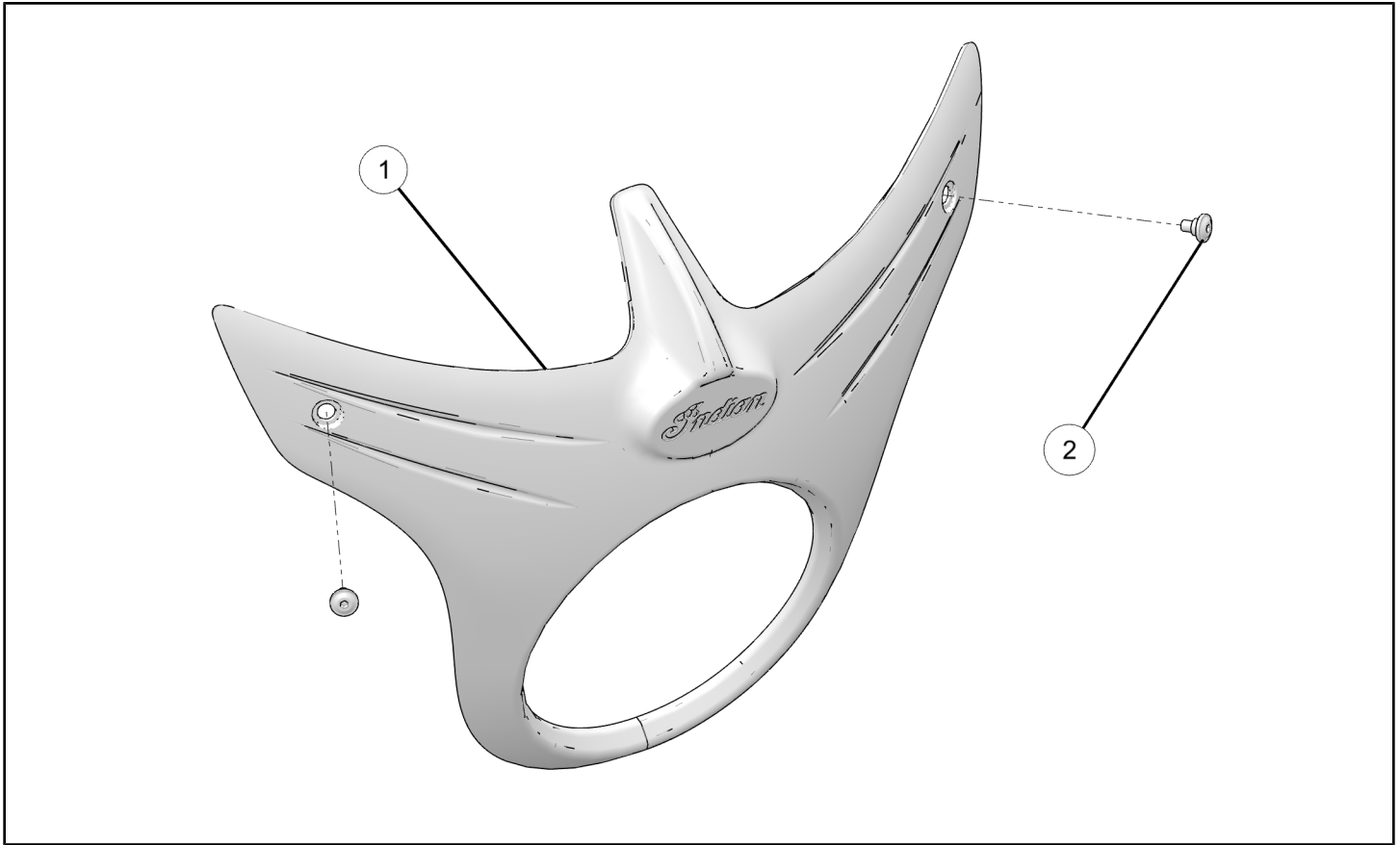

| REF | QTY | PART DESCRIPTION | PART NUMBER |
|-----|-----|--|-------------|
| 1 | 1 | Headlight - Bezel, Paint | 5452811 |
| 2 | 2 | Bolt - Socket Head, M6 X 1.0, 7mm, 9mm | 7520510 |
| | 1 | Instructions | 9926868 |

TOOLS REQUIRED

- 4mm Hex Key

IMPORTANT

Your Indian TOUR BLACK HEADLIGHT BEZEL KIT is exclusively designed for your vehicle. Please read the installation instructions thoroughly before beginning. Installation is easier if the vehicle is clean and free of debris. For your safety, and to ensure a satisfactory installation, perform all installation steps correctly in the sequence shown.

ASSEMBLY TIME

Approximately 5 minutes

INSTALLATION INSTRUCTIONS

NOTE

Protect all finished surfaces during these operations.

1. Remove two M6 flange head screws (A) from the top of the headlight bezel (B). Remove bezel by firmly pulling the top portion away first. The bezel will disconnect from three rubber grommets (C).

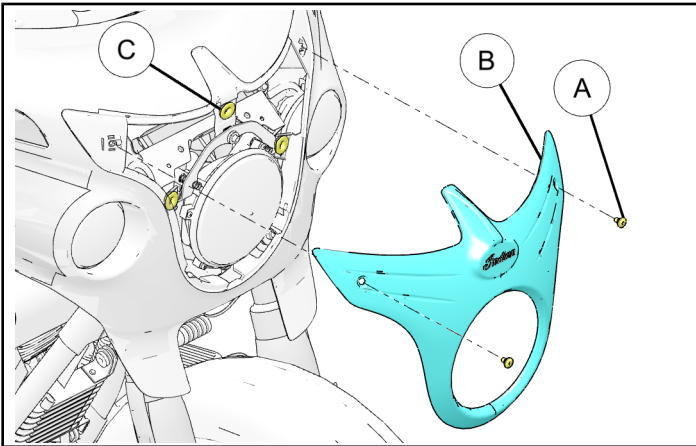

2. Insert the headlight bezel ① by inserting bezel features into the rubber grommets (C) in the fairing. Install two M6 socket head screws ② and torque to specification.

TORQUE

36 ± 6 in. lbs. (4.0 ± 0.6 Nm)

