

# FRONT FENDER KIT



**P/N 2882761**

## APPLICATION

Indian Springfield®, Indian® Chieftain®, Indian® Roadmaster® Classic, Indian® Roadmaster®

Verify fitment at [www.indianmotorcycle.com](http://www.indianmotorcycle.com).

### NOTE

This fender kit will not comply with European lighting regulation ECE-R53 on certain models. If using this kit on an international model, headlight PN 2412820 must also be installed on vehicle. See dealer for installation.

## BEFORE YOU BEGIN

Read these instructions and check to be sure all parts and tools are accounted for. Please retain these installation instructions for future reference and parts ordering information.

## KIT CONTENTS

This Kit includes:

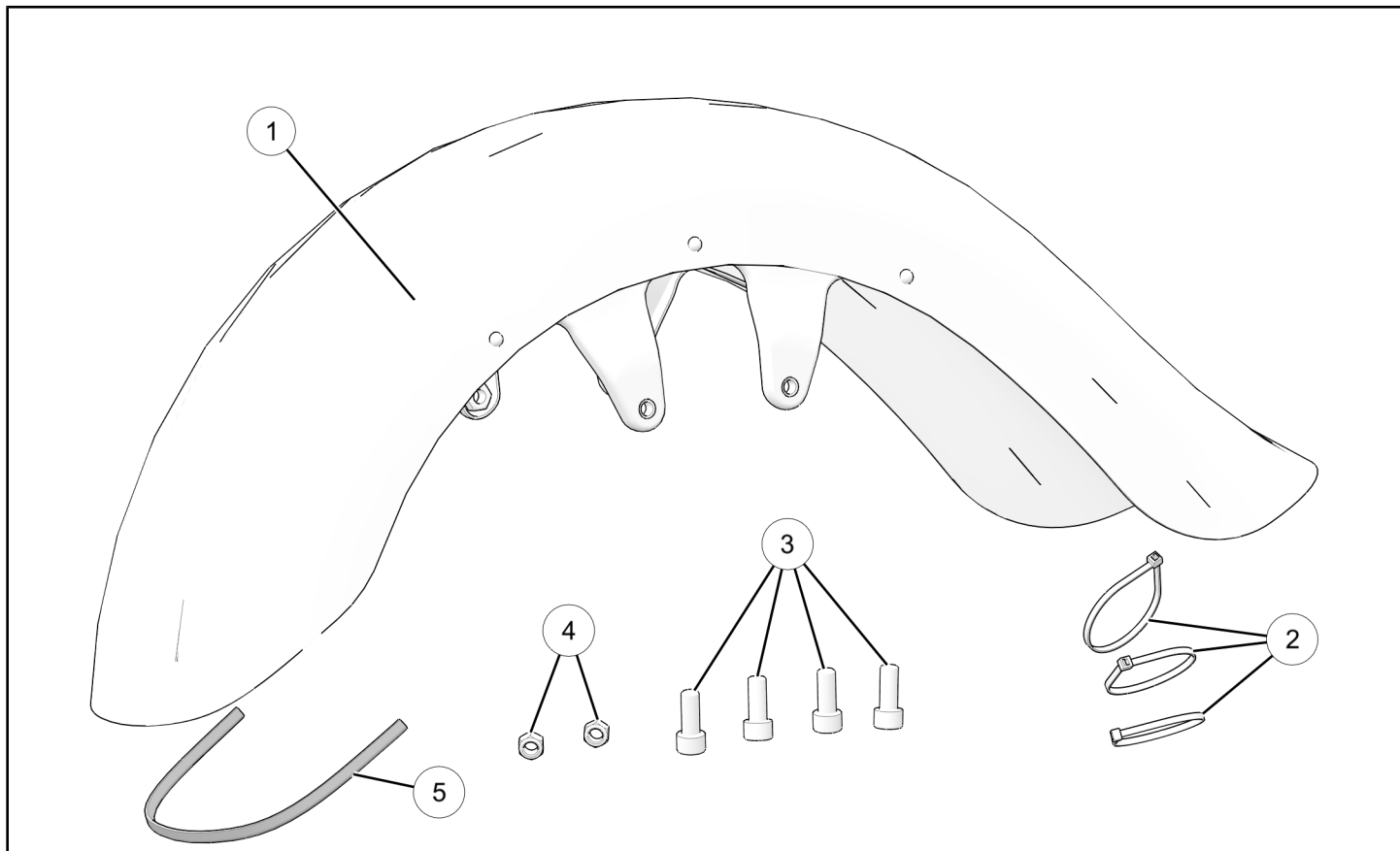

### NOTE

XXX = Indian® Color code (For Example: 266 = Black)

REF	QTY	PART DESCRIPTION	PART NUMBER
1	1	Fender, Trimmed, Front,	1023049-XXX
2	3	Cable Tie	7080138
3	4	Screw, Hex Bit Head, M10 X 1.25 X 25	7517990
4	2	Nut, Hex, Locking, M8 X 1.25	7547673
5	1	Trim-Edge, Fender, Intl.	8360149
	1	Instructions	9927925

## TOOLS REQUIRED

- Safety Glasses
- Socket Set, Hex Bit, Metric
- Socket Set, Metric
- Torque Wrench
- Wrench Set, Metric

## IMPORTANT

Your Indian Front Fender Kit is exclusively designed for your vehicle. Please read the installation instructions thoroughly before beginning. Installation is easier if the vehicle is clean and free of debris. For your safety, and to ensure a satisfactory installation, perform all installation steps correctly in the sequence shown.

## ASSEMBLY TIME

Approximately 18 minutes

## INSTALLATION INSTRUCTIONS

1. Turn ignition switch to "OFF" position and remove key fob from vehicle proximity.
2. Ensure motorcycle is parked on a flat surface, kickstand is fully extended, and vehicle is stable prior to installation.
2. Locate and remove cable ties that retain front fender light harness to brake line. Turn handlebar to right-most position to access wiring located in fairing. Disconnect fender light wire harness connector.
3. Remove three screws ① on each side of front fender ②. Retain screws for reassembly.

## FENDER REMOVAL

1. On right side of front fender, remove two acorn nuts ① and washers ②. Remove bolt ③ from under caliper cover and remove caliper cover. Repeat procedure for left side of front fender.

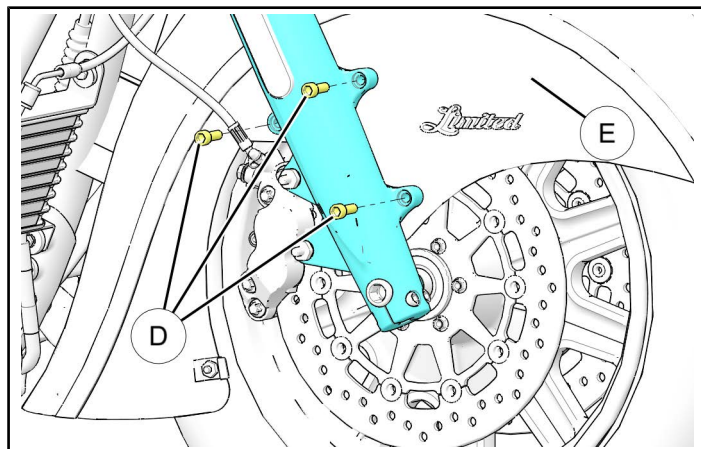
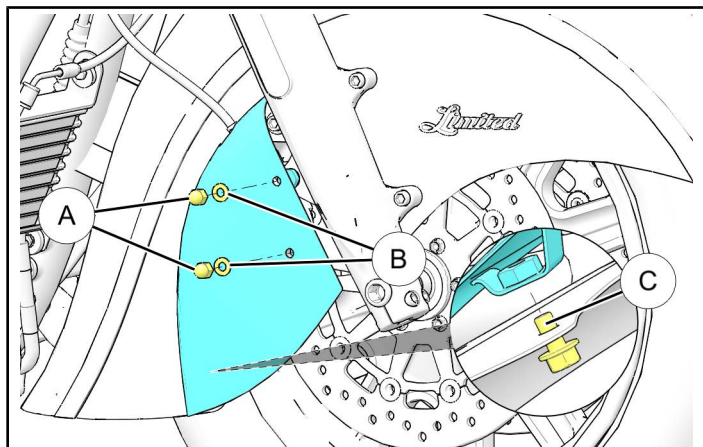

4. Stand in front of motorcycle facing front fender ⑤. Squeeze sides together while “rolling” fender out from fork legs.

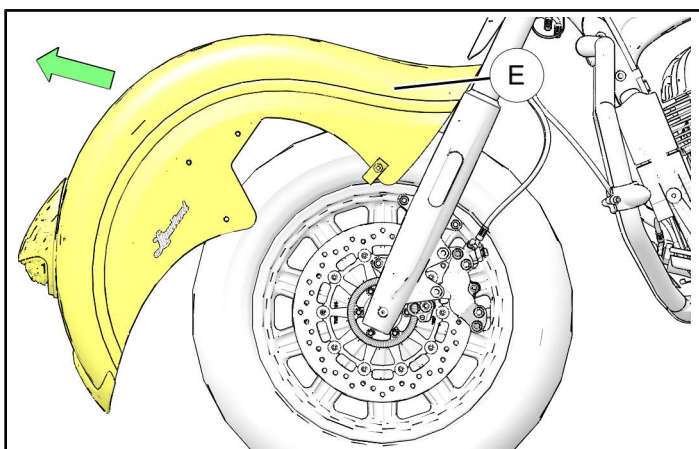
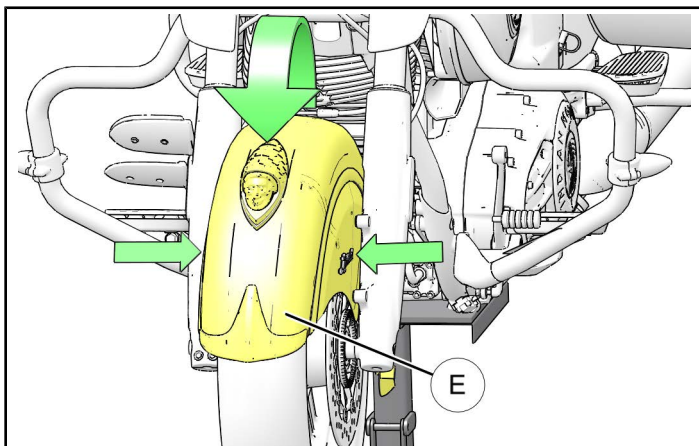

## FENDER INSTALLATION

1. Roll new fender ① into place and align mounting holes. Loosely install fender with four retained fasteners ④.

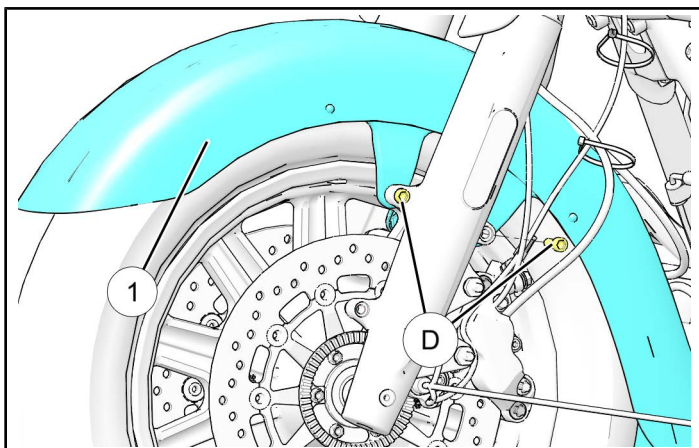

2. Align fender and torque four fasteners ④ to specification.

### TORQUE

18 ft. lbs. (24 Nm)

3. Install two retained fasteners ④ in lower holes on fork with included nut ④. Counter-hold nut ④ and torque fastener ④ to specification.

### TORQUE

18 ft. lbs. (24 Nm)

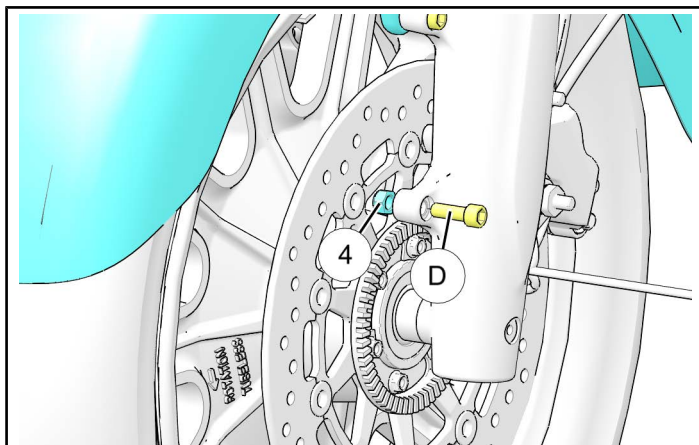

4. On right side of front fork, one at a time, remove caliper studs ⑥ and replace with included fasteners ③. Torque fasteners to specification. Repeat step for left side.

### TORQUE

35 ft. lbs. (48 Nm)

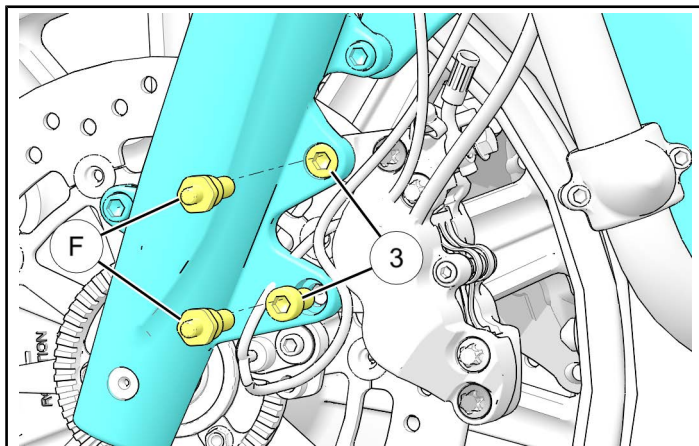

5. Replace cut cable ties to secure speed sensor harness to brake line, away from moving parts.

6. **EUROPEAN MODELS ONLY:** Install Rubber Trim ⑤ on front lip of fender ① as shown.

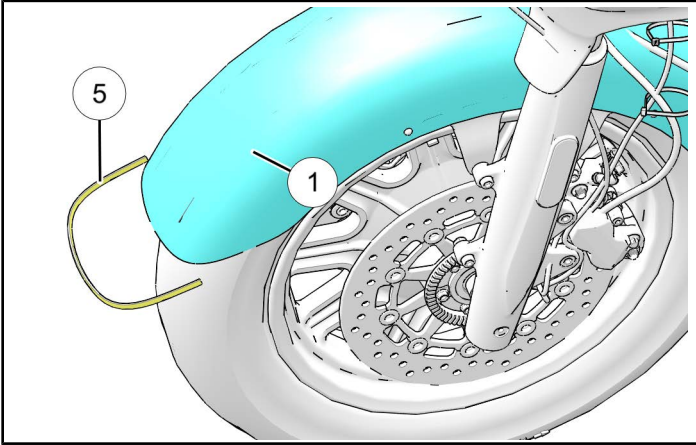

### FEEDBACK FORM

A feedback form has been created for the installer to provide any comments, questions or concerns about the installation instructions. The form is viewable on mobile devices by scanning the QR code or by clicking [HERE](#) if viewing on a PC.

#### FEEDBACK FORM

