

BRAKE AND SHIFT LEVERS KIT BY ROLAND SANDS DESIGN®



P/N 2884091

INTERNATIONAL INSTRUCTIONS

DE DEUTSCH

Laden Sie die neuesten PDF-Anweisungen von www.indianmotorcycle.de herunter.

FR FRANÇAIS

Télécharger les dernières instructions en format PDF sur www.indianmotorcycle.fr.

IT ITALIANO

Scarica l'ultima versione delle istruzioni in formato PDF da www.indianmoto.it.

EN ENGLISH

Download the latest PDF instructions from www.indianmotorcycle.com.

ES ESPAÑOL

Descargue las instrucciones más recientes en formato PDF de www.indianmotorcycle.mx / www.indianmotorcycle.es.

ZH 中文

从www.indianmotorcycle.cn 下载最新的PDF说明。

1

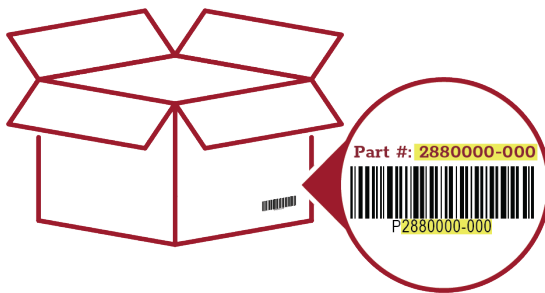

2



3



4

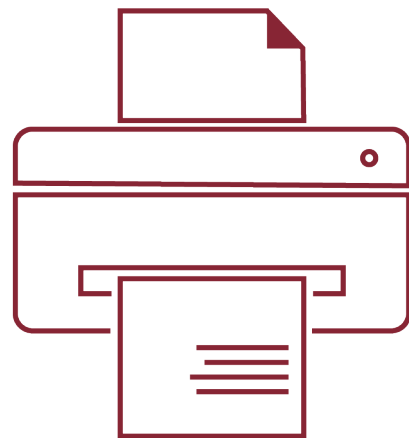

APPLICATION

Verify accessory fitment at www.indianmotorcycle.com.

BEFORE YOU BEGIN

Read these instructions and check to be sure all parts and tools are accounted for. Please retain these installation instructions for future reference and parts ordering information.

KIT CONTENTS

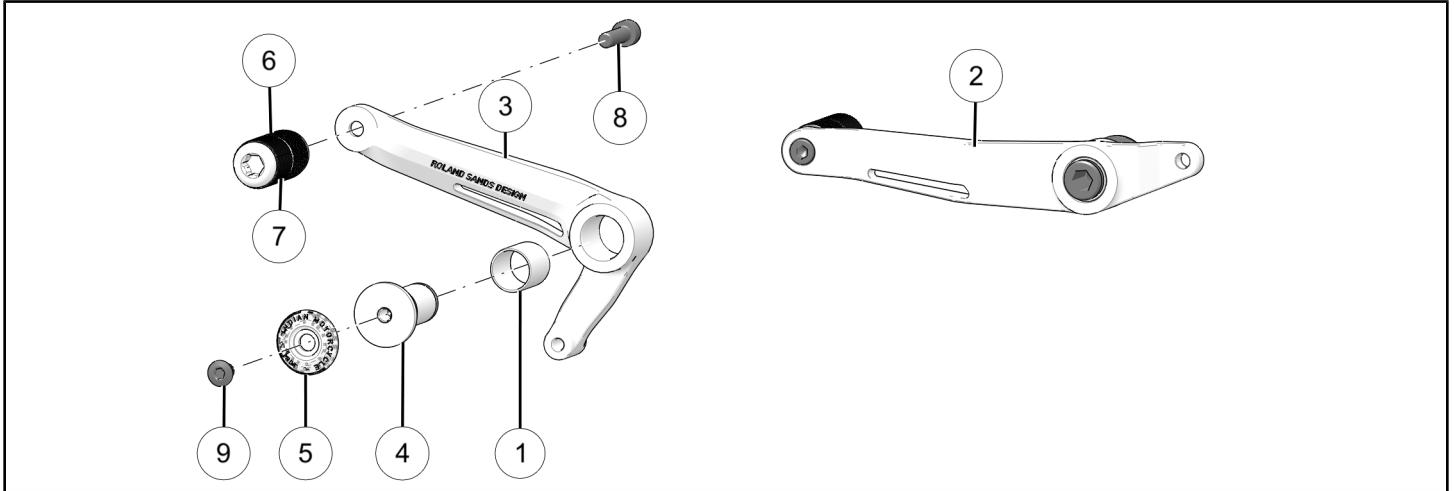

REF	QTY	PART DESCRIPTION	P/N AVAILABLE SEPARATELY
1	2	Bushing, 18 mm x 15 mm x 20 mm	n/a
2	1	Pedal-Brake, Roland Sands Design®	n/a
3	1	Pedal-Shifter, Roland Sands Design®	n/a
4	2	Screw-Shoulder, Pivot, Roland Sands Design®	n/a
5	2	Cap, Pivot, Pin, Roland Sands Design®	n/a
6	2	Sleeve, Shift, Brake, Roland Sands Design®	n/a
7	2	Toe Peg, Rubber, Roland Sands Design®	n/a
8	2	Screw-Socket Head, M6 x 1.0 x 20	7521108
9	2	Screw-Shoulder, M6 x 1.0 x 8	7521109
	1	Instructions	9929453

TOOLS REQUIRED

- Safety Glasses
- Hex Key Set, Metric
- Pliers, Retaining Ring
- Socket Set, Hex Bit, Metric
- Socket Set, Metric
- Torque Wrench

CONSUMABLES REQUIRED

- Loctite® 262
- Grease, Polaris® All Season (or equivalent)

IMPORTANT

Your accessory kit is exclusively designed for your vehicle. Please read the installation instructions thoroughly before beginning. Installation is easier if the vehicle is clean and free of debris. For your safety, and to ensure a satisfactory installation, perform all installation steps correctly in the sequence shown.

INSTALLATION INSTRUCTIONS

VEHICLE PREPARATION

GENERAL

1. Turn key or ignition switch to OFF position and remove key.
2. Ensure motorcycle is parked on a flat surface, kickstand is fully extended, and vehicle is stable prior to installation.

FOOT CONTROLS REMOVAL

FOOT CONTROLS (SHIFTER) REMOVAL

1. Remove and retain front shift rod bolt (A).

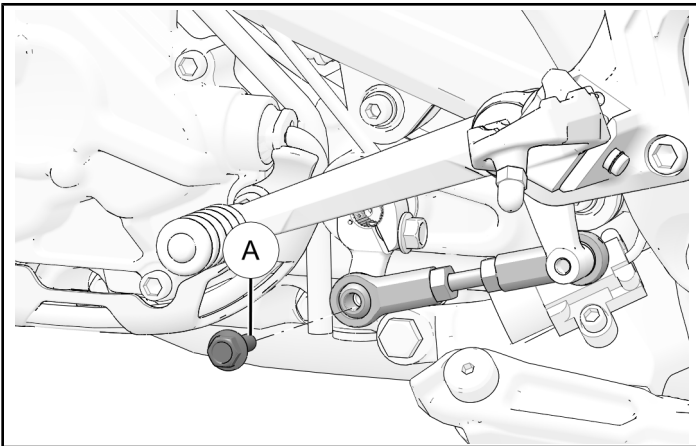

2. Remove two foot peg bracket bolts (B) and remove bracket from motorcycle.

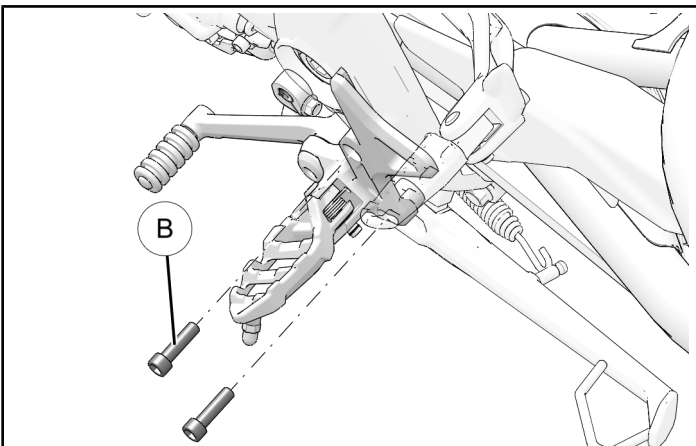

3. Remove and retain rear shift rod bolt (C).

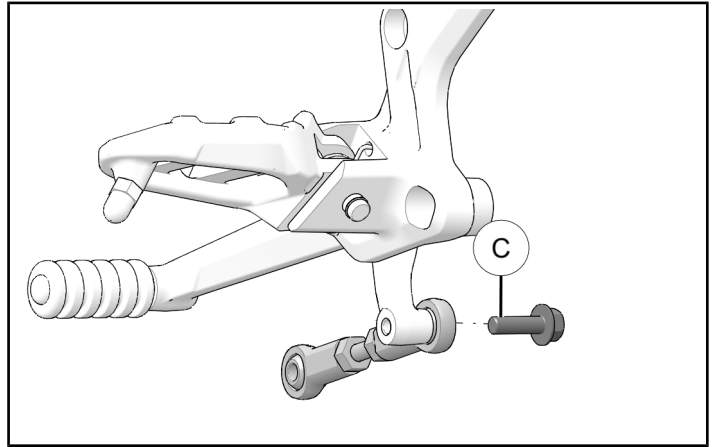

FOOT CONTROLS (BRAKE) REMOVAL

⚠ WARNING

Support and level master cylinder. Failure to keep brake reservoir upright may allow fluid leakage or air to enter brake system causing reduced brake performance or brake failure, resulting in personal injury or death.

1. Remove collar clip from clevis and slide clevis pin (A) towards motorcycle to remove.

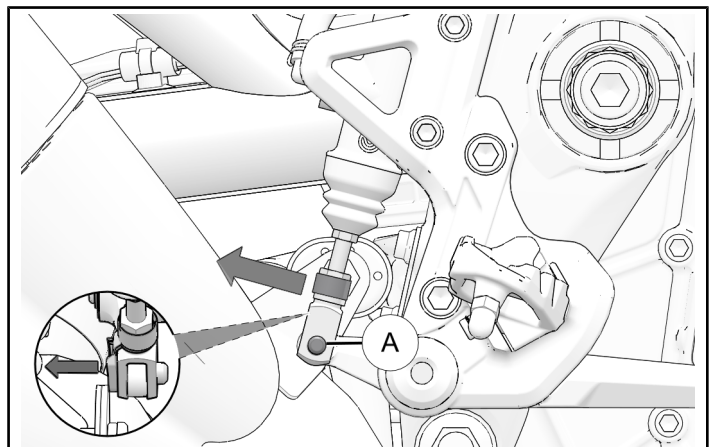

- Remove and retain two master cylinder bolts (B) and two foot peg bolts (C) to remove foot peg bracket. Ensure master cylinder is kept upright after foot peg removal.

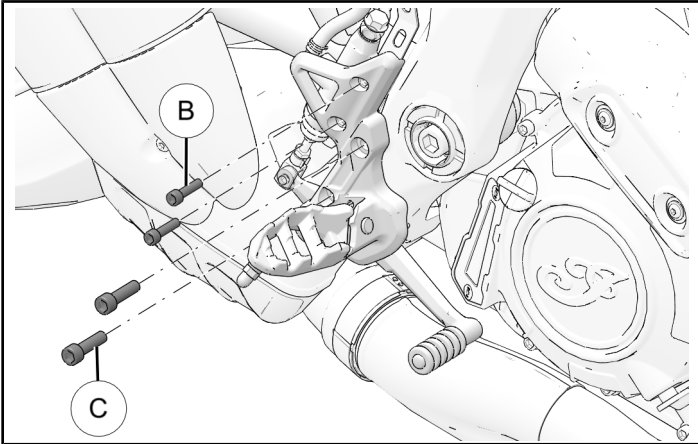

ACCESSORY INSTALLATION

SHIFTER INSTALLATION

- Remove retaining ring (A) from shoulder screw (B) to remove shifter pedal. Retain washers (C) and (D).

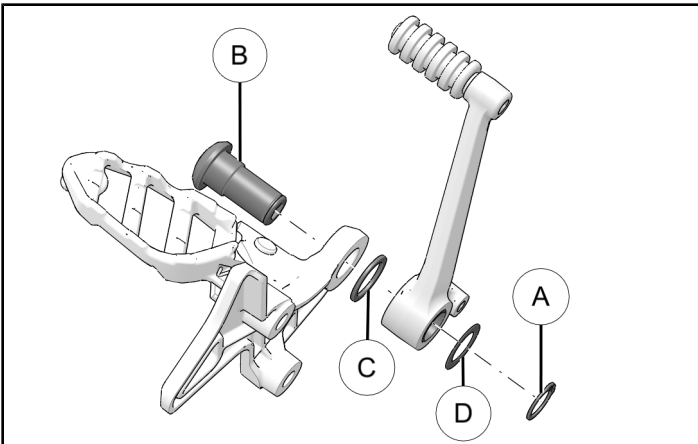

- Install shoulder screw (4) onto foot peg bracket.

TORQUE

Shoulder Screw (4):
50 ft-lbs (68 N·m)

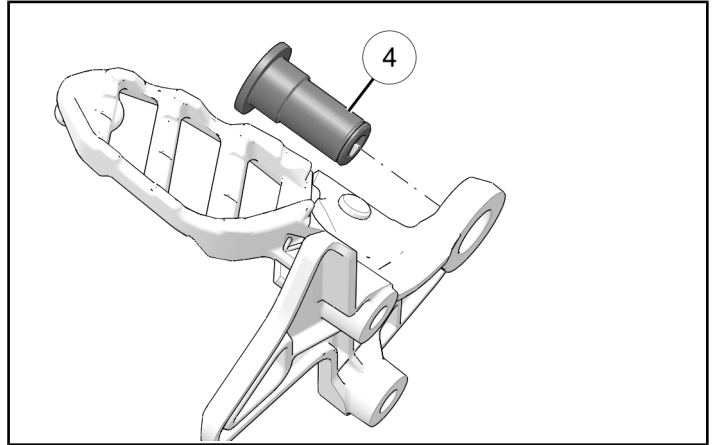

- Apply grease to shaft of shoulder screw.

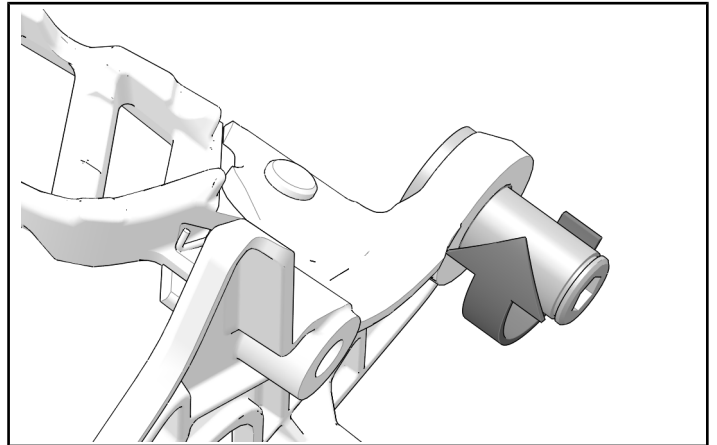

- Assemble wave washer (C), shifter pedal (3), and washer (D) onto shoulder screw. Secure with retaining ring (A).

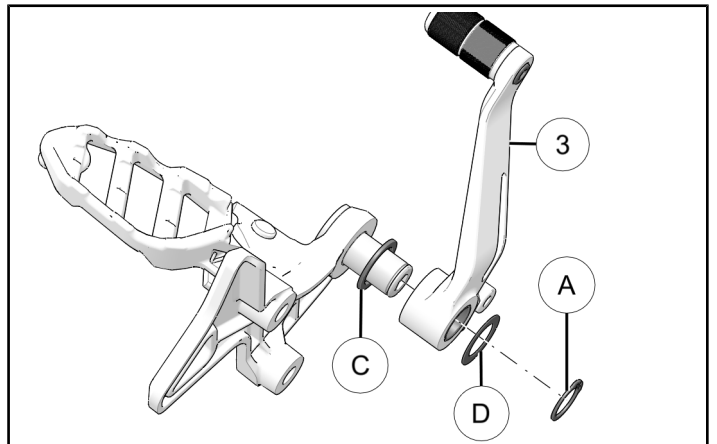

5. Apply Loctite® 262 to screw ⑨ before securing pin cap ⑤.

TORQUE

Pin Cap Screw ⑨:
5-10 in-lbs (0.6-1 N·m)

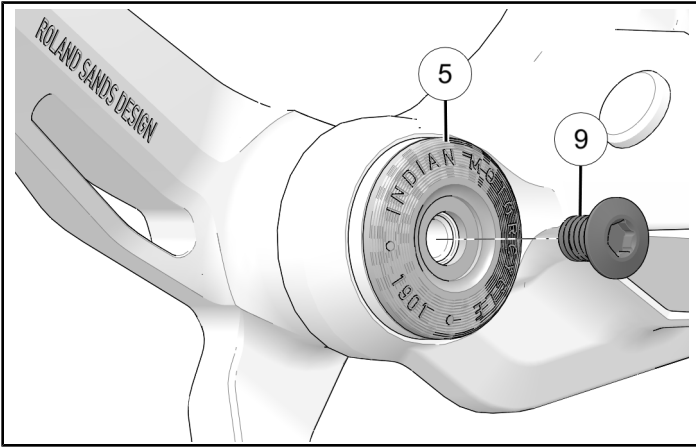

6. Reinstall shift linkage to shift pedal with fastener ③.

TORQUE

Shift Rod Fastener ③:
88 in-lbs (10 N·m)

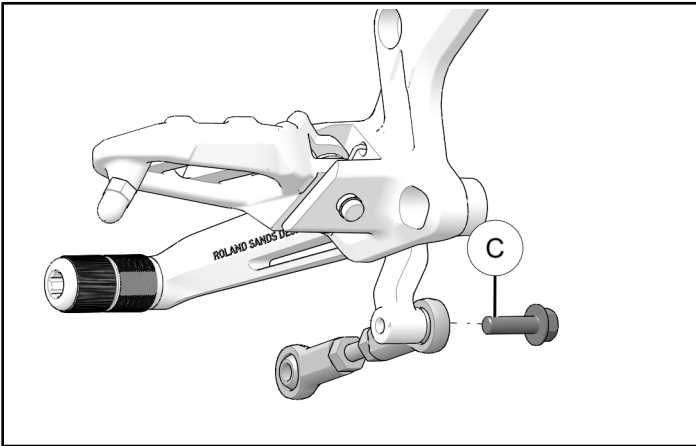

7. Reinstall foot peg bracket with two retained foot peg fasteners ②.

TORQUE

Foot Peg Fasteners ②:
17 ft-lbs (23 N·m)

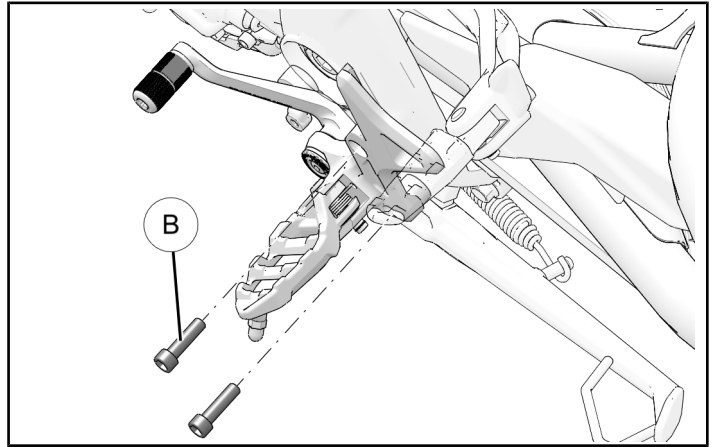

8. Reinstall shift rod to shift lever with fastener ①.

TORQUE

Shift Rod Fastener ①:
88 in-lbs (10 N·m)

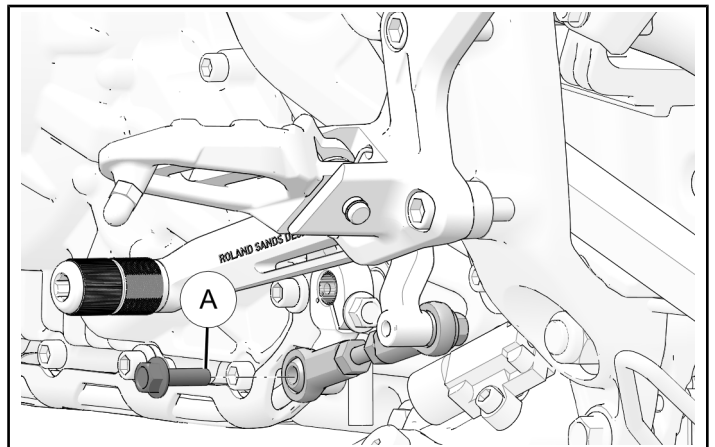

BRAKE INSTALLATION

1. Remove retaining ring (A) from shoulder screw (B) to remove shifter pedal. Retain washer (D).

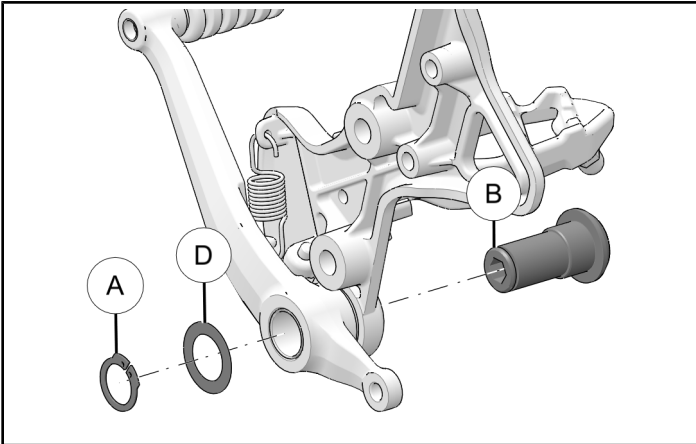

2. Unhook spring from brake pedal and retain washer (C).

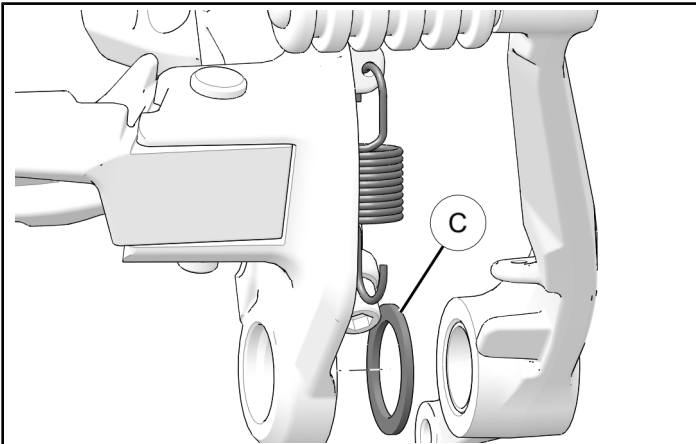

3. Install shoulder screw (4) to foot peg bracket.

TORQUE

Shoulder Screw (4):
50 ft-lbs (68 N·m)

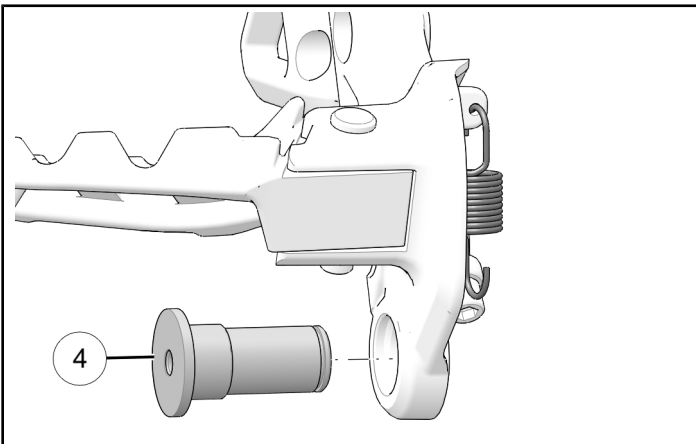

4. Apply grease to shaft of shoulder screw.

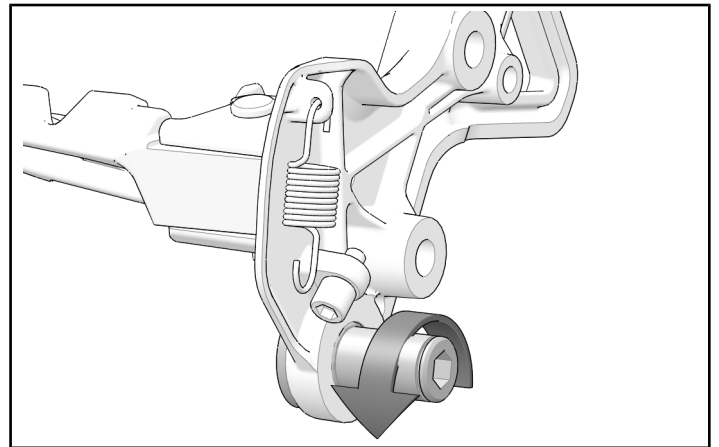

5. Assemble wave washer (C) and shifter pedal (2) onto shoulder screw. Hook spring onto brake pedal in orientation shown.

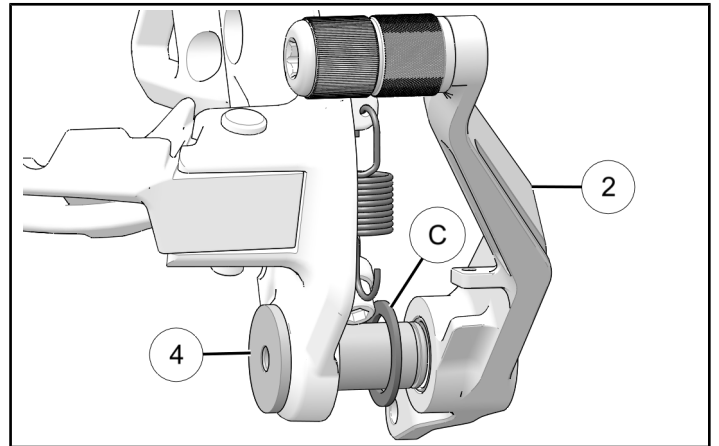

6. Secure brake pedal with washer (D) and retaining ring (A).

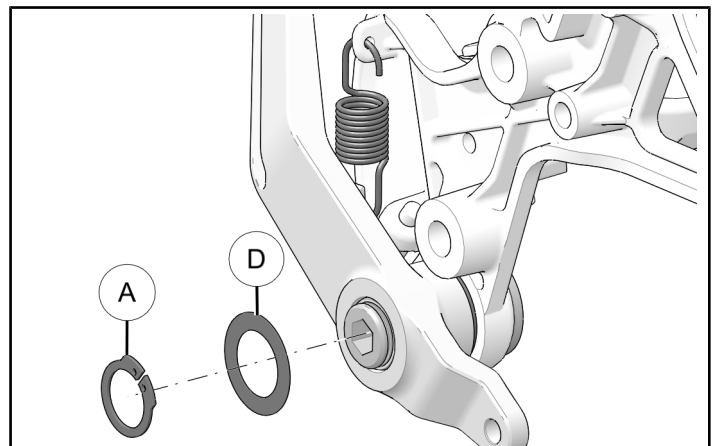

7. Apply Loctite® 262 to screw ⑨ before securing pin cap ⑤.

TORQUE

Pin Cap Screw ⑨:
5-10 in-lbs (0.6-1 N·m)

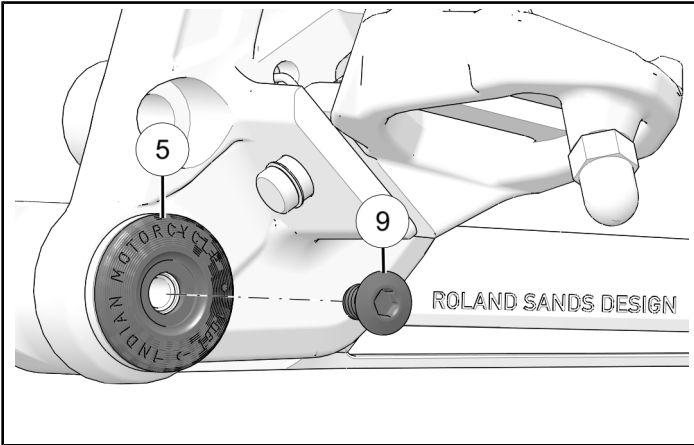

8. Reinstall master cylinder clevis to pedal with bolt ①.

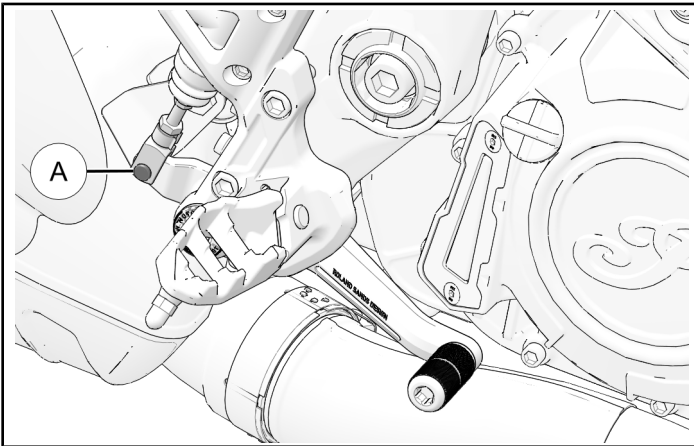

9. Align foot peg with master cylinder and reinstall foot peg with two master cylinder mounting fasteners ② and two foot peg fasteners ③.

TORQUE

Foot Peg Fasteners (driver) ③:
17 ft-lbs (23 N·m)

TORQUE

Master Cylinder Mounting Fasteners (rear) ②:
84 in-lbs (9 N·m)

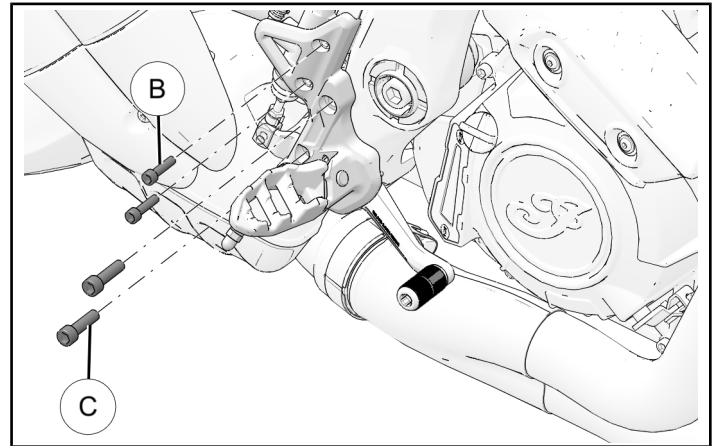

FEEDBACK FORM

A feedback form has been created for the installer to provide any comments, questions or concerns about the installation instructions. The form is viewable on mobile devices by scanning the QR code or by clicking [HERE](#) if viewing on a PC.

