

SCOUT GRIP KIT



P/N 2882520

APPLICATION

Indian Scout Motorcycles

BEFORE YOU BEGIN

Read these instructions and check to be sure all parts and tools are accounted for. Please retain these installation instructions for future reference and parts ordering information.

KIT CONTENTS

This kit is intended to be installed in conjunction with Mirror Kit PN 2882422-463 or equivalent (sold separately).

This Kit includes:

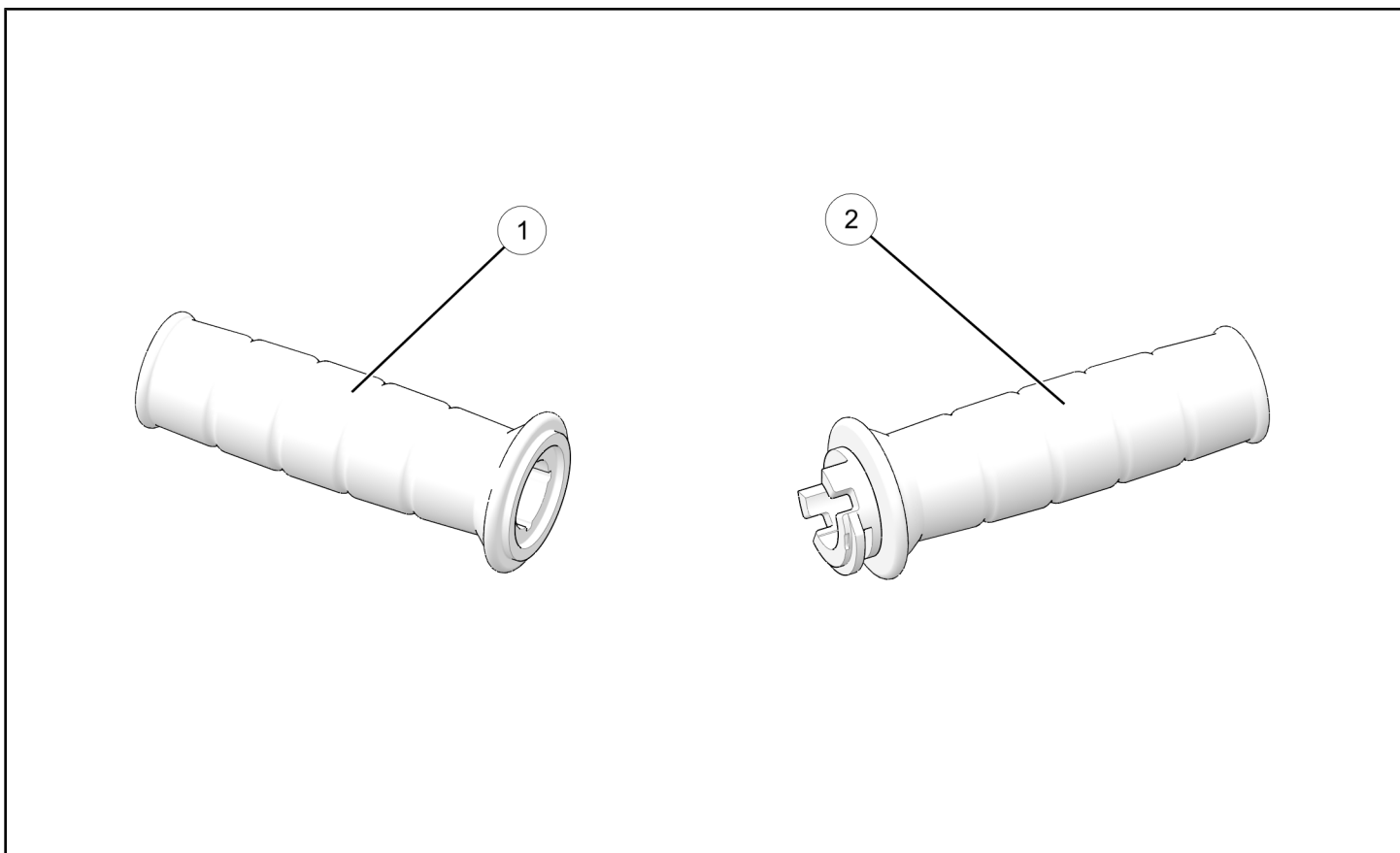

REF	QTY	PART DESCRIPTION	PART NUMBER
1	1	Grip, LH	5416129
2	1	Grip, RH	5416130
3	1	Adhesive, Grip (Not shown)	2882308
	1	Instructions	9927772

TOOLS REQUIRED

- Safety Glasses
- Screwdriver, Slotted
- Wrench, Strap

- Socket Set, Torx® Bit
- Torque Wrench

CONSUMABLES REQUIRED

- Adhesive Solvent

IMPORTANT

Your Indian Scout Grip Kit is exclusively designed for your vehicle. Please read the installation instructions thoroughly before beginning. Installation is easier if the vehicle is clean and free of debris. For your safety, and to ensure a satisfactory installation, perform all installation steps correctly in the sequence shown.

ASSEMBLY TIME

Approximately 24 minutes

INSTALLATION INSTRUCTIONS

1. Turn key to “OFF” position and remove from vehicle.
2. Ensure motorcycle is parked on a flat surface, kickstand is fully extended, and vehicle is stable prior to installation.
3. On front side of left grip cover, remove two screws **A** and remove switch housing **B**. Retain all parts for reinstallation.

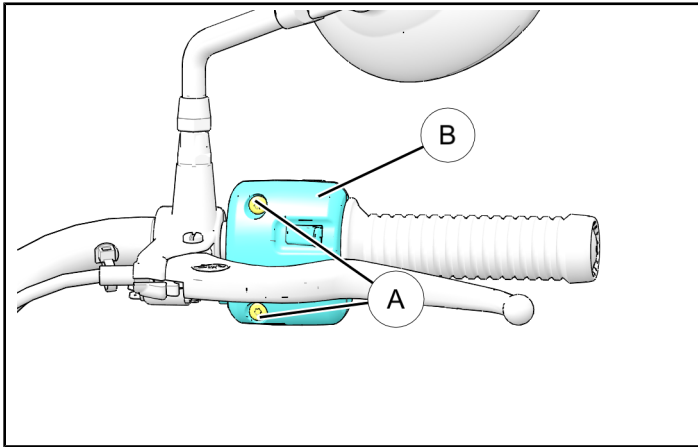

⚠ WARNING

Follow all chemical manufacturer instructions and safety precautions. Failure to follow all manufacturer instructions and precautions may result in severe injury or death.

4. Remove left grip **C** by gently inserting a slotted screwdriver between grip and handlebar to release adhesive. Adding a small amount of adhesive solvent will help loosen adhesive.

NOTE

Be careful not to get solvent on any painted surfaces.

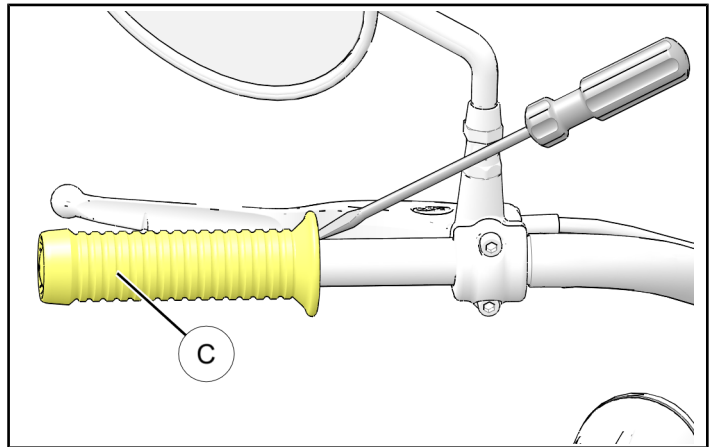

5. Firmly grasp left grip ③ and remove it from handlebar.

NOTE

Strap wrench or compressed air can be used to assist in removal.

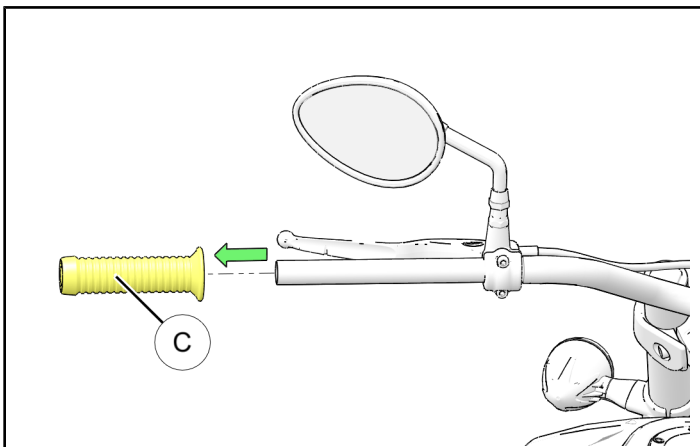

6. Remove any adhesive residue or grip material from handlebar.
7. Reinstall switch housing ② and torque bolts ④ to specification

TORQUE

36 in. lbs. (4Nm)

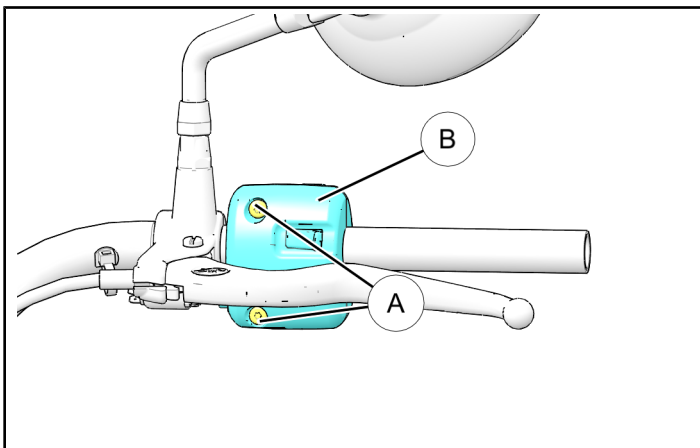

8. Apply supplied adhesive ③ to handlebar end covering as much as possible and distributing adhesive evenly. Quickly force left grip ① onto handlebar until grip bottoms out against handlebar end. Quickly rotate grip to desired rotation before adhesive sets.

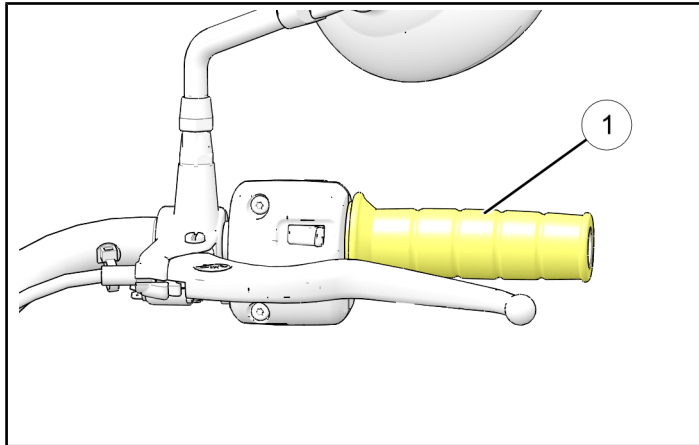

9. On front side of right grip, remove four screws ④, and remove back side of switch housing ⑤.

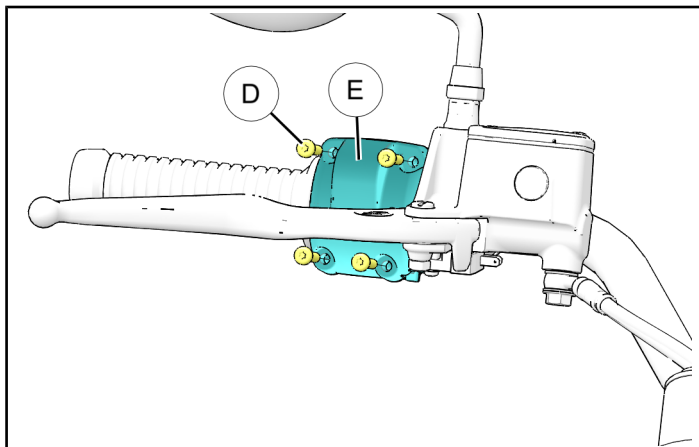

10. Separate right switch housing halves and slide right grip and throttle tube ⑥ off handlebar.

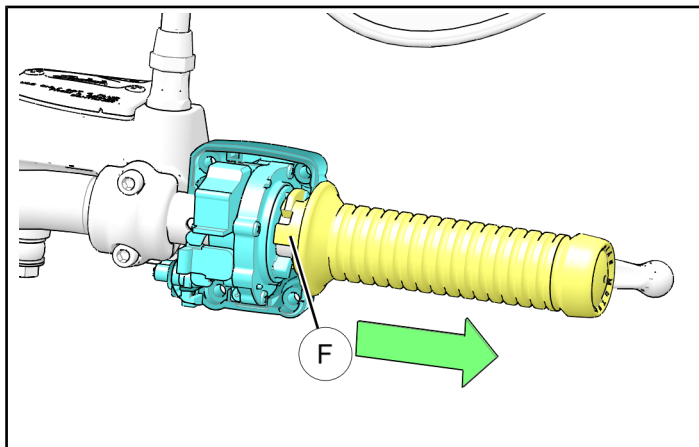

11. Install new Right grip ② on handlebar. Ensure slots in throttle tube ⑥ line up to throttle housing.

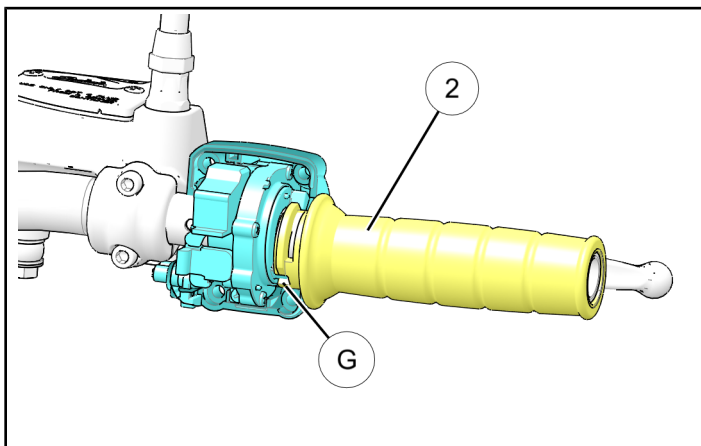

12. Reinstall back side of switch housing ⑤ and four screws ④. Torque screws to specification.

TORQUE

36 in. lbs. (4 Nm)

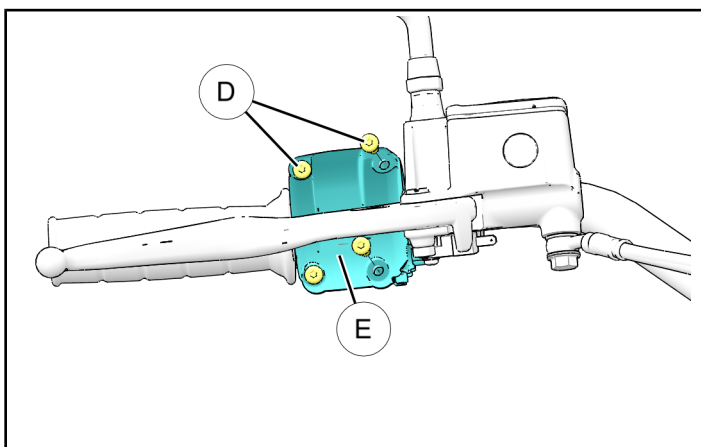

13. Cycle throttle after reassembly to confirm it moves freely and does not bind.

IMPORTANT

Allow motorcycle to sit for a period of 24 hours to allow glue to dry and set properly.