

CLUTCH RAM® MOUNT KIT



P/N 2880920

APPLICATION

Verify accessory fitment at www.indianmotorcycle.com.

BEFORE YOU BEGIN

Read these instructions and check to be sure all parts and tools are accounted for. Please retain these installation instructions for future reference and parts ordering information.

KIT CONTENTS

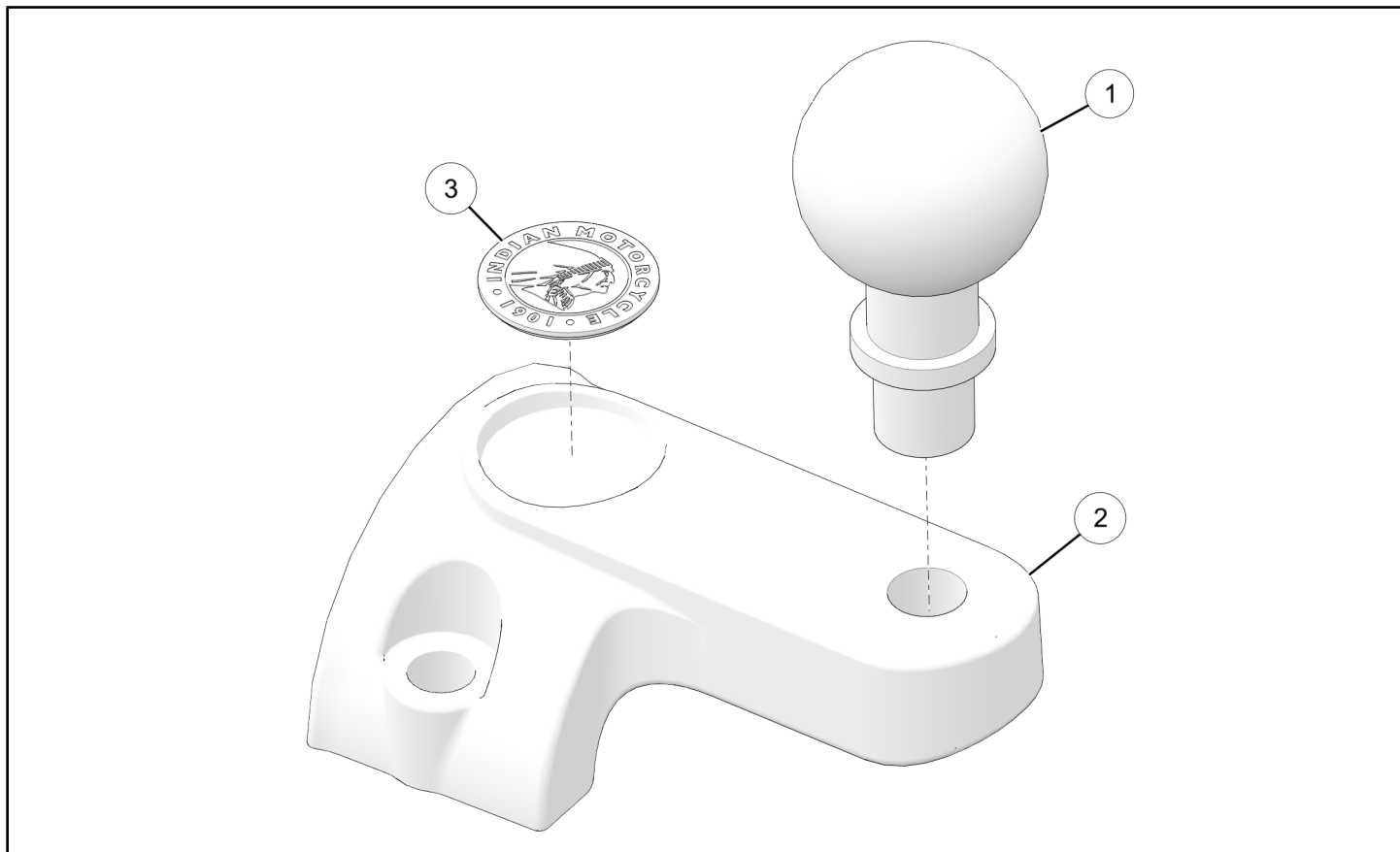

REF	QTY	PART DESCRIPTION	P/N AVAILABLE SEPARATELY
1	1	M10 Ball Mount	-
2	1	Clamp - Clutch Mount, RAM®	-
3	1	Plate - Emblem, Dipstick	5257416

TOOLS REQUIRED

- Safety Glasses
- Socket Set, Torx® Bit
- Torque Wrench

IMPORTANT

Your Indian Motorcycle® Clutch RAM® Mount Kit is exclusively designed for your vehicle. Please read the installation instructions thoroughly before beginning. Installation is easier if the vehicle is clean and free of debris. For your safety, and to ensure a satisfactory installation, perform all installation steps correctly in the sequence shown.

INSTALLATION INSTRUCTIONS

VEHICLE PREPARATION

GENERAL

1. Turn key or ignition switch to **OFF** position and remove key. If equipped with keyless fob, remove fob from proximity of vehicle.
2. Ensure motorcycle is parked on a flat surface, kickstand is fully extended, and vehicle is stable prior to installation.

RAM® MOUNT INSTALLATION

1. Remove and retain two screws (A) from stock clamp (B).

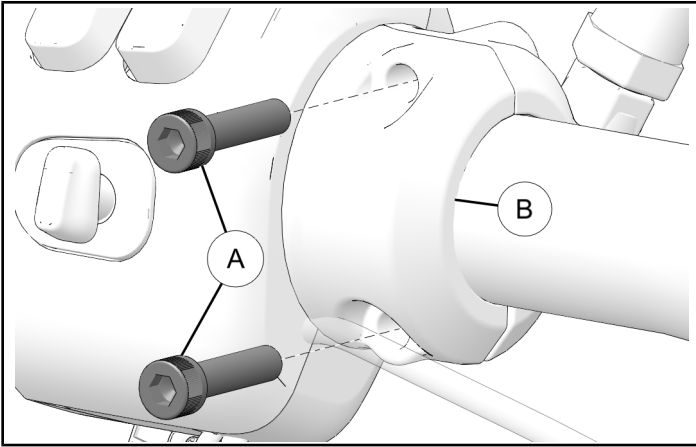

2. Remove and discard stock clutch clamp (B).

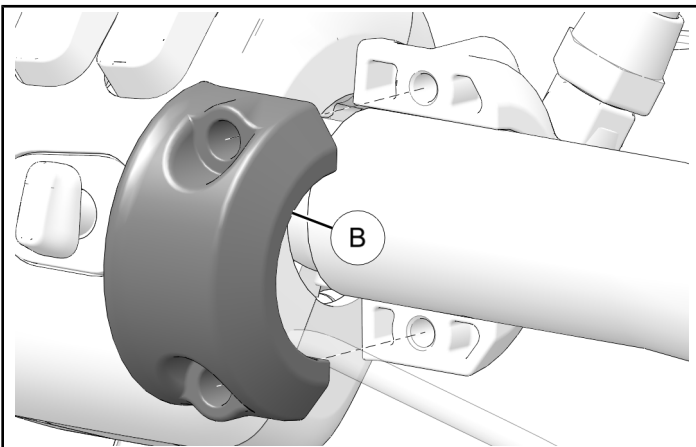

3. Thread RAM® ball mount (1) into RAM® clutch mount (2) as shown.

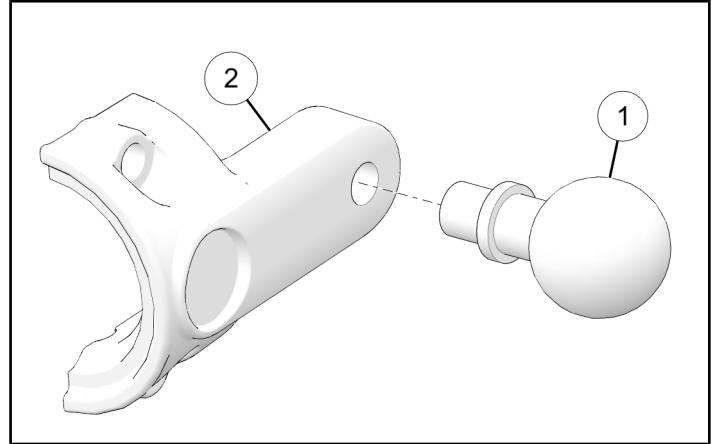

4. Orient RAM® mount assembly (C) with ball mount facing gauge cluster. Install and torque retained screws (A) to specification

TORQUE

Clamp Screws (A):
70 in-lbs (7.9 N·m)

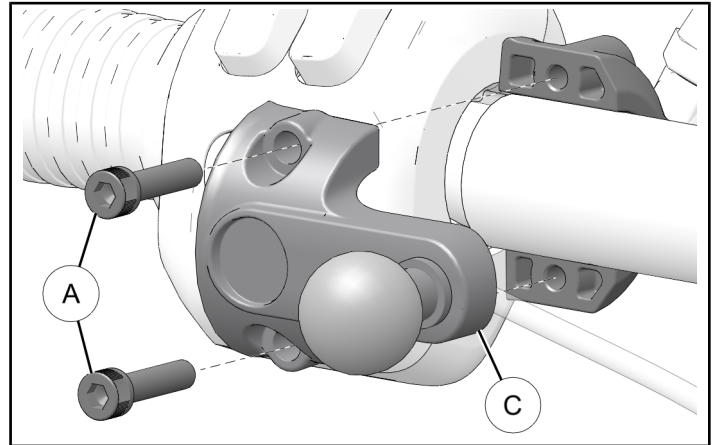

5. Remove paper backing from RAM® mount emblem ③. Ensure proper orientation and adhere emblem to RAM® mount assembly ④ as shown. Apply even pressure for 30 seconds to activate adhesive.

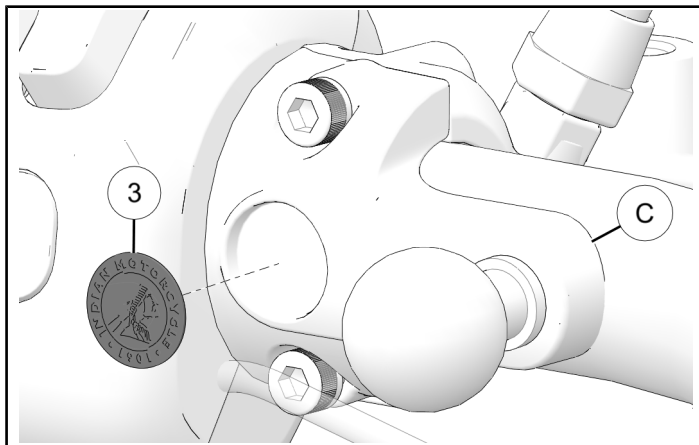

FEEDBACK FORM

A feedback form has been created for the installer to provide any comments, questions or concerns about the installation instructions. The form is viewable on mobile devices by scanning the QR code or by clicking [HERE](#) if viewing on a PC.

