

INDIAN SPRINGFIELD MINI APE

HANDLEBAR KIT

P/N 2880968; 2881313



APPLICATION

MY16 CRUISER AND BAGGERS - ORDER KIT # 2880968 (WITH CLUTCH LINE)

MY14 AND 15 CRUISERS AND BAGGERS - ORDER KIT # 2881313 (WITH CLUTCH AND BRAKE LINE)

NOTE: Starting in MY16, the longer brake line is included as stock. The kit is not designed for bikes with front fairings.

⚠ WARNING

This accessory is only approved for use with the models listed. **NEVER** use this accessory on non-approved models. Use of this accessory on models other than those listed in these instructions may negatively affect the stability of the vehicle, lead to loss of control, and result in serious injury or death.

For MY14 and 15 vehicles, it is highly recommended to have the dealer replace the brake line. The line is part of the safety-critical brake system, and replacement is complicated.

BEFORE YOU BEGIN

Read these instructions and check to be sure all parts and tools are accounted for. Please retain these installation instructions for future reference and parts ordering information.

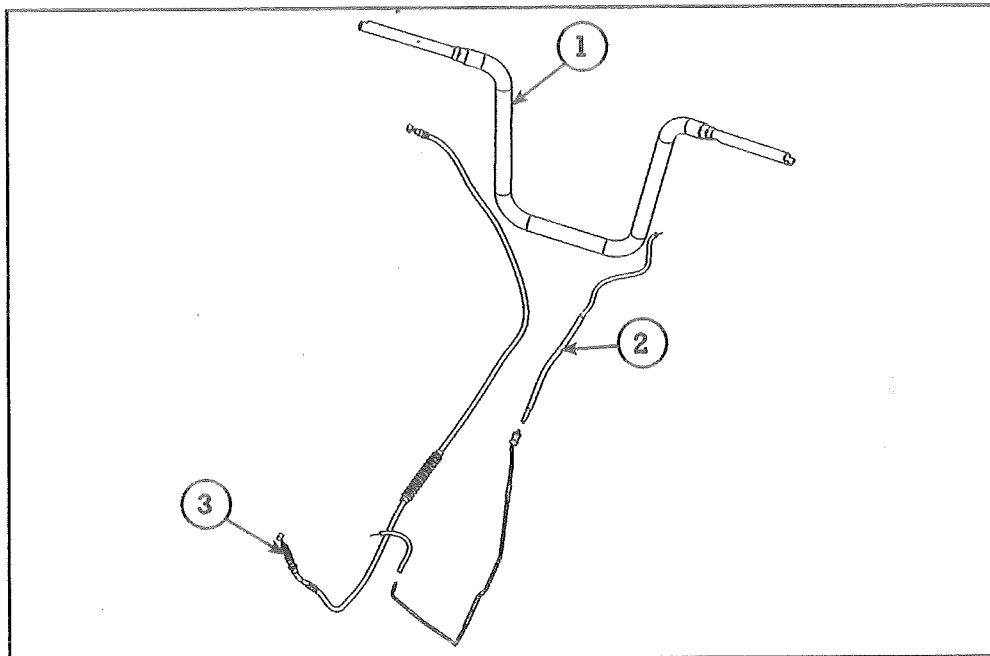

KIT CONTENTS

Ref	Qty	Part Description	Part Number
1	1	Cruiser Mini Ape Handle Bar	1021176
2	1	Front Brake Hose (For Kit 2881313 only)	1912487
3	1	Clutch Cable	7082079
	2	Panduit Nylon Strap	7081504
	1	Instructions	9925946

TOOLS NEEDED

Side Cutters	Extension	Ratchet
6 mm Hex Key Socket	Torque Wrench	T25 Torx Bit
#1 Phillips Screwdriver	Bench Vise (Optional)	Dental Pick
Electrical Tape (Optional)	4 mm Hex Key Socket	Protective Cloth
Digital Camera (Optional)	#2 Phillips Screwdriver	5 mm Hex Key Ball End Socket

APPROXIMATE ASSEMBLY TIME

90 min

IMPORTANT

Your INDIAN MINI APE HANDLEBAR KIT is exclusively designed for your vehicle. Please read the installation instructions thoroughly before beginning. Installation is easier if the vehicle is clean and free of debris. For your safety, and to ensure a satisfactory installation, perform all installation steps correctly in the sequence shown.

INSTALLATION INSTRUCTIONS

NOTE: Protect all finished surfaces during these operations.

Front Bodywork Removal (retain all fasteners, covers, clamps for re-assembly)

1. If applicable, remove windshield.
2. Remove two M6 button head screws (A) from the top of the headlight housing as shown in figure.

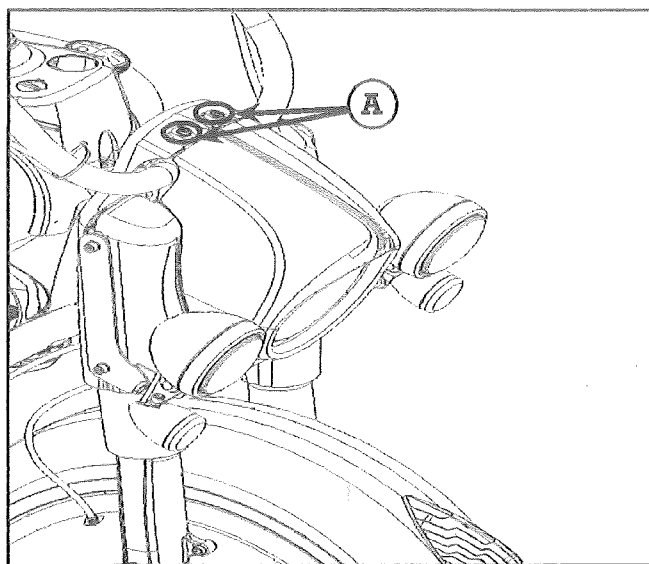

3. Support headlight housing and remove four M6 cap screws (B) and washers retaining the headlight housing from inside of the upper fork cover. A 5 mm ball end hex socket will be required for removal of the upper fasteners. See figure.
4. Remove the sealing boot. Press the looped end of the wire bulb retainer clip and swing the end toward the center of the bulb to release it from the latch tab. With the wire connector attached, pull the bulb out and protect. Do not disconnect the wire harness.

NOTE: Avoid touching a halogen lamp with bare fingers. Oil from your skin leaves a residue, causing a hot spot that will shorten the life of the lamp. If a lamp is touched, clean it thoroughly with denatured alcohol.

5. Remove the four M8 cap screws (C) and washers (D) retaining the upper fork covers to the forks, slide out two driving light wire rubber grommets (E) from front upper fork cover, and remove the driving light/mount assembly as shown in figure. Carefully rest driving light/mount assembly above front fender.

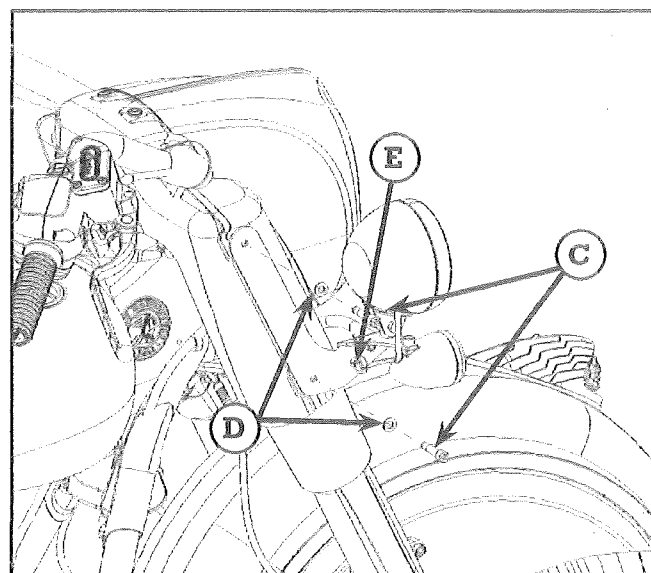
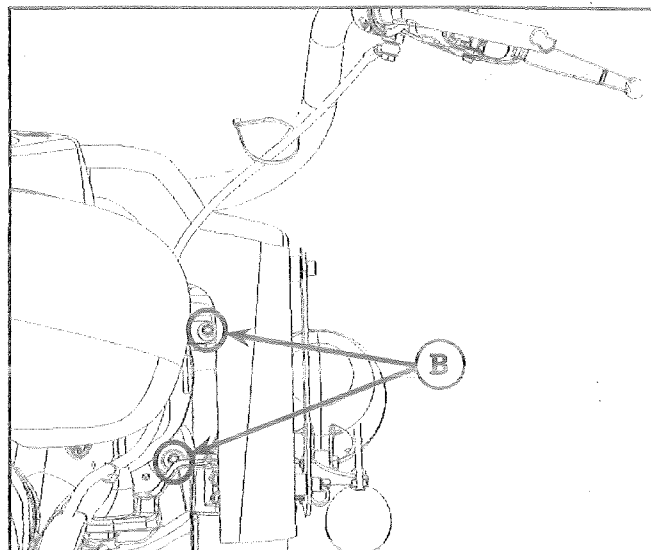

6. Remove two M6 button head screws (F) from front and rear of fuel tank console. Existing console wire terminals and leather strap do not need to be disconnected. Position console off to the side of fuel tank. Retain screws for re-assembly. See figure.
7. Using a dental pick, depress the lock tab and disconnect wire terminal from driving light switch that is mounted to the rear upper fork cover. See figure of Step 3 and 4 in Front Bodywork Removal section. Remove the rear upper fork cover.

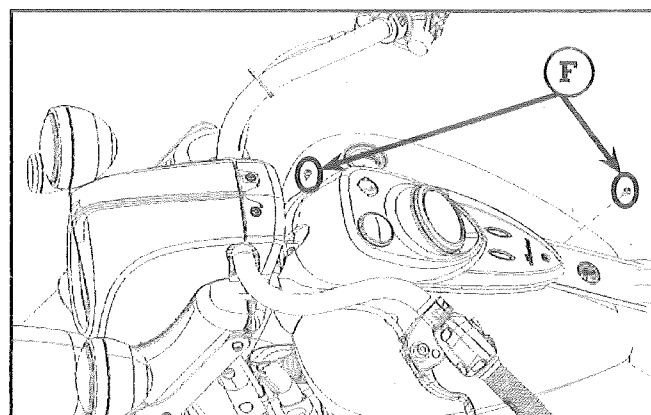

8. Trace the wiring exiting the center of the handlebars and cut the nylon straps containing the handlebar wiring bundles with side-cutters.

NOTE: Take photos of the wire routing from a front view and a rear view for reference during re-assembly.

9. To make certain wiring is plugged into the correct terminal during re-assembly, ensure the wiring is labeled on each terminal. There are a total of six terminals coming from the handlebars (four right hand / two left hand).

NOTE: Left and right hand wiring have identical terminals and should be labeled accordingly. Mark terminals as a matched pair if missing from vehicle.

10. With a dental pick, depress lock tab and disconnect all wire terminals that route into the handlebars.

Handlebar Removal (retain all fasteners, covers, clamps for re-assembly)

11. Using your thumb, deflect the rubber flange of the left hand grip next to the switch housing to reveal the #2 Phillips head screw. Remove screw and slide grip off of handlebar.
12. Using the T25 Torx bit, remove the three Torx fasteners from the backside of the switch housing.
13. On the bottom side of the clutch mount, remove two #1 Phillips screws and remove cover. Using a dental pick, depress clock tab and disconnect clutch wiring terminal.
14. Remove the two M6 screws from the clutch clamp and remove clutch lever assembly. Carefully hang clutch lever assembly from cable so excessive bending or kinking does not occur to the cable.
15. Remove the two M6 screws from the brake master cylinder clamp and assembly. Support master cylinder level on a flat and horizontal surface.
16. Using the T25 Torx bit, remove the four Torx fasteners from the backside of the right hand switch housing. Split switch housing apart and slide the right hand grip off of handlebar. Place grip in a clean location.

⚠ WARNING

Failure to continuously support master cylinder in a level orientation may cause reduced braking performance or braking failure.

17. From the switch housing wiring slots in the handlebar, pull the left and right hand wiring harnesses and switch housings out of the handlebar.

NOTE: Feed the excess wire into the center slot of the handlebar while simultaneously pulling from the switch housing ends.

18. Support the handlebar and remove the forward two and rearward two M8 cap screws from the handlebar riser cap and remove the handlebar.

Accessory Handlebar Installation (use retained fasteners, covers, clamps for re-assembly where applicable)

19. With the new handlebars resting on a flat surface, insert the right hand switch housing wiring harness into the right hand switch housing wiring slot in the handlebar and pull all terminals out of the center wiring slot in the handlebar. Pull harness taught until switch housing is located adjacent to the wiring slot. Repeat for the left hand switch housing wiring.

NOTE: Using a protective cloth, lightly clamp handlebars in vise for ease of wire insertion.

NOTE: Using a small piece of electrical tape to hold the wire terminals together for ease of wire insertion.

20. Place new handlebar in risers and replace riser cap. Loosely install two upper M8 cap screws and two lower M8 cap screws. Center the handlebar knur ling to the riser cap. Considering the switch housings, grips and levers, position the handlebars to rider preference such that there is adequate clearance to the fuel tank when turning left to right. Torque the forward two M8 riser cap screws to 18 +/- 2 ft.lb (24.4 +/- 2.7 Nm) first, then the torque the rearward two M8 riser cap screws.

21. Remove any dust, dirt or grime from the right hand grip tube, throttle switch housing assembly, and the handlebar prior to reassembly.
22. Slide the right hand grip onto the handlebar.
23. Assemble switch housing so the single boss on the rider-faced switch housing is located in the 5.4 mm hole on the handlebar and so the throttle components are aligned.
24. Install the retained four Torx fasteners into the backside of the switch housing and torque to 31 +/- 4.5 in.lb (3.5 +/- 0.5 Nm).

NOTE: Excessive force is not required to install these components. Ensure components are aligned and that wires are inside of the switch housing prior to closing switch housing halves.

CAUTION: Check the throttle operation. Open throttle fully and then release the grip. Throttle grip must return freely and completely to the idle position. If throttle return is sluggish or if it does not return freely and completely, disassemble throttle side switch housing to determine the cause. Do not operate the vehicle until throttle operates freely.

25. While holding the brake master cylinder level, install onto vehicle with two M6 screws and clamp adjacent to the right hand switch housing. Position to rider preference. Starting with the top screw and torque both fasteners to 70 +/- 10 in.lb (7.9 +/- 1.1 Nm).
 26. Assemble left hand switch housing so the single boss on the rider-faced switch housing is located in the 5.4 mm hole in the handlebar. Route the clutch wire through the provided slot in switch housing. Install the three retained Torx fasteners into the backside of the switch housing and torque to 31 +/- 4.5 in.lb (3.5 +/- 0.5 Nm).
- NOTE:** Excessive force is not required to install these components. With the exception of the clutch wire terminal, ensure wires are inside of the switch housing prior to closing switch housing halves.
27. Install clutch lever assembly onto vehicle with two M6 screws and clamp adjacent to the left hand switch housing. Position to rider preference. Starting with the top screw, torque both fasteners to 70 +/- 10 in.lb (7.9 +/- 1.1 Nm).
 28. Connect clutch wire terminals and replace cover and two Phillips screws and tighten.
 29. Slide the left hand grip onto the handlebar and fasten with the retained #2 Phillips head screw and tighten.

Front Bodywork Re-assembly

30. Set rear upper fork cover into place and connect the driving light switch wiring terminal.
31. Replace the previously cut nylon straps into the push dart locations in the front upper fork cover and set the cover into place. Do not close straps.
32. Install the driving light/mount assembly by sliding two driving light wire rubber grommets into the front upper fork cover slots, and then the retained windshield bushings and then fasten loosely into place with the four retained M8 cap screws.
33. Ensuring correct label pairing, connect the handlebar wiring terminals.
34. Neatly bundle the handlebar wiring by using the available nylon straps. Cinch tight and remove excess nylon strapping with side cutters, careful not to damage any wires. Wires should not be visible in and around the fuel tank while sitting in the rider position. Turn handlebar left and right, lock-to-lock, and determine if there is any resistance from wire binding. If you feel resistance or see wire interference, determine the cause and re-bundle wires as necessary.
35. Install the headlight bulb and secure with wire retainer. Reinstall the sealing boot. Make sure it seals tightly around the bulb base and lens to prevent condensation.

NOTE: Avoid touching a halogen lamp with bare fingers. Oil from your skin leaves a residue, causing a hot spot that will shorten the life of the lamp. If a lamp is touched, clean it thoroughly with denatured alcohol.

36. Position the headlight housing onto the upper front fork cover. From inside of the upper fork covers, install the retained four M6 cap screws and torque to 84 +/- 9 in-lbs. (9.4 +/- 1.0 Nm).
37. On the top of the headlight housing, install the retained two M6 button head screws and torque to 36 +/- 6 in-lbs. (4.0 +/- 0.6 Nm).
38. Squeeze the front and rear upper fork covers together and torque the four M8 cap screws to 18 +/- 2 ft.lb (24.4 +/- 2.7 Nm).

Clutch Cable, Removal / Installation

1. Place motorcycle in an upright position with the front wheel clamped in a wheel vise.

Clutch Cable Removal

2. Remove the side stand bumper bolt (J) and the clutch cable E-clip (K).

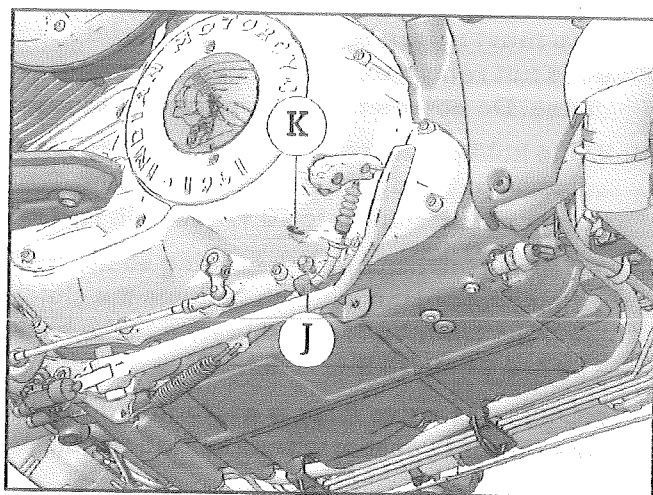

3. Protect the clutch release arm (L) with a shop towel. Using an adjustable wrench, rotate the release arm inward. Disconnect clutch cable from release arm.

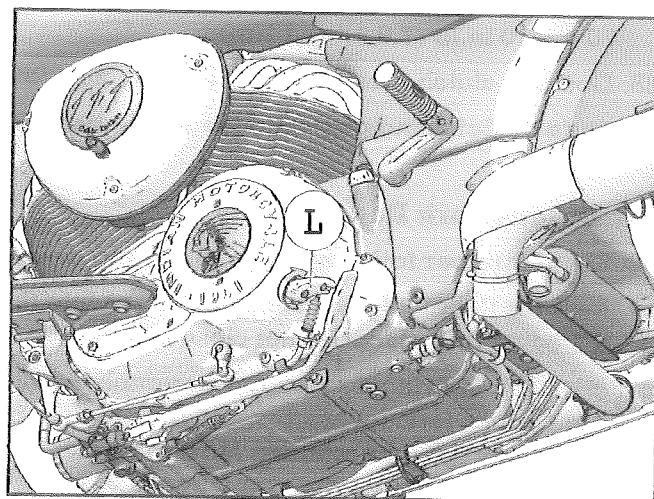

4. Withdraw the clutch cable from the mounting boss located on the primary cover.
 5. At the handlebar, pull the clutch cable casing straight out until clear of lever perch and rotate cable outward to align inner cable wire with slot in lever.
 6. Pull lever slightly until slotted opening in lever is clear of perch and slide cable barrel end down and out of lever.
 7. Note routing of clutch cable through frame.
 8. Loosen the bolts securing the LH frame downtube to the engine and steering head.
 9. Remove the clutch cable.
- IMPORTANT:** Do not kink, bend, or twist the inner cable or outer cable casing during installation.
10. Route clutch cable in the same manner as removed.
 11. Torque the LH frame downtube bolts to specification. See Engine Brackets / Fasteners, page 8.
 12. Apply multi-purpose grease to the lever end of the cable and install it in the clutch lever at the handlebar.
 13. Install the casing in the lever perch at the handlebar.
 14. Install cable in the mounting boss located on the primary cover.
 15. At the release arm end of the cable, pull the inner cable until fully extended. Be sure the upper end of the cable casing is seated in the lever perch at handlebar end.
 16. Apply multi-purpose grease to the lower barrel end of the cable.
 17. Rotate the release arm inward (as in Step 3) until cable can be installed in release arm.
 18. Install the clutch cable E-clip at the mounting boss.
 19. Install the side stand bumper and bolt. Torque to 84 in-lbs (9.5 Nm).
 20. Adjust clutch cable free play. See Clutch Lever Free Play below.

Clutch Lever Free Play

1. With handlebars pointing straight ahead, measure the clutch lever free play (M). Measurement should be .019-.059 in (0.5-1.5 mm).

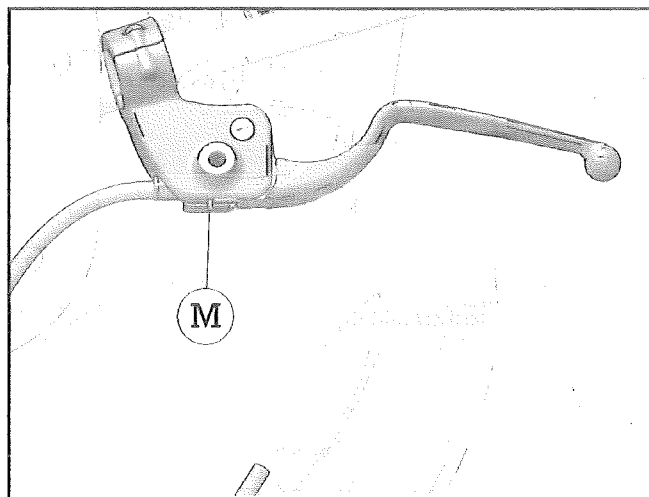

2. Fasten M6 screw (N) with P-clamp (P). Torque to 84 in-lbs. (9.4 Nm).
3. Compare measurement to specification. If adjustment is required, proceed to Step 4.
4. Locate the clutch cable adjuster boot (Q) and pull it back to expose the jam nut and barrel adjuster.
5. Hold the cable and loosen the adjuster jam nut.
6. Turn cable adjuster in or out until clutch free play is correct.
7. Tighten the adjuster jam nut. Torque to 48 in-lbs (5.4 Nm).
8. Slide adjuster boot back over adjuster assembly.

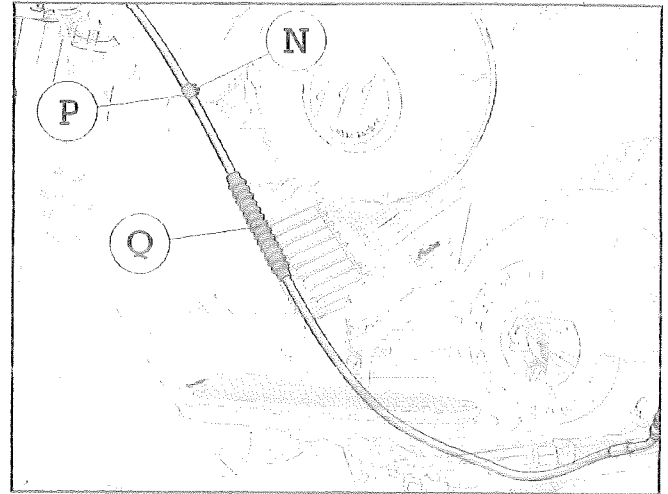

Engine Brackets / Fasteners

Left Side Brackets / Fasteners

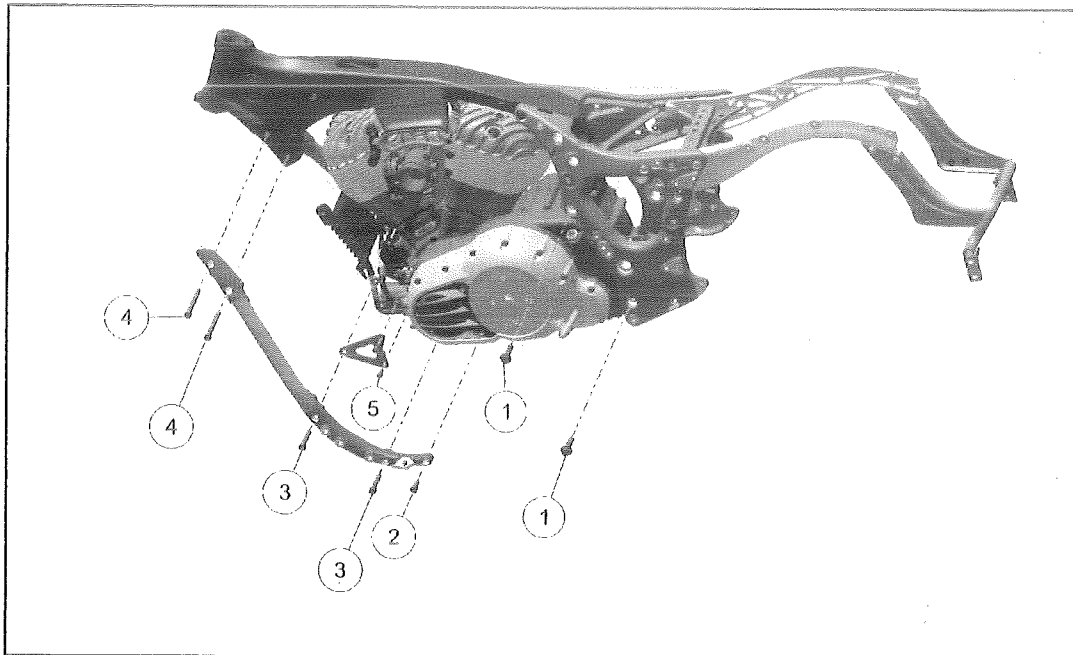

Number	Qty	Part Description	Torque (If Applicable)
1	2	Bolt, Engine Mount - M12 x 1.75 x 50	75 ft. lbs (101.6 Nm)
2	1	Bolt, Engine Mount — M10 x 1.5 x 25	45 ft. lbs (60.0 Nm)
3	2	Bolt, Engine Mount — M10 x 1.5 x 60	45 ft. lbs (60.0 Nm)
4	2	Bolt, Frame Down Tube — M10 x 1.5 x 100	45 ft. lbs (60.0 Nm)
5	2	Bolt, Front Engine Mount — M8 x 1.25 x 20	18 ft. lbs (24.4 Nm)