

HANDGUARDS KIT BY ROLAND SANDS DESIGN ®



P/N 2884095

INTERNATIONAL INSTRUCTIONS

DE DEUTSCH

Laden Sie die neuesten PDF-Anweisungen von www.indianmotorcycle.de herunter.

FR FRANÇAIS

Télécharger les dernières instructions en format PDF sur www.indianmotorcycle.fr.

IT ITALIANO

Scarica l'ultima versione delle istruzioni in formato PDF da www.indianmoto.it.

EN ENGLISH

Download the latest PDF instructions from www.indianmotorcycle.com.

ES ESPAÑOL

Descargue las instrucciones más recientes en formato PDF de www.indianmotorcycle.mx / www.indianmotorcycle.es.

ZH 中文

从www.indianmotorcycle.cn 下载最新的PDF说明。

1

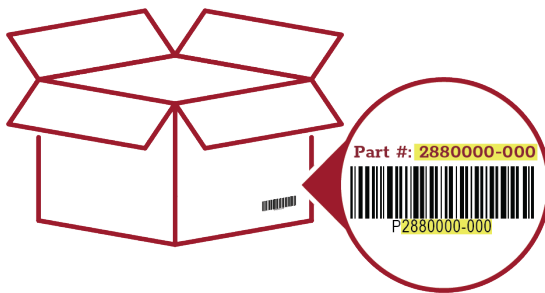

2



3



4

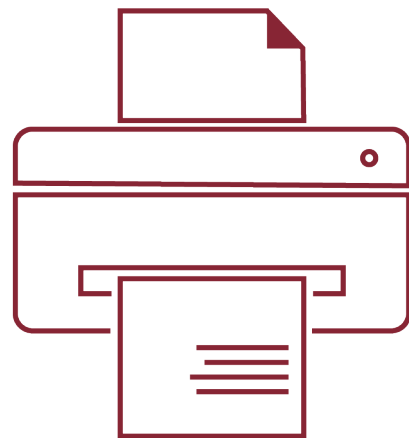

APPLICATION

Verify accessory fitment at www.indianmotorcycle.com.

BEFORE YOU BEGIN

Read these instructions and check to be sure all parts and tools are accounted for. Please retain these installation instructions for future reference and parts ordering information.

KIT CONTENTS

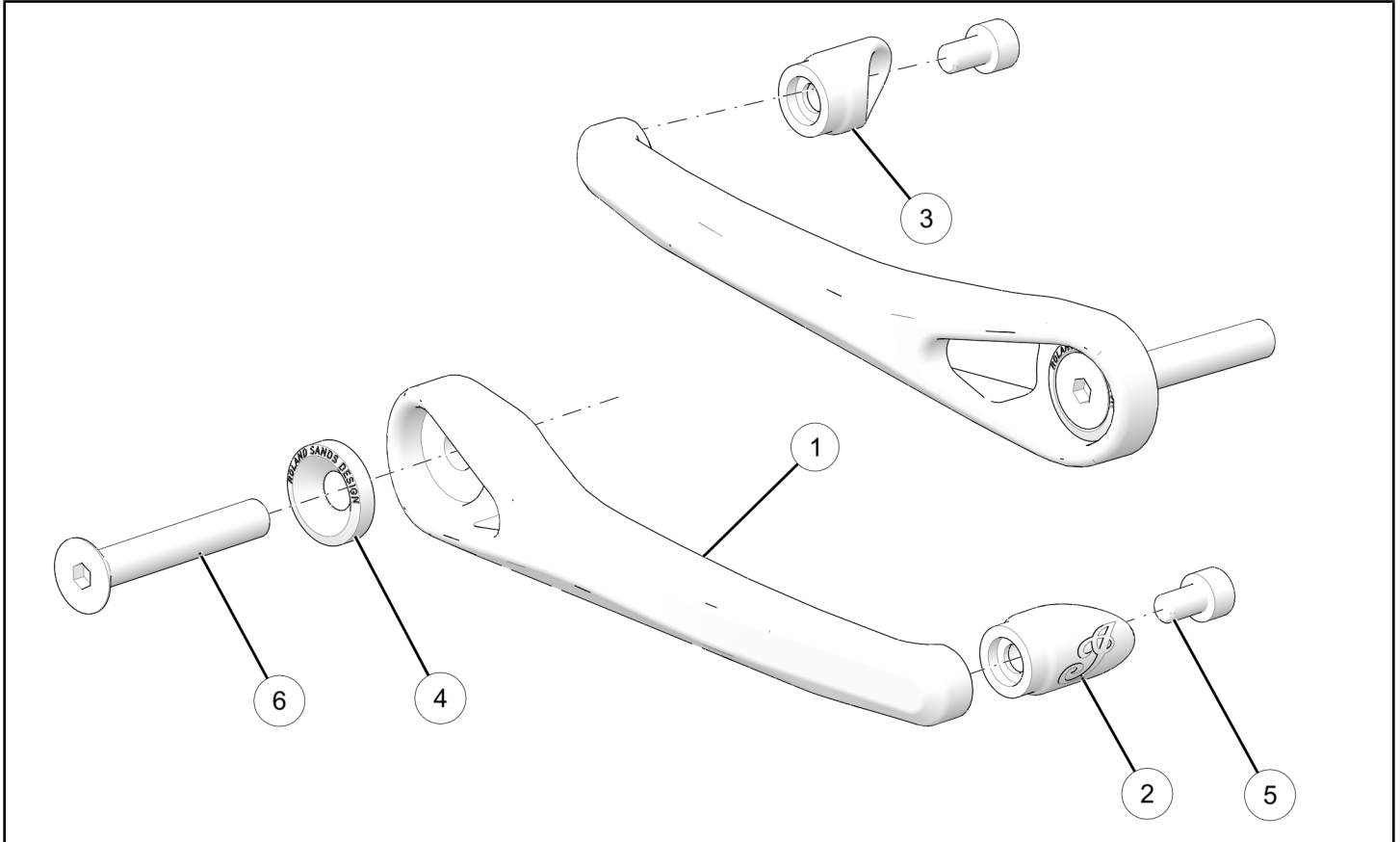

REF	QTY	PART DESCRIPTION	P/N AVAILABLE SEPARATELY
1	2	Guard, Hand, Roland Sands Design ®	N/A
2	1	Tip, Guard, Hand, RH, Roland Sands Design ®	N/A
3	1	Tip, Guard, Hand, LH, Roland Sands Design ®	N/A
4	2	Spacer, Guard, Hand, Roland Sands Design ®	N/A
5	2	Screw-Socket Head, M6 x 1.0 x 10	7521104
6	2	Screw-Flat Head, M8 x 1.25 x 50	7521105
	1	Instructions	9929457

TOOLS REQUIRED

- Safety Glasses
- Hex Key Set, Metric
- Hex Key Set, Ball End, Metric
- Socket Set, Hex Bit, Metric
- Torque Wrench

IMPORTANT

Your accessory kit is exclusively designed for your vehicle. Please read the installation instructions thoroughly before beginning. Installation is easier if the vehicle is clean and free of debris. For your safety, and to ensure a satisfactory installation, perform all installation steps correctly in the sequence shown.

INSTALLATION INSTRUCTIONS

VEHICLE PREPARATION

GENERAL

1. Turn key or ignition switch to OFF position and remove key.
2. Ensure motorcycle is parked on a flat surface, kickstand is fully extended, and vehicle is stable prior to installation.

BAR END REMOVAL

1. Loosen, but DO NOT completely remove, screw **A** until end cap and wedge anchor assembly can be removed from handlebar tube.

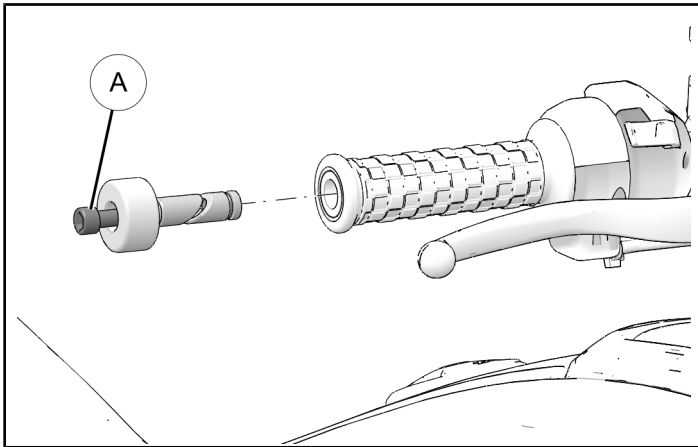

2. Repeat this section for opposite side.

ACCESSORY INSTALLATION

1. Pass screw **6** through spacer **4**. Partially thread screw **6** into wedge anchor assembly. Slide wedge anchor into handlebar tube until handguard is flush against handlebar tube.

TORQUE

One screw **6**:
18 ft-lbs (24 N·m)

IMPORTANT

Twist throttle and ensure throttle returns without friction. Friction may be caused by grip rubbing against handguard.

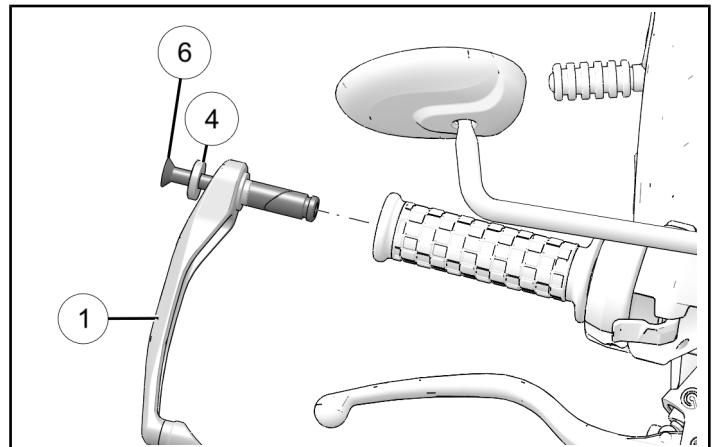

2. Repeat this section for LH side.

FEEDBACK FORM

A feedback form has been created for the installer to provide any comments, questions or concerns about the installation instructions. The form is viewable on mobile devices by scanning the QR code or by clicking [HERE](#) if viewing on a PC.

