

REAR HIGHWAY BAR KIT



P/N 2879582-156, 2879582-626

APPLICATION

Verify accessory fitment at Polaris.com.

2014 and newer Indian® Roadmaster®, Chieftain®, and Springfield® Motorcycles

BEFORE YOU BEGIN

Read these instructions and check to be sure all parts and tools are accounted for. Please retain these installation instructions for future reference and parts ordering information.

KIT CONTENTS

This Kit includes:

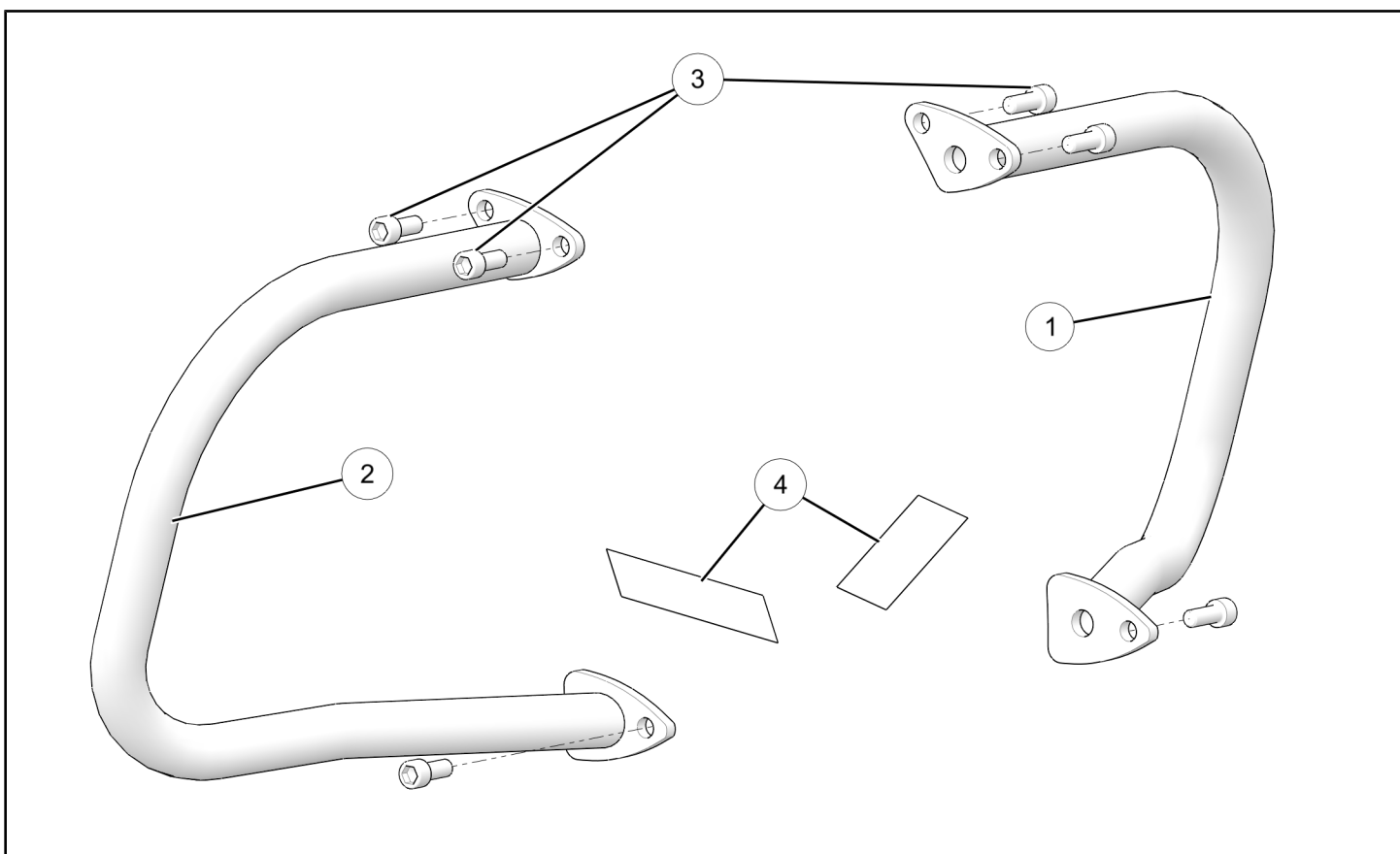

REF	QTY	PART DESCRIPTION	PART NUMBER
1	1	Tip Over Bar, LH	-
2	1	Tip Over Bar, RH	-
3	6	Screw, Socket Head, M8 X 1.25 X 20, Chrome Screw, Socket Head, M8 X 1.25 X 20, Black	7517410 7520241
4	2	Decal, Highway Bar	7176355
	1	Instructions	9924360

TOOLS REQUIRED

- Safety Glasses
- Socket Set, Hex Bit, Metric

- Torque Wrench

IMPORTANT

Your Indian Rear Highway Bar Kit is exclusively designed for your vehicle. Please read the installation instructions thoroughly before beginning. Installation is easier if the vehicle is clean and free of debris. For your safety, and to ensure a satisfactory installation, perform all installation steps correctly in the sequence shown.

ASSEMBLY TIME

Approximately 18 minutes

INSTALLATION INSTRUCTIONS

1. Turn key or ignition switch to “OFF” position and remove key. If equipped with keyless fob, remove fob from proximity of vehicle.
2. Ensure motorcycle is parked on a flat surface, kickstand is fully extended, and vehicle is stable prior to installation.

NOTE

Protect all finished surfaces prior to installation.

3. Remove two socket head screws (A) and remove black plastic decorative covers (B) and (C). Discard parts. Repeat for opposite side of motorcycle.

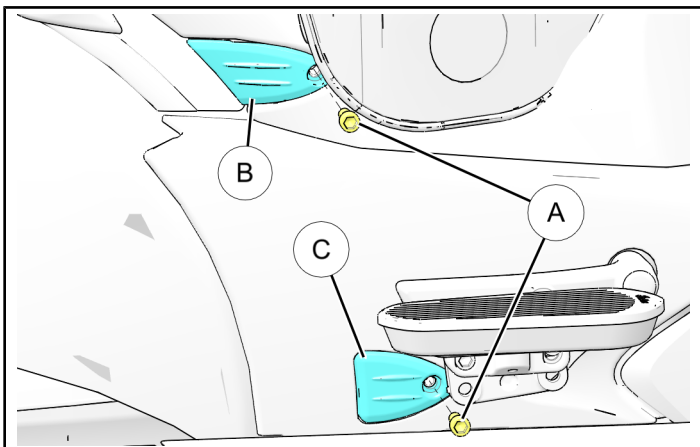

4. Install RH Highway Bar (2) using six new socket head screws (3). Torque screws to specification.

TORQUE

18 ft. lbs, (24 Nm)

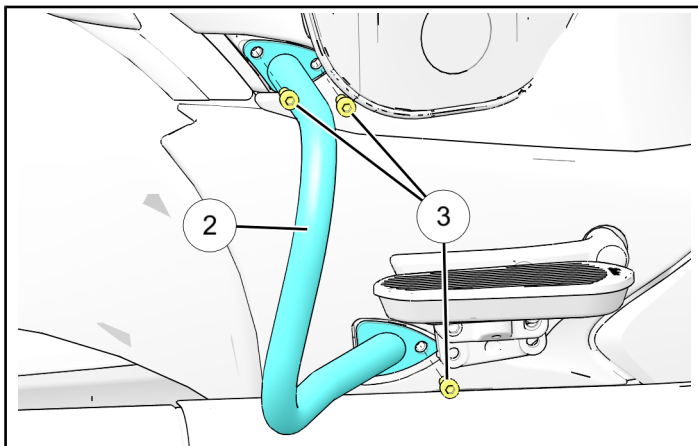

5. Repeat step 4 to install LH Highway bar (1).
6. Install warning decals (4) onto both left (1) and right (2) highway bars.

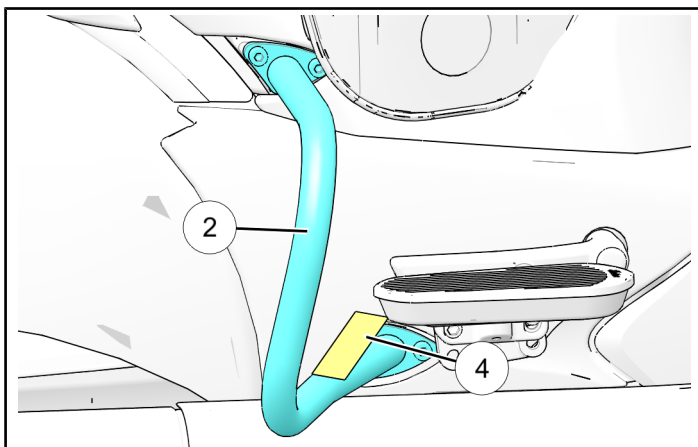

FEEDBACK FORM

A feedback form has been created for the installer to provide any comments, questions or concerns about the installation instructions. The form is viewable on mobile devices by scanning the QR code or by clicking [HERE](#) if viewing on a PC.

FEEDBACK FORM

