

REAR HIGHWAY BAR KIT



P/N 2879582-XXX

APPLICATION

Verify accessory fitment at www.indianmotorcycle.com.

BEFORE YOU BEGIN

Read these instructions and check to be sure all parts and tools are accounted for. Please retain these installation instructions for future reference and parts ordering information.

KIT CONTENTS

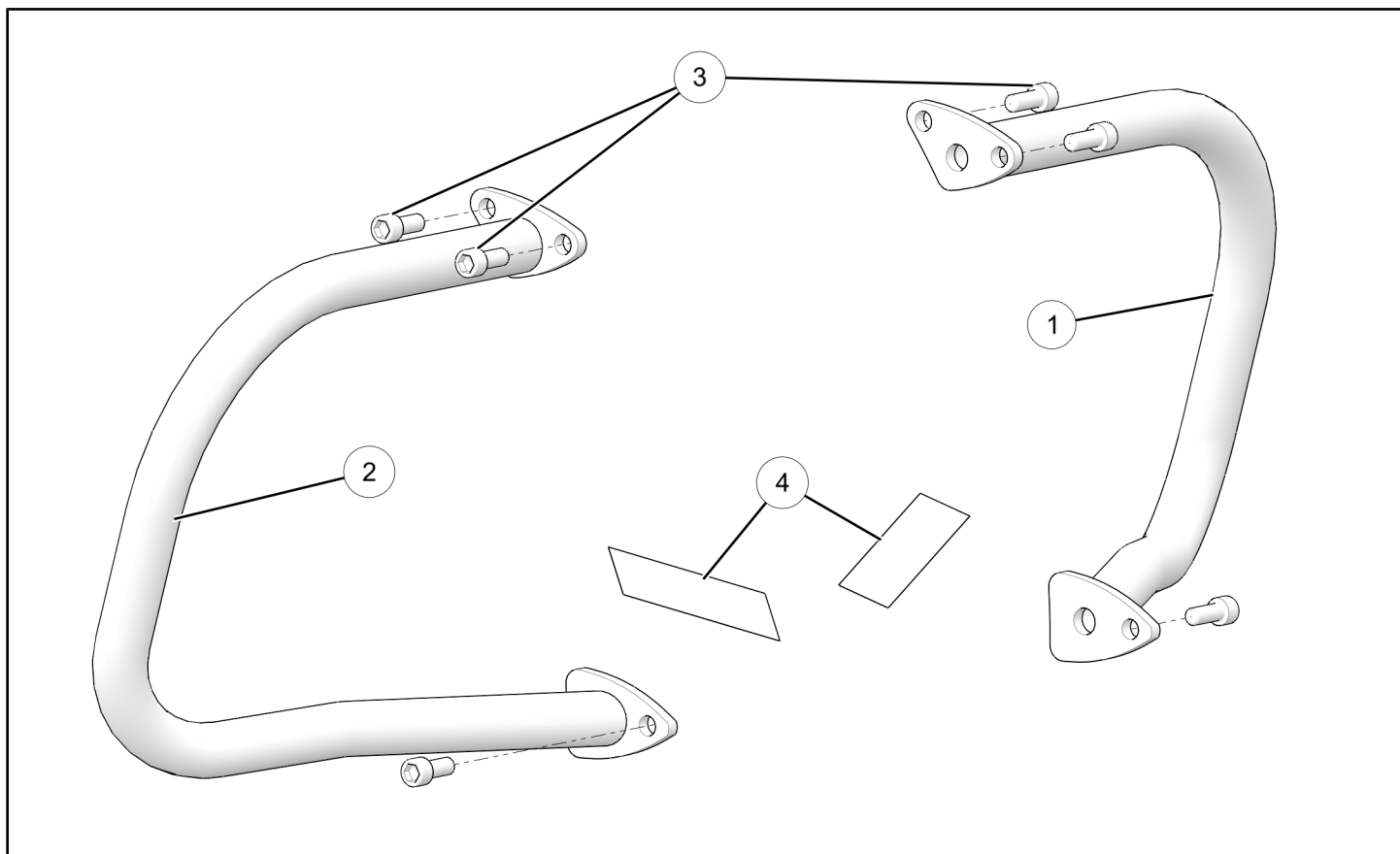

REF	QTY	PART DESCRIPTION	P/N AVAILABLE SEPARATELY
1	1	Highway Bar, LH	N/A
2	1	Highway Bar, RH	N/A
3	6	Screw, Socket Head, M8 X 1.25 X 20, Chrome (Kit P/N 2879582-156) Screw, Socket Head, M8 X 1.25 X 20, Black (Kit P/N 2879582-626)	7520241 7516738
4	2	Decal, Highway Bar	7176355

TOOLS REQUIRED

- Safety Glasses
- Socket Set, Hex Bit, Metric
- Torque Wrench

IMPORTANT

Your Indian Motorcycle® Rear Highway Bar Kit is exclusively designed for your vehicle. Please read the installation instructions thoroughly before beginning. Installation is easier if the vehicle is clean and free of debris. For your safety, and to ensure a satisfactory installation, perform all installation steps correctly in the sequence shown.

INSTALLATION INSTRUCTIONS

VEHICLE PREPARATION

GENERAL

1. Turn key or ignition switch to **OFF** position and remove key. If equipped with keyless fob, remove fob from proximity of vehicle.
2. Ensure motorcycle is parked on a flat surface, kickstand is fully extended, and vehicle is stable prior to installation.

CAUTION

Protect surfaces with protective cloth during installation.

ACCESSORY INSTALLATION

1. Remove and discard two screws (A), and black plastic decorative covers (B) and (C). Repeat for opposite side of motorcycle.

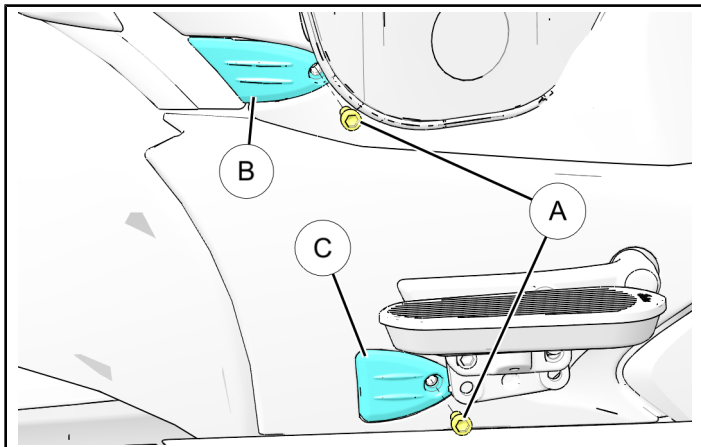

2. Install RH highway bar (2) using three new screws (3). Torque screws to specification.

TORQUE

Highway Bar Screws (3):
18 ft-lbs (24 N·m)

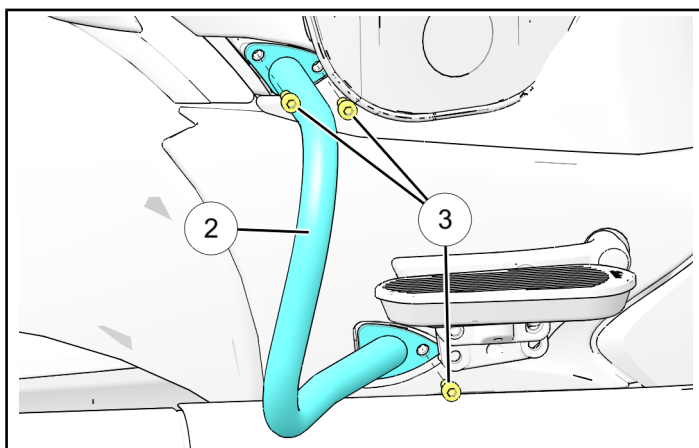

3. Repeat previous step for opposite side.
4. Install warning decals (4) onto both left (1) and right (2) highway bars.

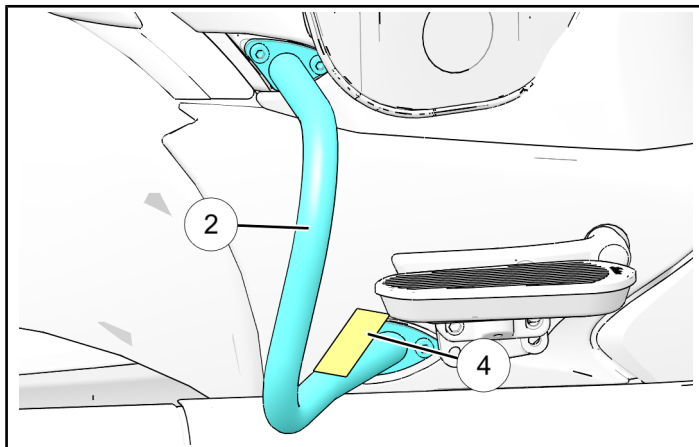

FEEDBACK FORM

A feedback form has been created for the installer to provide any comments, questions or concerns about the installation instructions. The form is viewable on mobile devices by scanning the QR code or by clicking [HERE](#) if viewing on a PC.

