

FRONT HIGHWAY BAR KIT



P/N 2883407

APPLICATION

Verify accessory fitment at www.indianmotorcycle.com.

BEFORE YOU BEGIN

Read these instructions and check to be sure all parts and tools are accounted for. Please retain these installation instructions for future reference and parts ordering information.

KIT CONTENTS

This Kit includes:

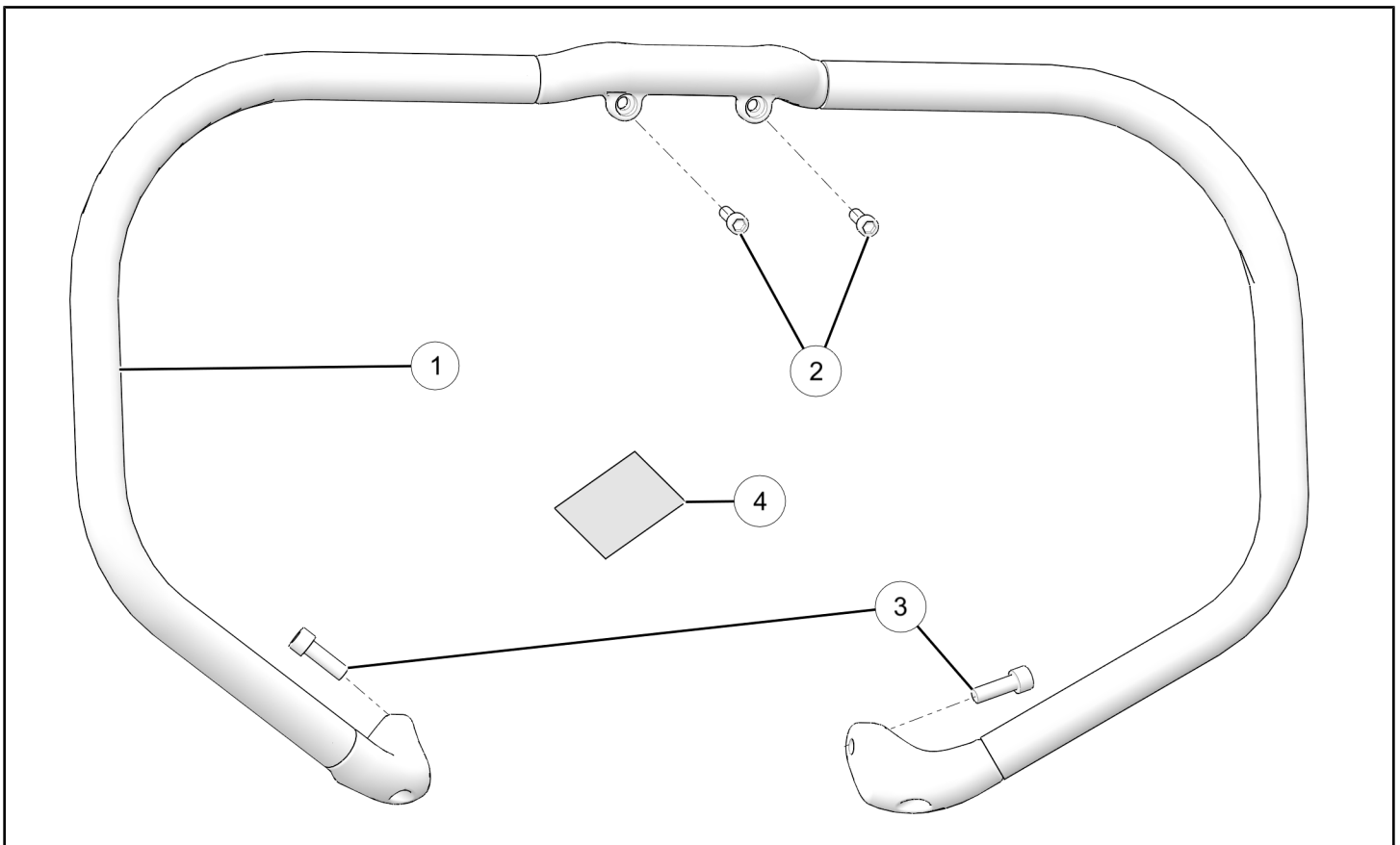

REF	QTY	PART DESCRIPTION	PART NUMBER
1	1	Highway Bar, Welded	-
2	2	Screw, M10 X 1.5 X 30	7519844
3	2	Screw, M8 X 1.25 X 25	7519859
4	1	Warning Decal	7176355
	1	Instructions	9928566

TOOLS REQUIRED

- Socket Set, Hex Bit, Metric
- Torque Wrench

CONSUMABLES REQUIRED

Solvent Wipe (99% Isopropyl Alcohol)

IMPORTANT

Your Indian Motorcycle® Front Highway Bar Kit is exclusively designed for your vehicle. Please read the installation instructions thoroughly before beginning. Installation is easier if the vehicle is clean and free of debris. For your safety, and to ensure a satisfactory installation, perform all installation steps correctly in the sequence shown.

INSTALLATION INSTRUCTIONS

1. Turn key or ignition switch to **OFF** position and remove key. If equipped with keyless fob, remove fob from proximity of vehicle.
2. Ensure motorcycle is parked on a flat surface, kickstand is fully extended, and vehicle is stable prior to installation.

FOOT CONTROL ASSEMBLY REMOVAL

1. Remove and retain two screws **A** from right hand foot control assembly **B**.

IMPORTANT

Support and level foot control assembly. **Do not** let hang by brake line.

⚠ WARNING

Right hand foot control assembly **B** contains rear brake master cylinder. Ensure brake lines do not bend or kink while detaching foot control assembly. Failure to support and level foot control assembly may cause reduced braking performance or braking failure resulting in serious personal injury.

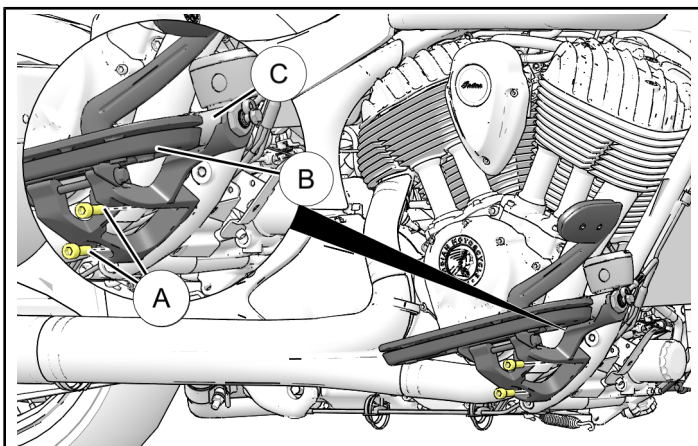

2. Remove and retain two screws **A** from left hand foot control assembly **D**.

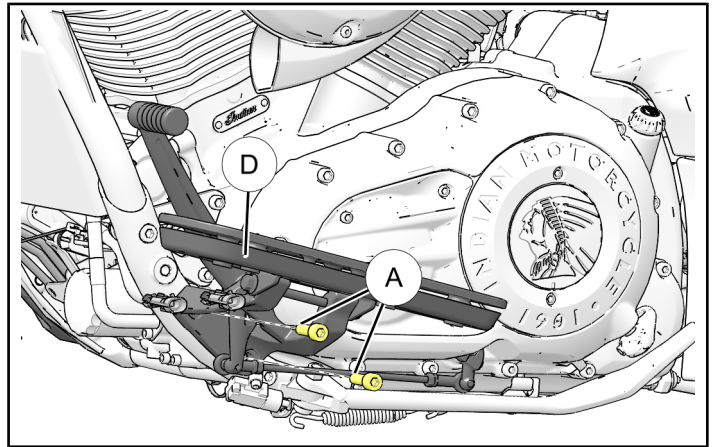

FRONT HIGHWAY BAR INSTALLATION

1. Loosely install top mount of front highway bar **1** with two screws **3**.

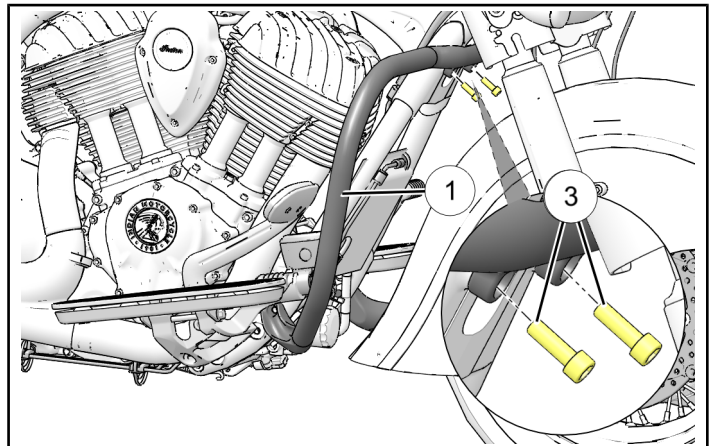

- Loosely install side mounts of front highway bar ① with one screw ② per mount.

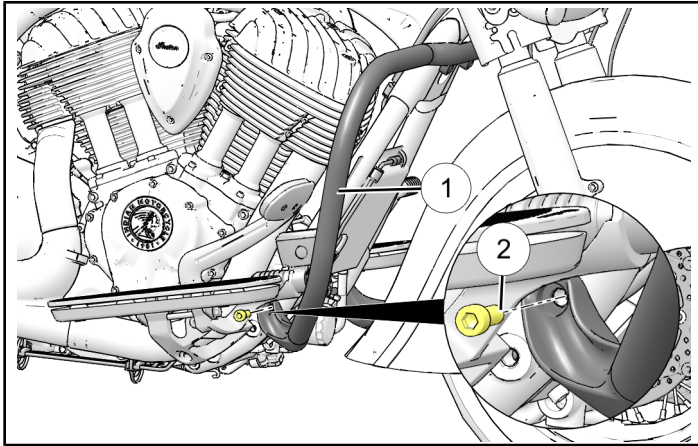

- Torque front highway bar screws to specification.

- Torque two screws ② to specification.

TORQUE

35 ft. lbs. (47 Nm)

- Torque two screws ③ to specification.

TORQUE

18 ft. lbs. (24 Nm)

REINSTALL FOOT CONTROL ASSEMBLIES

- Re-install foot control assemblies ⑧ and ⑩ removed in **Foot Control Assembly Removal** section with two screws ⑨ per foot control assembly.

Torque four screws ⑨ to specification.

TORQUE

35 ft. lbs. (47 Nm)

FEEDBACK FORM

A feedback form has been created for the installer to provide any comments, questions or concerns about the installation instructions. The form is viewable on mobile devices by scanning the QR code or by clicking [HERE](#) if viewing on a PC.

FEEDBACK FORM



APPLY WARNING DECAL

- Clean application area with solvent wipe.

⚠ WARNING

Isopropyl alcohol is hazardous to your health. See isopropyl alcohol packaging for proper handling instructions, including recommended personal protective equipment such as goggles and chemical resistant gloves.

- Remove paper backing from warning label. With two hands pinching edges of label place on highway bar so that there are no bubbles or ripples beneath label. Wrap label around highway bar.

