

# CRUISER LED DRIVING LIGHT KIT



**P/N 2880875**

## APPLICATION

2014 INDIAN CRUISER MOTORCYCLES WITH THUNDERSTROKE 111 REQUIRE A SOFTWARE UPDATE TO THE VEHICLE CONTROL MODULE AVAILABLE AT YOUR LOCAL INDIAN DEALER.  
2015 INDIAN CRUISER MOTORCYCLES WITH THUNDERSTROKE 111 DO NOT NEED A SOFTWARE UPDATE.

## BEFORE YOU BEGIN

Read these instructions and check to be sure all parts and tools are accounted for. Please retain these installation instructions for future reference and parts ordering information.

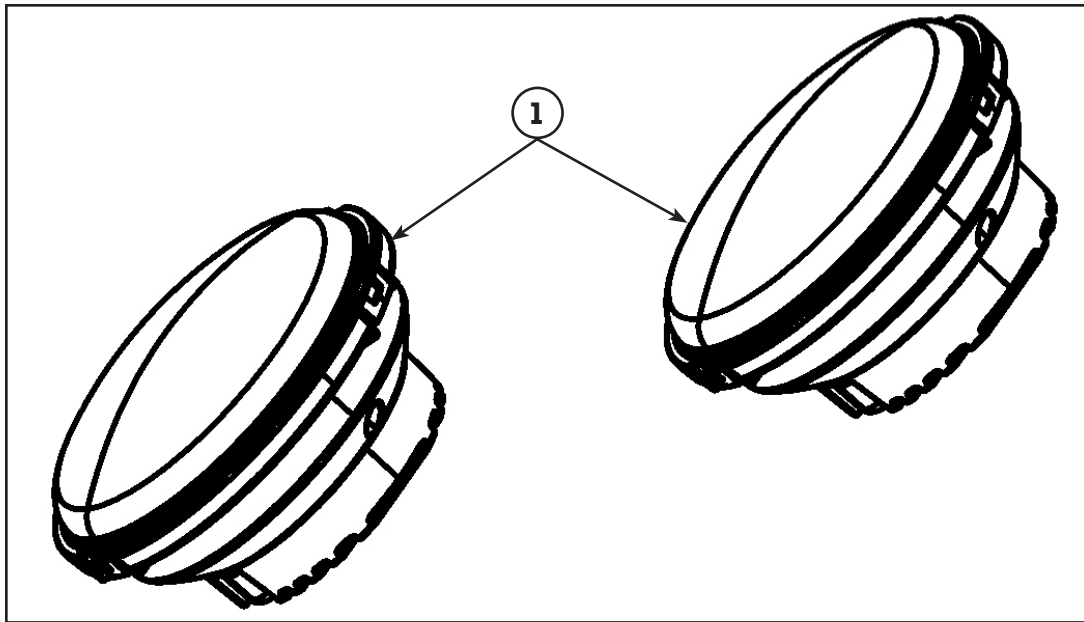

## KIT CONTENTS

| Ref | Qty | Part Description           | Part Number |
|-----|-----|----------------------------|-------------|
| 1   | 2   | Cruiser LED Driving Lights | 2413024     |
|     | 1   | Instructions               | 9925890     |

## TOOLS NEEDED

Phillips Screwdriver

Flat Blade Screwdriver

## APPROXIMATE ASSEMBLY TIME

15 mins

## IMPORTANT

Your Indian CRUISER LED DRIVING LIGHT KIT is exclusively designed for your vehicle. Please read the installation instructions thoroughly before beginning. Installation is easier if the vehicle is clean and free of debris. For your safety, and to ensure a satisfactory installation, perform all installation steps correctly in the sequence shown.

## INSTALLATION INSTRUCTIONS

**CAUTION:** Update Vehicle Control Module software before starting installation.

### Removal

1. Place the motorcycle in an upright position resting on the sidestand.
2. Remove the Philips head screw from each driving light assembly and remove the light from the housing.
3. Disconnect the wire from the back of the bulb.
4. Using a flat blade screwdriver, remove the three clips from the back of the lights.

### Installation

1. Place LED light into light cover. Verify "INDIAN" script is upright when installed.
2. Reinstall the clips. (A). See Figure.
3. Attach the wiring harnesses.

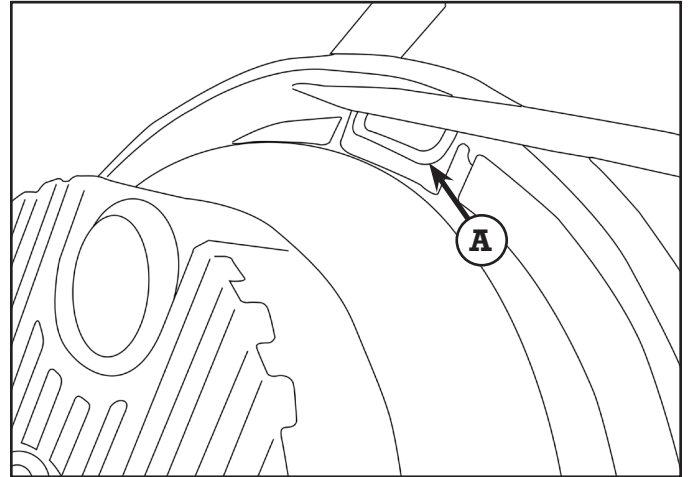

4. Reinstall the light into the housing using the screw (B). Torque to 23 in-lbs. (2.6 Nm). See Figure.

