

# CLEAR TURN SIGNALS KIT



**P/N 2884156, 2884157**

## INTERNATIONAL INSTRUCTIONS

### DE DEUTSCH

Laden Sie die neuesten PDF-Anweisungen von [www.indianmotorcycle.de](http://www.indianmotorcycle.de) herunter.

### FR FRANÇAIS

Télécharger les dernières instructions en format PDF sur [www.indianmotorcycle.fr](http://www.indianmotorcycle.fr).

### IT ITALIANO

Scarica l'ultima versione delle istruzioni in formato PDF da [www.indianmoto.it](http://www.indianmoto.it).

### EN ENGLISH

Download the latest PDF instructions from [www.indianmotorcycle.com](http://www.indianmotorcycle.com).

### ES ESPAÑOL

Descargue las instrucciones más recientes en formato PDF de [www.indianmotorcycle.mx](http://www.indianmotorcycle.mx).

### ZH 中文

从 [www.indianmotorcycle.cn](http://www.indianmotorcycle.cn) 下载最新的PDF说明。

1



2



3



4



## APPLICATION

Verify accessory fitment at [www.indianmotorcycle.com](http://www.indianmotorcycle.com).

## BEFORE YOU BEGIN

Read these instructions and check to be sure all parts and tools are accounted for. Please retain these installation instructions for future reference and parts ordering information.

## KIT CONTENTS

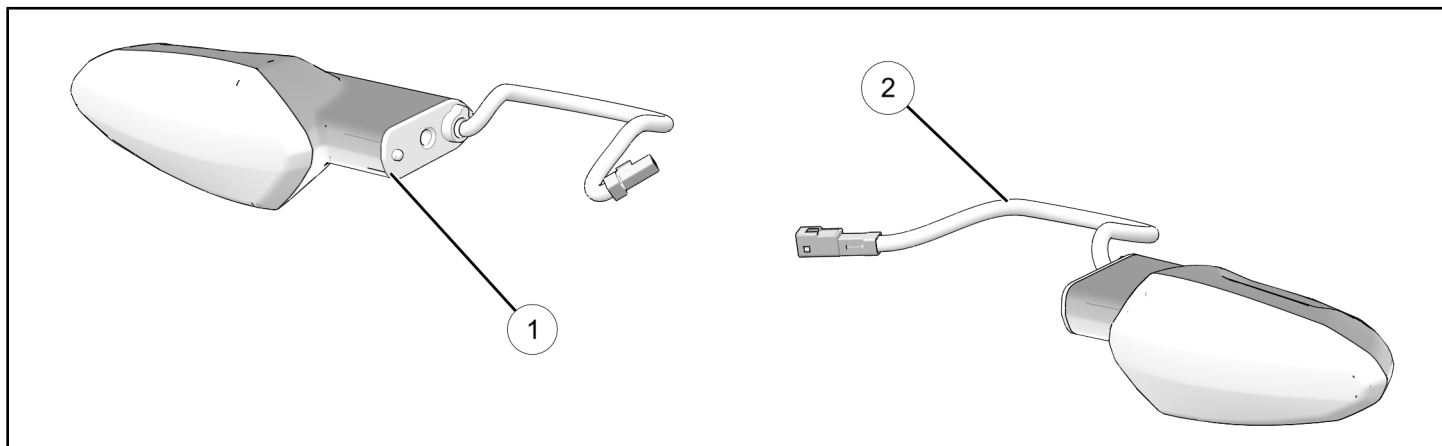

### UNITED STATES AND CANADA: P/N 2884156

REF	QTY	PART DESCRIPTION	P/N AVAILABLE SEPARATELY
1	2	Signal-Turn, RH	2414430
2	2	Signal-Turn, LH	2414429
	1	Instructions	9929612

### INTERNATIONAL: P/N 2884157

REF	QTY	PART DESCRIPTION	P/N AVAILABLE SEPARATELY
1	2	Signal-Turn, RH, International	2414158
2	2	Signal-Turn, LH, International	2414356
	1	Instructions	9929612

## TOOLS REQUIRED

- Safety Glasses
- Hex Key Set, Metric
- Socket Set, Hex Bit, Metric
- Socket Set, Metric
- Torque Wrench

## IMPORTANT

Your Indian Motorcycle® Clear Turn Signals Kit is exclusively designed for your vehicle. Please read the installation instructions thoroughly before beginning. Installation is easier if the vehicle is clean and free of debris. For your safety, and to ensure a satisfactory installation, perform all installation steps correctly in the sequence shown.

# INSTALLATION INSTRUCTIONS

## VEHICLE PREPARATION

### GENERAL

1. Turn key or ignition switch to OFF position and remove key.
2. Ensure motorcycle is parked on a flat surface, kickstand is fully extended, and vehicle is stable prior to installation.

### HEADLIGHT COWL REMOVAL (IF APPLICABLE)

1. Remove and retain four screws (A) and four washers (B) from headlight cowl.

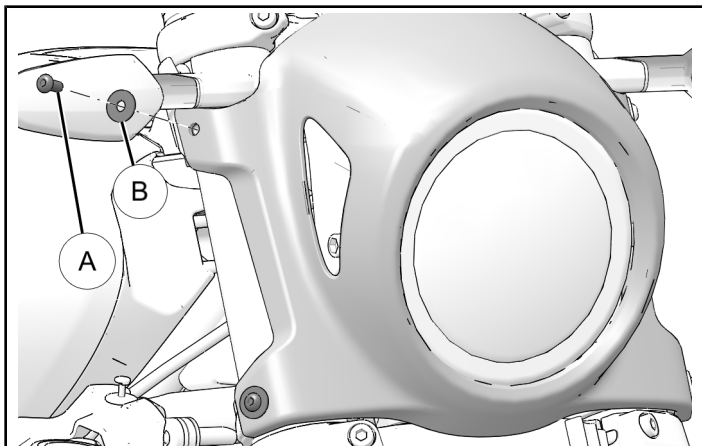

2. Remove headlight cowl and set aside for reinstallation.

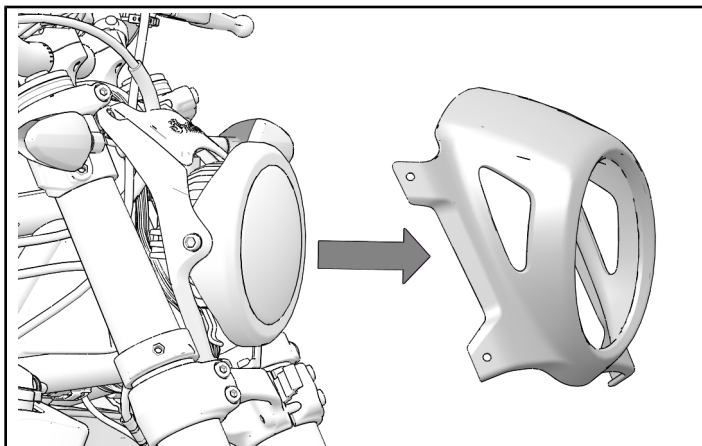

### FRONT TURN SIGNAL REMOVAL

1. Disconnect turn signal from chassis harness.

#### NOTE

Headlight bracket hidden for procedure clarity.

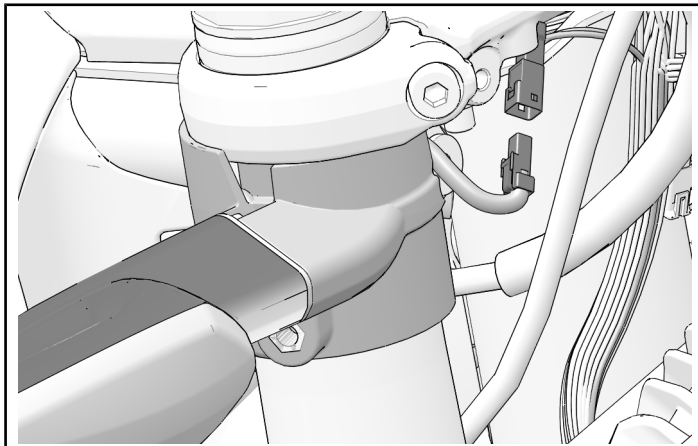

2. Remove and retain one screw (A) and one washer (B) from turn signal mount. Remove turn signal assembly from motorcycle.

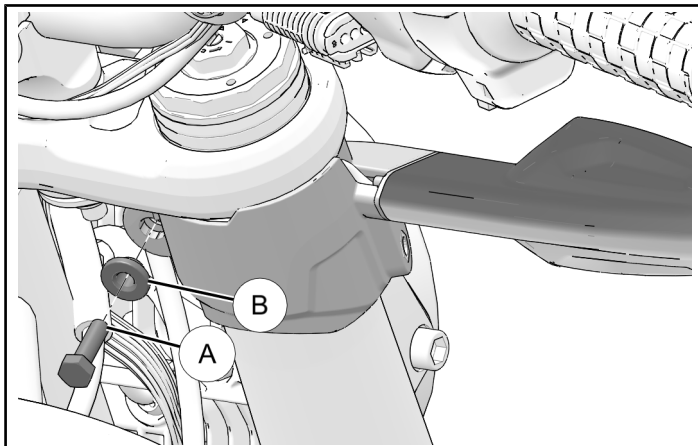

3. Remove and retain one screw (C) from within turn signal mount to uninstall stock turn signal. Discard stock turn signal.

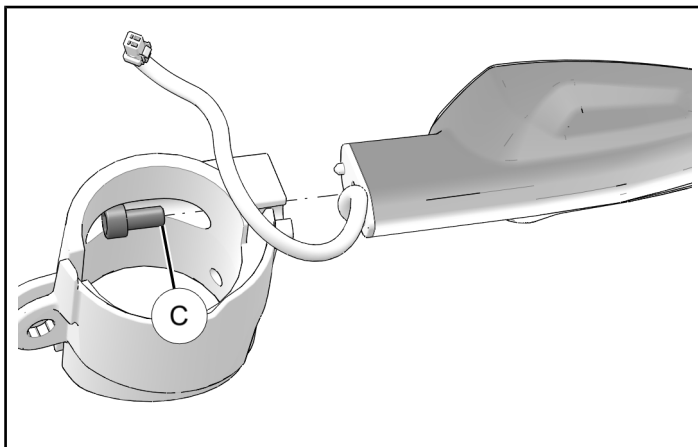

4. Repeat this section for opposite side.

## **REAR TURN SIGNAL REMOVAL**

1. Remove and retain license plate.
2. Pull rear lighting harness bundle out of mounting arm to reveal connectors. Disconnect license plate light, LH turn signal, and RH turn signal.

### **TIP**

Use small pick or slotted screw driver to carefully disconnect harness tabs.

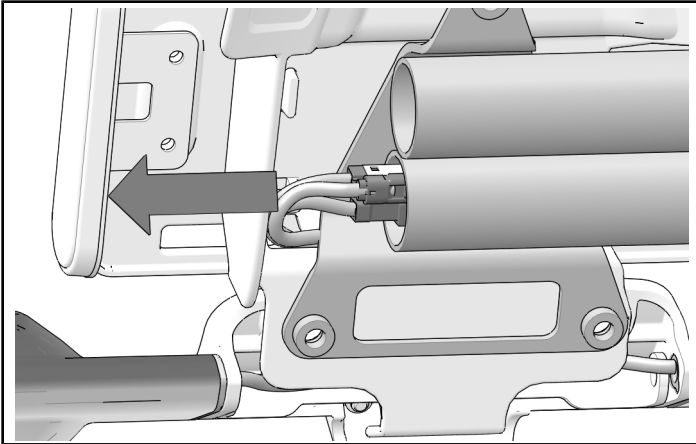

3. Remove and retain three screws (A) to uninstall license plate assembly from license plate arm. Place license plate mount on a clean surface.

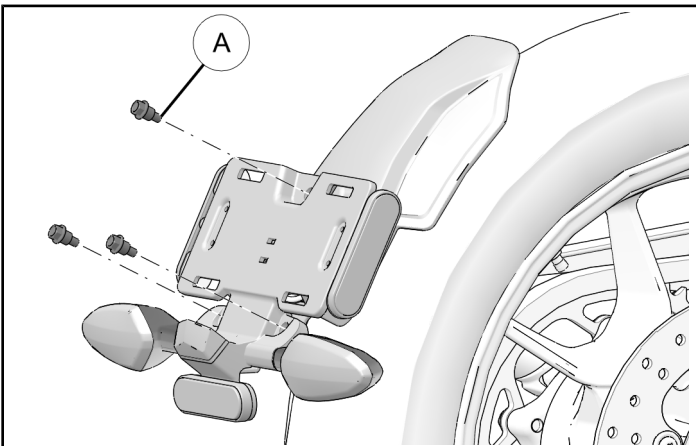

4. Pinch two tabs on license plate mount to disassemble from debris shield. Harnesses will need to be routed out of debris shield opening during disassembly.

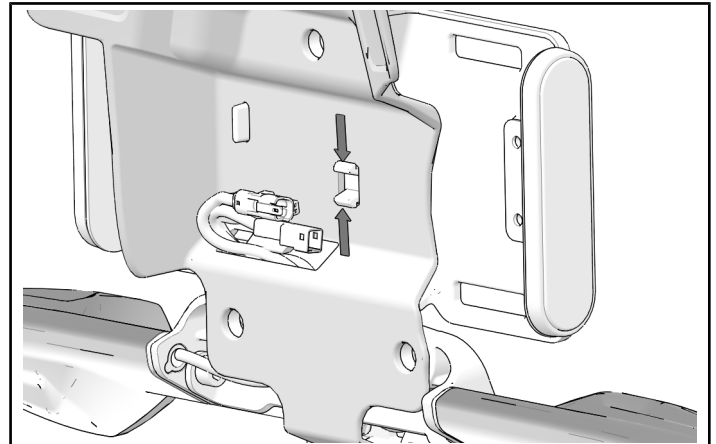

5. Remove and retain two screws from each turn signal.

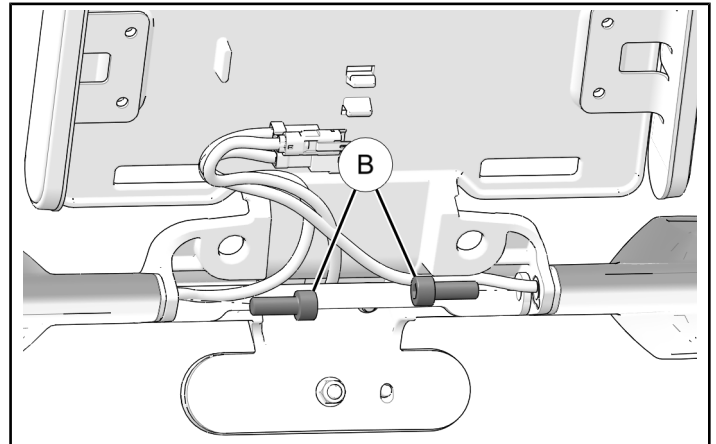

## ACCESSORY INSTALLATION

### FRONT TURN SIGNAL INSTALLATION

1. Install turn signal ① onto turn signal mount with one screw ①.

#### TORQUE

One screw ①: 36 in. lbs. (4 Nm)

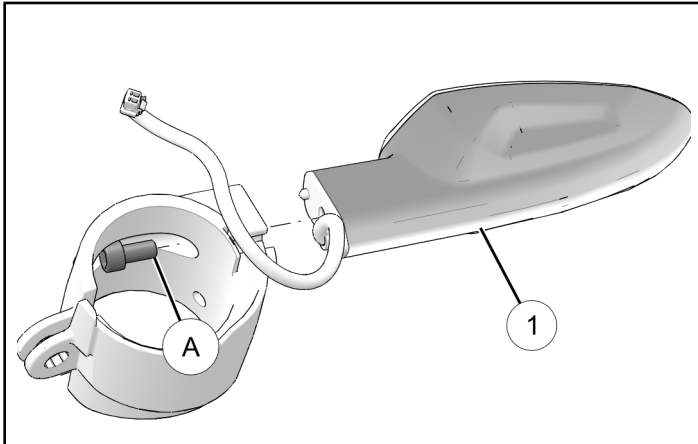

2. Ensure turn signal ① harness routes within channel of turn signal mount.

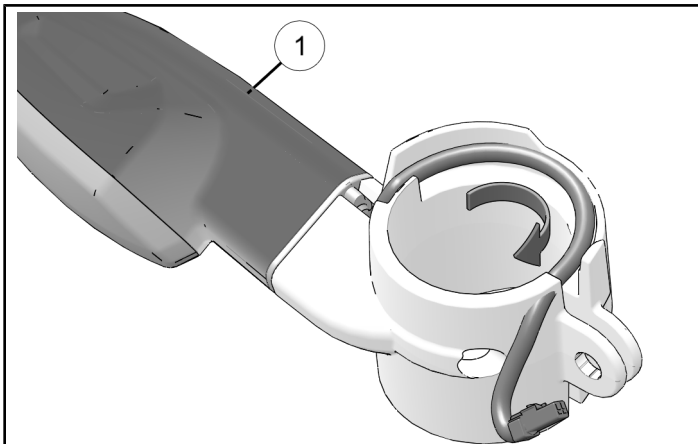

3. Install turn signal mount onto suspension fork with one retained screw ② and one retained washer ③.

#### TORQUE

One screw ②: 36 in. lbs. (4 Nm)

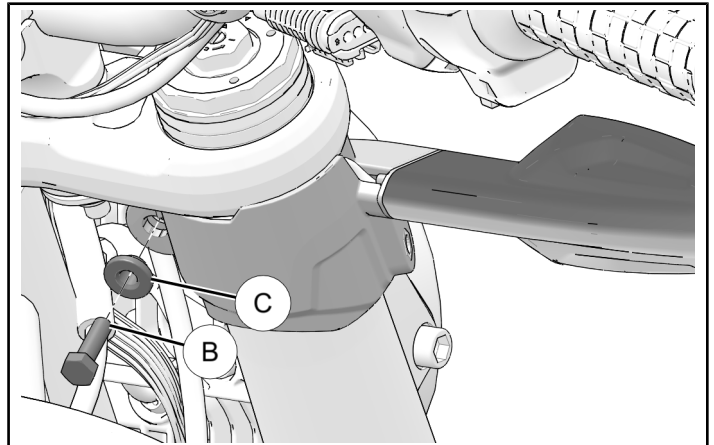

4. Join turn signal connector to chassis harness connector

#### NOTE

Headlight bracket hidden for procedure clarity.

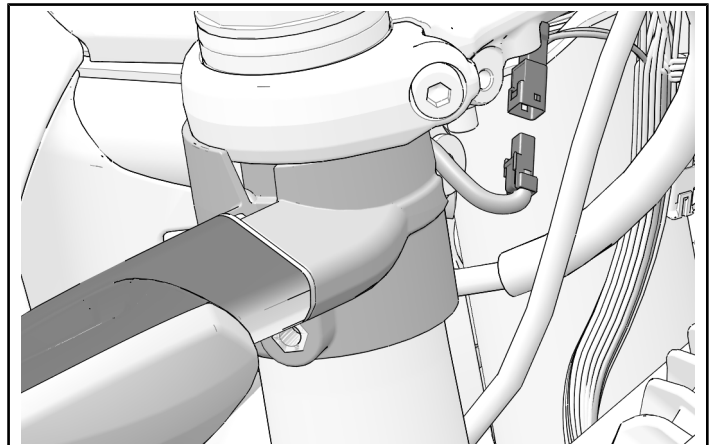

5. Repeat this section for opposite side.

## REAR TURN SIGNAL INSTALLATION

1. Install RH turn signal ① and LH turn signal ② onto license plate mount with two retained screws ③.

### TORQUE

Two screws ③: 36 in. lbs. (4 Nm)

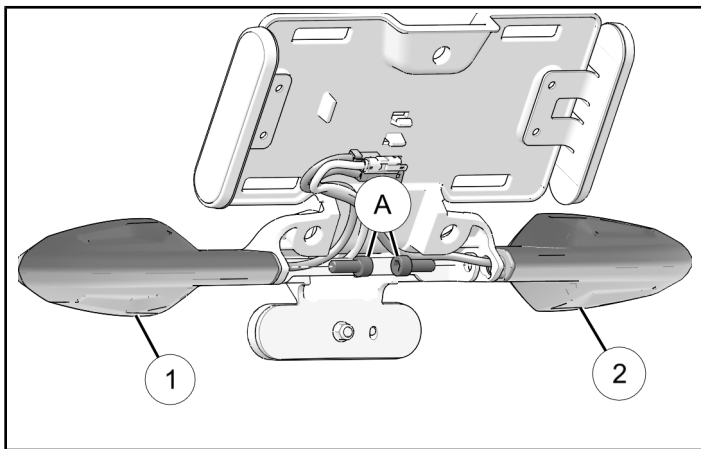

2. Route turn signal and license plate harnesses through debris shield opening before replacing license plate mount onto debris shield. Ensure two license plate mounts full engage within debris shield.

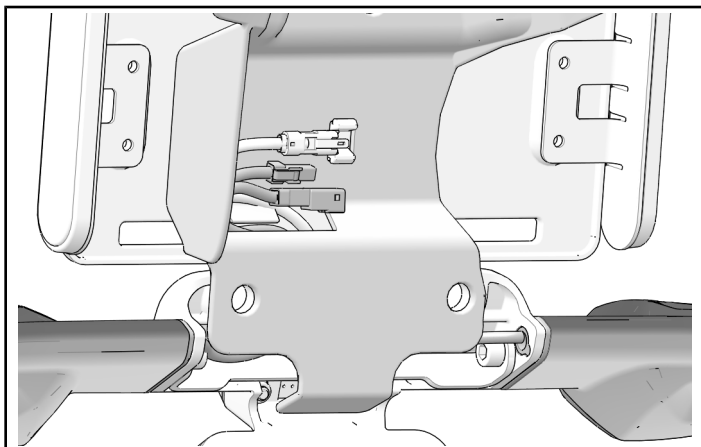

3. Reinstall license plate assembly onto license plate arm with three screws ④.

### TORQUE

Three screws ④: 96 in. lbs. (11 Nm)

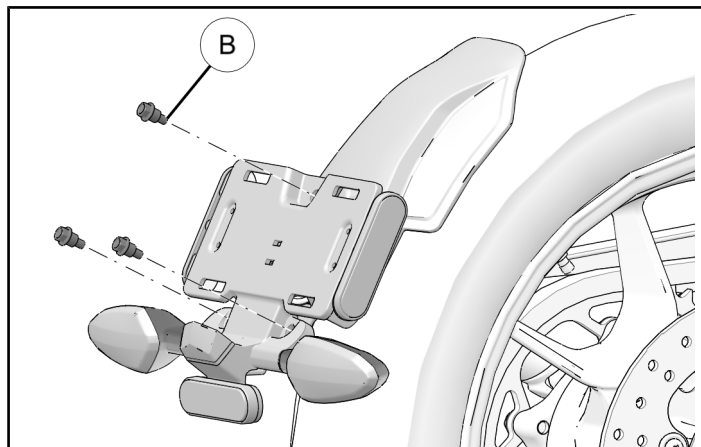

4. Join RH turn signal, LH turn signal, and license plate connectors to coordinating connectors on chassis harness.

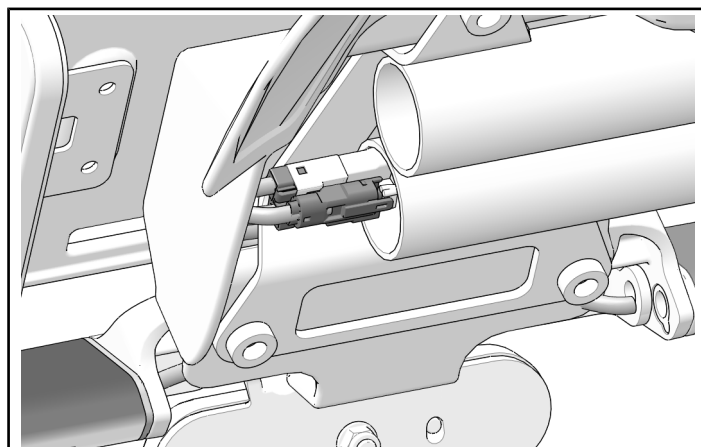

## VEHICLE REASSEMBLY

### GENERAL

1. Reinstall license plate.
2. Test turn signals to ensure harnesses are accurately connected.

## HEADLIGHT COWL INSTALLATION (IF APPLICABLE)

1. Install headlight cowl onto turn signal mounts and headlight cowl mounts with four screws **A** and four washers **B**.

### TORQUE

Four screws **A**: 18 in. lbs. (2 Nm)

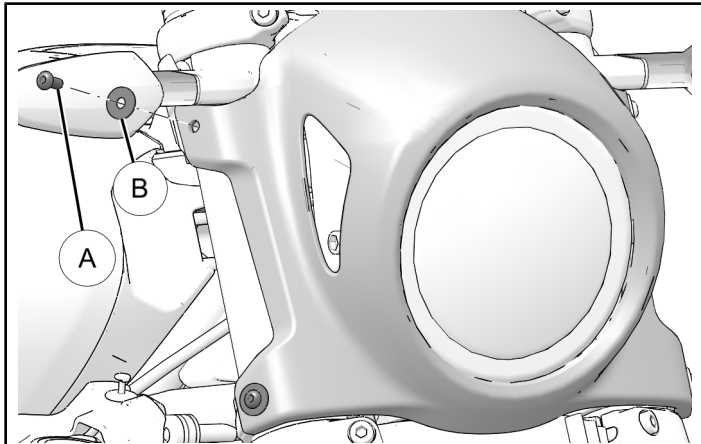

## FEEDBACK FORM

A feedback form has been created for the installer to provide any comments, questions or concerns about the installation instructions. The form is viewable on mobile devices by scanning the QR code or by clicking [HERE](#) if viewing on a PC.

### FEEDBACK FORM

