

LICENSE PLATE FRAME KIT



P/N 2882863, 2882864

APPLICATION

2014 and newer North American Indian® Chief®, Springfield®, Chieftain®, and Roadmaster® Motorcycles.

BEFORE YOU BEGIN

Read these instructions and check to be sure all parts and tools are accounted for. Please retain these installation instructions for future reference and parts ordering information.

KIT CONTENTS

This Kit includes one of the two kits below (See kit numbers for reference):

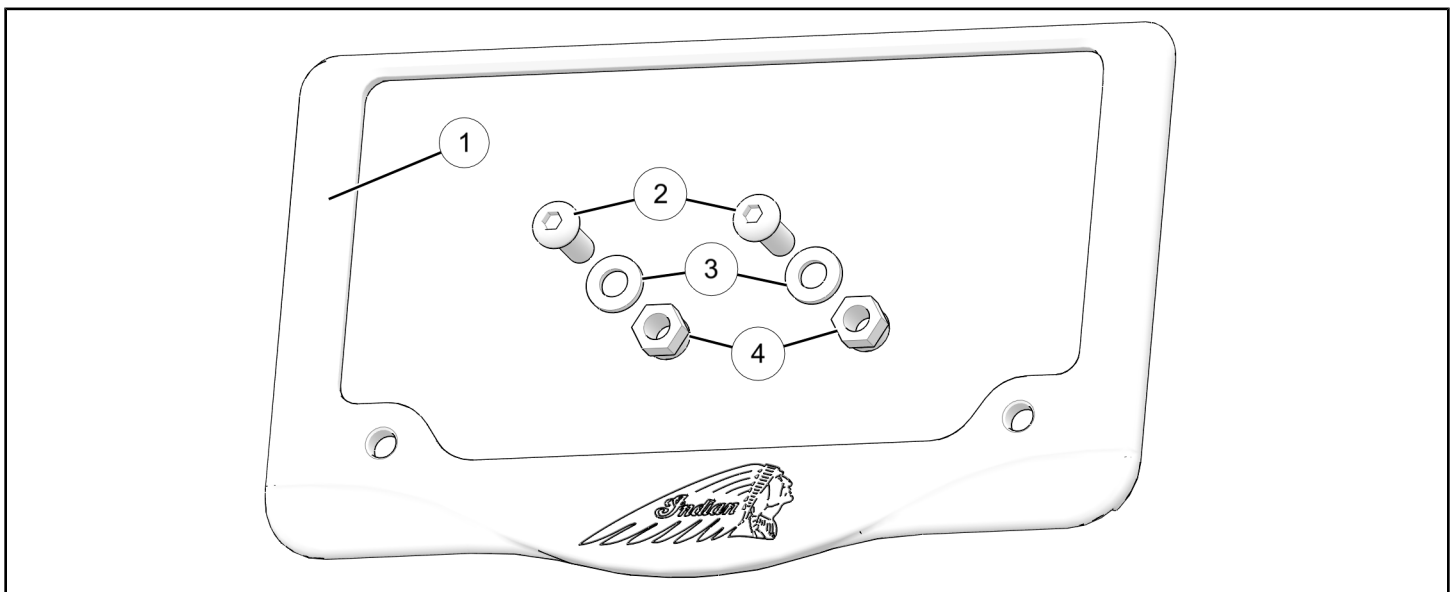
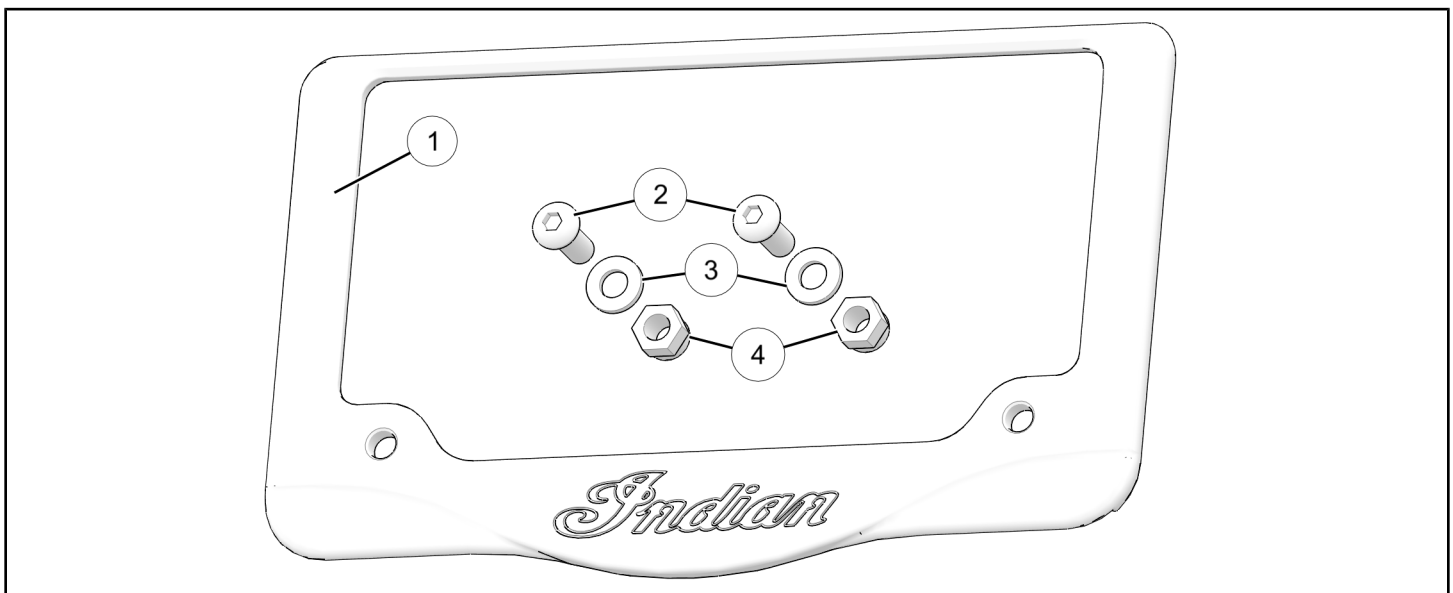

NOTE

XXX = Indian® Color Code. (For Example: 266 = Black)

REF	QTY	PART DESCRIPTION	PART NUMBER
1	1	Frame, License Plate, Script Frame, License Plate, Headress	5141376-XXX 5141377-XXX
2	2	Screw, Hex Button Head, M6 X 1.0 X 16	7517494
3	2	Washer, 6.4 X 12.5 X 1.6	7556337
4	2	Nut, Hex, Nylon Locking, M6 X 1.0	7546704
	1	Instructions	9928044

TOOLS REQUIRED

- Safety Glasses
- Socket Set, Hex Bit, Metric
- Wrench Set, Metric

IMPORTANT

Your Indian License Plate Frame Kit is exclusively designed for your vehicle. Please read the installation instructions thoroughly before beginning. Installation is easier if the vehicle is clean and free of debris. For your safety, and to ensure a satisfactory installation, perform all installation steps correctly in the sequence shown.

ASSEMBLY TIME

Approximately 12 minutes

INSTALLATION INSTRUCTIONS

NOTE

Do not use if this frame covers any text or a registration sticker on your license plate.

1. Turn key or ignition switch to “OFF” position and remove key. If equipped with keyless fob, remove fob from proximity of vehicle.
2. Ensure motorcycle is parked on a flat surface, kickstand is fully extended, and vehicle is stable prior to installation.
3. Remove license plate and discard screws.
4. Loosely install license plate frame ① and license plate A using two hex head screws ②, two washers ③ and nuts ④.

5. Counter-hold nuts ④ and torque screws ② to specification.

TORQUE

84 in. lbs. (9.5 Nm)

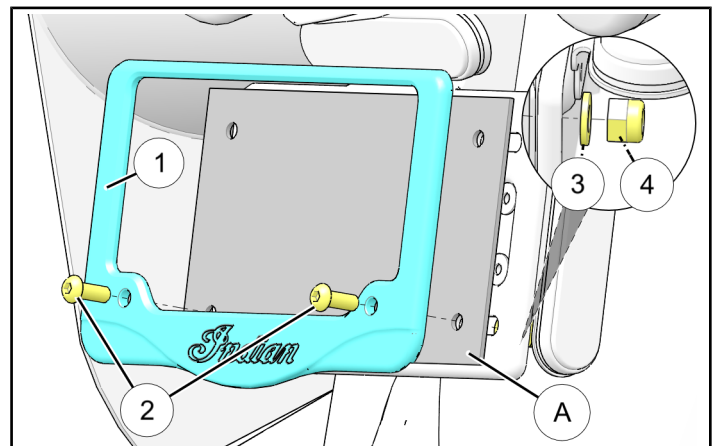

FEEDBACK FORM

A feedback form has been created for the installer to provide any comments, questions or concerns about the installation instructions. The form is viewable on mobile devices by scanning the QR code or by clicking [HERE](#) if viewing on a PC.

FEEDBACK FORM

