

SADDLEBAG AUDIO WIRE HARNESS KIT

P/N 2880986



APPLICATION

ALL INDIAN MOTORCYCLES WITH BOTH TRUNK AND SADDLEBAG AUDIO INSTALLED

BEFORE YOU BEGIN

Read these instructions and check to be sure all parts and tools are accounted for. Please retain these installation instructions for future reference and parts ordering information.

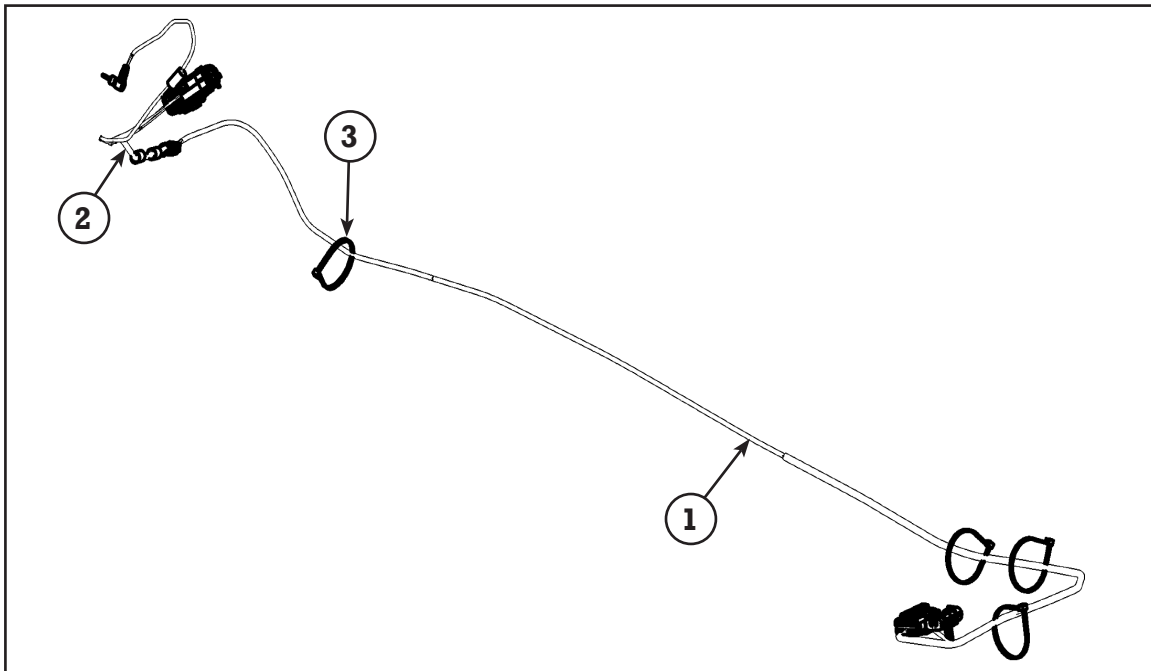

KIT CONTENTS

Ref	Qty	Part Description	Part Number
1	1	Vehicle Harness	2412576
2	1	Harness, Audio, Accy	2412815
3	4	Panduit	7080138
	1	Instructions	9925955

TOOLS NEEDED

Socket Extension	Flashlight	Ratchet
Diagonal Cutters	10 mm Socket Set	Cutters
10 mm Open End Wrench	4 mm Hex Key Socket (Standard)	Torque Wrench
5 mm and 6 mm Hex Key Sockets	4 mm Hex Key Socket (Ball-End Long)	

APPROXIMATE ASSEMBLY TIME

90 min

IMPORTANT

Your Indian SADDLEBAG AUDIO WIRE HARNESS KIT is exclusively designed for your vehicle. Please read the installation instructions thoroughly before beginning. Installation is easier if the vehicle is clean and free of debris. For your safety, and to ensure a satisfactory installation, perform all installation steps correctly in the sequence shown.

INSTALLATION INSTRUCTIONS

1. On a solid, level surface, park motorcycle on side stand and turn handlebars fully to the left.
2. Raise windshield to full up position.
3. Remove the three fasteners holding the seat in place (one in the back (5 mm hex), and one on each side (6 mm hex)).
4. Remove the seat, being careful to unplug any wire harnesses that may be connected to the seat. Set the seat aside. See the owner's manual for instructions on seat removal.
5. Disconnect the negative battery terminal. See the owner's manual for instructions on locating the battery.
6. Remove the leather (A) from the plastic button (B) at the bottom (just like a shirt button).



7. Loosen the socket head screw at front of console (C) using 4 mm hex key socket (just loosen 3 to 5 turns, DO NOT FULLY REMOVE).
8. Remove the socket head screw at the rear of the console using 4 mm hex key socket.



9. Gently slide console forward until console is clear of front socket head screw, then carefully lift up and out to the right (take care to not scratch the fuel tank).



10. Before fully removing the console, disconnect the three wire harness connectors (D) (power button, bag lock, and heated grips (if installed)). Mark the connectors with a marker before unplugging to aid in identification for re-assembly.

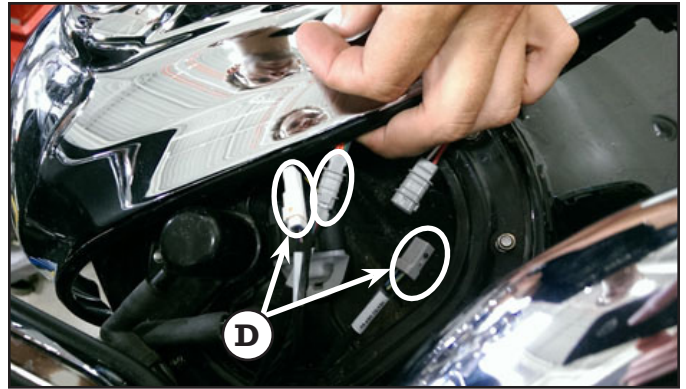

11. Once wires and leather are disconnected from the motorcycle, carefully set the center console assembly aside.
12. Disconnect the two vent lines at the front (E) and rear (F) of the tank.

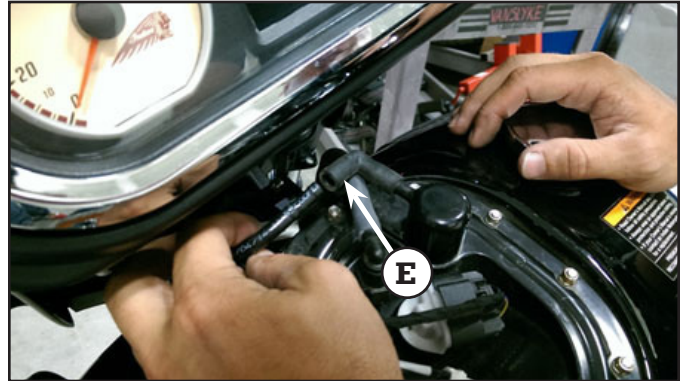

13. Disconnect the fuel line (G) by pushing in on both sides while pulling up.

NOTE: A small amount of fuel from the fitting may drip out. Have a towel or rag and a rubber band to affix it around the end of the fitting to prevent fuel from dripping onto the tank. Follow standard safety precautions for dealing with flammable liquids.

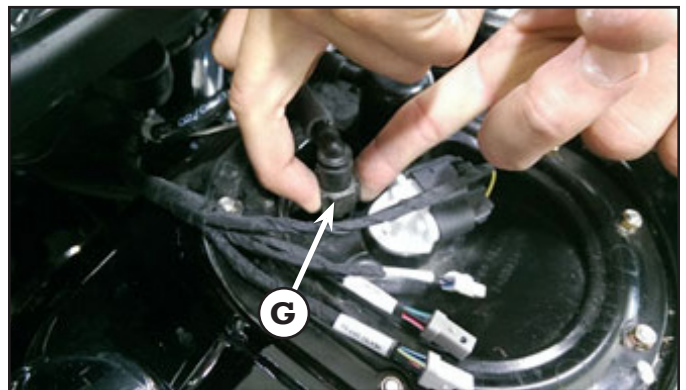

14. Disconnect the fuel pump wire harness (H).

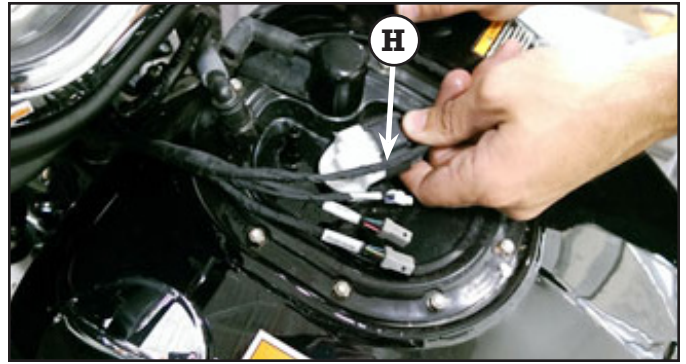

15. Remove the two socket head screws (J) from base of fuel tank (using 6 mm hex key).



16. Remove the fuel tank by carefully lifting up the base while sliding the tank towards the rear of the vehicle.

17. Remove the wire tray cover (K) by cutting the zip tie at the base, and prying up the cover from one side.

NOTE: Note how the zip tie is routed at the base for later assembly.

NOTE: Though not necessary, it may be easier to route the wires if the VCM / battery cover is moved out of the way. To do this, remove the M6 fastener that holds the battery cover in place. Lift battery cover with VCM attached and tip forward.

CAUTION: Care must be taken to not allow the VCM to contact the battery terminals. Also, no metal must be allowed to touch both the terminal and VCM at the same time (such as wrenches, etc.). Contact with terminals will damage the VCM.

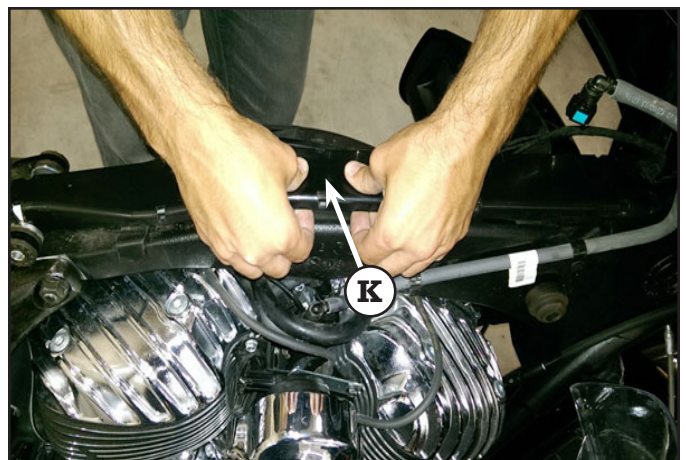
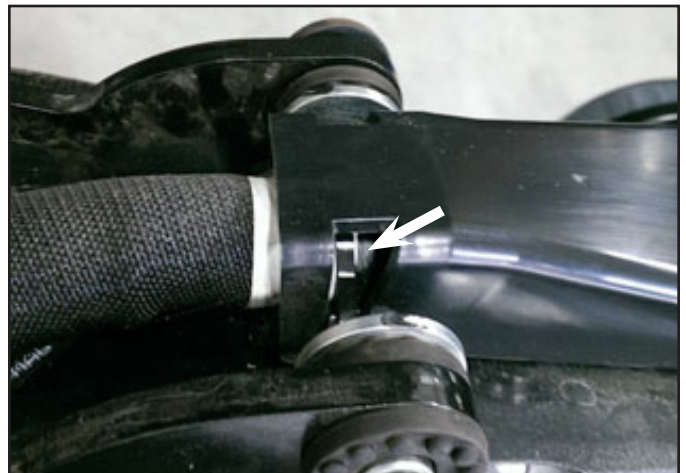

Remove Outer Fairing

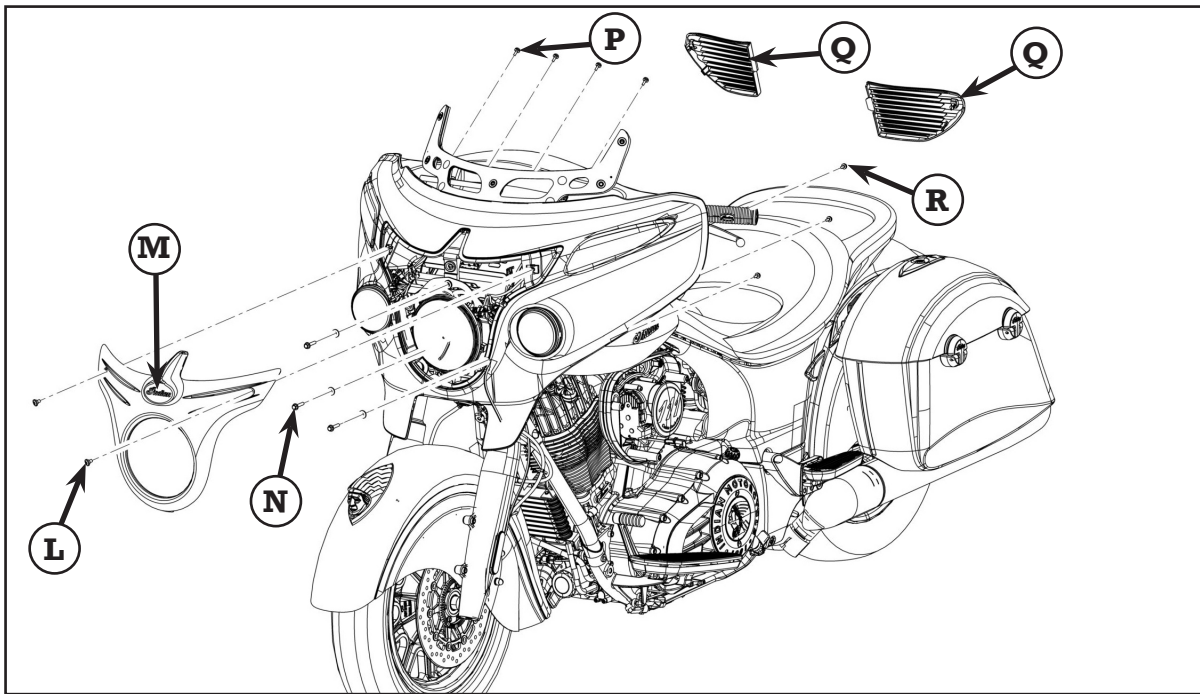

18. Remove chrome trim – remove two upper fasteners (L) using the 4 mm hex socket. The trim piece is now held on by a hook on the bottom and darts and grommets on the top. Pull forward on the top of the trim to disengage the darts, then lift the bezel (M) up and out of fairing. Torque the fasteners to 36 in-lbs. (4.07 Nm). See Figure.

19. Remove headlight and unplug - using 10 mm socket, remove the three fasteners (N) holding the headlight in place. Unplug wire harness from back of light, and carefully set headlight assembly to the side. Torque the fasteners to 36 in-lbs. (4.07 Nm).

20. Remove speaker covers (Q) - pull rearward on outboard edge to disengage darts from grommets and then slide outboard.

NOTE: Care should be taken when removing the speaker covers to avoid scratching the dash.

21. Remove three fasteners (R) on each side between inner and outer fairings using 4 mm hex key socket. See Figure.

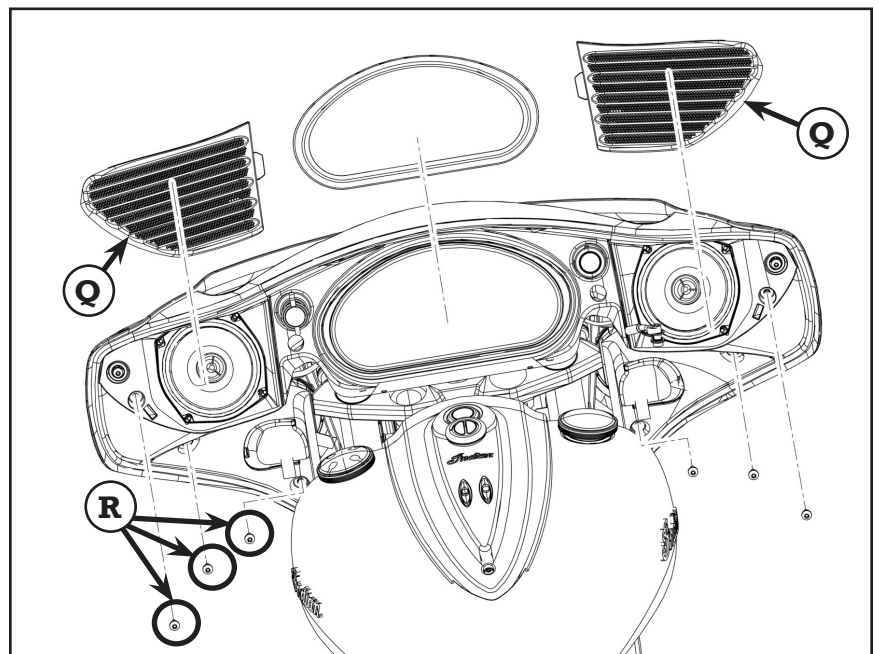

22. Remove four fasteners (P) along top edge of fairing using 4 mm long-ball-end hex key socket and extension. See Figure.
23. Lift fairing away from bike and unplug wire harnesses for turn signals and foglights.
24. Set fairing aside where it will not get damaged/scratched.

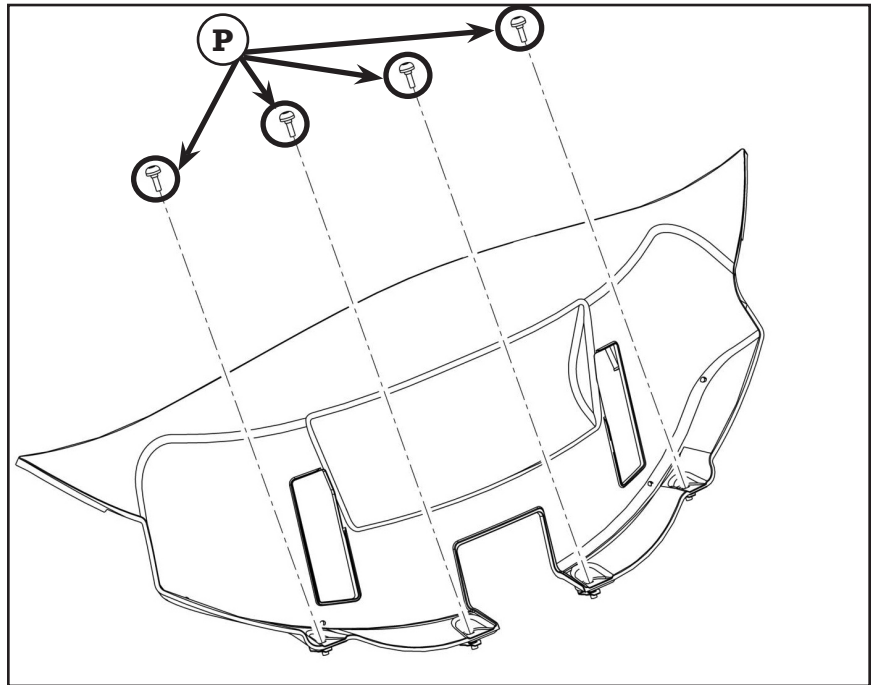

Slide Out Radio

25. Take a picture of how wire harnesses are routed around headlight opening for future reference.
26. Cut wire harness panduits, and lift wires up and out of the way.
27. Remove three screws (S) holding radio in place using a 10 mm open end wrench or 10 mm socket (where able to fit).
28. Slide radio forward and down to expose RH side of radio.
29. Remove rubber plug from RH side of radio (this won't be reused).
30. Insert audio harness plug into RH side of radio.

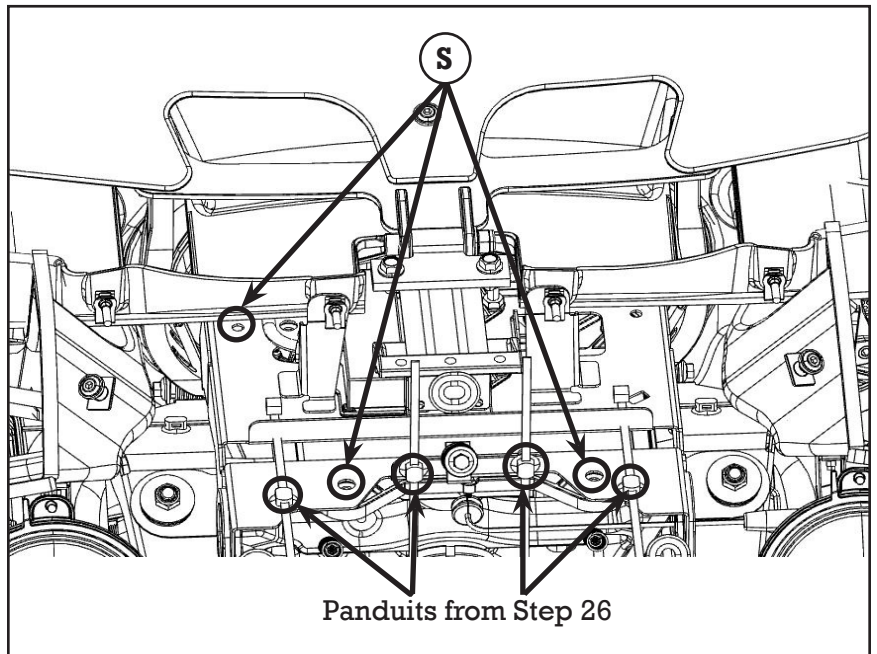

31. Place loose wire with gray connector into triple area on LH side of bike (this is only needed if customer is using the saddlebag audio and trunk at same time).
32. Feed radio jack through grommet.
33. Pry up the fairing visor and feed jack cord through the gap (same routing as USB cable).

Reinstall

34. Installation is reverse of disassembly, with torque values as shown below.

- a. Chrome Trim Screws (L): 36 in-lbs. (4.07 Nm).
- b. Headlight Bracket Screws (N): 36 in-lbs. (4.07 Nm).
- c. Fairing Top Edge Screws (P): 36 in-lbs. (4.07 Nm).
- d. Inner x Outer Fairing Screws (R): 36 in-lbs. (4.07 Nm).
- e. Radio Screws (S): 36 in-lbs. (4.07 Nm).

35. Be sure to connect all wire harnesses correctly (see picture from Step 25 for routing details).

36. Lay audio harness (T) over bike with the large end towards the rear of the vehicle, following the route of the existing trunk wire harness as much as possible.

NOTE: Route the wires underneath the negative battery cable; be sure to tuck the cables beneath the edge of the midcast frame pieces to avoid pinching them when the seat is installed.

37. Once cable routing is set (yellow arrows), loosely assemble the zip ties (white arrows) to hold the audio wire harness to the existing trunk wire harness bundle, but do not tighten.

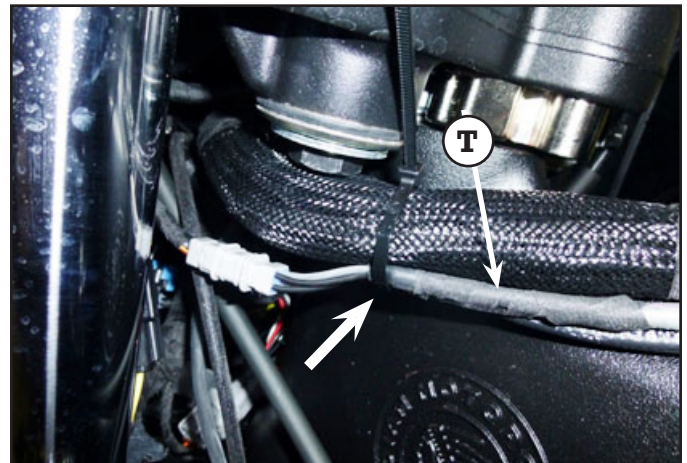
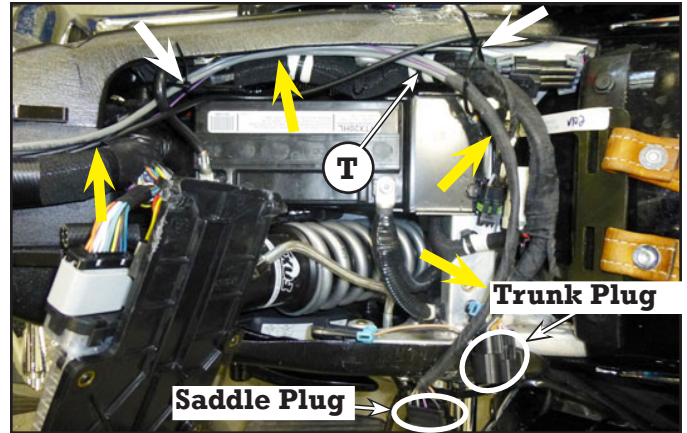

38. Now locate the mating plugs.

- a. In the front of the vehicle, between the frame and left fork and between the upper and lower triple clamps you'll find an unused gray eight pin JST connector (U) shown in figure (this is the part of Audio Harness Kit P/N 2880302). Connect with audio wire harness.
- b. In the underseat area, connect the saddlebag audio wire harness (V) and plug the black and blue power/ground connector into the mating black/blue connector on the trunk wire harness bundle (W) shown in figure.

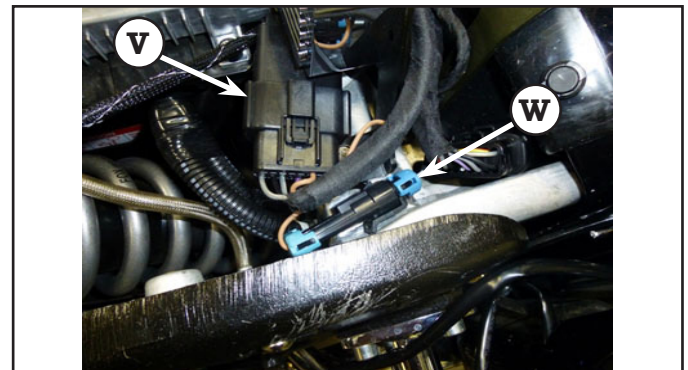

39. After making connections at both ends, starting at the rear of the vehicle, put the wire in final position, and tighten the nearest zip ties. Follow the wire towards the front of the vehicle, making adjustments to final routing and tightening zip ties as you come to them. Any slack should be captured in the fairing of the bike.

40. Installation of console is reverse of removal.

- | | |
|--------------------------------------|------------------------|
| a. Fuel Tank Screws | 12 ft. lbs. (16.3 Nm). |
| b. Seat Screws: | 18 ft. lbs. (24.4 Nm). |
| c. 4 mm Socket head screws for tank: | 84 in-lbs. (9.5 Nm). |

41. Route zip tie (X) as shown after reinstalling the wire tray cover. Trim excess length.



CAUTION: Ensure that the power lock and heated grip switches are plugged into the correct wire harness (see white labels on vehicle side harnesses and marks you made earlier).

Ensure all wire routing is clear of moving parts.

