

# DRIVER SEAT RAIL KIT

**P/N 2880752-156 CHROME,  
2880752-266 GLOSS BLACK**



## APPLICATION

2014-2016 INDIAN MOTORCYCLES WITH THE THUNDERSTROKE 111

## BEFORE YOU BEGIN

Read these instructions and check to be sure all parts and tools are accounted for. Please retain these installation instructions for future reference and parts ordering information.

## KIT CONTENTS

This Kit includes:

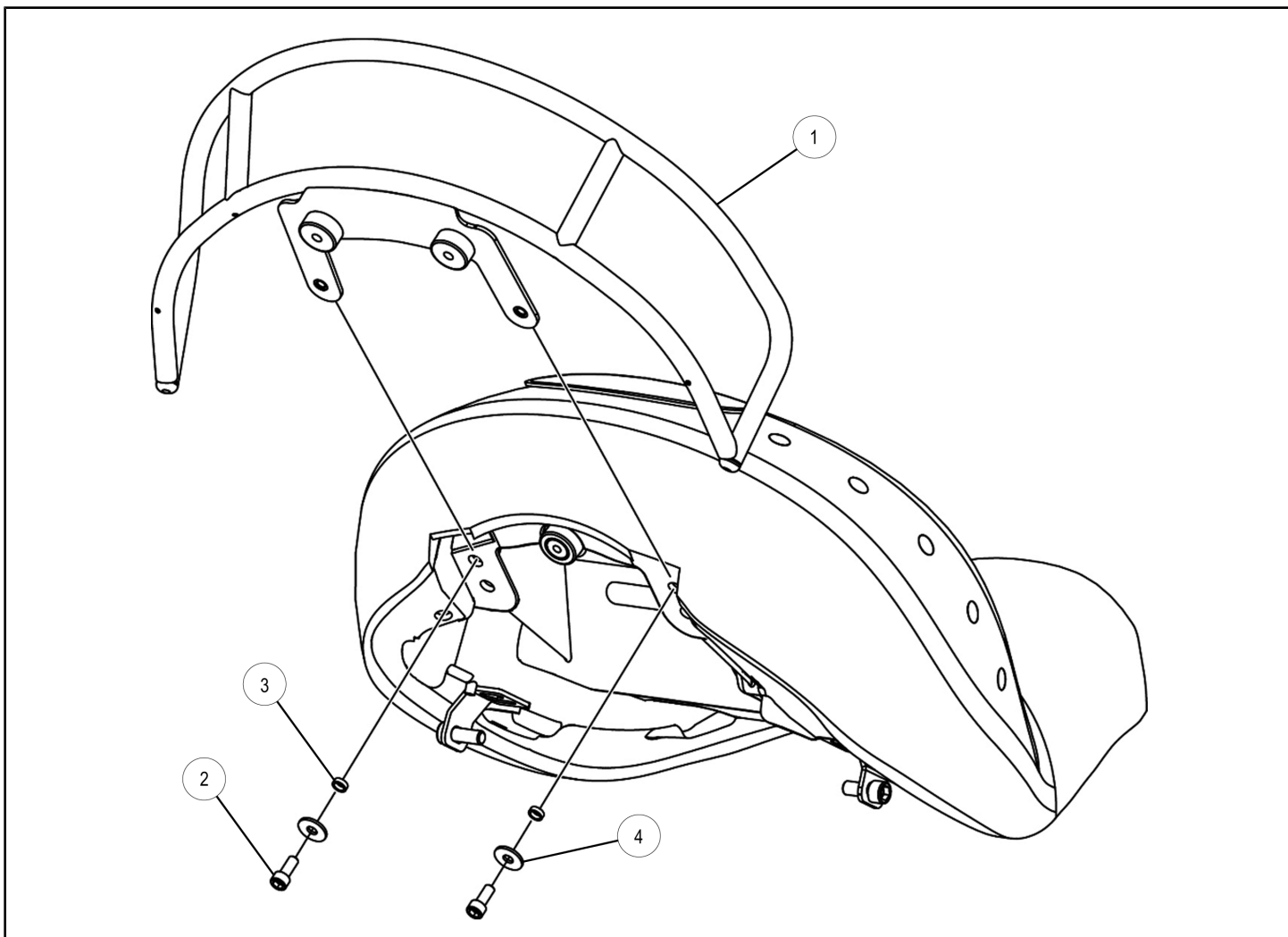

REF	QTY	PART DESCRIPTION	PART NUMBER
1	1	Seat Rail	1021114
2	2	Cap Screw - M6 X 1.0 X 15	7517272
3	4	Spacer - M6	5139013
4	2	Washer - 6.4 X 18 X 1.6	7556565
	1	Instructions	9924384

## TOOLS REQUIRED

- 5mm Hex Key Socket
- Torque Wrench

- 6mm Hex Key Socket
- Protective Cloth

## IMPORTANT

Your Indian DRIVER SEAT RAIL KIT is exclusively designed for your vehicle. Please read the installation instructions thoroughly before beginning. Installation is easier if the vehicle is clean and free of debris. For your safety, and to ensure a satisfactory installation, perform all installation steps correctly in the sequence shown.

## ASSEMBLY TIME

Approximately 15 minutes

## INSTALLATION INSTRUCTIONS

### NOTE

The driver seat rail cannot be installed with the use of a passenger seat.

### NOTE

The driver seat rail can be installed with or without the use of a Solo Rack Kit (PN 2879545). If installing with Solo Rack Kit, substitute installation Steps 3 – 7 of instructions PN 9924325 after Step 3 in below “Installation” section.

### NOTE

Protect finished surfaces prior to component removal and installation.

## SEAT REMOVAL

1. Remove three M8 cap screws mounting the driver and passenger seat.

### NOTE

Some seats have the cap screws located under the driver seat valance. Set aside screws for re-assembly.

2. Slide seat rearward while lifting on the rear of the seat.
3. If equipped with a passenger seat, remove four M6 button head screws attaching the passenger seat assembly to the driver seat. Separate seats.

## INSTALLATION

1. If installing with a Solo Rack Kit (PN 2879545), the solo rack must be fastened to the seat base prior to the seat rail installation and two seat rubber bumpers must be removed.

2. With the driver seat upside down, slide the seat rail mount into the passenger seat openings in the driver seat base.
  - a. Install one spacer ③ into each rear hole in the seat base.
  - b. (Installation with Solo Rack Kit only): Insert two spacers ③ into the rear holes in the seat base.
3. Install two washers ④ and two cap head screws ② into the rear mounting holes and torque to specification.

### TORQUE

84 +/- 4 in. lbs. (9.5 +/- 0.5 Nm)

## SEAT INSTALLATION WITHOUT SOLO RACK KIT

1. Use protective cloth to cover and protect the rear fender.
2. Slide the seat assembly onto the vehicle while supporting the seat rail.
3. Install the two previously removed M8 cap screws from Step 1 of “Seat Removal” section to fasten the seat and rail assembly to the vehicle.
4. Torque two M8 driver seat mount screws to specification.

### NOTE

18 +/- 2 ft. lbs. (24.4 +/- 2.7 Nm)

### CAUTION

This seat rail is for aesthetic purposes only. It is not intended to be used as a grab handle, lifting point or used as a tie down.