

CRUISER SPOOLS KIT

KIT P/N 2879740



Application

All MY14 Cruiser without bags

NOTE: Before you begin, read these instructions and check to be sure all parts and tools are accounted for in package. Please retain these installation instructions for future reference and parts ordering information. For your safety, and to ensure a satisfactory installation, perform all installation steps correctly in the sequence shown below.

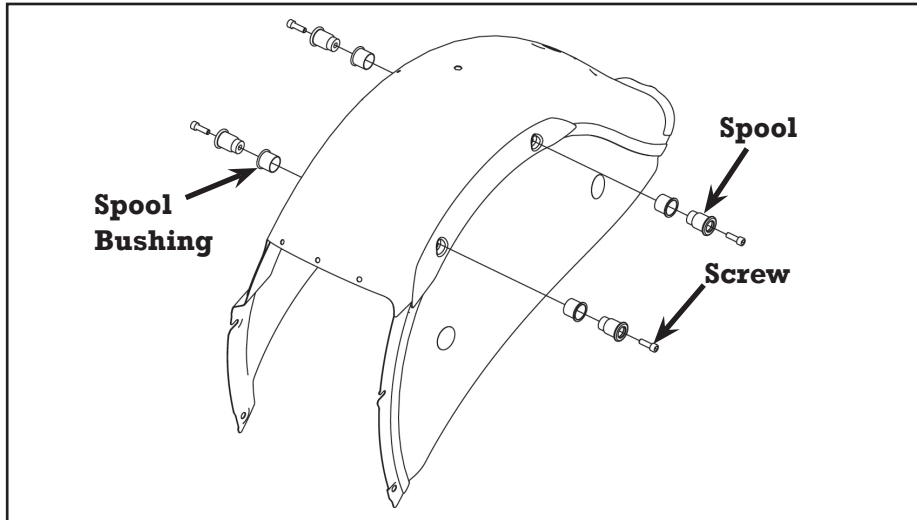

Kit Contents:

Quantity	Part Description	Part Number
4	Spool	5138776
4	Spool Bushing	5450768
4	Screw, M8 x 25 long	7519859
1	Instructions	9924522

You will need to supply:

M6 Hex Key Socket

Torque Wrench

APPROXIMATE ASSEMBLY TIME: 15 minutes

INSTALLATION INSTRUCTIONS

1. Slip bushings over spools with flanges adjacent to each other.
2. Install spools assembly to vehicle using screw. Torque to 18 +/- 2 ft.lb (24.4 +/- 2.7 Nm).