

HEAT SHIELD KIT



P/N 2889217-XXX

BEFORE YOU BEGIN

Read these instructions and check to be sure all parts and tools are accounted for. Please retain these installation instructions for future reference and parts ordering information.

APPLICATION

Verify accessory fitment at www.indianmotorcycle.com.

KIT CONTENTS

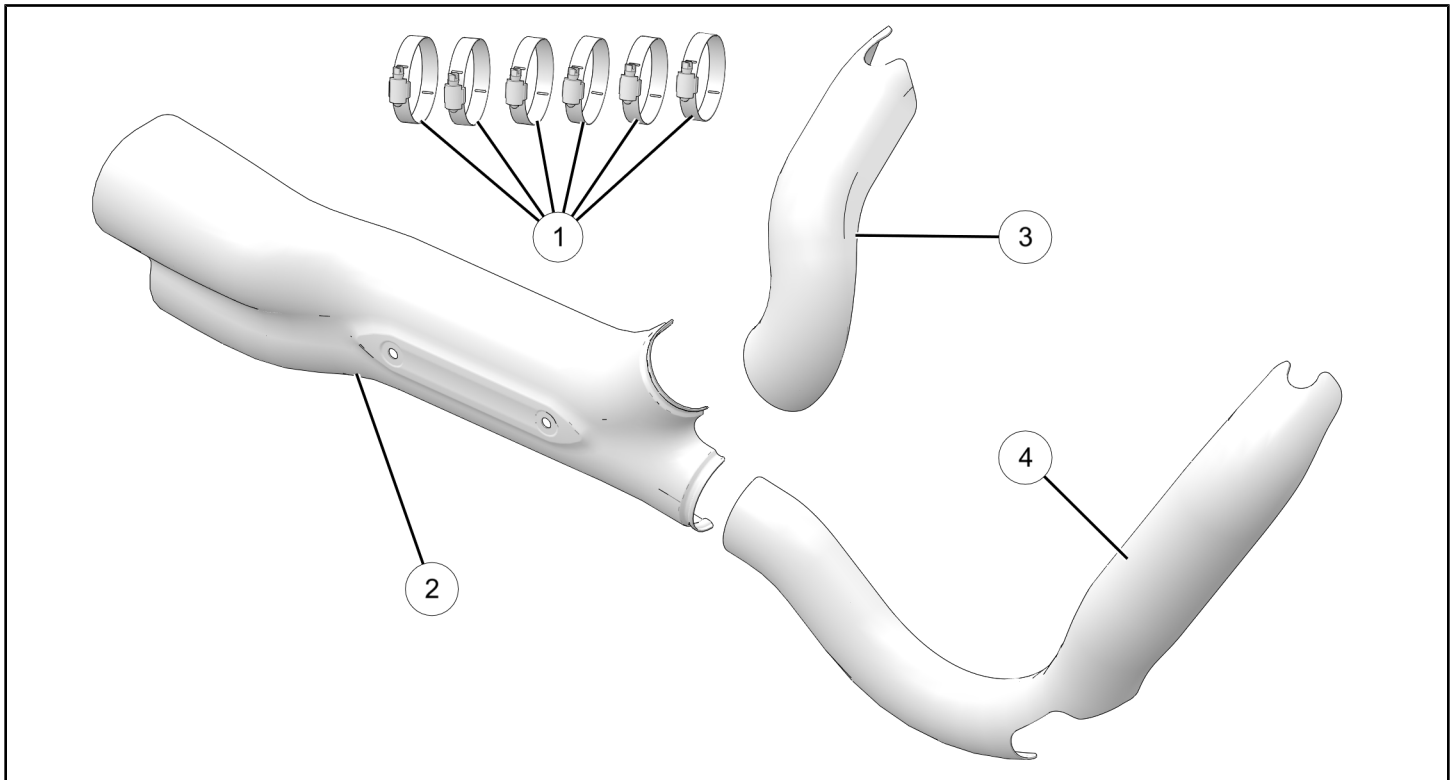

NOTICE

XXX = Indian Motorcycle® color code (For example: 266 = Black)

REF	QTY	PART DESCRIPTION	P/N AVAILABLE SEPARATELY
1	6	Clamp-Worm Drive 2.25 in Dia.	7082310
2	1	Shield, Catalytic Converter	1263415-XXX
3	1	Shield, Rear	1263414-XXX
4	1	Shield, Front	1263413-XXX

TOOLS REQUIRED

- Safety Glasses
- Socket Set, Metric
- Socket Set, Hex Bit, Metric
- Torque Wrench

IMPORTANT

Your Indian Motorcycle® Heat Shield Kit is exclusively designed for your vehicle. Please read the installation instructions thoroughly before beginning. Installation is easier if the vehicle is clean and free of debris. For your safety, and to ensure a satisfactory installation, perform all installation steps correctly in the sequence shown.

INSTALLATION INSTRUCTIONS

VEHICLE PREPARATION

GENERAL

1. Park motorcycle on a flat surface, fully extend kickstand, and make sure vehicle is stable.
2. Turn key or ignition switch to OFF position and remove key. If equipped with keyless fob, remove fob from proximity of vehicle.

REMOVAL PROCEDURE

⚠ WARNING

Engine and exhaust components get hot and remain hot for a period of time after the engine is stopped. Wear insulated protective clothing or wait for components to cool sufficiently before working on the machine.

IMPORTANT

Protect all finished and painted surfaces during these operations.

REMOVE RH FOOT CONTROL

1. Remove and keep the two fasteners **A** that secure the RH foot control to the motorcycle frame.

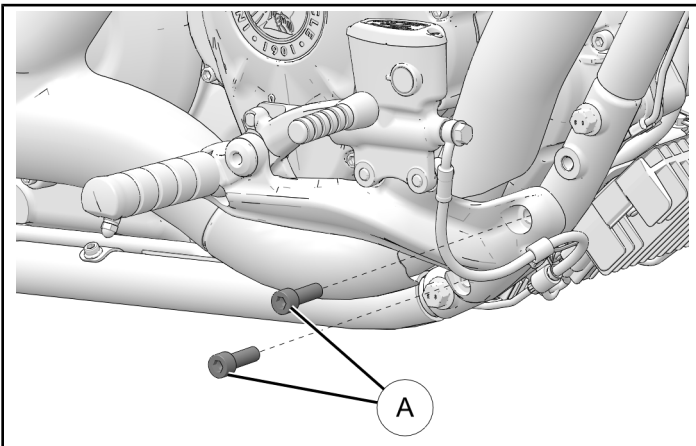

2. Support the RH foot control with a strap or similar equipment.

IMPORTANT

Make sure to support and keep the RH foot control upright as the brake line will remain connected.

REMOVE REAR HEAT SHIELD

1. Remove and discard the two worm-drive clamps **B**.

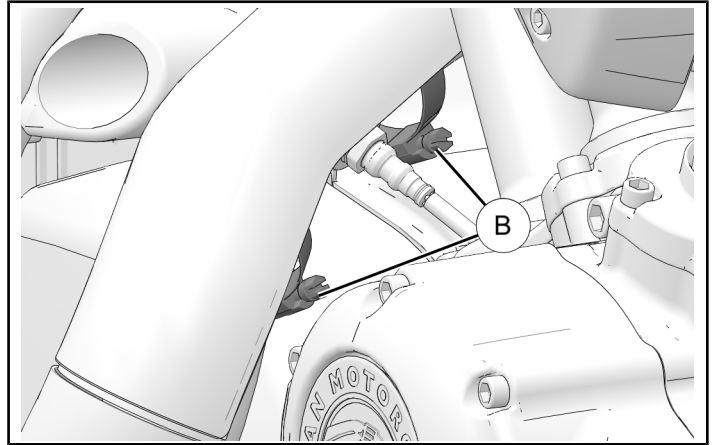

2. Remove the rear heat shield **C**.

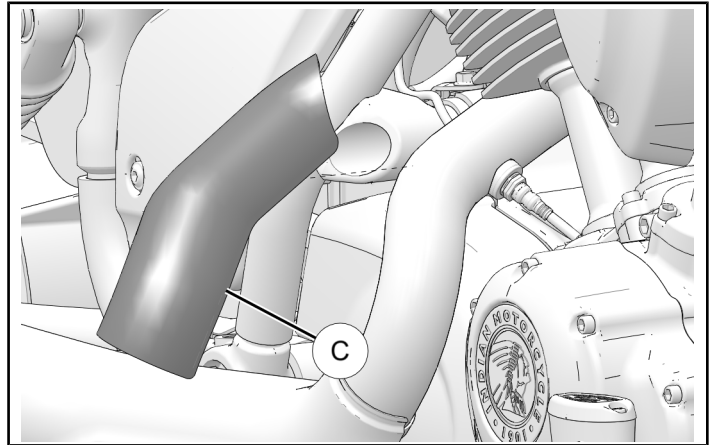

REMOVE FRONT HEAT SHIELD

1. Remove and discard the three worm-drive clamps (B).

NOTICE

Front heat shield hidden from image for illustration clarity.

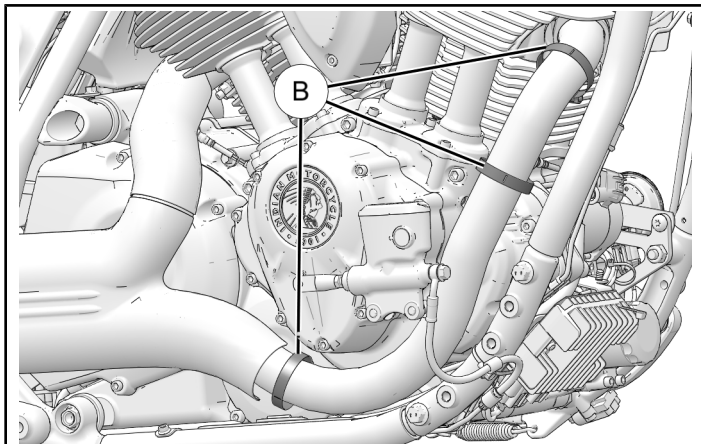

2. Remove the front heat shield (D).

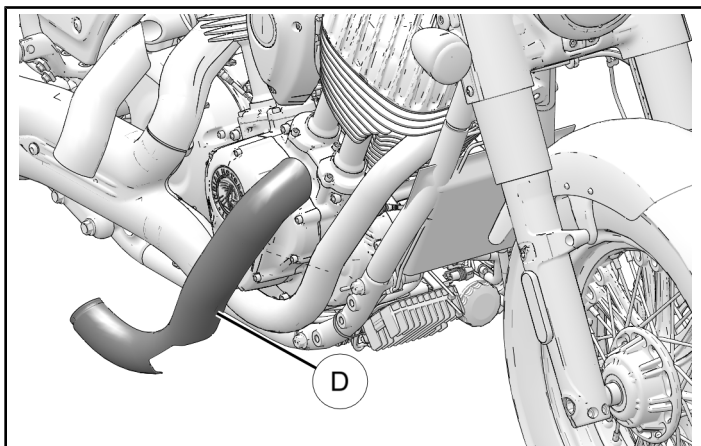

REMOVE CATALYTIC CONVERTER HEAT SHIELD

1. Remove and discard the one worm-drive clamp (B).

NOTICE

Catalytic converter heat shield hidden from image for illustration clarity.

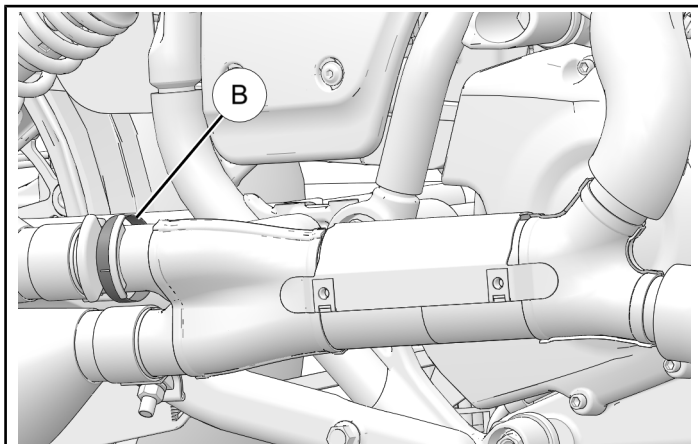

2. Remove and keep the two fasteners (E) that secure the heat shield to the motorcycle.

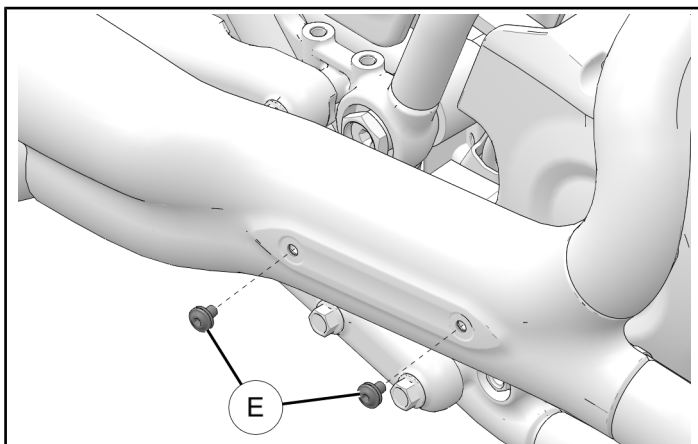

3. Remove the catalytic converter heat shield (F).

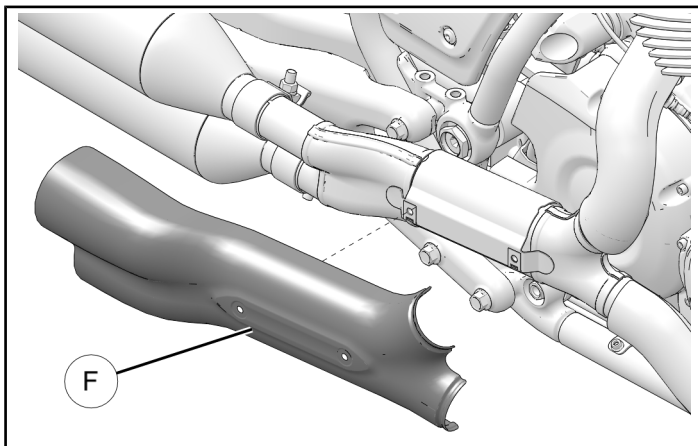

ACCESSORY INSTALLATION

IMPORTANT

Protect all finished and painted surfaces during these operations.

INSTALL CATALYTIC CONVERTER HEAT SHIELD

1. Open and insert a new worm-drive clamp ① on the accessory catalytic converter heat shield ② as shown.

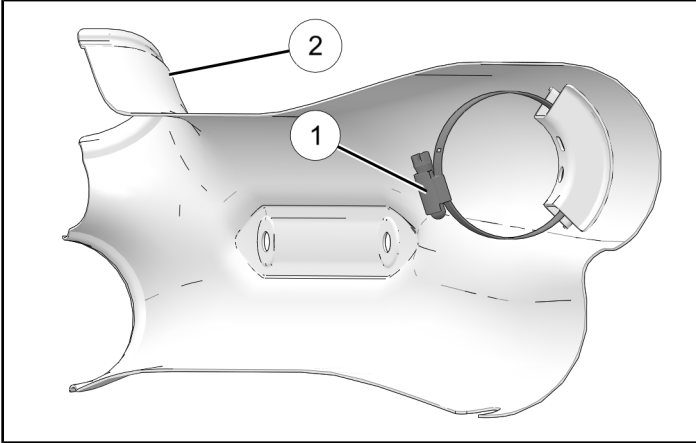

2. Open the worm-drive clamp far enough to slip it over the exhaust pipe, and then put the accessory catalytic converter heat shield ② on the motorcycle.

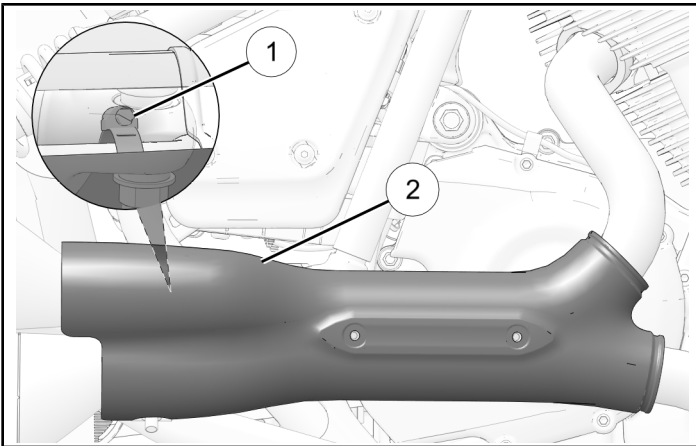

3. Install the two heat shield fasteners ⑤ and torque to specification.

TORQUE

Heat Shield Fasteners ⑤:
88 in-lbs (10 Nm)

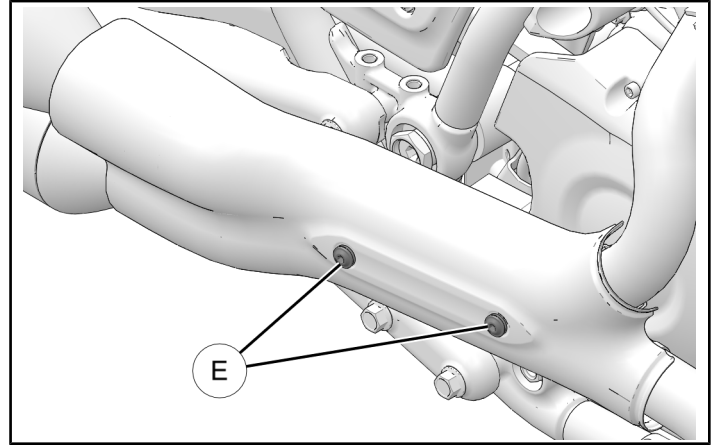

4. Torque the worm-drive clamp to specification.

TORQUE

Worm-Drive Clamp ①:
31 in-lbs (3.4 Nm)

INSTALL FRONT HEAT SHIELD

1. Open and insert three new worm-drive clamps ① on the accessory front heat shield ④ as shown.

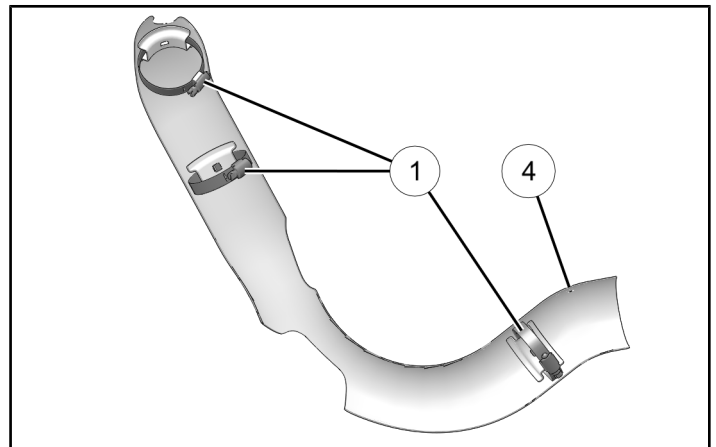

- Open the worm-drive clamps far enough to slip them over the exhaust pipe, and then put the accessory front heat shield ④ on the motorcycle. Make sure the clamps are set as shown.

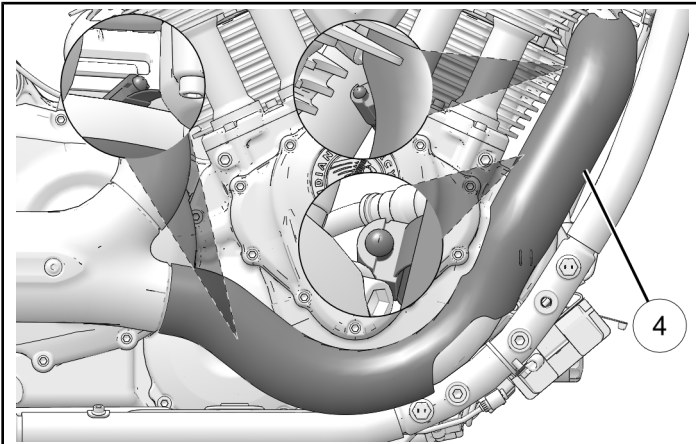

- Make sure the seams between the heat shields are aligned, and then torque the worm-drive clamps to specification.

TORQUE

Worm-Drive Clamp ①:
31 in-lbs (3.4 Nm)

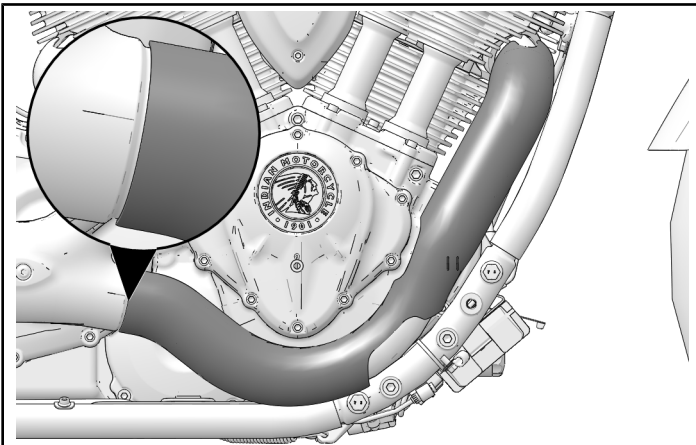

INSTALL REAR HEAT SHIELD

- Open and insert two new worm-drive clamps ① on the accessory rear heat shield ③ as shown.

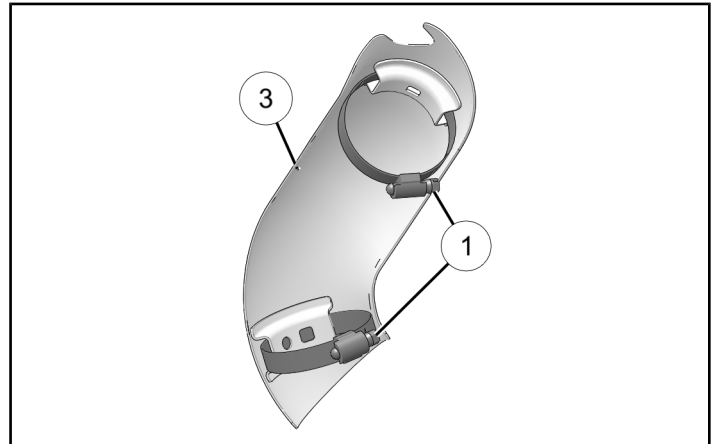

- Open the worm-drive clamps far enough to slip them over the exhaust pipe, and then put the accessory rear heat shield ③ on the motorcycle.

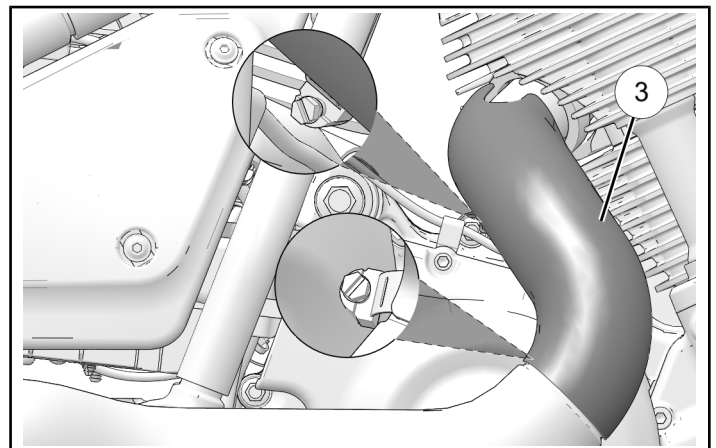

- Make sure the seams between the heat shields are aligned, and then torque the worm-drive clamps to specification.

TORQUE

Worm-Drive Clamp ①:
31 in-lbs (3.4 Nm)

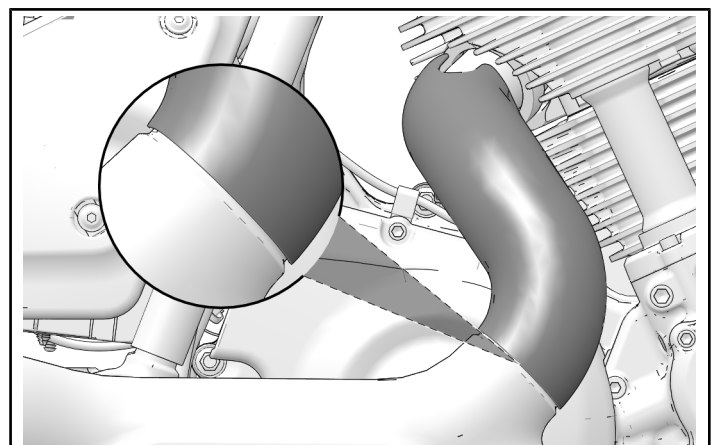

VEHICLE REASSEMBLY

INSTALL RH FOOT CONTROL

1. Raise the RH foot control into position on the motorcycle.
2. Install the two fasteners (A) that secure the RH foot control to the motorcycle frame. Torque the fasteners to specification.

TORQUE

RH Foot Control Fasteners (A):
35 ft-lbs (47.5 Nm)

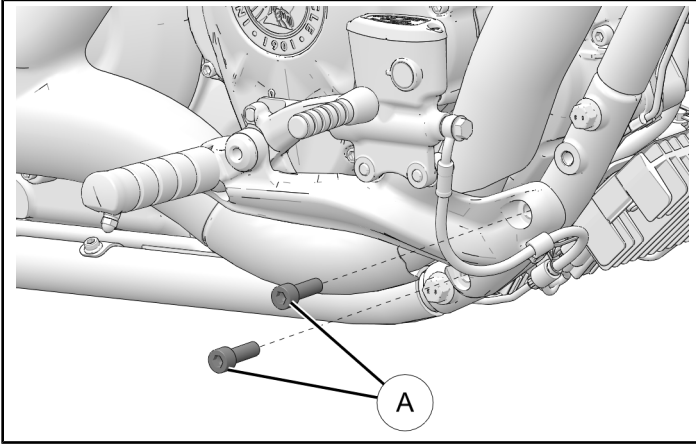

INSTRUCTION FEEDBACK FORM

A feedback form has been created for the installer to provide any comments, questions or concerns about the installation instructions. The form is viewable on mobile devices by scanning the QR code or by clicking [HERE](#) if viewing on a PC.

