

# ÖHLINS® SHOCK ABSORBER KIT



P/N 2889063

## BEFORE YOU BEGIN

Read these instructions and check to be sure all parts and tools are accounted for. Please retain these installation instructions for future reference and parts ordering information.

## APPLICATION

Verify accessory fitment at [www.indianmotorcycle.com](http://www.indianmotorcycle.com).

### IMPORTANT

This accessory is not compatible with 19 in wheels.

## KIT CONTENTS

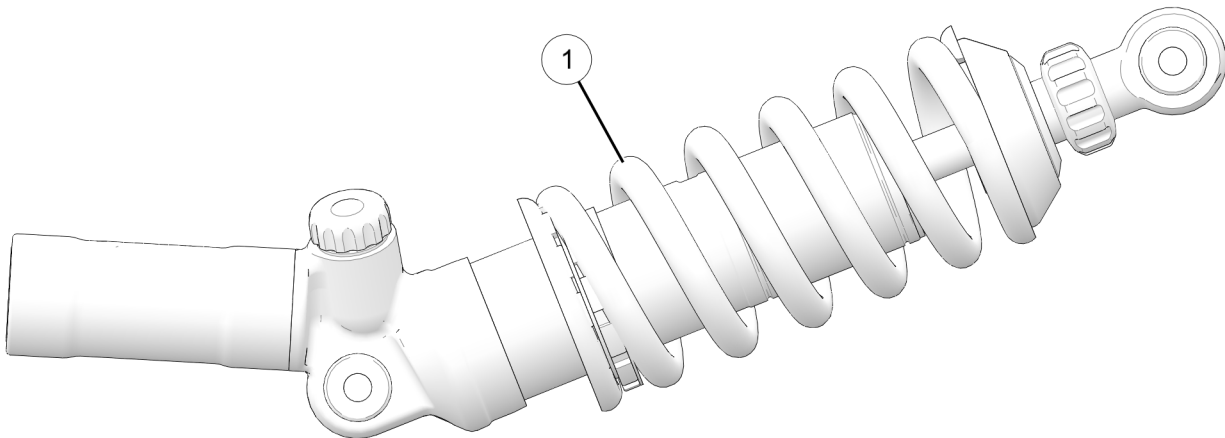

### NOTICE

XXX = Indian® color code (For example: 266 = Black)

REF	QTY	PART DESCRIPTION	P/N AVAILABLE SEPARATELY
1	1	Assembly-Shock	1824984-XXX

## TOOLS REQUIRED

- Safety Glasses
- Hex Key Set, Metric
- Platform Jack, Motorcycle
- Socket Set, Hex Bit, Metric
- Socket Set, Torx® Bit
- Torque Wrench
- **Special Service Tool:**
  - Spanner Wrench, P/N 2884176 (or equivalent)
- Vehicle Lift/Support Equipment

## IMPORTANT

Your Indian Motorcycle® Öhlins® Shock Absorber Kit is exclusively designed for your vehicle. Please read the installation instructions thoroughly before beginning. Installation is easier if the vehicle is clean and free of debris. For your safety, and to ensure a satisfactory installation, perform all installation steps correctly in the sequence shown.

## INSTALLATION INSTRUCTIONS

### VEHICLE PREPARATION

#### GENERAL

1. Park motorcycle on a flat surface, fully extend kickstand, and make sure vehicle is stable.
2. Turn key to OFF position and remove key.

#### MUFFLER REMOVAL

##### WARNING

Engine and exhaust components get hot and remain hot for a period of time after the engine is stopped. Wear insulated protective clothing or wait for components to cool sufficiently before working on the machine.

1. Remove muffler heat shield fastener and muffler heat shield.

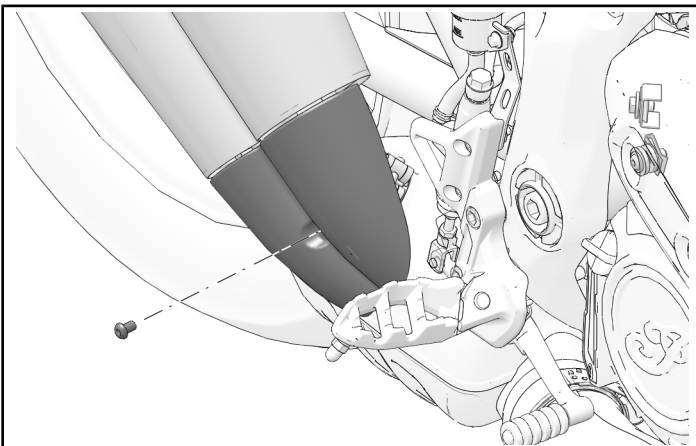

2. Loosen exhaust clamp retaining muffler to exhaust resonator.

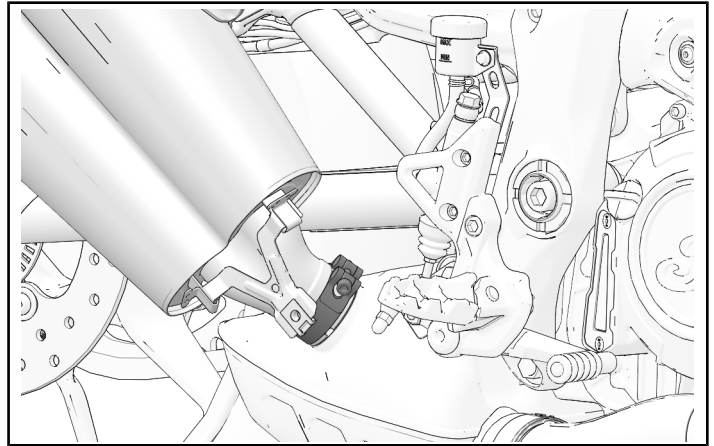

3. Remove muffler isolator fastener. Retain loose spacer (if applicable) between muffler assembly and passenger foot peg mount.

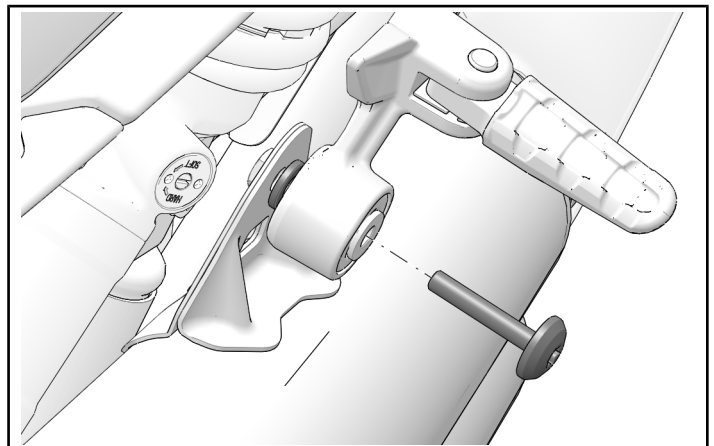

4. Remove muffler from resonator.

## LIFTING MOTORCYCLE

### **⚠ WARNING**

This installation requires raising and supporting motorcycle off the ground. Precautions should be taken to ensure motorcycle is properly stabilized at all times. Failure to properly support motorcycle may result in personal injury or damage to motorcycle.

### **IMPORTANT**

Secure motorcycle in an upright position with tie-down straps and platform jack positioned beneath engine cases.

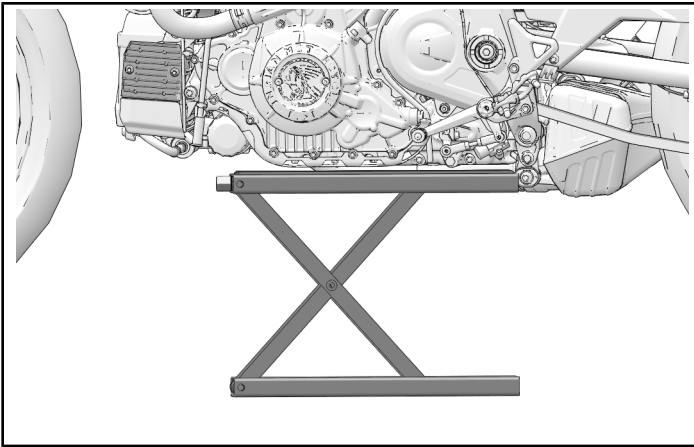

## SHOCK ABSORBER REMOVAL

1. Remove two fasteners, one washer, and one bushing to remove shock absorber from motorcycle.

### **TIP**

Use vehicle lift/support equipment to raise the rear wheel and relieve tension on the shock absorber.

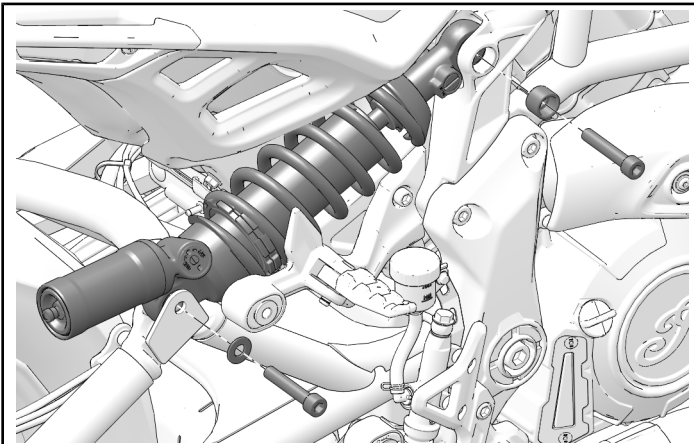

## ACCESSORY INSTALLATION

1. Install shock absorber with two fasteners, one washer, and one bushing. Torque two fasteners to specification.

### **TORQUE**

Shock Absorber Fasteners:  
**44 ft-lbs (60 N·m)**

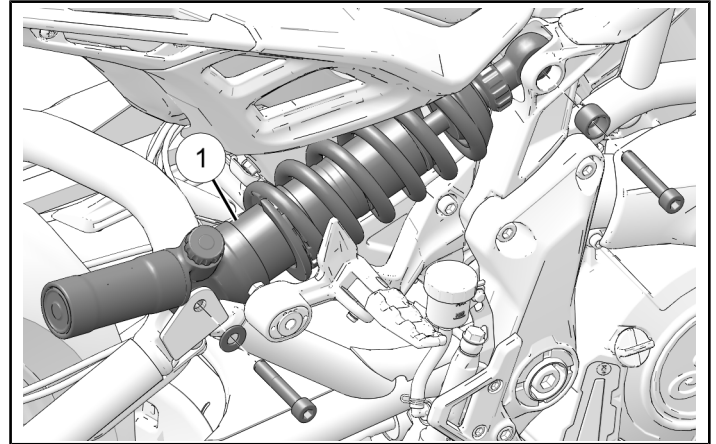

## VEHICLE REASSEMBLY

### MUFFLER INSTALLATION

1. Install muffler to exhaust resonator with retained clamp. Note orientation of clamp in graphic.

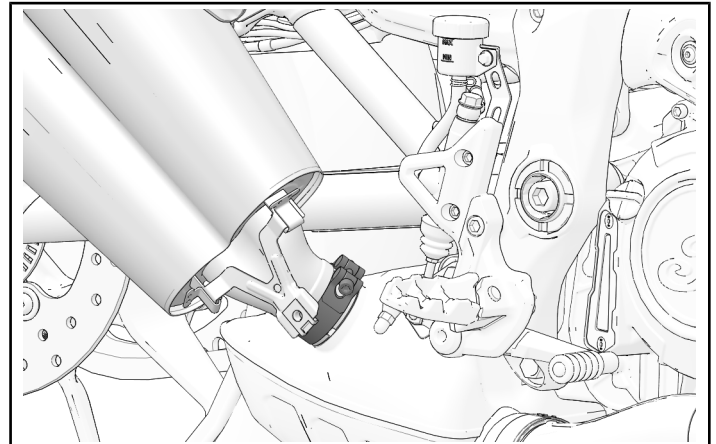

2. Install muffler to passenger foot peg with retained isolator fastener and retained loose spacer (if applicable). Make sure loose spacer is between foot peg and muffler bracket, as shown. Torque isolator fastener to specification.

**TORQUE**

Isolator Fastener:  
**16 ft-lbs (22 N·m)**

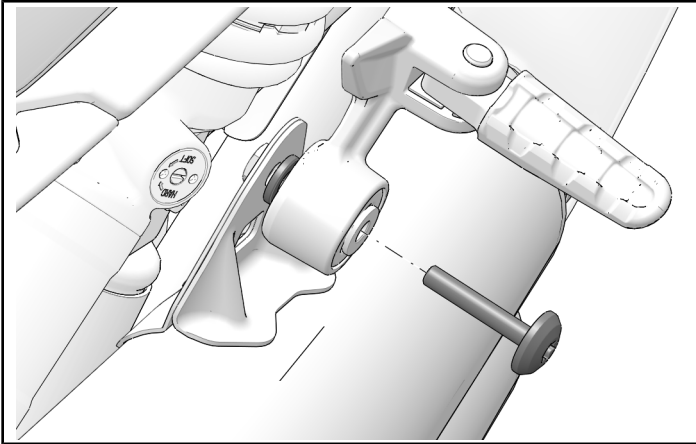

3. Torque clamp to specification.

**TORQUE**

Muffler Clamp:  
**15 ft-lbs (20 N·m)**

4. Install muffler heat shield with retained fastener. Torque fastener to specification.

**TORQUE**

Heat Shield Fastener:  
**70 in-lbs (8 N·m)**

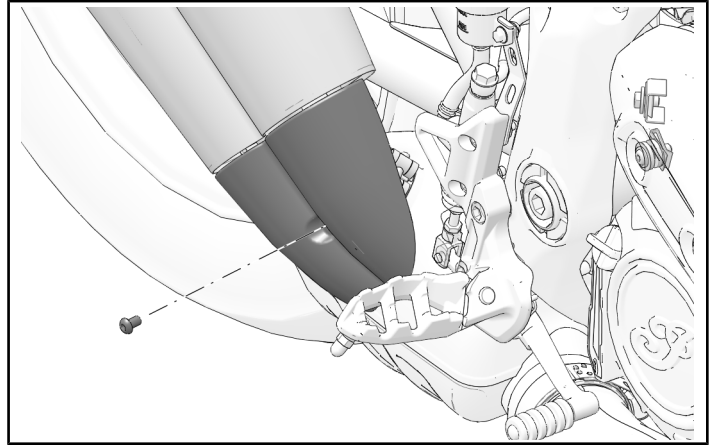

## OPERATION

### REAR SHOCK PRELOAD INSPECTION

Periodically inspect rear shock preload. For the most comfortable ride and proper ground clearance, adjust preload according to following table.

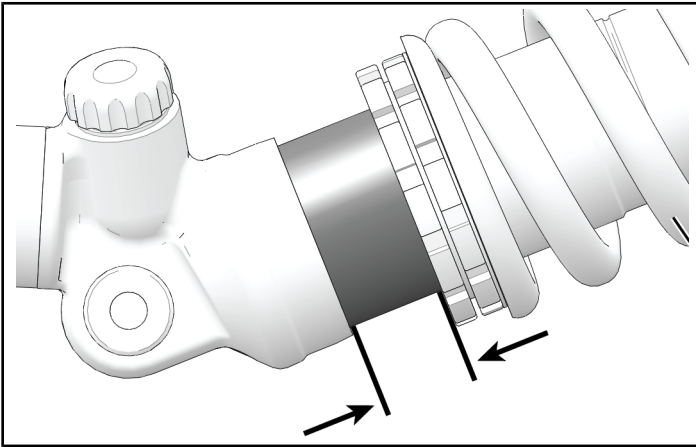

1. Identify the combined weight of rider, passenger, and cargo.
2. Calculate shock preload by measuring the amount of exposed thread on the shock body behind the jam nut. See the table below for measurement based on weight.
3. Adjust preload as needed to get dimension specified in the table below. To adjust, see *Rear Shock Preload Adjustment*.

Combined Weight of Rider, Passenger, and Cargo	Dimension
125 lb (57 kg)	19 mm
150 lb (68 kg)	21 mm
175 lb (79 kg)	23.5 mm
200 lb (91 kg)	26 mm
225 lb (102 kg)	28 mm
250 lb (113 kg)	31 mm
275 lb (125 kg)	32 mm
300 lb (136 kg)	34 mm
325 lb (147 kg)	37 mm
350 lb (159 kg)	39 mm
375 lb (170 kg)	39.5 mm
400 lb (181 kg)	39.5 mm
425 lb (196 kg)	39.5 mm

### REAR SHOCK PRELOAD ADJUSTMENT

1. Place the motorcycle in an upright position with the front wheel clamped in a wheel vise.
2. Using shock spanner wrench P/N 2884176 (included with motorcycle tool kit), loosen the lock nut by turning it counter-clockwise (as viewed from the top of the shock).
3. Spray a light lubricant on the adjuster nut where it contacts the spring.
4. Adjust shock preload by rotating the adjuster nut clockwise (as viewed from the top of the shock) to **INCREASE** preload (higher) or counter-clockwise to **DECREASE** preload (lower).

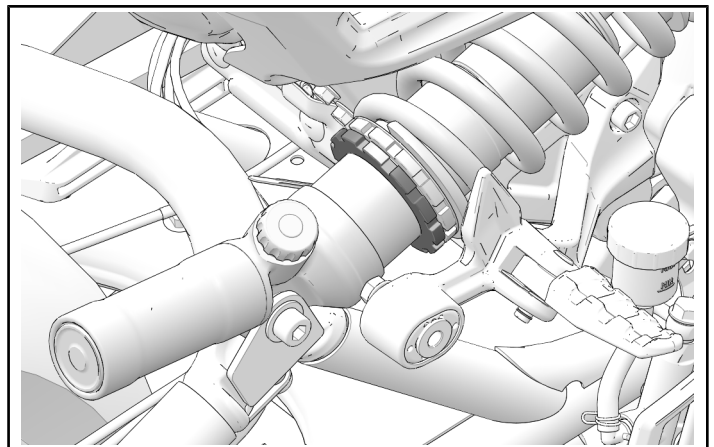

5. Recheck the preload measurement after adjusting.
6. Tighten the lock nut securely against the adjuster nut.

### REAR SHOCK ADJUSTMENT GUIDE

#### REBOUND DAMPING SETTINGS

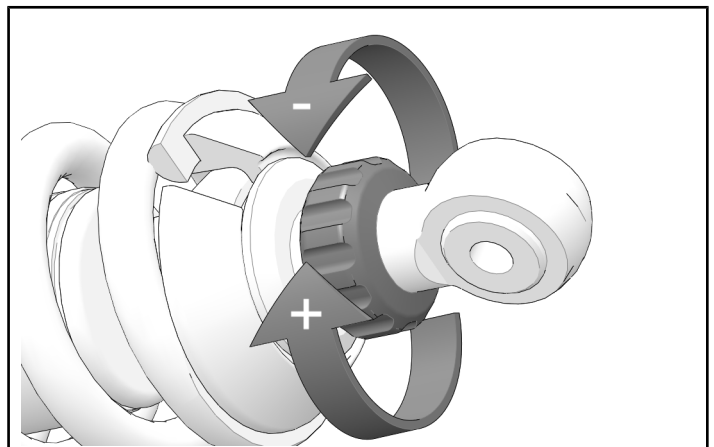

Riding Type	Shock Compression	Shock Rebound
Low Speed Riding (Urban)	20 clicks out	17clicks out
General Riding (Town/ Highway)	15 clicks out	14 clicks out
General Riding (2-up)	13 clicks out	12 clicks out
Aggressive Riding (Track)	12 clicks out	14 clicks out

**COMPRESSION DAMPING SETTINGS**

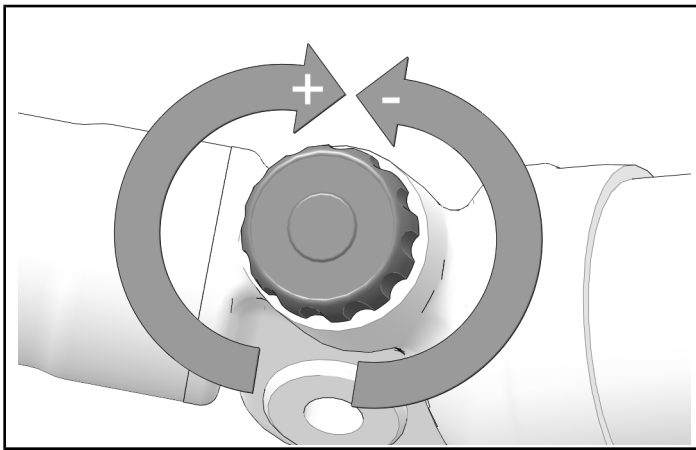

**INSTRUCTION FEEDBACK FORM**

A feedback form has been created for the installer to provide any comments, questions or concerns about the installation instructions. The form is viewable on mobile devices by scanning the QR code or by clicking [HERE](#) if viewing on a PC.

