

# DRIVER BACKREST MOUNT KIT



**P/N 2879543**

## APPLICATION

All Heavyweight Indian Motorcycles

## BEFORE YOU BEGIN

Read these instructions and check to be sure all parts and tools are accounted for. Please retain these installation instructions for future reference and parts ordering information.

## KIT CONTENTS

This Kit includes:

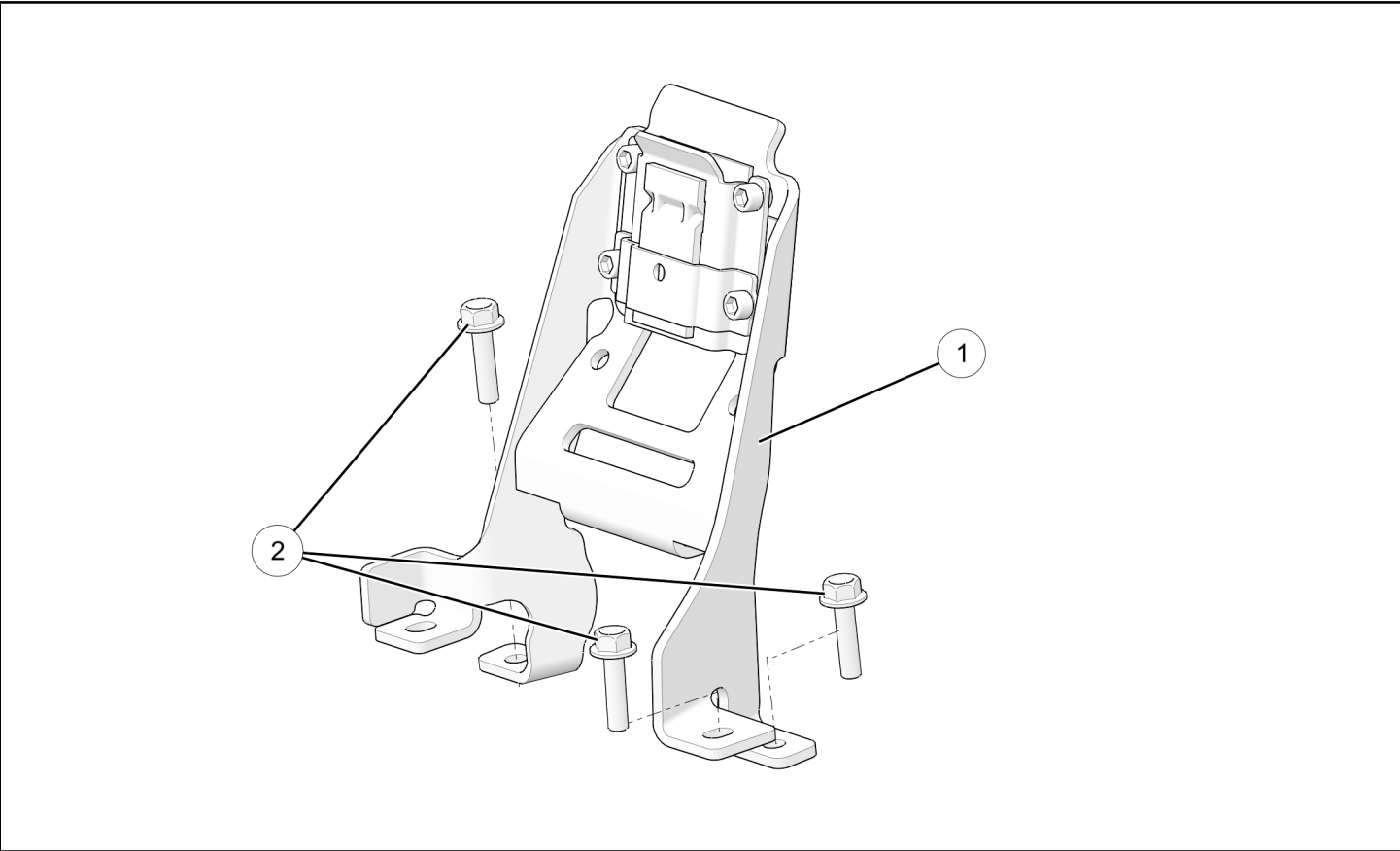

REF	QTY	PART DESCRIPTION	PART NUMBER
1	1	Driver Backrest Mount Assembly	—
2	3	Screw, Hex Flange, M6 X 1.0 X 25	7517751
	1	Instructions	9927620

## TOOLS REQUIRED

- Safety Glasses
- Socket Set, Metric
- Socket Set, Hex Bit, Metric
- Torque Wrench

## IMPORTANT

Your Indian Driver Backrest Mount Kit is exclusively designed for your vehicle. Please read the installation instructions thoroughly before beginning. Installation is easier if the vehicle is clean and free of debris. For your safety, and to ensure a satisfactory installation, perform all installation steps correctly in the sequence shown.

## ASSEMBLY TIME

Approximately 30 minutes

## INSTALLATION INSTRUCTIONS

1. Turn key to "OFF" position and remove from vehicle.
2. Ensure motorcycle is parked on a flat surface, kickstand is fully extended, and vehicle is stable prior to installation.
3. Remove side covers and seat as per owner's manual. Set removed parts aside for reassembly.
4. Remove and retain screw (A) from battery mount as shown.

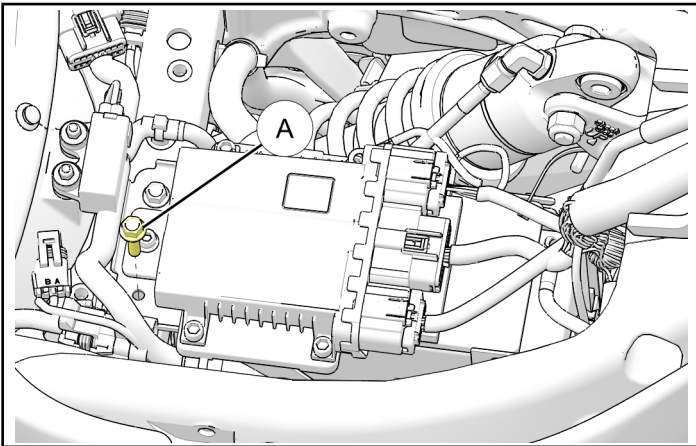

5. Place backrest (1) assembly onto frame as shown. Route chassis wire harness (B) and any accessory harnesses in front of bracket.

### ⚠ WARNING

Wiring harness must be routed properly or severe damage to your vehicle may occur.

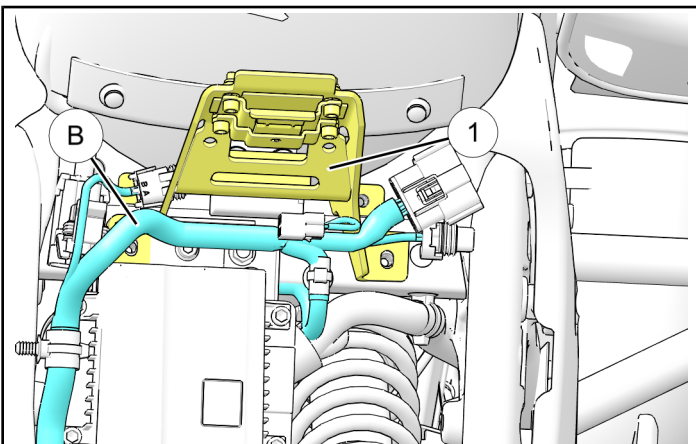

6. Loosely install retained screw (A) into original hole. **Do not tighten screw at this time.**

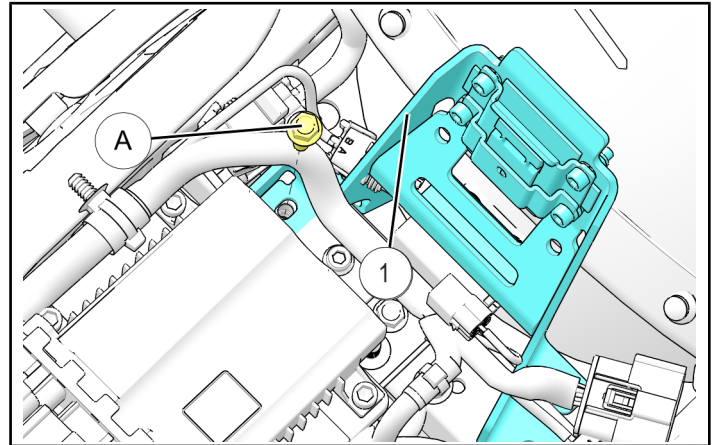

7. Install three screws (2) as shown. Torque all four screws (A and 2) to specification.

### TORQUE

90 +/- 9 in. lbs. (10 +/- 1 Nm)

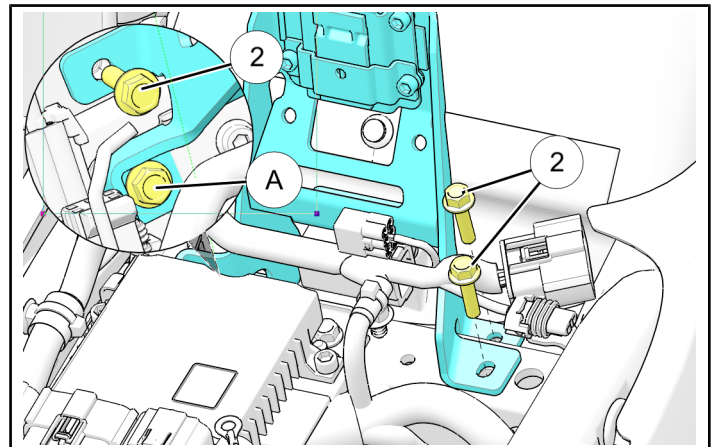

8. Reinstall seat and side covers as per owner's manual.

### ⚠ WARNING

Ensure tabs are securely engaged in seat base pockets when installing seat. Failure to install tabs may cause seat to come loose and may lead to personal injury or death.

9. Re-torque all fasteners after 500 miles.