

# BACKREST PLUG KIT



**P/N 2881788**

## APPLICATION

All Full-Sized Indian Motorcycles with Passenger Backrest

## BEFORE YOU BEGIN

Read these instructions and check to be sure all parts and tools are accounted for. Please retain these installation instructions for future reference and parts ordering information.

## KIT CONTENTS

This Kit includes:

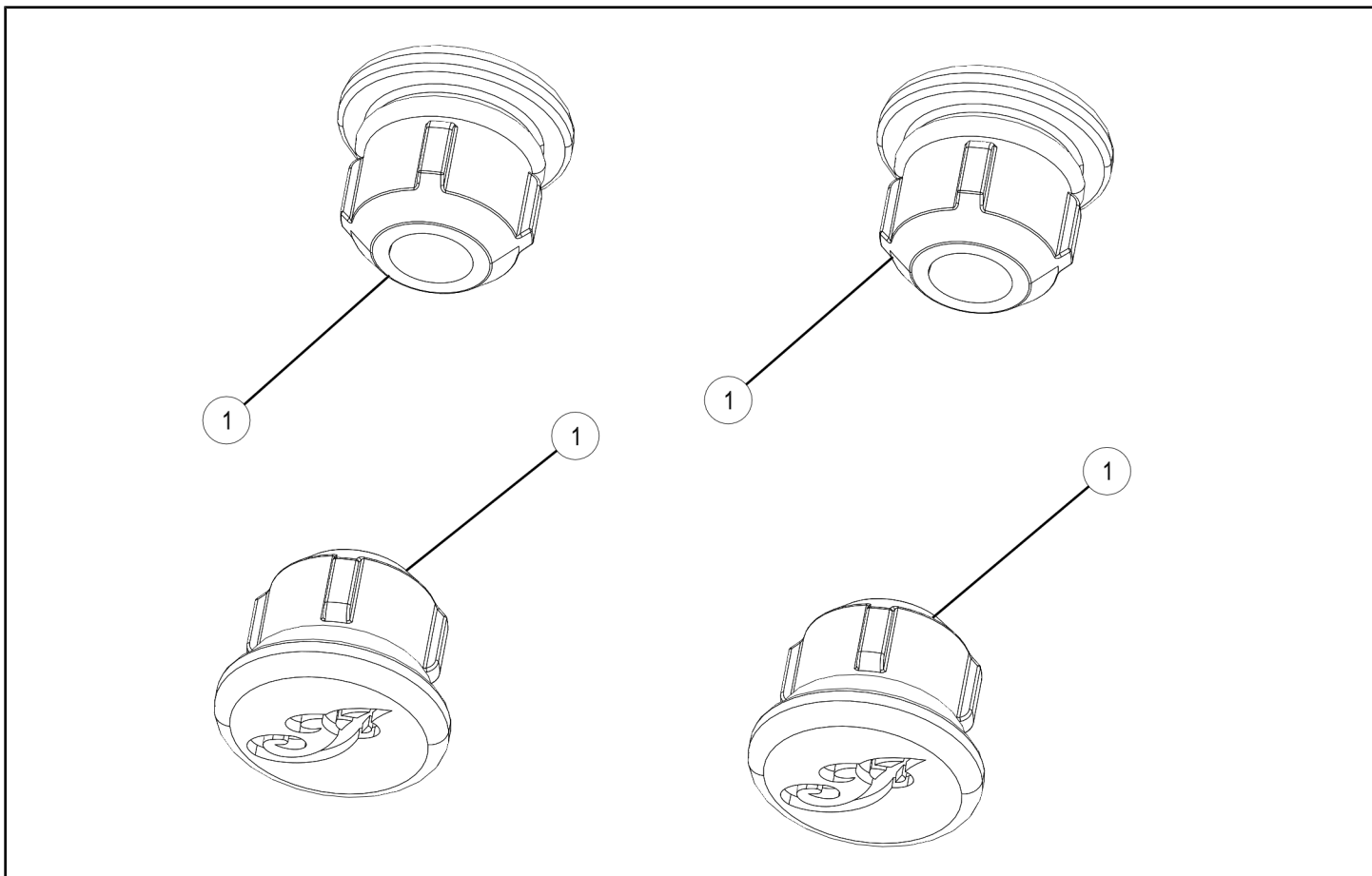

REF	QTY	PART DESCRIPTION	PART NUMBER
1	4	Plug, Passenger Backrest	5415823
	1	Instructions	9926895

## TOOLS REQUIRED

- Safety Glasses

## IMPORTANT

Your Indian BACKREST PLUG KIT is exclusively designed for your vehicle. Please read the installation instructions thoroughly before beginning. Installation is easier if the vehicle is clean and free of debris. For your safety, and to ensure a satisfactory installation, perform all installation steps correctly in the sequence shown.

## ASSEMBLY TIME

Approximately 2 minutes

## INSTALLATION INSTRUCTIONS

1. Ensure motorcycle is parked on a flat surface and vehicle is stable prior to installation or remove the backrest from the vehicle and set it on a flat surface.

Insert plugs ① on each side of the sleeves for the luggage rack (A). Orient the Indian Script "I" vertically, as shown in the figure.

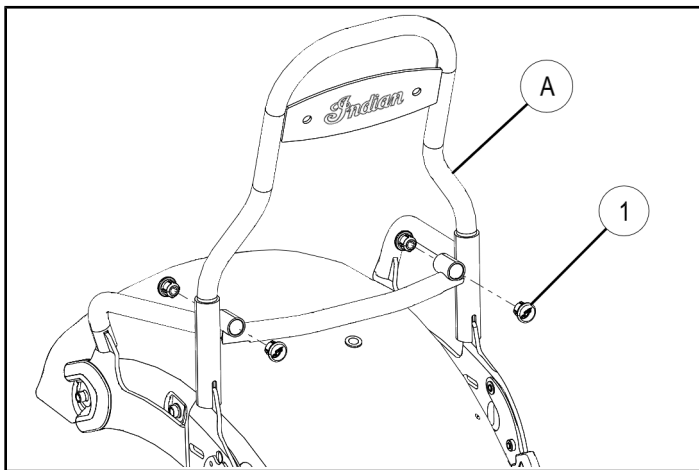

2. Ensure all front and rear plugs ① fitted properly to the sleeves.

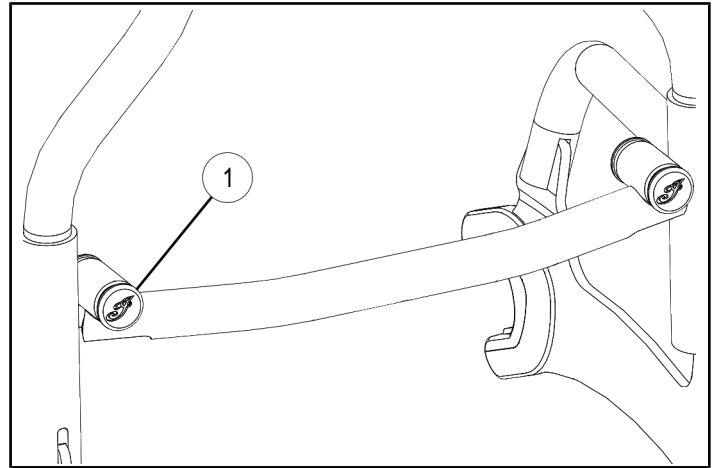

3. Reinstall the backrest onto vehicle, if it was removed earlier.