

# SPORT SEAT KIT



**P/N 2881997**

## APPLICATION

All Indian Scout Motorcycles

## BEFORE YOU BEGIN

Read these instructions and check to be sure all parts and tools are accounted for. Please retain these installation instructions for future reference and parts ordering information.

## KIT CONTENTS

This Kit includes:

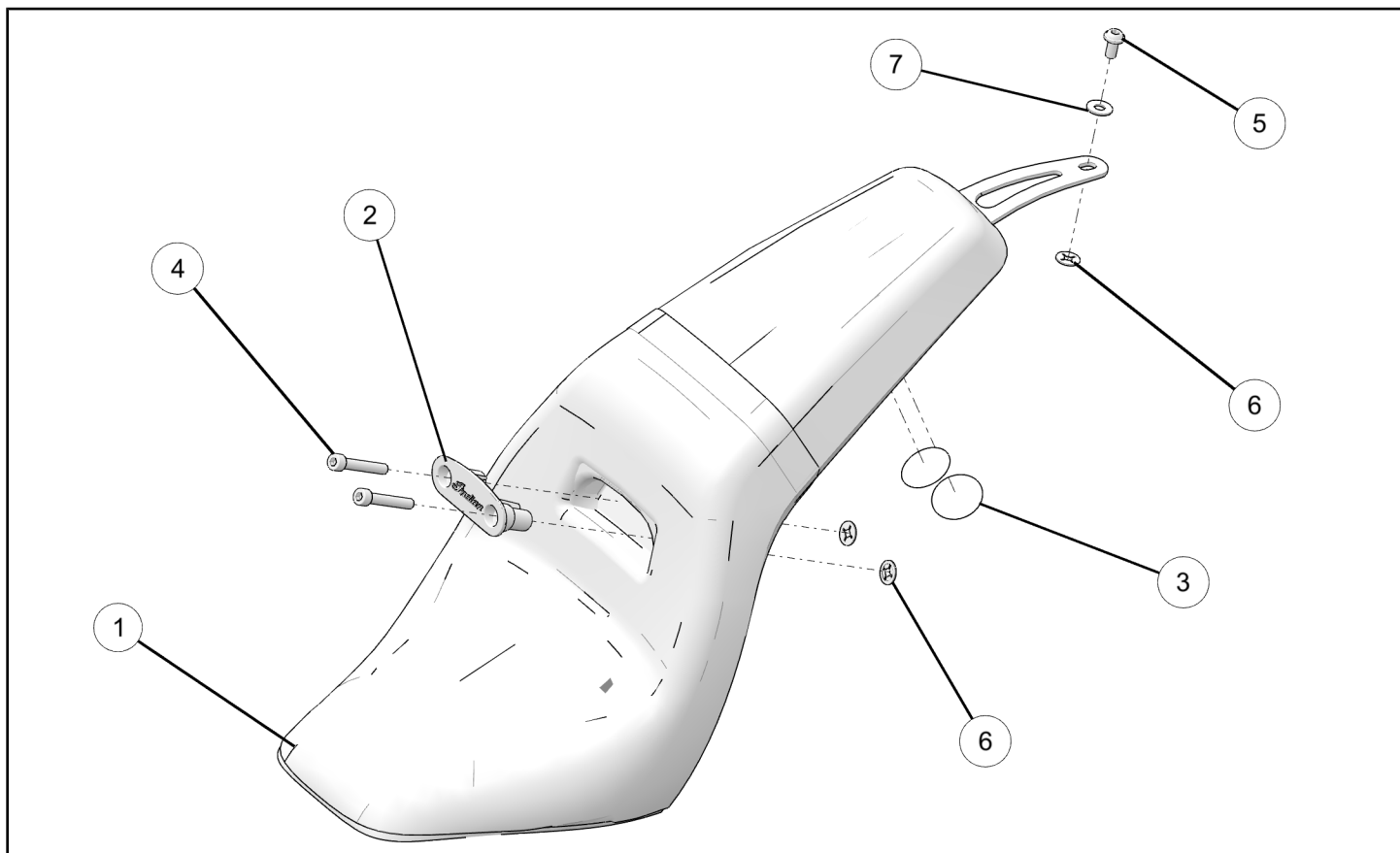

REF	QTY	PART DESCRIPTION	PART NUMBER
1	1	Sport Seat Assembly	2687268
2	1	Sport Seat Logo	5633643
3	2	Rear Fender Film Protection	5814001
4	2	Screw - M8 X 1.25 X 50	7519895
5	1	Screw - M8 X 1.25 X 16	7520456
6	3	Washer - M8 X 18.6 X 1.6	7556884
7	1	Washer - M8.4 X 20 X 16	7556969
	1	Instructions	9927097

## TOOLS REQUIRED

- 6mm Hex Key Socket
- Flat Head Screw Driver

- Torque Wrench

## IMPORTANT

Your Indian SPORT SEAT KIT is exclusively designed for your vehicle. Please read the installation instructions thoroughly before beginning. Installation is easier if the vehicle is clean and free of debris. For your safety, and to ensure a satisfactory installation, perform all installation steps correctly in the sequence shown.

## ASSEMBLY TIME

Approximately 18 minutes

## INSTALLATION INSTRUCTIONS

1. Lift up on the front of the seat (B) to disengage from the seat retention post (A).

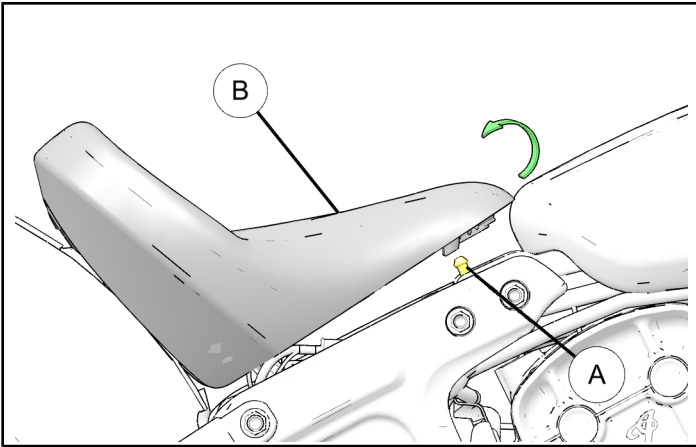

2. Pull the seat (B) up and rearward to disengage the rear mount (C) and remove the seat from the bike.

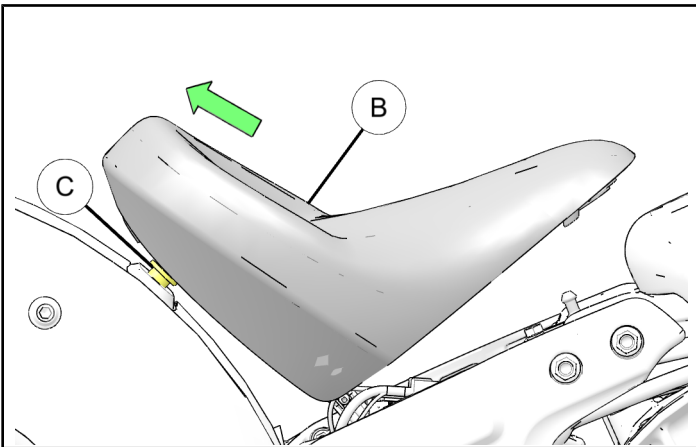

3. Remove the cap (D) on the rear fender.

### CAUTION

Make sure not to scratch or chip the paint beneath the cap (D).

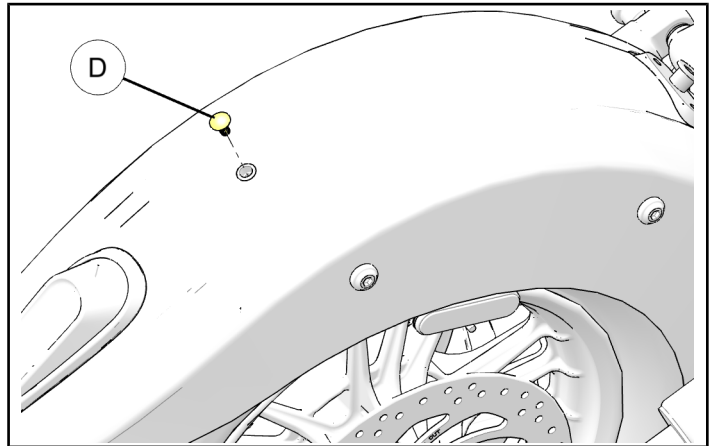

4. Cut the template (E) from the instruction sheet. Lay the template on the fender and align the template holes (F) with the mounting holes next to the seat mounting peg (C). Remove the backing from the protective film (3) and apply the two pieces inside the oblong cut as shown.

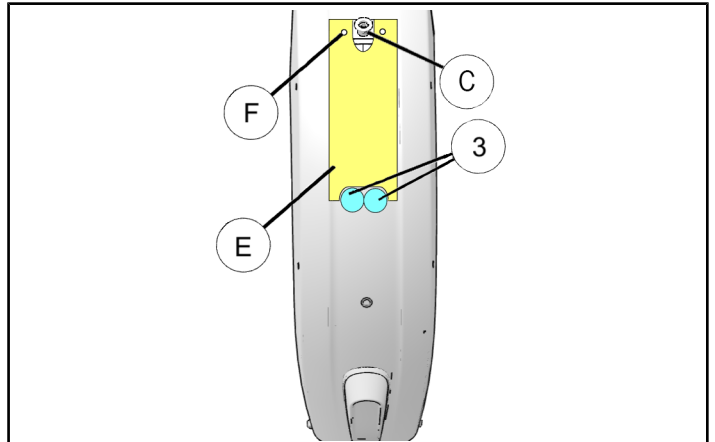

5. Remove the stock seat mount peg (C).

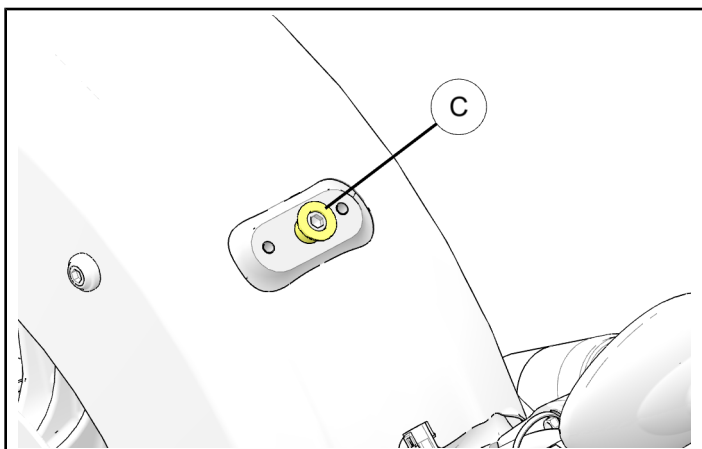

6. Remove the plastic retention washers (6) holding the sport seat logo (2) and screws (4) in place (underside of seat). These washer must be removed prior to assembling your seat to the bike.

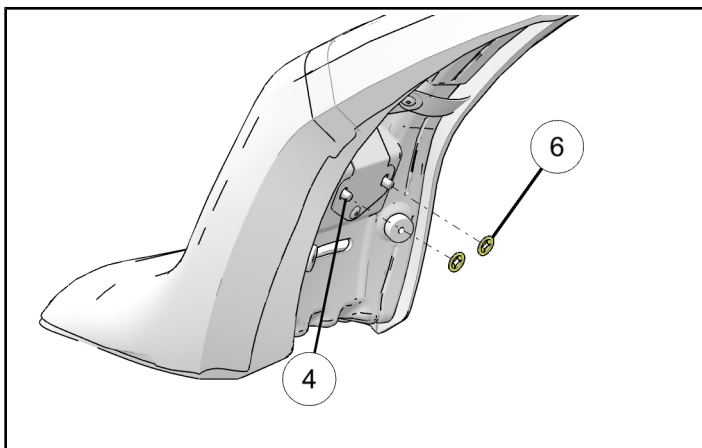

7. Place your sport seat (1) on the bike and start to thread the sport seat logo screws (4) into the frame to help align the seat. At this point do not fully tighten the screws.

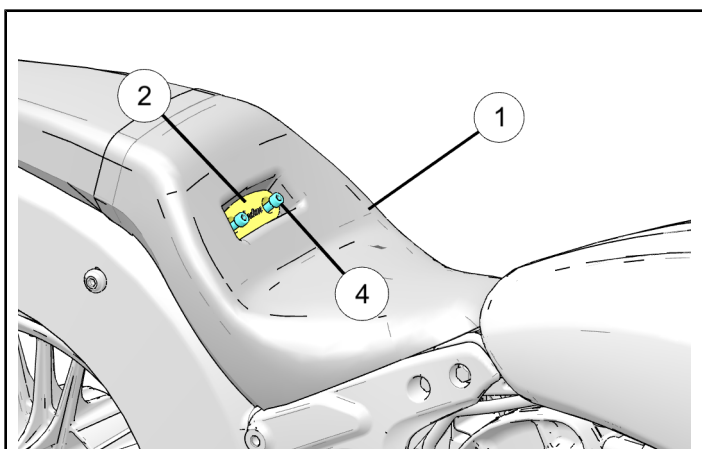

8. Engage the front of the seat (1) with the seat retention post (A).

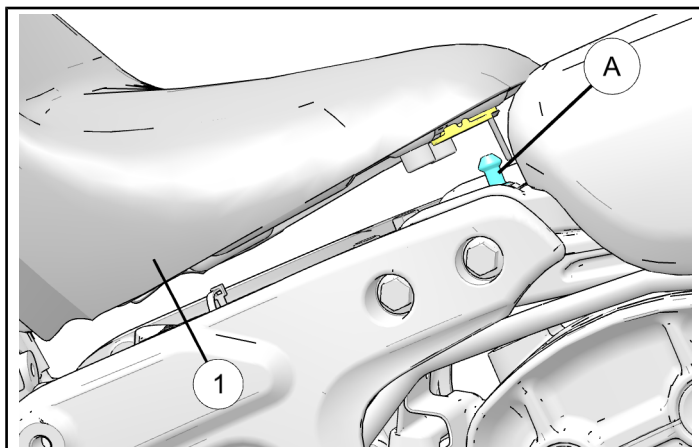

9. Secure the rear portion of the seat (1) to the fender using screw (5) and washers (6) (7). Torque the sport seat logo screws (4) and then rear screw (5) to specification.

### TORQUE

14 ft. lbs. (19 Nm)

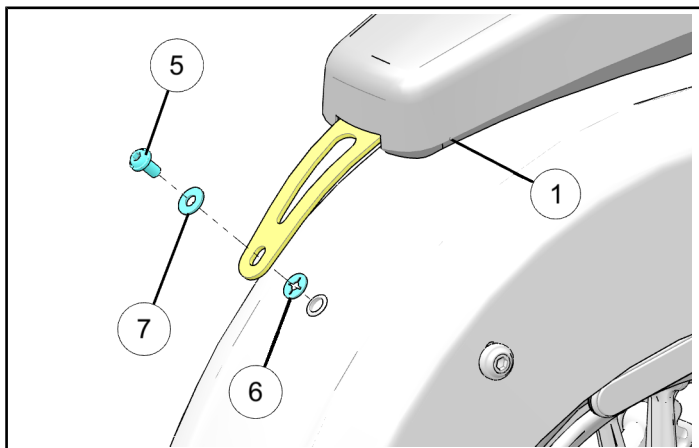

10. Final sport seat installation as shown below.

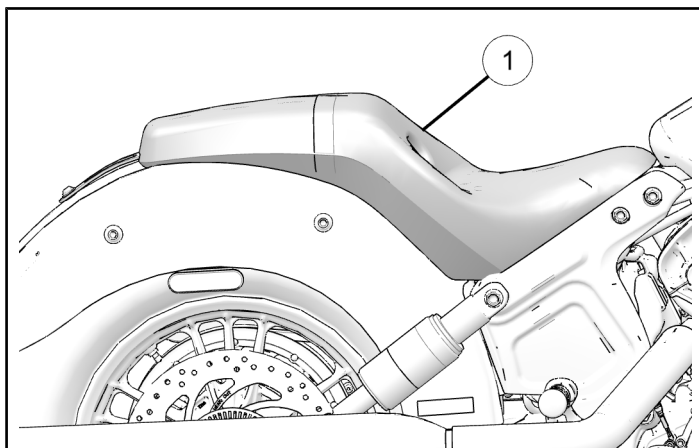

**THIS PAGE IS INTENTIONALLY LEFT BLANK**

**Template Layout:**

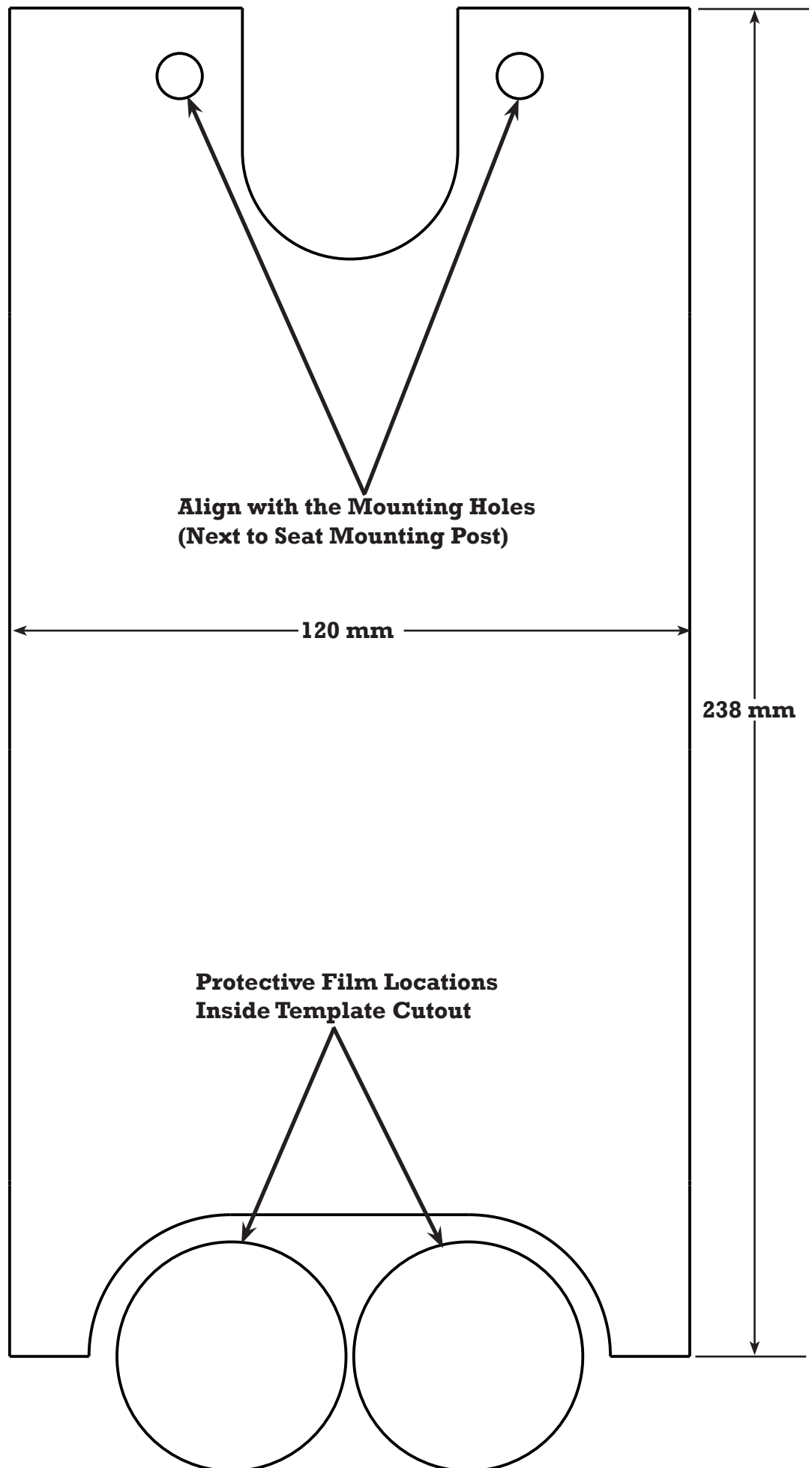

**NOTE:** Template sized to be printed to scale on 8.5" x 11" paper.