

ONE-PIECE SEAT KIT



P/N 2880285-XX, 2883663-XXX, 2883664-XXX

APPLICATION

Verify accessory fitment at www.indianmotorcycle.com.

IMPORTANT

Extended Reach Seat Kit (PN 2883664-XXX) cannot be used with Rider Backrest Pad Kit (PN 2879542-XXX)

BEFORE YOU BEGIN

Read these instructions and check to be sure all parts and tools are accounted for. Please retain these installation instructions for future reference and parts ordering information.

KIT CONTENTS

This Kit includes:

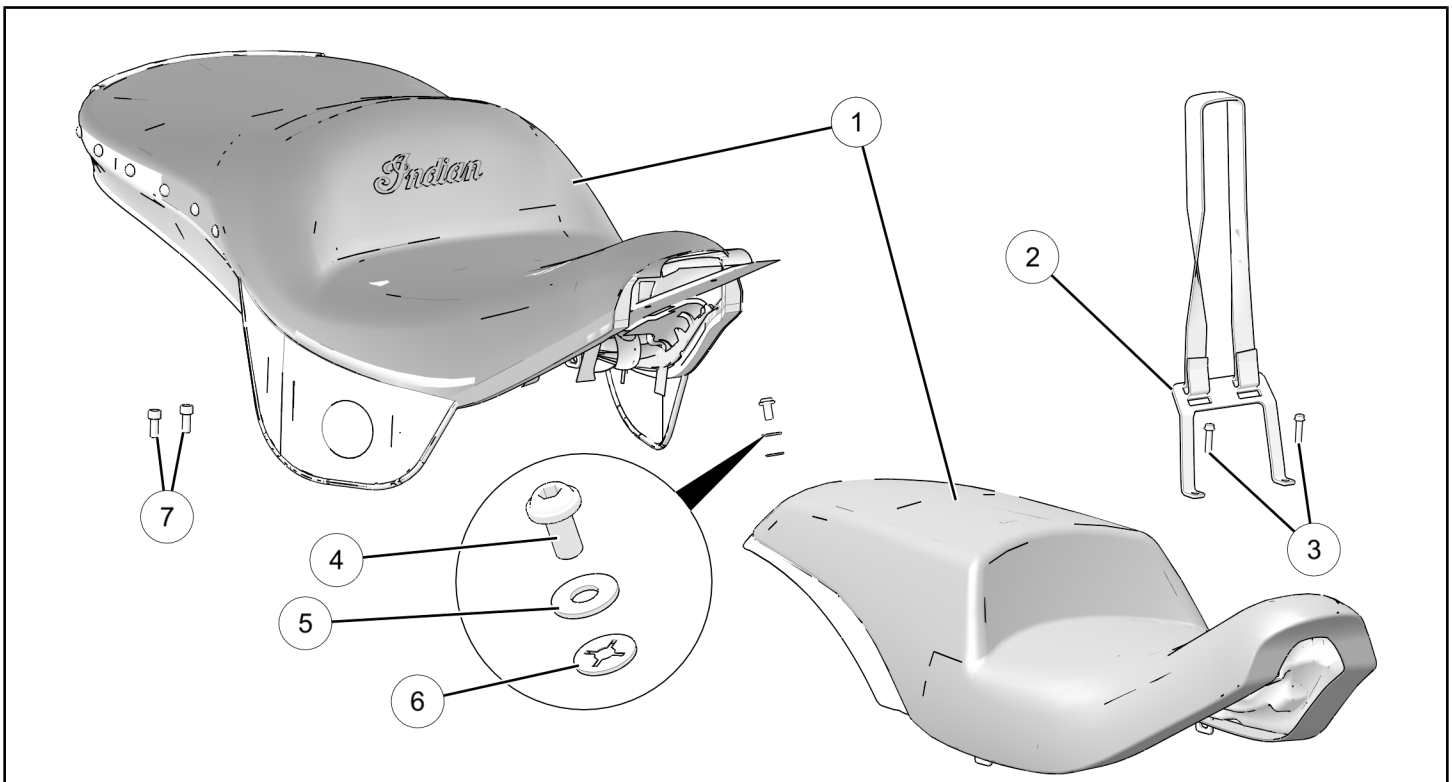

NOTE

XXX = Indian® color code (For example: 266 = Black)

REF	QTY	PART DESCRIPTION	PART NUMBER
1	1	Assembly, Seat, Heated (Kit PN 2880285-XX) Assembly, Seat, Gunfighter, Standard (Kit PN 2883663-XXX) Assembly, Seat, Gunfighter, Extended Reach (Kit PN 2883664-XXX)	- - -
2	1	Strap, Seat, Passenger	2685823
3	2	Screw, Hex Flange Head, M6 X 1.0 X 25	7519297

REF	QTY	PART DESCRIPTION	PART NUMBER
4	1	Screw, Hex Button Head, M8 X 1.25 X 16 (Kit PN 2880285-XX) Screw, hex Button Head, M8 X 1.25 X 16 (Kit PN 2883663-XXX and 2883664-XXX)	7517359 7520456
5	1	Washer, 8.4 X 16 X 1.6 (Kit PN 2880285-XX) Washer, 8.4 X 20 X 1.6 (Kit PN 2883663-XXX and 2883664-XXX)	7556254 7556969
6	1	Washer, M8 X 18.3 X 1.3, Self-Retaining, Nylon, Black	7556884
7	2	Screw, Hex Socket Head, M8 X 1.25 X 20 (Kit PN 2880285-XX only)	7517410
	1	Instructions	9925234

TOOLS REQUIRED

- Safety Glasses
- Socket Set, Hex Bit, Metric
- Socket Set, Metric
- Torque Wrench

IMPORTANT

Your Indian One-Piece Seat Kit is exclusively designed for your vehicle. Please read the installation instructions thoroughly before beginning. Installation is easier if the vehicle is clean and free of debris. For your safety, and to ensure a satisfactory installation, perform all installation steps correctly in the sequence shown.

ASSEMBLY TIME

Approximately 18 minutes

INSTALLATION INSTRUCTIONS

VEHICLE PREPARATION

1. Turn key or ignition switch to "OFF" position and remove key. If equipped with keyless fob, remove fob from proximity of vehicle.
2. Ensure motorcycle is parked on a flat surface, kickstand is fully extended, and vehicle is stable prior to installation.
3. If equipped, remove trunk and store in a safe location.

STOCK SEAT REMOVAL

1. Remove and retain side covers (A) by grasping firmly and pulling outward.

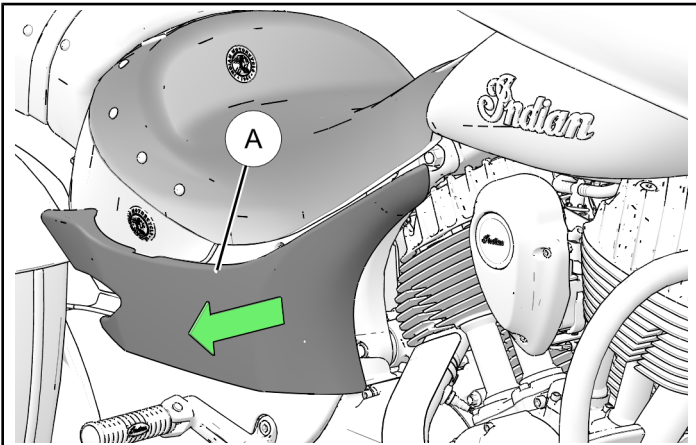

2. Lift seat valence flap (B) to access seat mounting bolts (if equipped). Remove and retain one bolt (C) from each side of seat.

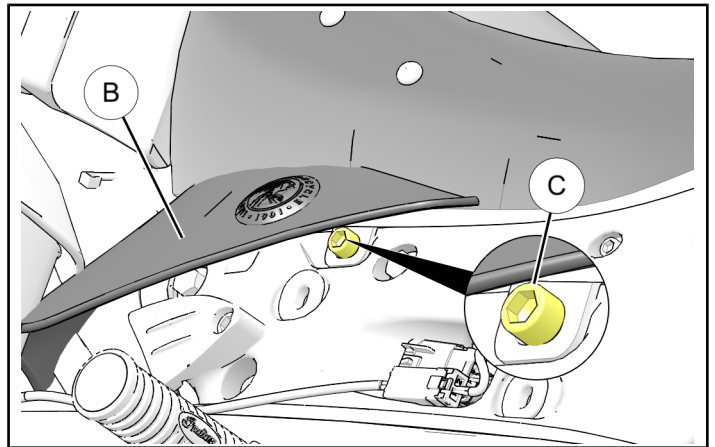

3. If removing a touring (2-person) seat, remove and retain one bolt (D) and one washer (E) from rear fender.

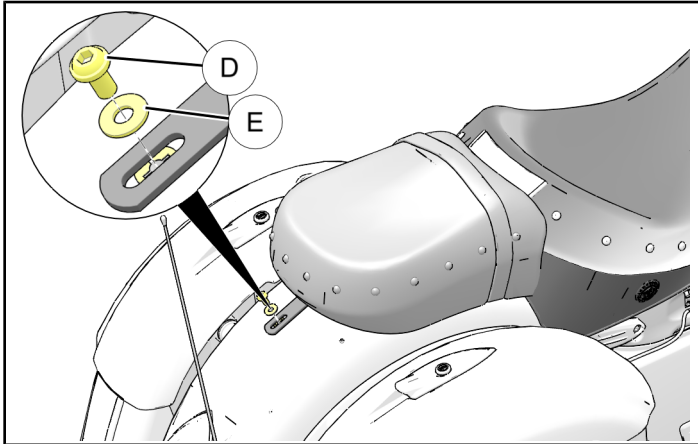

4. Slide seat rearward while lifting on rear and remove seat.

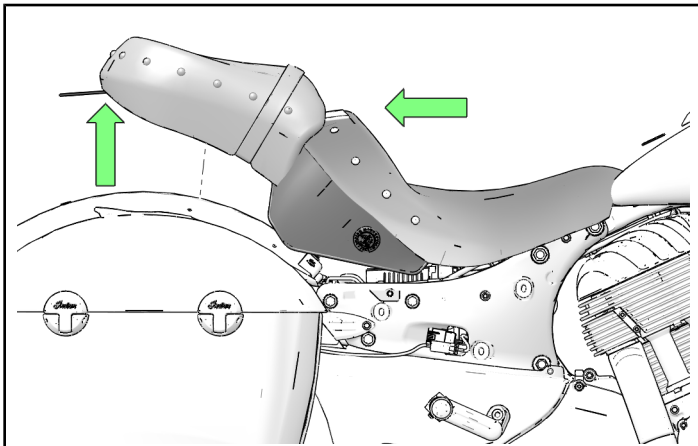

SEAT STRAP INSTALLATION

1. Install seat strap (2) using two screws (3). Torque screws to specification.

TORQUE

90 in. lbs. (10 Nm)

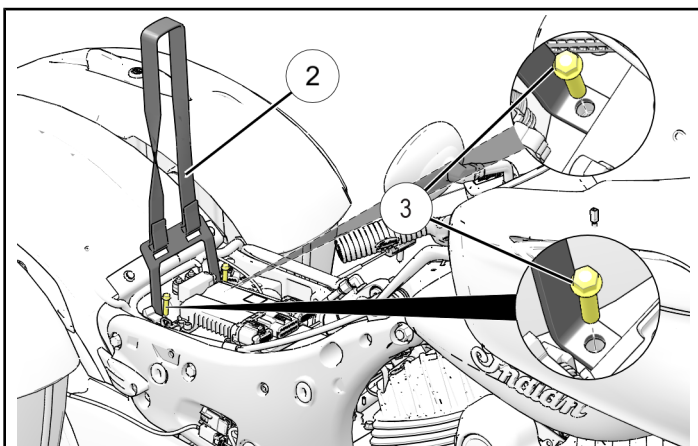

HEATED SEAT ELECTRICAL INSTALLATION

1. Connect electrical wires between seat and motorcycle. Connector (A) can be found under seat near rear of seating area. Plug connector from heat seat into connector (A).

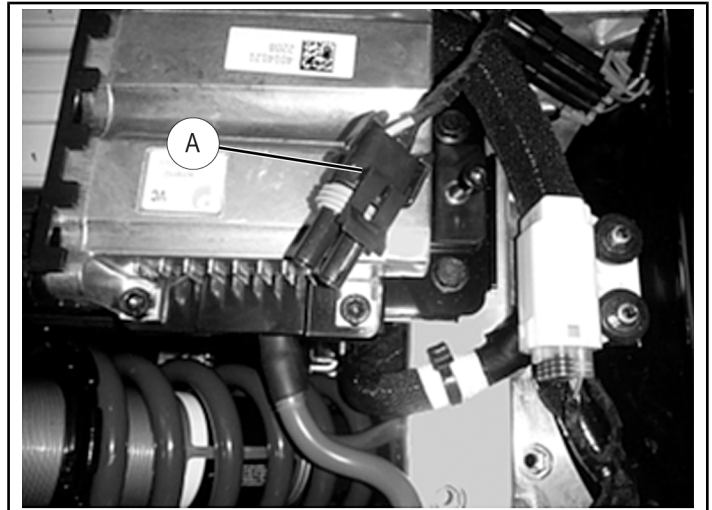

2. Carefully position wires so they will not be pinched when installing seat.

SEAT INSTALLATION

1. Route seat strap (2) through slot in seat from bottom of seat so it comes through top of seat (1).

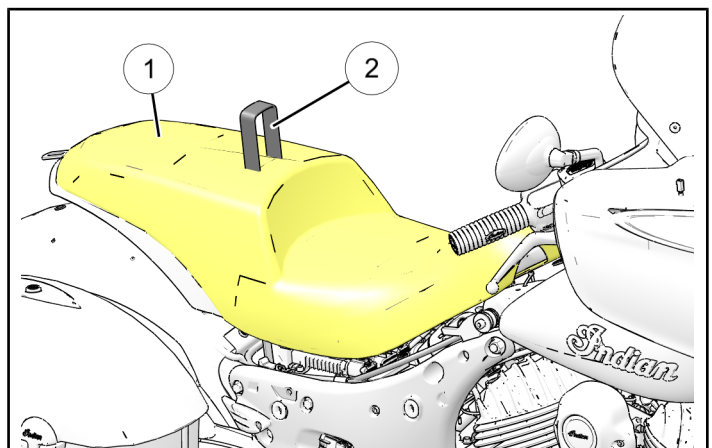

- Place seat onto motorcycle approximately 1.5 inches (3.8 cm) to rear of mounted position. Press down at nose of seat and slide forward to engage frame tabs. Pull up on front of seat to ensure tabs are engaged.

IMPORTANT

Seat front should be secure to motorcycle.

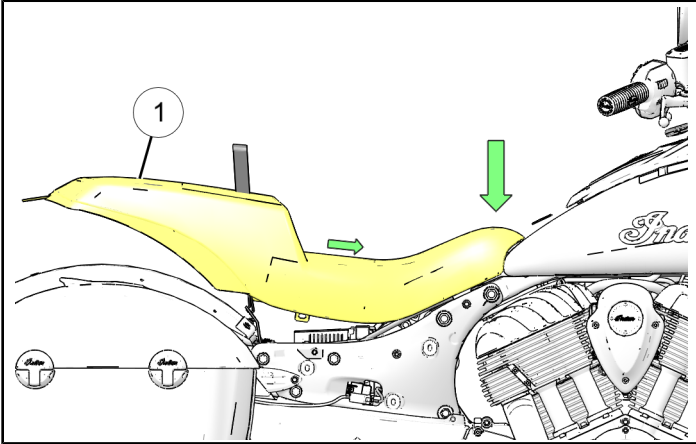

- Install two new ⑦ (Kit PN 2880285 only) or retained screws ⑧ (removed in **step 2** of **Stock Seat Removal** section) to attach seat to frame. Torque screws to specification.

TORQUE

18 ft. lbs. (24 Nm)

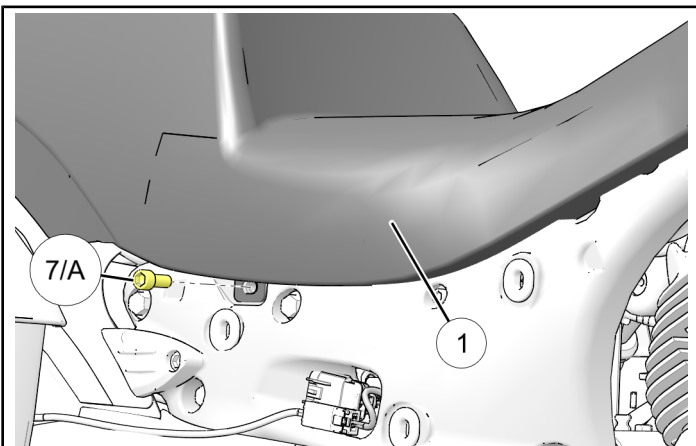

- Install rear seat mounting screw ④, and washers ⑤ and ⑥. Torque screw to specification.

NOTE

Plastic washer ⑥ is installed **between** fender and metal tab.

TORQUE

7.5 ft. lbs. (10 Nm)

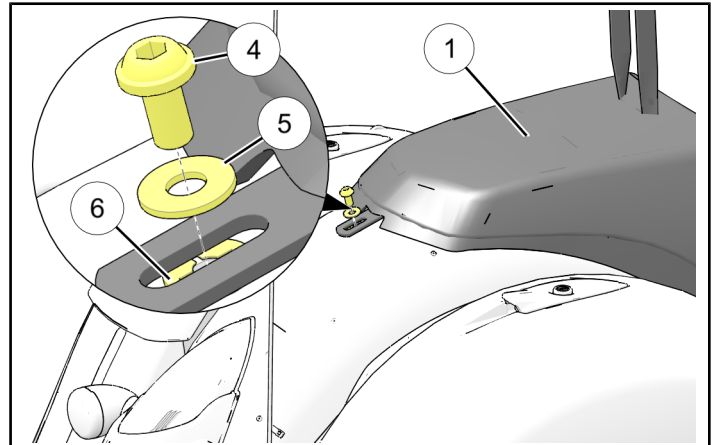

- Reinstall side covers (removed in **step 1** in **Stock Seat Removal** section.) by aligning tabs and firmly pressing into place.

HEATED SEAT OPERATING INSTRUCTIONS

Switches are located on left hand side of seat. Front switch is for driver seat, rear switch is for passenger seat.

Three settings are available:

- Top Position: **High**
- Center Position: **Off**
- Lower Position: **Low**

Choose setting which allows for maximum comfort.

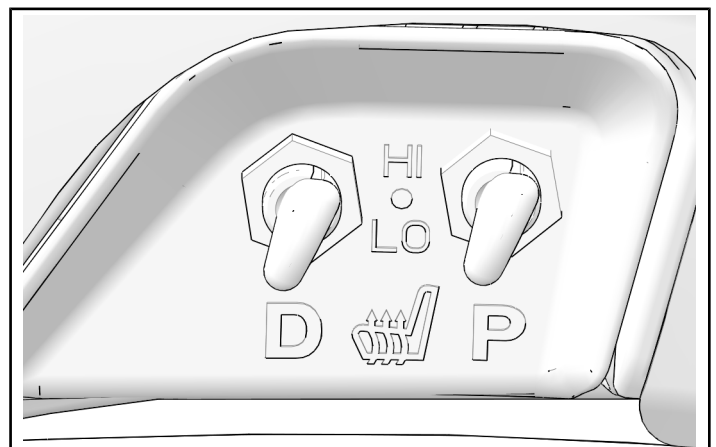

⚠ WARNING

Seat must be properly installed for safe operation of motorcycle. Failure to ensure proper installation may lead to loss of control and result in serious injury or death.

NOTE

Leather will lose oil and condition with time and exposure to elements. Leather care Kit (PN 2205578) will add back many oils that are lost from exposure to weather. Apply dressing with a clean dry cloth. Use generously and allow to soak in. Allow to dry overnight. Wipe off excess. Under normal conditions, annual application is sufficient.

FEEDBACK FORM

A feedback form has been created for the installer to provide any comments, questions or concerns about the installation instructions. The form is viewable on mobile devices by scanning the QR code or by clicking [HERE](#) if viewing on a PC.

FEEDBACK FORM

