

SEAT COWL KIT



P/N 2883900

INTERNATIONAL INSTRUCTIONS

DE DEUTSCH

Laden Sie die neuesten PDF-Anweisungen von www.indianmotorcycle.de herunter.

FR FRANÇAIS

Télécharger les dernières instructions en format PDF sur www.indianmotorcycle.fr.

IT ITALIANO

Scarica l'ultima versione delle istruzioni in formato PDF da www.indianmoto.it.

EN ENGLISH

Download the latest PDF instructions from www.indianmotorcycle.com.

ES ESPAÑOL

Descargue las instrucciones más recientes en formato PDF de www.indianmotorcycle.mx / www.indianmotorcycle.es.

ZH 中文

从 www.indianmotorcycle.cn 下载最新的PDF说明。

1



2



3



4



APPLICATION

Verify accessory fitment at www.indianmotorcycle.com.

IMPORTANT

The *Seat Cowl Kit* P/N 2883900 is not compatible with the following kits:

- *Tracker Seat Kit* P/N 2884144-VBA
- *Tracker Seat Cowl Kit* P/N 2884145-XXX
- *Aviator Seat Kit* P/N 2883503-VNA
- *Luggage Rack Kit* P/N 2883511
- *Grab Handle Kit* P/N 2883512

BEFORE YOU BEGIN

Read these instructions and check to be sure all parts and tools are accounted for. Please retain these installation instructions for future reference and parts ordering information.

KIT CONTENTS

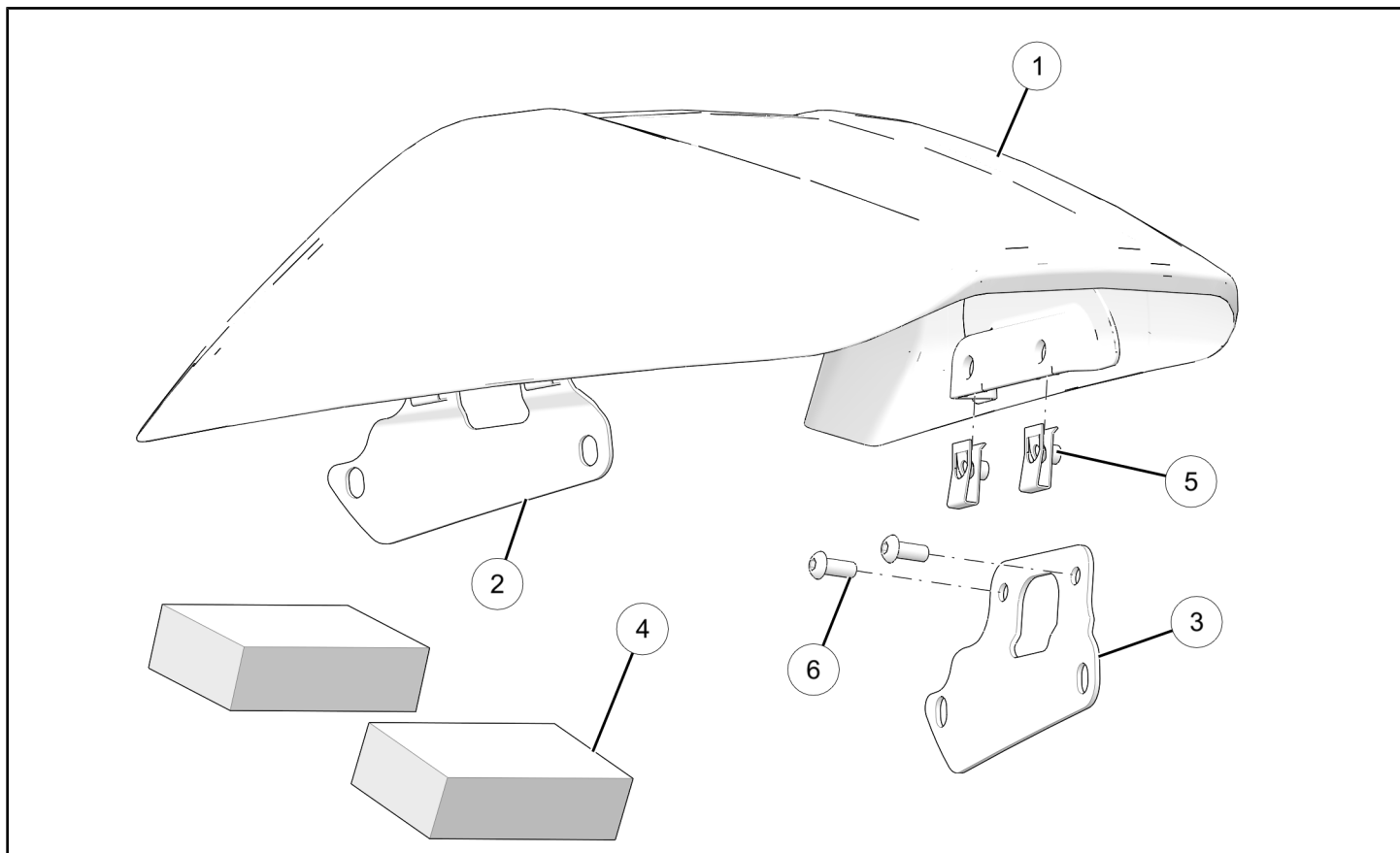

REF	QTY	PART DESCRIPTION	P/N AVAILABLE SEPARATELY
1	1	Cowl-Seat, Carbon Fiber	2637387
2	1	Bracket-Cowl Seat, LH	5267023
3	1	Bracket-Cowl Seat, RH	5267024
4	2	Seat Cowl, Foam	5871864

REF	QTY	PART DESCRIPTION	P/N AVAILABLE SEPARATELY
5	4	Clip-U, Speed Nut	7081305
6	4	Screw-Hex Button Head, M6 x 1.0 x 14	7519061
	1	Instructions	9929451

TOOLS REQUIRED

- Safety Glasses
- Hex Key Set, Metric
- Screwdriver Set, Torx®
- Socket Set, Hex Bit, Metric
- Socket Set, Torx® Bit
- Torque Wrench

IMPORTANT

Your accessory kit is exclusively designed for your vehicle. Please read the installation instructions thoroughly before beginning. Installation is easier if the vehicle is clean and free of debris. For your safety, and to ensure a satisfactory installation, perform all installation steps correctly in the sequence shown.

INSTALLATION INSTRUCTIONS

VEHICLE PREPARATION

GENERAL

1. Turn key or ignition switch to OFF position and remove key.
2. Ensure motorcycle is parked on a flat surface, kickstand is fully extended, and vehicle is stable prior to installation.

PASSENGER HANDLE REMOVAL

1. Remove two screws (A) to remove passenger handle from motorcycle frame.

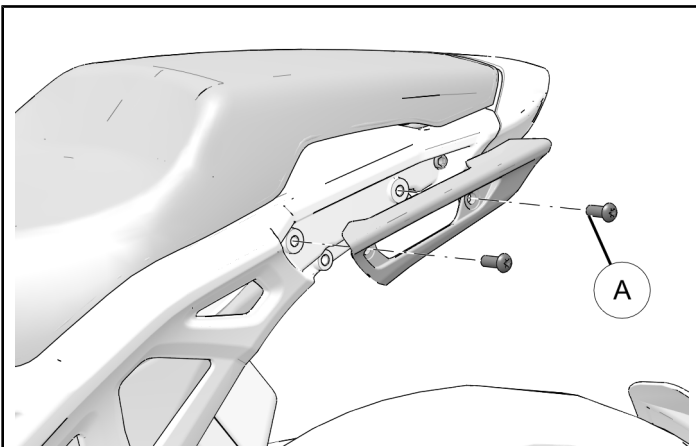

2. Repeat this section for opposite side.

ACCESSORY INSTALLATION

1. Install four clip-nuts (5) onto seat cowl mounts (1).

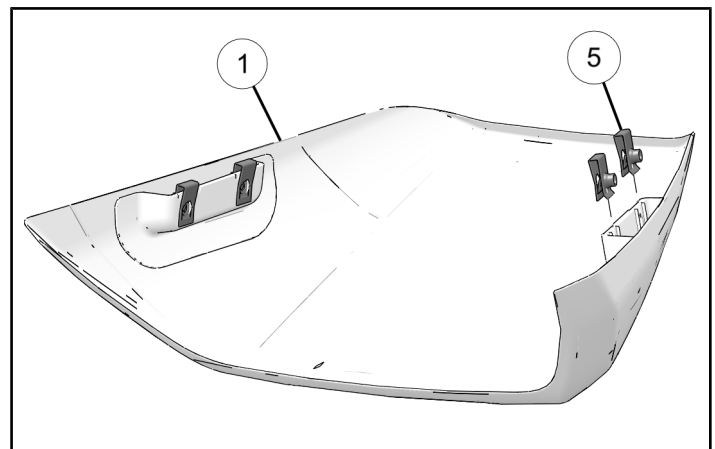

2. Align RH bracket ③ and LH bracket ② with clip-nuts and install with two fasteners ⑥ per bracket.

TIP

Pointed end of bracket faces forward. Rounded end faces rearward.

TIP

Bracket offset faces towards inside of cowl.

TORQUE

Seat Cowl Bracket Fasteners ⑥:
55 in-lbs (6 Nm)

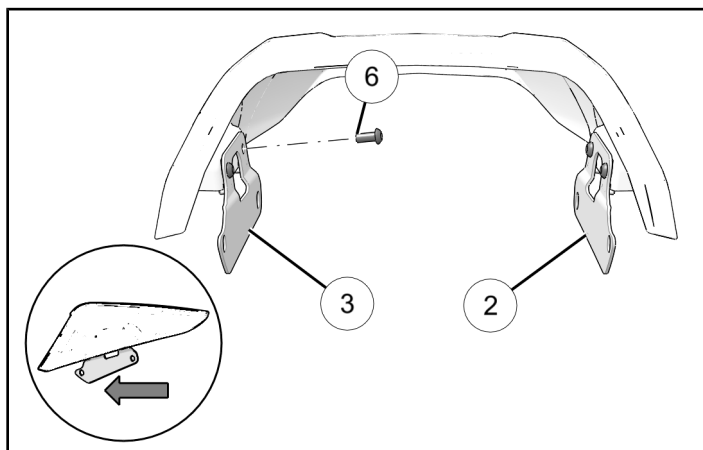

3. Apply two pieces of foam ④ on inside of seat cowl. Ensure foam pieces are centered horizontally and equally spaced vertically.

MEASUREMENT

Rear Foam ①: 37mm (1-1/2 in.)
Front Foam ②: 64mm (2-1/2 in.)

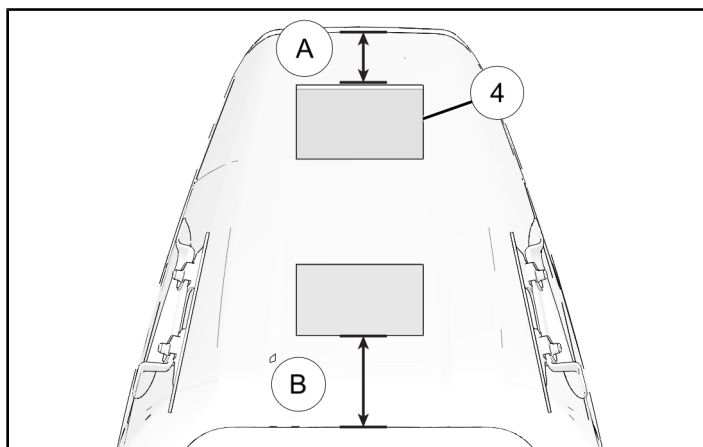

4. Place seat cowl assembly over rear portion of seat and pass retained fasteners ① through passenger handles and seat cowl brackets.

Hand tighten fasteners.

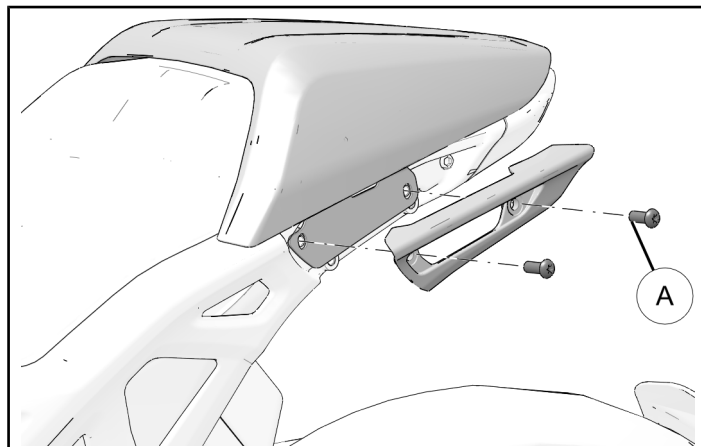

5. Adjust seat cowl height to ensure even spacing along sub-frame and rear light.

TORQUE

Passenger Handle Fasteners ①:
19 ft. lbs. (26 Nm)

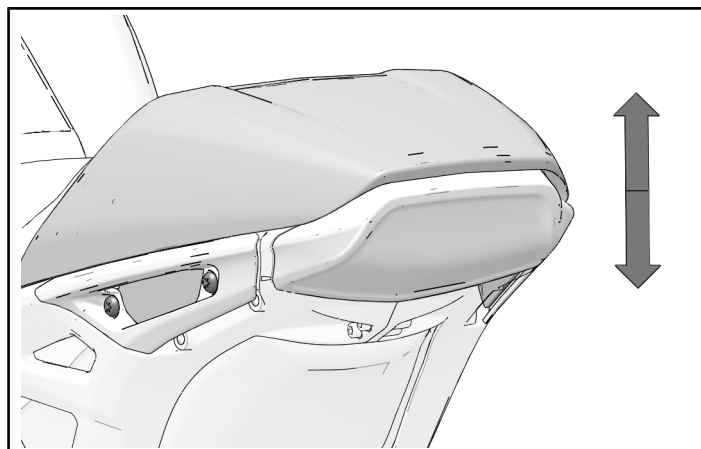

FEEDBACK FORM

A feedback form has been created for the installer to provide any comments, questions or concerns about the installation instructions. The form is viewable on mobile devices by scanning the QR code or by clicking [HERE](#) if viewing on a PC.

