

TRUNK INSTALLATION KIT



P/N 2884008

APPLICATION

All 2014-2018 Chieftain® and Springfield® models
Verify accessory fitment at www.indianmotorcycle.com.

BEFORE YOU BEGIN

Read these instructions and check to be sure all parts and tools are accounted for. Please retain these installation instructions for future reference and parts ordering information.

REQUIRED SOLD SEPARATELY

Only parts for installation of the Indian Motorcycle® Trunk Installation Kit are included. Prior installation of the following additional kits are also required (sold separately):

- *Trunk Base Kit*, P/N 2884048-XXX
- *Trunk Kit*, P/N 2884046-XXX

NOTE

XXX = Indian Motorcycle® color code (For example: 266 = Black)

KIT CONTENTS

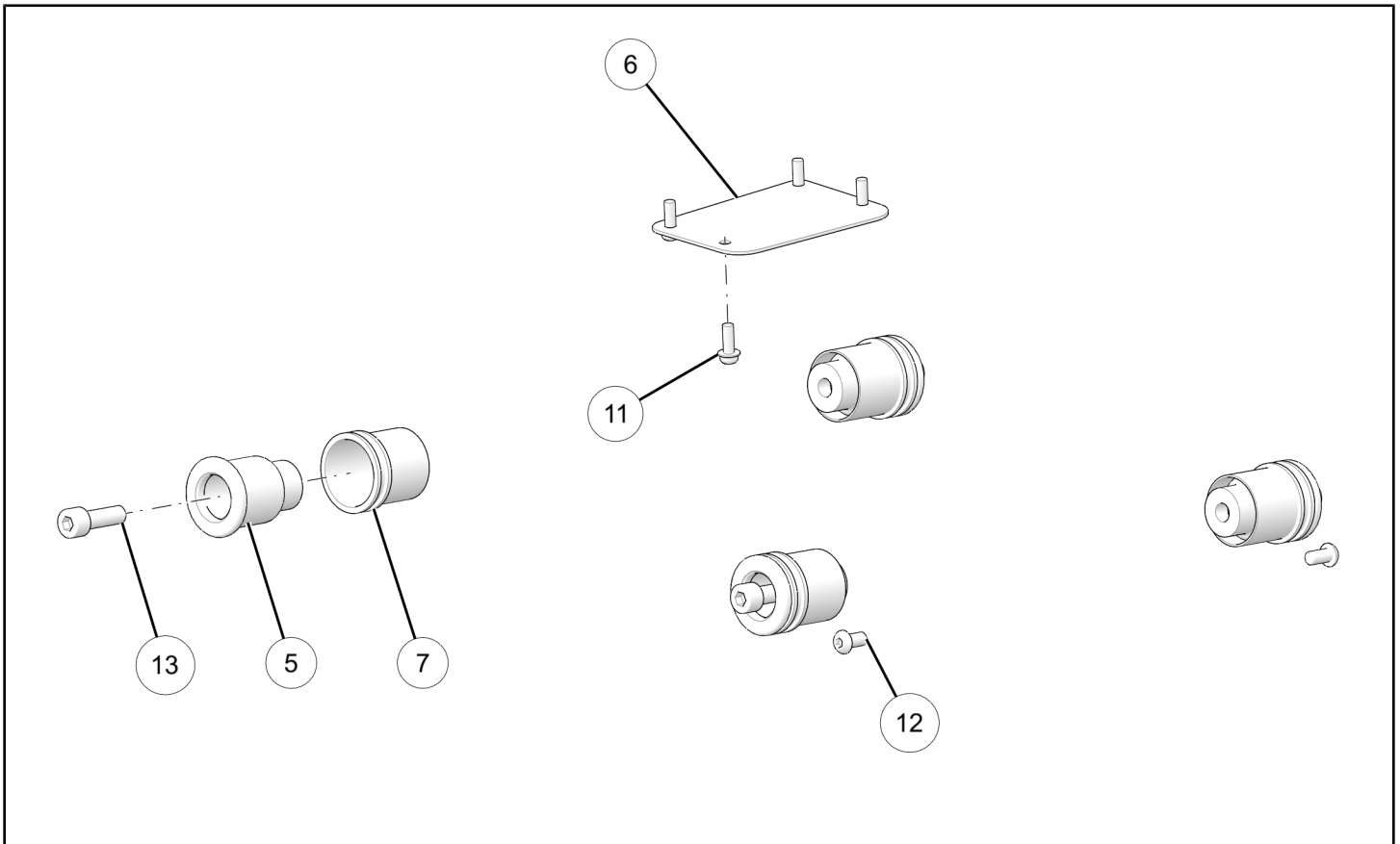

REF	QTY	PART DESCRIPTION	P/N AVAILABLE SEPARATELY
1	1	Harness-Trunk, Indian® (see <i>Harness Detail</i> section)	2412614
2	1	Harness-Trunk, Chieftain® Seat (see <i>Harness Detail</i> section)	2413049
3	1	Harness-Trunk, No Amp, Indian® (see <i>Harness Detail</i> section)	2413395
4	1	Harness-Jumper, Trunk (see <i>Harness Detail</i> section)	2414308
5	4	Spool-Trunk	5139711
6	1	Bracket-Amp Delete, Black	5260416-266
7	4	Bushing-Spool, Trunk	5455069
8	1	PL-Wire Cover, Seat, Touring, Heated (not shown)	5814094
9	2	Cable Tie (not shown)	7080138
10	3	Cable Tie-Releasable (not shown)	7082000
11	4	Screw-Washer Pan Head, 10 - 16, HiLo	7518641
12	2	Screw-Hex Button Head, M6 x 1.0 x 12	7519000
13	4	Screw-Socket Head, M8 x 1.25 x 25	7520170
	1	Instructions	9929569

HARNESS DETAIL

TRUNK HARNESS ①

P/N 2412614

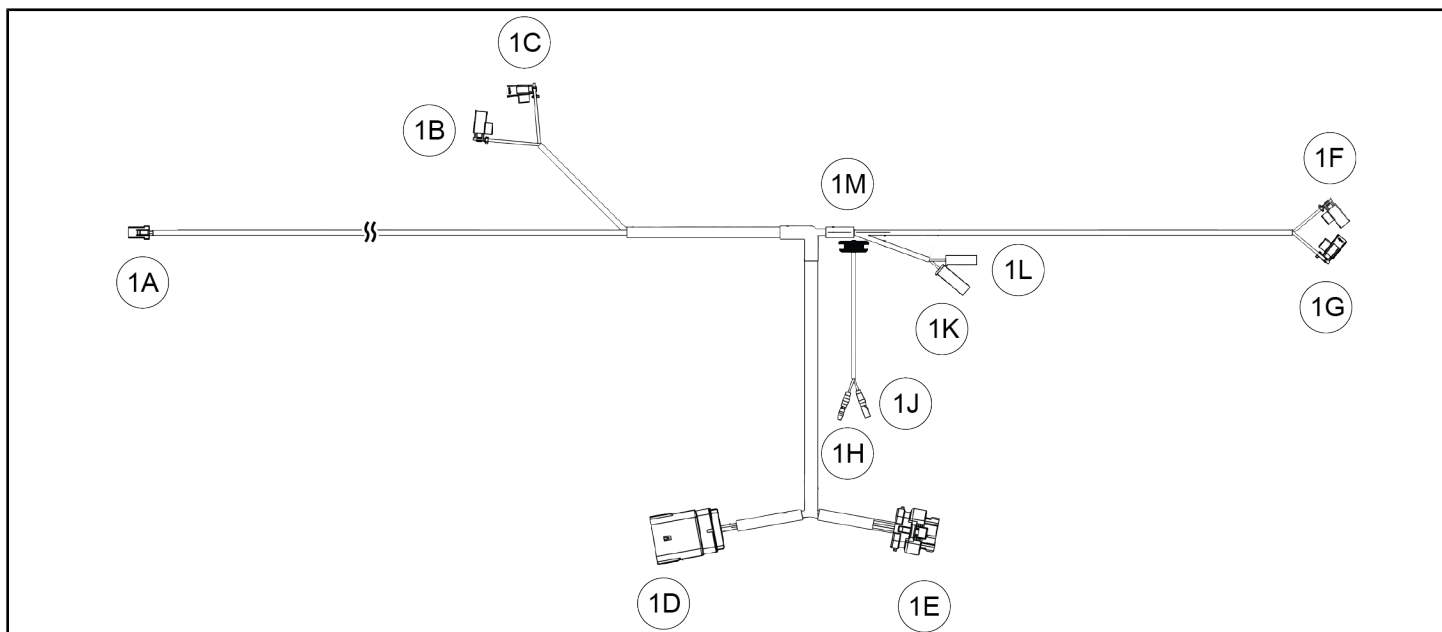

REF	PART DESCRIPTION	PIN QTY/ GENDER	CONNECTS TO
1A	Connector, Taillight	4 pin Female	Taillight
1B	Connector, Trunk Speaker, LH, Ground	1 pin Female	Trunk Speaker, LH

REF	PART DESCRIPTION	PIN QTY/ GENDER	CONNECTS TO
1C	Connector, Trunk Speaker, LH, Positive	1 pin Female	Trunk Speaker, LH
1D	Connector, Chassis Harness	16 Male	Chassis Harness
1E	Connector, Amp	14 Female	Amp
1G	Connector, Trunk Speaker, RH, Ground	1 pin Female	Trunk Speaker, RH
1F	Connector, Trunk Speaker, RH, Positive	1 pin Female	Trunk Speaker, RH
1D	Connector, Chassis Harness	16 pin Male	Chassis Harness
1H	Connector, Bullet, Lock A	Female	Lock A, Trunk Unlock
1J	Connector, Bullet, Lock B	Male	Lock A, Trunk Lock
1K	Connector, Accessory Port, Positive	N/A	Accessory Port, Positive
1L	Connector, Accessory Port, Ground	N/A	Accessory Port, Ground
1M	Grommet-Rubber	N/A	Trunk

SEAT HARNESS ②
P/N 2413049

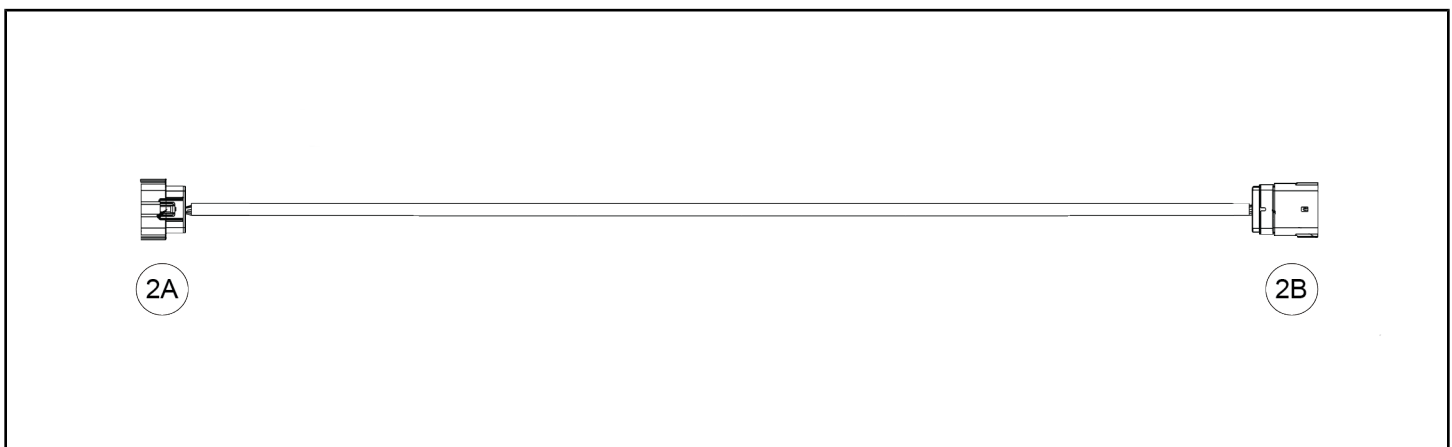

REF	PART DESCRIPTION	PIN QTY/ GENDER	CONNECTS TO
2A	Connector, Chassis Harness	16 pin Female	Harness, Chassis
2B	Connector, Trunk	16 pin Male	Harness, Trunk ① or ③

TRUNK HARNESS ③
P/N 2413395

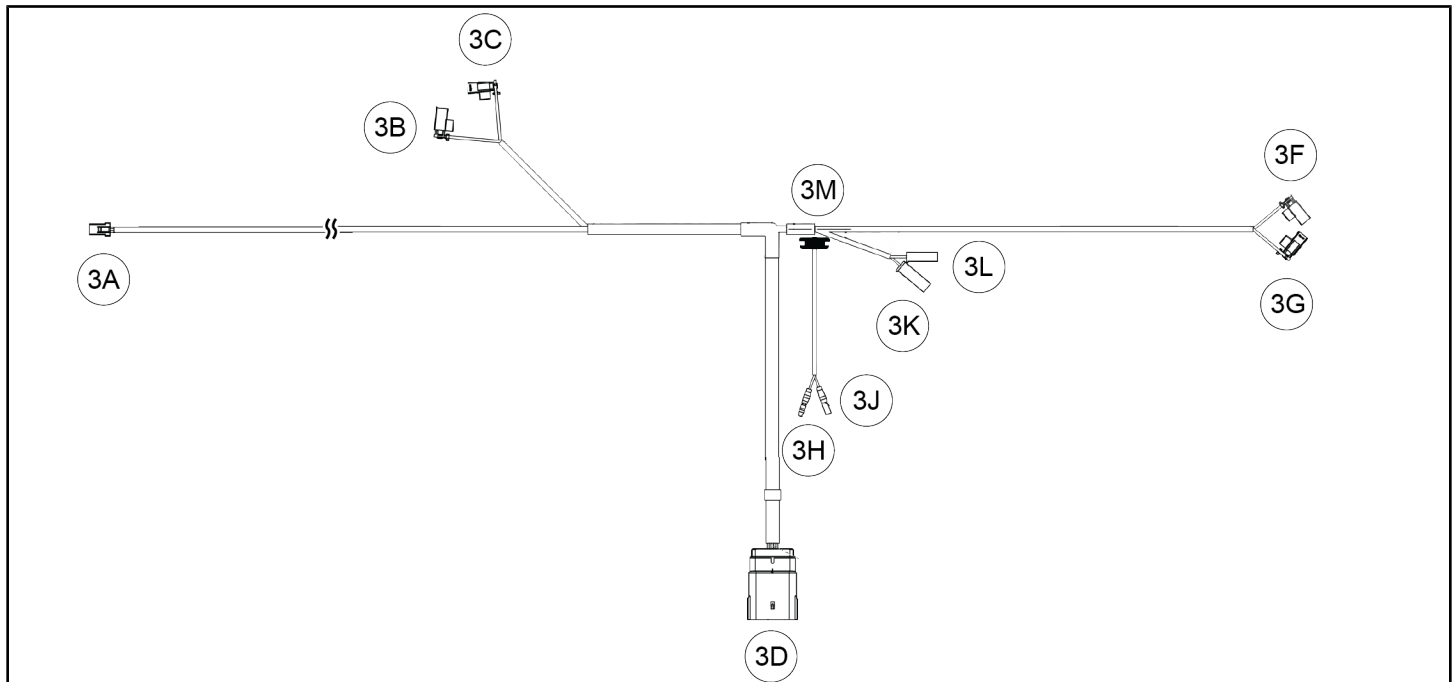

REF	PART DESCRIPTION	PIN QTY/ GENDER	CONNECTS TO
3A	Connector, Taillight	4 pin Female	Taillight
3B	Connector, Trunk Speaker, LH, Ground	1 pin Female	Trunk Speaker, LH
3C	Connector, Trunk Speaker, LH, Positive	1 pin Female	Trunk Speaker, LH
3D	Connector, Chassis Harness	16 Male	Chassis Harness
3G	Connector, Trunk Speaker, RH, Ground	1 pin Female	Trunk Speaker, RH
3F	Connector, Trunk Speaker, RH, Positive	1 pin Female	Trunk Speaker, RH
3D	Connector, Chassis Harness	16 pin Male	Chassis Harness
3H	Connector, Bullet, Lock A	Female	Lock A, Trunk Unlock
3J	Connector, Bullet, Lock B	Male	Lock A, Trunk Lock
3K	Connector, Accessory Port, Positive	N/A	Accessory Port, Positive
3L	Connector, Accessory Port, Ground	N/A	Accessory Port, Ground
3M	Grommet-Rubber	N/A	Trunk

JUMPER HARNESS ④

P/N 2414308



REF	PART DESCRIPTION	PIN QTY/ GENDER	CONNECTS TO
4A	Connector, Chassis Harness	16 pin Male	Harness, Chassis
4B	Connector, Trunk	2 pin Female	Harness, Trunk
4C	Tape, White	N/A	Identifies installation location for cable tie ⑨

TOOLS REQUIRED

- Safety Glasses
- Socket Set, Metric
- Socket Set, Hex Bit, Metric
- Torque Wrench

IMPORTANT

Your Indian Motorcycle® Trunk Installation Kit is exclusively designed for your vehicle. Please read the installation instructions thoroughly before beginning. Installation is easier if the vehicle is clean and free of debris. For your safety, and to ensure a satisfactory installation, perform all installation steps correctly in the sequence shown.

INSTALLATION INSTRUCTIONS

VEHICLE PREPARATION

GENERAL

1. Ensure motorcycle is parked on a flat surface, kickstand is fully extended, and vehicle is stable prior to installation.
2. Remove keyless fob from proximity of motorcycle.
3. Remove saddlebags as per owner's manual.

SPOOL INSTALLATION

- TIP**

Torque strut cover screws: 84 in. lbs. (9.5 Nm)

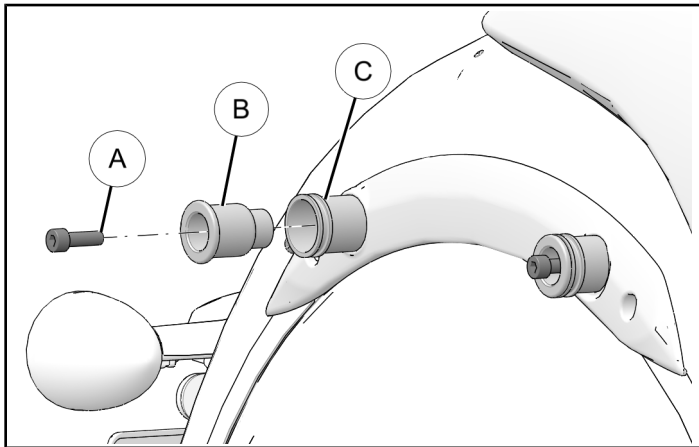

- ## TORQUE

Four screws ⑬: 25 ft. lbs. (34 Nm)

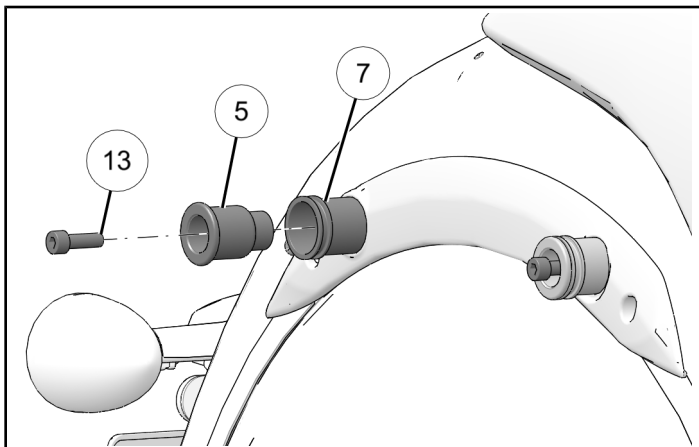

2. Remove and retain trunk liners.

-

-
- This diagram illustrates the front end of a vehicle, showing the hood, front bumper, and front grille assembly. The hood is shown in a slightly raised position, revealing the front grille and bumper area. The front grille is a large, rectangular component with a mesh pattern. The front bumper is a large, curved component that fits around the front of the vehicle. The diagram shows the relative positions of these components, indicating how they are assembled.

- ## TRUNK HARNESS ① OR ③ ROUTING

Trunk Harness ① shown; Trunk Harness ③ similar.

Ride Command® Equipped	Standard Instrument Cluster
Trunk Harness ③ P/N 2413395	Trunk Harness ① P/N 2412614

1. Remove and retain two screws ① from each speaker housing.

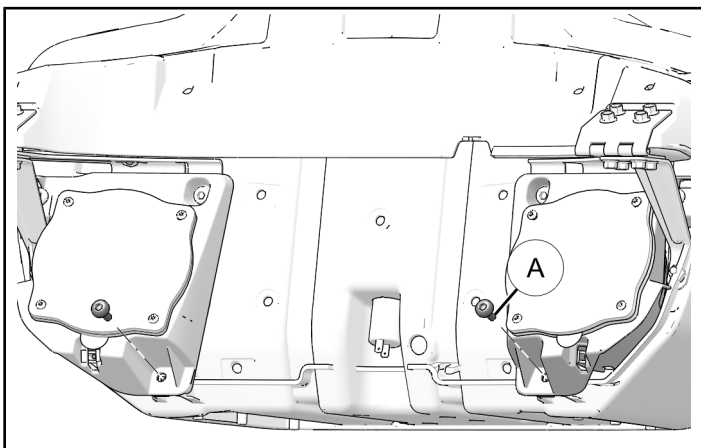

- Route lock connectors 1H and 1J into trunk compartment. Seal hole with grommet 1M.
- Join positive connector 1K (small connector) to power supply.
- Join ground connector 1L (large connector) to power supply.

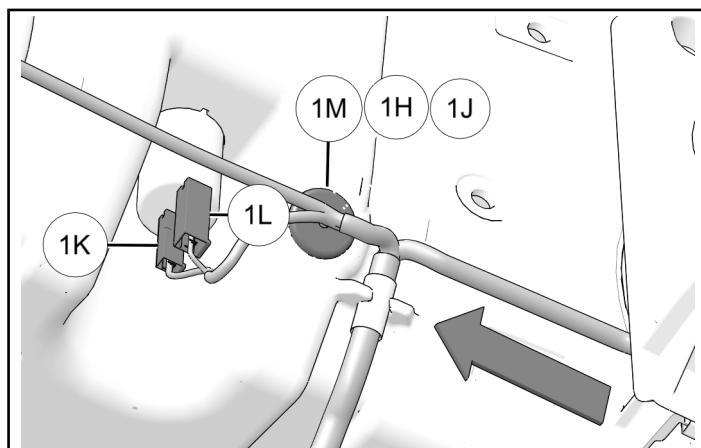

2. Flex LH speaker housing upward to route trunk harness connectors 1A, 1B, 1C.

- Route trunk harness connector 1A upwards along speaker housing and clip to housing.
- Route trunk harness connectors 1B and 1C through hole, into trunk compartment.

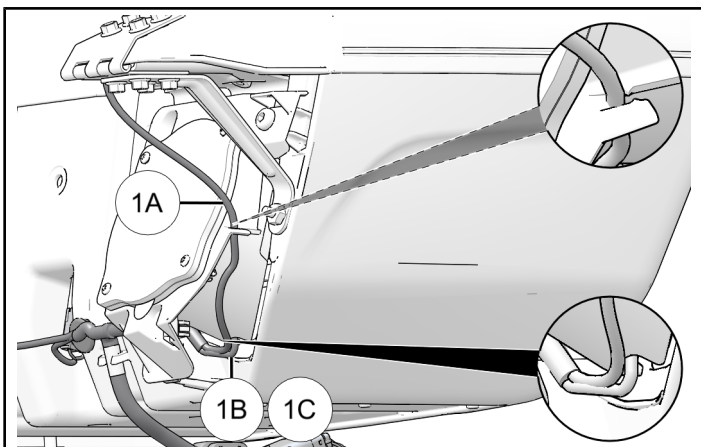

3. Secure center of trunk harness ① to built-in clip at taped location.

4. Flex RH speaker housing upward to route trunk harness connectors 1F and 1G into trunk compartment.

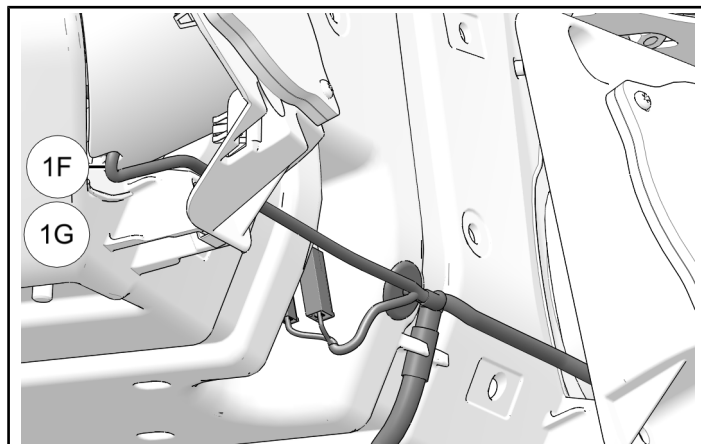

5. Continue to route trunk harness connector 1A up along trunk back rest and join to taillight connector. Ensure harness is firmly secure within clips.

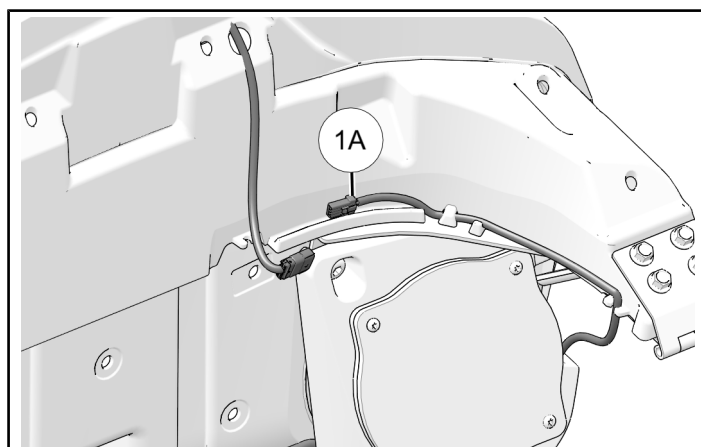

6. Reinstall speaker housings with two screws (A).

TORQUE

Two screws (A): 36 in. lbs. (4 Nm)

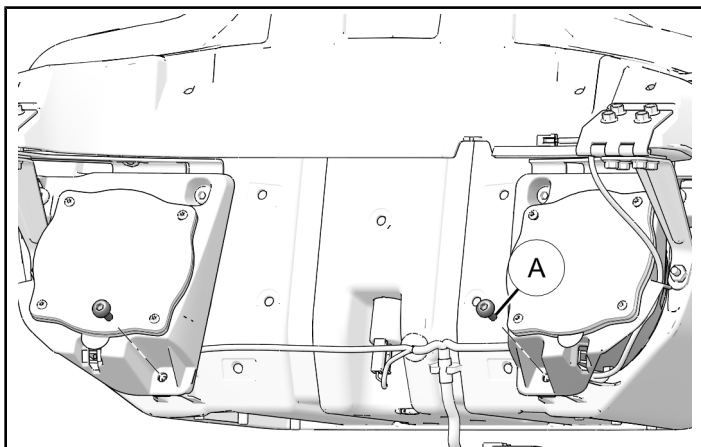

TRUNK AUDIO INSTALLATION

1. Follow installation instructions for selected audio kit (sold separately).
2. Reinstall speaker enclosures with three retained screws (A) per enclosure.

TORQUE

Six screws (A): 36 in. lbs. (4 Nm)

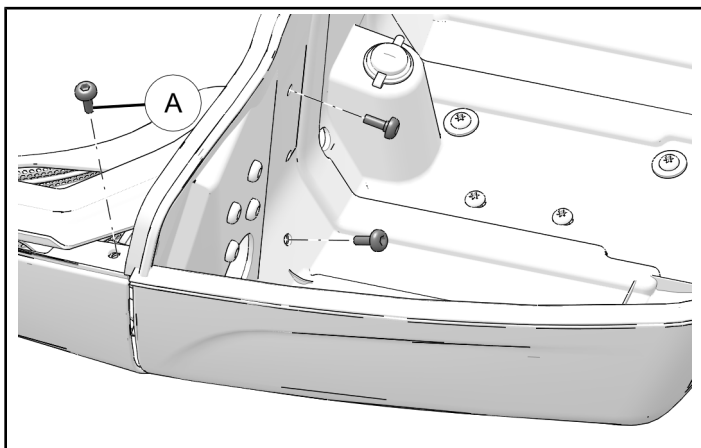

TRUNK BASE AND TRUNK INSTALLATION

1. Install *Trunk Frame Kit* P/N 2884048-XXX onto new spools.
 - a. Hook front of trunk frame onto front spools before lowering frame-rear onto rear spools.

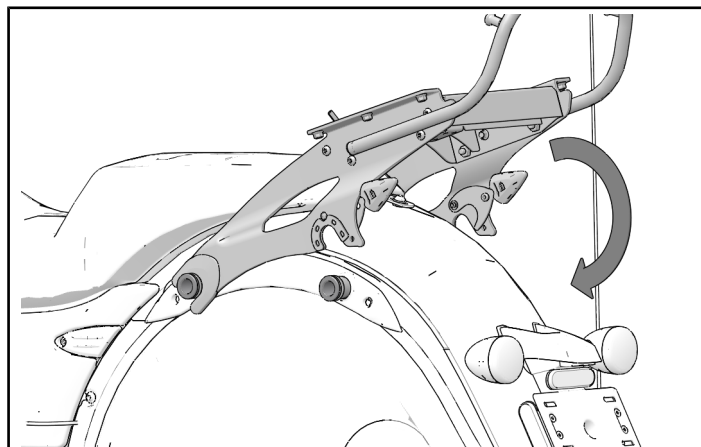

- b. Close latches onto spools to lock frame into place.

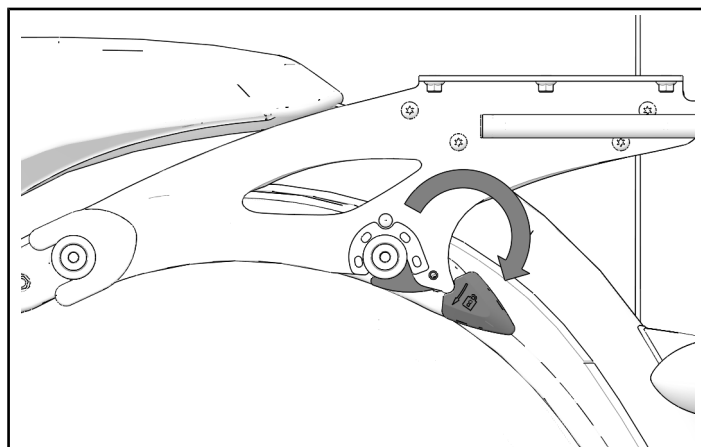

2. Proceed with installing *Quick Release Trunk Kit* P/N 2884046-XXX, as per installation instructions.

SEAT HARNESS ② ROUTING (IF APPLICABLE)

NOTE

This section references specific components of Seat Harness ② P/N 2414487. See *Harness Detail* section for details.

NOTE

This section references components on *Heated Seat Kits* (sold separately).

1. Remove seat as per owner's manual.
2. Set seat upside down on clean surface.
3. Install harness to underside of seat.

- Attach seat harness ② to clip, built-in to seat base.
- Attach to seat with one cable tie ⑨.

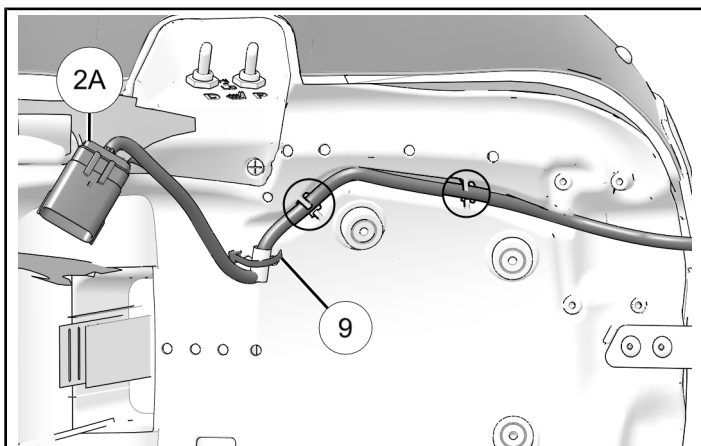

4. Install wire cover ⑥ onto seat base with four screws ⑪.

TORQUE

Four screws ⑨: 14 in. lbs. (1.6 Nm)

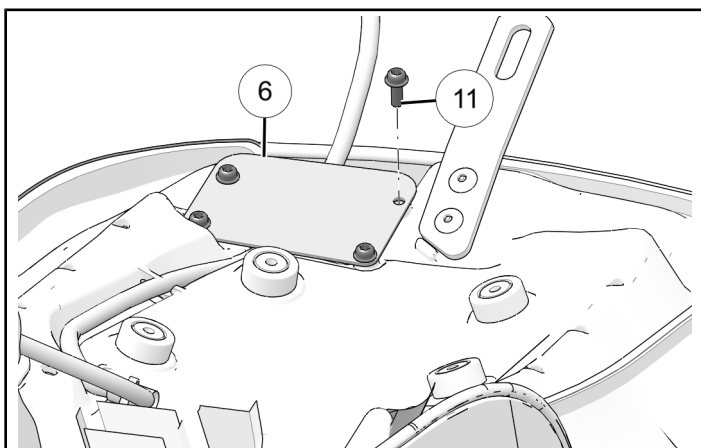

5. Place seat back onto motorcycle and before installing join harness connector 2A to the chassis harness connectors. Install seat as per owner's manual.

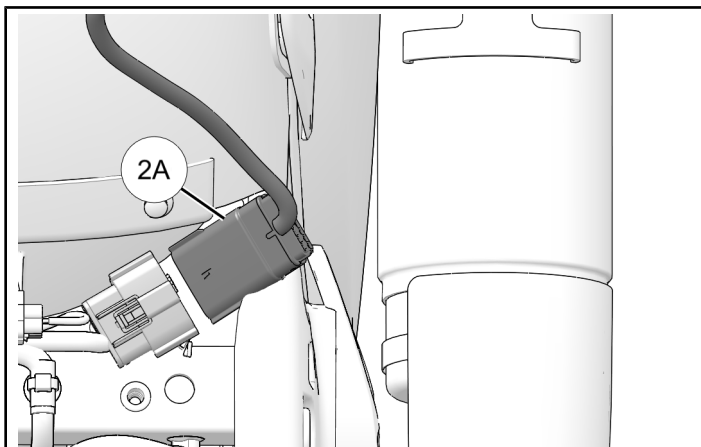

6. Join seat harness connector 2B to trunk harness connector 1D or 3D (depending on trunk harness used). Once joined, place connection atop bracket.

NOTE

Secure seat harness to trunk frame with cable tie ⑨.

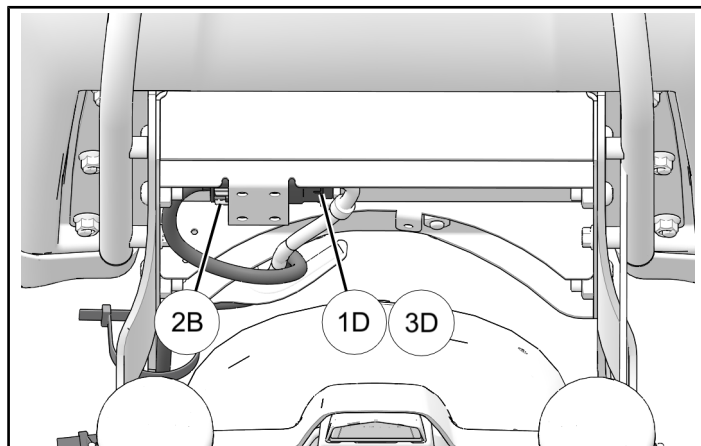

JUMPER HARNESS ④ ROUTING (IF APPLICABLE)

NOTE

This section references components on *Jumper Harness ④* P/N 2414308 and is to be used with stock seat.

1. Remove seat as per owner's manual.
2. Connect connector 4A to chassis harness and begin to route harness under LH side cover.

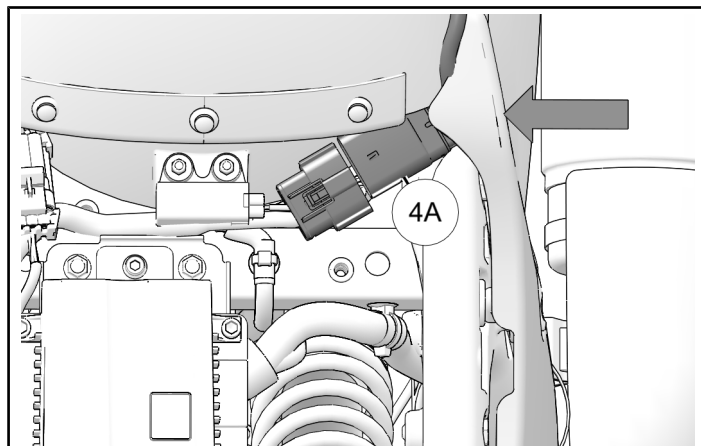

- Secure harness to trunk base with two cable ties ⑩.

CAUTION

Ensure cable ties do not come into contact with painted surfaces during this step.

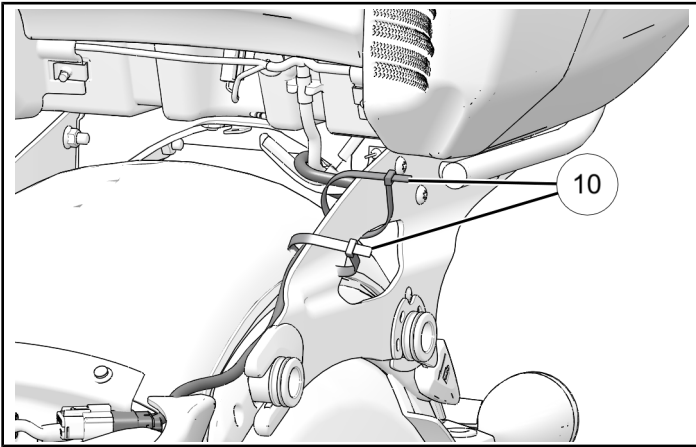

- Join seat harness connector 4B to trunk harness connector 1D or 3D (depending on trunk harness used). Once joined, place connection atop bracket.

NOTE

Secure seat harness to trunk frame with cable tie ⑦.

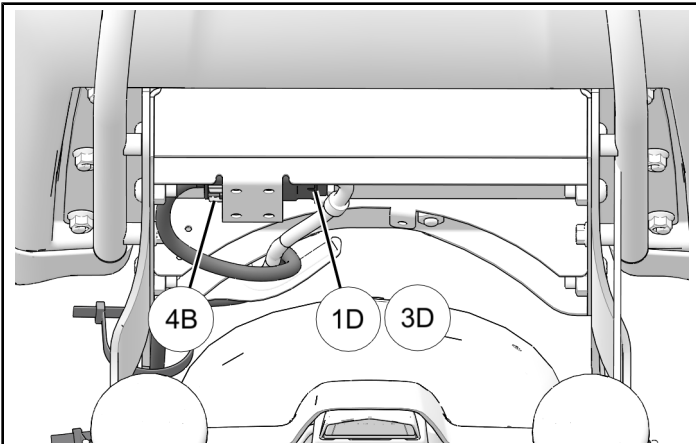

FEEDBACK FORM

A feedback form has been created for the installer to provide any comments, questions or concerns about the installation instructions. The form is viewable on mobile devices by scanning the QR code or by clicking [HERE](#) if viewing on a PC.

- Reinstall seat as per owner's manual.

TAMPER RESISTANT INSTALLATION (OPTIONAL)

- Install two screws ⑫ into trunk frame to securely lock latches.

NOTE

Screws ⑩ are only accessible with hard saddlebags removed.

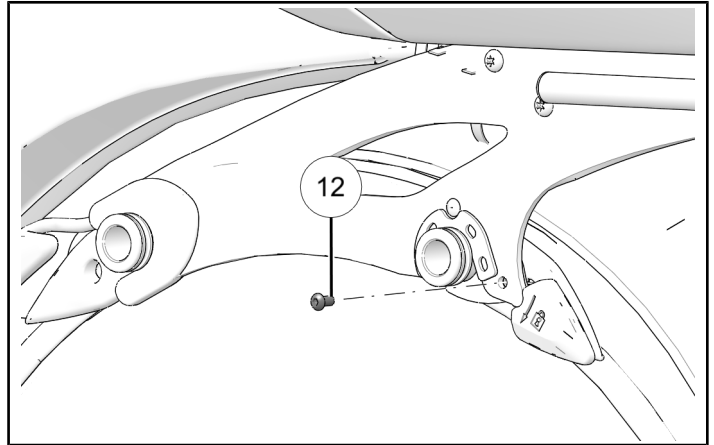

VEHICLE REASSEMBLY

GENERAL

- Reinstall saddlebags as per owner's manual.

FEEDBACK FORM

