

WINDSHIELD / WIND DEFLECTOR KIT



P/N 2883506, 2883507, 2884009, 2884010, 2884011

INTERNATIONAL INSTRUCTIONS

DE DEUTSCH

Laden Sie die neuesten PDF-Anweisungen von www.indianmotorcycle.de herunter.

FR FRANÇAIS

Télécharger les dernières instructions en format PDF sur www.indianmotorcycle.fr.

IT ITALIANO

Scarica l'ultima versione delle istruzioni in formato PDF da www.indianmoto.it.

EN ENGLISH

Download the latest PDF instructions from www.indianmotorcycle.com.

ES ESPAÑOL

Descargue las instrucciones más recientes en formato PDF de www.indianmotorcycle.mx / www.indianmotorcycle.es.

ZH 中文

从www.indianmotorcycle.cn下载最新的PDF说明。

1



2



3



4



APPLICATION

Verify accessory fitment at www.indianmotorcycle.com.

FTR™ 1200	FTR™ 1200 with Headlight Cowl
<i>Low Wind Deflector Kit</i> P/N 2883507	<i>Low Wind Deflector Kit</i> P/N 2884010
<i>Mid Windshield Kit</i> P/N 2883506	<i>Mid Windshield Kit</i> P/N 2884009
<i>Windshield Mount Kit</i> P/N 2884011	<i>Windshield Mount Kit</i> P/N 2884011

IMPORTANT

Indian Motorcycle® FTR™ 1200 *Windshield / Wind Deflector Kits* are not compatible with *Front Number Plate Kit* P/N 2883767.

BEFORE YOU BEGIN

Read these instructions and check to be sure all parts and tools are accounted for. Please retain these installation instructions for future reference and parts ordering information.

REQUIRED SOLD SEPARATELY

Only parts for installation of the *Windshield / Wind Deflector Kit* are included. For complete installation, the following additional kit is required (sold separately).

- *Windshield Mount Kit*, P/N 2884011

KIT CONTENTS

LOW WIND DEFLECTOR WITH HEADLIGHT COWL, P/N 2884010

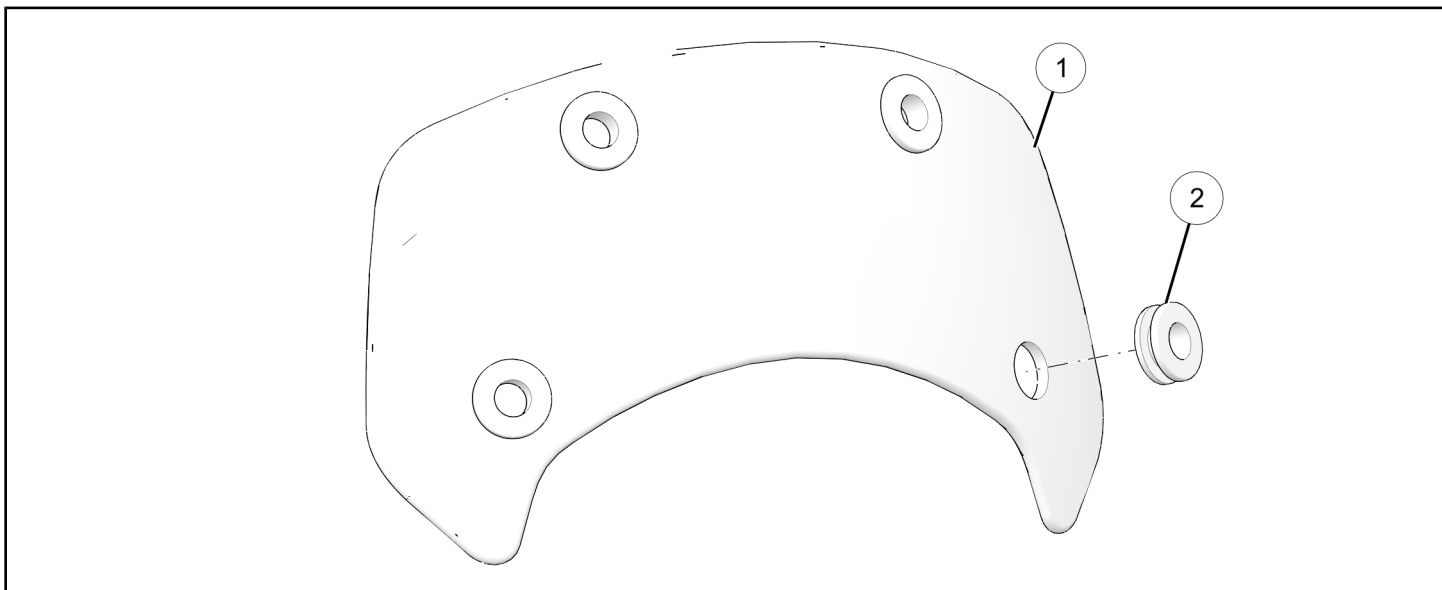

REF	QTY	PART DESCRIPTION	P/N AVAILABLE SEPARATELY
1	1	Windscreen-Small	n/a
2	4	Grommet-Windscreen	5416860
	1	Instructions	9929479

MID WINDSHIELD WITHOUT HEADLIGHT COWL, P/N 2883506

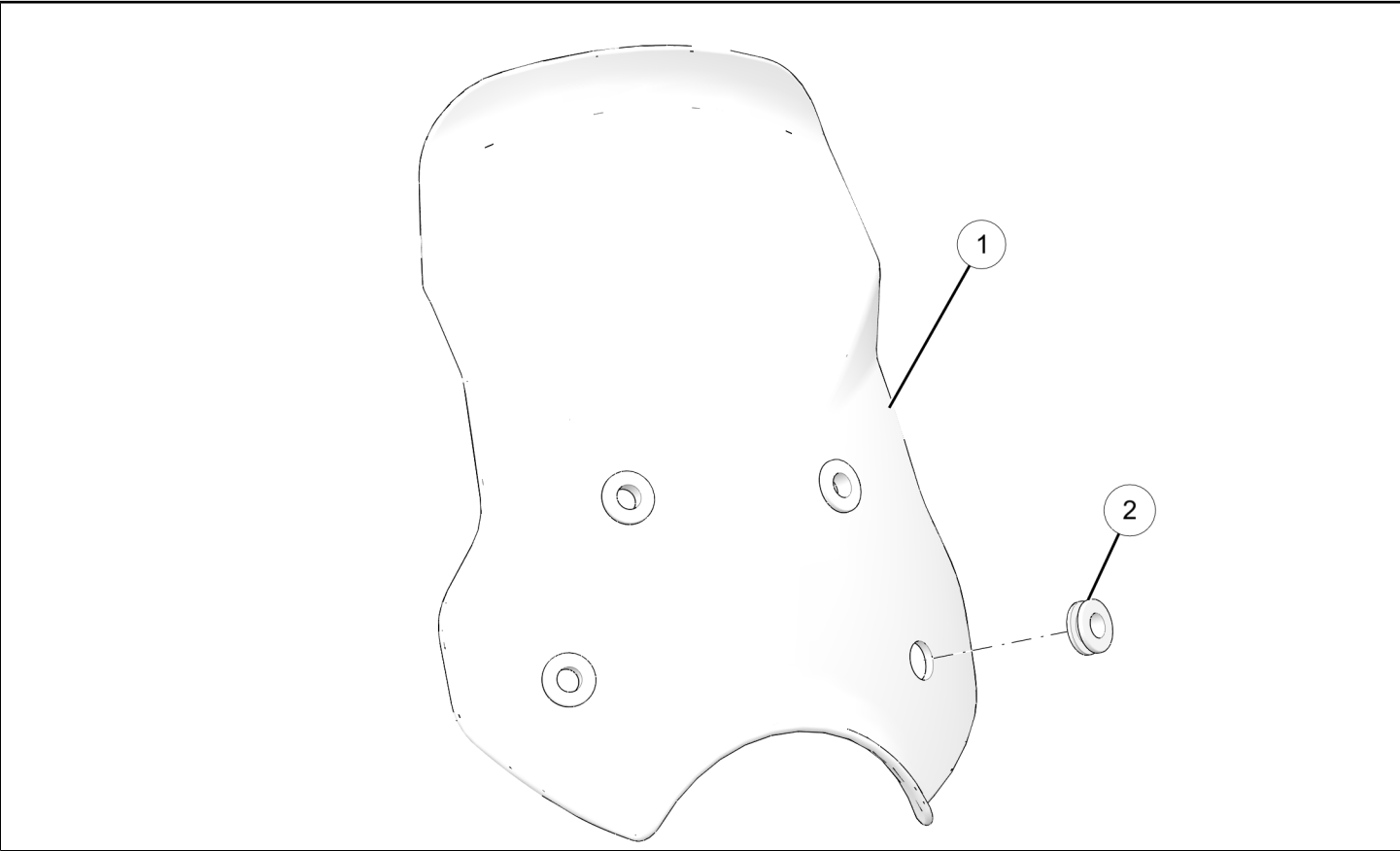

REF	QTY	PART DESCRIPTION	P/N AVAILABLE SEPARATELY
1	1	Windscreen–Mid	n/a
2	4	Grommet–Windscreen	5416860
	1	Instructions	9929479

LOW WIND DEFLECTOR WITHOUT HEADLIGHT COWL, P/N 2883507

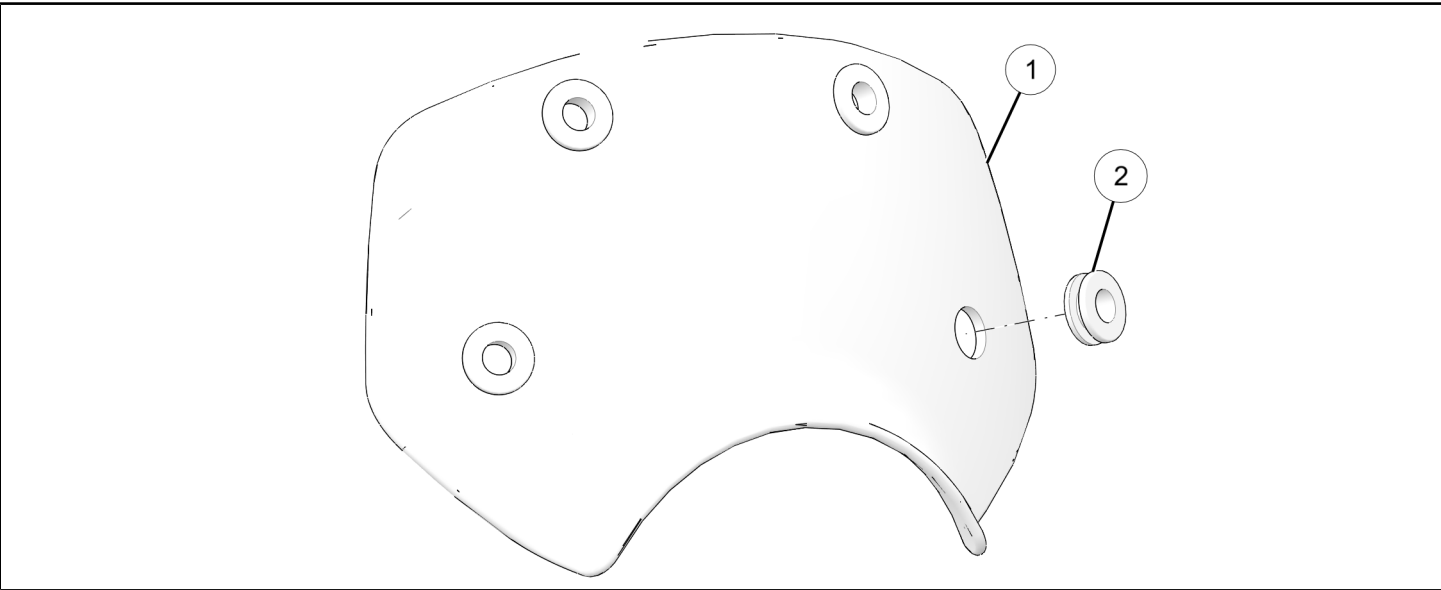

REF	QTY	PART DESCRIPTION	P/N AVAILABLE SEPARATELY
1	1	Windscreen–Small, Nacelle	n/a
2	4	Grommet–Windscreen	5416860
	1	Instructions	9929479

MID WINDSHIELD WITH HEADLIGHT COWL, P/N 2884009

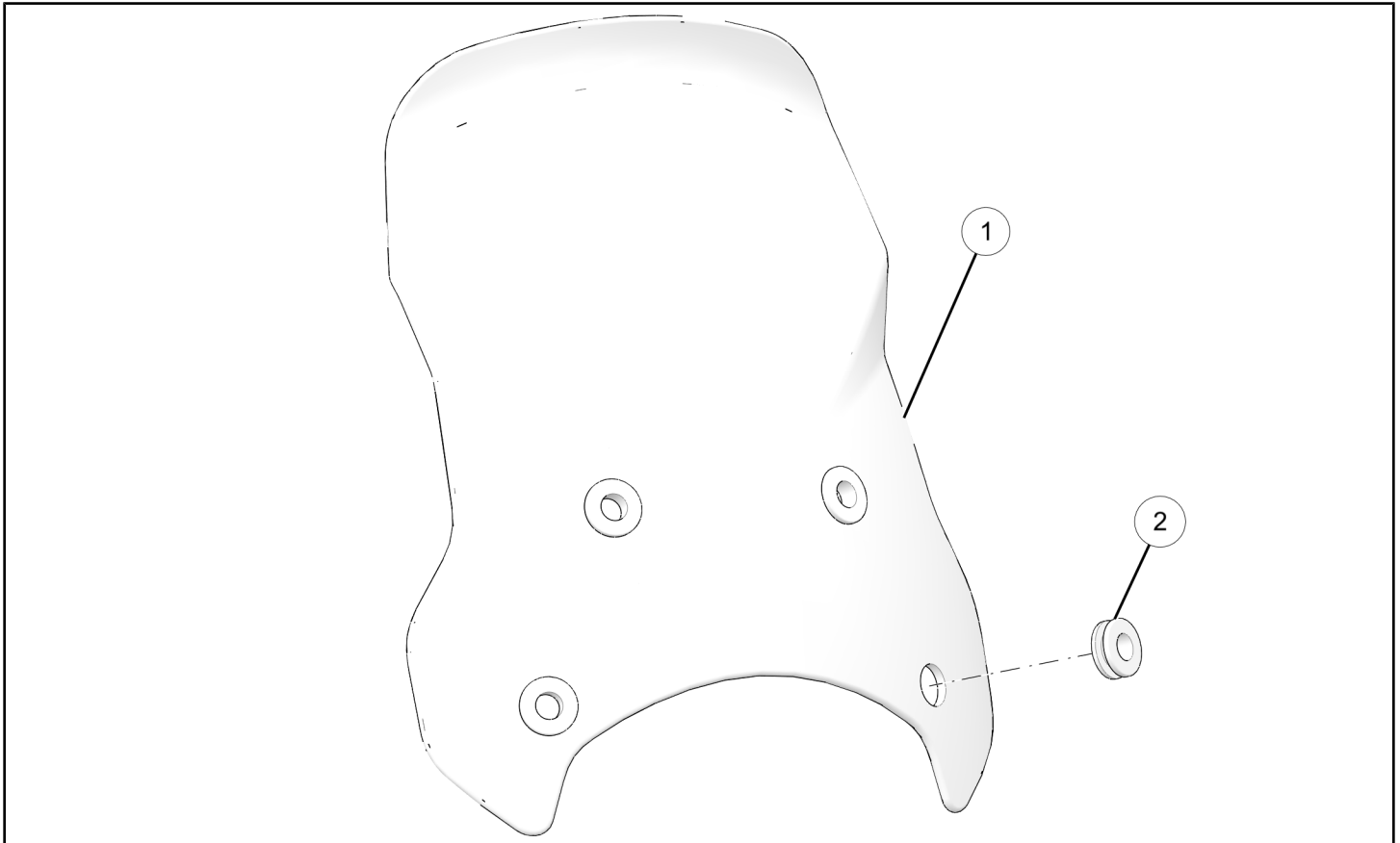

REF	QTY	PART DESCRIPTION	P/N AVAILABLE SEPARATELY
1	1	Windscreen–Mid, Nacelle	n/a
2	4	Grommet–Windscreen	5416860
	1	Instructions	9929479

WINDSCREEN MOUNT KIT, P/N 2884011

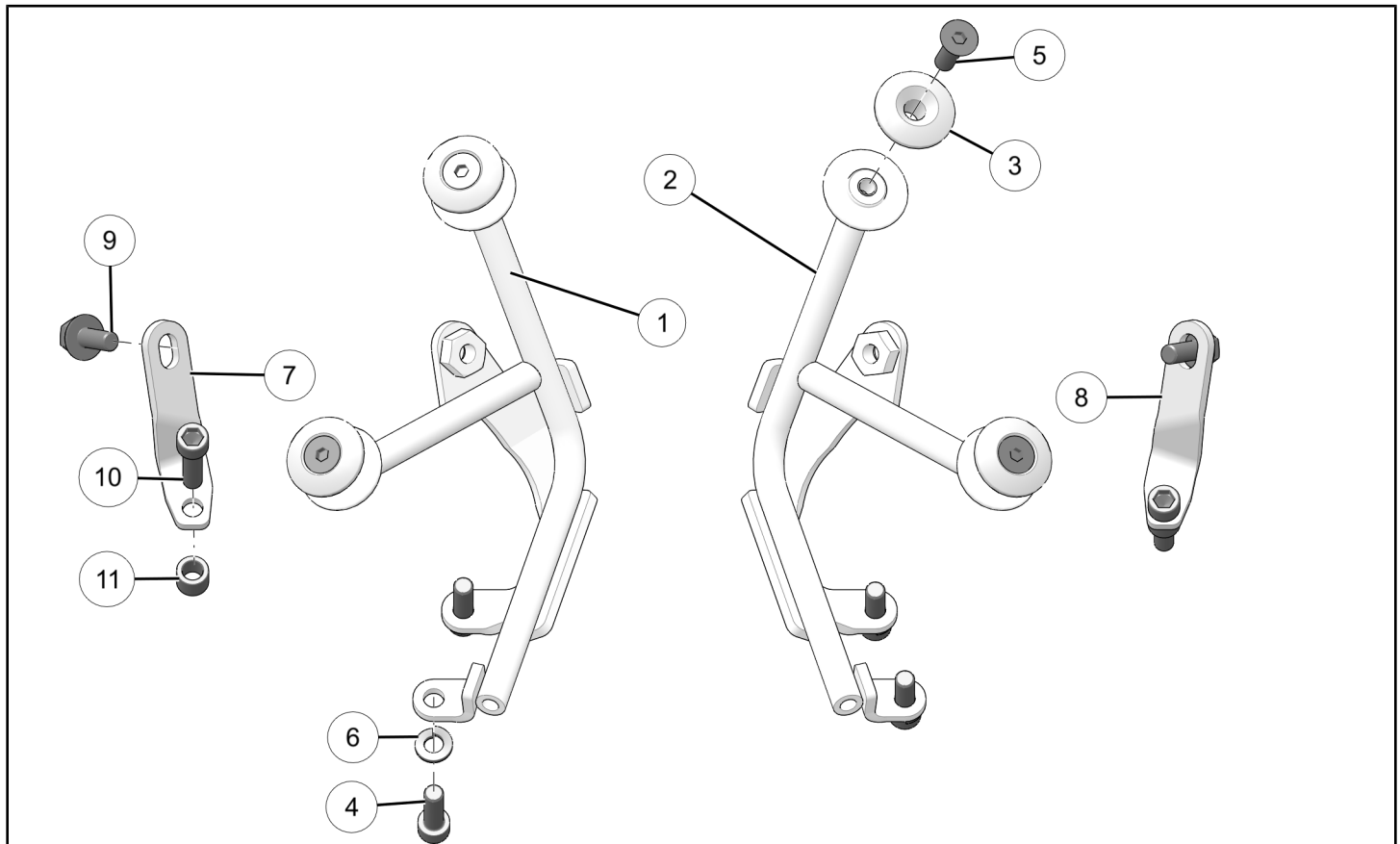

REF	QTY	PART DESCRIPTION	P/N AVAILABLE SEPARATELY
1	1	Weld-Windscreen Mount, FTR™, RH	n/a
2	1	Weld-Windscreen Mount, FTR™, LH	n/a
3	4	Cap-Windscreen	5143218
4	4	Screw-Socket Head, M6 x 1.0 x 20	7517305
5	4	Screw-Flat Head, M6 x 1.0 x 20	7521054
6	4	Washer-Lock, 6 mm	7552616
7	1	Bracket-Windshield, Mid, Left-Hand	5268491
8	1	Bracket-Windshield, Mid, Right-Hand	5268492
9	2	Screw-Hex Flange, M6 x 1.0 x 14	7520143
10	2	Screw-Socket Head, M6 x 1.0 x 20	7517638
11	2	Spacer-Windscreen	5143095
	1	Instructions	9929479

TOOLS REQUIRED

- Safety Glasses
- Hex Key Set, Metric
- Socket Set, Hex Bit, Metric
- Socket Set, Metric
- Torque Wrench

IMPORTANT

Your accessory kit is exclusively designed for your vehicle. Please read the installation instructions thoroughly before beginning. Installation is easier if the vehicle is clean and free of debris. For your safety, and to ensure a satisfactory installation, perform all installation steps correctly in the sequence shown.

INSTALLATION INSTRUCTIONS

VEHICLE PREPARATION

GENERAL

1. Turn key or ignition switch to OFF position and remove key.
2. Ensure motorcycle is parked on a flat surface, kickstand is fully extended, and vehicle is stable prior to installation.

HEADLIGHT COWL REMOVAL (IF APPLICABLE)

1. Remove and retain four screws **A** and four washers **B** from headlight cowl.

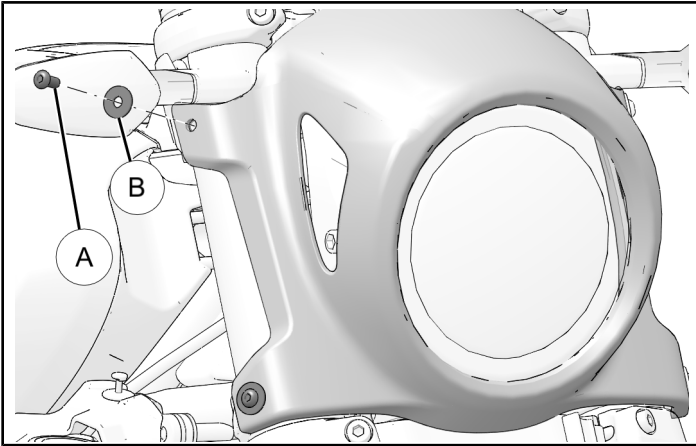

2. Remove headlight cowl and set aside for reinstallation.

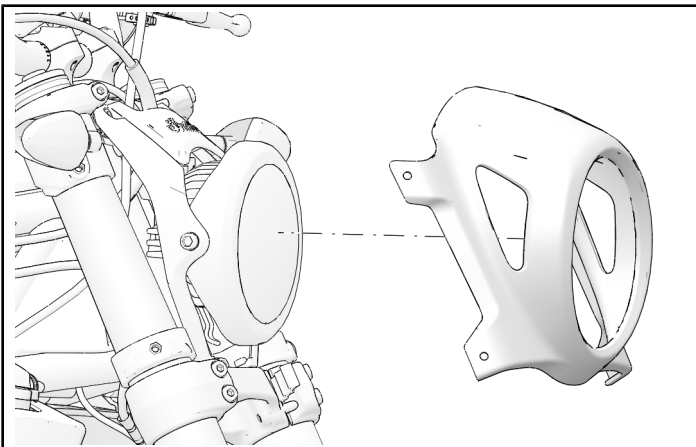

HEADLIGHT REMOVAL

1. Remove and retain two screws **A** from top of headlight bracket.

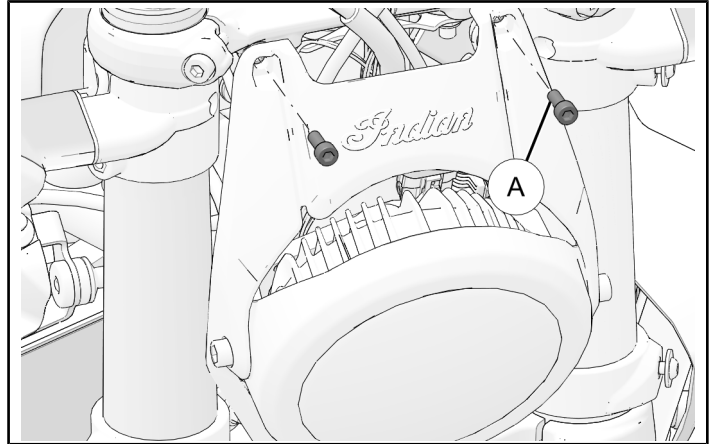

2. Remove and retain two screws **A** from bottom of headlight bracket.

TIP

Turn handlebars lock-to-lock to access two screws **A** from rear-side.

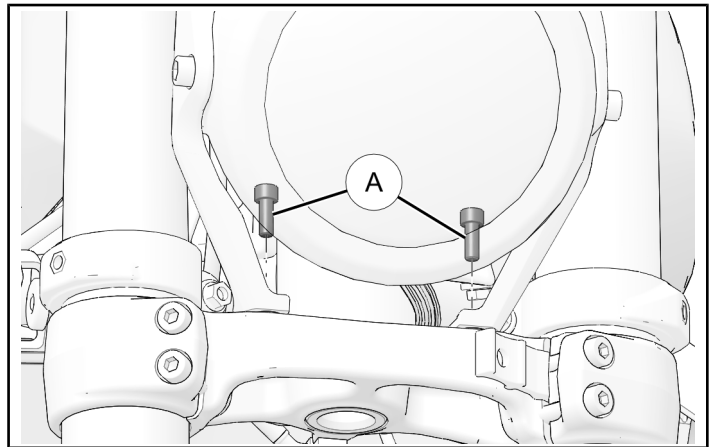

3. With headlight assembly unmounted, tilt assembly forward and slide electronic throttle control (ETC) connection off push-pin clip. It is not necessary to disconnect harnesses.

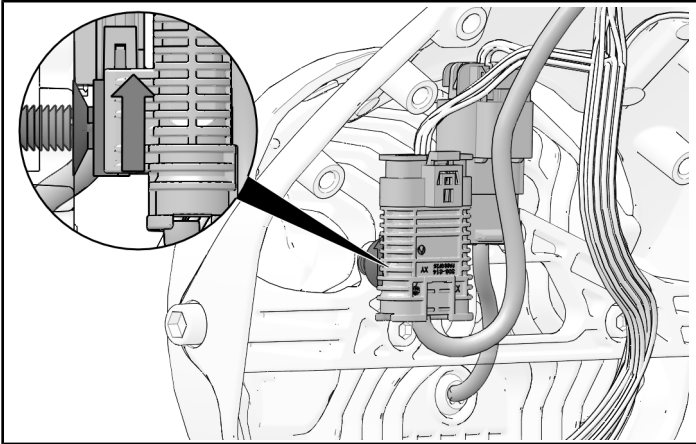

4. Disconnect headlight from chassis harness. Headlight connector will remain installed onto push-pin clip.

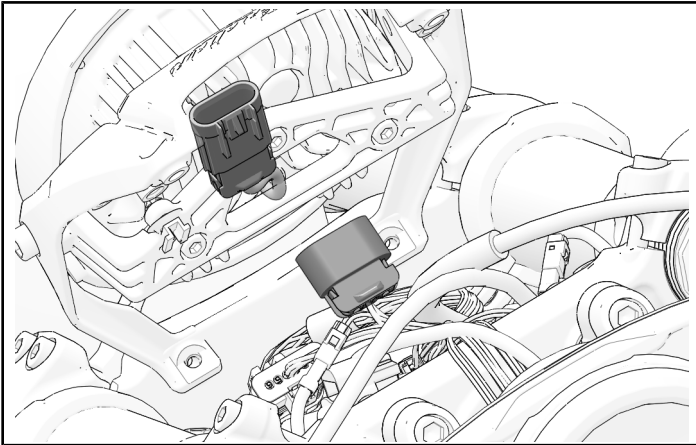

5. Carefully set headlight assembly aside on soft surface as to not scratch finished surfaces.

ACCESSORY INSTALLATION

WINDSHIELD MOUNT KIT P/N 2884011 INSTALLATION

NOTE

All Indian Motorcycle® FTR™ 1200 models require *Windshield Mount Kit P/N 2884011* to be installed prior to windshield installation.

1. Protect face of headlight assembly with cloth or other soft surface before placing face down.
2. Loosely install brackets ⑦ ⑧ onto windscreen mounts with bracket fasteners ⑨.

Do not torque fasteners at this time.

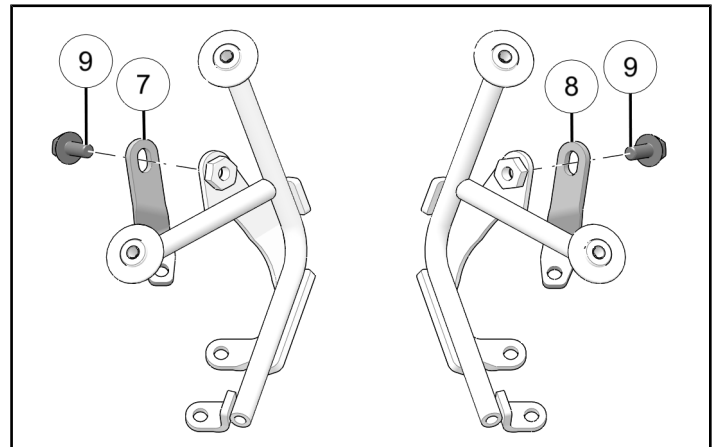

3. Slide windscreen mount assembly over headlight bracket and place one spacer ⑪ between windscreen bracket and headlight bracket in each top mounting hole.

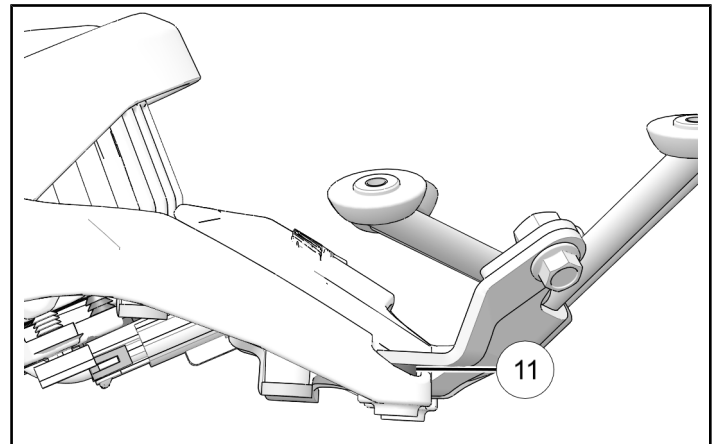

4. Install right-hand mount ① and left-hand mount ② to back of headlight bracket with four screws ④ and four washers ⑥.

TORQUE

Four screws ④:
96 in-lbs (11 N·m)

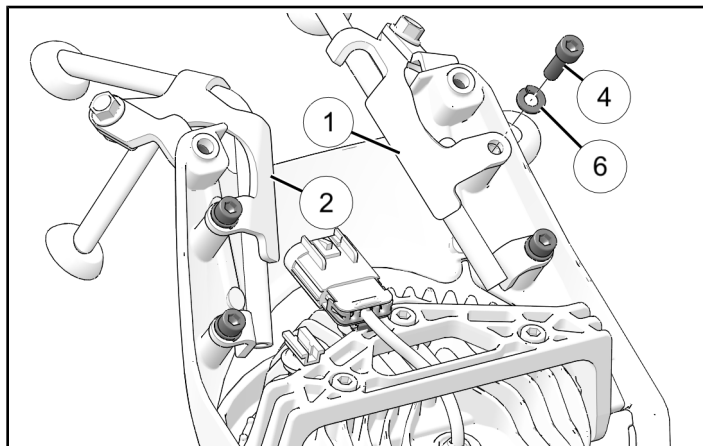

5. Re-join headlight connector to chassis harness connector. Re-mount ETC connection onto push-pin clip, on back of headlight mount.
6. Reinstall bottom of headlight assembly with two screws ①.

TIP

Turn handlebars lock-to-lock to access two screws ① from rear-side.

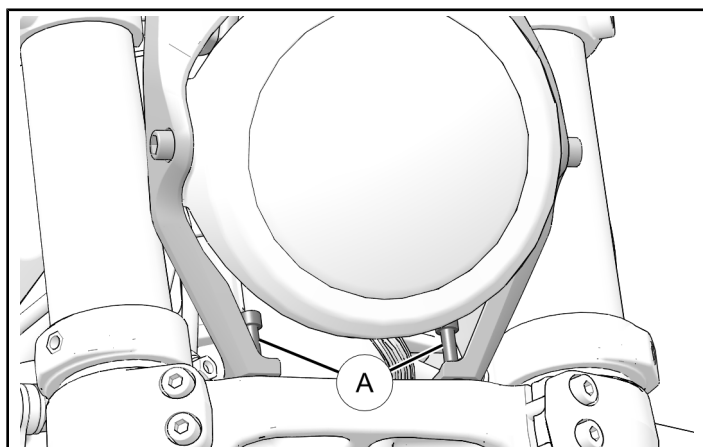

7. Ensure two screws ⑩ pass through spacers and reinstall headlight bracket. Torque two bracket fasteners ⑨ during this step.

TORQUE

Two screws ⑩:
84 in-lbs (9.5 N·m)

TORQUE
Bracket Fasteners ⑨: 96 in-lbs (11 N·m)

TORQUE
Two screws ①: 84 in-lbs (9.5 N·m)

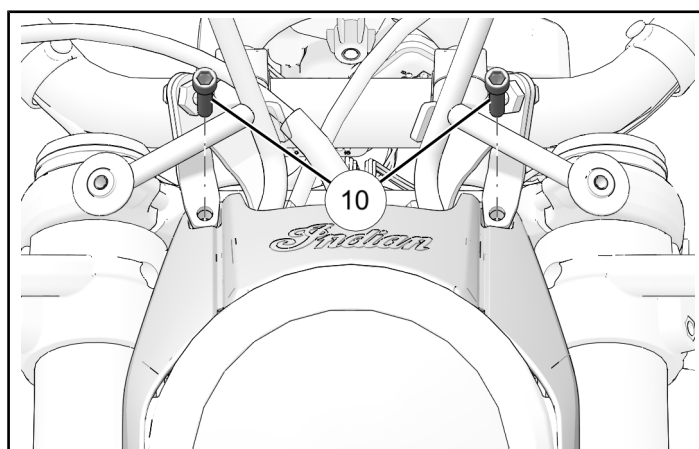

HEADLIGHT COWL INSTALLATION (IF APPLICABLE)

1. Install headlight cowl onto turn signal mounts and headlight cowl mounts with four screws ① and four washers ②.

TORQUE

Four screws ①: **18 in. lbs. (2 Nm)**

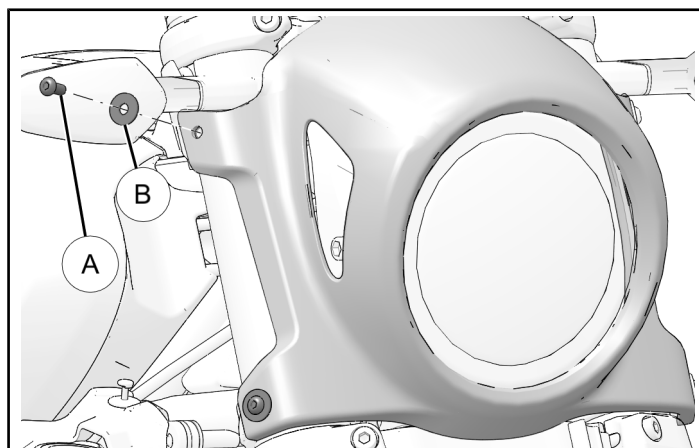

WINDSHIELD / WIND DEFLECTOR INSTALLATION

NOTE

- This section references parts found in *Windshield Mount Kit P/N 2884011*.
- *Low Wind Deflector Kit P/N 2884010* shown; others similar.

1. Align wind deflector ① with arms of windshield mount and loosely install with four screws ⑤ and four caps ③, included in *Windshield Mount Kit P/N 2884011*.

TORQUE

Four screws ⑤:
96 in-lbs (11 N·m)

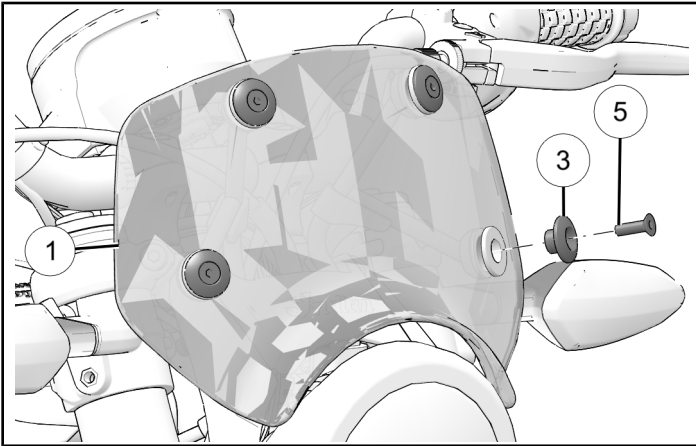

FEEDBACK FORM

A feedback form has been created for the installer to provide any comments, questions or concerns about the installation instructions. The form is viewable on mobile devices by scanning the QR code or by clicking [HERE](#) if viewing on a PC.

