

# Kolpin KXP Rhino Grip Pro - ATV

## Product Instructions | Part No: 21561

Kit contents:

Item	Qty	Part Description	Part Number
1	2	Rubber Strap	-
2	2	Rhino Grip	KOL21560
3	2	Side Pivot Block, Screw Guide	KOL21561
4	2	Side Pivot Block, Nut Holder	KOL21562
5	2	Thumb Screw	KOL21564
6	2	KXP Pivot Base	KOL21569
7	2	M8-1.25 Nylon Lock Nut	-
8	2	Flat Washer	-
9	2	Nylon Washer	-
10	2	Rubber Expander	-
11	2	Threaded Rod	-

### Install Preparation:

1. Remove the Rhino Grip assemblies from packaging. Verify that the grips are in good condition and that all the hardware is present.

Note: If any hardware is missing, do not return to the store.

Call us to help, Toll Free 1-877-956-5746.

These grips are designed to quickly mount to Polaris® ATV racks with Lock & Ride® hole features. *Note, installation may be easier if certain items are removed from vehicle first.*

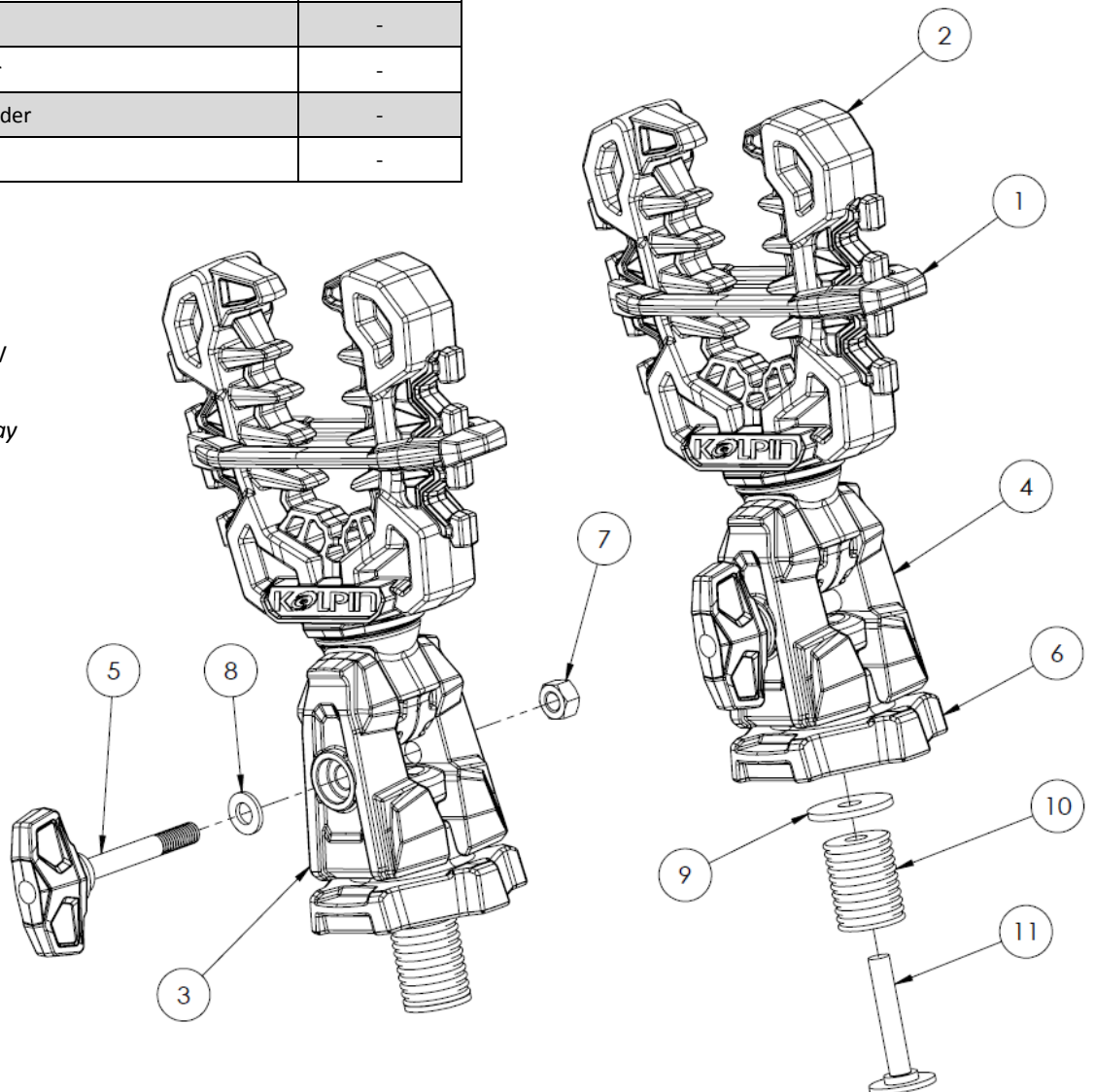

Kolpin Outdoors, Inc. | 9955 59th Ave N | Plymouth, MN 55442

(877) 956-5746 or (763) 478-5800 | [www.kolpin.com](http://www.kolpin.com) | [customerservice@kolpin.com](mailto:customerservice@kolpin.com)

## Mounting Instructions:

1. Place the rubber expander (item 10) on the threaded rod (item 11). Place the nylon washer (item 9) on top of the rubber expander and thread into the hole in the bottom of the pivot base (item 6). *Note, the rubber expander has a counter-bored relief that mates to the threaded rod. Please be sure to install correctly.*
2. Place the expander in the Lock & Ride hole and twist the base clockwise. As you twist the base, the threaded rod will compress the rubber expander and secure the grip to your ATV rack.
3. To remove, simply turn the base counter-clockwise and remove from the ATV rack.

**WARNING:** Do not over tighten hardware or damage can occur.

## Operating Instructions:

- **To rotate the grip on its base**

1. Slightly loosen the thumb screw, rotate grip to the orientation of your choice and retighten. *Note, the grip can rotate 360°.*

- **To tilt the grip on its base**

1. Loosen the thumb screw enough to pivot grip within the side blocks to the angle of your choice and retighten. *Note, the grip can tilt 0° to 180° at 45° increments.*

**WARNING:** Make sure the items carried in your Rhino Grips do not extend below or outside the vehicle frame as severe damage could result to your items if obstructions are encountered.

**CAUTION:** Always make sure your firearm is unloaded before placing it in your Rhino Grips.

SPARE KITS		Rubber Strap kit	KXP Plunger kit
Item	Description	P/N: 21590	P/N: 98500
1	Rubber Strap	2x	
9	Nylon Washer		1x
10	Rubber Expander		1x
11	Threaded Rod		1x

For additional assistance, please contact Kolpin customer service department at (877) 956-5746 or (763) 478-5800 or email [customerservice@kolpin.com](mailto:customerservice@kolpin.com)