

KOLPIN[®] OUTDOORS

DRIFTER

PLOW-IN-A-BOX

ASSEMBLY / OWNER'S MANUAL

Part No: 10-0550

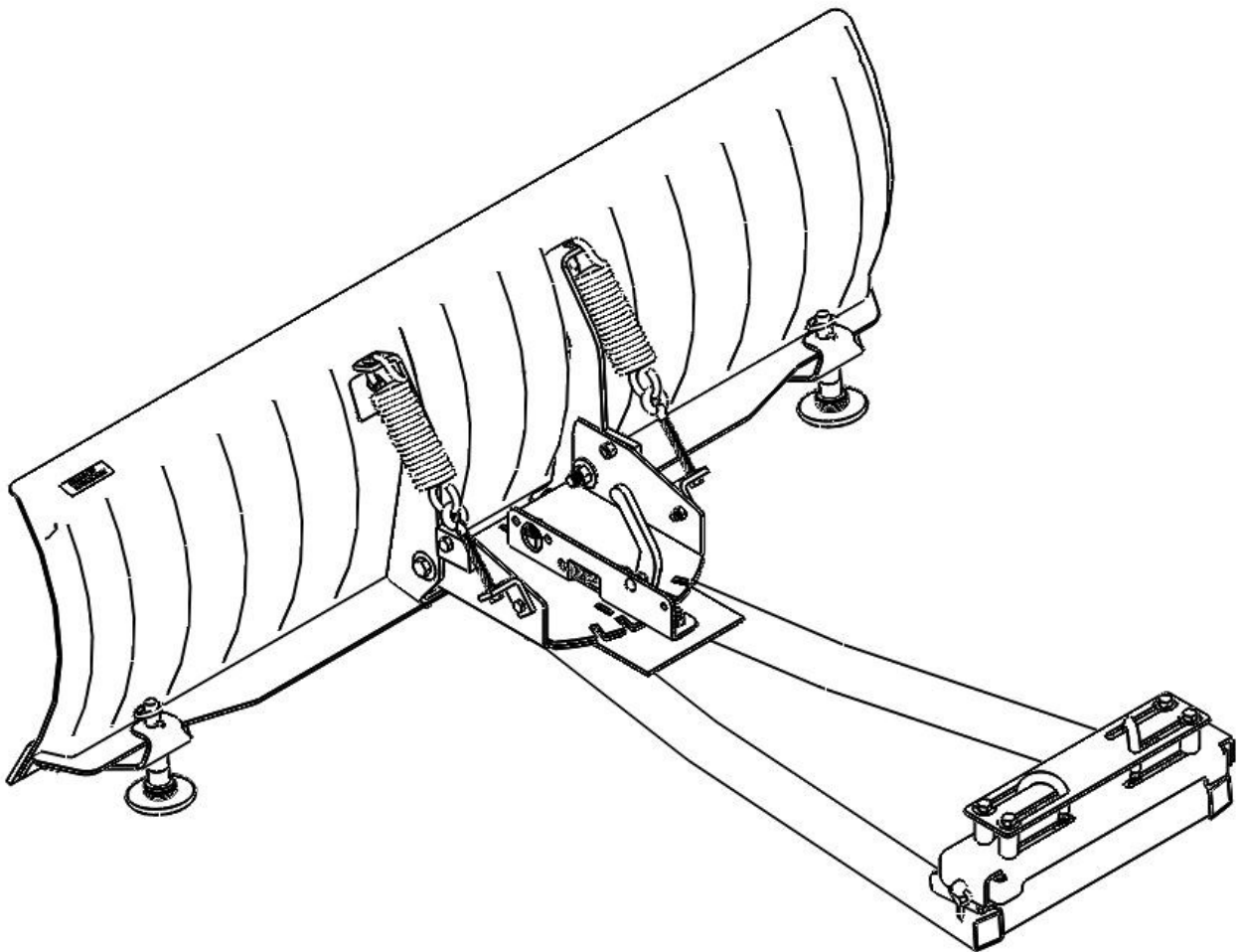

OPERATING INSTRUCTIONS

Congratulations! You've just purchased one of the industry's top plow systems. The DRIFTER™ Plow System works great for all types of plowing. With proper care and maintenance, your plow system will last for many years!

The DRIFTER™ Plow system is easily assembled and attaches to your ATV using a patented, unique Forward Mount™ system. It is designed to fit most models with 200cc or larger engines. The blade pivot design allows the operator to select multiple angled left-or-right positions, and also incorporates a spring-loaded 'trip' system that allows the blade to handle impacts with small obstructions. The patented 52" (132 cm) Poly Blade Assembly allows for quality snow moving capacity and snow roll-over characteristics. Additionally, this system will handle light to medium-duty summer landscape work.

NOTICE	
The DRIFTER Plow System includes these components:	
<ul style="list-style-type: none">• 52" (132 cm) Poly Blade and Blade Hinge Pivot Assembly• Forward Mount™ Push Tube• Universal Forward Mount™ System	
Plow operation requires an additional component for operation: <i>Winch Kit, Electric Lift or Manual Lift *</i>	
<small>*These components may be specific to your vehicle.</small>	

PUSH TUBE ENGAGEMENT: Place push tube under the ATV as shown and insert into the left and right channels of the assembled Forward Mount Weldment, Item #1. Fasten the push tube to the mount with supplied lock pins, Item #13.

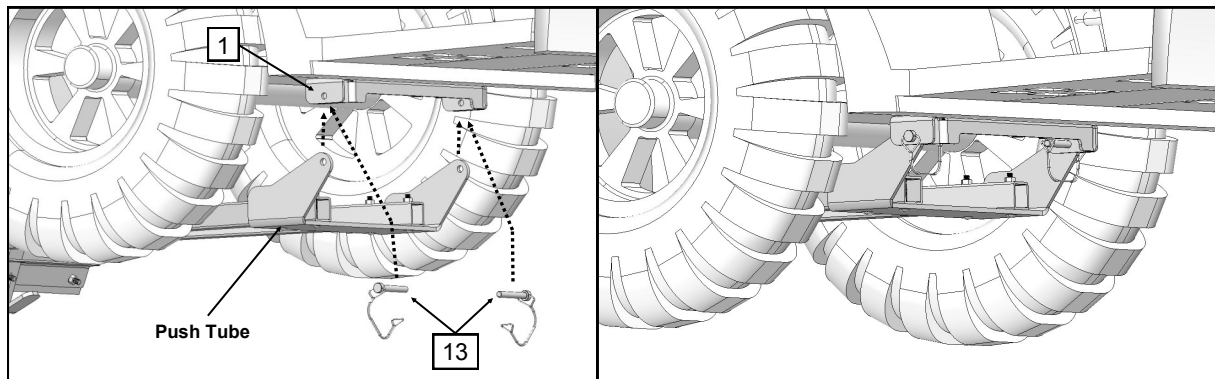

ATTACH LIFTING HOOK OR ELECTRIC LIFT: Attach the lifting hook from a winch or manual lift kit to the push tube as shown. If using an electric lift kit, install the electric lift at the hole locations shown.

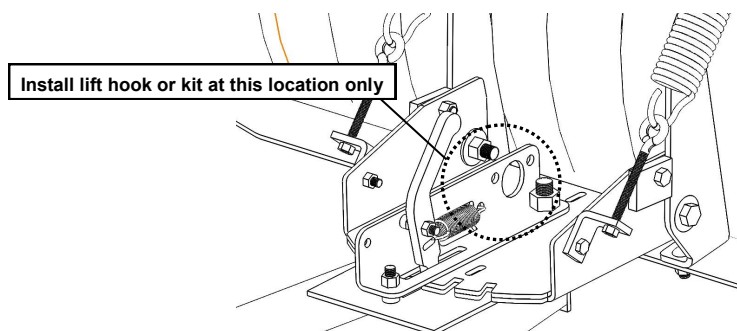

Please read and understand all assembly instructions, notices and warnings before assembling and operating your plow system.

Follow these guidelines to ensure satisfactory operation:

- Read this manual and your ATV operators manual before use.
- Periodically check for wear and tightness of all fasteners. Replace or re-torque fasteners as necessary.
- Before first use, set plow in the furthest right or left angled position to check for clearance between the plow and front tires.
- Operate with extreme caution on slopes and rough terrain. Be familiar with the area before you plow.
- Be aware of immovable objects that could be hidden in the area you are plowing.
- To avoid damage when pushing snow into a pile, reverse direction before raising the plow blade.
- Do not ram the plow blade into piles of snow.
- For best results, set the suspension preload of your ATV to the stiffest setting.
- To reduce steering effort and increase mobility, set the air pressure of your tires to the maximum pressure specification.
- The plow blade assembly is designed to “trip” when it strikes an object or digs in too far. When pressure is released, the plow springs back into position. *Spring tension can be increased by tightening the locknuts on the bottom of the eyebolts. For less spring tension, loosen the locknuts.*
- The plow skids are adjustable. General skid setting is even with the plow wear bar bottom edge, higher settings reduce the chance of rocks and gravel from being collected. *See Page 9 for more information.*
- To increase traction during plow operation, operators can try: Securing weight to the ATV for additional tire downforce, reducing tire air pressure, or installing tire chains.

SAFETY INFORMATION

Our plow systems were designed with your safety in mind. Please read and understand all Cautions, Notices and Warnings in this manual before you begin. In order to protect you and your ATV, certain parts of the plow system and/or hardware are designed to fail when the equipment is over-stressed.

 WARNING
To avoid personal injury or damage to your vehicle:
Do not exceed 5 mph (8 kph) with the blade installed
Be aware that vehicle ground clearance is reduced with plow system installed
Keep yourself, other people and pets away from the blade and moving parts during operation
Before adjusting blade angle or disconnecting the plow system, stop the ATV engine and set the parking brake
Remove your plow system before trail riding

 WARNING
To avoid personal injury or damage to your vehicle:
Do not install forward mount system over plastic guard components, which can compress over time and loosen the installation, resulting in poor product performance and/or damage to the ATV.
Do not allow forward mount system to interfere with ATV operational items such as brake lines, coolant hoses, control cables, steering or any other function.

Model Number 10-0550
 Hardware Pack # 12-0400
 Parts List 1 of 3

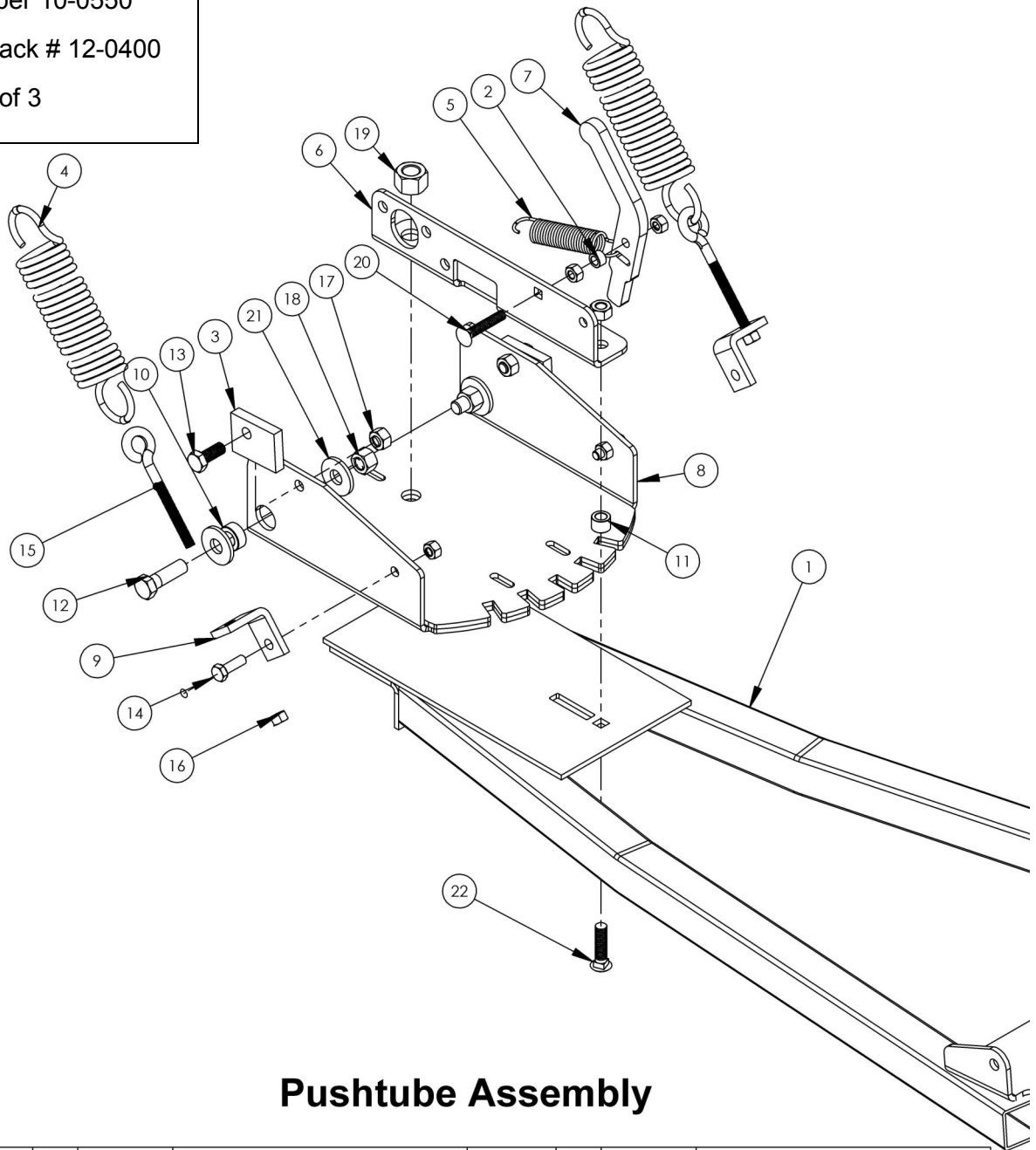

Pushtube Assembly

ITEM NO.	QTY.	PART NO.	DESCRIPTION	ITEM NO.	QTY.	PART NO.	DESCRIPTION
1	1	CYC6454	Pushtube QAB SQ Weldment	12	2	PUR3203	Metric Bolt 12 x 40mm
2	1	PUR1360	Sleeve Bushing	13	2	PUR3023	Metric Bolt 10 x 25mm
3	2	CYC0813	Blade Stop	14	2	PUR3012	Metric Bolt 8 x 25mm
4	2	PUR1409	Blade Spring	15	2	PUR1216	8mm x 110mm Eye Bolt
5	1	PUR1437	Spring	16	6	PUR3068	Nylon Lock Nut M8
6	1	CYC2070	Lever Bracket	17	3	PUR3069	Nylon Lock Nut M10
7	1	CYC2069	Lever	18	2	PUR3070	Nylon Lock Nut M12
8	1	CYC2065	Blade Hinge Weldment	19	1	PUR3072	Nylon Lock Nut M16
9	2	CYC0812	Blade Spring Bracket	20	1	PUR3202	Carriage Bolt M8 x 45mm
10	2	PUR1411	Bushing	21	4	PUR3089	Flat Washer 12mm
11	1	PUR2424	Bushing .385" x .625" x .450"	22	1	PUR3063	Carriage Bolt M10 x 40mm

PARTS ORDERING INFORMATION:
 Replacement fasteners are common-type and can be purchased locally. Use minimum Metric 8.8 or SAE Grade 5 fasteners.

Model Number 10-0550

Hardware Pack # CYC1010

Parts List 2 of 3

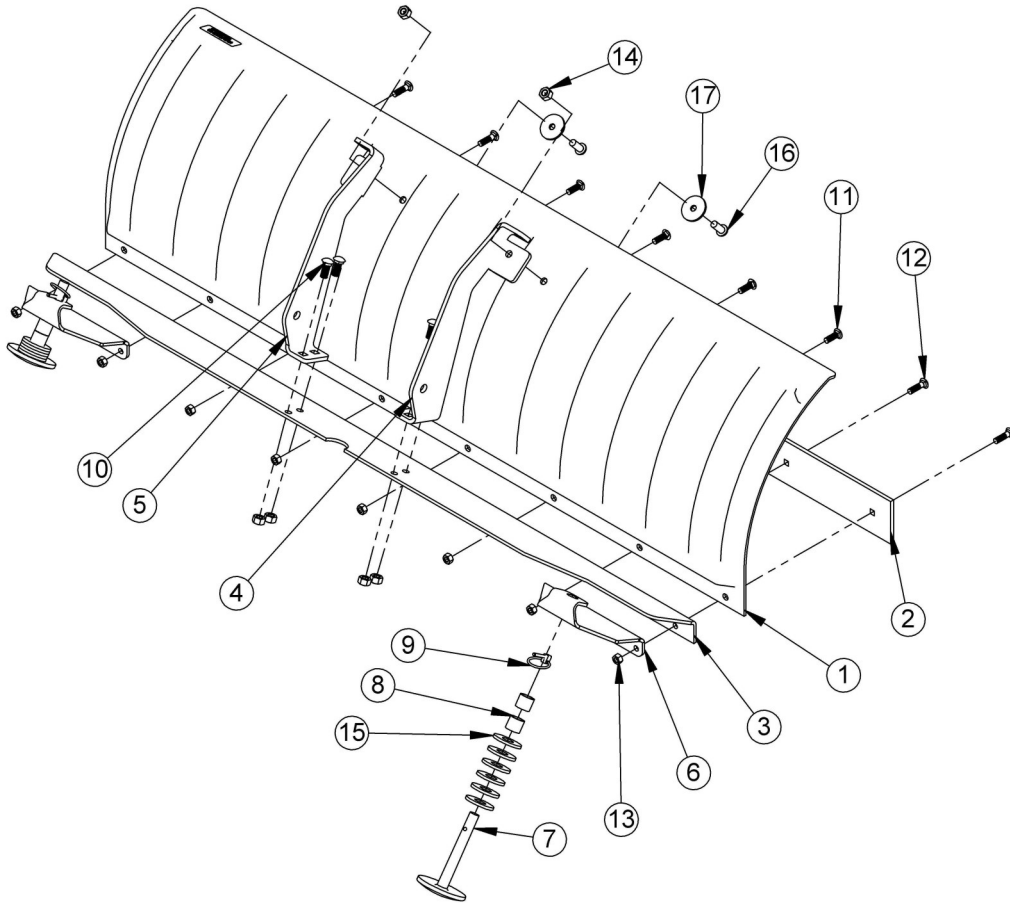

Blade Assembly

ITEM NO.	QTY.	PART NO.	DESCRIPTION
1	1	OSP0084	Blade 52 Plastic Black
2	1	12-0140	Wear Bar 52" Double Sided
3	1	CYC1007	Angle
4	1	CYC1008	Rib RH
5	1	CYC1009	Rib LH
6	2	CYC1011	Skid Bracket
7	2	PUR1467	Skid Cast Heavy Duty
8	4	PUR0400	Heavy Duty Skid Spacer
9	2	PUR1359	Quick Pin .1875 x 1.5
10	4	PUR3060	Carriage Bolt M10 x 25mm
11	4	PUR3053	Carriage Bolt 8 x 25mm
12	4	PUR3054	Carriage Bolt 8 x 30mm
13	8	PUR3068	Nylon Lock Nut M8
14	6	PUR3069	Nylon Lock Nut M10
15	12	PUR3091	Flat Washer 16mm
16	2	PUR3205	Button Head Cap Screw 10mm x 25mm - Black
17	2	PUR3095	Wide Flat Washer 10mm Black

PARTS ORDERING INFORMATION:

Replacement fasteners are common-type and can be purchased locally. Use minimum Metric 8.8 or SAE Grade 5 fasteners.

Model Number 10-0550
 Hardware Pack # HK-124
 Parts List 3 of 3

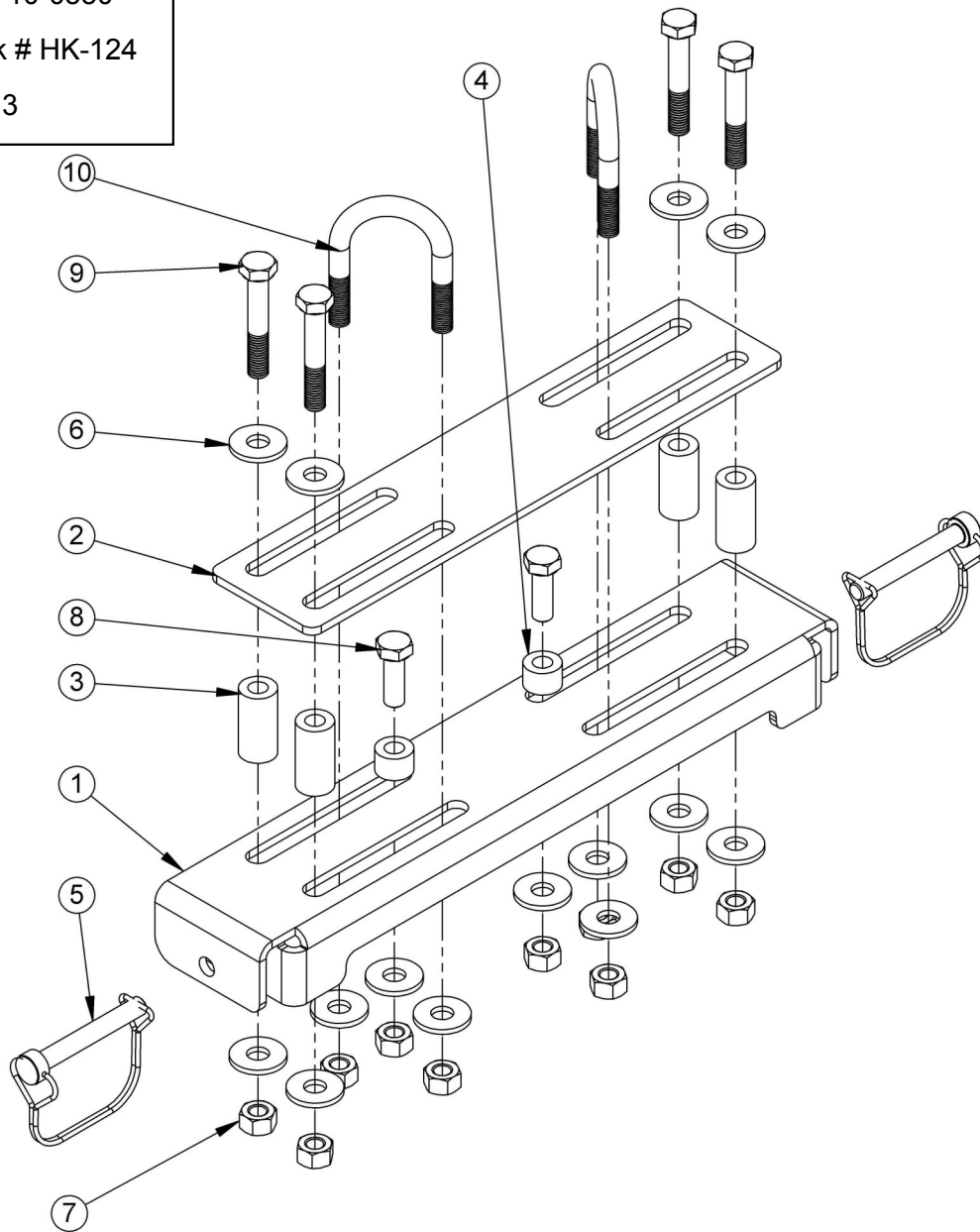

Mount Kit CYC6043

ITEM NO.	QTY.	PART NO.	DESCRIPTION
1	1	CYC6041	Foward Mount Weldment
2	1	CYC6042	Back Plate
3	4	CYC2312	Spacer
4	2	CYC6118	Spacer
5	2	PUR1286	3/8" x 2 1/2" Lock Pin
6	14	PUR3088	Flat Washer 10mm
7	10	PUR3069	Nylon Lock Nut M10
8	2	PUR3024	Metric Bolt 10 x 30mm
9	4	PUR3030	Metric Bolt 10 x 60mm
10	2	PUR3234	U-Bolt 10mm x 40mm x 65mm

PARTS ORDERING INFORMATION:
 Replacement fasteners are common-type and can be purchased locally. Use minimum metric 8.8 or SAE Grade 5 fasteners.

BEFORE YOU BEGIN:

- Please read and understand all instructions.
- Verify all parts and tools are accounted for.
- To ensure a satisfactory installation, follow all steps correctly and in the sequence described.
- All directions referring to right and left are when the rider is sitting on the machine

TOOLS REQUIRED:

- Basic Hand Wrench and Socket Set
- Torque Wrench
- Pliers & Cutting Tool

INSTALLATION NOTES:

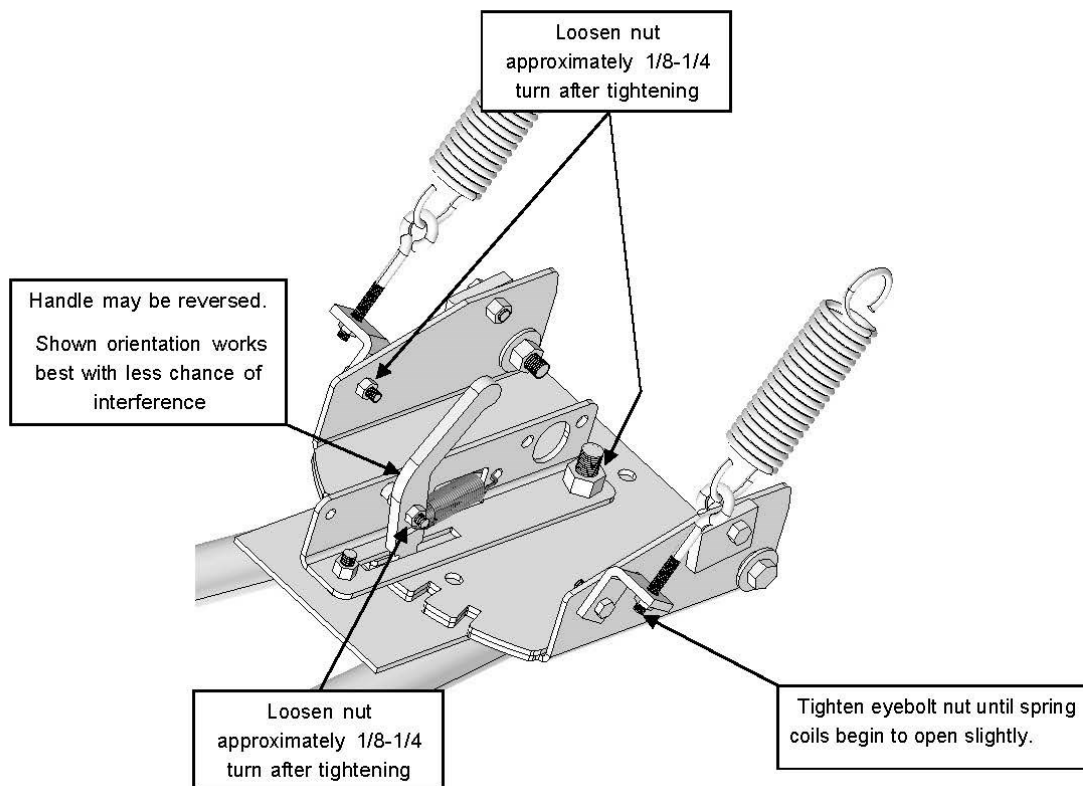

ASSEMBLY INSTRUCTIONS:

1. Assemble the lever bracket as shown in Illustration 1.

NOTICE
1A - Torque inside nut, Item #16 to 12ft. lbs. (13.5 Nm)

NOTICE
1B - Tighten outside nut, Item #16, then back out 1/8 -1/4 turn to allow lever, Item #7 to pivot freely

NOTICE
1B - Lever can be installed in either direction that offers the most clearance for operation.

NOTICE
1C - Install Lever Spring, Item #5

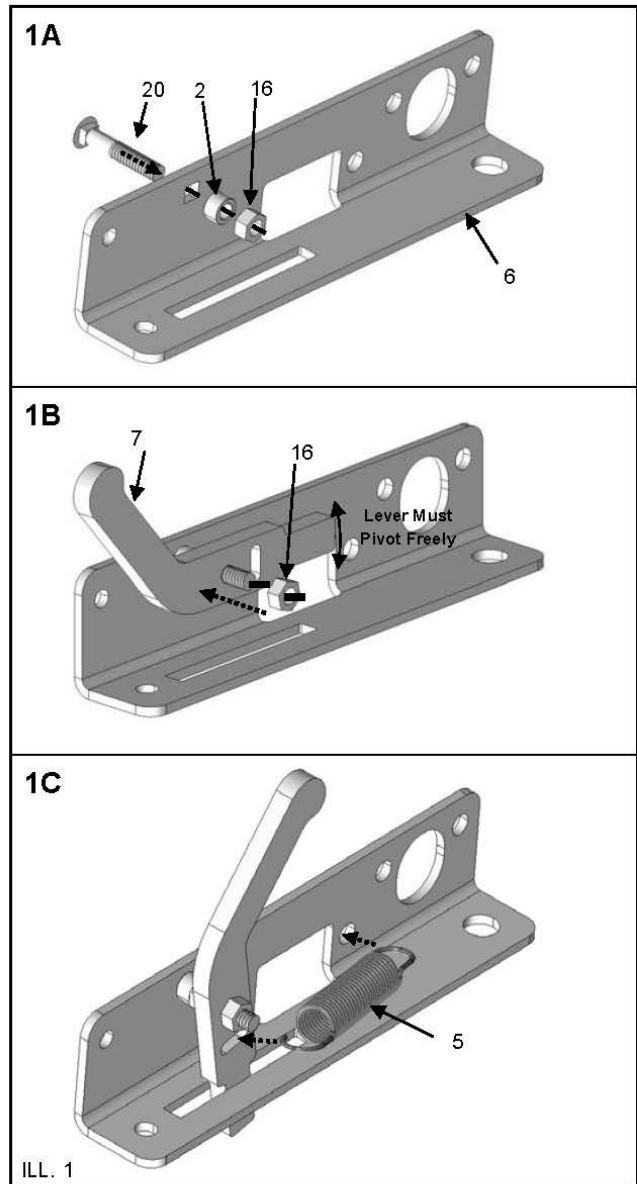

2. Place hinge pivot bracket, Item #8, onto the push tube, Item #1, as shown in Illustration 2.

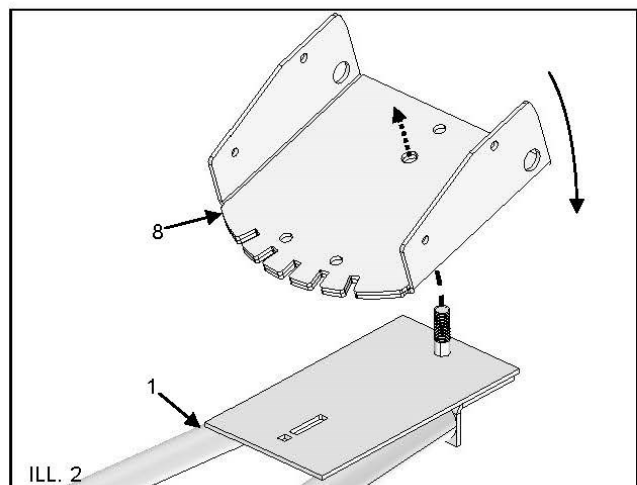

- Place the assembled lever bracket, onto the blade hinge as shown in Illustration 3.
- Install bushing, item #11, between the lever bracket and push tube and install fasteners, Item #22 and #17. Torque to specification.

 = T
FASTENER TORQUE: 17ft. lbs. (23 Nm)

- Install Locknut, Item #19. See NOTICE.

NOTICE
Item #19 - Tighten lock nut, then back out 1/8-1/4 turn to allow blade hinge, Item #8 to pivot freely

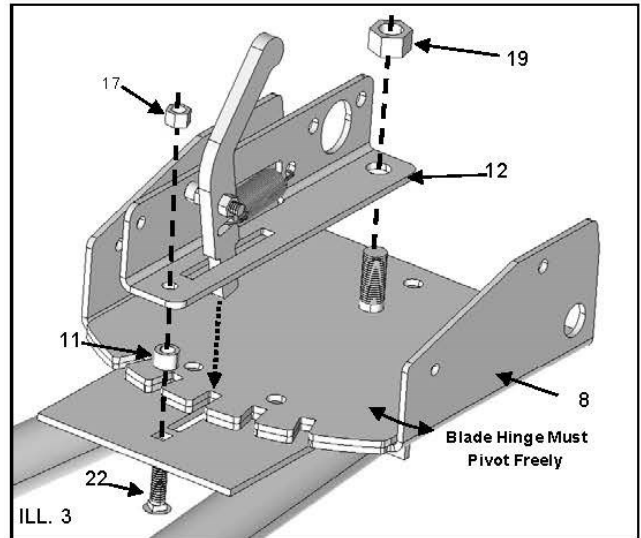

PUSH TUBE INSTALLATION ONTO BLADE ASSEMBLY:

- Place bushings, Item #10 into the blade hinge as shown. Attach the assembled push tube to a previously assembled blade. Place washers, Item #21 over the holes and fasten the push tube to the blade using bolts, Item #12 and locknuts, Item #18. See Illustration 4. Torque to specification.

 = T
FASTENER TORQUE: 50 ft. lbs. (67.7 Nm)

- Install the blade stops, Item #3. Fasten with bolts, Item #13 and nuts, Item #17. See Illustration 5. *Do not Torque fasteners at this time.*

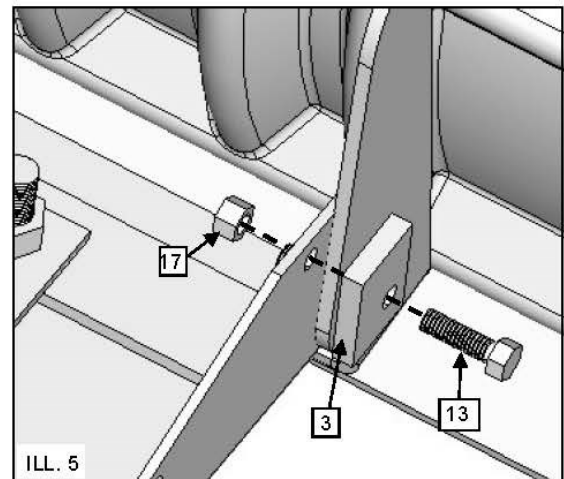
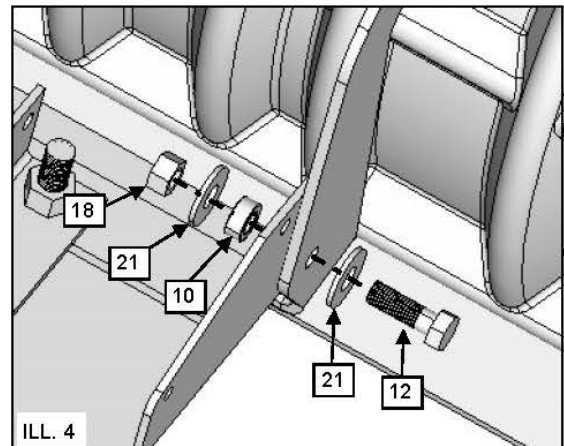

- Attach the blade spring brackets, Item #9, to the pivot bracket using bolts, Item #14 and nuts, Item #16. *Hand-tighten sufficiently, then back-off 1/8-1/4 turn to allow bracket to pivot freely.* See Illustration 6.

NOTICE
Item #9 - Bracket must pivot freely

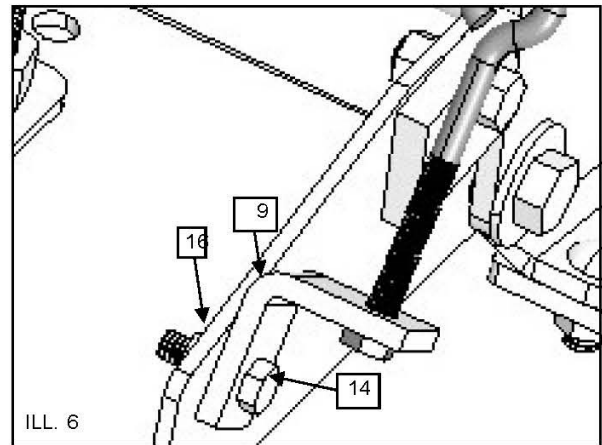

- Assemble blade springs, Item #4 and eyebolts, Item #15 between the blade assembly and spring brackets as shown in Illustration 7. Thread nuts, Item #16, onto the eyebolts until 2-3 threads show through the locking feature. See Illustration 7.

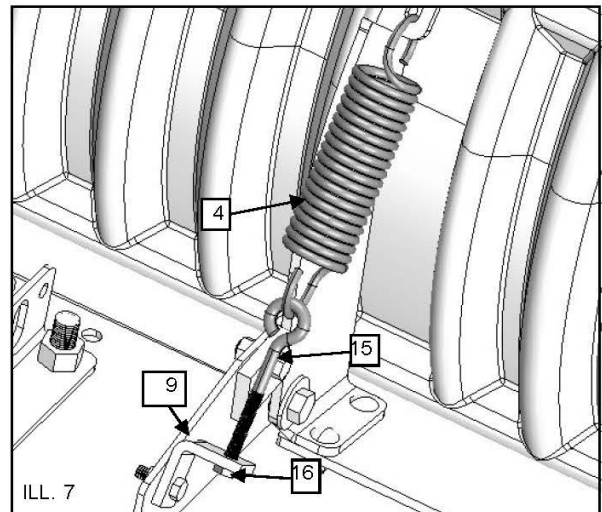

- Once the plow system is mounted to the ATV, adjust the blade stops and blade spring tension as desired to achieve best performance. See Illustration 8.

NOTICE
BLADE TILT / STOP ADJUSTMENT: Perform with plow system mounted and in the down position.
Blade position should be vertical for best performance

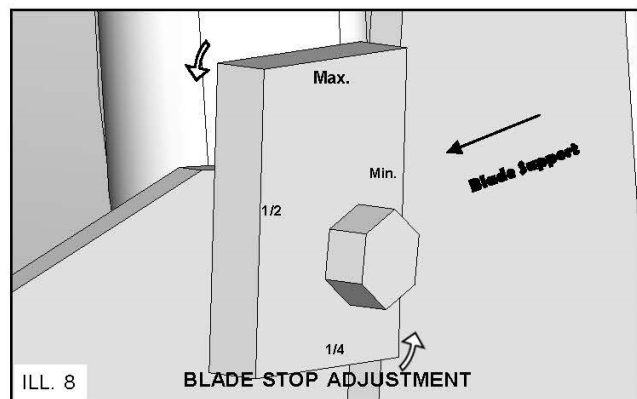

- Tighten the blade pivot fasteners to specification once the desired stop position is determined.

 = T
FASTENER TORQUE: 17ft. lbs. (23 Nm)

ASSEMBLY INSTRUCTIONS:

1. Assemble angle #3, to ribs #4 and #5 using fasteners #14, and #10 as shown in Illustration 1A. Torque to specification.

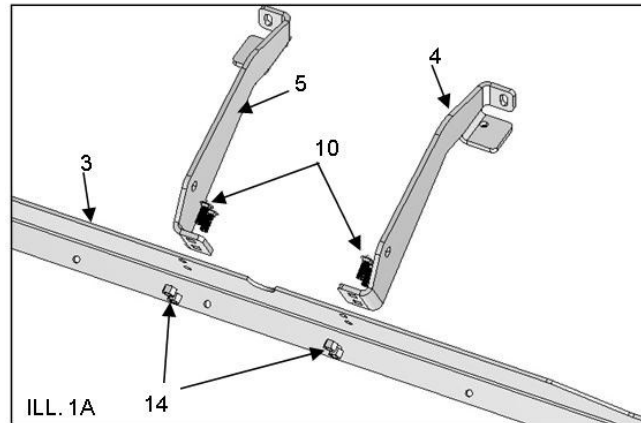
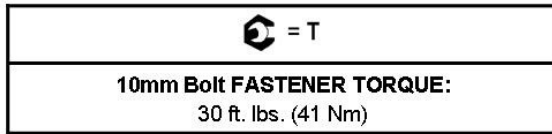

2. Attach blade, item #1, to ribs using washers #17 and fasteners #16 and #14 as shown in Illustration 1B. *Do not torque fasteners at this time.*

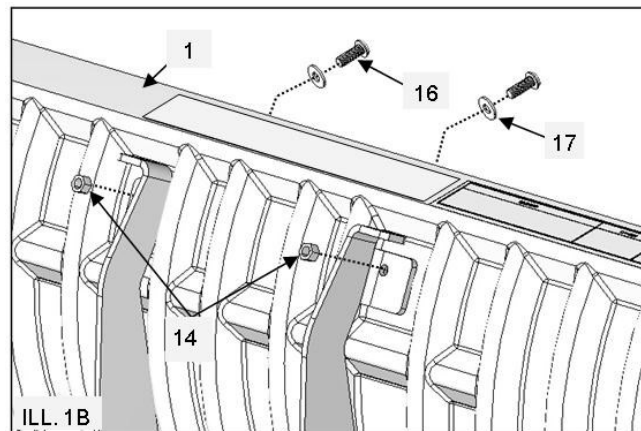
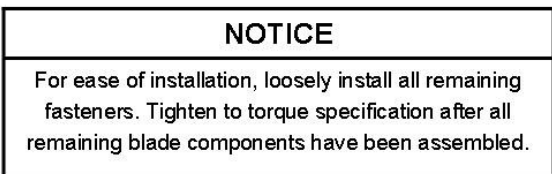

3. Attach the wear bar, item #2, to the blade and support using fasteners #11 and #13. **Install in middle holes only.** See Illustration 1C. *Do not torque the fasteners at this time.*

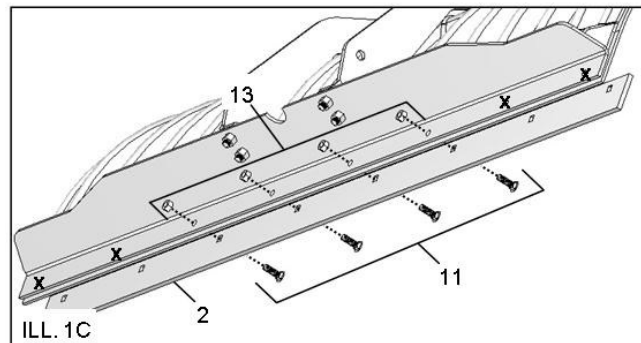

- Attach skid brackets, Item #6 (x2) to each end of angle #3 using fasteners, Items #12 and #13 as shown in Illustration 1D.

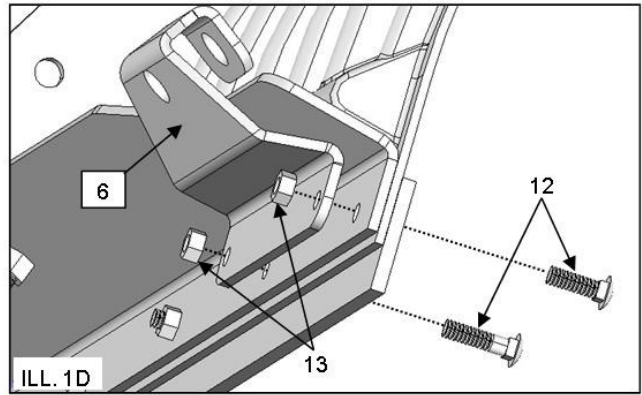

- Torque all wear bar fasteners, Item #13 to specification.

 = T
8mm Bolt - FASTENER TORQUE: 17ft. lbs. (23 Nm)

- Torque the *upper support fasteners*, Items #16 and #14 to specification.

 = T
10mm Bolt - FASTENER TORQUE: 30 ft. lbs. (41 Nm)

- Assemble and install skid components, Items #7, #8 and #15 to each skid bracket as shown in Illustration 1E. Fasten with quick pins, Item #9.

NOTE: Initial setting of skid height depends on the terrain. Set the skids above the wear bar cutting edge for level surfaces such as concrete or asphalt. For irregular surfaces, lower the skids to raise the wear bar cutting edge.

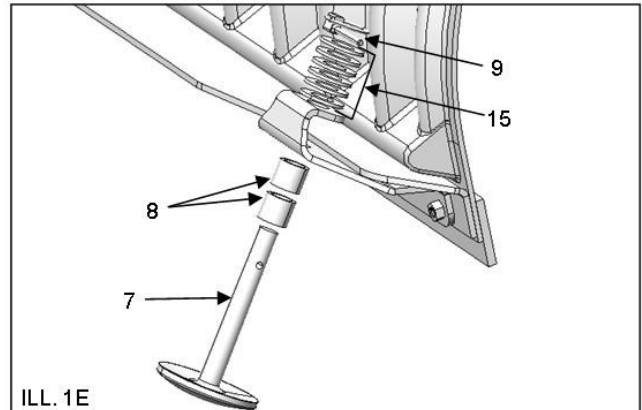

BEFORE YOU BEGIN:

- Please read and understand all instructions.
- Verify all parts and tools are accounted for.
- To ensure a satisfactory installation, follow all steps correctly and in the sequence described.
- All directions referring to right and left are when the rider is sitting on the machine

TOOLS REQUIRED:

- Basic Hand Wrench and Socket Set
- Torque Wrench
- Plastic Cutting Tool

INSTALLATION NOTES:

NOTICE

Depending on application, some trimming of plastic guards or panels may be required to install the Forward Mount.

NOTICE

Refer to Installation Option A, B, C or D for Forward Mount installation, depending on your application.

NOTICE

Position fasteners of the Forward Mount against the

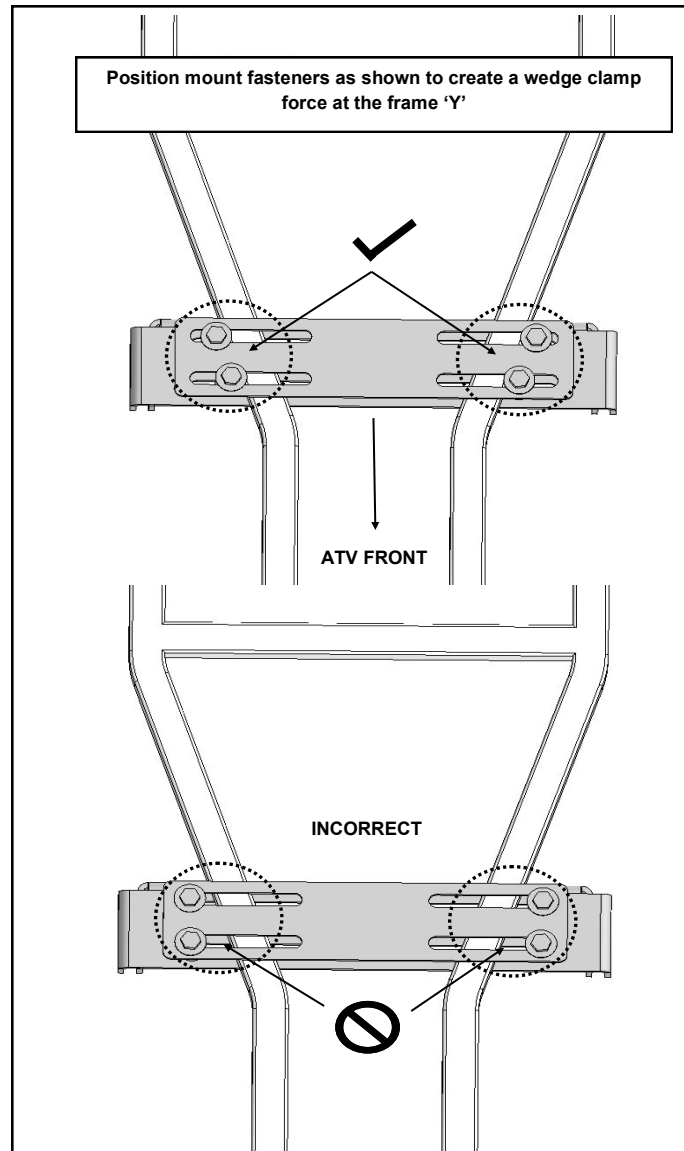

OPTION A - GENERIC MOUNT INSTALLATION FOR ROUND TUBE FRAME ATVs

1. Position the Back Plate, Item #2, on top of the Forward Mount Weldment, Item #1, as shown in Illustration 1.

NOTICE
Depending on application, some trimming of plastic guards or panels may be required.

2. Position the forward mount weldment and back plate under the frame tubes at the "Y" location as shown in Illustration 1.
3. Fasten the mount and back plate using U-bolts, washers and locknuts, Items #4, #5 and #6. *Do not torque fasteners at this time.*
4. Position the mount and fasteners at a point on the frame that allows the push tube to be attached, but will not interfere with operation of the ATV.
5. Once the mount position has been determined, position U-bolts to the frame tube walls as close as possible and torque to specification.

 = T
FASTENER TORQUE: 30 ft. lbs. (41 Nm)

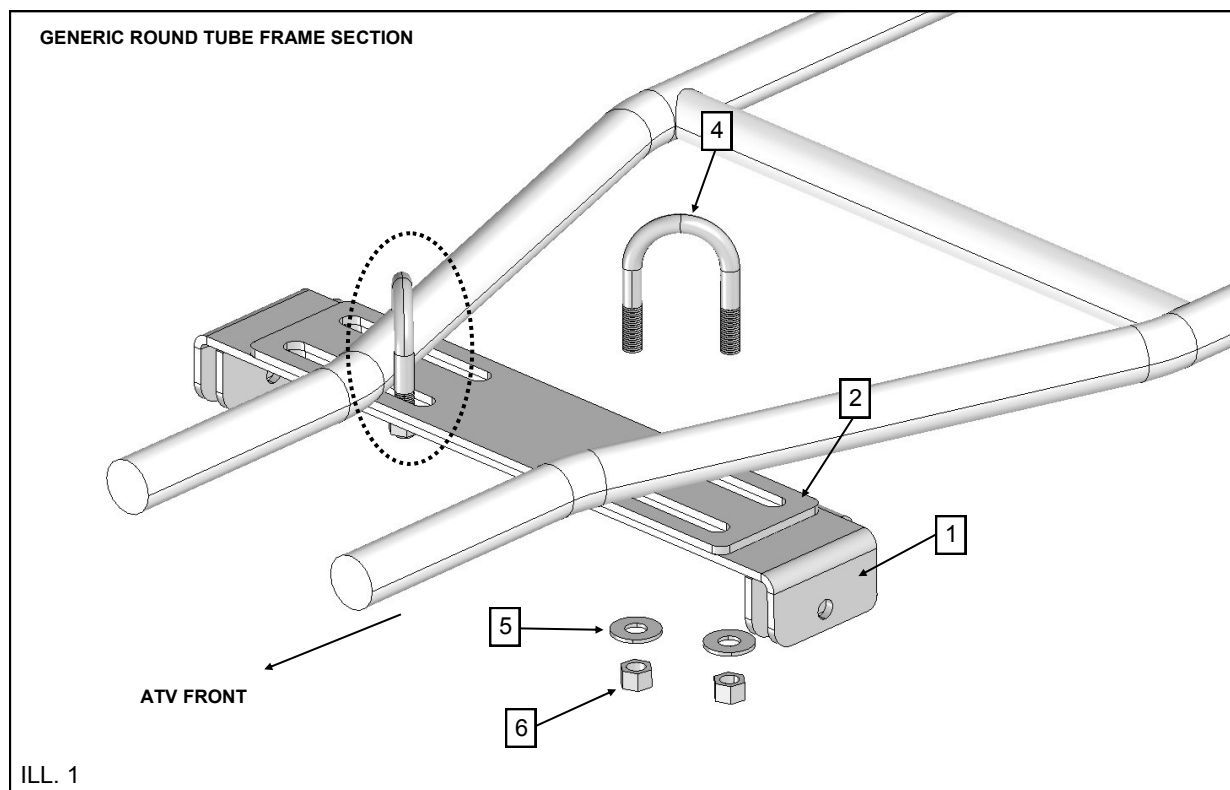

OPTION B - GENERIC MOUNT INSTALLATION FOR SQUARE TUBE FRAME ATVs

NOTICE

Depending on application, some trimming of plastic guards or panels may be required.

1. Position the Forward Mount Weldment, Item #1, under the frame tubes at the “Y” location as shown in illustration 2..
2. Position the Back Plate, Item #2, on top of the frame tubes at the “Y” location as shown in Illustration 2.
3. Place spacers, Item #7, between the mount and back plate. Loosely fasten the mount and back plate using bolts, washers and locknuts, Items #9, #6 and #7. *Do not torque fasteners at this time.*
4. Position the mount and fasteners at a point on the frame that allows the push tube to be attached, but will not interfere with operation of the ATV.
5. Once the mount position has been determined, push the spacers and fasteners to the frame tube walls as close as possible. Torque to specification. REFER TO INSTALLATION NOTES - PAGE 13.



FASTENER TORQUE:
30 ft. lbs. (41 Nm)

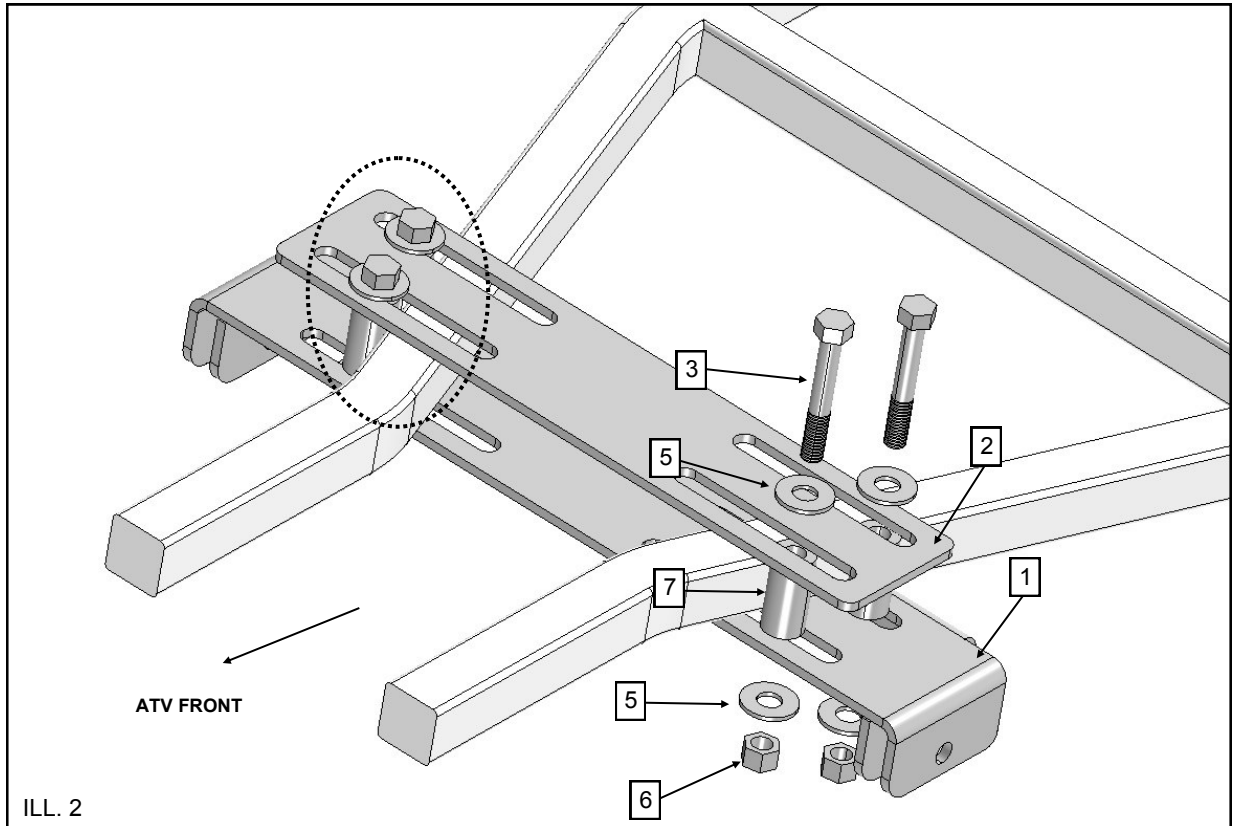

OPTION C - MOUNT INSTALLATION: POLARIS 400/500/800 H.O. ATVs

1. Position the Forward Mount Weldment, Item #1, under the frame tubes at the "Y" location as shown in Illustration 1.
2. **IMPORTANT:** To keep the mount level and clear the built-in rock guard extrusion on Sportsman HO ATVs, add spacers, Item #3 to the forward channel of the mount. Loosely fasten the spacers between the mount and rock guard with bolts, washers and locknuts, Items #9, #6 and #7. Do not torque fasteners at this time. See Illustration 3.
3. Position the Back Plate, Item #2, on top of the frame tubes at the "Y" location as shown in Illustration 3.
4. Place spacers, Item #3, between the mount and back plate. Loosely fasten the mount and back plate using bolts, washers and locknuts, Items #9, #6 and #7. Do not torque fasteners at this time.
5. Once the mount has been positioned, orientate fasteners, to the frame tube walls as close as possible and torque to specification. REFER TO INSTALLATION NOTES - PAGE 13.

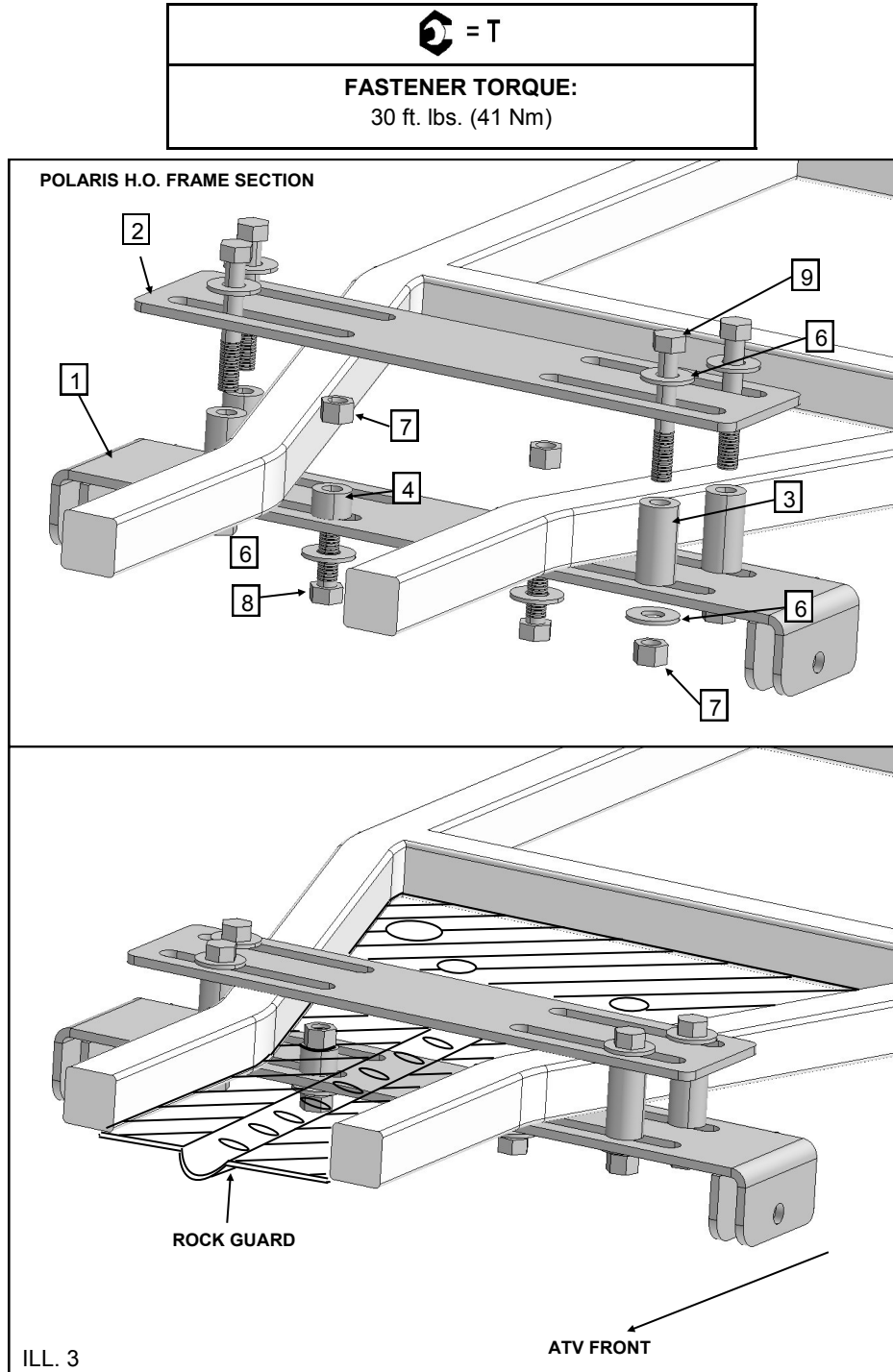

STEP 5 - ATTACH PLOW SYSTEM TO THE FORWARD MOUNT:

1. Refer to Operating Instructions, Page 2 & 3.
2. Once the plow system is attached to your ATV and the plow blade is on the ground, adjust the blade stops and blade spring tension as desired to achieve best performance. Refer to page 10 illustration 7 & 8.
3. Once the desired blade position is obtained, torque the blade stop fasteners to specification.

 = T
FASTENER TORQUE: 17ft. lbs. (23 Nm)



One Year Limited Warranty

For the period of one (1) year from the purchase date, Kolpin will replace for the original purchaser, free of charge, any part or parts found upon examination by Kolpin to be defective in material, workmanship, or both.

All transportation costs incurred submitting product to Kolpin for warranty consideration must be borne by the purchaser. If Kolpin determines that the product must be returned to the factory for credit, please call 1-877-956-5746 for a Return Merchandise Authorization (RMA) number and shipping instructions.

This warranty does not apply to parts that have been damaged by accident, alteration, abuse, improper maintenance, normal wear, or other causes beyond the manufacturer's control. In order to protect you and your ATV, certain parts of the plow system and/or hardware are designed to fail when the equipment is over-stressed. Parts that are lost due to loosening and improper maintenance are not covered under warranty. This warranty does not cover removal or reinstallation labor fees of the plow system and related components.

Peripheral products such as engines, electric motors, and actuators may carry an original manufacturer's warranty. Most hardware is general in nature and is easily obtained locally. Be sure to replace with minimum metric class 8.8 specification.

Kolpin Outdoors, Inc.

Telephone: (763)-478-5800

Toll Free: (877)-956-5746

Fax Number: (800)-245-7569

www.kolpin.com

Email: customerservice@kolpin.com