

Kawasaki Mule Pro-FXT Steel Roof



Product Instructions | Part No: 29300

Application: Kawasaki Mule Pro-FXT, verify accessory fitment at Kolpin.com.

This Kit includes:

Before You Begin: Read these instructions and check to be sure all parts and tools are accounted for. Please retain these installation instructions for future reference and parts ordering information.

Note: If any hardware is missing, do not return to the store. Call us to help, Toll Free 1-877-956-5746.

Note: Two people are required to install this Roof Kit.

Items marked (*) are included in Hardware Kit PN 29301.

Items marked (**) are included in Hardware Kit PN 29302.

Items marked (***) are included in Hardware Kit PN 28091.

Item	Qty	Part Description
1	1	Mule Pro-FXT Front Roof Panel
2	1	Mule Pro-FXT Rear Roof Panel
3*	9	Button Screw, Zinc Plated, M6-1.0 x 20mm LG
4*	21	Flange Locknut, Zinc Plated, M6-1.0
5*/***	11	Flat Washer, Zinc Plated, M6
6*/***	2	Lock Washer, Zinc Plated, M6
7*	2	Warning Decal, Pinch Point
8*	1	Thick Overlap Foal Seal
9*	4	Long Foam Strip
10*	2	Clamp, Painted, 1.875" Diameter
11*	1	Clamp, Painted, 1.625" Diameter
12**	3	Hinge, Painted, M6-1.0 threaded studs
13*/***	2	Thumbscrew Knob, M6-1.0 thread
14*	2	Nut Clamp, Painted, 1.875" Diameter
15	1	Instruction Guide (not shown)

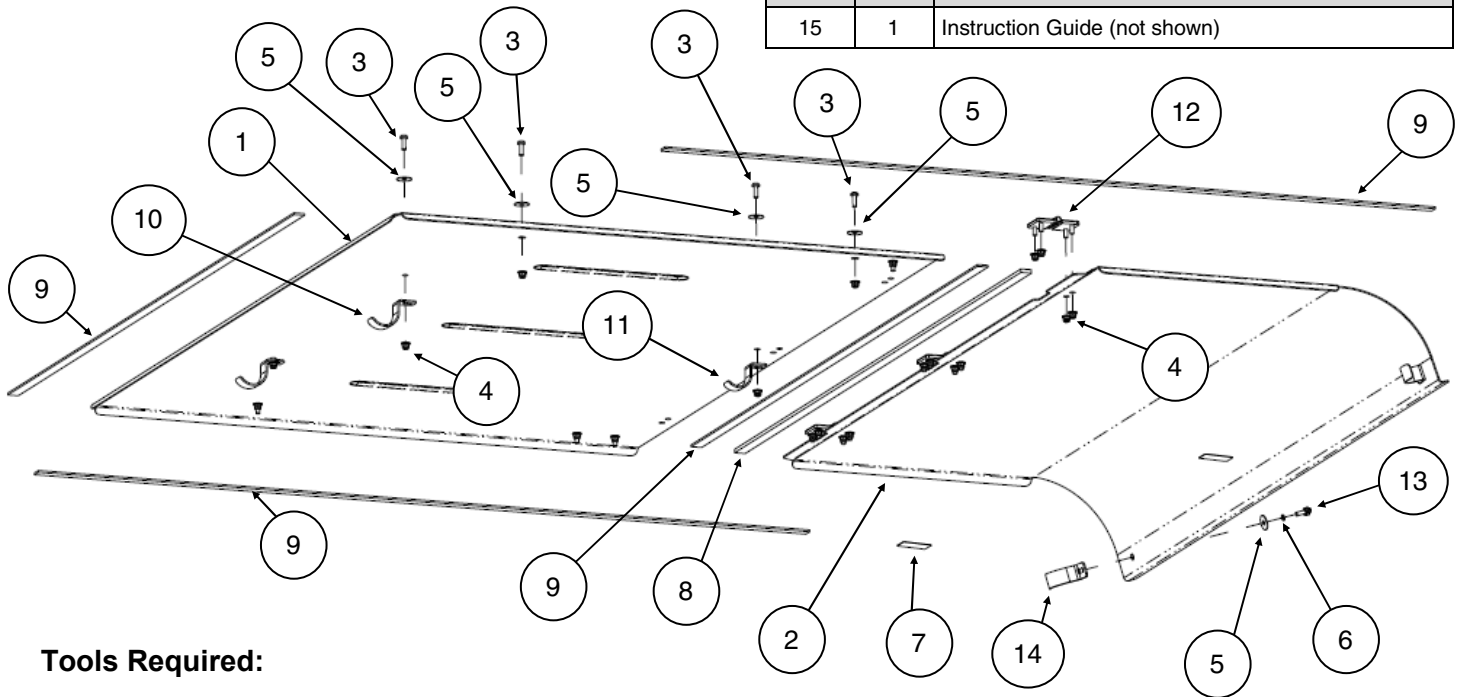

Tools Required:

- Socket Set, Metric
- Torx Bit Set
- Utility Knife/Cutting Tool
- Wrench Set, Metric
- Torque Wrench

Kolpin Outdoors, Inc. | 9955 59th Ave N | Plymouth, MN 55442

(877) 956-5746 or (763) 478-5800 | www.kolpin.com | customerservice@kolpin.com

Assembly Time: Approximately 30 minutes

Important: Your Kolpin Steel Roof Kit is exclusively designed for your vehicle. Please read the installation instructions thoroughly before beginning. Installation is easier if the vehicle is clean and free of debris. For your safety, and to ensure a satisfactory installation, perform all installation steps correctly in the sequence shown. For better cab assembly procedure, install kits in the following order: front window, and roof.

Installation Instructions:

1. Shift vehicle transmission into "NUETRAL" and set parking brake. Turn key to "OFF" position and remove from vehicle.
2. Being careful to not scratch painted surfaces, place the front steel roof panel (item #1) onto rear steel roof panel (item #2). Connect panels together by using the hinges (item #12) and inserting threaded studs through holes on the top surface. Secure hinges using M6 locknuts (item #4) on underside roof surface. (See illustrations 1-1 and 1-2). **Note, clean the rear roof overlap area and apply thick foam seal (item #8) onto rear roof as shown.**

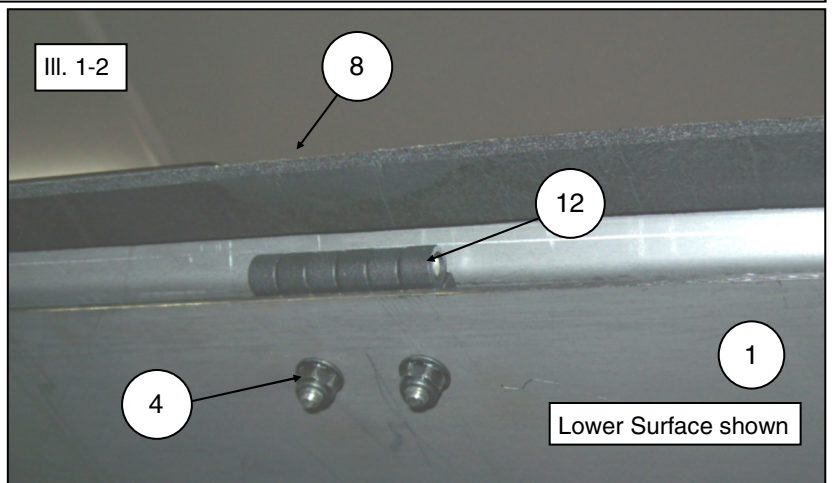
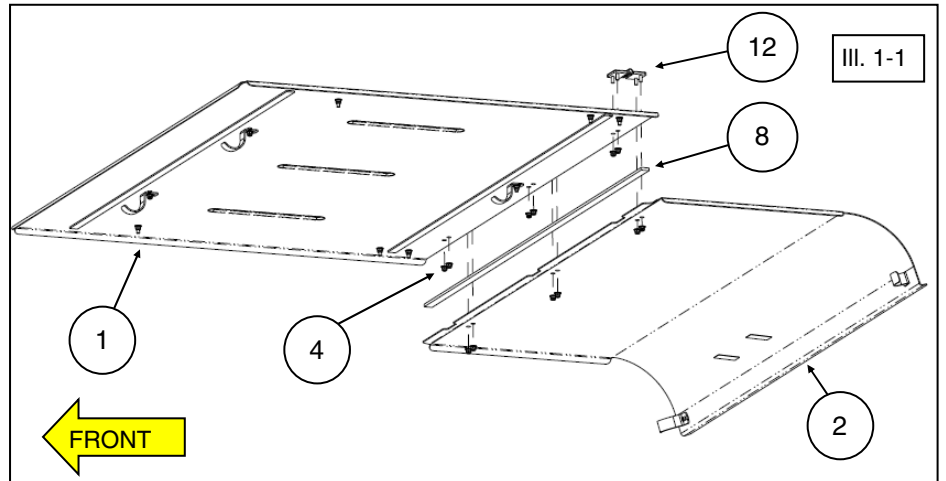

3. Clean lower surface of front roof (item #1) and rear roof (item #2) as required, then apply long foam strips (item #9) as shown. Trim seals as required. (See illustration 1-3). **Note, foam strip alignment may be easier if roof assembly is placed on cab frame, then mark with pencil or tape where the roll cage tubes make contact with metal roof.**
4. Place roof assembly on the top of the vehicle cab frame.

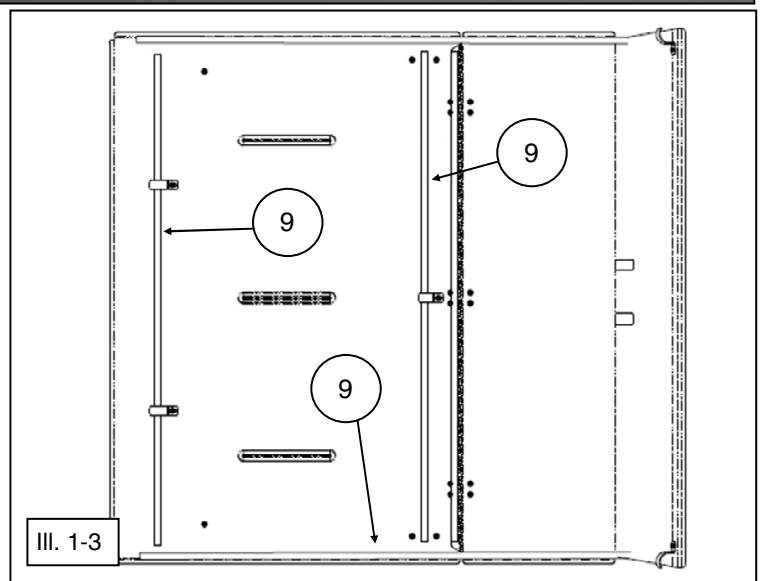

Installation Instructions (Continued):

- From top surface, loosely install front of roof (item #1) by inserting two of the M6 screws (item #3) and flat washers (item #5) thru the two outer holes as shown. (See illustration 1-4).

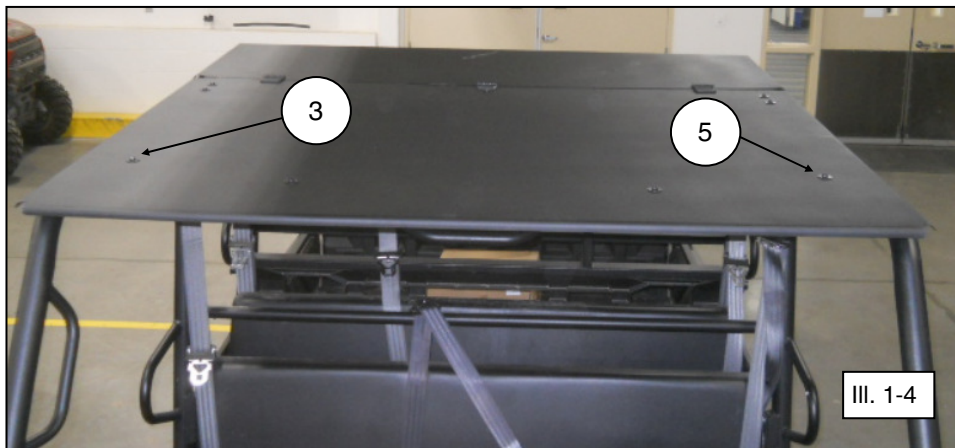

- From underneath roof, loosely fasten front screws with two M6 locknuts (item #4) as shown. (See illustration 1-5).
Note: Do not tighten hardware at this step since adjustments may be required later.

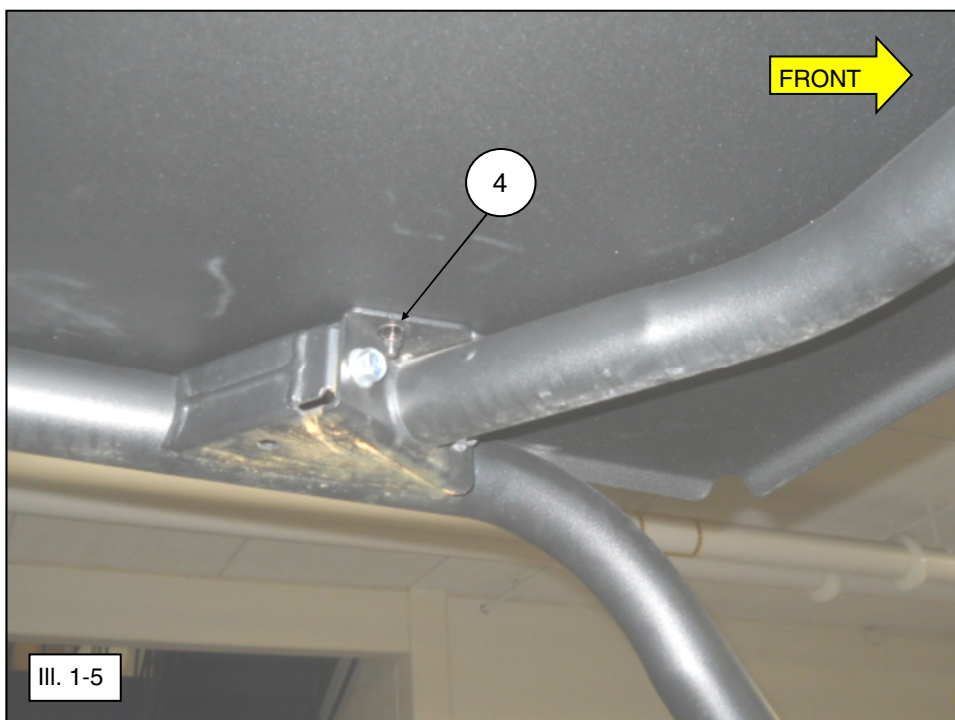

- For the middle front holes of the roof, attach the two larger clamps (item #10) to the assembly as shown. From the top surface, secure the middle clamps using M6 screws (item #3) and M6 washers (item #5). Fasten the clamps with M6 locknuts (item #4). (See illustration 1-6). **Note: Do not tighten hardware at this step since adjustments may be required later.**

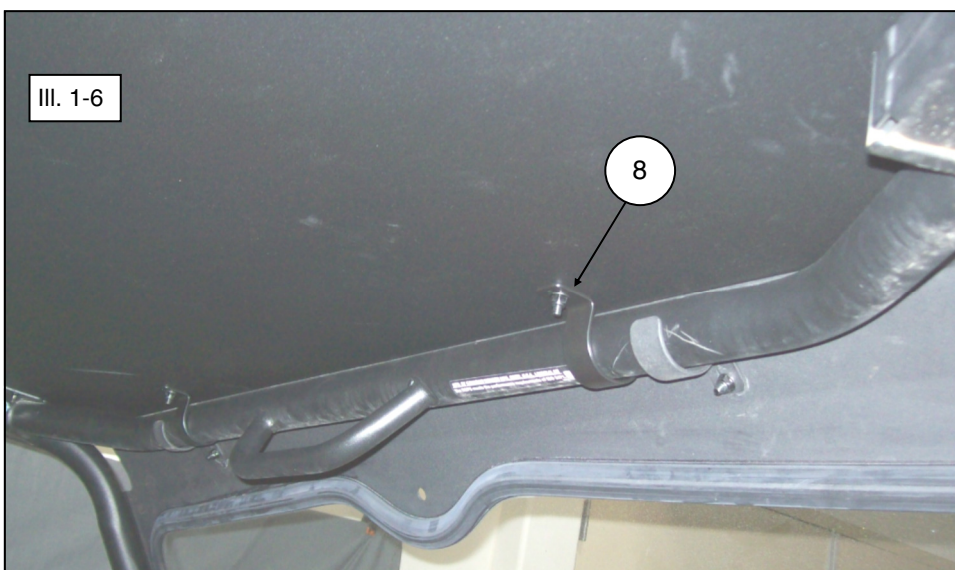

**Installation Instructions
(Continued):**

- Secure the middle of the roof using M6 screws (item #3) and M6 washers (item #5) and placing them thru holes top surface roof holes and thru cab frame flange holes. Fasten the clamps with M6 locknuts (item #4) from lower surface as shown. (See illustrations 1-6 and 1-7). **Note: Do not tighten hardware at this step since adjustments may be required later.**

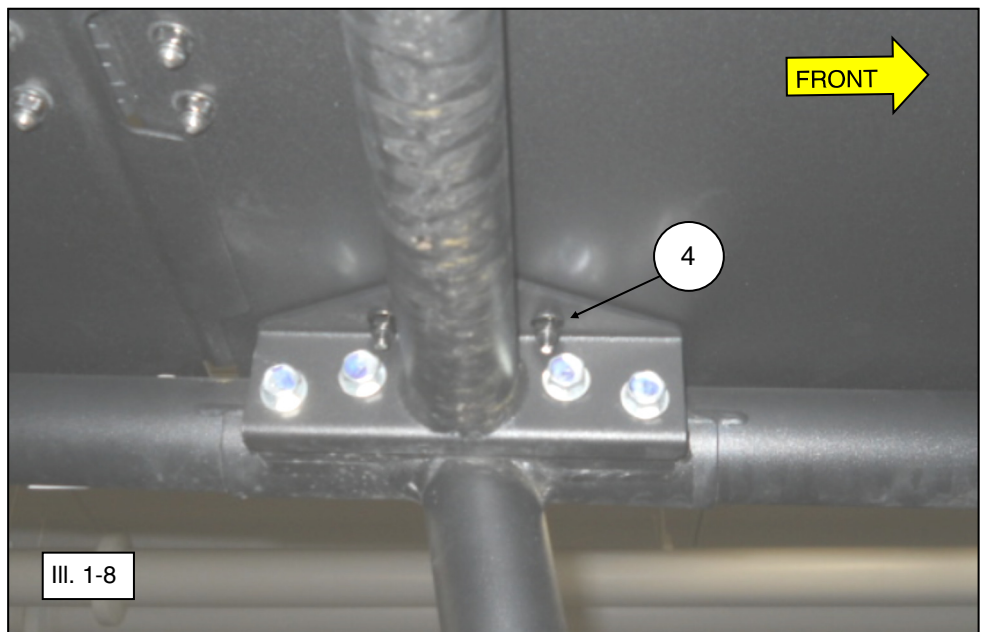
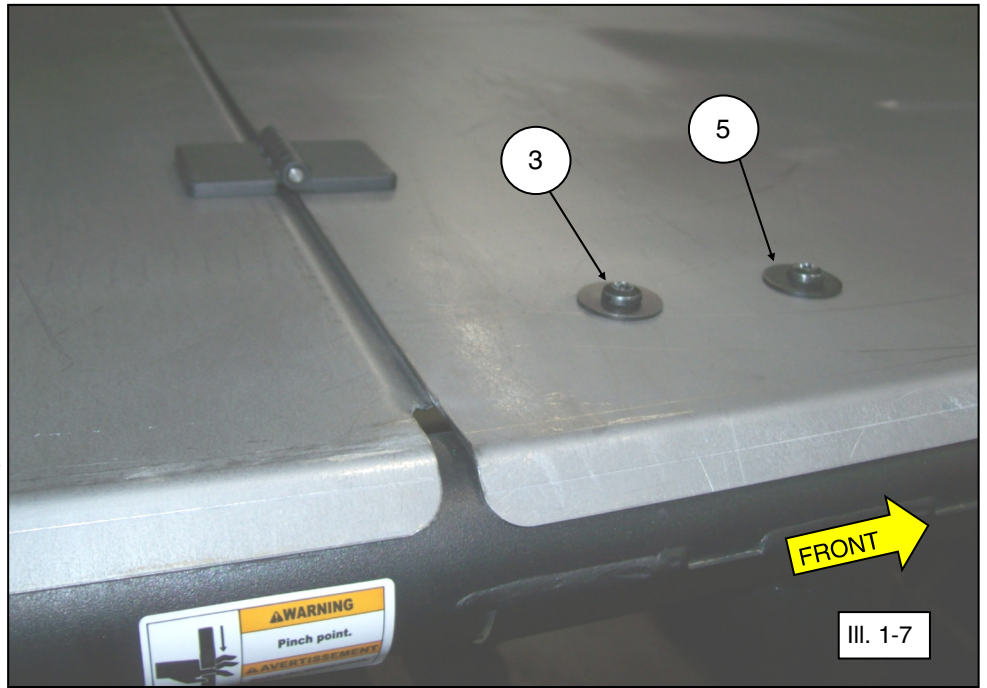

- Position and align the smaller clamp (item #11) onto the middle cab frame tube and fasten using M6 screw (item #3) and M6 flat washer (item #5) from top surface. Secure clamp using M6 locknut (item #4) as shown. (See illustration 1-9).
- Once roof panels are aligned onto cab frame, tighten all hardware to specifications. **Note, the rear section of roof is hinged to allow tilting of long cargo bed, follow next steps.**

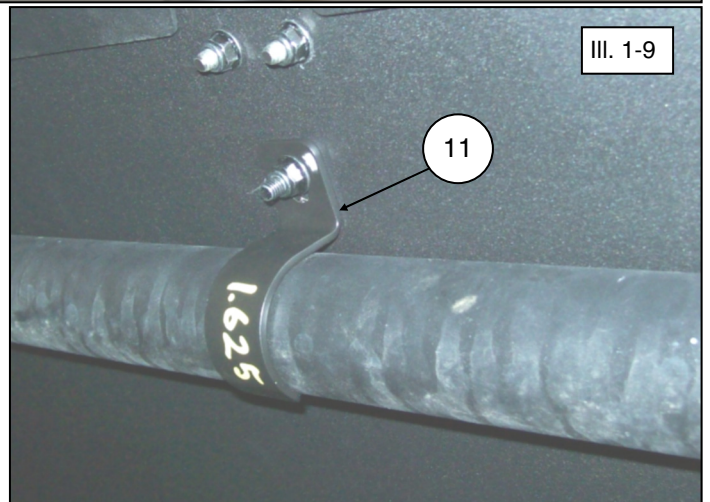

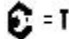
 = T
6MM FASTENER TORQUE: 7 ft. lbs. (9.5 Nm)

Installation Instructions (Continued):

11. Clean surface of rear upper cab frame and apply warning decal (item #7) on each side as shown. (See illustrations 1-10 and 1-11).
Note: The rear hinge has integrated hinge to allow tilting of long cargo bed.

WARNING: A pinch point exists between the hinged rear roof panel and upper rear cab frame.

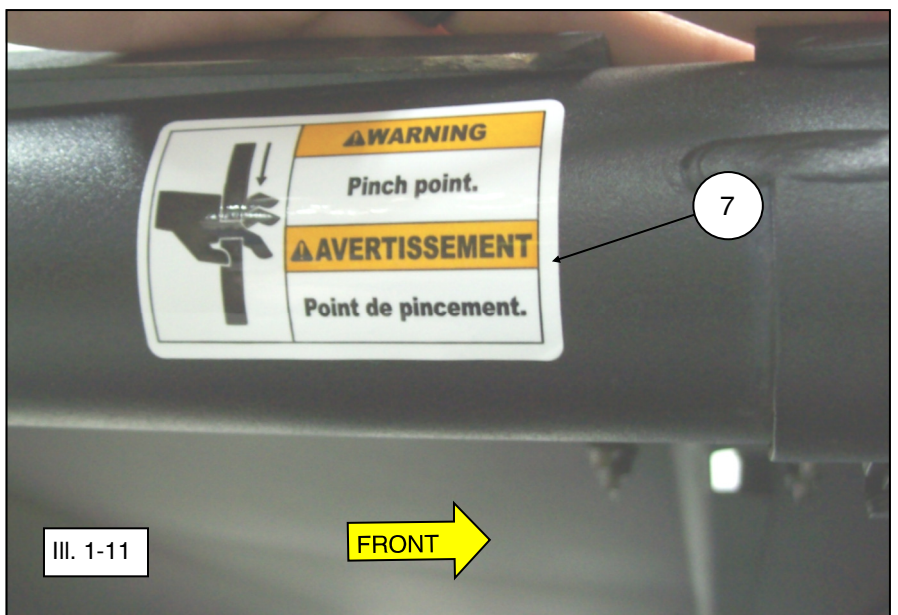
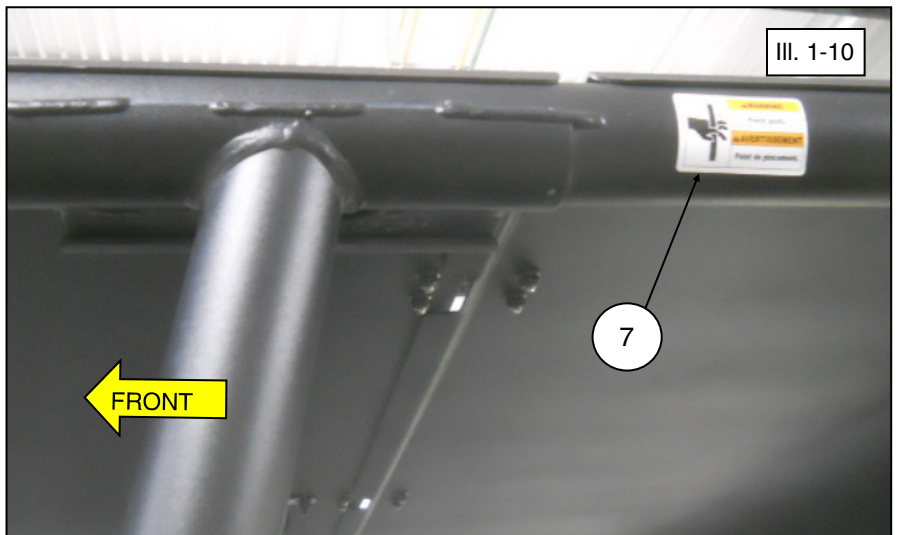

12. Insert thumbscrew knob (item #13) thru lock washer (item #6) and flat washer (item #5) and then insert thru rear slotted hole in roof panel on each side as shown. (See illustration 1-12).

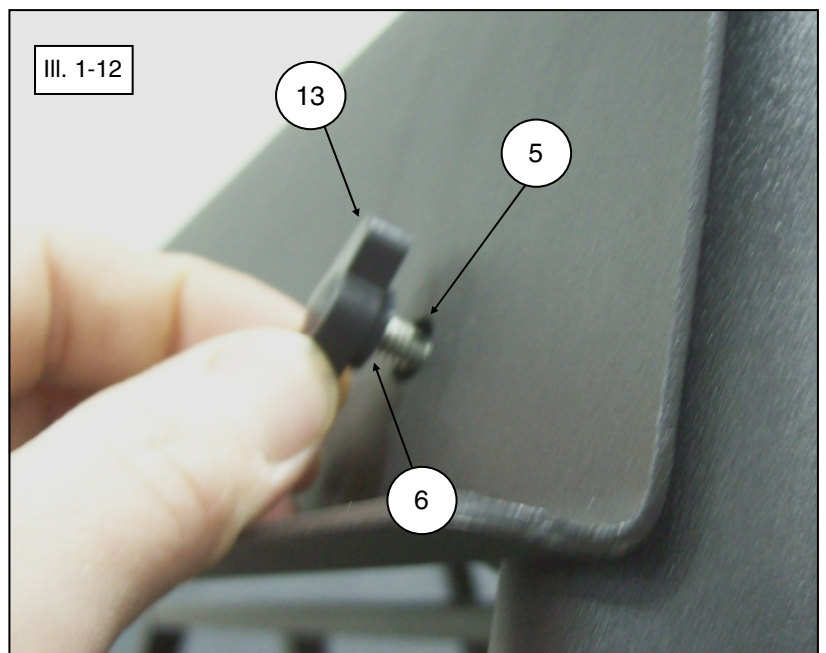

Installation Instructions (Continued):

- Secure each side of the rear roof panel to cab frame using nut clamps (item #14) as shown. Tighten the thumbscrew until snug. (See illustration 1-13). **Note, when tilting the bed with long bed, loosen the thumbscrews and rotate clamp off of cab frame tube and tilt the rear roof panel forward.**

WARNING: Do not drive the Mule with the rear of the steel roof flipped forward as it could damage the hinges.

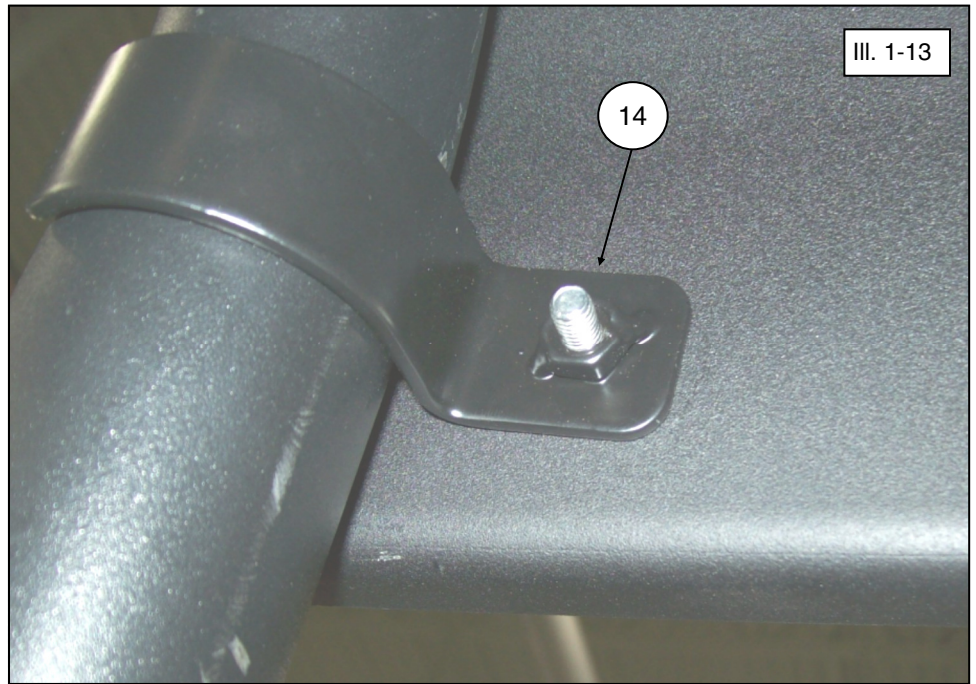

Note: Two people are required to flip the rear roof forward to allow tilting of long cargo bed.

Use and Care Information:

- Check the accessory mounts frequently and retighten hardware if necessary.
- Replace this accessory with a new one if it is damaged.
- Never use petroleum solvents such as gasoline, thinner, benzene, acid or alkaline cleaners.

For additional assistance, please contact Kolpin customer service department at (877) 956-5746 or (763) 478-5800 or email customerservice@kolpin.com

One Year Limited Warranty

For the period of one (1) year from the purchase date, Kolpin will replace for the original purchaser, free of charge, any part or parts found upon examination by Kolpin to be defective in material, workmanship, or both.

All transportation costs incurred submitting product to Kolpin for warranty consideration must be borne by the purchaser. If Kolpin determines that the product must be returned to the factory for credit, please call 1-877-956-5746 for a Return Merchandise Authorization (RMA) number and shipping instructions.

This warranty does not apply to parts that have been damaged by accident, alteration, abuse, improper maintenance, normal wear, or other causes beyond the manufacturer's control. In order to protect you and your ATV, certain parts of the accessory system and/or hardware are designed to fail when the equipment is over-stressed. Parts that are lost due to loosening and improper maintenance are not covered under warranty. This warranty does not cover removal or reinstallation labor fees of the plow system and related components.

Peripheral products such as engines, electric motors, and actuators may carry an original manufacturer's warranty. Most hardware is general in nature and is easily obtained locally. Be sure to replace with minimum metric class 8.8 specification.