

INTERCOM / VHF RADIO MOUNT KIT



P/N 2881320

APPLICATION

All RZR Models Except 570

BEFORE YOU BEGIN

Read these instructions and check to be sure all parts and tools are accounted for. Please retain these installation instructions for future reference and parts ordering information.

KIT CONTENTS

This kit contains parts used for physical installation of the Intercom Mount Kit only. Electrical/audio installation requires the following additional components (sold separately):

- Intercom/VHF Radio Kit, PN 2881319
- Headset Kit, PN 2881550

This Kit includes:

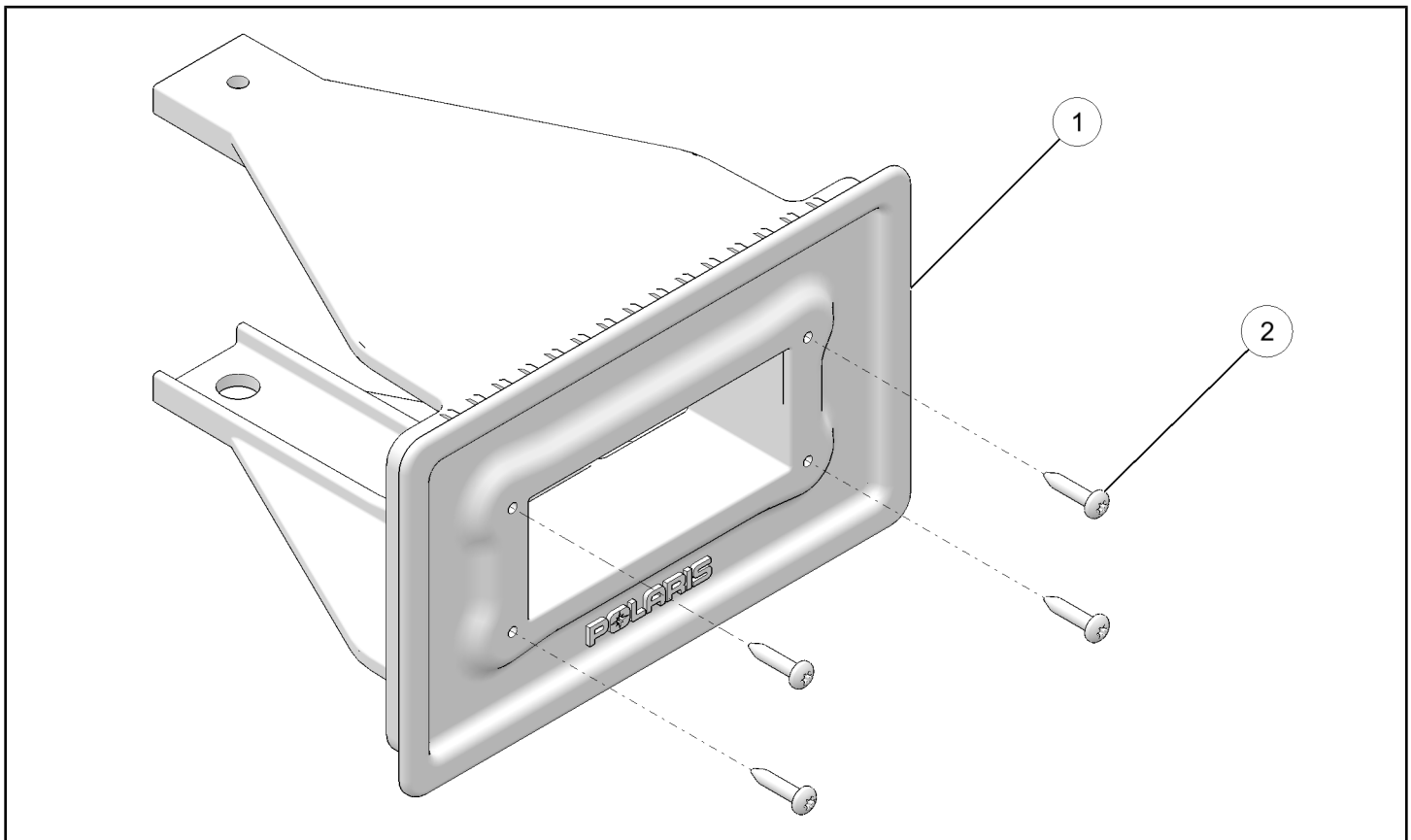

REF	QTY	PART DESCRIPTION	PART NUMBER
1	1	Intercom/VHF Radio Mount	—
2*	4	Screw, Torx® Pan Head - #8 X 0.75"	—
	1	Instructions	9926367

Items marked (*) are included in Hardware Kit PN 2206080.

TOOLS REQUIRED

- Safety Glasses

- Screwdriver Set, Torx®

IMPORTANT

Your INTERCOM / VHF RADIO MOUNT KIT is exclusively designed for your vehicle. Please read the installation instructions thoroughly before beginning. Installation is easier if the vehicle is clean and free of debris. For your safety, and to ensure a satisfactory installation, perform all installation steps correctly in the sequence shown.

ASSEMBLY TIME

Approximately 15 minutes

INSTALLATION INSTRUCTIONS

NOTE

The following instructions are for physical installation of the Intercom/VHF Radio Mount Kit only. Electrical/audio installation instructions are included in their respective kits (sold separately). Refer to Kit Contents for more information.

1. Shift vehicle transmission into "PARK". Turn key to "OFF" position and remove from vehicle.
2. Gain access.
 - a. Remove hood.
 - b. Remove two screws (A) securing front of upper dash panel, then pull panel rearward, disengaging seven spring clips (B) retaining upper dash panel to lower dash panel as shown.

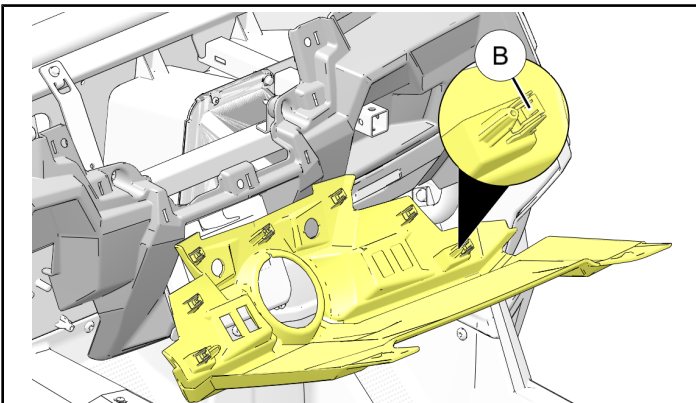
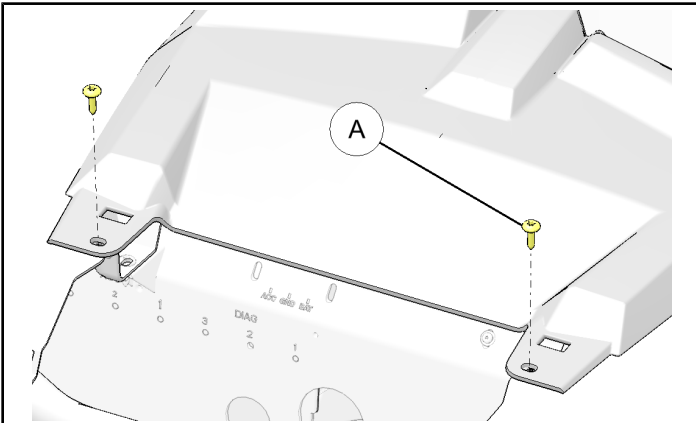

3. Carefully detach LED light (C) from front lower flange of storage compartment (D) as shown.

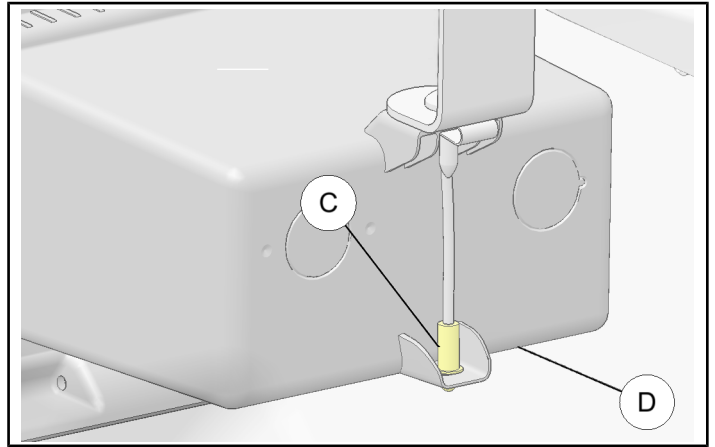

4. Remove screw (E) securing upper rear flange of storage compartment (D) to bracket (F) as shown. Retain screw.

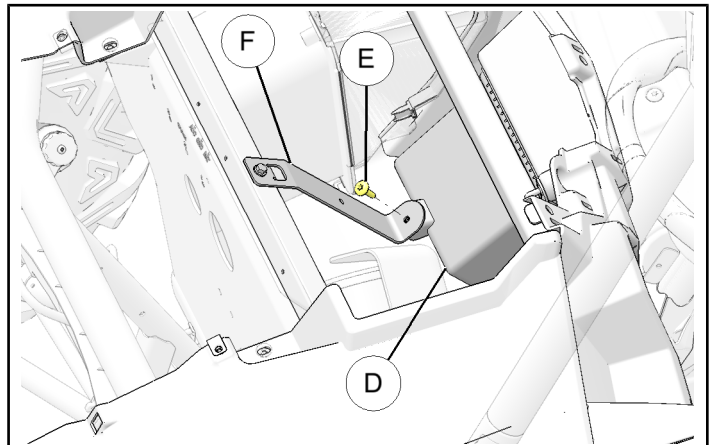

5. Remove storage compartment (D) from lower dash panel.

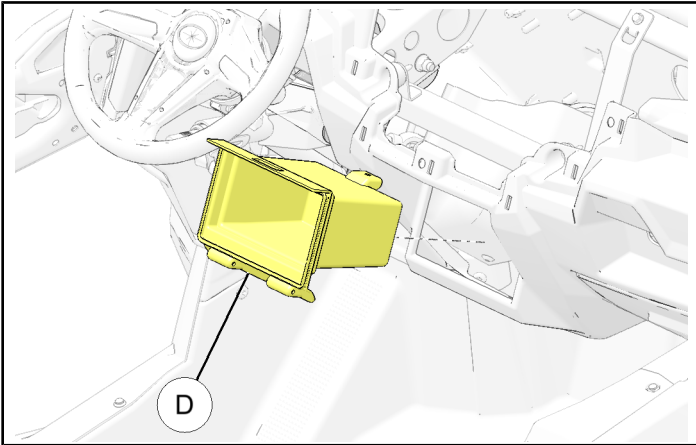

8. Install retained screw (E) to secure bracket (F) to upper rear flange of storage compartment ① as shown.

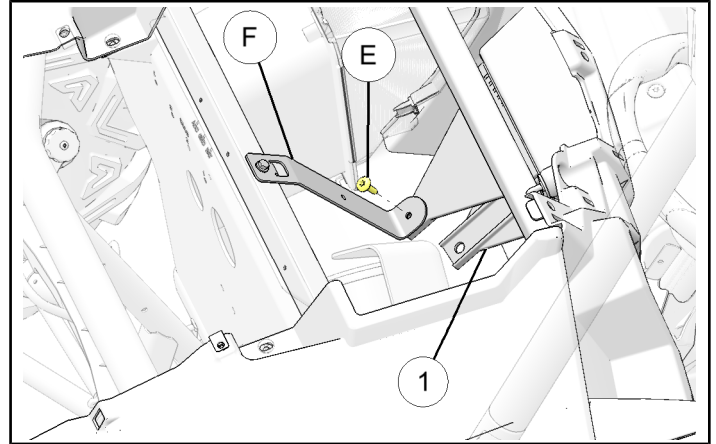

6. Remove nut clip (G) from upper rear flange of storage compartment (D), then reinstall nut clip on upper rear flange of intercom mount ① as shown. Ensure proper orientation of nut clip.

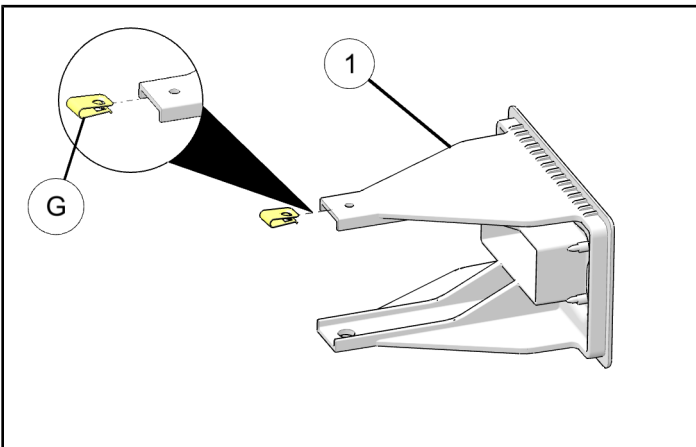

9. Carefully reattach LED light (C) to front lower flange of intercom mount ①.

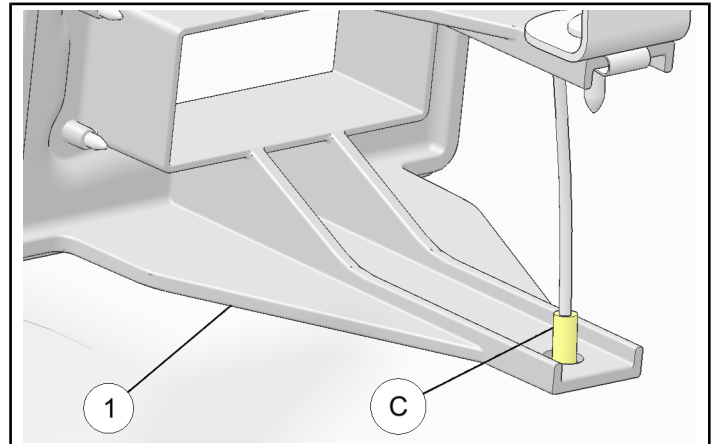

7. Ensure "POLARIS" text on front face of intercom mount ① is oriented properly, then hook lower tab and rotate mount up to lock into dash panel.

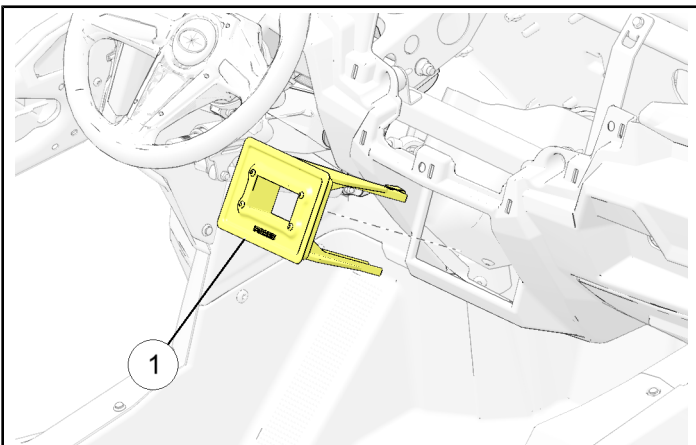

10. Restore access.

NOTE

Four screws ② are provided for installation of intercom/VHF radio to mount ①. See instructions included with Intercom/VHF Radio Kit for installation detail.