

SOFT REAR PANEL KIT

P/N 2879040



Application

MY 13 Ranger 900 XP

Before you begin, read these instructions twice and check to be sure all parts and tools are accounted for. Please retain these installation instructions for future reference and parts ordering information.

This Kit Includes:

<u>Qty</u>	<u>Part Description</u>	<u>Part Number</u>
1.....	Rear Panel, Canvas	
1.....	Metal Rear Panel Bracket	
7.....	Plastic Retainer Darts	
2.....	Rod, Reinforcement	
1.....	Instructions	9924227

Tools Required:

Hammer/Mallet

Additional Service Kits Available to Order:

<u>Qty</u>	<u>Part Description</u>	<u>Part Number</u>
1.....	KIT-SVC,RR PNL,HDWR,BESTOP,TTN (Includes extrusion and hardware for mounting rear panel)	2204810

IMPORTANT: For your safety, and to ensure a satisfactory installation, perform all installation steps correctly in the sequence as shown on the attached instructions. Please wear safety glasses while performing the steps in the following instructions.

INSTALLATION INSTRUCTIONS

1. Remove and discard the plastic rivets on the rear close off panel at the location shown in Figure 1.
2. Line up the metal rear panel bracket with the seven holes in the rear close off panel. Insert the new plastic retainer darts through metal bracket and into rear close off. Figure 1.

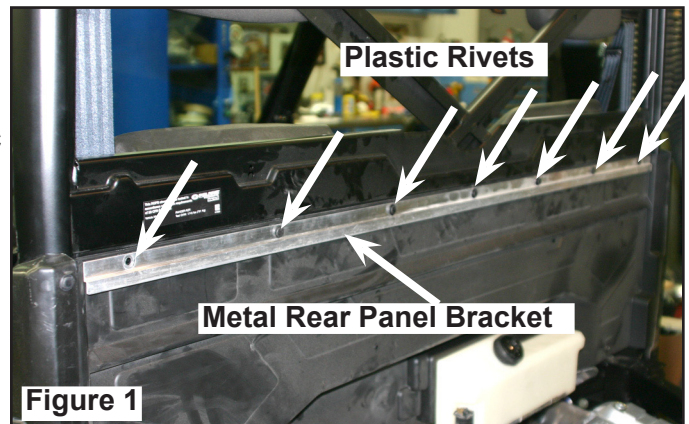

2. Gently tap plastic retainer darts with a hammer to ensure they are fully seated. Figure 2.

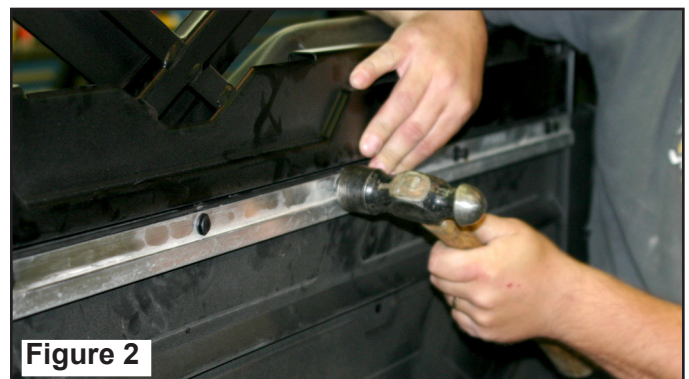

3. Insert reinforcement rods into pockets on either side of the rear panel.
4. Hook the top of rear panel canvas to the edge on the rear ROPS frame. Figures 3a and 3b.

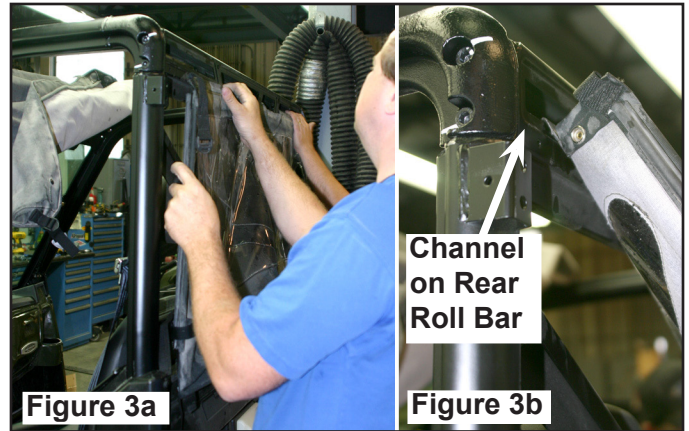

5. To install the rear panel into the bottom channel, pull downward on the rear panel. Starting at one end, feed the rear panel into bottom channel of the rear panel bracket. Figure 4.

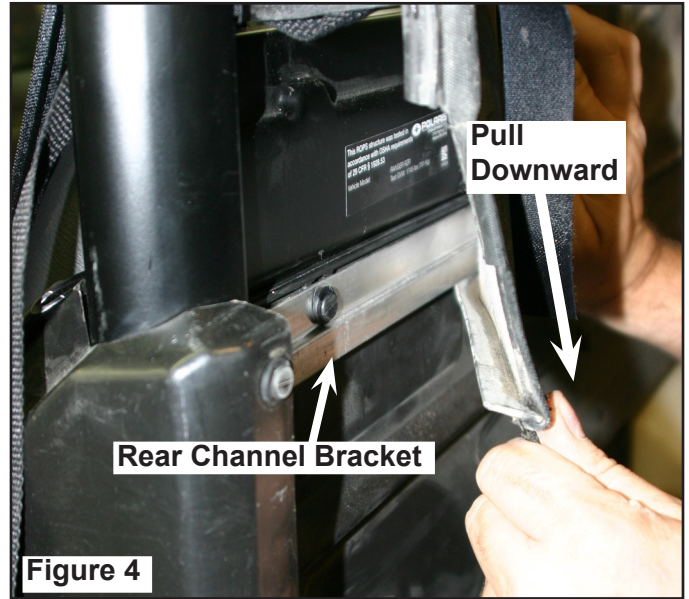

6. Take the long hook strap and thread through the two loops on the rear panel canvas. Go under and over the top roll bar and through buckle. Tighten strap. Figures 5a-d.

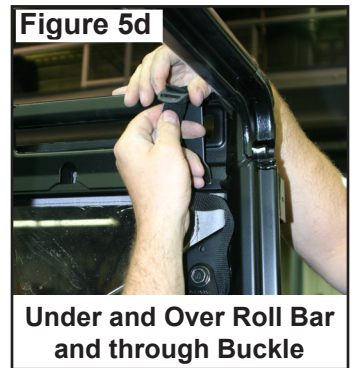
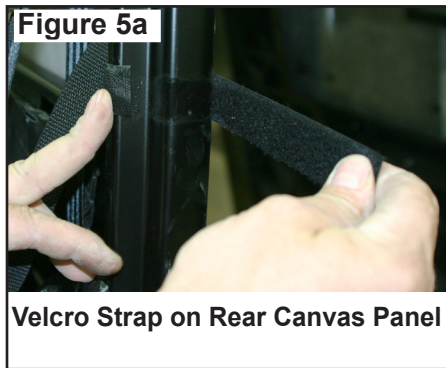

7. Strap installed. Figure 6.

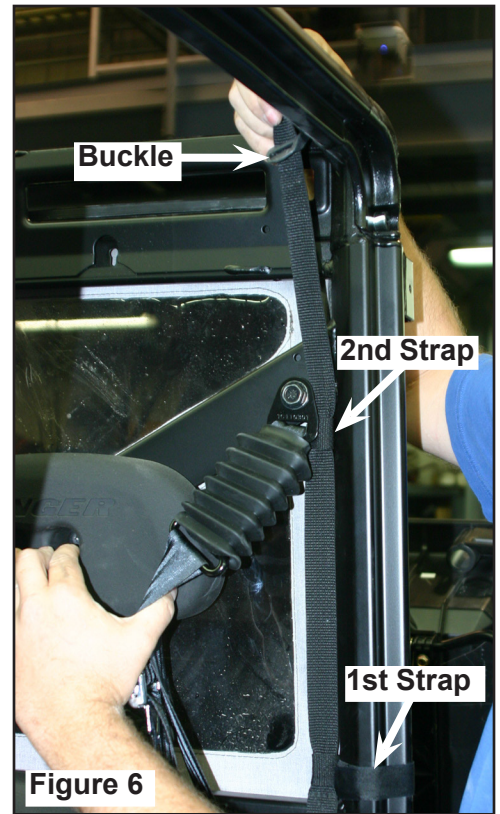

8. If the Soft Top kit has been installed, snap top over rear panel. Figure 7.



**Ranger 900 XP Shown with Soft
Doors, Top and Rear Panel Installed**

