

FRONT BRUSHGUARD KIT



P/N 2882356

APPLICATION

Verify accessory fitment at Polaris.com.

BEFORE YOU BEGIN

Read these instructions and check to be sure all parts and tools are accounted for. Please retain these installation instructions for future reference and parts ordering information.

KIT CONTENTS

This Kit includes:

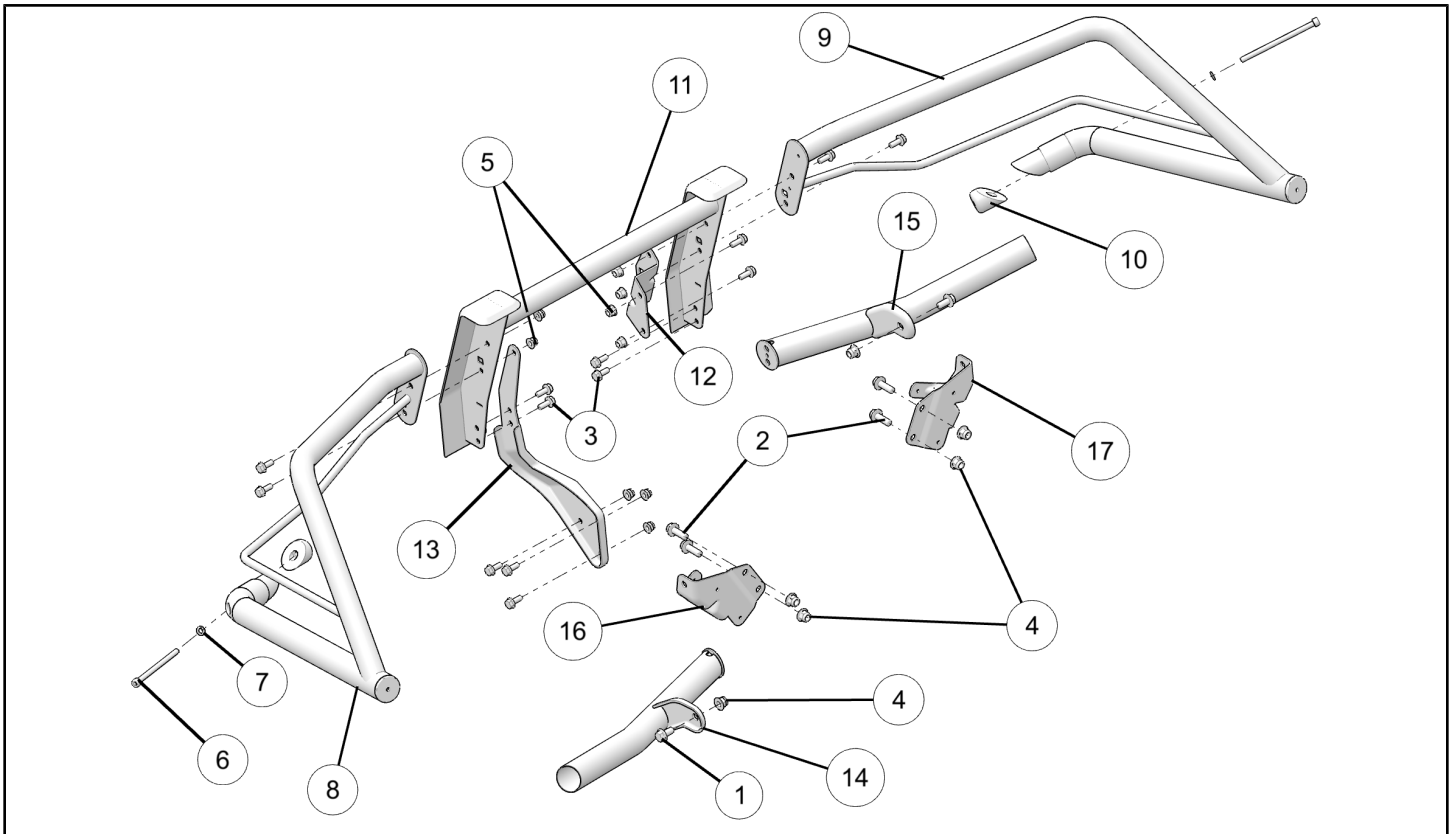

REF	QTY	PART DESCRIPTION	PART NUMBER
1	2	Bolt, Hex Flange, M10 X 1.5 X 20	-
2	4	Bolt, Hex Flange, M10 X 1.5 X 30	-
3	13	Bolt, Hex Flange, M8 X 1.25 X 20	-
4	6	Nut, Hex Nylon Flange, M10 X 1.5	-
5	9	Nut, Hex Nylon Flange, M8 X 1.25	-
6	2	Socket Head Cap Screw, M8 X 1.25 X 130mm	-
7	2	Spring Lock Washer M8 X 8.2 X 14.8 X 2	-
8	1	Weld Assembly, Left	-

REF	QTY	PART DESCRIPTION	PART NUMBER
9	1	Weld Assembly, Right	-
10	2	Taper Block	-
11	1	Center Weld Assembly	-
12	1	Plate	-
13	1	Plate	-
14	1	Brushguard Weld, LH	-
15	1	Brushguard Weld, RH	-
16	1	Mounting Plate, LH	-
17	1	Mounting Plate, RH	-
	1	Instructions	9927689

TOOLS REQUIRED

- Safety Glasses
- Internal Hex Bit Set
- Metric Ratchet Set
- Hex Bit Set
- Torx® Bit Set

IMPORTANT

Your FRONT BRUSHGUARD KIT is exclusively designed for your vehicle. Please read the installation instructions thoroughly before beginning. Installation is easier if the vehicle is clean and free of debris. For your safety, and to ensure a satisfactory installation, perform all installation steps correctly in the sequence shown.

ASSEMBLY TIME

Approximately 45 minutes

INSTALLATION INSTRUCTIONS

1. Shift vehicle transmission into "PARK". Turn key to "OFF" position and remove from vehicle.
2. Remove the existing plastic support brackets (A) (one on each side) by removing two bolts (B) from the front fascia bracket (C). Remove another bolt (D) from upper front fascia (E). Retain the bolts (B) and (D) and discard brackets (A).
3. Remove the hood (F) by rotating two knobs (G) as shown.

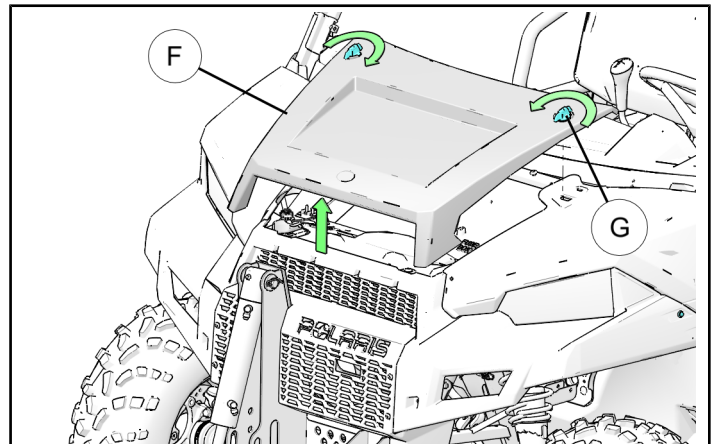
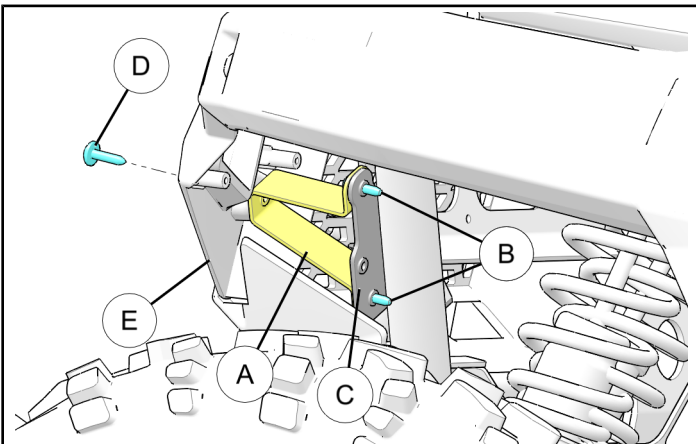

- Remove lower front fascia (P) by removing four screws (H) and two lower screws (D) as shown. Retain hardware for reinstallation.

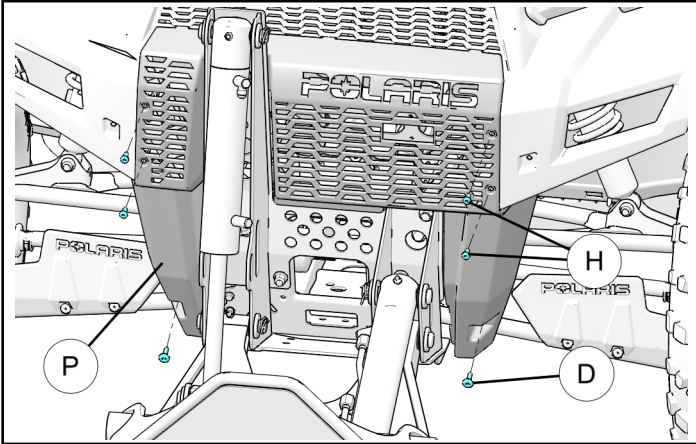

- Remove upper front fascia (E) by removing two screws (D) and six push darts (J) as shown.

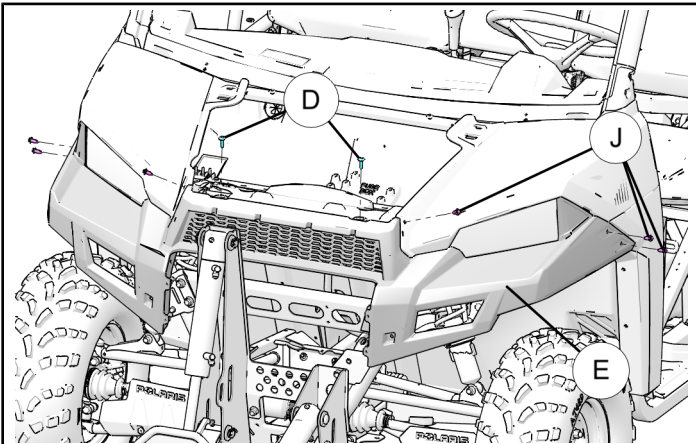

- Remove two bolts (K) and nuts (L) from front attachment mounting bracket (M). Discard both bolts and nuts.

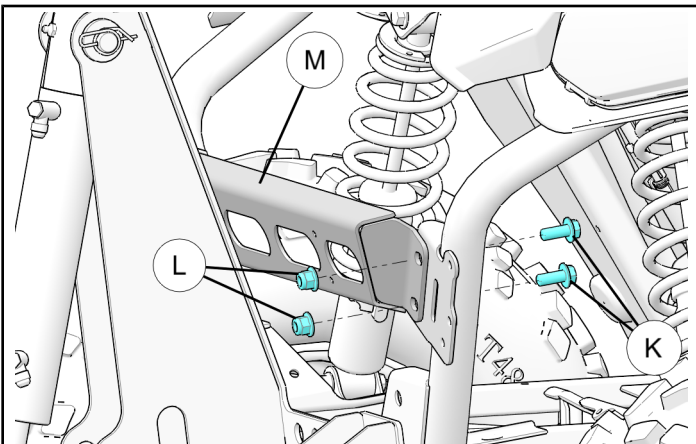

- Install LH mounting plate (16) to front attachment mounting bracket (M) using bolts (2) and nuts (4). Reuse two Torx® bolts (B) removed in Step 2. Torque bolts to specification.

TORQUE

Bolts (B): 8 ft. lbs. (10.8 Nm)
Bolts (2): 37 ft. lbs. (50 Nm)

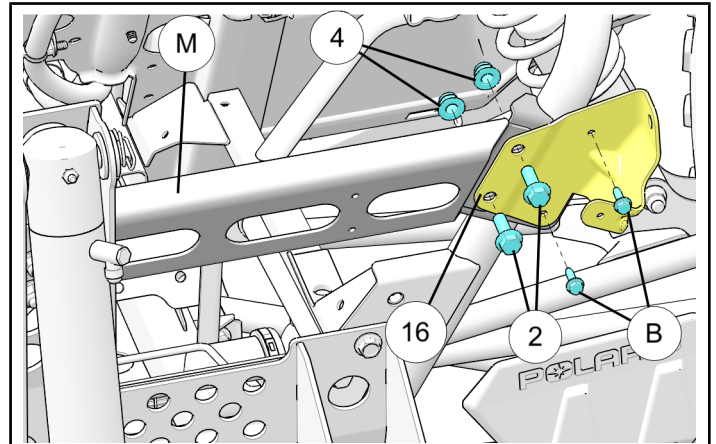

- Repeat Step 6 and Step 7 on opposite side of vehicle for RH mounting plate (17) installation.
- Install LH brushguard weldment (14) and mounting plate (13) to center weld assembly (11) using two bolts (3) as shown.

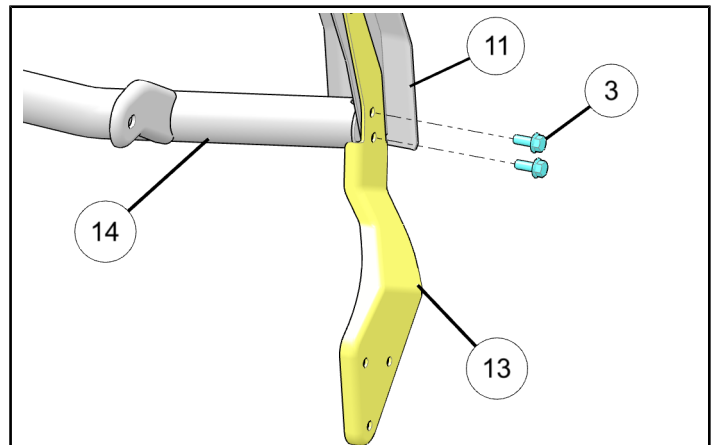

10. Install RH brushguard weldment ⑮ to center weld assembly ⑪ using two bolts ③.

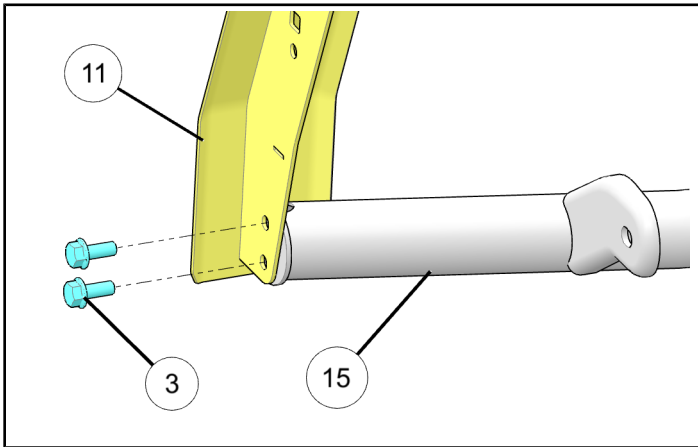

11. Position the taper block ⑩ onto end of the left brushguard section ⑧ and fasten using socket head cap screw ⑥ with washer ⑦. Tighten until the taper block ⑩ leaned against the left section. Repeat same for the opposite side.

NOTE

Do not overtighten to facilitate the insertion.

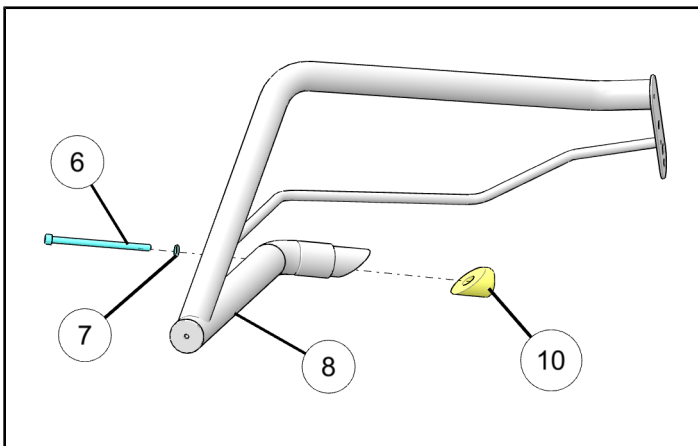

12. Insert the lower part of LH brushguard assembly ⑧ with taper block ⑩ installed into LH brushguard weldment ⑭. Align holes of the upper part of LH brushguard assembly ⑧ with center weld assembly ⑪ and mounting plate ⑬ and install bolts ③ and nuts ⑤. Finger tighten hardware at this time.

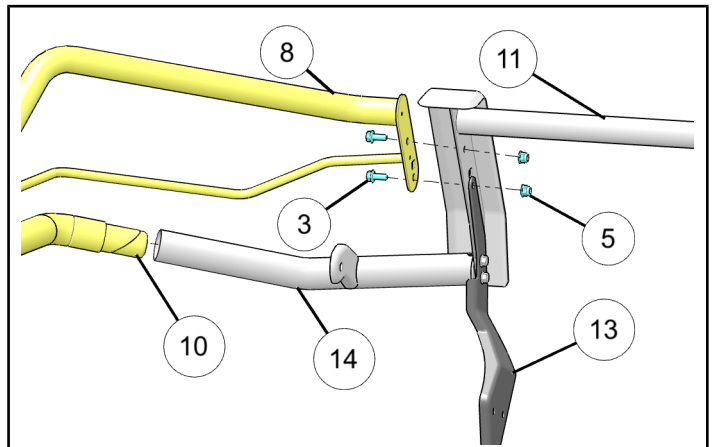

13. Insert the lower part of RH brushguard assembly ⑨ with taper block ⑩ installed into RH brushguard weldment ⑮. Align holes of the upper part of RH brushguard assembly ⑨ with center weld assembly ⑪ and mounting plate ⑫ and install bolts ③ and nuts ⑤.

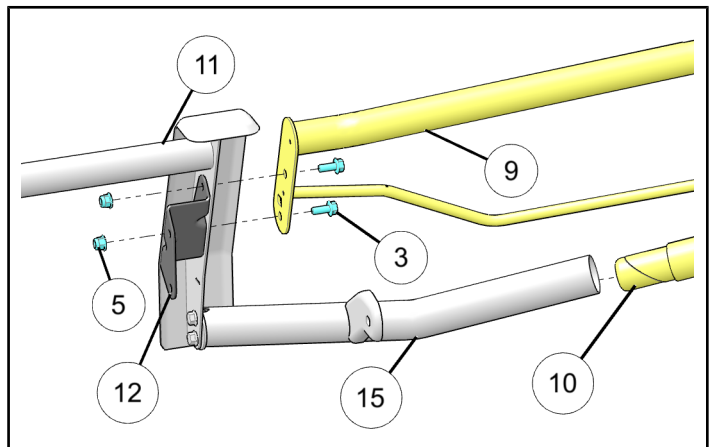

14. Torque previously installed bolts ③ to below specification at this time.

TORQUE

17 ft. lbs. (23 Nm)

15. Using template dimensions on last page of instructions, measure template to verify proper 1:1 scale. Carefully cut out template. Place templates (S) and (T) on front attachment (N) and mark three hole locations on LH side and two hole locations on RH side. Drill holes (R) and (Q) on LH and RH side of front attachment (N) as shown.

NOTE

If printing from electronic file and template is not at proper 1:1 scale, then ensure print settings indicate "Actual Size" (not "Fit").

LH Side

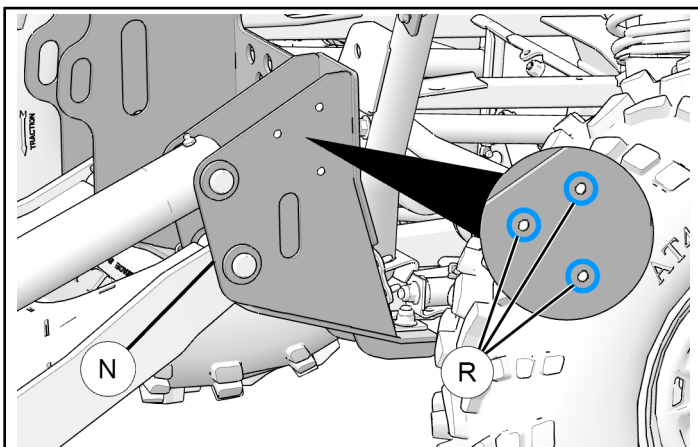
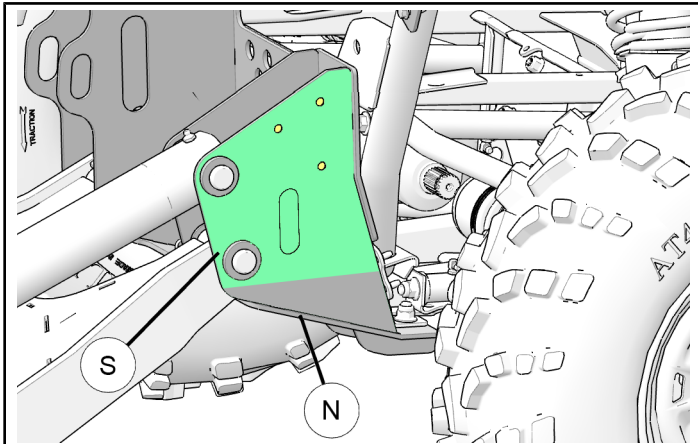

RH Side

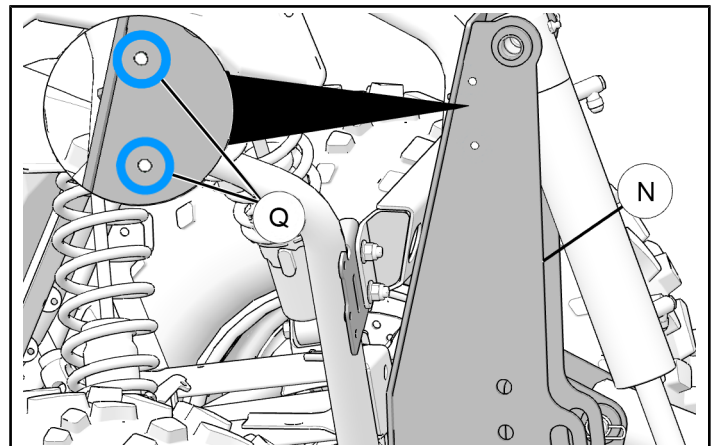
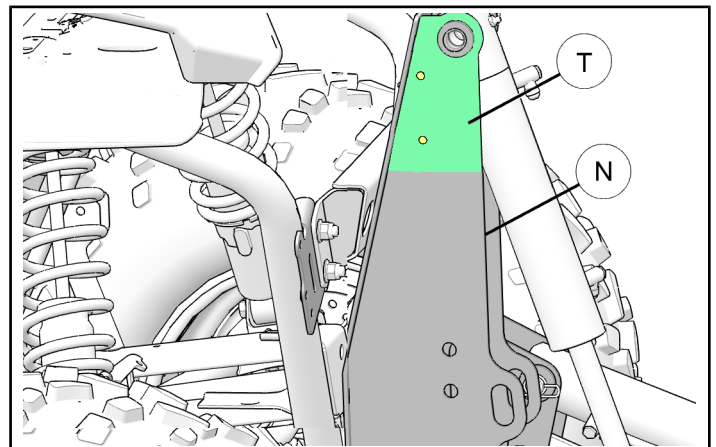

16. Reinstall front fascia (E) and (P) removed in Step 5 and Step 4. Reinstall hood, removed in Step 3. Reinstall screws (D), removed in Step 2.

17. Install brushguard assembly onto LH mounting plate ⑩ using bolt ① and nut ④. Repeat the same on opposite side. Torque bolts ① on both sides to specification.

TORQUE

37 ft. lbs. (50 Nm)

NOTE

Upper front fascia (E) is shown transparent for better clarity.

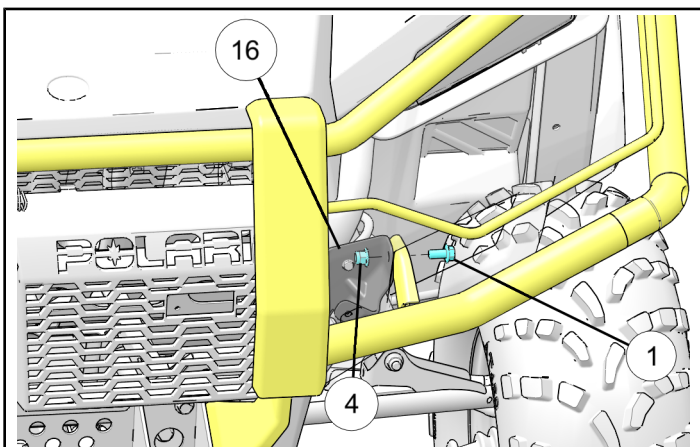

18. Install brushguard assembly onto front attachment (N) by aligning with previously drilled holes and installing three screws ③ and nuts ⑤ on LH side and two screws ③ and nuts ⑤ on RH side. Torque screws to specification.

TORQUE

17 ft. lbs. (23 Nm)

LH Side

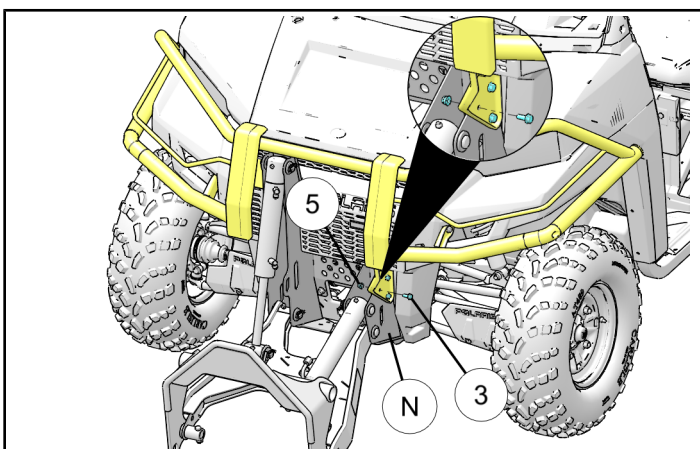

RH Side

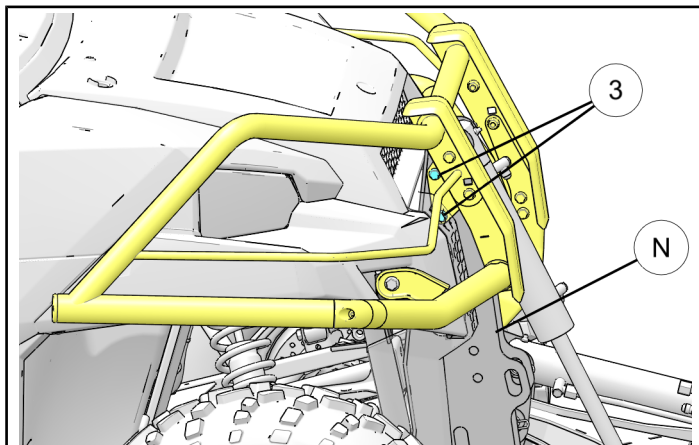

NOTE

Lower cylinder mounting point may be disconnected to ease in access for RH side.

19. Ensure end of the left brushguard assembly ⑧ is held firmly against LH brushguard weldment ⑭. Lock in position by tightening Allen socket machine screws ⑥ installed in Step 11. Secure firmly the flange bolts ③ retaining the left section ⑧ onto the middle section ⑩. Repeat same for the opposite side.

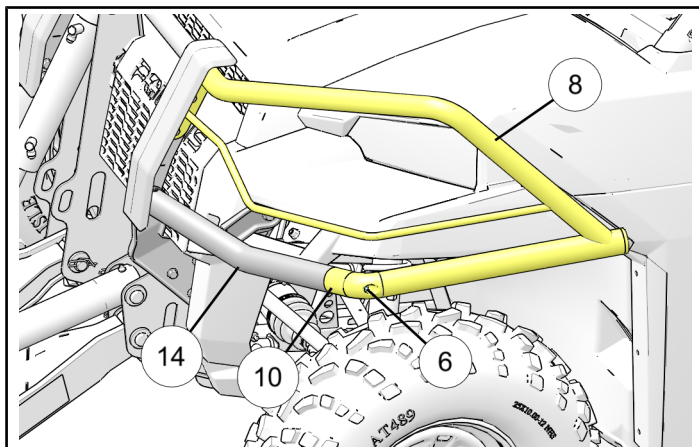

Template, LH

NOTE

If printing from electronic file and template is not at proper 1:1 scale, then ensure print settings indicate "Actual Size" (not "Fit").

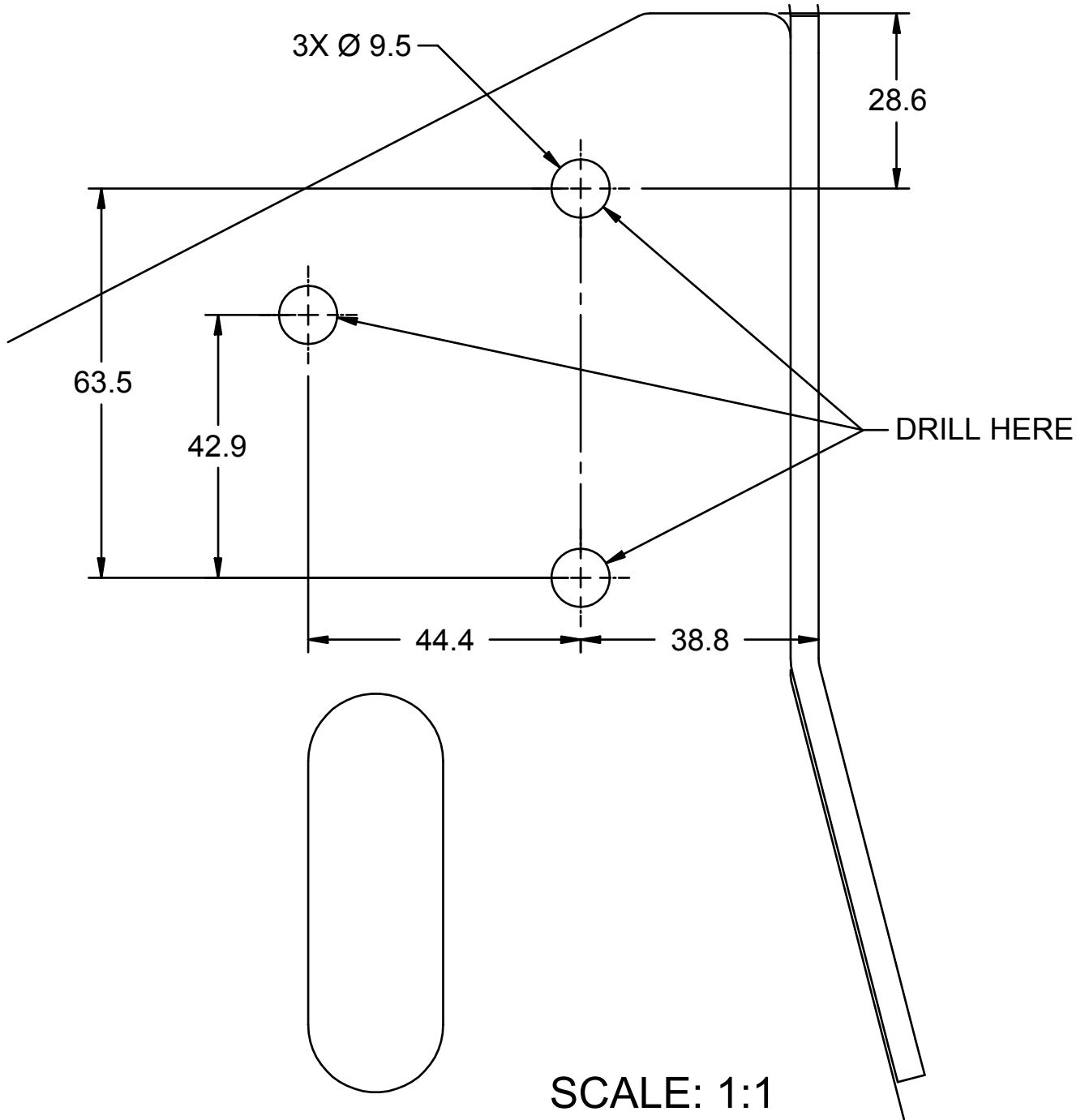

THIS PAGE IS INTENTIONALLY LEFT BLANK

Template, RH

NOTE

If printing from electronic file and template is not at proper 1:1 scale, then ensure print settings indicate "Actual Size" (not "Fit").

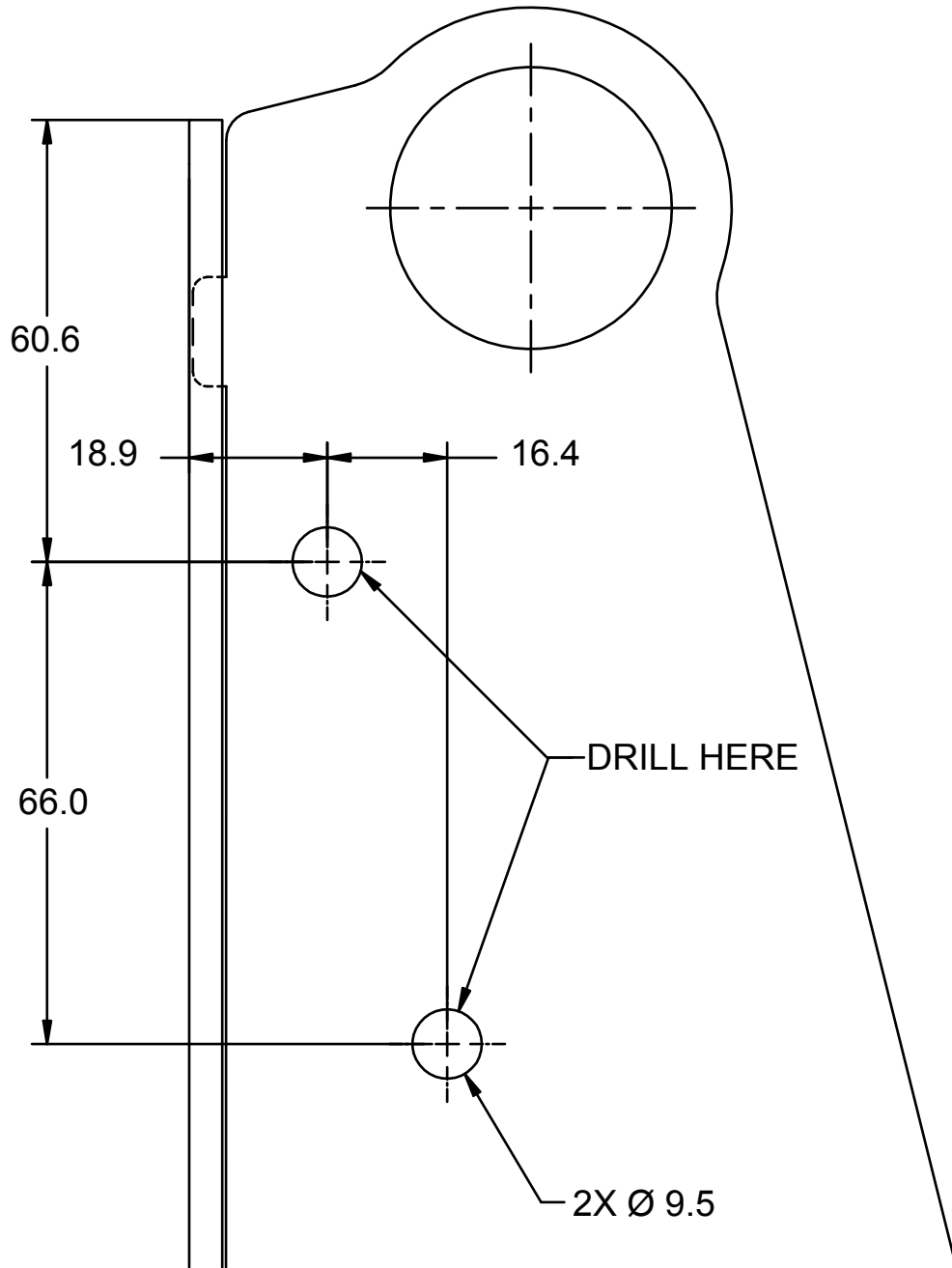

SCALE: 1:1