

FRONT A-ARM GUARD KIT



P/N 2879889

APPLICATION

MY14 AND NEWER SPORTSMAN 570 AND SPORTSMAN 570 TOURING MODELS,
MY11-14 SPORTSMAN 400, 500, AND 800 MODELS

BEFORE YOU BEGIN

Read these instructions thoroughly and make sure all parts and tools are accounted for. Please retain these installation instructions for future reference and parts ordering information.

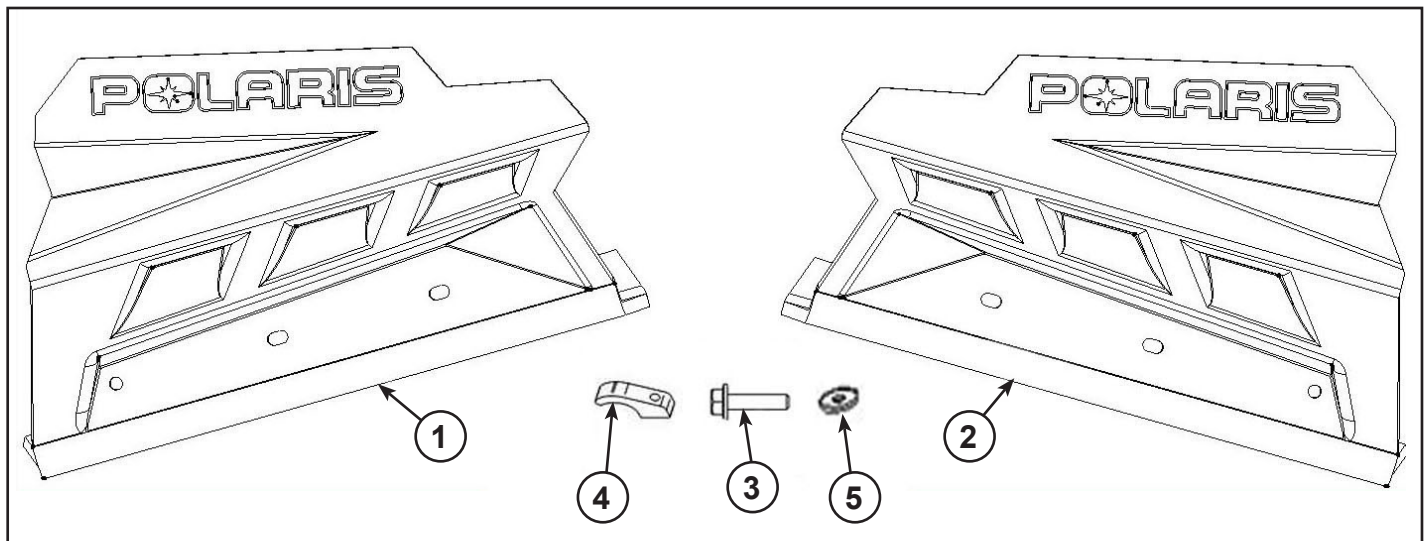

KIT CONTENTS

Ref	Description	Front A-Arm Guard Kit (PN 2879889)	Hardware Kit (PN 2205218)
1	Front A-Arm Guard, LH	1x	-
2	Front A-Arm Guard, RH	1x	-
3	Bolt-M6X1.0X25, HXHD	4x	4x
4	Clamp	4x	4x
5	Washer, M6	4x	4x
	Instructions (PN 9925582)	1x	-

TOOLS NEEDED

Safety Goggles

Metric Wrench Set

Metric Socket Set

T-25 Torx Wrench

APPROXIMATE ASSEMBLY TIME

10 min

IMPORTANT

Your Polaris FRONT A-ARM GUARD KIT is exclusively designed for your vehicle. Please read the installation instructions thoroughly before beginning. Installation is easier if the vehicle is clean and free of debris. For your safety, and to ensure a satisfactory installation, perform all installation steps correctly in the sequence shown.

INSTALLATION INSTRUCTIONS

1. Place the vehicle in “**PARK**”. Turn the key to “**OFF**” position and remove from the vehicle.
2. Remove the RH stock A-Arm guard (A) by removing three bolts (B). Retain bolts (B) for re-installation. Repeat this step on other side of the vehicle.

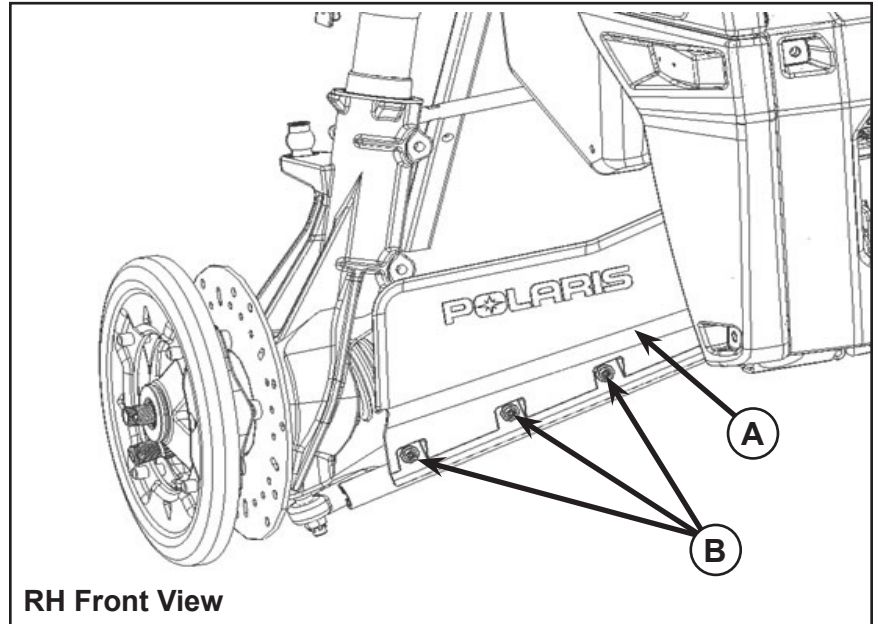

3. Install RH front A-Arm guard (1) using three bolts (B) removed in Step 2.
4. Hold the rear of the A-Arm guard against the rear tube of the A-Arm and secure in place using two clamps (4), two bolts (3) and two washers (5) as shown in the figure.
5. Repeat the above steps to install the LH A-Arm guard.
6. Check all hardware to ensure the guard is securely fastened to the A-Arms.

