

FRONT A-ARM GUARD KIT



P/N 2880644

APPLICATION

SPORTSMAN XP

BEFORE YOU BEGIN

Read these instructions thoroughly and make sure all parts and tools are accounted for. Please retain these installation instructions for future reference and parts ordering information.

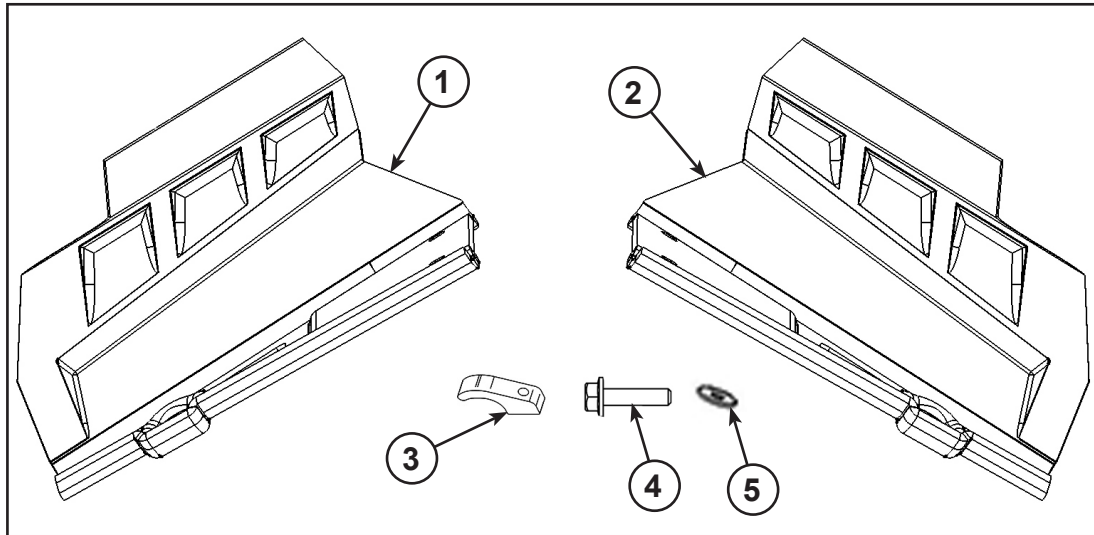

KIT CONTENTS

Ref	Description	Front A-Arm Guard Kit (PN 2880644)	Hardware Kit (PN 2205218)
1	Front A-Arm Guard, LH	1x	-
2	Front A-Arm Guard, RH	1x	-
3	Clamp	4x	4x
4	Bolt-M6X1.0X25, HXHD	4x	4x
5	Washer-M6X1.0	4x	4x
	Instructions (PN 9925577)	1x	-

TOOLS NEEDED

Safety Goggles

Metric Wrench Set

Metric Socket Set

Torque Wrench

APPROXIMATE ASSEMBLY TIME

10 min

IMPORTANT

Your Polaris FRONT A-ARM GUARD KIT is exclusively designed for your vehicle. Please read the installation instructions thoroughly before beginning. Installation is easier if the vehicle is clean and free of debris. For your safety, and to ensure a satisfactory installation, perform all installation steps correctly in the sequence shown.

INSTALLATION INSTRUCTIONS

1. Place the vehicle in “**PARK**”. Turn the key to “**OFF**” position and remove from the vehicle.
2. Remove the stock A-Arm guard (A) by removing screw (B) as shown in figure. Retain the screw for re-installation. Repeat the step on other side of the vehicle.

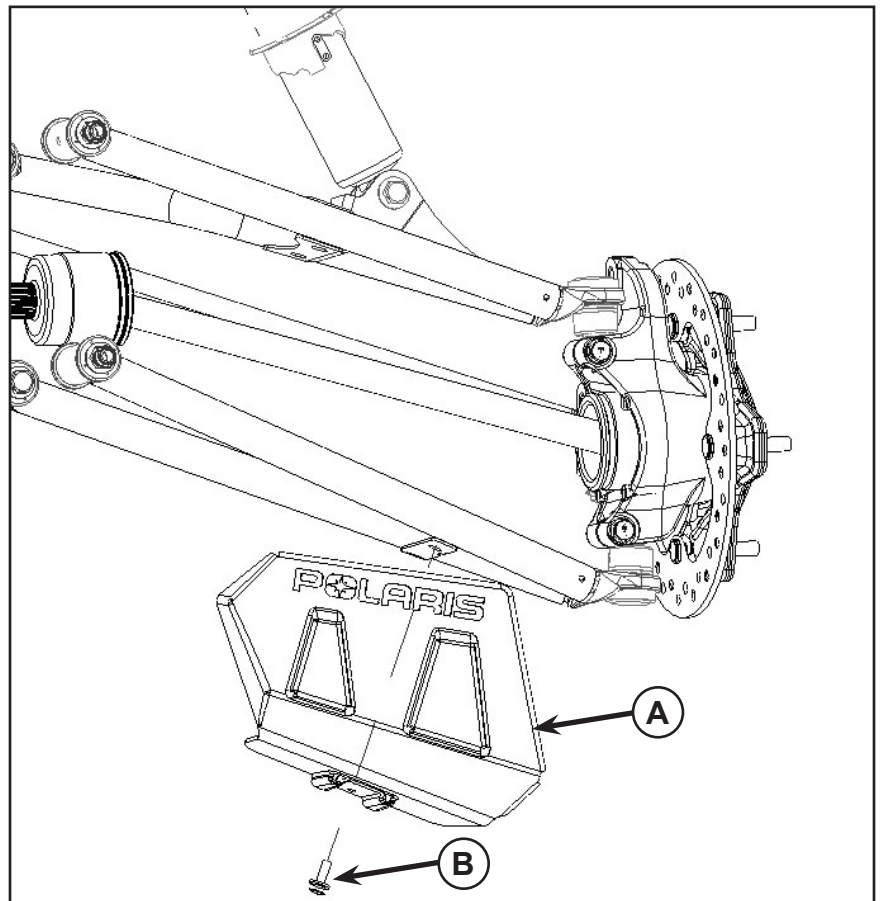

3. Attach the LH front A-Arm guard (1) to the tube with two clamps (3), two M6 bolts (4), and two washers (5) as shown in figure. Install screw (B) removed in Step 2.
4. Repeat the above step to install RH front A-Arm guard (2).
5. Check all hardware to ensure the guard is securely fastened to the A-Arms.

NOTE: Torque M6 bolts to 8 ft. lbs. (10.8 Nm).

