

REAR A-ARM GUARD KIT



P/N 2880679

APPLICATION

MY14 AND NEWER SPORTSMAN 570 AND SPORTSMAN 570 TOURING MODELS,
MY11-14 SPORTSMAN 400, 500, AND 800 MODELS

BEFORE YOU BEGIN

Read these instructions thoroughly and make sure all parts and tools are accounted for. Please retain these installation instructions for future reference and parts ordering information.

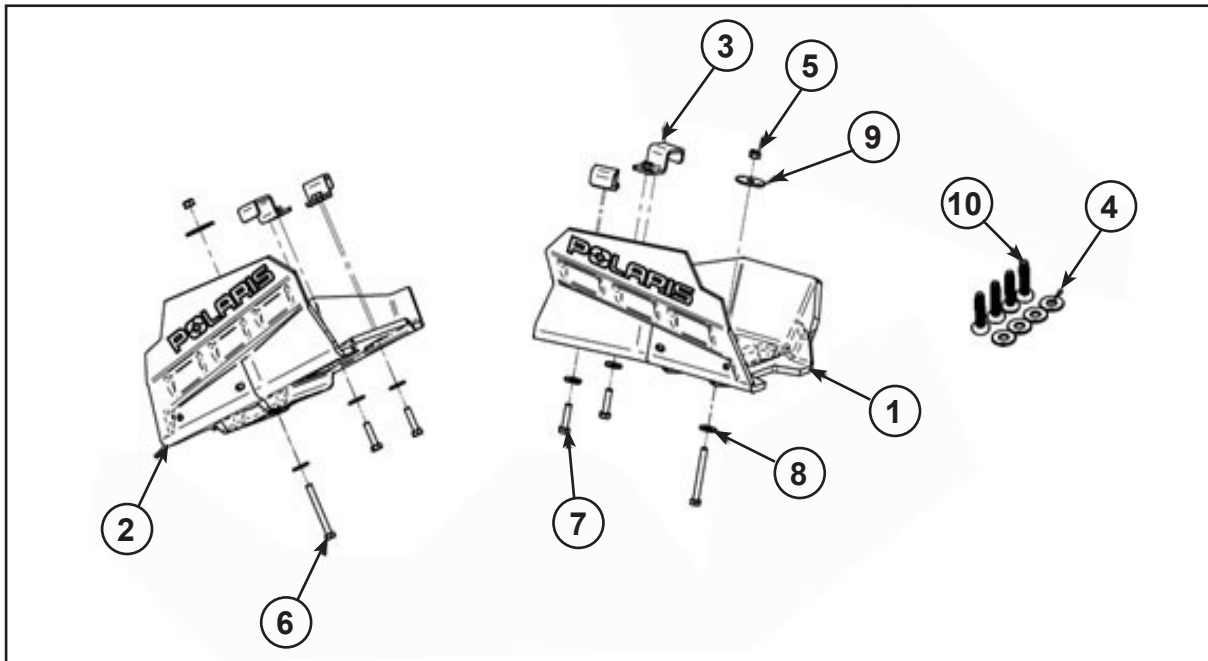

KIT CONTENTS

Ref	Description	Rear A-Arm Guard Kit (2880679)	Hardware Kit (2205716)
1	Rear A-Arm Guard, RH	1x	-
2	Rear A-Arm Guard, LH	1x	-
3	Tube Clamp	4x	4x
4	Flat Washer #10	4x	4x
5	Hexagonal Nylon Nut-M6 - 1.0	2x	2x
6	Hexagonal Bolt - M6 - 1.0 X 55	2x	2x
7	Hexagonal Bolt - M6 - 1.0 X 25	4x	4x
8	Flat Fender Washer-M6	6x	6x
9	Fender Washer 1/4 ID (9/32) X 1 1/4	2x	2x
10	Button Head Torx Thread Forming Screw #10-24 X 0.75"	4x	4x
	Instructions (PN 9925583)	1x	-

TOOLS NEEDED

Safety Goggles
T-25 Torx

Metric Wrench Set
Torx Wrench

Metric Socket Set

APPROXIMATE ASSEMBLY TIME

10 min

IMPORTANT

Your Polaris REAR A-ARM GUARD KIT is exclusively designed for your vehicle. Please read the installation instructions thoroughly before beginning. Installation is easier if the vehicle is clean and free of debris. For your safety, and to ensure a satisfactory installation, perform all installation steps correctly in the sequence shown.

INSTALLATION INSTRUCTIONS

1. Place the vehicle in “**PARK**”. Turn the key to “**OFF**” position and remove from the vehicle.
2. Remove the RH stock A-Arm guard (A) by removing two bolts (B) and washers (C).

NOTE: The stock hardware will not be reused when installing the A-Arm guards.

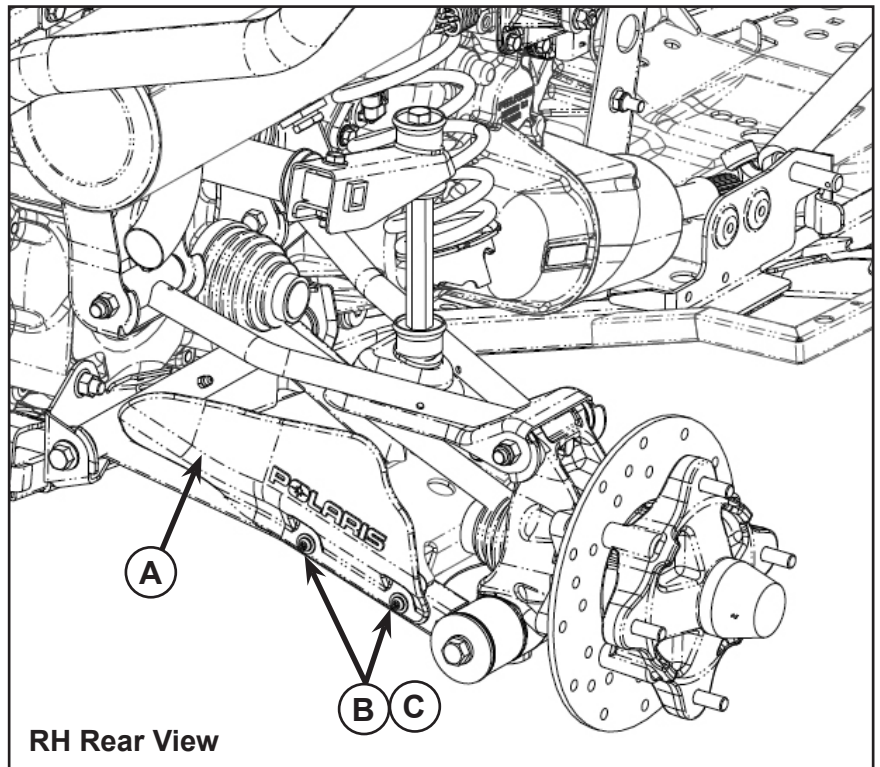

3. Install RH rear A-Arm guard (2) using two screws (10) and washers (4) and secure it with the tube using M6 bolt (6), nylon nut (5) and relevant washers (8 and 9).

4. Attach the rear A-Arm guard to the tube with two clamps (3) on top of the tube and secure with two bolts (7) and two washers (8) under the A-Arm guard as shown in figure.

5. Repeat the above steps for installing LH A-Arm guard (1).

6. Check all hardware to ensure the guards are securely fastened to the A-Arms.

NOTE: Torque all M6 bolts to 8 ft. lbs. (10.8 Nm) at this time. Tighten the #10 hardware until snug.

