

FRONT TIPOUT WINDSHIELD KIT

P/N 2879959

Application

RANGER 570 AND RANGER ETX

POLARIS

ENGINEERED PARTS
ACCESSORIES & APPAREL

Before you begin, read these instructions twice and check to be sure all parts and tools are accounted for. Please retain these installation instructions for future reference and parts ordering information.

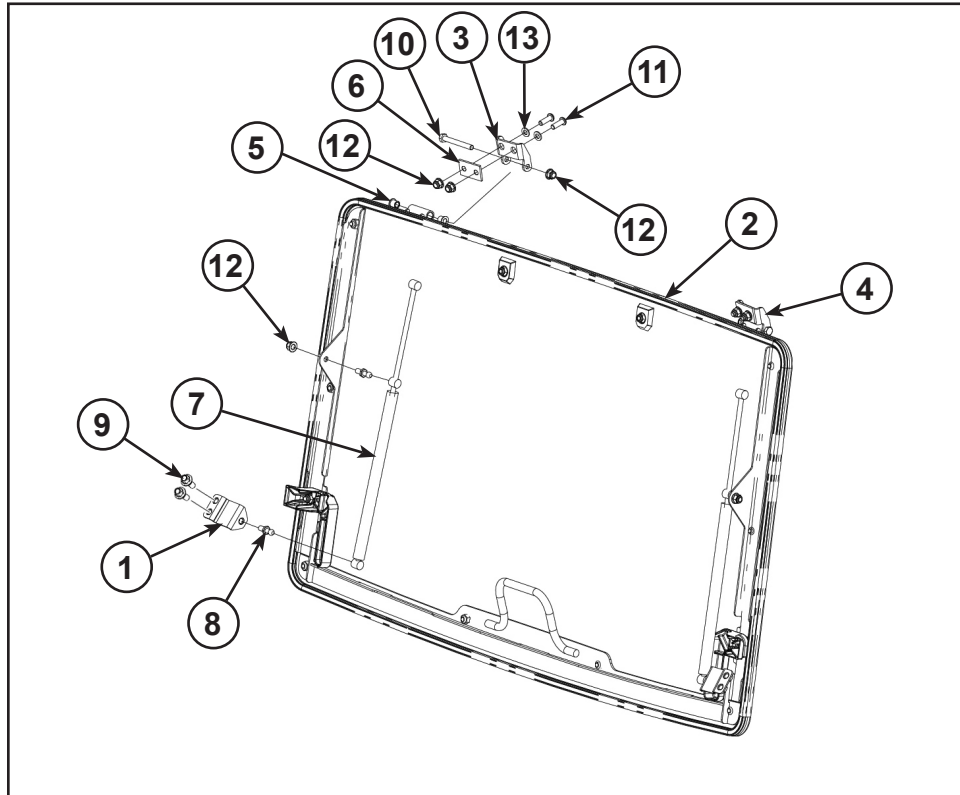

Kit Contents:

<u>Ref</u>	<u>Qty</u>	<u>Part Description</u>	<u>Part Number</u>
1	2	Lower Shock Mount, Windshield Tip Weldment	1020777
2	1	Tipout Polycarbonate Assembly, Base	2635357
3	1	Hinge Bracket, LH Tipout	5259767
4	1	Hinge Bracket, RH Tipout	5259768
5	4	Windshield Bushing, 12mm OD X 8mm ID	5451523
6	2	Grommet, Window Base Mount	5522061
7	2	Gas Shock, Tipout	7043889
8	4	End Ball, M8X1.25	7081839
9*	4	Screw-HXFL-M8X1.25 x 20 10.9 ZPB	7517838
10*	2	Screw-M8X1.25 x 70 8.8 HH ZOD	7518992
11*	4	Screw-TXBH-M8X1.25X25 8.8 ZPB	7519747
12*	8	Nut-HXFL-M8X1.25 8 ZB3 Nyloc	7547454
13*	4	Washer-8.4X16.0X1.6	7556043
	1	Instructions	9925115

Items marked (*) are included in Hardware Kit PN 2205482.

Tools Required:

Safety Glasses
Side Cutter

T-40 Torx Wrench
13 mm 7/16" Wrench

NOTE: This windshield is made of laminate safety glass and should be treated with care when installing and storing.

APPROXIMATE ASSEMBLY TIME: 30 minutes

IMPORTANT: Your Polaris FRONT TIPOUT WINDSHIELD KIT is exclusively designed for your vehicle. Please read the installation instructions thoroughly before beginning. Installation is easier if the vehicle is clean and free of debris. For your safety, and to ensure a satisfactory installation, perform all installation steps correctly in the sequence shown.

INSTALLATION INSTRUCTIONS:

1. Two people should work together to carefully remove windshield from box. The installation of this windshield kit is easier to accomplish with two people.
2. Remove dash cap by removing four plastic darts. Figure 1.

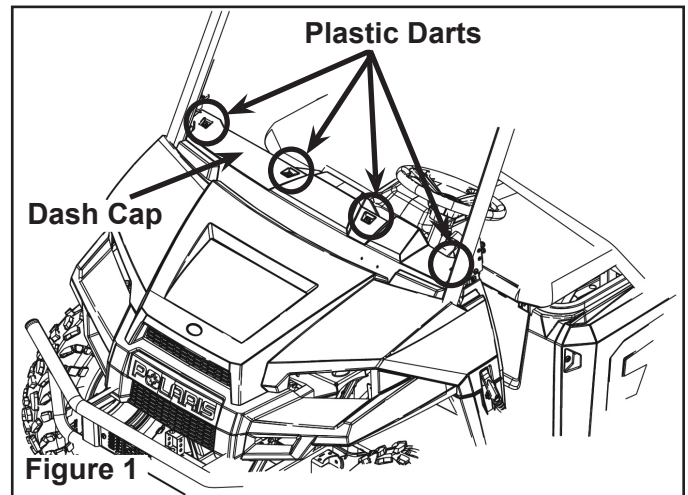

3. Install the hinges (PN 1018927 LH; PN 1018927 RH) onto the windshield. Figure 2.

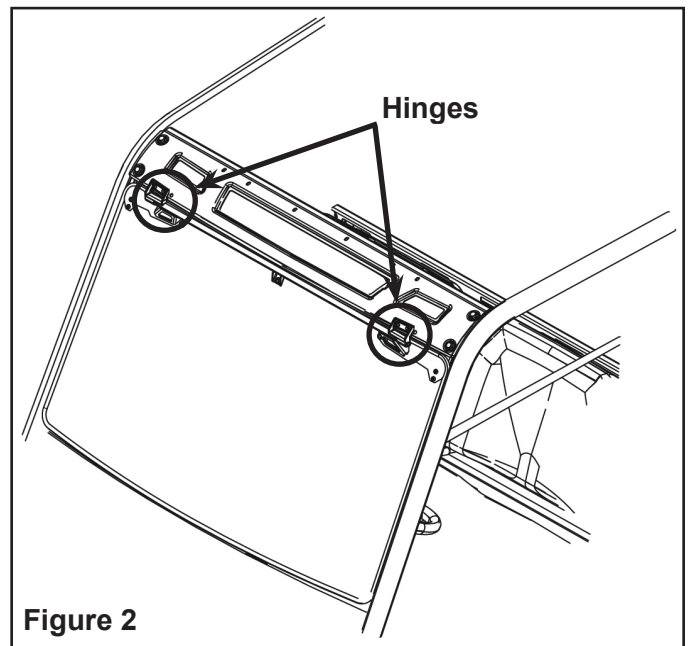

- Remove any roof you may have installed on your vehicle. Set the windshield in place. Figure 3.

NOTE: It is recommended for the ease of installation that two people lift the windshield into place.

- Install bolts through windshield hinges and grommet (PN 5522061) to holes provided on vehicle frame. To allow for adjustments, snug just one bolt each side. Open and close the windshield a couple of time to make sure it is centered on vehicle. Once this is accomplished, torque bolts to 20 ft. lbs. (27 Nm). Figure 3.

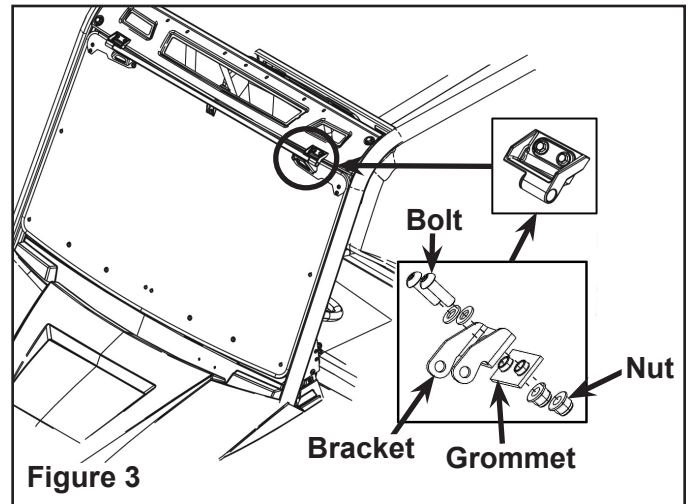

- Install ball studs to the frame mount on each side. Torque to 12 ft. lbs. (16.2 Nm). Figure 4.

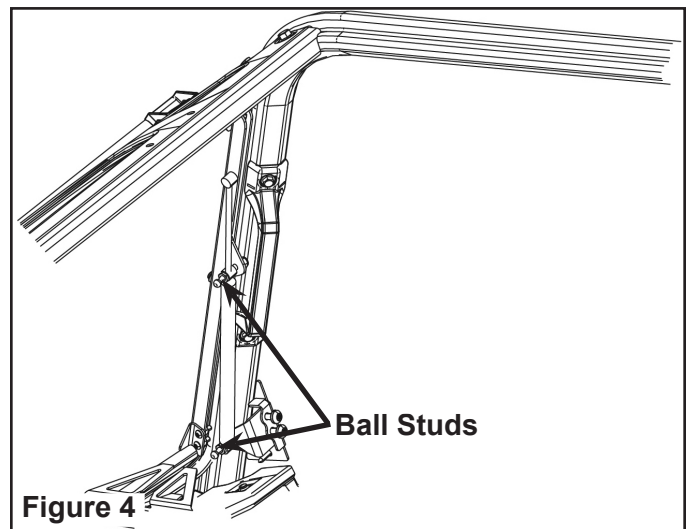

- Slip shocks onto ball studs on the vehicle and the windshield.

IMPORTANT: Orient shock correctly with the shock body (thick part of shock) at the bottom with the shock rod at the top attached to the ball studs. Figure 5.

- Reinstall dash cap.

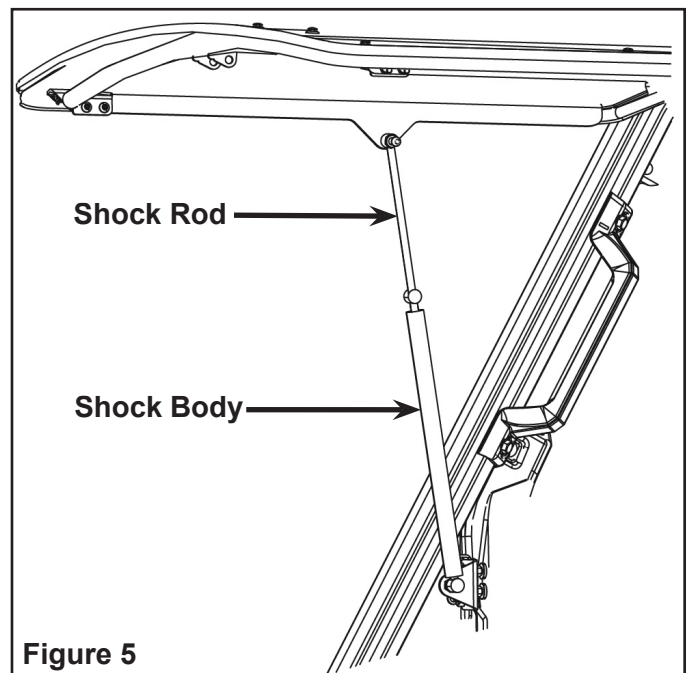

IMPORTANT: Only move the windshield with the tip out handle. If you grab or push out the windshield glass to open and close, you could cause damage to the windshield. Figure 6.

