

# PERFORMANCE AIR FILTER KIT



**P/N 2881063, 2882233**

## APPLICATION

Verify accessory fitment at [Polaris.com](http://Polaris.com).

## BEFORE YOU BEGIN

Read these instructions and check to be sure all parts and tools are accounted for. Please retain these installation instructions for future reference and parts ordering information.

## KIT CONTENTS

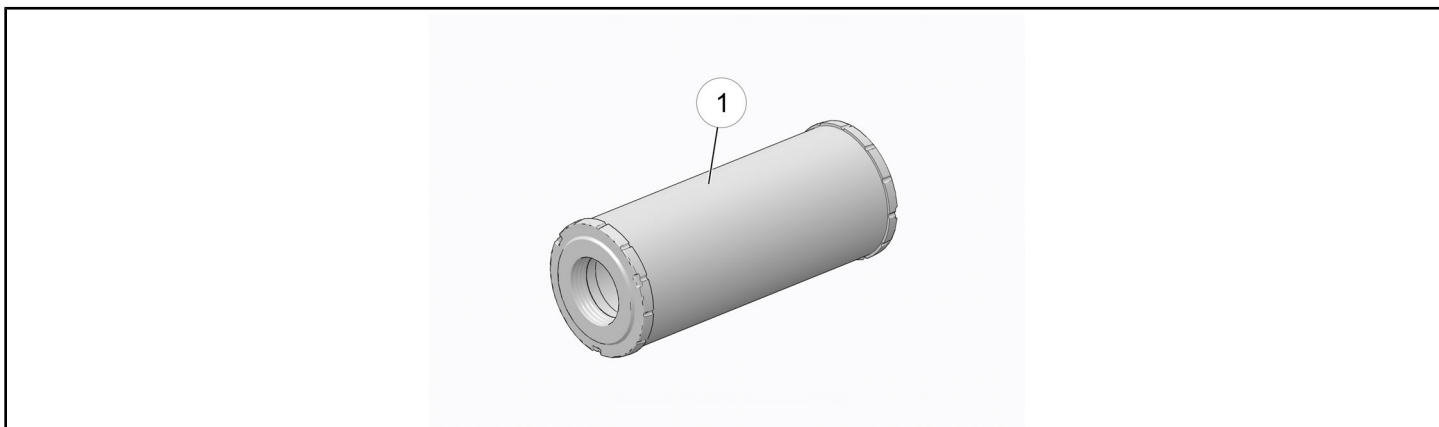

REF	QTY	PART DESCRIPTION	PART NUMBER
1	1	Filter, Performance Air	-
	1	Instructions	9926088

## APPROXIMATE ASSEMBLY TIME

5 minutes

## IMPORTANT

Your PERFORMANCE AIR FILTER KIT is exclusively designed for your vehicle. Please read the installation instructions thoroughly before beginning. Installation is easier if the vehicle is clean and free of debris. For your safety, and to ensure a satisfactory installation, perform all installation steps correctly in the sequence shown.

## INSTALLATION INSTRUCTIONS

1. Shift vehicle transmission into "PARK". Turn key to "OFF" position and remove from vehicle.
2. Remove access panel (A) from cargo bed by lifting latch (B) as shown.

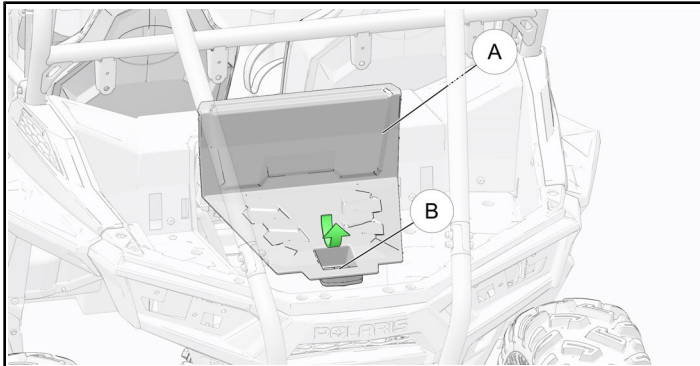

3. Clean dirt and debris from around air box as required.
4. Unlatch two air box cover straps (C) as shown, then remove air box cover (D).

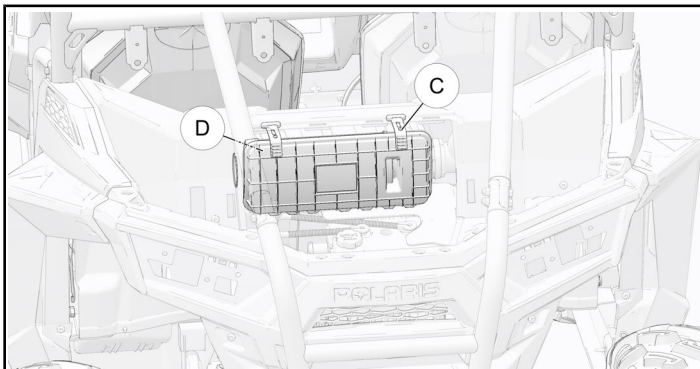

5. Inspect air box and filter for dirt, debris, or water.
6. Remove old filter (E) by sliding it towards passenger side of vehicle as shown.

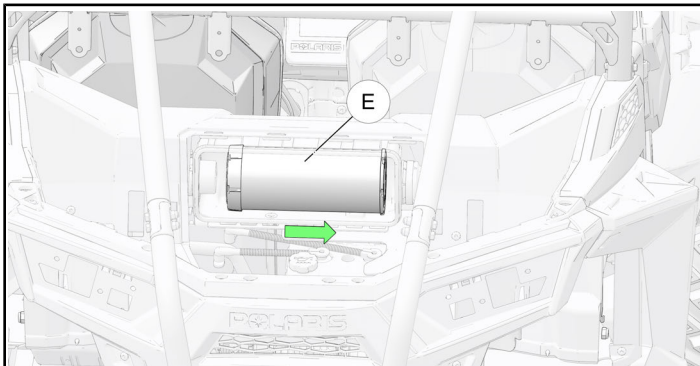

### CAUTION

Engine ingestion of dirt or debris can result in severe engine damage! Ensure all dirt and debris is removed prior to installing air filter.

7. With filter removed, thoroughly clean intake tube and air box. Wipe with clean, dry cloth.
8. Install new filter (1) by sliding it towards driver side of vehicle as shown. Ensure filter is fully seated against stop on intake tube.

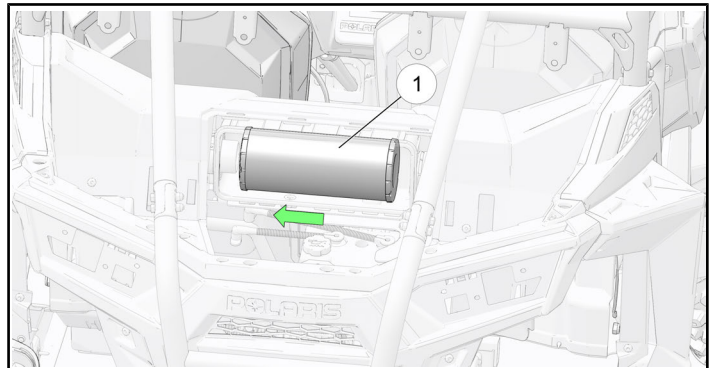

9. Reinstall air box cover (D), ensuring tabs on lower edge of cover properly engage air box, then latch two cover straps (C).
10. Reinstall bed box access cover (A).