

# REAR RACK KIT



**P/N 2882322**

## APPLICATION

Verify accessory fitment at [Polaris.com](http://Polaris.com).

## BEFORE YOU BEGIN

Read these instructions and check to be sure all parts and tools are accounted for. Please retain these installation instructions for future reference and parts ordering information.

## KIT CONTENTS

This Kit includes:

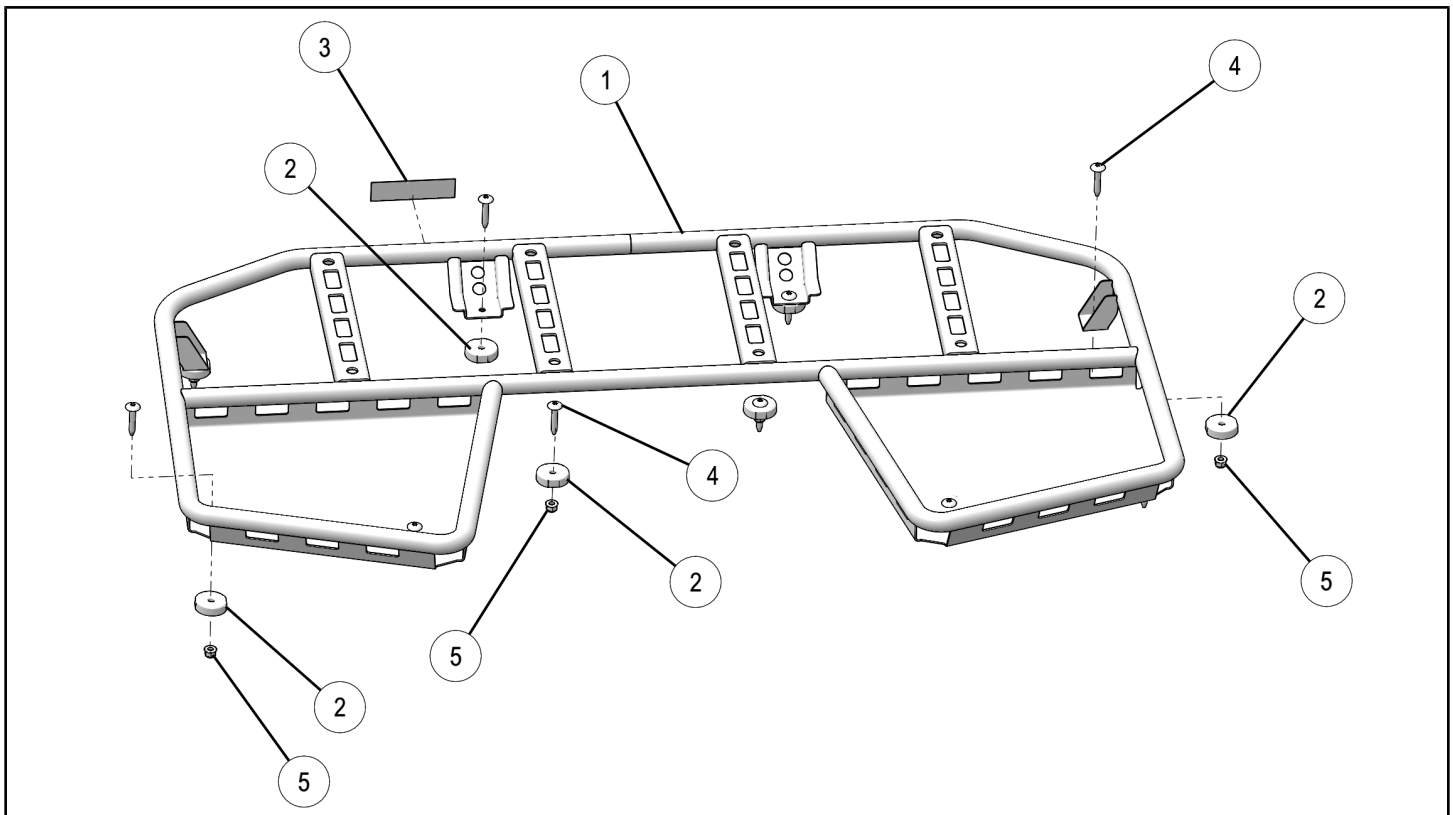

REF	QTY	PART DESCRIPTION	PART NUMBER
1	1	Rear Rack, Welded	1022512
2	10	Spacer	5453519
3	1	Warning Decal	7172572
4	10	Torx® Screw, 1/4-20 X 1.50	7518375
5	8	Nut, 1/4-20	7542153
	1	Instructions	9927757

## TOOLS REQUIRED

- Safety Glasses
- Torx® Drivers
- Standard Wrench Set

## IMPORTANT

Your REAR RACK KIT is exclusively designed for your vehicle. Please read the installation instructions thoroughly before beginning. Installation is easier if the vehicle is clean and free of debris. For your safety, and to ensure a satisfactory installation, perform all installation steps correctly in the sequence shown.

## ASSEMBLY TIME

Approximately 15 minutes

## INSTALLATION INSTRUCTIONS

1. Shift vehicle transmission into "PARK". Turn key to "OFF" position and remove from vehicle.
2. Remove two screws (A) (out of ten) holding rear rack (B) on rear cab frame as shown.
4. Remove rear rack (B) along with the support tube (E) by removing eight screws (A) as shown.

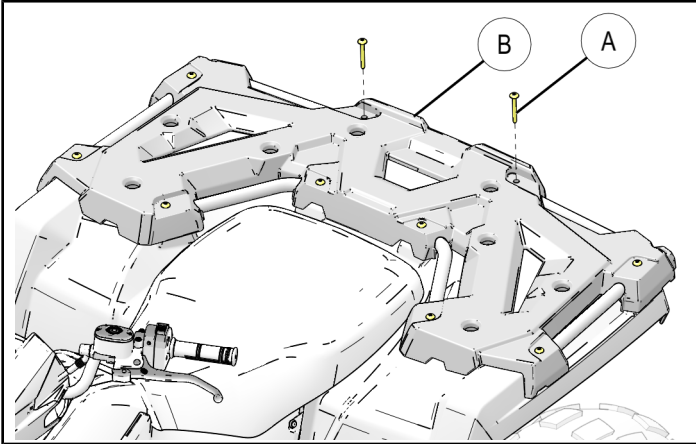

3. For remaining eight screws (A), remove nuts (C) from underside of the rear cab frame (D) on both sides.

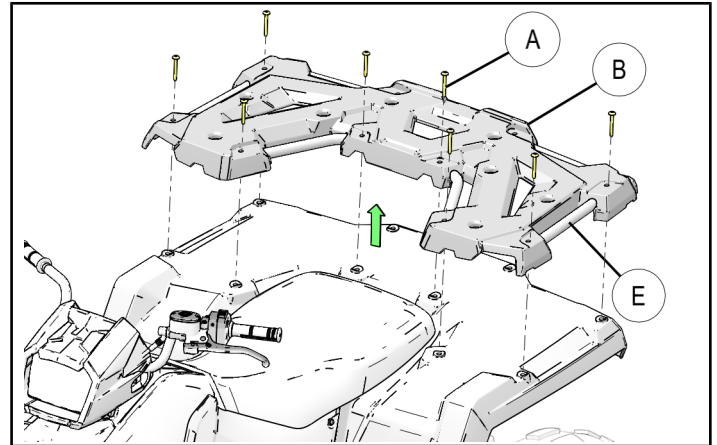
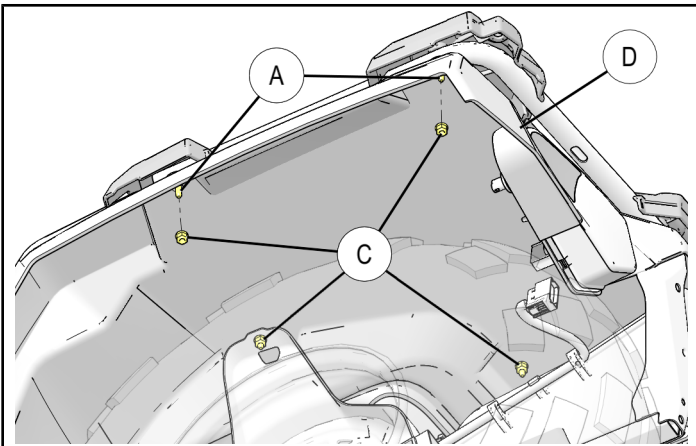

5. Install spacers (2) on rear cab frame (D) at ten locations as shown.

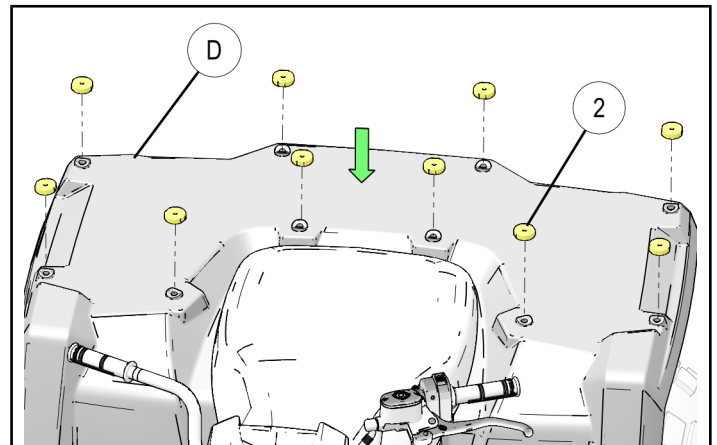

6. Install two screws ④ onto the front spacers. Install nuts ⑤ onto these screws from underside of rear cab frame (D) as shown. Tighten nuts until snug.

#### NOTE

Two screws ④ and spacers shown below do not attach to the rack, but are used to cover the holes exposed by removal of the plastic rack (B). The remaining spacers are all in direct contact with the rack.

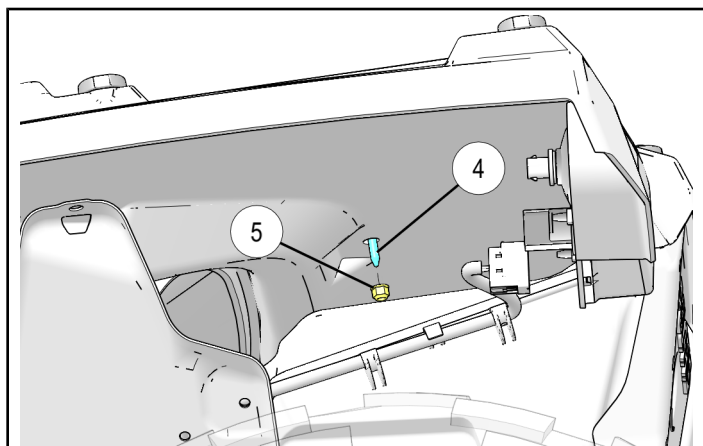
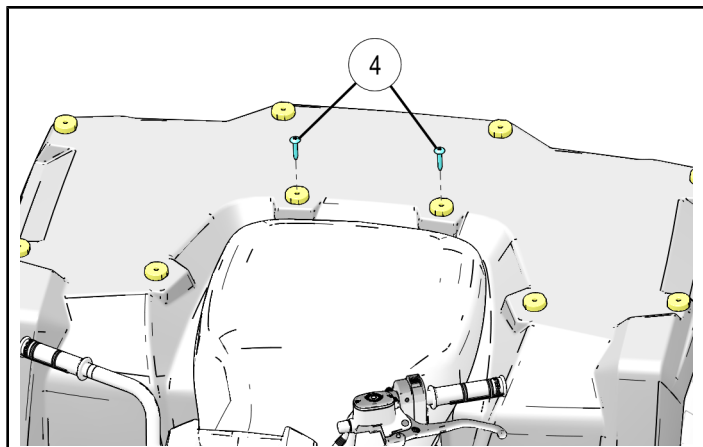

7. Mount rear rack ① onto the installed spacers ② as shown. Ensure the hole locations on rear rack align with holes on spacers.

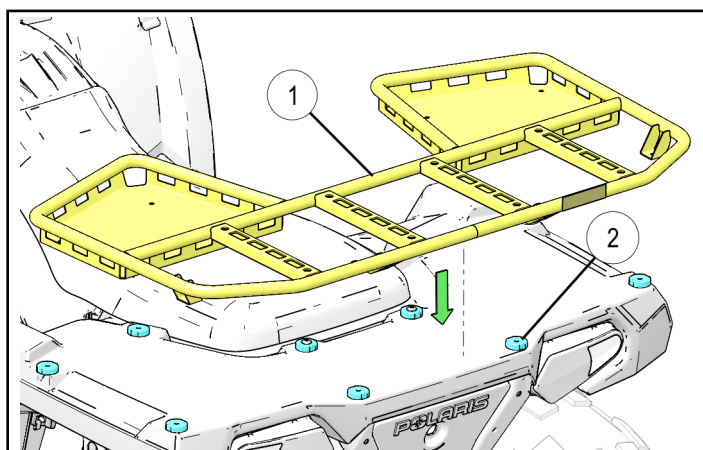

8. Install eight screws ④ onto rear rack ① passing through spacers ② and rear cab frame (D).

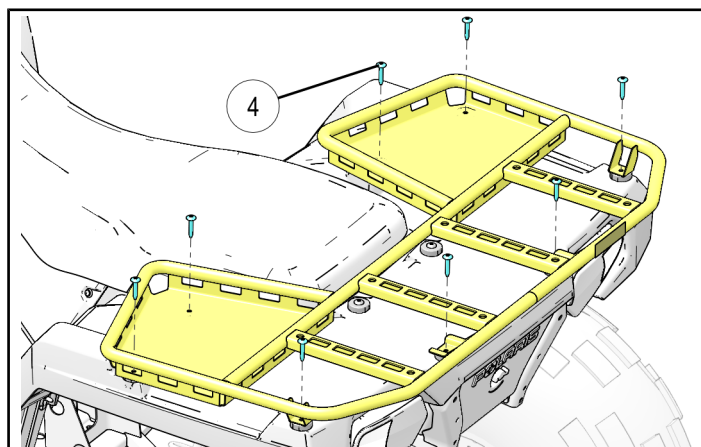

9. Install nuts ⑤ onto screws ④ from underside of rear cab frame (D) on both sides of vehicle.

