

SPORTSMAN CARGO BOX BACKREST KIT



P/N 2876367

APPLICATION

Sportsman Rear Cargo Box (PN 2875176)

BEFORE YOU BEGIN

Read these instructions and check to be sure all parts and tools are accounted for. Please retain these installation instructions for future reference and parts ordering information.

KIT CONTENTS

This Kit includes:

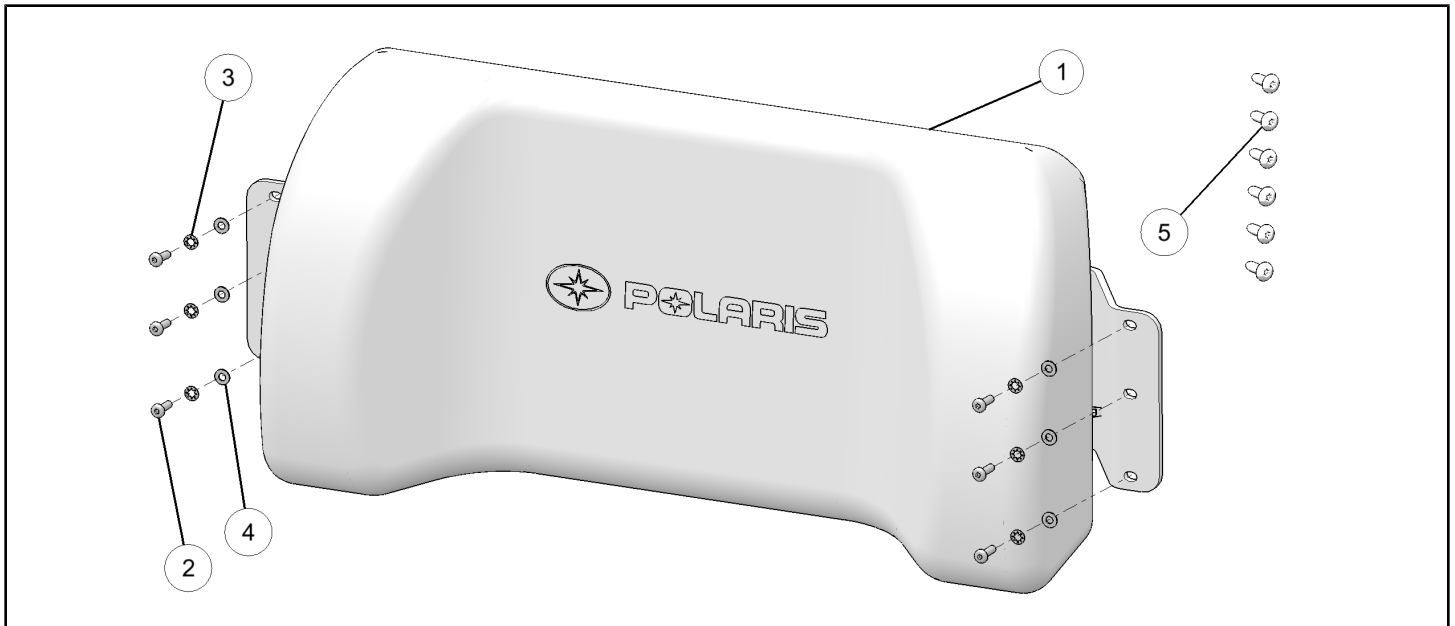

REF	QTY	PART DESCRIPTION	PART NUMBER
1	1	Backrest	-
2	6	#10 X 3/4" Allen Socket Machine Screw	-
3	6	#10 Internal Tooth Lock Washer	-
4	6	#10 Flat Washer	-
5	6	Self Tapping Plastic Screws	7519045
	1	Instructions	9926839

TOOLS REQUIRED

- 5/32" Allen Key
- T25 Torx Driver

IMPORTANT

Your SPORTSMAN CARGO BOX BACKREST KIT is exclusively designed for your vehicle. Please read the installation instructions thoroughly before beginning. Installation is easier if the vehicle is clean and free of debris. For your safety, and to ensure a satisfactory installation, perform all installation steps correctly in the sequence shown.

ASSEMBLY TIME

Approximately 15 minutes

INSTALLATION INSTRUCTIONS

1. Remove six plastic caps (three on each side) to box as shown.
2. If your box has metal nutserts molded into box, position and fasten backrest ① onto plastic box using six Allen socket machine screws ②, six internal tooth lock washers ③, and six flat washers ④.

If your box does not have metal nutserts molded into box, position backrest so that brackets on either side are located just below hinges. Attach backrest to box using six self-tapping plastic screws ⑥, being careful only to tighten until bracket is snug to box.

NOTE

While positioning backrest, ensure that center of bottom hole/screw need to be at 2.5" height from base plastic box.

