

# POLY TIP-DOWN WINDSHIELD KIT



**P/N 2882178**

## APPLICATION

Verify accessory fitment at [Polaris.com](http://Polaris.com).

## BEFORE YOU BEGIN

Read these instructions and check to be sure all parts and tools are accounted for. Please retain these installation instructions for future reference and parts ordering information.

## KIT CONTENTS

This Kit includes:

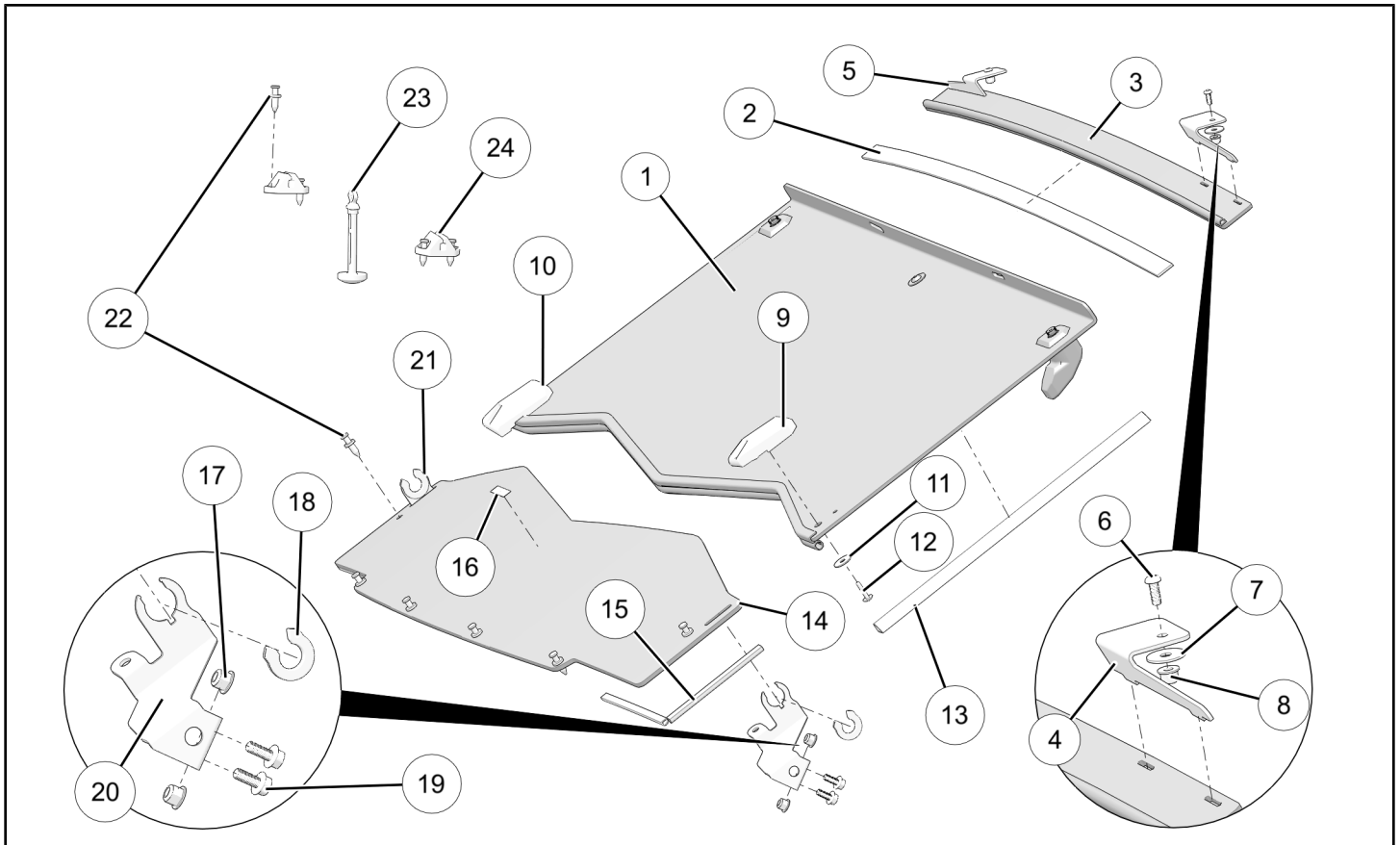

REF	QTY	PART DESCRIPTION	PART NUMBER
1	1	Windshield, Upper	-
2*	-	Tape, Foam - 1/8 in X 1 in X 3.75 ft	-
3	1	Visor Panel	-
4	1	Bracket, Visor Panel, LH	-
5	1	Bracket, Visor Panel, RH	-
6*	2	Screw, Socket Head Cap - M6 X 1.0 X 16	-
7*	2	Washer, Fender - 1/4	-
8*	2	Nut, Hex Flange - M6 X 1.0	-

REF	QTY	PART DESCRIPTION	PART NUMBER
9*	1	Hinge, LH	-
10*	1	Hinge, RH	-
11	2	Washer, Fender - 1/4	-
12*	2	Screw, Torx® - 10-12 X 3/4	-
13*	-	D-seal, Wide (3.3 ft; cut as required)	-
14	1	Windshield, Lower	-
15*	-	D-seal, Narrow (2.5 ft; cut as required)	-
16	1	Tape, Wear Protection	-
17*	4	Nut, Hex Flange - M8 X 1.25	-
18*	2	Insert, Bracket	-
19*	4	Screw, Hex Flange - M8 X 1.25 X 20	-
20	1	Bracket, LH	-
21	1	Bracket, RH	-
22*	10	Rivet, Push Pin	-
23*	1	Strap, Latch	-
24*	2	Slot Clamp, Rubber	-
	1		9927340

Items marked (\*) are included in Hardware Kit PN 2206449.

## TOOLS REQUIRED

- Safety Glasses
- Drill
- Drill Bit: 1/8 inch, 5/16 inch, 1/2 inch
- Pliers, Push Pin
- Socket Set, Metric
- Wrench Set, Metric
- Utility Knife/Cutting Tool

## IMPORTANT

Your Poly Tip-Down Windshield Kit is exclusively designed for your vehicle. Please read the installation instructions thoroughly before beginning. Installation is easier if the vehicle is clean and free of debris. For your safety, and to ensure a satisfactory installation, perform all installation steps correctly in the sequence shown.

## ASSEMBLY TIME

Approximately 60 minutes

## INSTALLATION INSTRUCTIONS

1. Shift vehicle transmission into "PARK". Turn key to "OFF" position and remove from vehicle.
2. Vehicle preparation.
  - a. Remove roof (if installed).
  - b. Ensure vehicle ROPS is at room temperature ( $\geq 68^{\circ}$  F) for proper application of D-seals ⑬ and ⑮, and foam tape ②.

- c. Clean ROPS and upper dash panel as shown. Wipe dry.

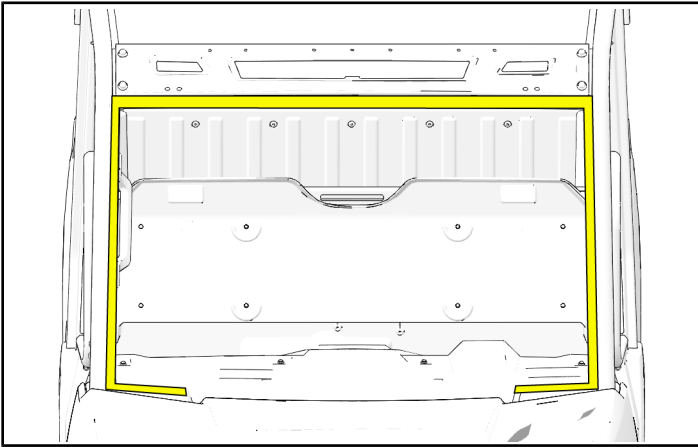

3. Install visor panel.

- a. Peel backing from foam tape ② and apply to visor flange as shown. Trim tape as required.

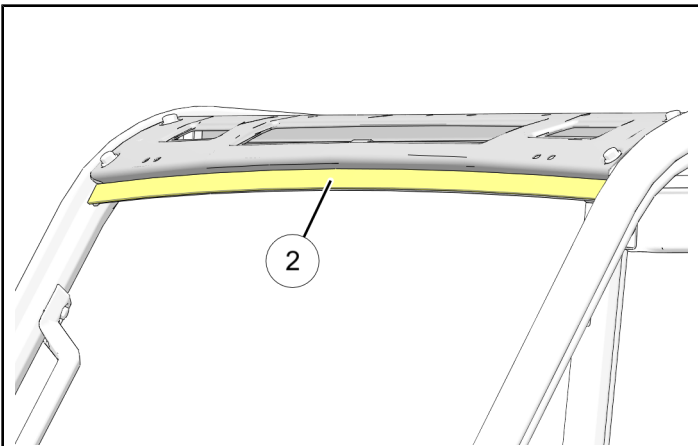

- b. Install visor panel ③ to ROPS visor using brackets ④, ⑤, and two each screws ⑥, washers ⑦, and nuts ⑧ as shown. Ensure seal is oriented on upper side of panel. Firmly press center of panel against ROPS visor, then tighten screws. Torque to specification.

### TORQUE

50–60 in. lbs (5.6–6.8 Nm)

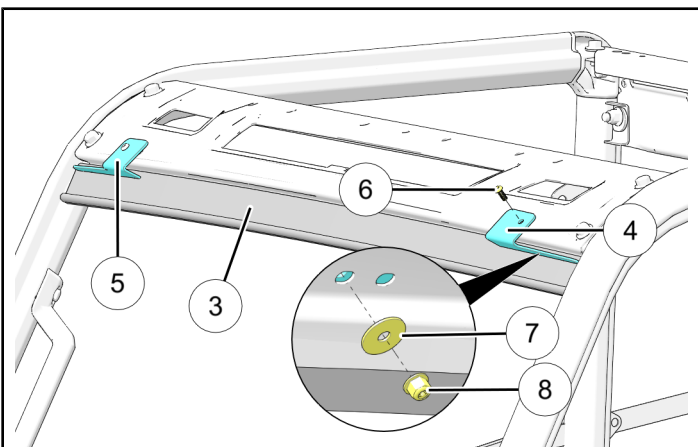

4. Install lower windshield.

- a. Install LH bracket ⑳ to interior of door striker bracket using two each screws ⑲ and nuts ⑰ as shown. Repeat for opposite side using RH bracket ㉑.

If door striker is installed, then temporarily remove striker and reinstall together with windshield bracket.

### NOTE

LH side shown; RH side opposite.

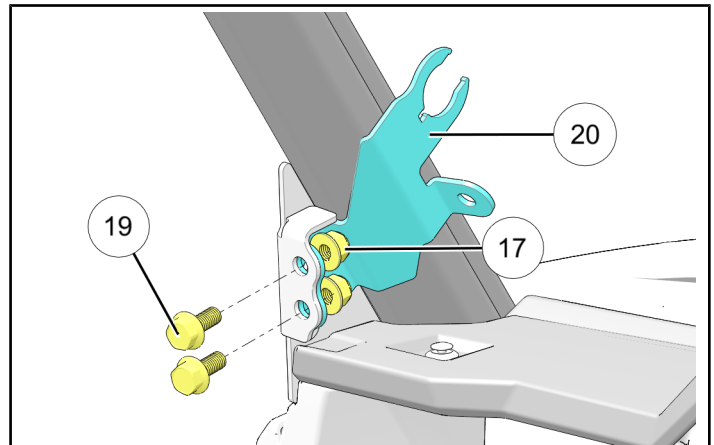

- b. Temporarily slide lower windshield ⑭ over brackets ⑳ and ㉑ and position against ROPS, aligning push pin attach holes.

Note location of windshield edges on upper dash and A-pillars, then remove windshield.

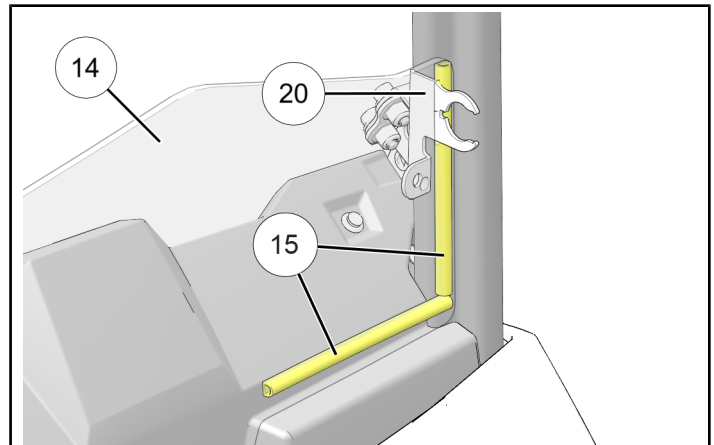

- c. Peel off backing and apply **narrow** D-seal ⑮ to upper dash and A-pillars as previously shown, ensuring lower and side edges of windshield ⑭ will adequately contact D-seal as noted in previous step. Also ensure outboard end of horizontal D-seal is secured to A-pillar. Cut/trim seal as required. Repeat for opposite side.

- d. Install lower windshield ⑭ to brackets ⑳ and ㉑ using two push pin rivets ㉒ as shown.

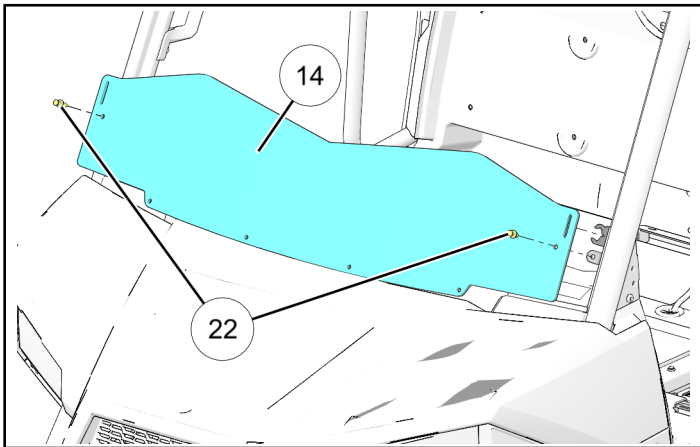

- e. Using lower windshield ⑭ as template, mark and drill four 5/16 inch holes through upper dash panel. Starting from middle of windshield, secure using four push pin rivets ㉒ as shown.

### IMPORTANT

Control drill depth to prevent damage to underlying structure or components.

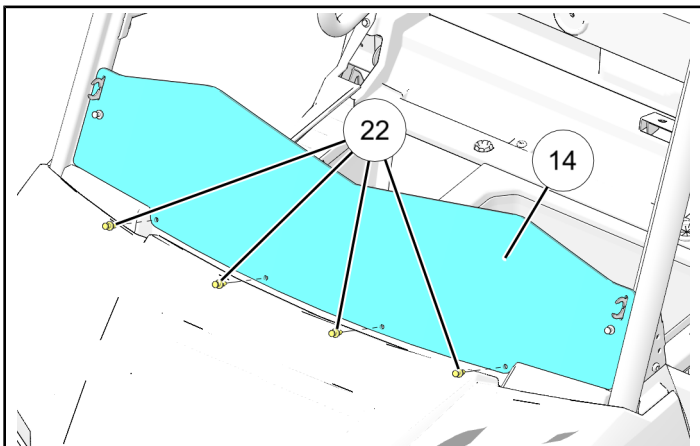

5. Install bracket insert ⑱ to brackets ⑳ and ㉑ as shown.

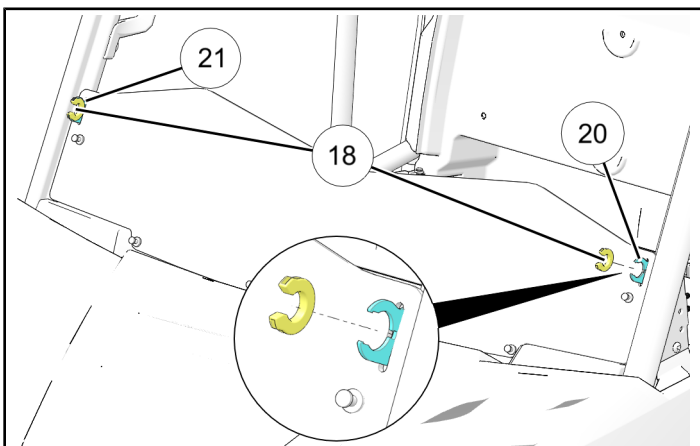

6. Install upper windshield.

- a. Cut wide D-seal ⑬ in half, peel off backing, then apply to LH and RH A-pillars between visor panel ③ and lower windshield ⑭ as shown. Trim as required.

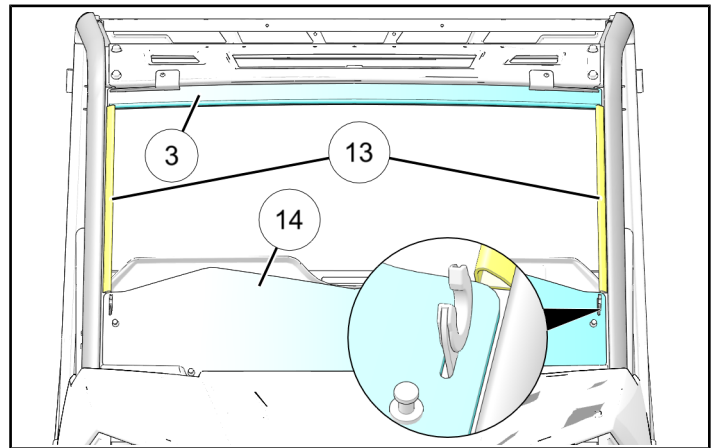

- b. Position upper windshield ① as shown, then insert into hinge assemblies.

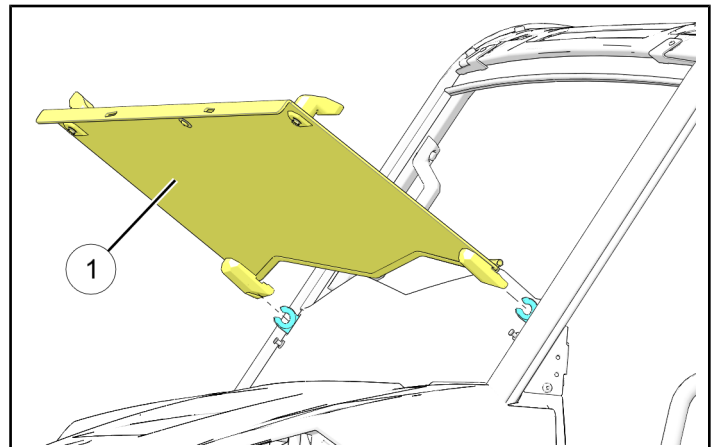

- c. Tip upper windshield ① up as shown, then rotate both handles ① A 1/4 turn to lock windshield to A-pillars. Adjust brackets ⑳ and ㉑ as required to ensure windshield is centered in ROPS opening.

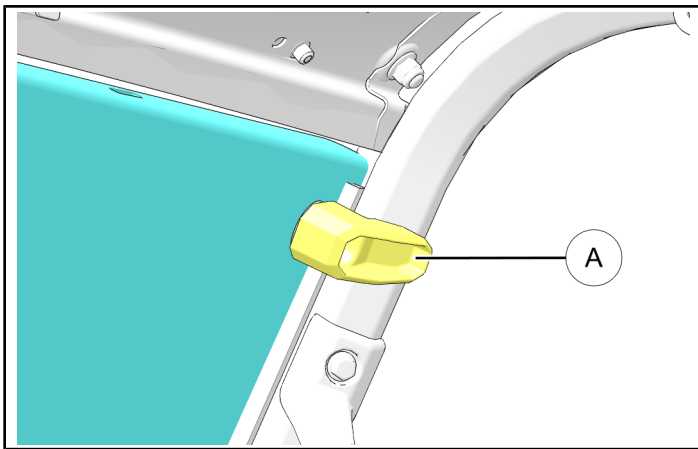
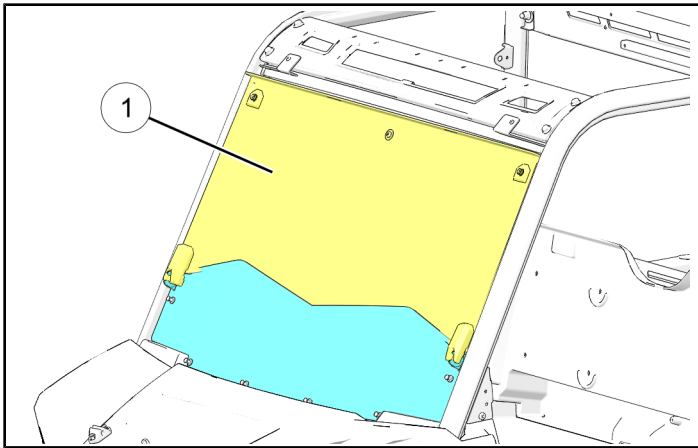

7. Install slot clamps to hood.

- a. Install two slot clamps ㉔ to slots in upper windshield ①, then tip windshield down, gently laying clamps flat against hood as shown.

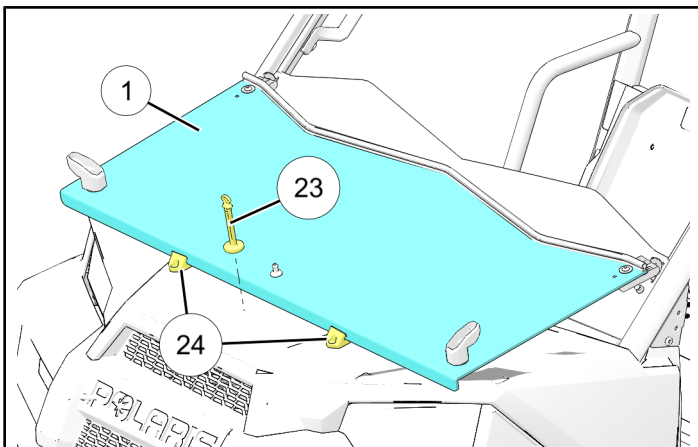

- b. Using slot clamps ㉔ as template, mark four fastener holes on hood as previously shown. Also, mark hole in center of hood, 1/2 inch forward of windshield, for latch strap ㉓ as shown.
- c. Open hood.
- d. Carefully drill four 5/16 inch holes through hood at marked clamp fastener locations, and one 1/2 inch hole at marked latch strap location.

**TIP**

Drill 1/8 inch pilot holes first, verify hole locations, then upsize to final dimension.

- e. Push latch strap ㉔ up through 1/2 inch hole.

**NOTE**

Keeper flange on top of strap will prevent it from falling through hole when not in use.

- f. Close and secure hood.
- g. Install two slot clamps ㉔ to hood using four push pin rivets ㉒ as shown.

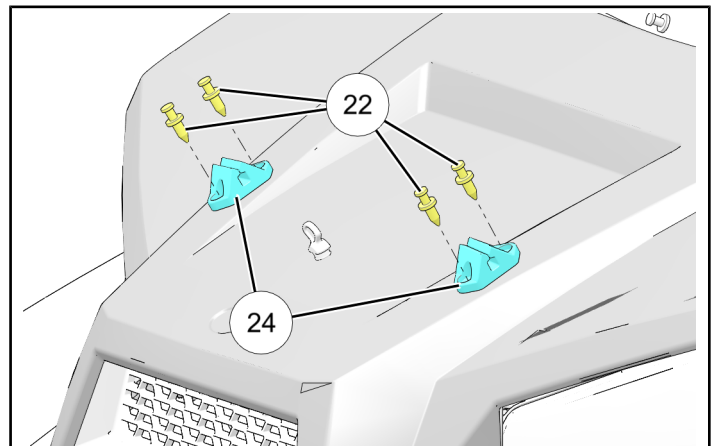

8. Apply wear protection tape.
  - a. Tip upper windshield ① down, fully engaging slot clamps ②④, and note location where upper windshield contacts lower windshield ⑬ (at vehicle centerline).

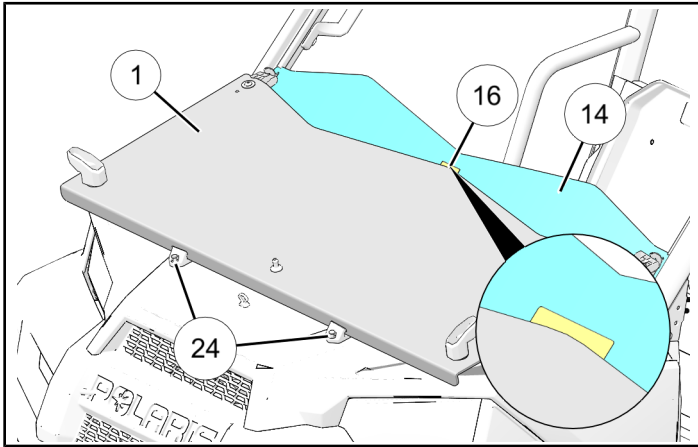

- b. Clean noted location on lower windshield and wipe dry.
    - c. Peel adhesive backing from wear protection tape ⑬ and firmly apply to lower windshield at noted location.
9. Reinstall roof (if previously removed).

**⚠ WARNING**

If vehicle is trailered FACING FORWARD, windshield must be CLOSED (upright) and LOCKED to upper ROPS. Failure to close and lock windshield may allow airflow to separate windshield from vehicle, resulting in an accident and severe injury or death.

Do NOT trailer vehicle FACING REARWARD with windshield installed. Airflow may cause windshield to separate from vehicle, resulting in an accident and severe injury or death. Remove windshield or transport vehicle in enclosed trailer.