

P/N 2882714, 2882715

BEFORE YOU BEGIN

Read these instructions and check to be sure all parts and tools are accounted for. Please retain these installation instructions for future reference and parts ordering information.

APPLICATION

Verify accessory fitment at www.polaris.com.

KIT CONTENTS

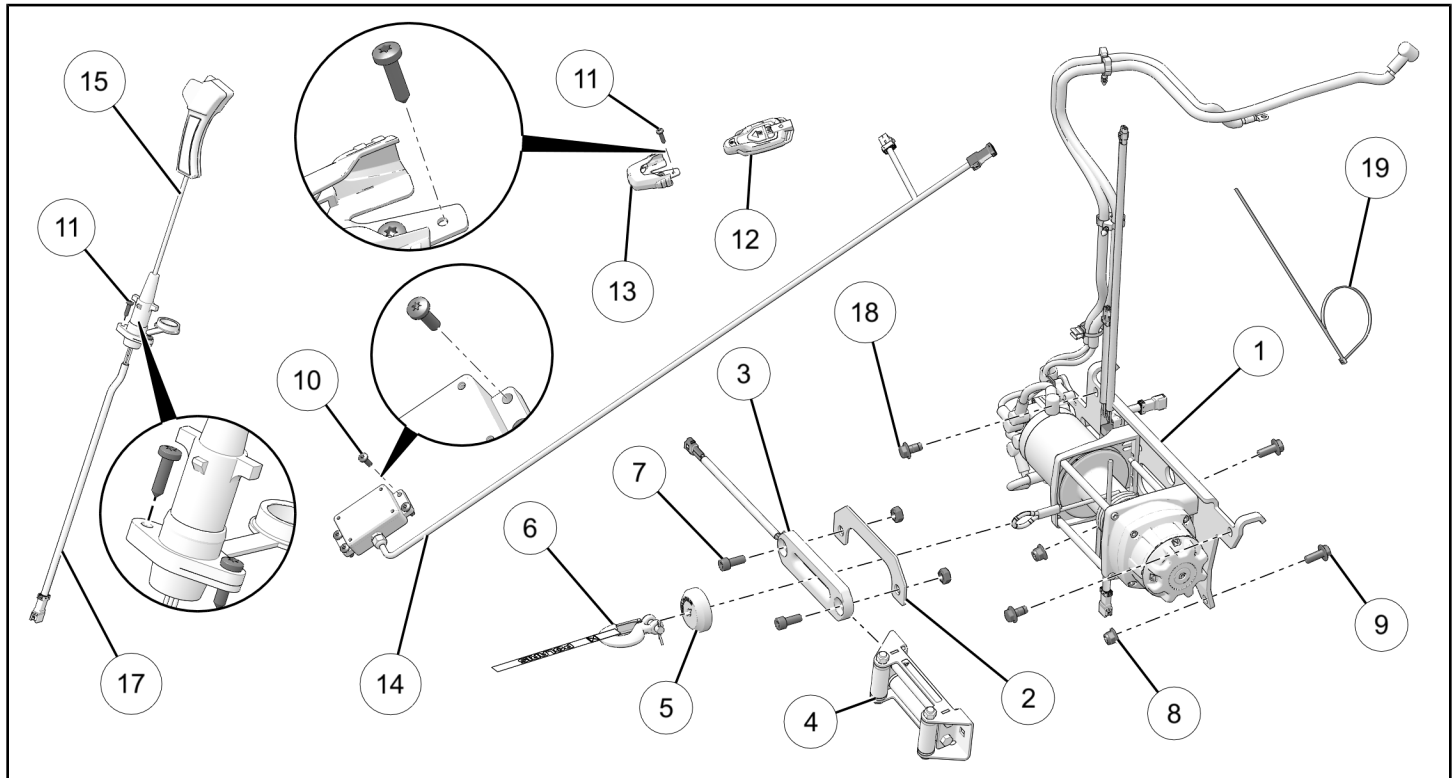

REF	QTY	PART DESCRIPTION	P/N AVAILABLE SEPARATELY	AVAILABLE SERVICE KIT
1	-	Winch Assembly (includes items 1.1 through 1.7, unless otherwise noted) Winch, Assembly (includes items 1.1 through 1.7, unless otherwise noted)	2636677 2638179	n/a n/a
1.1	1	- Winch, Motor Assembly 4500 lb (includes item 1.1.1.)	n/a	2204856
1.1.1	1	-- Handle, Gear Selector, Single Speed	n/a	2205265
1.2	1	- Contactor	4015600	n/a
1.3	1	- Cable, Contactor to Terminal Block	4017112	n/a
1.4	-	(unused)	-	-
1.5	1	- Rope (Kit 2882715 only)	2879187	n/a

REF	QTY	PART DESCRIPTION	P/N AVAILABLE SEPARATELY	AVAILABLE SERVICE KIT
1.6	1	- Cable, Steel, 7/32 inch (Kit 2882714 only)	2878899	n/a
1.7	1	- Controller, Autostop (Kit 2882715 only)	2415484	2884702
2	1	Plate, Fairlead Backer	1023559	n/a
3	1	Fairlead, Autostop (Kit 2882715 only)	51403584	2884702
4	1	Fairlead (Kit 2882714 only)	2411847	n/a
5	1	Stop, Magnetic (Kit 2882715 only)	5415787	2884702
6	1	Hook	2411836	n/a
7	2	Screw, Socket Cap - M10 x 1.5 x 25	7517358	2207258
8	2	Nut, Hex Flange, Locking - M10 x 1.5	7547423	2207258
9	2	Screw, Hex Flange - M10 x 1.5 x 25	7519071	2207258
10	4	Screw, Torx® Pan Head, High/Low - #14 x 0.75 (Kit 2282715 only)	7519731	2883455
11	2	Screw, Torx® Pan Head, High/Low - #10 x 0.75	7512026	2883455
12	1	Remote, Wireless (Kit 2882715 only)	n/a	2883455
13	1	Holder, Wireless Remote (Kit 2882715 only)	n/a	2883455
14	1	Receiver, Wireless (Kit 2882715 only)	n/a	2883455
15	1	Remote, Wired (Kit 2882714 only)	4013466	n/a
16	-	(unused)	-	-
17	1	Socket, Wired Remote (Kit 2882714 only)	4017102	n/a
18	1	Screw, Hex Flange with Locking Patch - M10 x 1.5 x 20	7519905	2207258
19	10	Cable Tie	7080492	2207258
	1	Winch Guide	9923644	n/a

HARNESS DETAIL

WINCH HARNESS @ (KITS 2882715):

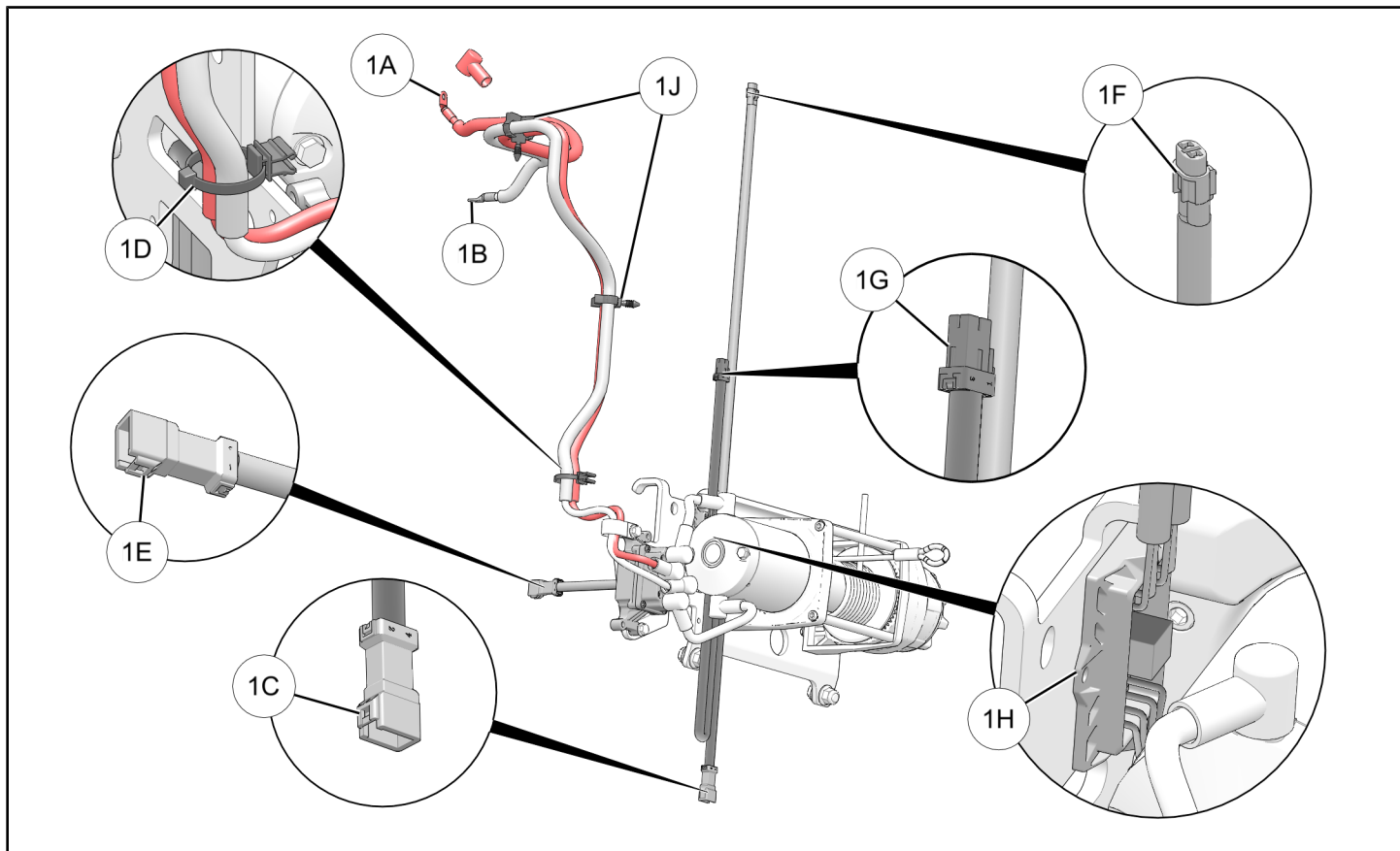

REF	PART DESCRIPTION	WIRE COLOR	PIN QTY/ GENDER	CONNECTS TO
1A	Ring Terminal, 45 degree (with cap) - 1/4 inch (6 mm)	Red	-	Terminal block, battery positive (+)
1B	Ring Terminal - 1/4 inch (6 mm)	Black	-	Chassis ground / battery negative (-)
1C	Connector, Winch Controller/ Contactor	-	4 male	Main vehicle harness breakout; see instructions for detail
1D	Clip, Edge	-	-	Vehicle structure
1E	Connector, Winch Controller/ Contactor	-	4 male	PRE-CONNECTED to 1G
1F	Connector, Autostop Fairlead	-	2 female	See instructions for detail
1G	Connector, Winch Controller/ Contactor	-	4 female	PRE-CONNECTED to 1E
1H	Autostop Controller; shown for reference only	-	-	-
1J	Clip, Routing	-	-	Vehicle structure

WINCH HARNESS ① (Kit 2882714 only):

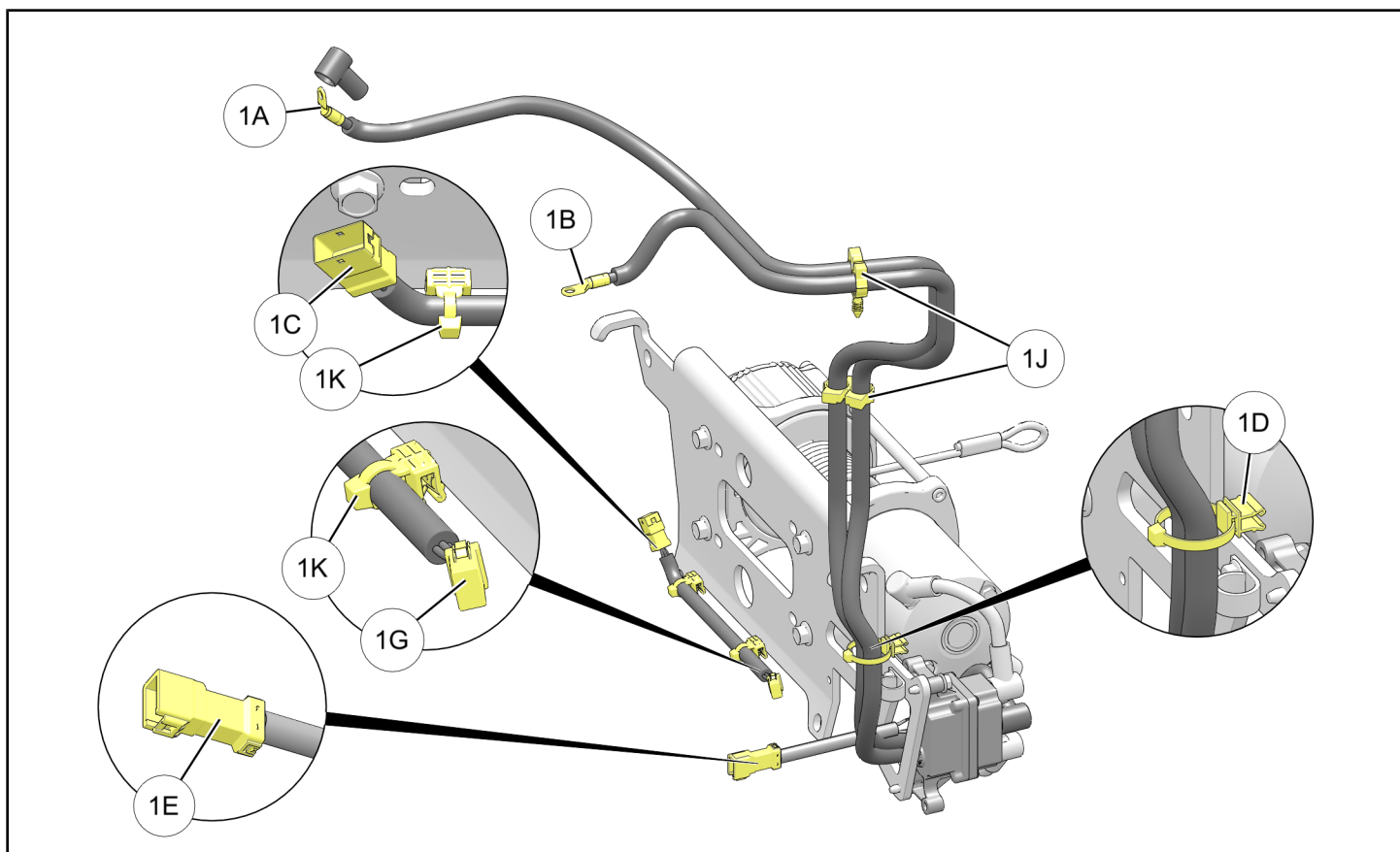

REF	PART DESCRIPTION	WIRE COLOR	PIN QTY/ GENDER	CONNECTS TO
1A	Ring Terminal, 45 degree (with cap) - 1/4 inch (6 mm)	Red	-	Terminal block, battery positive (+)
1B	Ring Terminal - 1/4 inch (6 mm)	Black	-	Chassis ground / battery negative (-)
1C	Connector, Winch Controller/Contactor	-	4 male	Main vehicle harness breakout; see instructions for detail
1D	Clip, Edge	-	-	Vehicle structure
1E	Connector, Winch Controller/Contactor	-	4 male	PRE-CONNECTED to 1G
1F	(unused)	-	-	-
1G	Connector, Winch Controller/Contactor	-	4 female	PRE-CONNECTED to 1E
1H	(unused)	-	-	-
1J	Clip, Routing	-	-	Vehicle structure
1K	Clip, Edge	-	-	Vehicle structure

AUTOSTOP FAIRLEAD HARNESS ③ (Kit 2882715 only):

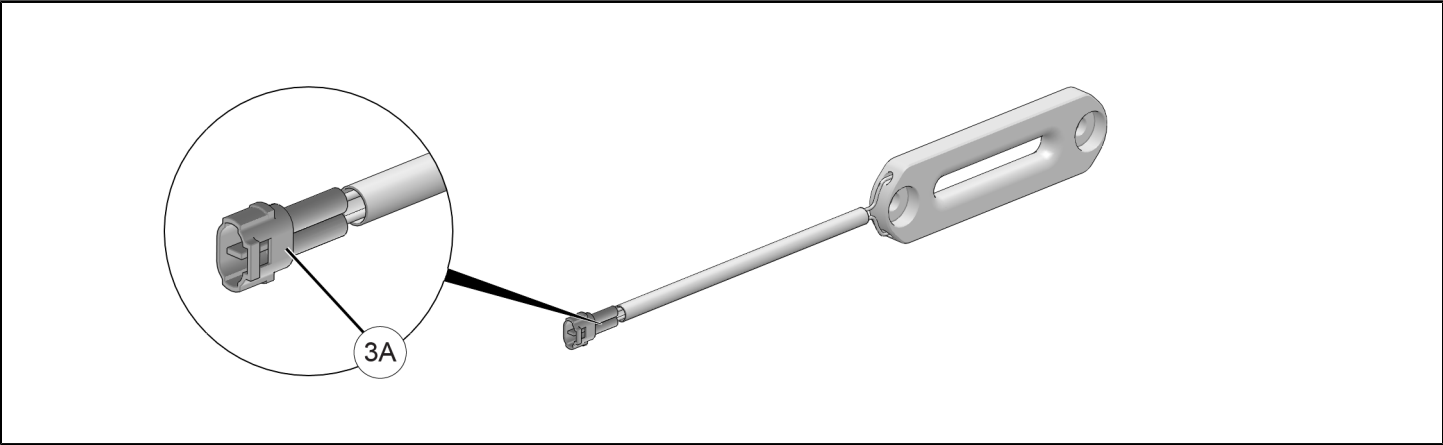

REF	PART DESCRIPTION	WIRE COLOR	PIN QTY/ GENDER	CONNECTS TO
3A	Connector, Autostop Fairlead	-	2 male	See instructions for detail

WIRELESS RECEIVER HARNESS ⑭ (Kit 2882715 only):

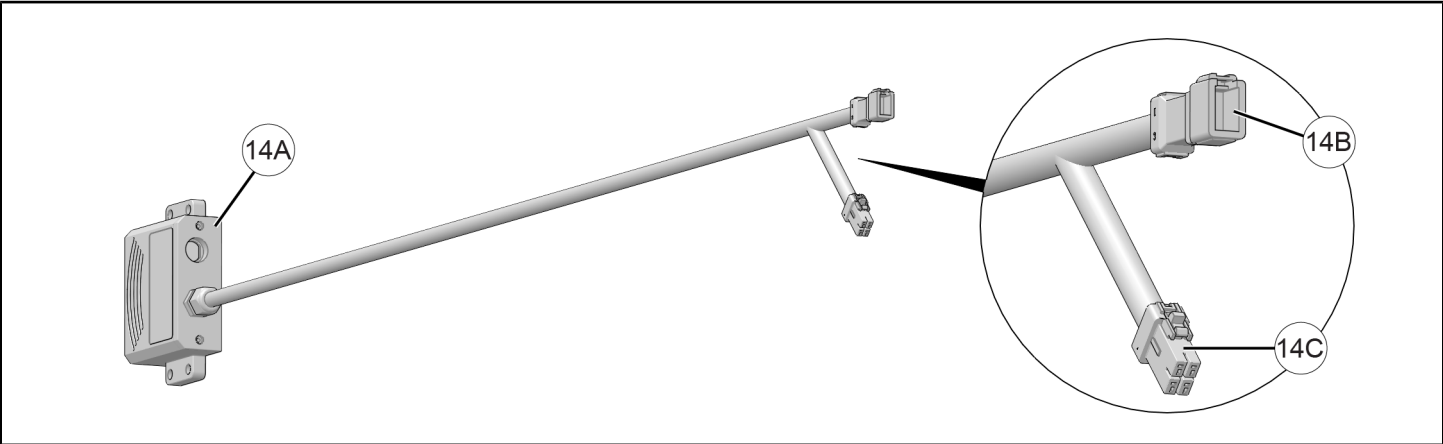

REF	PART DESCRIPTION	WIRE COLOR	PIN QTY/ GENDER	CONNECTS TO
14A	Wireless Receiver	-	-	Vehicle structure
14B	Connector, Winch Controller/Contactor	-	4 male	Main vehicle harness breakout; see instructions for detail
14C	Connector, Wired Remote	-	4 female	OPTIONAL: Wired remote socket, connector 17B*

* Or compatible kit.

WIRED REMOTE SOCKET ⑰ (Kit 2882714 only):

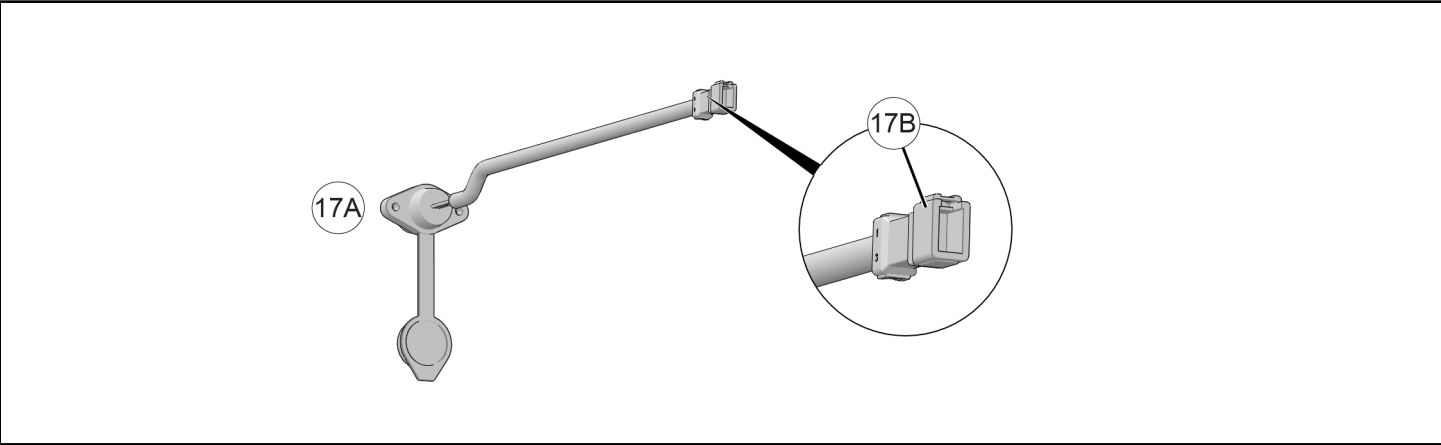

REF	PART DESCRIPTION	WIRE COLOR	PIN QTY/ GENDER	CONNECTS TO
17A	Connector, Wired Remote	-	-	Wired remote ⑮
17B	Connector, Winch Controller/Contactor	-	4 male	Main vehicle harness breakout; see instructions for detail

TOOLS REQUIRED

- Safety Glasses
 - Drill
 - Drill Bit:
 - Hole Saw:
 - Pliers, Push Pin Rivet
- Screwdriver Set, Torx®
 - Socket Set, Hex Bit, Metric
 - Socket Set, Metric
 - Torque Wrench
 - Wrench Set, Metric

IMPORTANT

Your Winch Kit is exclusively designed for your vehicle. Please read the installation instructions thoroughly before beginning. Installation is easier if the vehicle is clean and free of debris. For your safety, and to ensure a satisfactory installation, perform all installation steps correctly in the sequence shown.

INSTALLATION INSTRUCTIONS

1. Shift vehicle transmission into **PARK**. Turn ignition key to **OFF** position and remove from ignition switch.
2. Flip up passenger seat bottom, remove driver's seat and underseat storage compartment, then disconnect black negative (-) cable from battery.
3. Gain access.
 - a. Remove hood.
 - b. Remove lower grille by carefully depressing two tabs **A** at top of grille, tip grille outward, then lift grille out of two lower side tabs **B** in upper fascia.

NOTE

Bumper hidden for clarity.

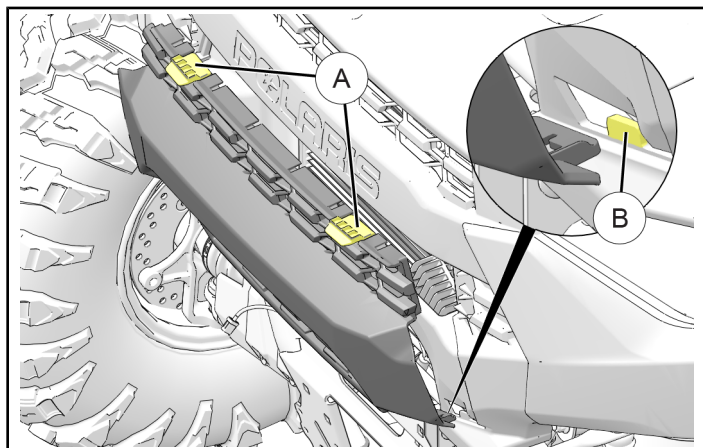

- c. Remove upper dash cupholder by removing two push pin rivets **C**, then sliding cupholder rearward. Retain rivets.

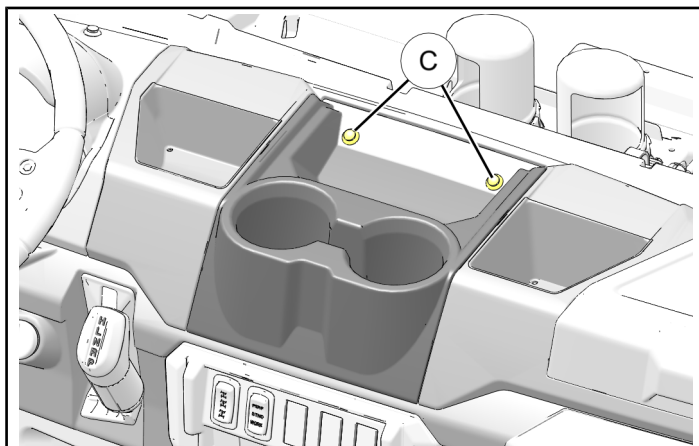

4. Remove and prepare front bumper.
 - a. Remove nut **D** and screw **E** from bottom of bumper. Repeat for opposite side. Retain hardware.

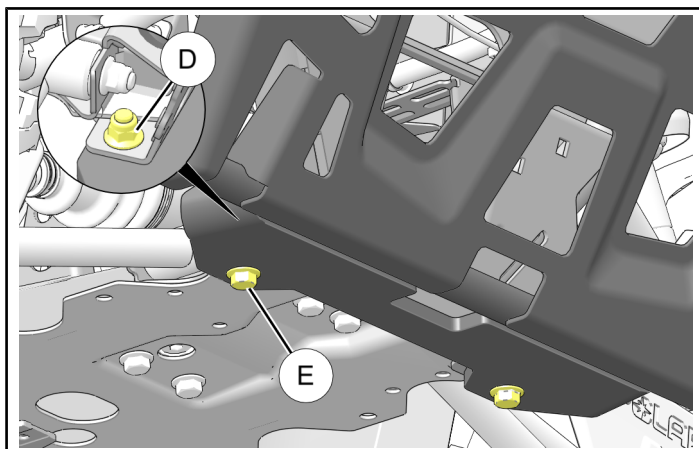

⚠ CAUTION

Bumper weighs approximately 38 lbs. (17 kg). Provide adequate support for bumper before removing final screws. Failure to comply may result in personal injury or damage to bumper.

- b. While supporting bumper, remove nut (F) and screw (G). Repeat for opposite side, then remove bumper and set aside. Retain hardware.

NOTE

Screws (G) pass through bumper support brackets (H). These brackets will be referenced in Step 5a.

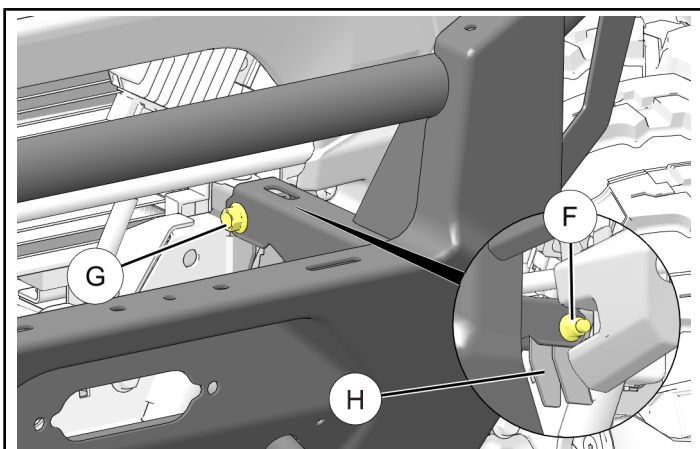

- c. Install autostop fairlead (3) (Kit 2882715) or standard fairlead (4) (Kit 2882714), and fairlead backer plate (2), to bumper using two screws (7). Tighten screws. Set bumper aside.

IMPORTANT

If installing autostop fairlead (3), then ensure fairlead is oriented so electrical harness exits on RH side of bumper as shown.

TORQUE

40 ft. lbs. (54 Nm) \pm 10%

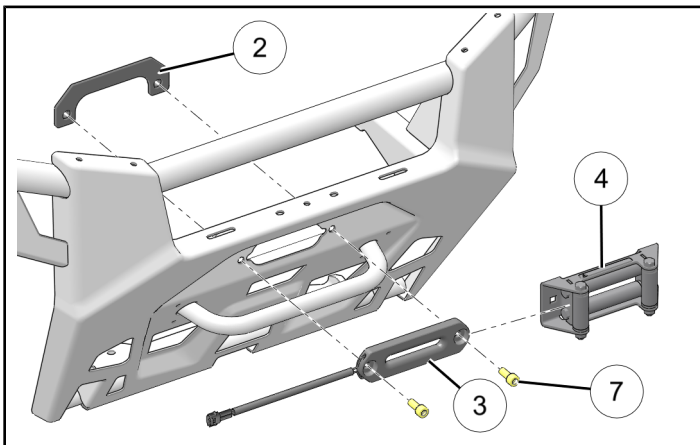

5. Install winch assembly.

- a. Hang rear hooks of winch assembly (1) on vehicle front support structure, centered between two bumper support brackets (H) as noted in previous Step 4b.

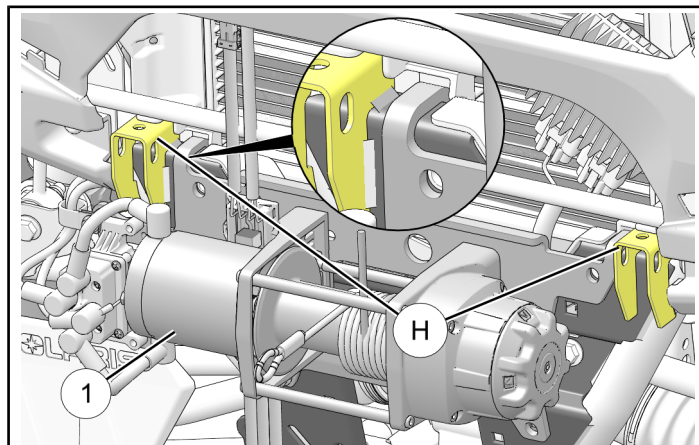

- b. At UPPER fastener holes loosely install two screws ⑱ REARWARD through winch into vehicle front support structure.

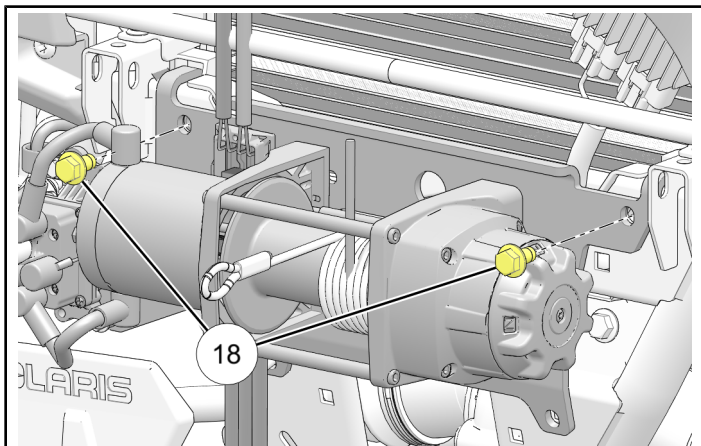

- c. At LOWER fastener holes install two screws ⑨ FORWARD through vehicle front support structure and winch, then secure each screw with nut ⑧.

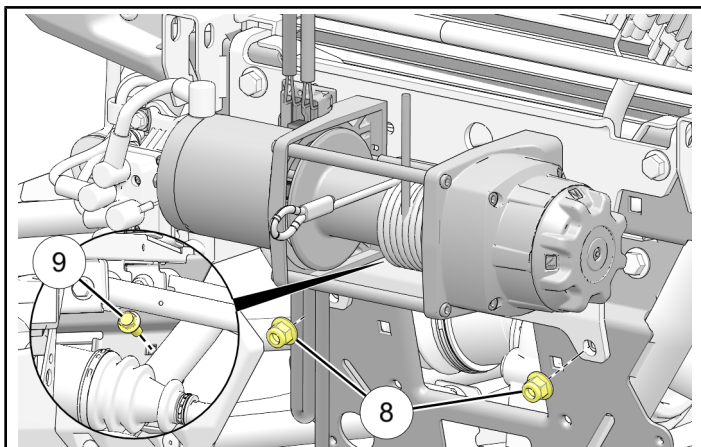

- d. Torque screws ⑱ and nuts ⑧ to specification.

TORQUE

40 ft. lbs. (54 Nm) ± 10%

6. Route cables and make connections at terminal block.

- a. Route terminal block cables ① upward from winch ①, then through cut-out in under-hood liner ⑫. Secure cables to vehicle using edge clip 1D and lower routing clip 1J.

NOTE

See previous section, **HARNESS DETAIL**, for connector identification.
View looking inboard from right front wheel well. Wheel hidden for clarity.

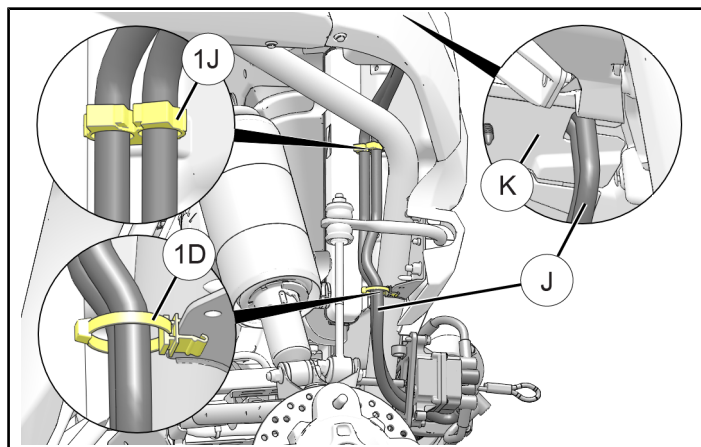

- b. Secure terminal block cables ① to under-hood liner using upper routing clip 1J.

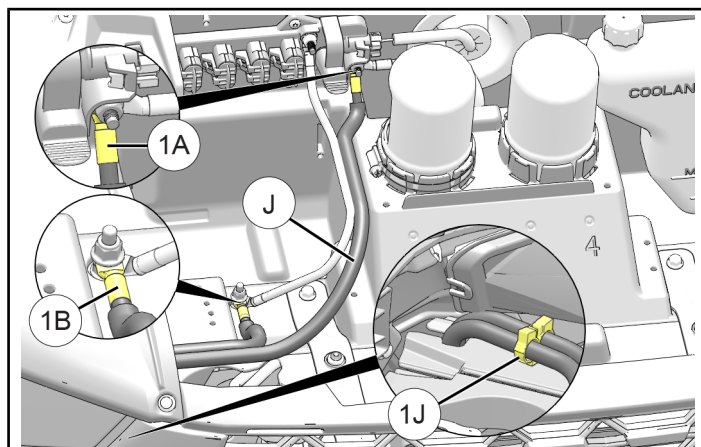

- c. Join **RED** 45 degree ring terminal 1A to terminal block battery positive (+). Torque nut to specification, then install boot.

TORQUE

30 in. lbs. (3.4 Nm) ± 10%

NOTE

If two cable boots exist for same terminal, then slide inner boot (closest to terminal block) down cable.
Unused boot can remain on cable.
Red boot not shown for clarity.

- d. Join **BLACK** straight ring terminal 1B to chassis ground / battery negative (-). Torque nut to specification.

TORQUE

8 ft. lbs. (11 Nm) ± 10%

7. **Kit 2882715:** Proceed to Step 8.

Kit 2882714: Secure winch jumper to chassis structure using two edge clips 1K.

NOTE

View looking inboard from right front wheel well. Connectors 1C, 1G, and 1E shown for reference; 1G comes pre-connected to 1E. Some vehicle components hidden for clarity.

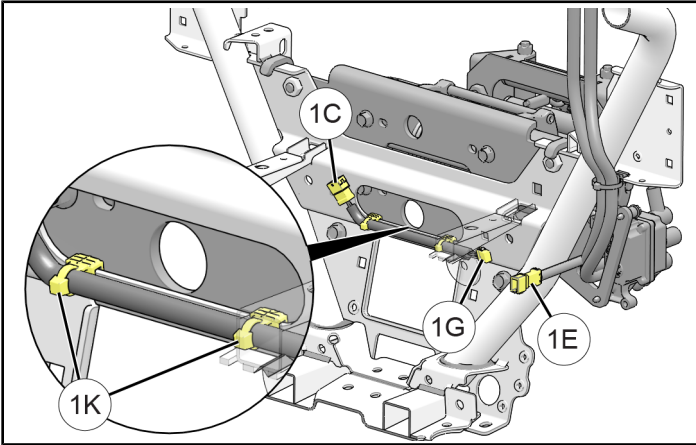

8. Locate UNUSED 4-pin main vehicle harness breakout connector ① (near head of lower left winch attach screw ⑨). Remove cap from connector, then join to mating winch connector 1C.

NOTE

View looking inboard from right front wheel well. Kit 2882715 shown; kit 2882714 similar. Some vehicle components hidden for clarity.

- MY20 and older: Cut two cable ties holding connector 1C and route harness over top of winch bracket to backside of frame to connect to vehicle harness ①.

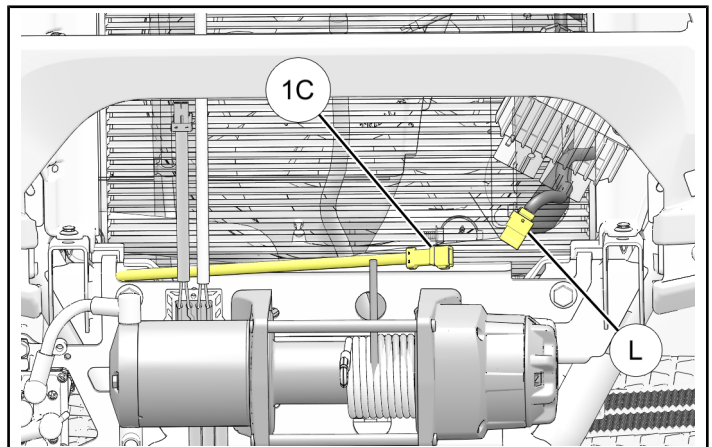
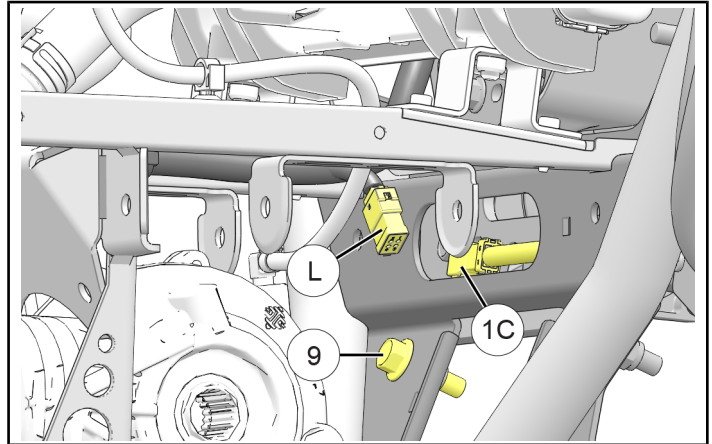

- MY 21 and newer: Connect vehicle harness ① located near bottom front of radiator to winch connector 1C. It is not necessary to cut cable ties to make connection.

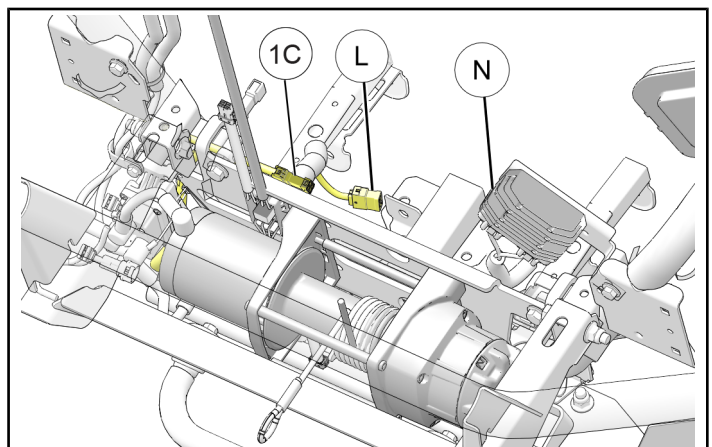

9. Install remote and associated components.

Kit 2882715

a. Install wireless receiver.

- i. Install wireless receiver ⑭ to RH side of under-hood liner using four screws ⑩. Do not over-tighten screws.

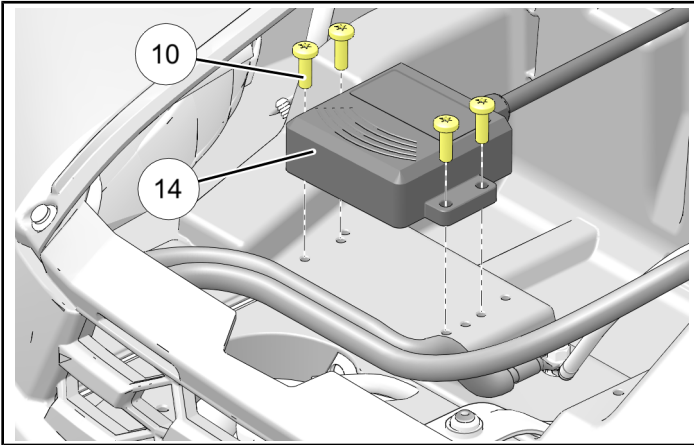

- ii. Route wireless receiver connectors 14B and 14C rearward through firewall grommet into upper dash compartment.
- iii. Locate UNUSED 4-pin main vehicle harness breakout connector ⑓ in cavity where cupholder was removed in Step 3c. Remove cap from connector, then join to mating wireless receiver connector 14B.

NOTE

Wireless receiver connector 14C provided for optional WIRED remote connection. See previous section, **HARNESS DETAIL**, for more information.

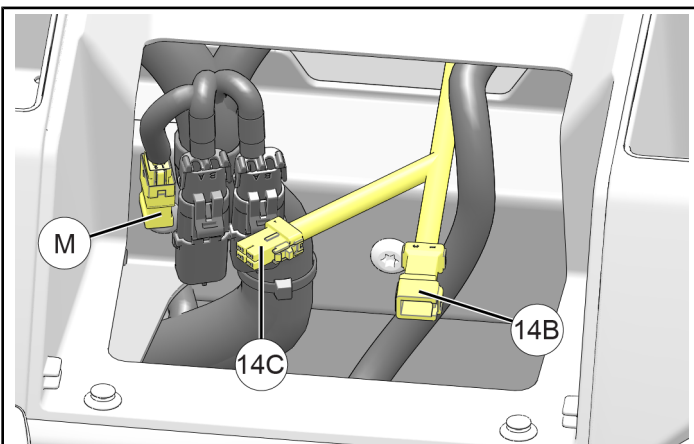

b. OPTIONAL: Install wireless remote.

NOTE

Wireless remote can be stowed in any suitable location. Holder ⑬ is not required.

- i. Remove wireless remote ⑫ from holder ⑬. Determine suitable mounting location for holder with special attention to the following:
- Driver operation of vehicle (including travel of controls, such as shift lever)
 - Driver visibility
 - Adequate clearance between holder mounting fasteners and other vehicle components on underside of mounting surface
- ii. Using holder ⑬ as template, mark and drill two 1/8 inch (3 mm) holes into mounting surface.

IMPORTANT

Control drill depth to prevent damage to underlying structure or components.

- iii. Install holder ⑬ using two screws ⑪. Do not over-tighten screws.
- iv. Reinstall wireless remote into holder.

Kit 2882714

- a. On lower dash panel, locate and mark centerpoint between two fastener dimples ⑒. Cut hole ⑐ through panel at marked location using 1 inch (25 mm) hole saw.

IMPORTANT

Control drill depth to prevent damage to underlying structure or components.

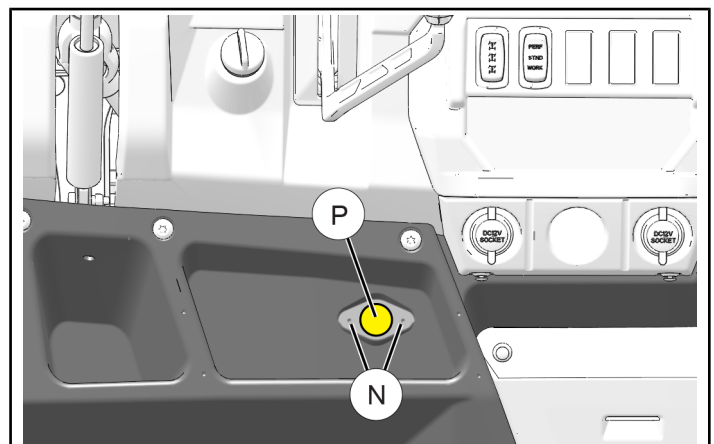

- b. Using 1/8th inch (3 mm) drill bit, drill out two fastener dimples **(N)**. Only drill deep enough to penetrate panel surface and enter pre-drilled bosses on opposite side of panel.

NOTE

It is not necessary to remove lower dash panel. All holes are drilled from rear (passenger) side of panel. Forward side of panel shown below for reference only.

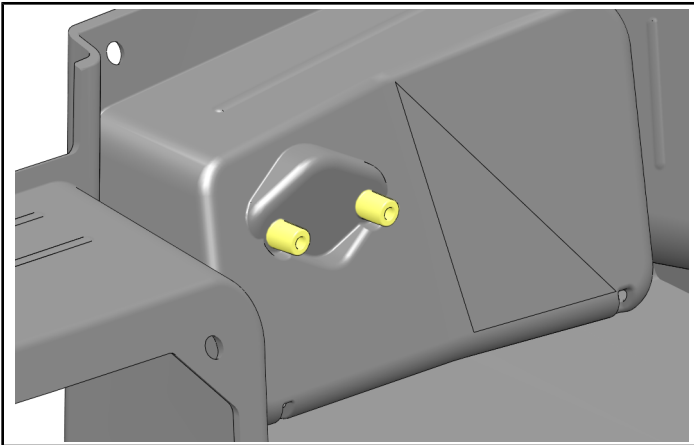

- c. Insert connector 17B on wired remote socket **(17)** through hole **(P)**, then feed harness through hole until socket contacts lower dash panel.

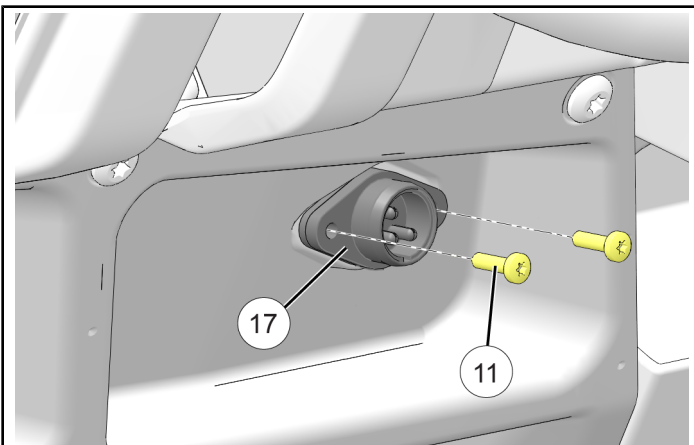

- d. Install socket to dash panel using two each screws **(11)**. Do not over-tighten screws.
- e. Route connector 17B upward through dash towards upper dash cupholder. Ensure routing prevents harness contact with hot components, sharp edges, or moving parts.

- f. Locate UNUSED 4-pin main vehicle harness breakout connector **(M)** in cavity where cupholder was removed in Step 3c. Remove cap from connector, then join to mating wired remote connector 17B.

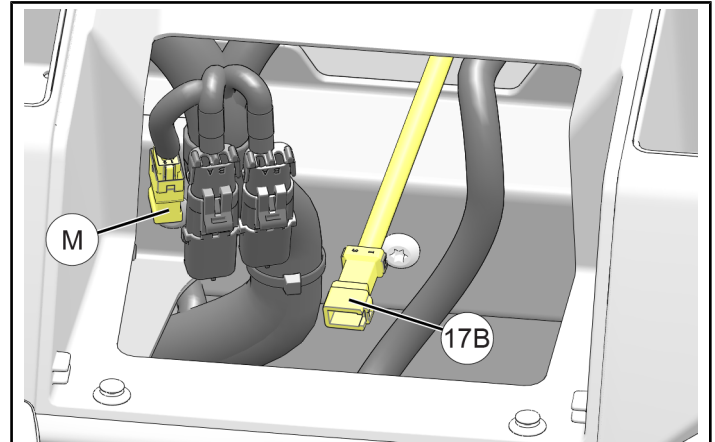

- g. Plug wired remote **(15)** into wired remote socket **(17)**.

10. Reinstall bumper.

- a. Unwind BY HAND several turns of rope/cable from winch spool. While lifting bumper into position thread loop at end of rope/cable through bumper and fairlead **(3)** or **(4)** (as applicable).

IMPORTANT

Do NOT electrically operate winch at this time.

NOTE

Autostop fairlead **(3)** shown; standard fairlead **(4)** similar.

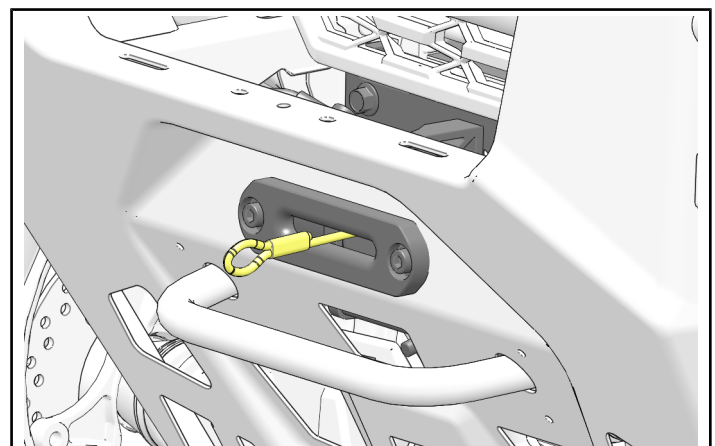

- b. Loosely install middle of bumper to vehicle frame using two each retained screws **(G)** and nuts **(F)**. See Step 4b.
- c. Install bottom of bumper to vehicle frame using two each retained screws **(E)** and nuts **(D)**. See Step 4a.

d. Torque fasteners to specification.

TORQUE

40 ft. lbs. (54 Nm) \pm 10%

11. Reinstall lower grille. See Step 3b.

12. **Kit 2882714**: Proceed to next Step 13.

Kit 2882715: Connect autostop fairlead ③.

NOTE

View looking up and forward from front right wheel. Installation of RIDE COMMAND® Kit (PN 2882872, 2884564, or equivalent) may affect some of the following connections. See instructions included with RIDE COMMAND® Kit for details.

- a. Your vehicle will have one of two chassis harness configurations at front of vehicle. Harness configuration will affect installation of autostop fairlead connector.

Determine harness configuration as follows:

FACTORY CHOICE harness has the following breakouts:

- Two regulators ①
- 4-pin female connector ① (previously joined to connector 1C in Step 8)
- 2-pin male connector ②
- 2-pin female connector ③

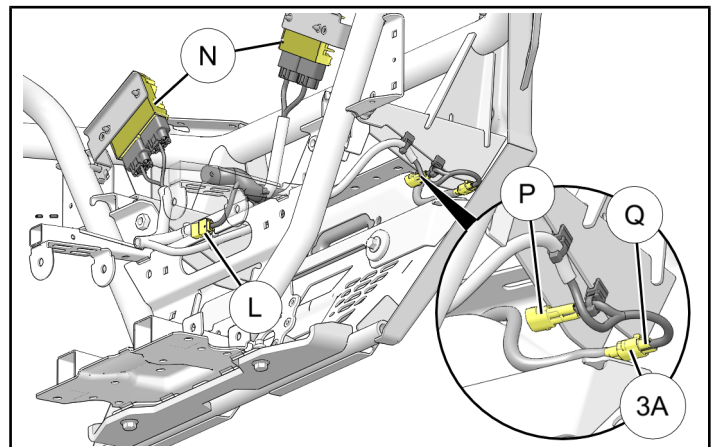

NON-FACTORY CHOICE harness has the following breakouts:

- One regulator ①
- 4-pin female connector ① (previously joined to connector 1C in Step 8)

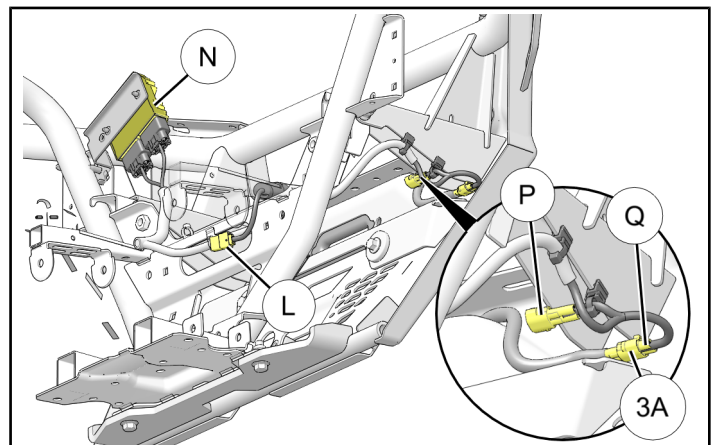

- b. Make electrical connections.

NOTE

See previous section, **HARNESS DETAIL**, for connector identification.

FACTORY CHOICE

- i. Join connector 1F on winch ① to main chassis harness connector ⑧.
- ii. Join main chassis harness connector ⑩ to connector 3A on autostop fairlead ③.
- iii. Ensure routing prevents harness contact with hot components, sharp edges, or moving parts.

NON-FACTORY CHOICE

Join connector 1F on winch ① to connector 3A on autostop fairlead ③. Ensure routing prevents harness contact with hot components, sharp edges, or moving parts.

13. Install remaining winch components.

Kit 2882715

- a. Thread loop at end of rope through magnetic stop ⑤. Ensure stop is oriented with WIDE end (with magnet) towards winch, and BEVELED end (with "POLARIS") towards hook.

TIP

Loop a cable tie to end of rope, but do not tighten. Thread looped cable tie through magnetic stop, then pull cable tie and rope through magnetic stop.

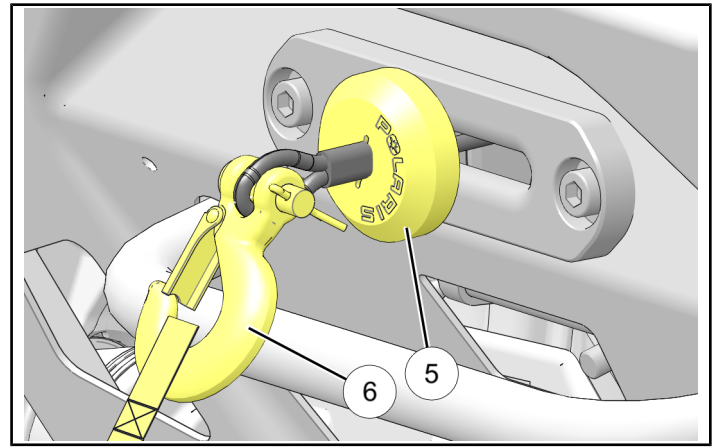

- b. Install hook ⑥ to loop at end of rope. Ensure cotter pin is secured.

Kit 2882714

Install hook ⑥ to loop at end of cable. Ensure cotter pin is secured.

CAUTION

Use caution when operating 4500 lb Winch Kit 2882714. Winch does NOT have autostop mechanism to prevent hook from retracting through fairlead. Hook must be manually stopped PRIOR to contact with fairlead. Failure to stop hook from contacting fairlead may result in damage to fairlead, bumper, or other components.

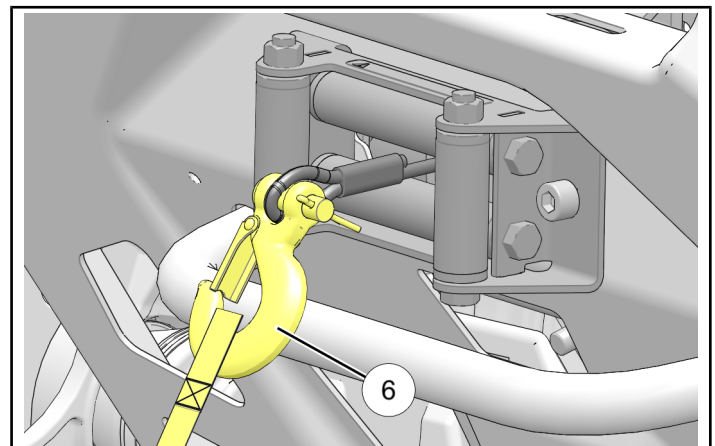

14. Secure all harnesses using cable ties ⑲ as required to prevent contact with hot components, sharp edges, or moving parts.
15. Restore access. See Step 3.
16. Reconnect black negative (-) cable to battery, then reinstall under-seat storage compartment and driver's seat.

INSTRUCTION FEEDBACK FORM

A feedback form has been created for the installer to provide any comments, questions or concerns about the installation instructions. The form is viewable on mobile devices by scanning the QR code or by clicking [HERE](#) if viewing on a PC.

