

CREW REAR DOOR KIT



P/N 2883437

APPLICATION

Verify accessory fitment at Polaris.com.

BEFORE YOU BEGIN

Read these instructions and check to be sure all parts and tools are accounted for. Please retain these installation instructions for future reference and parts ordering information.

KIT CONTENTS

This Kit includes:

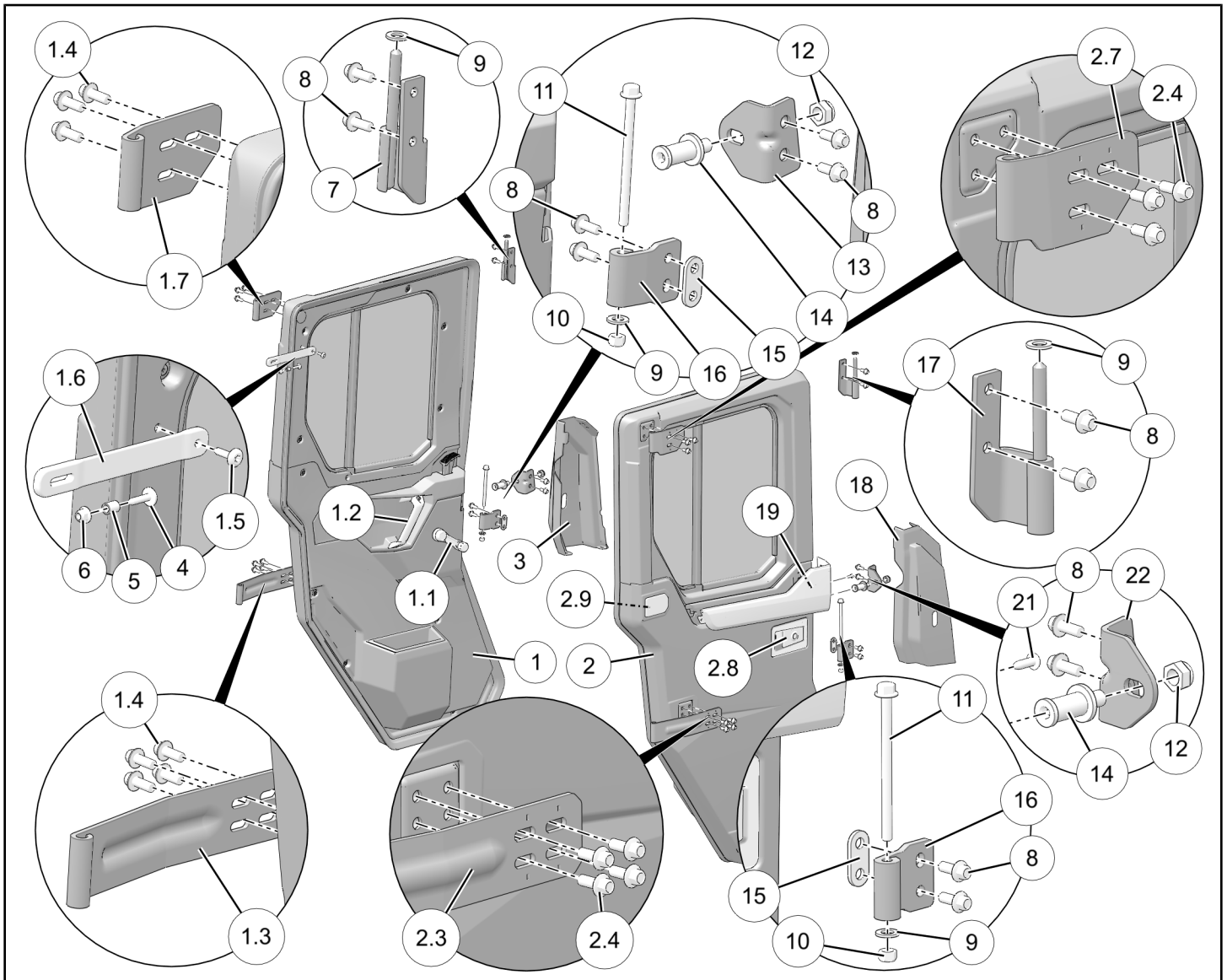

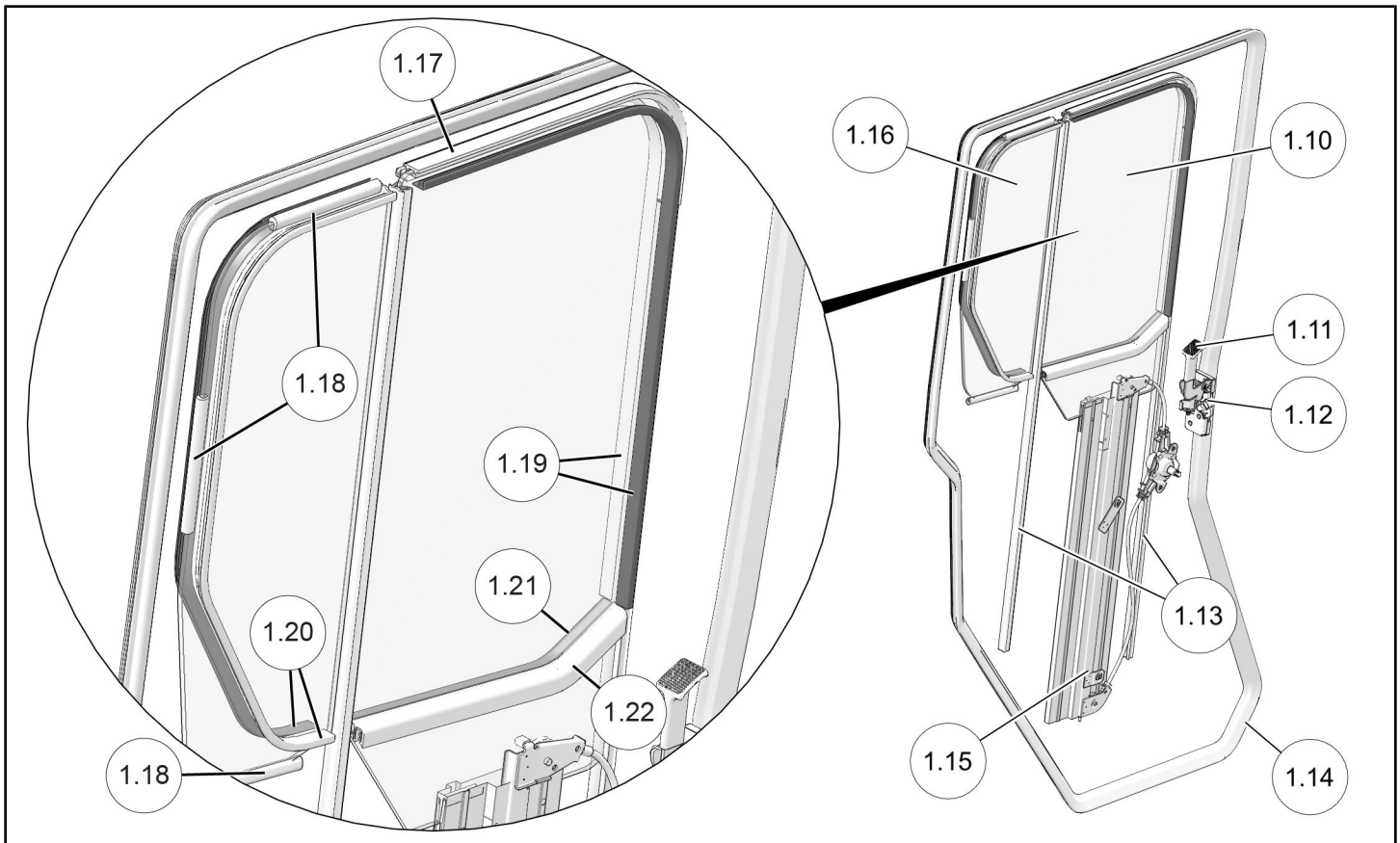

REF	QTY	PART DESCRIPTION	PART NUMBER	INCLUDED IN SERVICE KIT
1	1	Door Assembly, LH (includes items 1.1 through 1.22 below)	2636817	-
1.1	1	- Crank, Window	-	2207712
1.2	1	- Handle, Grab, LH	-	2207851
1.3	1	- Hinge, Door Side, Lower	-	2207708
1.4	7	- Screw, Hex Flange - M8 X 1.25 X 20	7519936	2207708
1.5	1	- Screw, Torx® Truss Head - M6 X 1.0 X 25	7519650	2205280
1.6	1	- Strap, Limiter	-	2205280
1.7	1	- Hinge, Door Side, Upper, LH	-	2207708
1.8	1	- Latch Assembly, Exterior (not shown)	-	2207716
1.9	1	- Cover, Hinge (not shown)	-	2207853
1.10	1	- Glass, Moveable (Front)	-	2207855
1.11	1	- Handle, Latch	-	2207715
1.12	1	- Latch Assembly, Interior, LH	-	2207715
1.13	2	- Seal, Moveable Glass, Front/Rear	-	2207852
1.14	1	- Seal, Door, Full Perimeter	-	2207852
1.15	1	- Regulator Assembly, LH	-	2207856
1.16	1	- Glass, Fixed (Rear)	-	2207854

REF	QTY	PART DESCRIPTION	PART NUMBER	INCLUDED IN SERVICE KIT
1.17	1	- Seal, Moveable Glass, Upper	-	2207852
1.18	3	- Seal, Fixed Glass, Upper/Rear/Lower	-	2207852
1.19	2	- Seal, Moveable Glass, Upper/Front	-	2207852
1.20	2	- Seal, Fixed Glass, Upper/Rear/Lower	-	2207852
1.21	1	- Seal, Moveable Glass, Lower	-	2207852
1.22	1	- Seal, Moveable Glass, Lower	-	2207852
2	1	Door Assembly, RH (includes items 2.2, 2.7, 2.12, and 2.15 below; all other RH window parts same as LH window parts)	2636818	-
2.2	1	- Handle, Grab, RH (not shown)	-	2207851
2.7	1	- Hinge, Door Side, Upper, RH	-	2207708
2.12	1	- Latch Assembly, Interior, RH (not shown)	-	2207715
2.15	1	- Regulator Assembly, RH (not shown)	-	2207857
3	1	Cover, B-Pillar, LH	5454372-070	-
4	2	Screw, Torx® Truss Head - M6 X 1.0 X 25	7519650	2205280
5	2	Spacer	5139193	2205280
6	2	Nut, Hex Flange, Locking - M6 X 1.0	7547339	2205280
7	1	Hinge, Chassis-Side, Upper, LH (front door)	-	2207849
8	12	Screw, Hex Flange - M8 X 1.25 X 20	7519936	-
9	4	Washer, Nylon - 10.25 X 19.0 X 2.0	5439712	2207849
10	2	Nut, Hex, Locking - M8 X 1.25	7547480	2207849
11	2	Screw, Hex Flange - M8 X 1.25 X 120	7519818	2207849
12	2	Nut, Hex - M12 X 1.75	7540000	2207850
13	1	Bracket, Striker, LH	-	2207850
14	2	Pin, Striker	-	2207850
15	2	Spacer	-	2207849
16	2	Hinge, Chassis-Side, Lower (front door)	-	2207849
17	1	Hinge, Chassis-Side, Upper, RH (front door)	-	2207849
18	1	Cover, B-Pillar, RH	5454373-070	-
19	1	Panel, Accent, RH	5454769-070	-
20	1	Panel, Accent, LH (not shown)	5454768-070	-
21	2	Screw, Torx® Truss Head, High/Low - #14 X 3/4	7519045	-
22	1	Bracket, Striker, RH	-	2207850
	1	Instructions	9928645	-

TOOLS REQUIRED

- Safety Glasses
- Pliers, Push Pin Rivet
- Screwdriver Set, Torx®
- Socket Set, Hex Bit, Metric
- Socket Set, Metric
- Socket Set, Torx® Bit
- Torque Wrench
- Wrench Set, Metric

CONSUMABLES REQUIRED

- Gloves, Chemical Resistant
- Grease, Polaris All Season (or equivalent)

IMPORTANT

Your Crew Rear Door Kit is exclusively designed for your vehicle. Please read the installation instructions thoroughly before beginning. Installation is easier if the vehicle is clean and free of debris. For your safety, and to ensure a satisfactory installation, perform all installation steps correctly in the sequence shown.

ASSEMBLY TIME

Approximately 75-90 minutes

INSTALLATION INSTRUCTIONS

IMPORTANT

Polaris recommends installing this Crew Rear Door Kit **PRIOR TO** Front Door Kit (PN 2882561, 2882562, or equivalent).
When installing front doors on **crew** vehicles, hinge installation is different from **non-crew** vehicles.

NOTE

Polaris recommends two people install this kit.

1. Shift vehicle transmission into "PARK". Turn ignition switch to "OFF" position and remove key.
2. Open vehicle bed.
3. Install chassis-side **FRONT** door hinges.

IMPORTANT

The chassis-side hinges included in this Crew REAR Door Kit will be used on the FRONT doors. Conversely, the chassis-side hinges included in the FRONT Door Kit will be used on the Crew REAR doors.

Swapping hinges is required to accommodate different hinge mounting structure in crew and non-crew vehicles.

As a result, do NOT follow hinge installation instructions included in the Front Door Kit. Follow these instructions instead.

- a. Identify upper **LH** chassis-side hinge ⑦. Notice differences from upper **RH** chassis-side hinge ⑰.

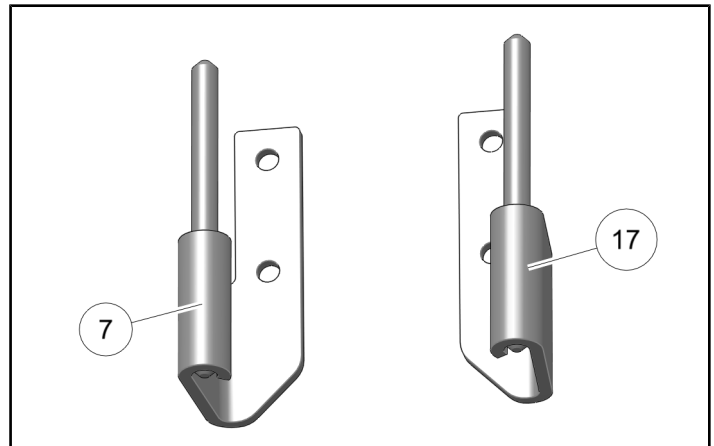

- b. Loosely install upper LH chassis-side hinge ⑦ to B-pillar fitting using two screws ⑧.

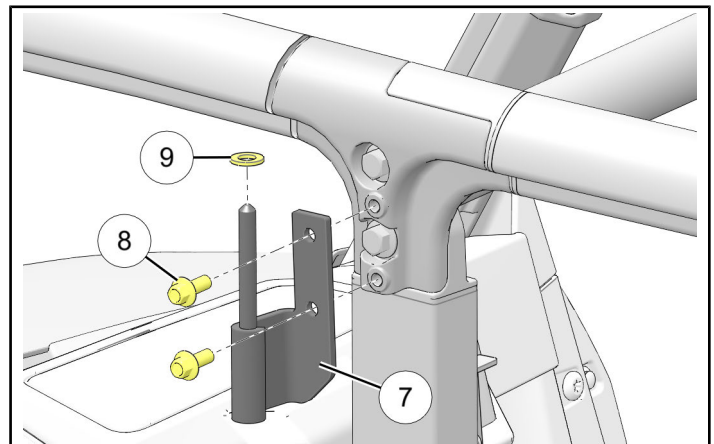

- c. Install nylon washer ⑨ to hinge pin.

NOTE

Washer acts as bearing surface to assist in smooth door operation.

- d. Remove two screws ① from top of existing B-pillar cover. Retain screws.

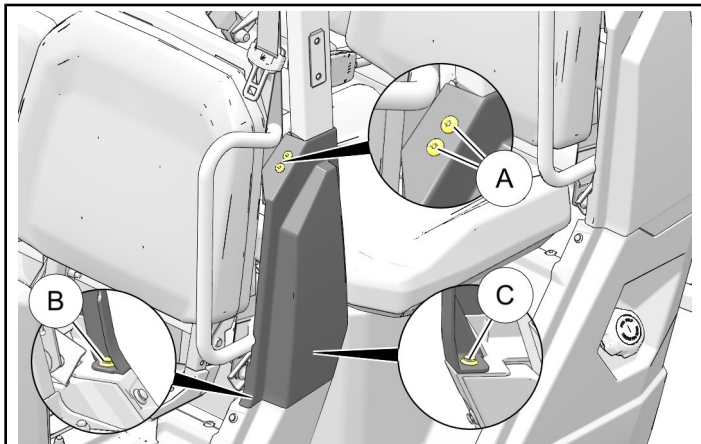

- e. Remove two push pin rivets from bottom interior of B-pillar cover (front rivet ② and rear rivet ③), then remove cover. Retain rivets. Cover will not be reused.

- f. Install new B-pillar cover ④ using retained screws ① and push-pin rivets ② and ③.

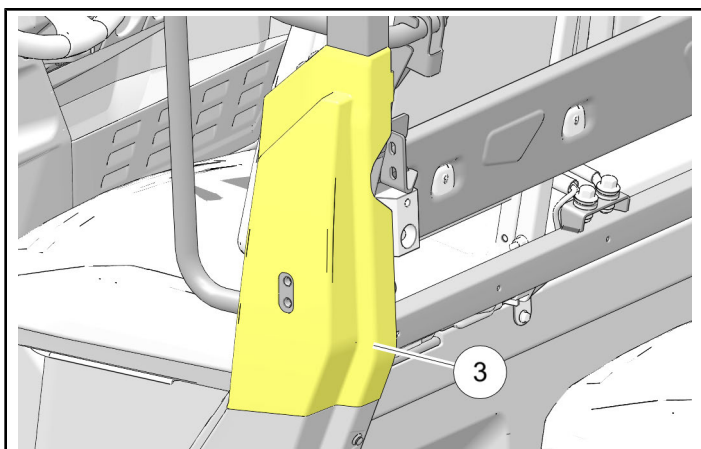

- g. Loosely install spacer ⑮ and lower chassis-side hinge ⑯ to B-pillar fitting using two screws ⑧.

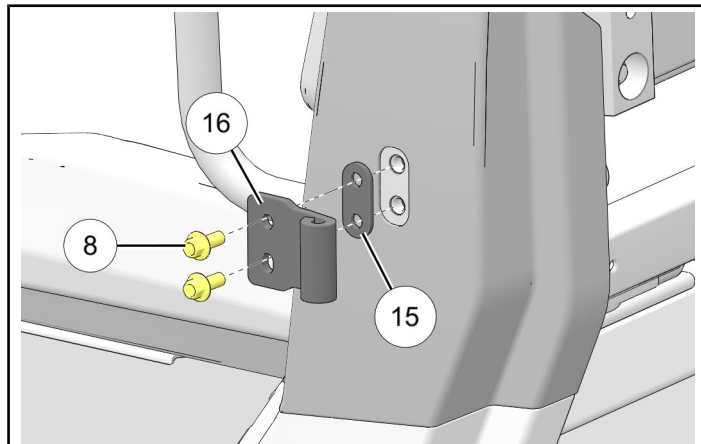

⚠ WARNING

Follow all chemical manufacturer instructions and safety precautions. Failure to follow all manufacturer instructions and precautions may result in severe injury or death.

- h. Grease screw ⑪ and pin on upper chassis-side hinge ⑦ with Polaris All Season Grease (or equivalent).
- i. Hang front door assembly ① on upper chassis-side hinge ⑦. Align door with lower chassis-side hinge ⑯, insert nylon washer ⑨ between chassis and door-side hinges as shown, then install screw ⑪.

Secure with nut ⑩. Torque to specification.

TORQUE

8 ft. lbs. (11 Nm) ± 20%

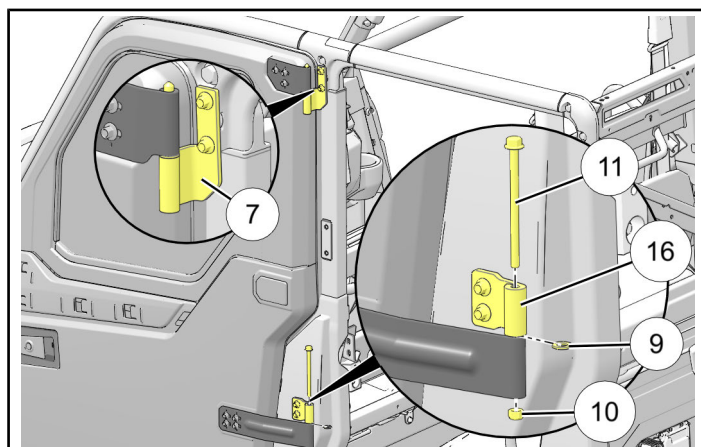

- j. Continue with front door installation per instructions provided with Front Door Kit. Torque all four hinge screws ⑧ to specification.

TORQUE

17 ft. lbs. (23 Nm) ± 10%

4. Install chassis-side **REAR** door hinges.

- a. Locate the following parts included in the **FRONT DOOR KIT**:

- Upper **LH** chassis-side hinge ④ and upper **RH** chassis-side hinge ⑤
- Four M8 X 1.25 X 20 hex flange screws
- Two nutplates
- Two nylon washers

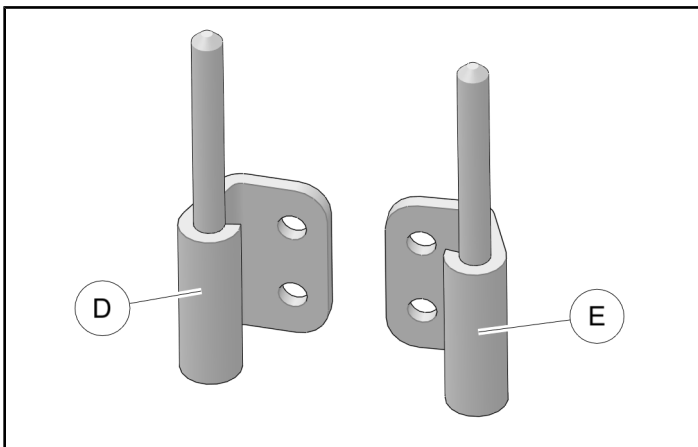

- b. Loosely install upper LH chassis-side hinge ④ to C-pillar fitting using two screws and nut plate.

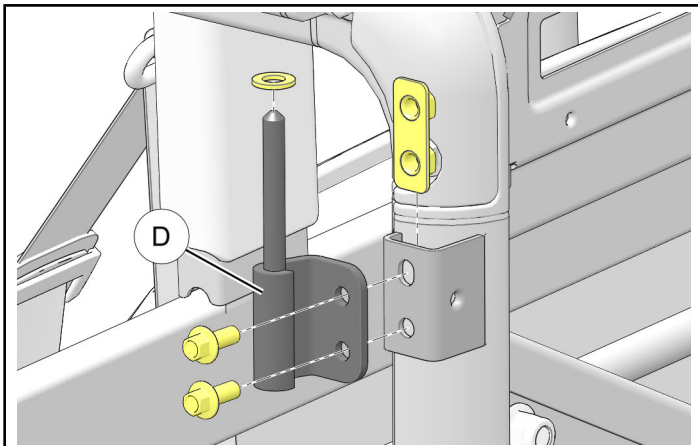

- c. Install nylon washer to hinge pin.

NOTE

Washer acts as bearing surface to assist in smooth door operation.

- d. Locate the following parts included in the **FRONT DOOR KIT**:

- Lower **LH** chassis-side hinge ⑥ and lower **RH** chassis-side hinge ⑦
- Four M8 X 1.25 X 20 hex flange screws
- Two nylon washers

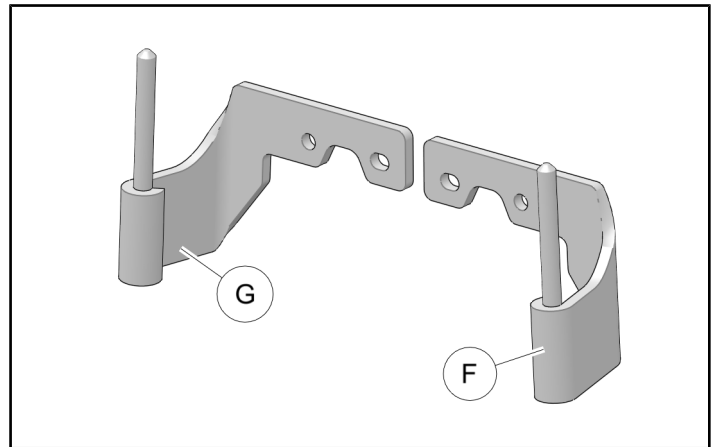

- e. Loosely install lower LH chassis-side hinge ⑥ to chassis fitting using two screws.

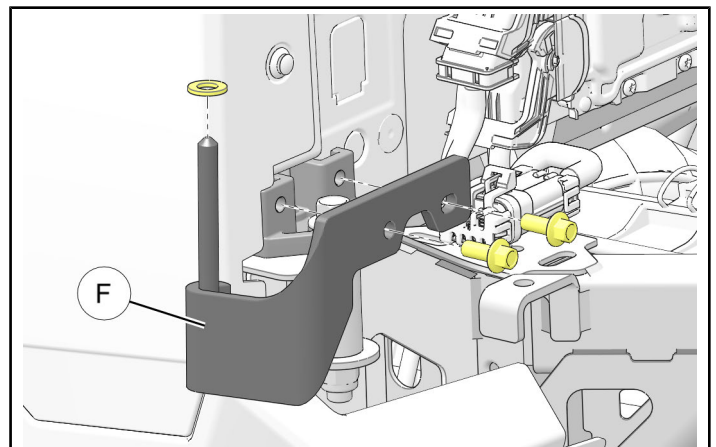

- f. Install nylon washer to hinge pin.

⚠ WARNING

Follow all chemical manufacturer instructions and safety precautions. Failure to follow all manufacturer instructions and precautions may result in severe injury or death.

5. Grease pins on upper and lower hinges ④ and ⑥ using Polaris All Season Grease (or equivalent).

6. Install LH rear door assembly ① on lower hinge ⑥ first, then upper hinge ④.

NOTE

Lower hinge pin is longer than upper hinge pin to assist in door installation.

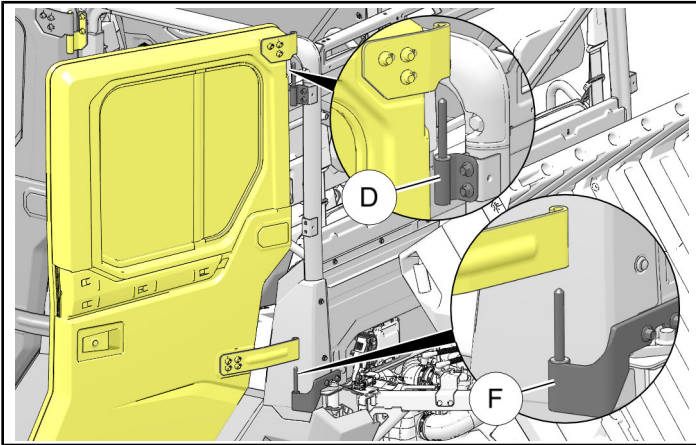

7. With upper and lower chassis-side hinge screws still slightly loose, close door.

Push door inwards while centering door in ROPS/chassis opening. Hold door in place, then observe gap between door assembly ① and ROPS/chassis (around entire perimeter of door).

- **IF PERIMETER GAP IS EVEN:** Determine if gap exists between bottom of DOOR-SIDE hinges ⑧ and ① and corresponding CHASSIS-SIDE hinges ④ and ⑥. If hinge gap exists, adjust height of upper chassis-side hinge ④ to eliminate gap and equalize door loading. Tighten screws.

NOTE

If necessary, remove one or both nylon washers ⑨ to eliminate hinge gap.

- **IF PERIMETER GAP IS UNEVEN:** Loosen all seven upper and lower DOOR-SIDE hinge screws ⑦, center door in opening using slotted fastener openings, then re-tighten same screws.

When complete, go to previous section, **IF PERIMETER GAP IS EVEN.**

TIP

Have one person hold and center the door, and a second person tighten the screws.

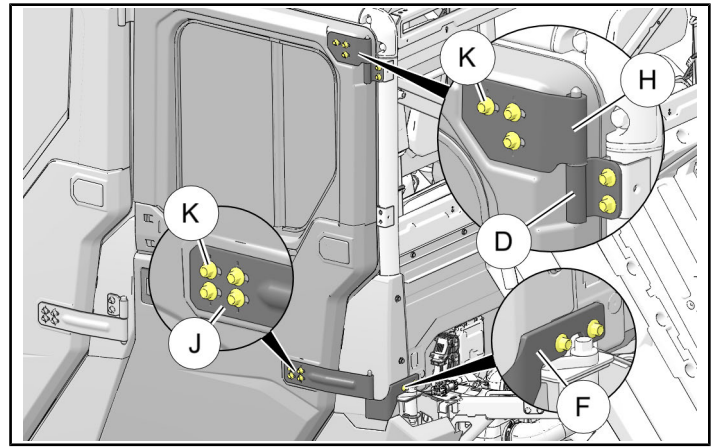

8. Torque all four chassis-side hinge screws (and door-side hinge screws ⑦, if loosened) to specification.

TORQUE

17 ft. lbs. (23 Nm) ± 10%

9. Assemble and install striker.
 - a. Identify LH striker bracket ⑬. Notice differences from RH striker bracket ⑭.

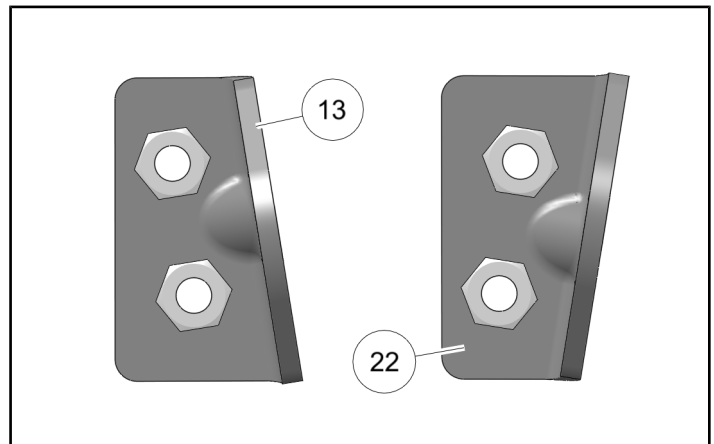

- b. Install striker pin ⑮ to LH striker bracket ⑬ using nut ⑫. Center pin in slot, then tighten nut.

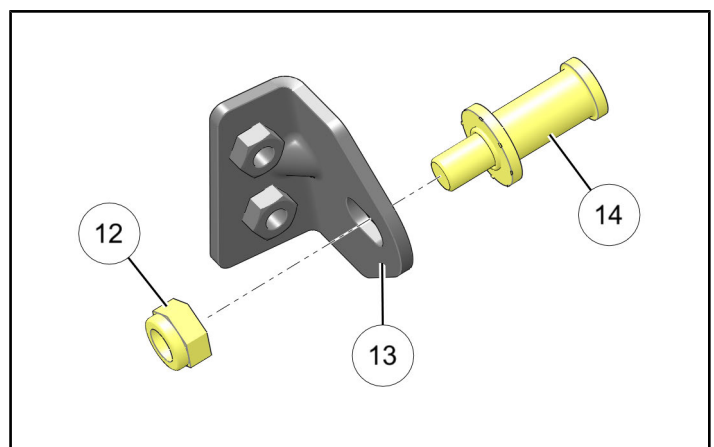

- c. Install LH striker bracket ⑬ to chassis using two screws ⑧. Center bracket in slots, then tighten screws.

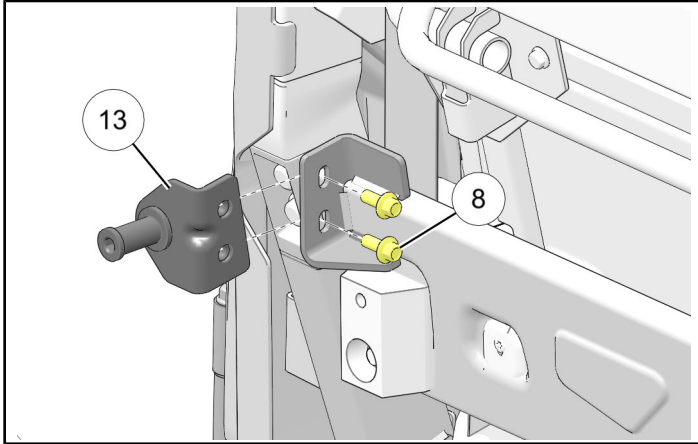

10. Open door latch (to properly position pawls), then slowly close door and observe engagement of striker pin ⑭ into door latch.

Adjust striker pin and/or striker bracket ⑬ to achieve the following:

- HEIGHT (L):** Pin ⑭ should be centered vertically in opening of latch pawls (M). To adjust, loosen two screws ⑧, slide striker bracket ⑬ up or down as required, then retighten screws.
- DEPTH (N):** As required to achieve desired fairing between door assembly ① and ROPS/chassis structure. To adjust, loosen nut ⑫, slide striker pin ⑭ inboard or outboard as required, then retighten nut.

Ensure depth adjustment is made with latch pawls (M) at FULL closure as shown below (second "click"), not at partial closure (first "click").

NOTE

Nut can be accessed by reaching up from below striker bracket.
Bracket shown partially transparent for clarity.

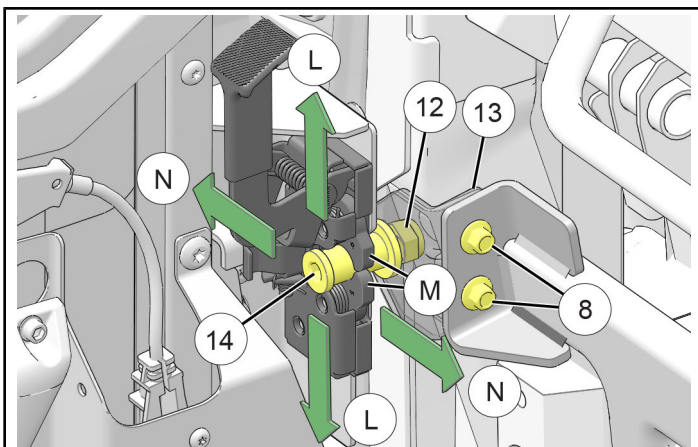

11. Torque striker screws ⑧ to specification.

TORQUE

17 ft. lbs. (23 Nm) ± 10%

12. Torque striker nut ⑫ to specification.

TORQUE

30 ft. lbs. (41 Nm) ± 10%

13. Install limiter strap retaining post to ROPS diagonal support using screw ④, spacer ⑤, and nut ⑥. Torque to specification, then secure strap (P) to retaining post.

TORQUE

7 ft. lbs. (9 Nm) ± 10%

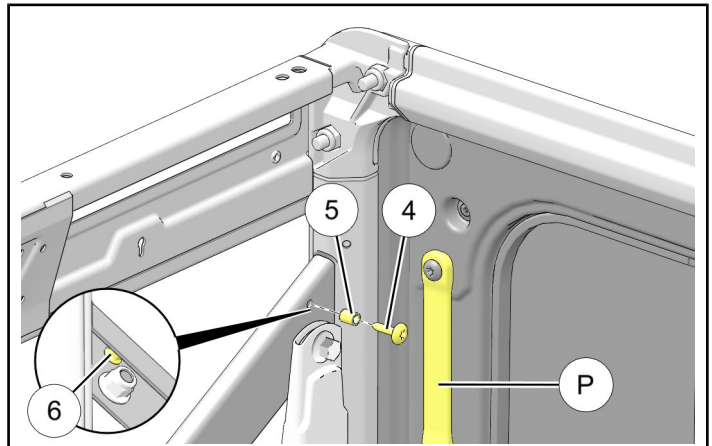

14. Install LH accent panel ⑳ to door, engaging tabs in door with receptacles in panel, then secure using screw ㉑. Torque to specification.

TORQUE

18 in. lbs. (2.0 Nm) ± 20%

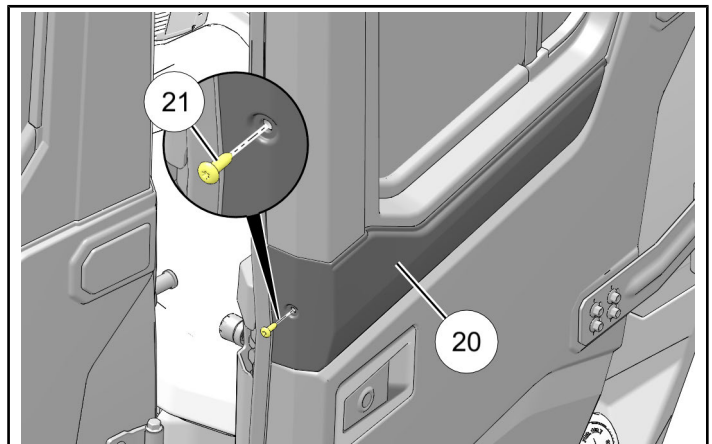

15. Repeat Steps 3–14 for RH door assembly ②, using upper RH chassis-side hinge ⑰, RH B-pillar cover ⑱, RH accent panel ⑲, and RH striker bracket ⑳.

16. Lower vehicle bed.

17. Restore access.

FEEDBACK FORM

A feedback form has been created for the installer to provide any comments, questions or concerns about the installation instructions. The form is viewable on mobile devices by scanning the QR code or by clicking [HERE](#) if viewing on a PC.

